

SEE DRAWING No. 121153-GR1

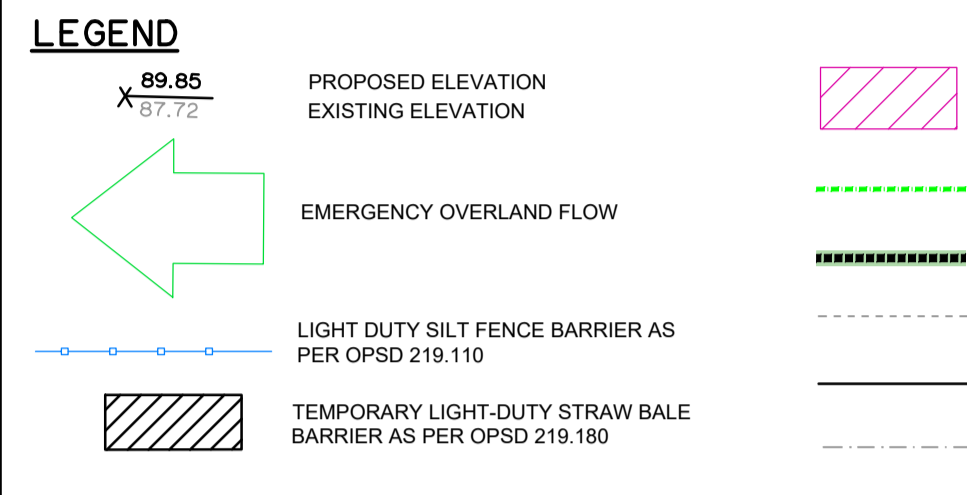
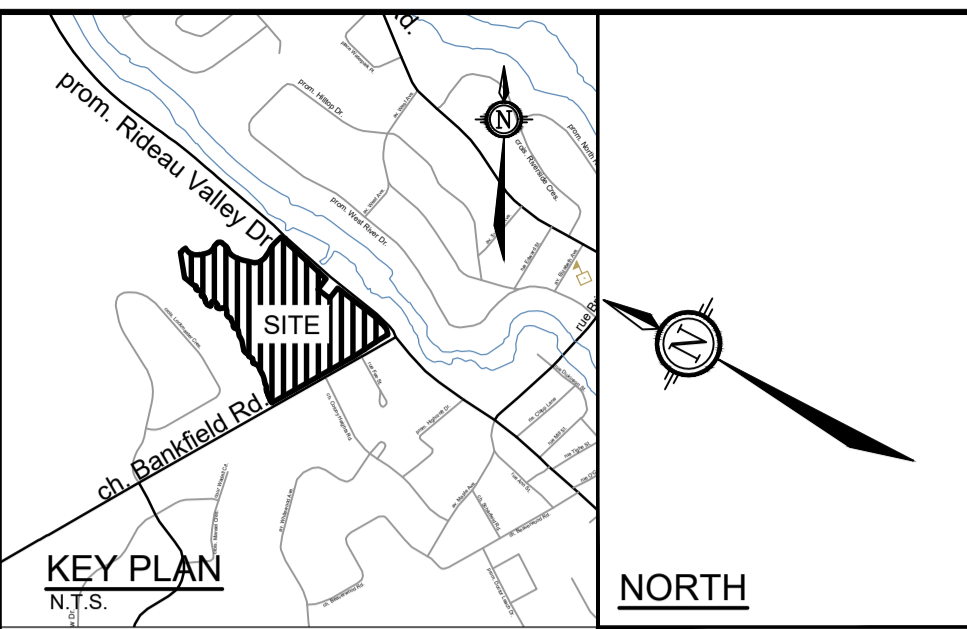

REAR HALF OF LOTS 30-32 & 56-63 AND BLOCKS 64 & 79 TO SHEET DRAIN TO OXBOW

BLOCK 80 PH1 OPEN SPACE 2.87 Ha

BLOCK 79 PH1 EDMUND STINSON PARK 0.24 Ha

BLOCK 81 PH1 OPEN SPACE 1.44 Ha

REAR HALF OF LOTS 1-29 TO SHEET DRAIN TO WILSON COWAN DRAIN

TO BE FILLED IN WILSON COWAN DRAIN

REFER TO 121153-GR1 FOR EROSION AND SEDIMENT CONTROL NOTES

M:\2024\121153\CAD\Design\Figures\121153-GR_V3.dwg, GR2, Dec 18, 2024, 8:47 am, bundle

NOTE: THE POSITION OF ALL POLE LINES, CONDUITS, WATERMANS, SEWERS AND OTHER UNDERGROUND AND OVERGROUND UTILITIES AND STRUCTURES IS NOT NECESSARILY SHOWN ON THE CONTRACT DRAWINGS, AND WHERE SHOWN, THE ACCURACY OF THE POSITION OF SUCH UTILITIES AND STRUCTURES IS NOT GUARANTEED. BEFORE STARTING WORK, DETERMINE THE EXACT LOCATION OF ALL SUCH UTILITIES AND STRUCTURES AND ASSUME ALL LIABILITY FOR DAMAGE TO THEM.

No.	REVISION	DATE	BY
6.	ISSUED FOR PH 2 REVIEW	JUN 18/26	BHB
5.	ISSUED FOR RE-SUBMISSION REVIEW	MAR 3/25	BHB
4.	ISSUED FOR RE-SUBMISSION REVIEW	DEC 13/24	BHB
3.	ISSUED FOR RE-SUBMISSION REVIEW	OCT 23/24	BHB
2.	ISSUED FOR RE-SUBMISSION REVIEW	APR 11/24	BHB
1.	ISSUED FOR REVIEW	JAN 6/23	BHB

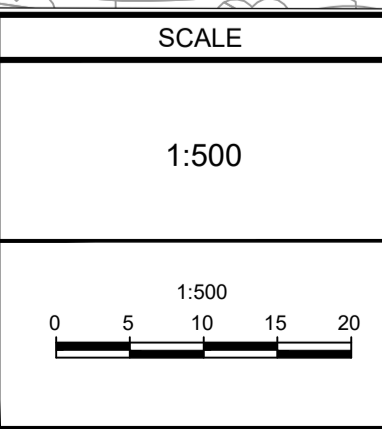

DESIGN	FOR REVIEW ONLY
BPR	
CHECKED BHB	
DRAWN BPR	
CHECKED BHB	
APPROVED BHB	

NOVATECH
 Engineers, Planners & Landscape Architects
 Suite 200, 240 Michael Cowpland Drive
 Ottawa, Ontario, Canada K2M 1R6
 Telephone: (613) 254-9643
 Facsimile: (613) 254-5867
 Website: www.novatech-eng.com

LOCATION CITY OF OTTAWA STINSON LANDS SUBDIVISION	PROJECT No. 121153-00
DRAWING NAME CONCEPTUAL GRADING, EROSION, & SEDIMENT CONTROL PLAN	REV # REV
	DRAWING No. 121153-GR2