

**INVENTORY INFORMATION:**  
 FIRST INVENTORY: November 23th-26th, 2022      SECOND INVENTORY: December 12th-13th, 2022

**LEGEND**

- MINIMUM TREE PROTECTION ZONE
- EX. DECIDUOUS TREE TO REMAIN
- EX. CONIFEROUS TREE TO REMAIN
- EX. DECIDUOUS TREE TO BE REMOVED
- EX. CONIFEROUS TREE TO BE REMOVED
- TREE PRESERVATION FENCING SEE DETAIL 1, TPD-1
- TREE GROUP
- TREE TAG / IDENTIFICATION

FOR EXISTING TREE IDENTIFICATION TABLE REFER TO ARBORIST REPORT APPENDIX B

**MIGRATORY BIRD CONVENTION ACT:**  
 IN ACCORDANCE WITH THE MIGRATORY BIRDS CONVENTION ACT, 1994, TREE REMOVAL SHALL NOT TAKE PLACE FROM MARCH 31<sup>ST</sup> TO AUGUST 31<sup>ST</sup>.

CLIENT  
**CANADA LANDS COMPANY**  
 100 Queen St Suite 1050, Ottawa, ON K1P 1A5

**COPYRIGHT**  
 This drawing has been prepared solely for the intended use, thus any reproduction or distribution for any purpose other than authorized by Arcadis is forbidden. Written dimensions shall have precedence over scaled dimensions. Contractors shall verify and be responsible for all dimensions and conditions on the job, and Arcadis shall be informed of any variations from the dimensions and conditions shown on the drawing. Shop drawings shall be submitted to Arcadis for general conformance before proceeding with fabrication.

Arcadis Professional Services (Canada) Inc.

**ISSUES**

No.	DESCRIPTION	DATE
1	DRAFT PLAN OF SUBDIVISION	2024-09-06
2	RESUBMITTED FOR DRAFT PLAN OF SUBDIVISION	2026-01-06

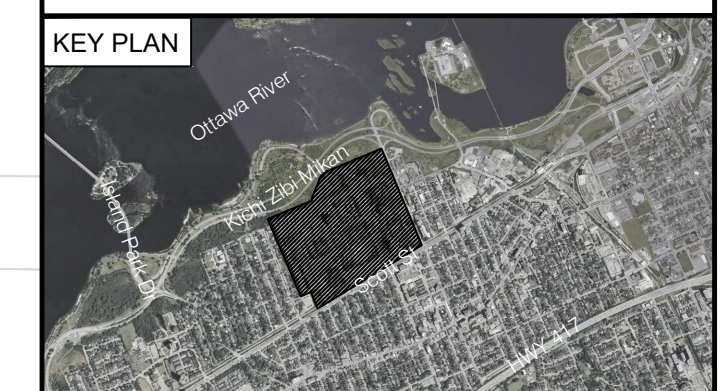

CONSULTANTS

NOT FOR CONSTRUCTION

SEAL

PRIME CONSULTANT

**ARCADIS**

360 James Street North - Suite 200  
 Hamilton ON L8L 1H5 Canada  
 tel 905 546 1010  
 www.arcadis.com

PROJECT

**PUBLIC ROAD REDEVELOPMENT**

TUNNEY'S PASTURE OTTAWA, ON

PROJECT NO:  
139833

DRAWN BY:  
**T. KEMP**

PROJECT MGR:  
**S. ALBANESE**

CHECKED BY:  
**Z. BROWN**

APPROVED BY:  
**Z. BROWN**

SHEET TITLE

**TREE PROTECTION & REMOVALS KEY PLAN**

SHEET NUMBER

**TPP-1**

ISSUE

**2**

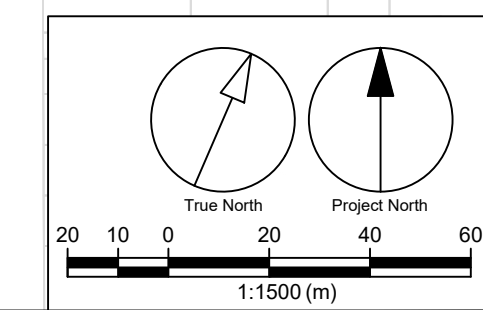

File Location: Y:\Toronto\139833\_TunneyPasture7.0\_Production\05\_LandscapeContent\139833TPP - CW.rvt    Last Saved: June 11, 2025, by kemp4336    Plotted: January 6, 2026 10:56:35 AM by Kemp, Taylor



**INVENTORY INFORMATION:**  
 FIRST INVENTORY: November 23th-26th, 2022  
 SECOND INVENTORY: December 12th-13th, 2022

**LEGEND**

- CRITICAL ROOT ZONE
- EX. DECIDUOUS TREE TO REMAIN
- EX. CONIFEROUS TREE TO REMAIN
- EX. DECIDUOUS TREE TO BE REMOVED
- EX. CONIFEROUS TREE TO BE REMOVED
- TREE PRESERVATION FENCING SEE DETAIL 1, TPD-1
- TREE GROUP
- TREE TAG / IDENTIFICATION

FOR EXISTING TREE IDENTIFICATION TABLE REFER TO ARBORIST REPORT APPENDIX B

**MIGRATORY BIRD CONVENTION ACT:**  
 IN ACCORDANCE WITH THE MIGRATORY BIRDS CONVENTION ACT, 1994, TREE REMOVAL SHALL NOT TAKE PLACE FROM MARCH 31<sup>ST</sup> TO AUGUST 31<sup>ST</sup>.

**CLIENT**  
**CANADA LANDS COMPANY**  
 100 Queen St Suite 1050, Ottawa, ON K1P 1A5

**COPYRIGHT**  
 This drawing has been prepared solely for the intended use, thus any reproduction or distribution for any purpose other than authorized by Arcadis is forbidden. Written dimensions shall have precedence over scaled dimensions. Contractors shall verify and be responsible for all dimensions and conditions on the job, and Arcadis shall be informed of any variations from the dimensions and conditions shown on the drawing. Shop drawings shall be submitted to Arcadis for general conformance before proceeding with fabrication.

**Arcadis Professional Services (Canada) Inc.**

**ISSUES**

No.	DESCRIPTION	DATE
1	DRAFT PLAN OF SUBDIVISION	2024-09-06
2026-01-08	RESUBMITTED FOR DRAFT PLAN OF SUBDIVISION	2025-06-13

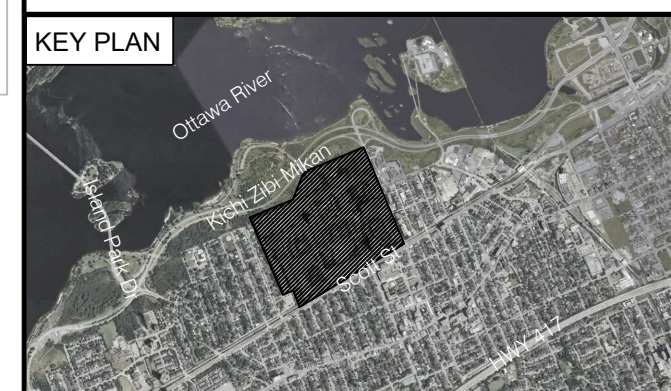

**CONSULTANTS**

**NOT FOR CONSTRUCTION**

**SEAL**

**PRIME CONSULTANT**  
**ARCADIS**  
 360 James Street North - Suite 200  
 Hamilton ON L8L 1H5 Canada  
 tel 905 546 1010  
 www.arcadis.com

**PROJECT**  
**PUBLIC ROAD REDEVELOPMENT**  
 TUNNEY'S PASTURE OTTAWA, ON

**PROJECT NO:** 139833

**DRAWN BY:** T.KEMP  
**CHECKED BY:** Z. BROWN

**PROJECT MGR:** S. ALBANESE  
**APPROVED BY:** Z. BROWN

**SHEET TITLE**  
**TREE PROTECTION & REMOVALS PLAN**

**SHEET NUMBER** **TPP-2** **ISSUE** **2**

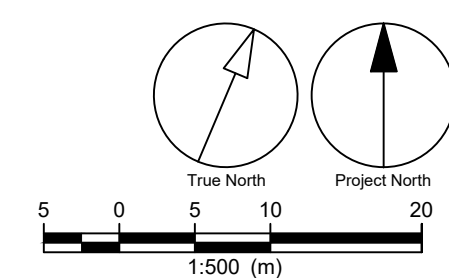

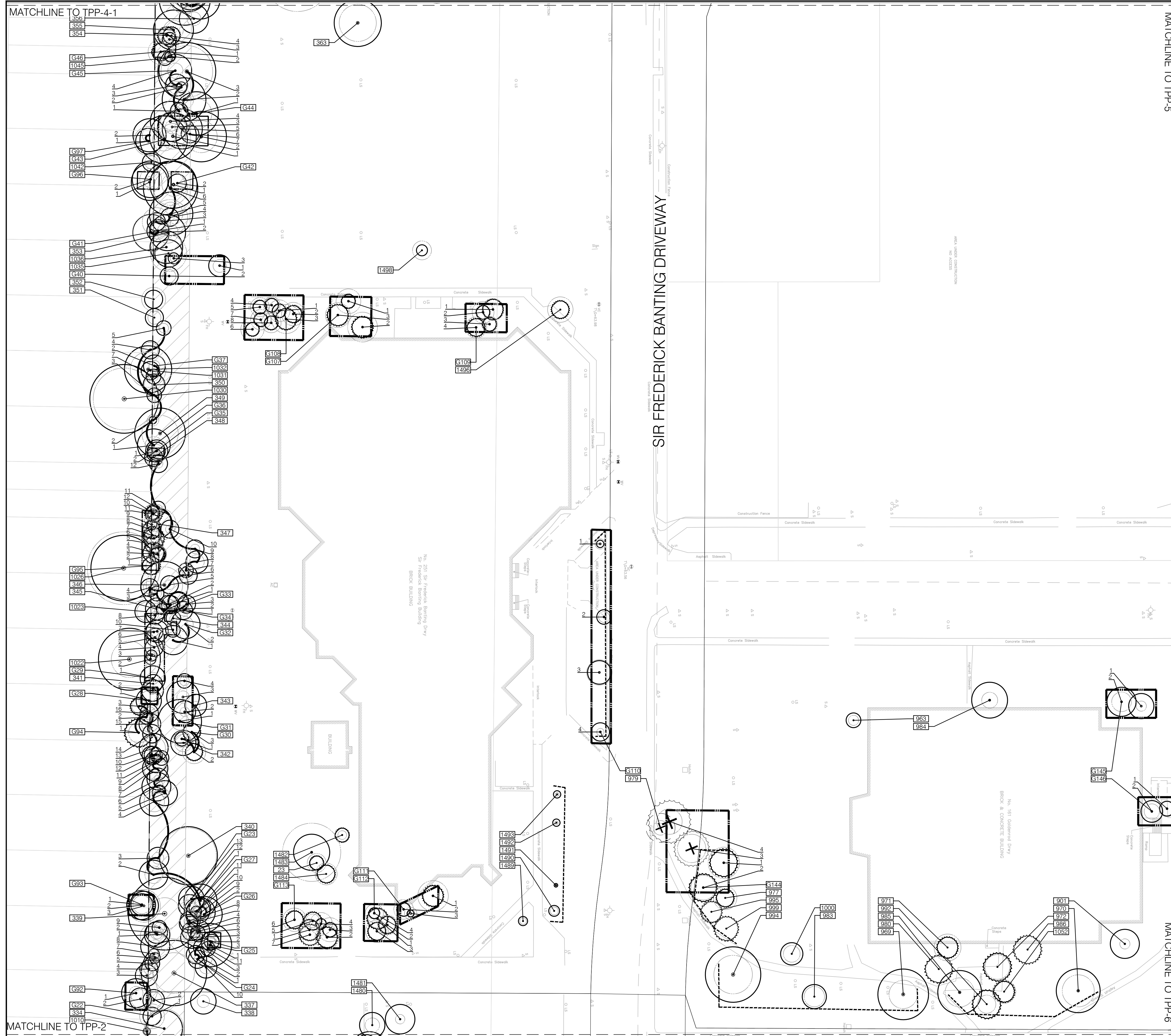

**INVENTORY INFORMATION:**  
 FIRST INVENTORY: November 23th-26th, 2022  
 SECOND INVENTORY: December 12th-13th, 2022

**LEGEND**

- CRITICAL ROOT ZONE
- EX. DECIDUOUS TREE TO REMAIN
- EX. CONIFEROUS TREE TO REMAIN
- EX. DECIDUOUS TREE TO BE REMOVED
- EX. CONIFEROUS TREE TO BE REMOVED
- TREE PRESERVATION FENCING SEE DETAIL 1, TPD-1
- TREE GROUP
- TREE TAG / IDENTIFICATION

FOR EXISTING TREE IDENTIFICATION TABLE REFER TO ARBORIST REPORT APPENDIX B

**MIGRATORY BIRD CONVENTION ACT:**  
 IN ACCORDANCE WITH THE MIGRATORY BIRDS CONVENTION ACT, 1994, TREE REMOVAL SHALL NOT TAKE PLACE FROM MARCH 31<sup>ST</sup> TO AUGUST 31<sup>ST</sup>.

**CLIENT**  
**CANADA LANDS COMPANY**  
 100 Queen St Suite 1050, Ottawa, ON K1P 1A5

**COPYRIGHT**  
 This drawing has been prepared solely for the intended use, thus any reproduction or distribution for any purpose other than authorized by Arcadis is forbidden. Written dimensions shall have precedence over scaled dimensions. Contractors shall verify and be responsible for all dimensions and conditions on the job, and Arcadis shall be informed of any variations from the dimensions and conditions shown on the drawing. Shop drawings shall be submitted to Arcadis for general conformance before proceeding with fabrication.

**Arcadis Professional Services (Canada) Inc.**

**ISSUES**

No.	DESCRIPTION	DATE
1	DRAFT PLAN OF SUBDIVISION	2024-09-06
2	RESUBMITTED FOR DRAFT PLAN OF SUBDIVISION	2026-01-06

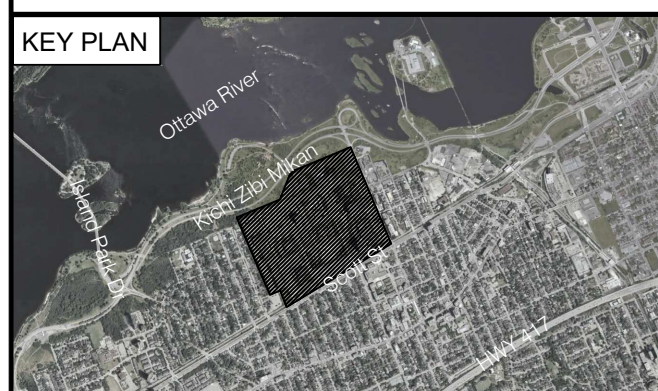

**CONSULTANTS**

**NOT FOR CONSTRUCTION**

**PRIME CONSULTANT**  
**ARCADIS**  
 360 James Street North - Suite 100  
 Hamilton ON L8L 1H5 Canada  
 tel 905 546 1010  
 www.arcadis.com

**PROJECT**  
**PUBLIC ROAD REDEVELOPMENT**  
 TUNNEY'S PASTURE OTTAWA, ON

**PROJECT NO:** 139833  
**DRAWN BY:** T.KEMP  
**CHECKED BY:** Z. BROWN  
**PROJECT MGR:** S. ALBANESE  
**APPROVED BY:** Z. BROWN

**SHEET TITLE**  
**TREE PROTECTION & REMOVALS PLAN**

**SHEET NUMBER** **TPP-3** **ISSUE** **2**

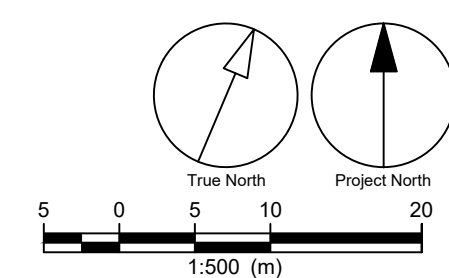

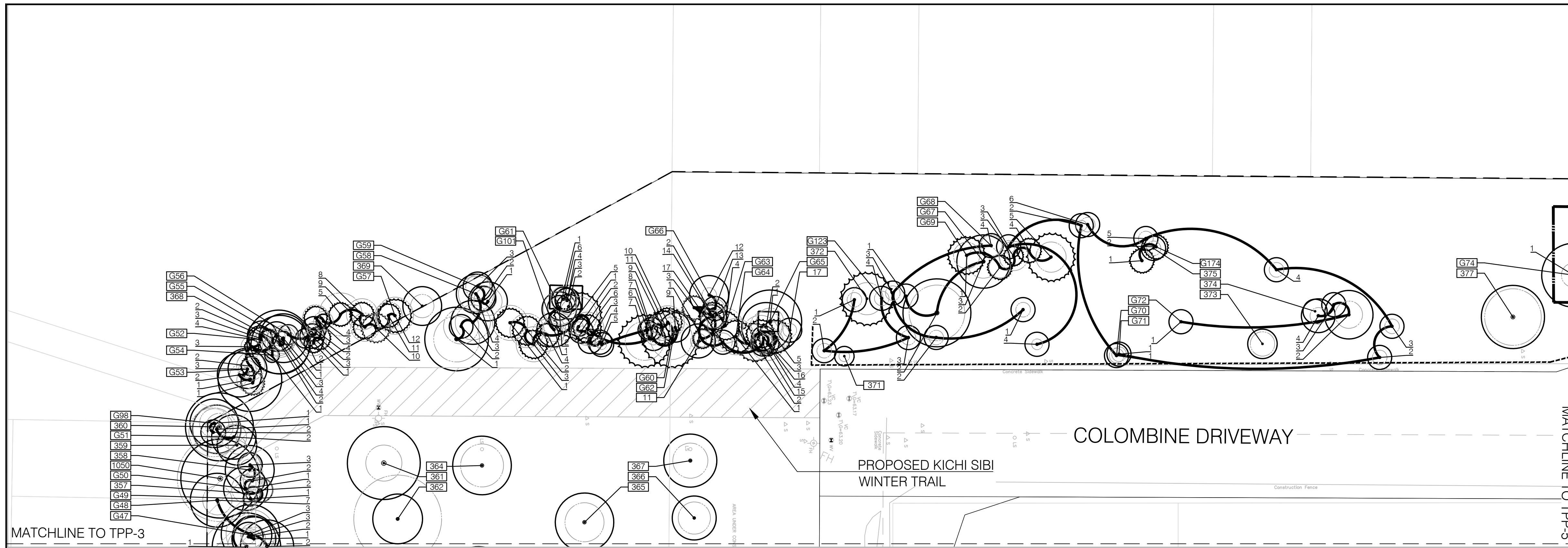

MATCHLINE TO TPP-3

MATCHLINE TO TPP-5

4-1

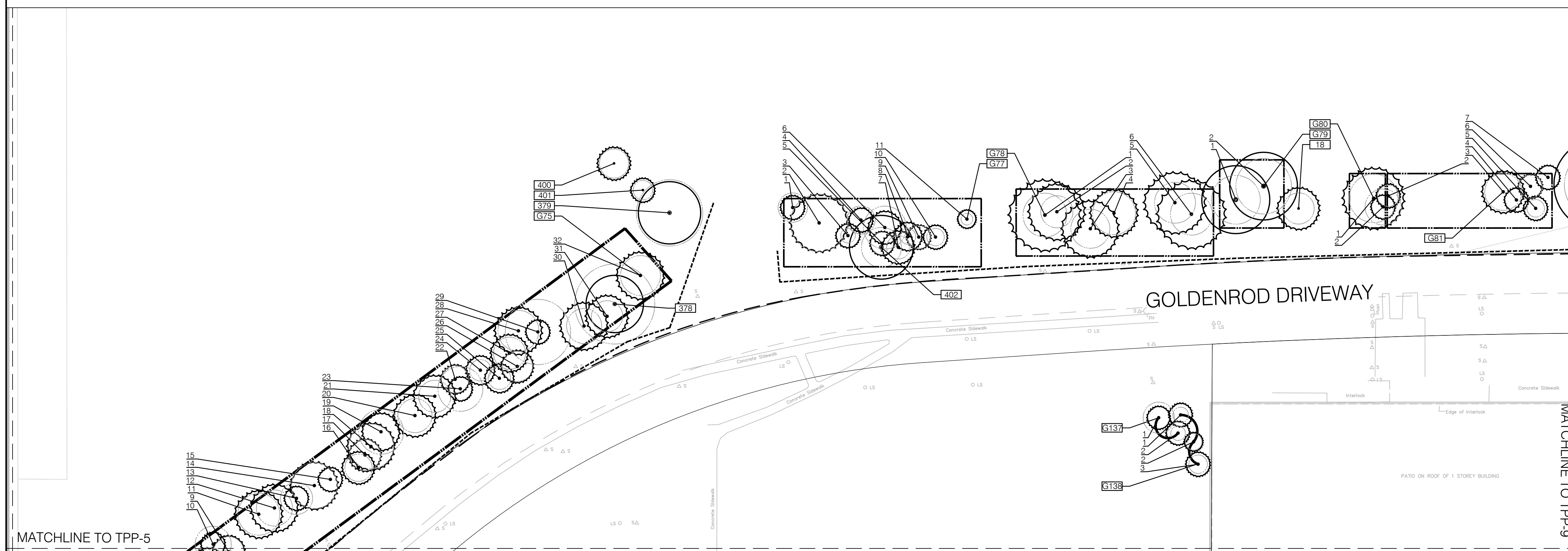

MATCHLINE TO TPP-5

MATCHLINE TO TPP-9

4-2

**INVENTORY INFORMATION:**  
 FIRST INVENTORY: November 23th-26th, 2022  
 SECOND INVENTORY: December 12th-13th, 2022

**LEGEND**

- CRITICAL ROOT ZONE
- EX. DECIDUOUS TREE TO REMAIN
- EX. CONIFEROUS TREE TO REMAIN
- EX. DECIDUOUS TREE TO BE REMOVED
- EX. CONIFEROUS TREE TO BE REMOVED
- TREE PRESERVATION FENCING SEE DETAIL 1, TPD-1
- TREE GROUP
- TREE TAG / IDENTIFICATION

FOR EXISTING TREE IDENTIFICATION TABLE REFER TO ARBORIST REPORT APPENDIX B

**MIGRATORY BIRD CONVENTION ACT:**  
 IN ACCORDANCE WITH THE MIGRATORY BIRDS CONVENTION ACT, 1994, TREE REMOVAL SHALL NOT TAKE PLACE FROM MARCH 31<sup>ST</sup> TO AUGUST 31<sup>ST</sup>.

**CLIENT**  
**CANADA LANDS COMPANY**  
 100 Queen St Suite 1050, Ottawa, ON K1P 1A5

**COPYRIGHT**  
 This drawing has been prepared solely for the intended use, thus any reproduction or distribution for any purpose other than authorized by Arcadis is forbidden. Written dimensions shall have precedence over scaled dimensions. Contractors shall verify and be responsible for all dimensions and conditions on the job, and Arcadis shall be informed of any variations from the dimensions and conditions shown on the drawing. Shop drawings shall be submitted to Arcadis for general conformance before proceeding with fabrication.

**Arcadis Professional Services (Canada) Inc.**

ISSUES		
No.	DESCRIPTION	DATE
1	DRAFT PLAN OF SUBDIVISION	2024-09-06
2	RESUBMITTED FOR DRAFT PLAN OF SUBDIVISION	2026-01-06

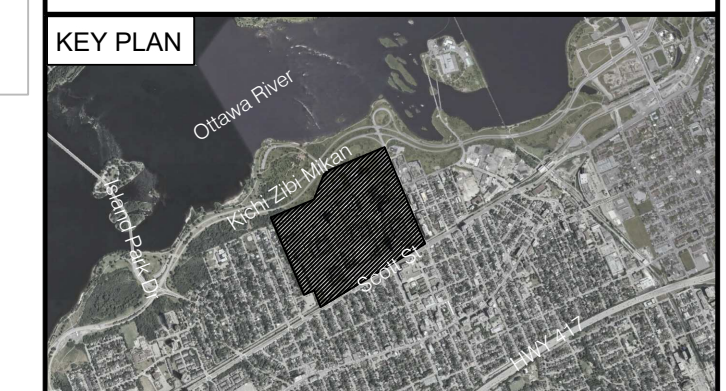

**CONSULTANTS**

**NOT FOR CONSTRUCTION**

**SEAL**

**PRIME CONSULTANT**  
**ARCADIS**  
 360 James Street North - Suite 200  
 Hamilton ON L8L 1H5 Canada  
 tel 905 546 1010  
 www.arcadis.com

**PROJECT**  
**PUBLIC ROAD REDEVELOPMENT**  
 TUNNEY'S PASTURE OTTAWA, ON

**PROJECT NO:**  
 139833

**DRAWN BY:** T.KEMP  
**CHECKED BY:** Z. BROWN

**PROJECT MGR:** S. ALBANESE  
**APPROVED BY:** Z. BROWN

**SHEET TITLE**  
**TREE PROTECTION & REMOVALS PLAN**

**SHEET NUMBER** **ISSUE**  
**TPP-4** **2**

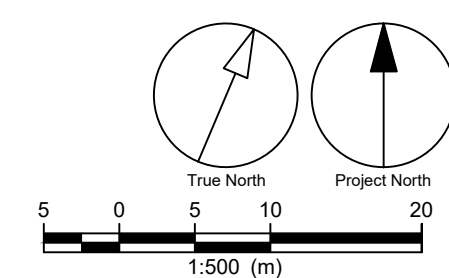

File Location: Y:\Toronto\139833\_TunneyPasture7\_0\_Production\7\_03\_Design\06\_Landscape\Content\139833TPP-CW.dwg Last Saved: June 11, 2025, by kemp4336 Plotted: January 6, 2026, 10:56:09 AM by Kemp, Taylor

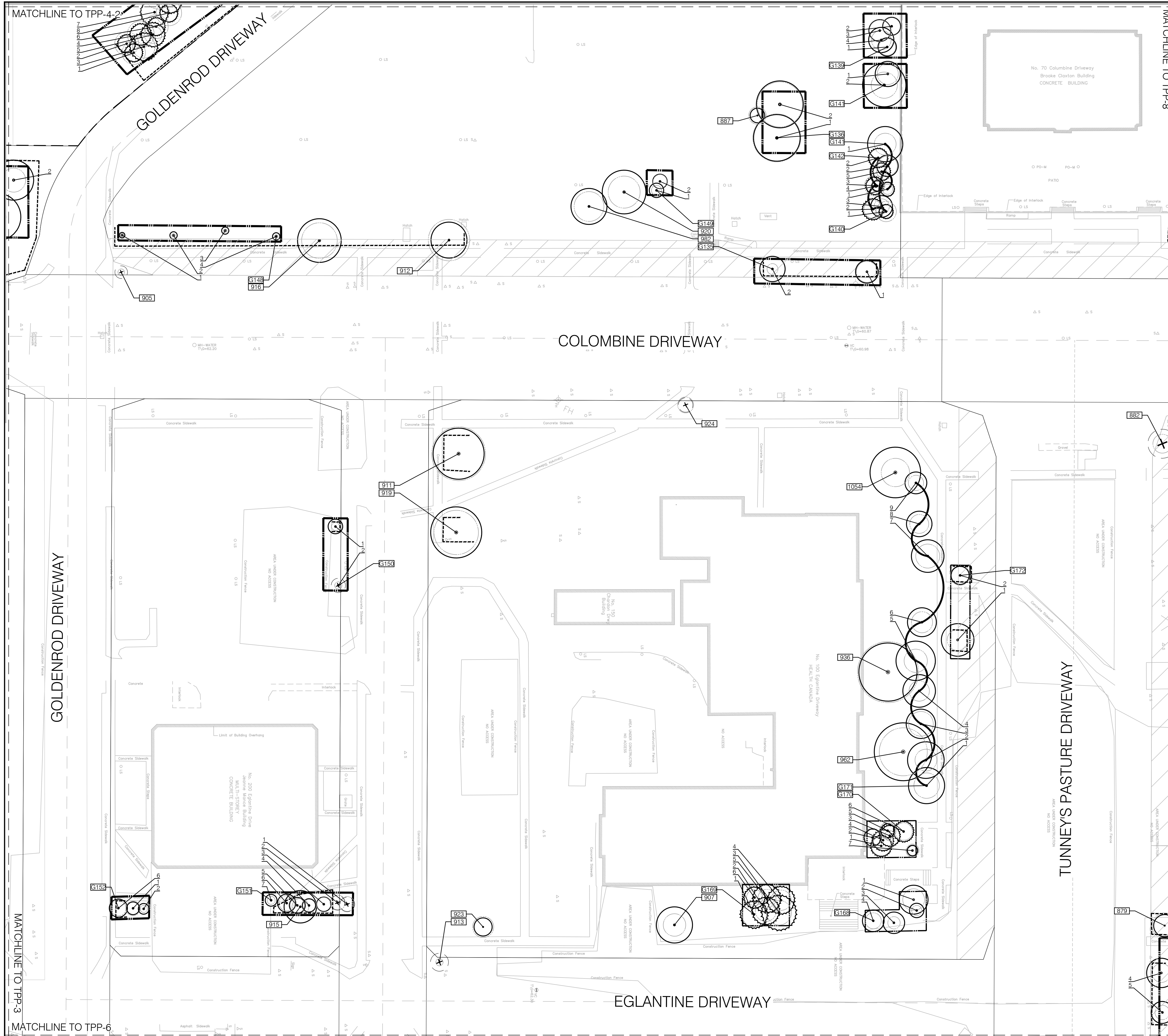

**INVENTORY INFORMATION:**  
 FIRST INVENTORY: November 23th-26th, 2022  
 SECOND INVENTORY: December 12th-13th, 2022

**LEGEND**

- CRITICAL ROOT ZONE
- EX. DECIDUOUS TREE TO REMAIN
- EX. CONIFEROUS TREE TO REMAIN
- EX. DECIDUOUS TREE TO BE REMOVED
- EX. CONIFEROUS TREE TO BE REMOVED
- TREE PRESERVATION FENCING SEE DETAIL 1, TPD-1
- TREE GROUP
- TREE TAG / IDENTIFICATION

FOR EXISTING TREE IDENTIFICATION TABLE REFER TO ARBORIST REPORT APPENDIX B

**MIGRATORY BIRD CONVENTION ACT:**  
 IN ACCORDANCE WITH THE MIGRATORY BIRDS CONVENTION ACT, 1994, TREE REMOVAL SHALL NOT TAKE PLACE FROM MARCH 31<sup>ST</sup> TO AUGUST 31<sup>ST</sup>.

**CLIENT**  
**CANADA LANDS COMPANY**  
 100 Queen St Suite 1050, Ottawa, ON K1P 1A5

**COPYRIGHT**  
 This drawing has been prepared solely for the intended use, thus any reproduction or distribution for any purpose other than authorized by Arcadis is forbidden. Written dimensions shall have precedence over scaled dimensions. Contractors shall verify and be responsible for all dimensions and conditions on the job, and Arcadis shall be informed of any variations from the dimensions and conditions shown on the drawing. Shop drawings shall be submitted to Arcadis for general conformance before proceeding with fabrication.

**Arcadis Professional Services (Canada) Inc.**

**ISSUES**

No.	DESCRIPTION	DATE
1	DRAFT PLAN OF SUBDIVISION	2024-09-06
2	RESUBMITTED FOR DRAFT PLAN OF SUBDIVISION	2026-01-06

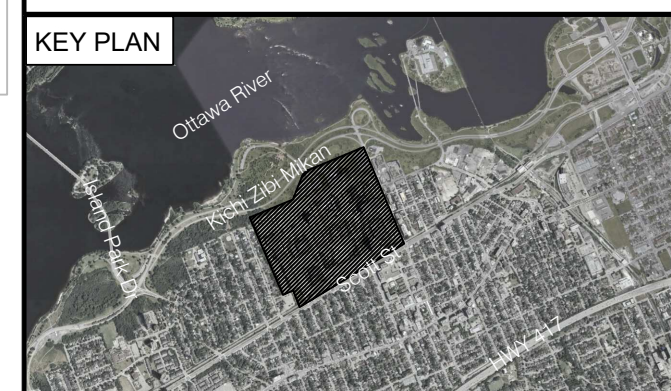

**CONSULTANTS**

**NOT FOR CONSTRUCTION**

**SEAL**

**PRIME CONSULTANT**  
**ARCADIS**  
 360 James Street North - Suite 200  
 Hamilton ON L8L 1H5 Canada  
 tel 905 546 1010  
 www.arcadis.com

**PROJECT**  
**PUBLIC ROAD REDEVELOPMENT**  
 TUNNEY'S PASTURE OTTAWA, ON

**PROJECT NO:** 139833  
**DRAWN BY:** T.KEMP  
**CHECKED BY:** Z. BROWN  
**PROJECT MGR:** S. ALBANESE  
**APPROVED BY:** Z. BROWN

**SHEET TITLE**  
**TREE PROTECTION & REMOVALS PLAN**

**SHEET NUMBER** **TPP-5** **ISSUE** **2**

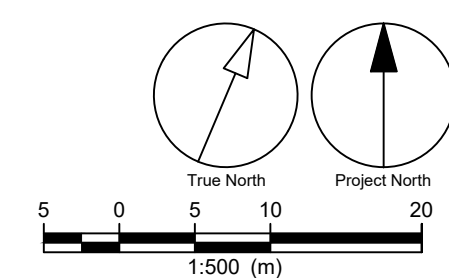

MATCHLINE TO TPP-4-2

MATCHLINE TO TPP-8

MATCHLINE TO TPP-3

MATCHLINE TO TPP-6

File Location: Y:\Toronto\139833\_TunneyPasture7\_0\_Production\7\_03\_Design\06\_Landscape\Content\139833TPP - CW.dwg Last Saved: June 11, 2025, by kemp4336 Plotted: January 6, 2026, 10:56:44 AM by Kemp, Taylor

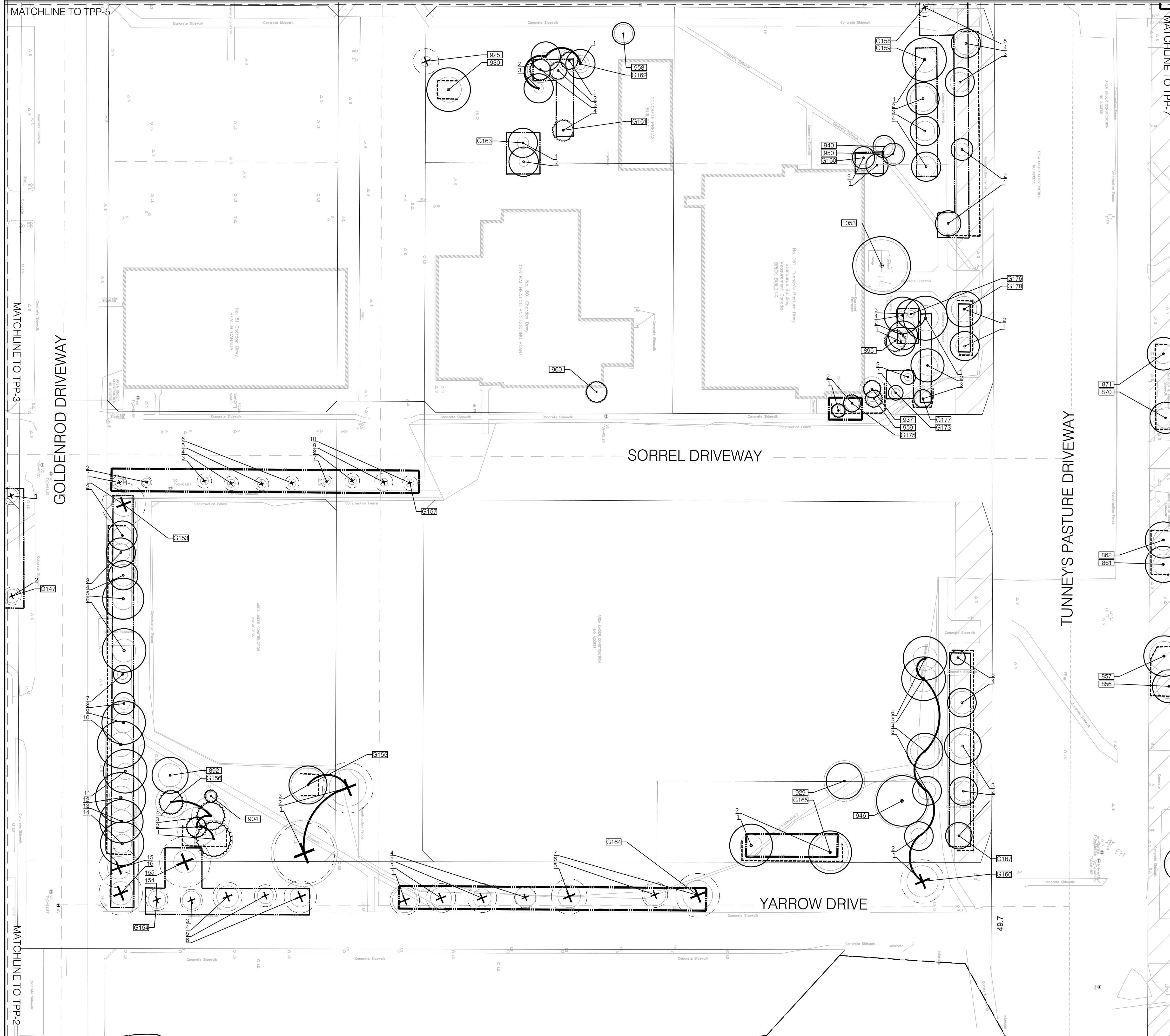

**INVENTORY INFORMATION:**  
 FIRST INVENTORY: November 23<sup>rd</sup>-26<sup>th</sup>, 2022  
 SECOND INVENTORY: December 12<sup>th</sup>-13<sup>th</sup>, 2022

**LEGEND**

- CRITICAL ROOT ZONE
- EX. DECIDUOUS TREE TO REMAIN
- EX. CONIFEROUS TREE TO REMAIN
- EX. DECIDUOUS TREE TO BE REMOVED
- EX. CONIFEROUS TREE TO BE REMOVED
- TREE PRESERVATION FENCING  
SEE DETAIL 1, TPD-1
- TREE GROUP
- TREE TAG / IDENTIFICATION

FOR EXISTING TREE IDENTIFICATION TABLE  
REFER TO ARBORIST REPORT APPENDIX B

**MIGRATORY BIRD CONVENTION ACT:**  
 IN ACCORDANCE WITH THE MIGRATORY BIRDS CONVENTION ACT,  
 1994, TREE REMOVAL SHALL NOT TAKE PLACE FROM MARCH  
 31<sup>ST</sup> TO AUGUST 31<sup>ST</sup>.

**CLIENT**  
**CANADA LANDS COMPANY**  
 100 Queen St Suite 1050, Ottawa, ON K1P 1A5

**COPYRIGHT**  
 This drawing has been prepared solely for the intended use, thus any reproduction or distribution for any purpose other than authorized by Arcadis is forbidden. Written dimensions shall have precedence over scaled dimensions. Contractors shall verify and be responsible for all dimensions and conditions on the job, and Arcadis shall be informed of any variations from the dimensions and conditions shown on the drawing. Shop drawings shall be submitted to Arcadis for general conformance before proceeding with fabrication.

**ISSUES**

No.	DESCRIPTION	DATE
1	DRAFT PLAN OF SUBDIVISION	2024-09-06
2	RESUBMITTED FOR DRAFT PLAN OF SUBDIVISION	2026-01-06

**PRIME CONSULTANT**  
**ARCADIS**  
 360 James Street North - Suite 200  
 Hamilton ON L8L 1H5 Canada  
 tel 905 546 1010  
 www.arcadis.com



**CONSULTANTS**  
**NOT FOR CONSTRUCTION**

**PROJECT**  
**PUBLIC ROAD REDEVELOPMENT**  
 TUNNEY'S PASTURE OTTAWA, ON

**PROJECT NO:**  
139833

**DRAWN BY:** T.KEMP  
**CHECKED BY:** Z. BROWN

**PROJECT MGR:** S. ALBANESE  
**APPROVED BY:** Z. BROWN

**SHEET TITLE**  
**TREE PROTECTION & REMOVALS PLAN**

**SHEET NUMBER**  
**TPP-6**

**ISSUE**  
**2**

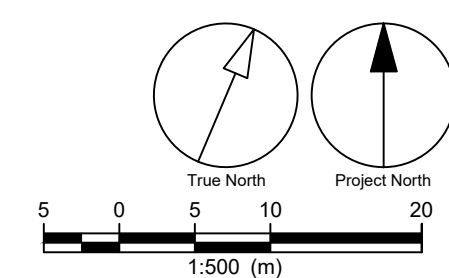

File Location: Y:\Toronto\139833\_TunneyPasture7\_0\_Production\7\_03\_Design\06\_Landscape\Content\139833TPP - CW.dwg Last Saved: June 11, 2025, by kemp4336 Plotted: January 6, 2026, 10:56:15 AM by Kemp, Taylor

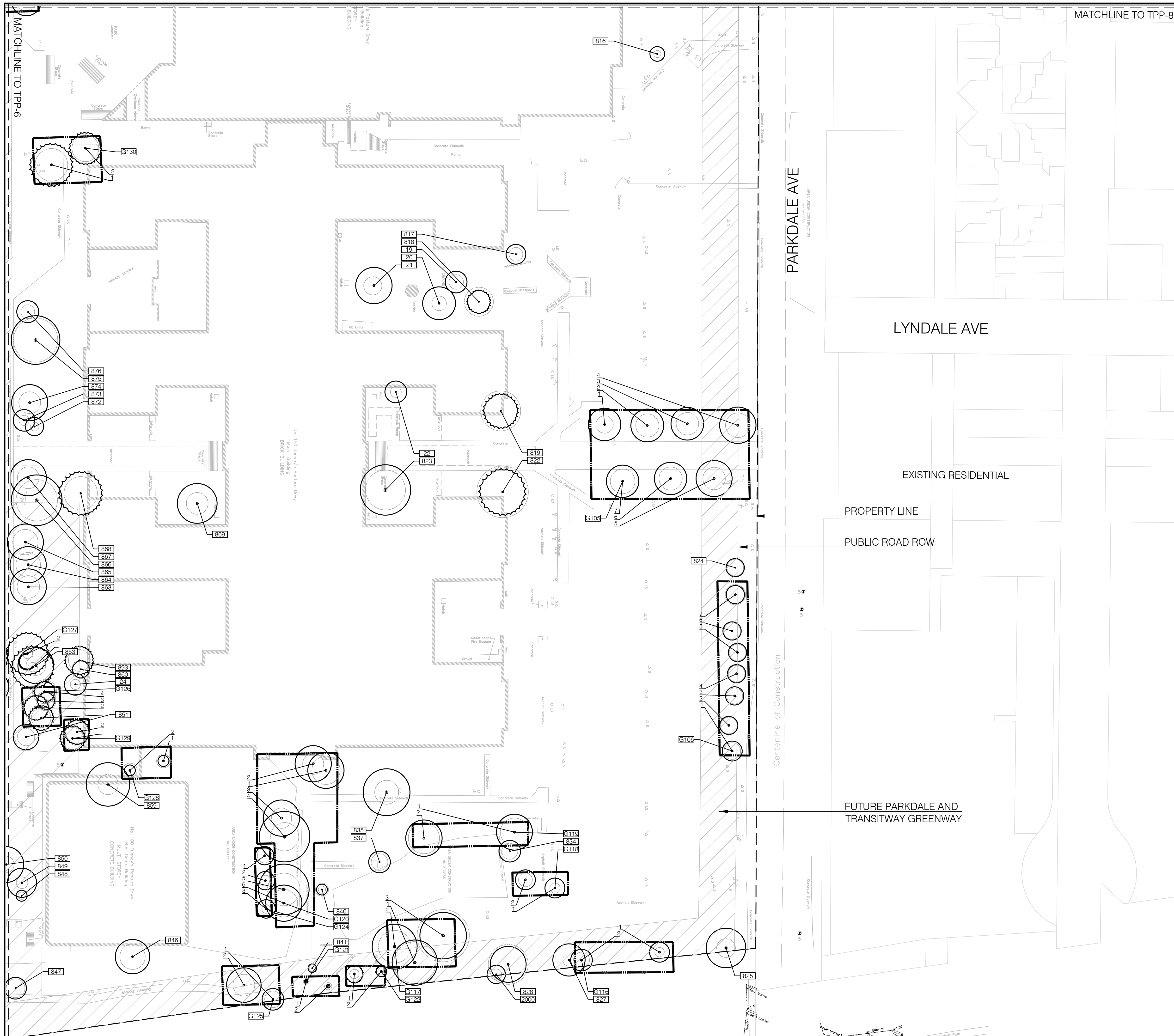

**INVENTORY INFORMATION:**  
 FIRST INVENTORY: November 23th-26th, 2022  
 SECOND INVENTORY: December 12th-13th, 2022

**LEGEND**

- CRITICAL ROOT ZONE
- EX. DECIDUOUS TREE TO REMAIN
- EX. CONIFEROUS TREE TO REMAIN
- EX. DECIDUOUS TREE TO BE REMOVED
- EX. CONIFEROUS TREE TO BE REMOVED
- TREE PRESERVATION FENCING SEE DETAIL 1, TPD-1
- TREE GROUP
- TREE TAG / IDENTIFICATION

FOR EXISTING TREE IDENTIFICATION TABLE REFER TO ARBORIST REPORT APPENDIX B

**MIGRATORY BIRD CONVENTION ACT:**  
 IN ACCORDANCE WITH THE MIGRATORY BIRDS CONVENTION ACT, 1994, TREE REMOVAL SHALL NOT TAKE PLACE FROM MARCH 31<sup>ST</sup> TO AUGUST 31<sup>ST</sup>.

**CLIENT**  
**CANADA LANDS COMPANY**  
 100 Queen St Suite 1050, Ottawa, ON K1P 1A5

**COPYRIGHT**  
 This drawing has been prepared solely for the intended use, thus any reproduction or distribution for any purpose other than authorized by Arcadis is forbidden. Written dimensions shall have precedence over scaled dimensions. Contractors shall verify and be responsible for all dimensions and conditions on the job, and Arcadis shall be informed of any variations from the dimensions and conditions shown on the drawing. Shop drawings shall be submitted to Arcadis for general conformance before proceeding with fabrication.

**Arcadis Professional Services (Canada) Inc.**

**ISSUES**

No.	DESCRIPTION	DATE
1	DRAFT PLAN OF SUBDIVISION	2024-09-06
2	RESUBMITTED FOR DRAFT PLAN OF SUBDIVISION	2026-01-06



**CONSULTANTS**

**NOT FOR CONSTRUCTION**

**SEAL**

**PRIME CONSULTANT**  
**ARCADIS**  
 360 James Street North - Suite 200  
 Hamilton ON L8L 1H5 Canada  
 tel 905 546 1010  
 www.arcadis.com

**PROJECT**  
**PUBLIC ROAD REDEVELOPMENT**  
 TUNNEY'S PASTURE OTTAWA, ON

**PROJECT NO:** 139833

**DRAWN BY:** T.KEMP  
**CHECKED BY:** Z. BROWN

**PROJECT MGR:** S. ALBANESE  
**APPROVED BY:** Z. BROWN

**SHEET TITLE**  
**TREE PROTECTION & REMOVALS PLAN**

**SHEET NUMBER** **TPP-7** **ISSUE** **2**

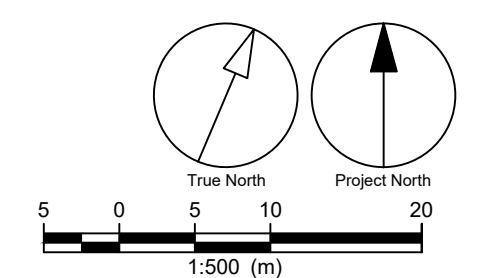

File Location: Y:\Toronto\139833\_Tunney\Pasture7\_0\_Production\7\_03\_Design\06\_Landscape\Content\139833TPP - CW.dwg Last Saved: June 11, 2025, by kemp4336 Printed: January 6, 2026 10:59:41 AM by Kemp, Taylor



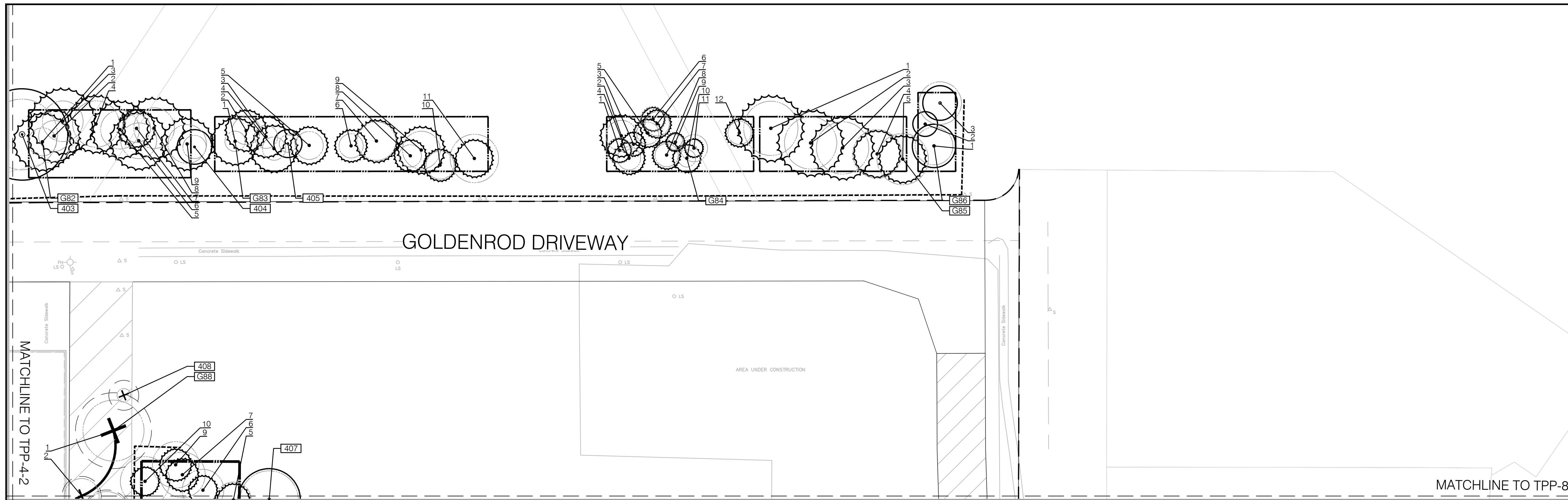

**INVENTORY INFORMATION:**  
 FIRST INVENTORY: November 23th-26th, 2022  
 SECOND INVENTORY: December 12th-13th, 2022

**LEGEND**

- CRITICAL ROOT ZONE
- EX. DECIDUOUS TREE TO REMAIN
- EX. CONIFEROUS TREE TO REMAIN
- EX. DECIDUOUS TREE TO BE REMOVED
- EX. CONIFEROUS TREE TO BE REMOVED
- TREE PRESERVATION FENCING  
SEE DETAIL 1, TPD-1
- TREE GROUP
- TREE TAG / IDENTIFICATION

FOR EXISTING TREE IDENTIFICATION TABLE  
REFER TO ARBORIST REPORT APPENDIX B

**MIGRATORY BIRD CONVENTION ACT:**  
 IN ACCORDANCE WITH THE MIGRATORY BIRDS CONVENTION ACT,  
 1994, TREE REMOVAL SHALL NOT TAKE PLACE FROM MARCH  
 31<sup>ST</sup> TO AUGUST 31<sup>ST</sup>.

**CLIENT**  
**CANADA LANDS COMPANY**  
 100 Queen St Suite 1050, Ottawa, ON K1P 1A5

**COPYRIGHT**  
 This drawing has been prepared solely for the intended use, thus any reproduction or distribution for any purpose other than authorized by Arcadis is forbidden. Written dimensions shall have precedence over scaled dimensions. Contractors shall verify and be responsible for all dimensions and conditions on the job, and Arcadis shall be informed of any variations from the dimensions and conditions shown on the drawing. Shop drawings shall be submitted to Arcadis for general conformance before proceeding with fabrication.

**Arcadis Professional Services (Canada) Inc.**

**ISSUES**

No.	DESCRIPTION	DATE
1	DRAFT PLAN OF SUBDIVISION	2024-09-06
2	RESUBMITTED FOR DRAFT PLAN OF SUBDIVISION	2026-01-06

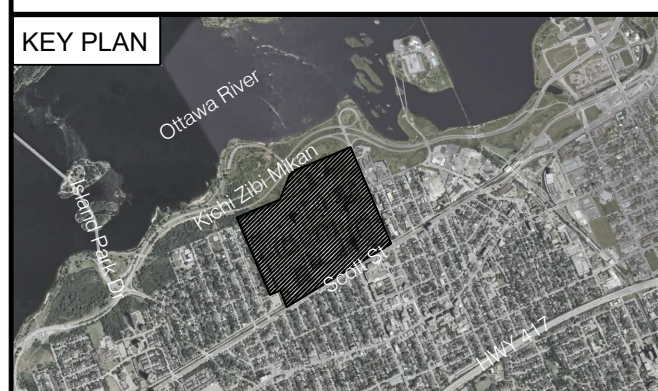

**CONSULTANTS**  
**NOT FOR CONSTRUCTION**

**SEAL**

**PRIME CONSULTANT**  
  
 360 James Street North - Suite 200  
 Hamilton ON L8L 1H5 Canada  
 tel 905 546 1010  
 www.arcadis.com

**PROJECT**  
**PUBLIC ROAD REDEVELOPMENT**  
 TUNNEY'S PASTURE OTTAWA, ON

**PROJECT NO:** 139833  
**DRAWN BY:** T.KEMP  
**CHECKED BY:** Z. BROWN  
**PROJECT MGR:** S. ALBANESE  
**APPROVED BY:** Z. BROWN

**SHEET TITLE**  
**TREE PROTECTION & REMOVALS PLAN**

**SHEET NUMBER** **ISSUE**  
**TPP-9** **2**

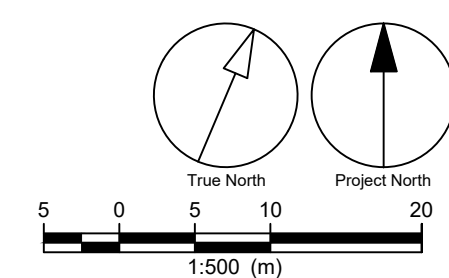

MATCHLINE TO TPP-4-2

MATCHLINE TO TPP-8

File Location: Y:\Toronto\139833\_TunneyPasture7\_0\_Production\7\_0\_Production\7\_03\_Design\06\_Landscape\Content\139833TPP - CW.dwg  
 Last Saved: June 11, 2025, by kemp4336  
 Plotted: January 6, 2026 11:00:32 AM by Kemp, Taylor

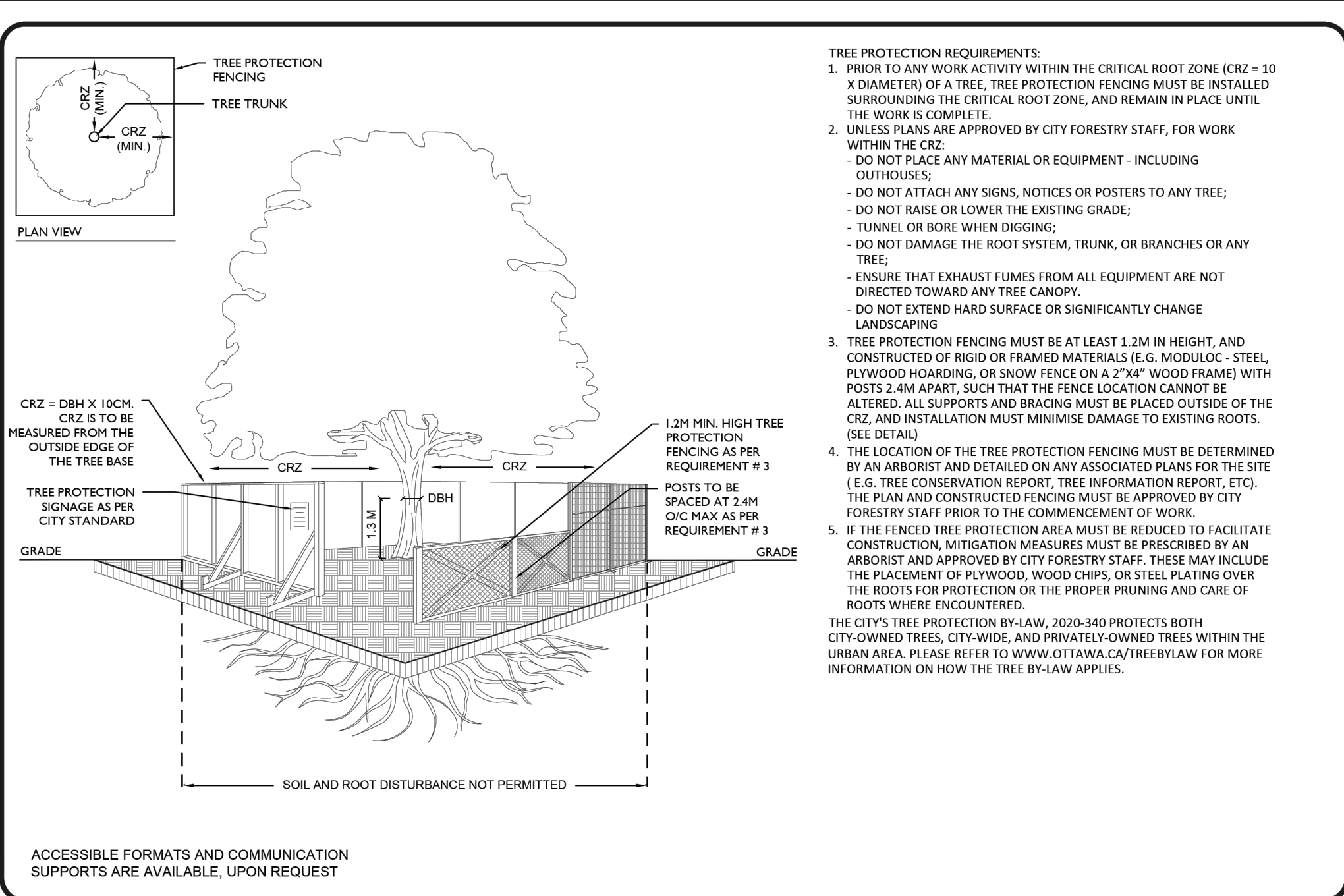

- TREE PROTECTION REQUIREMENTS:**
- PRIOR TO ANY WORK ACTIVITY WITHIN THE CRITICAL ROOT ZONE (CRZ = 10 X DIAMETER) OF A TREE, TREE PROTECTION FENCING MUST BE INSTALLED SURROUNDING THE CRITICAL ROOT ZONE, AND REMAIN IN PLACE UNTIL THE WORK IS COMPLETE.
  - UNLESS PLANS ARE APPROVED BY CITY FORESTRY STAFF, FOR WORK WITHIN THE CRZ:
    - DO NOT PLACE ANY MATERIAL OR EQUIPMENT - INCLUDING OUTHOUSES;
    - DO NOT ATTACH ANY SIGNS, NOTICES OR POSTERS TO ANY TREE;
    - DO NOT RAISE OR LOWER THE EXISTING GRADE;
    - TUNNEL OR BORE WHEN DIGGING;
    - DO NOT DAMAGE THE ROOT SYSTEM, TRUNK, OR BRANCHES OR ANY TREE;
    - ENSURE THAT EXHAUST FUMES FROM ALL EQUIPMENT ARE NOT DIRECTED TOWARD ANY TREE CANOPY;
    - DO NOT EXTEND HARD SURFACE OR SIGNIFICANTLY CHANGE LANDSCAPING
  - TREE PROTECTION FENCING MUST BE AT LEAST 1.2M IN HEIGHT, AND CONSTRUCTED OF RIGID OR FRAMED MATERIALS (E.G. MODULOC, STEEL, PLYWOOD HOARDING, OR SNOW FENCE ON A 2"x4" WOOD FRAME) WITH POSTS 2.4M APART, SUCH THAT THE FENCE LOCATION CANNOT BE ALTERED. ALL SUPPORTS AND BRACING MUST BE PLACED OUTSIDE OF THE CRZ, AND INSTALLATION MUST MINIMISE DAMAGE TO EXISTING ROOTS. (SEE DETAIL)
  - THE LOCATION OF THE TREE PROTECTION FENCING MUST BE DETERMINED BY AN ARBORIST AND DETAILED ON ANY ASSOCIATED PLANS FOR THE SITE (E.G. TREE CONSERVATION REPORT, TREE INFORMATION REPORT, ETC). THE PLAN AND CONSTRUCTED FENCING MUST BE APPROVED BY CITY FORESTRY STAFF PRIOR TO THE COMMENCEMENT OF WORK.
  - IF THE FENCED TREE PROTECTION AREA MUST BE REDUCED TO FACILITATE CONSTRUCTION, MITIGATION MEASURES MUST BE PRESCRIBED BY AN ARBORIST AND APPROVED BY CITY FORESTRY STAFF. THESE MAY INCLUDE THE PLACEMENT OF PLYWOOD, WOOD CHIPS, OR STEEL PLATING OVER THE ROOTS FOR PROTECTION OR THE PROPER PRUNING AND CARE OF ROOTS WHERE ENCOUNTERED.
- THE CITY'S TREE PROTECTION BY-LAW, 2020-340 PROTECTS BOTH CITY-OWNED TREES, CITY-WIDE, AND PRIVATELY-OWNED TREES WITHIN THE URBAN AREA. PLEASE REFER TO WWW.OTTAWA.CA/TREEBYLAW FOR MORE INFORMATION ON HOW THE TREE BY-LAW APPLIES.

ACCESSIBLE FORMATS AND COMMUNICATION SUPPORTS ARE AVAILABLE, UPON REQUEST



**TREE PROTECTION SPECIFICATION**

TO BE IMPLEMENTED FOR RETAINED TREES, BOTH ON SITE AND ON ADJACENT SITES, PRIOR TO ANY TREE REMOVAL OR SITE WORKS AND MAINTAINED FOR THE DURATION OF WORK ACTIVITIES ON SITE.

SCALE: NTS

DATE: MARCH 2021

DRAWING NO.: 1 of 1

1 TREE PRESERVATION FENCING  
TPD-1 N.T.S

CLIENT  
**CANADA LANDS COMPANY**

100 Queen St Suite 1050, Ottawa, ON K1P 1A5

**COPYRIGHT**  
This drawing has been prepared solely for the intended use, thus any reproduction or distribution for any purpose other than authorized by Arcadis is forbidden. Written dimensions shall have precedence over scaled dimensions. Contractors shall verify and be responsible for all dimensions and conditions on the job, and Arcadis shall be informed of any variations from the dimensions and conditions shown on the drawing. Shop drawings shall be submitted to Arcadis for general conformance before proceeding with fabrication.

Arcadis Professional Services (Canada) Inc.

ISSUES		
No.	DESCRIPTION	DATE
1	DRAFT PLAN OF SUBDIVISION	2024-09-06
2	RESUBMITTED FOR DRAFT PLAN OF SUBDIVISION	2026-01-06

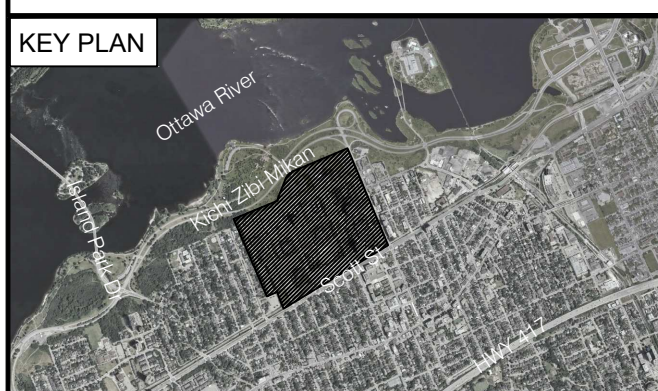

CONSULTANTS

**NOT FOR CONSTRUCTION**

SEAL

PRIME CONSULTANT  
**ARCADIS**  
360 James Street North - Suite 200  
Hamilton ON L8L 1H5 Canada  
tel 905 546 1010  
www.arcadis.com

PROJECT  
**PUBLIC ROAD REDEVELOPMENT**  
TUNNEY'S PASTURE OTTAWA, ON

PROJECT NO:  
139833

DRAWN BY: <b>T.KEMP</b>	CHECKED BY: <b>Z.BROWN</b>
PROJECT MGR: <b>S. ALBANESE</b>	APPROVED BY: <b>Z.BROWN</b>

SHEET TITLE  
**TREE PROTECTION DETAILS**

SHEET NUMBER <b>TPD-1</b>	ISSUE <b>2</b>
------------------------------	-------------------