

MATTAMY HOMES WATERIDGE VILLAGE BLOCK 22 & 23



ISSUED FOR SPA FIRST SUBMISSION
MARCH 20, 2026

LIST OF DRAWINGS:

- L1.0 - LANDSCAPE PLAN
- L2.0 - DETAILS
- L2.1 - DETAILS
- L2.2 - DETAILS

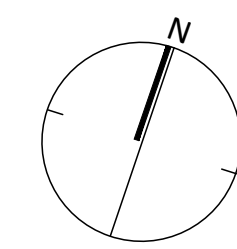
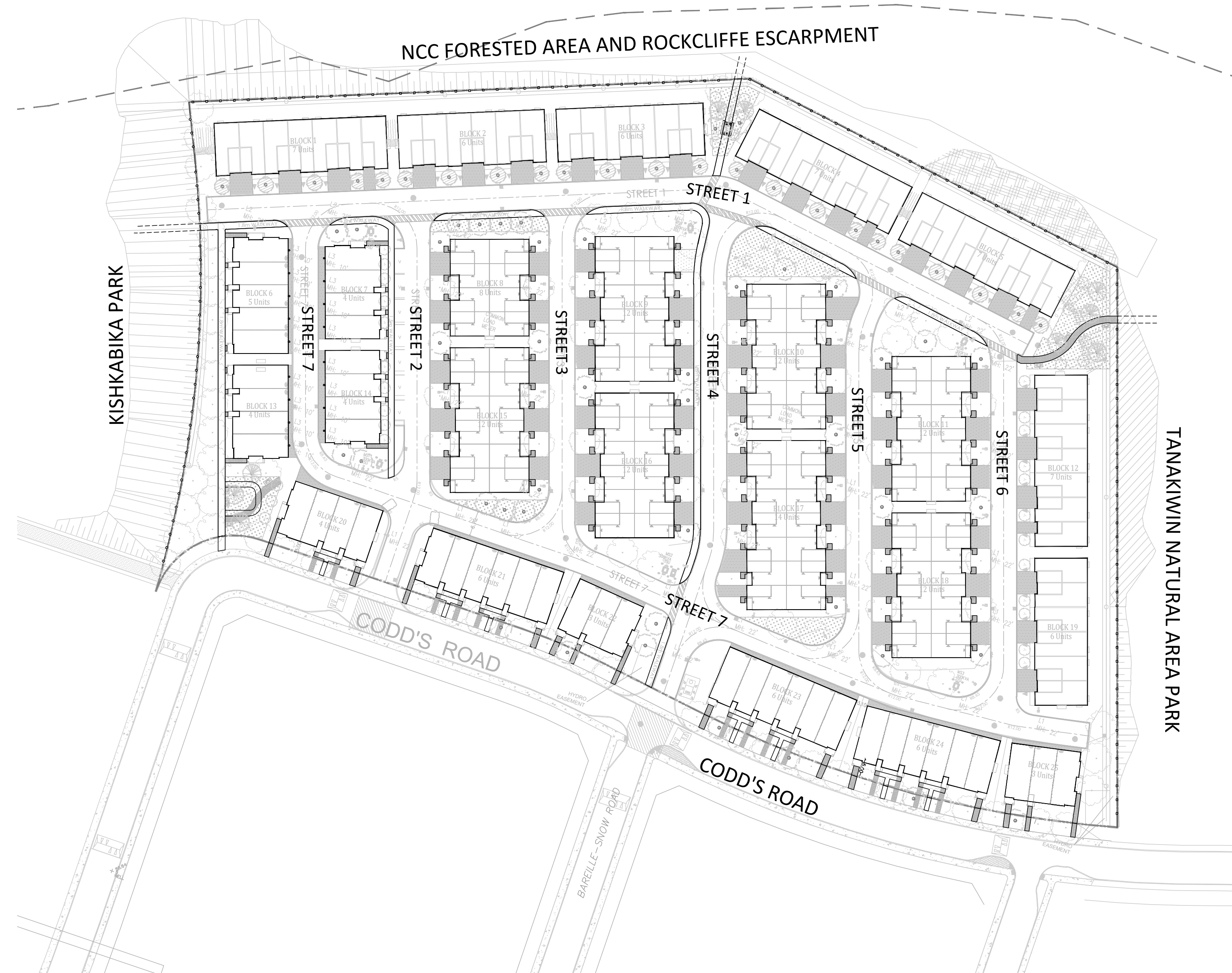

KEYMAP
1:800

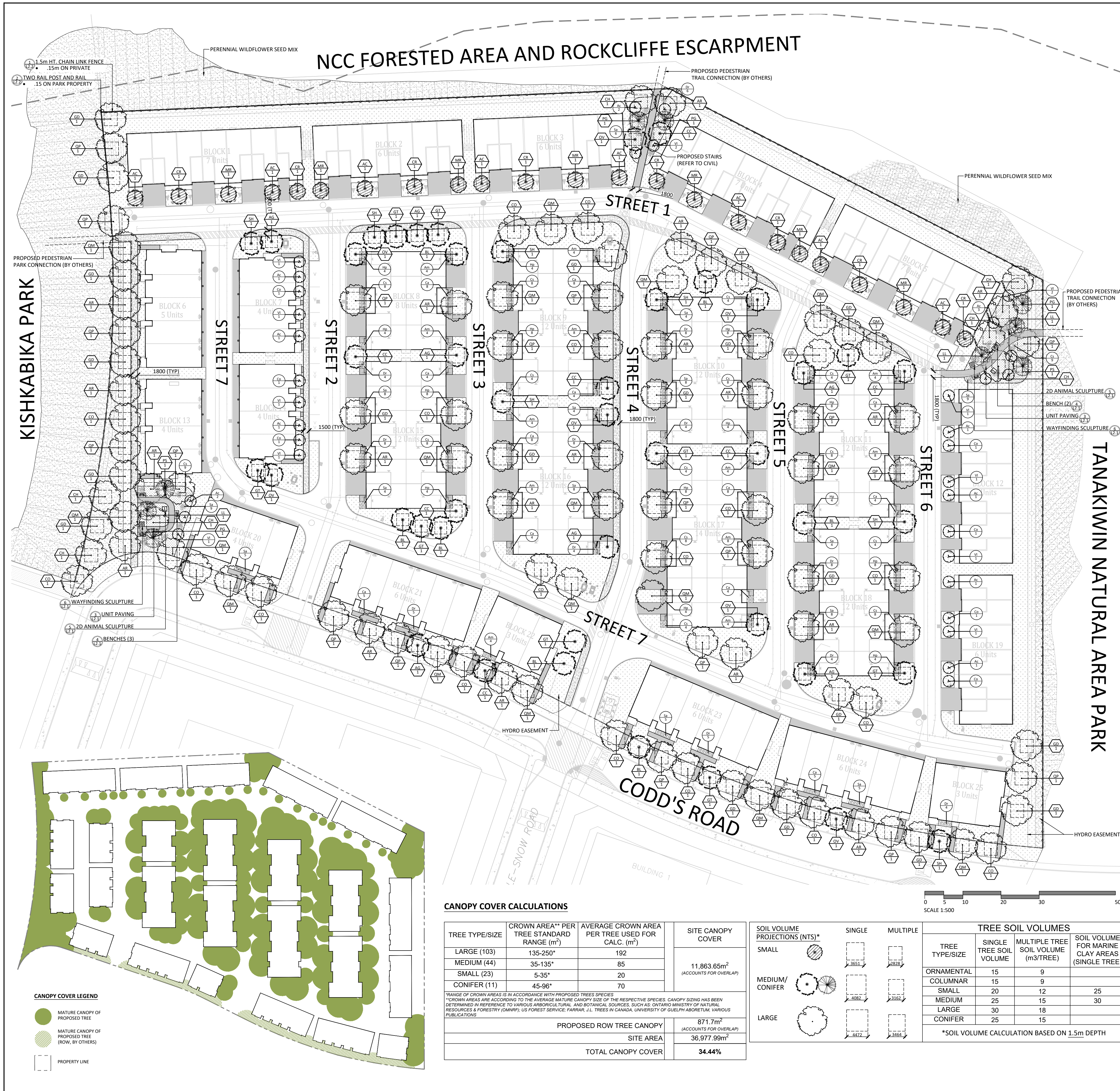

NCC FORESTED AREA AND ROCKCLIFFE ESCARPMENT

PLANT LIST							
KEY	BOTANICAL NAME	COMMON NAME	QTY	SIZE	NOTES	NATIVE	OWNER
DECIDUOUS TREES - LARGE							
AR	ACER RUBRUM	RED MAPLE	20	50mm	B&B	Y	PRIVATE/PUBLIC
CH	CARYA CORDIFORMIS	BITTERNUT HICKORY	7	50mm	B&B	Y	PRIVATE
CO	CELTIS OCCIDENTALIS	COMMON HACKBERRY	19	50mm	B&B	Y	PRIVATE/PUBLIC
GD	GYMNOCLADUS DIOICUS	KENTUCKY COFFEE TREE	19	50mm	B&B	Y	PRIVATE/PUBLIC
QM	QUERCUS MACROCARPA	BUR OAK	19	50mm	B&B	Y	PRIVATE/PUBLIC
QP	QUERCUS PALUSTRIS	PIN OAK	20	50mm	B&B	Y	PRIVATE/PUBLIC
DECIDUOUS TREES - MEDIUM							
AG	AESCULUS GLABRA	OHIO BUCKEYE	7	50mm	B&B	Y	PRIVATE/PUBLIC
BL	BETULA LENTA	CHERRY BIRCH	7	50mm	B&B	Y	PRIVATE/PUBLIC
CC	CARPINUS CAROLINIANA	BLUE BEECH	7	50mm	B&B	Y	PRIVATE/PUBLIC
GT	GLEDITSIA TRIACANTHOS V. INERMIS	HONEYLOCUST	9	50mm	B&B	Y	PRIVATE/PUBLIC
OV	OSTRYA VIRGINIANA	IRONWOOD	7	50mm	B&B	Y	PRIVATE/PUBLIC
SH	SORBUS AMERICANA	MOUNTAIN-ASH	7	50mm	B&B	Y	PRIVATE/PUBLIC
DECIDUOUS TREES - SMALL							
AC	AMELANCHIER CANADENSIS	SERVICEBERRY	8	50mm	B&B	Y	PRIVATE
CR	CERCIS CANADENSIS	EASTERN REDBUD	8	50mm	B&B	Y	PRIVATE
MR	MORUS RUBRA	RED MULBERRY	7	50mm	B&B	Y	PRIVATE
CONIFEROUS TREES							
LL	LARIX LARICINA	TAMARACK	3	200cm	B&B	Y	PRIVATE
PG	PICEA GLAUCUS	WHITE SPRUCE	4	200cm	B&B	Y	PRIVATE
PS	PINUS STROBUS	WHITE PINE	2	200cm	B&B	Y	PRIVATE
MULTI-STEM SHRUBS							
Ac	AMELANCHIER CANADENSIS	SERVICEBERRY	14	7 GAL	POT	Y	PRIVATE
Co	CORNUS ALTERNIFOLIA	PAGODA DOGWOOD	7	7 GAL	POT	Y	PRIVATE
VI	VIBURNUM LENTAGO	NANNYBERRY	13	7 GAL	POT	Y	PRIVATE
DECIDUOUS SHRUBS							
Am	ARONIA MELANOCARPA	BLACK CHOKEBERRY	64	3 GAL	POT	Y	PRIVATE
Ca	CEANOTHUS AMERICANUS	NEW JERSEY TEA	70	3 GAL	POT	Y	PRIVATE
Cs	CORNUS SERICEA 'ARCTIC FIRE'	RED TWIG DOGWOOD	98	3 GAL	POT	Y	PRIVATE
Hp	HYPERICUM PROLIFICUM	ST. JOHNS WORT	80	3 GAL	POT	Y	PRIVATE
Sa	SYMPHORICARPOS ALBUS	SNOWBERRY	87	3 GAL	POT	Y	PRIVATE
Dr	DIERVILLA LONICERA	BUSH HONEYSUCKLE	68	3 GAL	POT	Y	PRIVATE
GRASSES/PERENNIALS							
ac	ANEMONE CANADENSIS	CANADIAN ANEMONE	0	1 GAL	POT	Y	PRIVATE
af	ATHYRIUM FILIX-FEMINA	LADY FERN	0	1 GAL	POT	Y	PRIVATE
cp	CAREX PENNSYLVANICA	FOX SEDGE	0	1 GAL	POT	Y	PRIVATE
dc	DESCHAMPSIA CESPIITOSA	TUFTED HAIR GRASS	0	1 GAL	POT	Y	PRIVATE
dsm	DRYOPTERIS MARGINALIS	WOOD FERN	0	1 GAL	POT	Y	PRIVATE
hm	HEUCHERA MACRORRHIZA	CORAL BELLS	0	1 GAL	POT	Y	PRIVATE
SEED MIX							
PERENNIAL WILDFLOWER SEED MIX : DECOR SERIES, AS SUPPLIED BY AIGLON INDIGO							

- GENERAL NOTES:**
- ALL PLANT MATERIAL SHALL BE NURSERY GROWN STOCK UNLESS OTHERWISE NOTED.
 - TREES TO HAVE A MINIMUM 1800 CLEAR STEM ABOVE GRADE.
 - CONTRACTOR TO MAKE GOOD ALL EXISTING AREAS DAMAGED BY HIS WORK TO THE SATISFACTION OF THE CONTRACTOR.
 - ALL PLANT MATERIAL SHALL BE WARRANTED FOR TWO YEARS FROM THE DATE OF SUBSTANTIAL COMPLETION.
 - CONTRACTOR TO VERIFY LOCATION OF ALL SERVICES PRIOR TO ANY EXCAVATION.
 - ANY PROPOSED SUBSTITUTIONS OF PLANT SPECIES SHALL BE MADE WITH PLANTS OF EQUIVALENT OVERALL FORM, HEIGHT, BRANCHING HABIT, FLOWER, LEAF, COLOR, FRUIT AND CULTURE AND ONLY AFTER APPROVAL OF THE LANDSCAPE ARCHITECT.

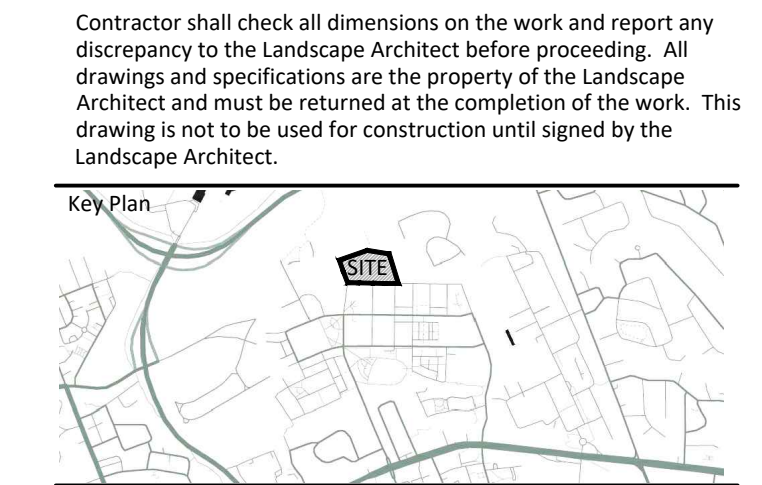

LEGEND

- PROPERTY LINE
- 1.5m HT. CHAIN LINK FENCE
- POST AND RAIL FENCE

PLANTING

- LARGE DECIDUOUS TREE
- MEDIUM DECIDUOUS TREE
- CONIFEROUS TREE
- SMALL DECIDUOUS TREE
- MULTI-STEM SHRUB
- DECIDUOUS SHRUB

PAVING

- CIP CONCRETE PAVING
- UNIT PAVING
- NATURALIZED PLANTING
- PERENNIAL WILDFLOWER SEED MIX

FURNISHINGS & FEATURES

- BENCH
- WAYFINDING, 2D ANIMAL SCULPTURES

PLANTING KEY

- XX - TREE SPECIES
- 00 - QUANTITY
- XX - SHRUB SPECIES
- 00 - QUANTITY

DETAIL KEY

- 1 - DETAIL NO.
- 1 - SHEET NO.

No.	Description	Date
3	Issued for SPA First Submission	3/20/2026
2	Issued for Coordination	3/13/2026
1	Issued for Coordination	2/18/2026

OWNERSHIP
MATTAMY HOMES
50 Howe Rd., Suite 100, Ottawa ON K2K 2M5

ARCHITECT
KORSAK
277 Lakeshore Rd., #206, Oakville ON L6J 1H9

CIVIL
STANTEC
380-1533 Clyde Ave., Ottawa ON K2C 2G4

LANDSCAPE ARCHITECT
NAK DESIGN STRATEGIES
1285 Wellington St., Ottawa ON K1Y 3A8

ELECTRICAL
USE
5430 Carleton Rd., Ottawa ON K1J 9G2

TRANSPORTATION
NOVATECH
240 Michael Cowland Dr., Suite 200, Ottawa, ON, K2M1P6

NOISE
GRADIENT WIND
127 Walgreen Rd., Carp ON K0A 1J0

SURVEY
ANNIS O'SULLIVAN VOLLEBEKK LTD.
14 Concourse Gate, Suite 500, Nepean, ON K2E 7S6

GEOTECH
PATERSON GROUP
9 Auriga Drive, Ottawa ON K2E 779

PROPERTY INFORMATION
PART OF LOTS 22, 22.1 AND 23 CONVEYANCE 1 (OTTAWA FRONT) AND PART OF RESERVE BLOCK 14 AND ALL OF RESERVE BLOCKS 15 AND 16 REGISTERED PLAN 4M 1653 CITY OF OTTAWA



NAK design strategies
1285 WELLINGTON STREET, OTTAWA, ON K1Y 3A8 CANADA
T 613.237.2345
Project

WATERBLOCK BLOCK 22&23

200 Codd's Road, Ottawa ON K1K 2E3

Date	2026-01-30	Sheet
Scale	1:500	
Drawn	JE	
Checked	SC	
Job No.	25-438	

L1.0

LANDSCAPE PLAN

CANOPY COVER CALCULATIONS

TREE TYPE/SIZE	CROWN AREA** PER TREE STANDARD RANGE (m ²)	AVERAGE CROWN AREA PER TREE USED FOR CALC. (m ²)	SITE CANOPY COVER
LARGE (103)	135-250*	192	11,863.65m ² (ACCOUNTS FOR OVERLAP)
MEDIUM (44)	35-135*	85	
SMALL (23)	5-35*	20	
CONIFER (11)	45-96*	70	
PROPOSED ROW TREE CANOPY			871.7m ²
SITE AREA			36,977.99m ²
TOTAL CANOPY COVER			34.44%

SOIL VOLUME PROJECTIONS (NTS)*	SINGLE	MULTIPLE	TREE SOIL VOLUMES			
			TREE TYPE/SIZE	SINGLE TREE SOIL VOLUME	MULTIPLE TREE SOIL VOLUME (m ³ /TREE)	SOIL VOLUME FOR MARINE CLAY AREAS (SINGLE TREE)
SMALL	1851	2878	ORNAMENTAL	15	9	
MEDIUM/CONIFER	8982	13184	COLUMNAR	20	9	
	8982	13184	SMALL	20	12	25
	8982	13184	MEDIUM	25	15	30
LARGE	4872	7308	LARGE	30	18	
	4872	7308	CONIFER	25	15	

*SOIL VOLUME CALCULATION BASED ON 1.5m DEPTH

*RANGE OF CROWN AREAS IS IN ACCORDANCE WITH PROPOSED TREE SPECIES
**CROWN AREAS ARE ACCORDING TO THE AVERAGE MATURE CANOPY SIZE OF THE RESPECTIVE SPECIES. CANOPY SIZING HAS BEEN DETERMINED BY REFERENCE TO VARIOUS ARBORICULTURAL AND BOTANICAL SOURCES, SUCH AS: ONTARIO MINISTRY OF NATURAL RESOURCES & FORESTRY (OMNR); US FOREST SERVICE; FARRAR, J.L. TREES IN CANADA. UNIVERSITY OF GUELPH ARBORETUM. VARIOUS PUBLICATIONS

NOTES:
THE LANDSCAPE PLAN WAS PREPARED IN CONJUNCTION WITH THE GEOTECHNICAL REPORT PREPARED BY PATERSON GROUP:
• PG7793-1, DATED DECEMBER 12, 2025

THE LANDSCAPE PLAN WAS PREPARED IN CONJUNCTION WITH THE ENVIRONMENTAL IMPACT STATEMENT AND TREE CONSERVATION REPORT BY ARCADIS PROFESSIONAL SERVICES (CANADA) INC., DATED JUNE 2025

ALL EXISTING SITE INFORMATION AS PER SITE SURVEY PLAN DATED DECEMBER 6, 2024, AND PREPARED BY ANNIS O'SULLIVAN, VOLLEBEKK LTD.

Contractor shall check all dimensions on the work and report any discrepancy to the Landscape Architect before proceeding. All drawings and specifications are the property of the Landscape Architect and must be returned at the completion of the work. This drawing is not to be used for construction until signed by the Landscape Architect.

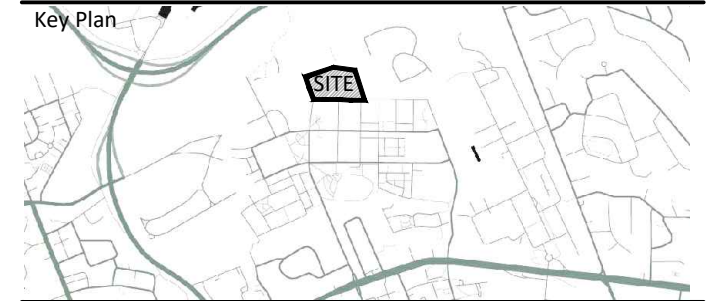

LEGEND

- PROPERTY LINE
- 1.5m HT. CHAIN LINK FENCE
- POST AND RAIL FENCE

PLANTING

- LARGE DECIDUOUS TREE
- MEDIUM DECIDUOUS TREE
- CONIFEROUS TREE
- SMALL DECIDUOUS TREE
- MULTI-STEM SHRUB
- DECIDUOUS SHRUB

PAVING

- CIP CONCRETE PAVING
- UNIT PAVING
- NATURALIZED PLANTING
- PERENNIAL WILDFLOWER SEED MIX

FURNISHINGS & FEATURES

- BENCH
- WAYFINDING, 2D ANIMAL SCULPTURES

PLANTING KEY

- XX TREE SPECIES
- 00 QUANTITY
- XX SHRUB SPECIES
- 00 QUANTITY

DETAIL KEY

- 1 DETAIL NO.
- L1 SHEET NO.

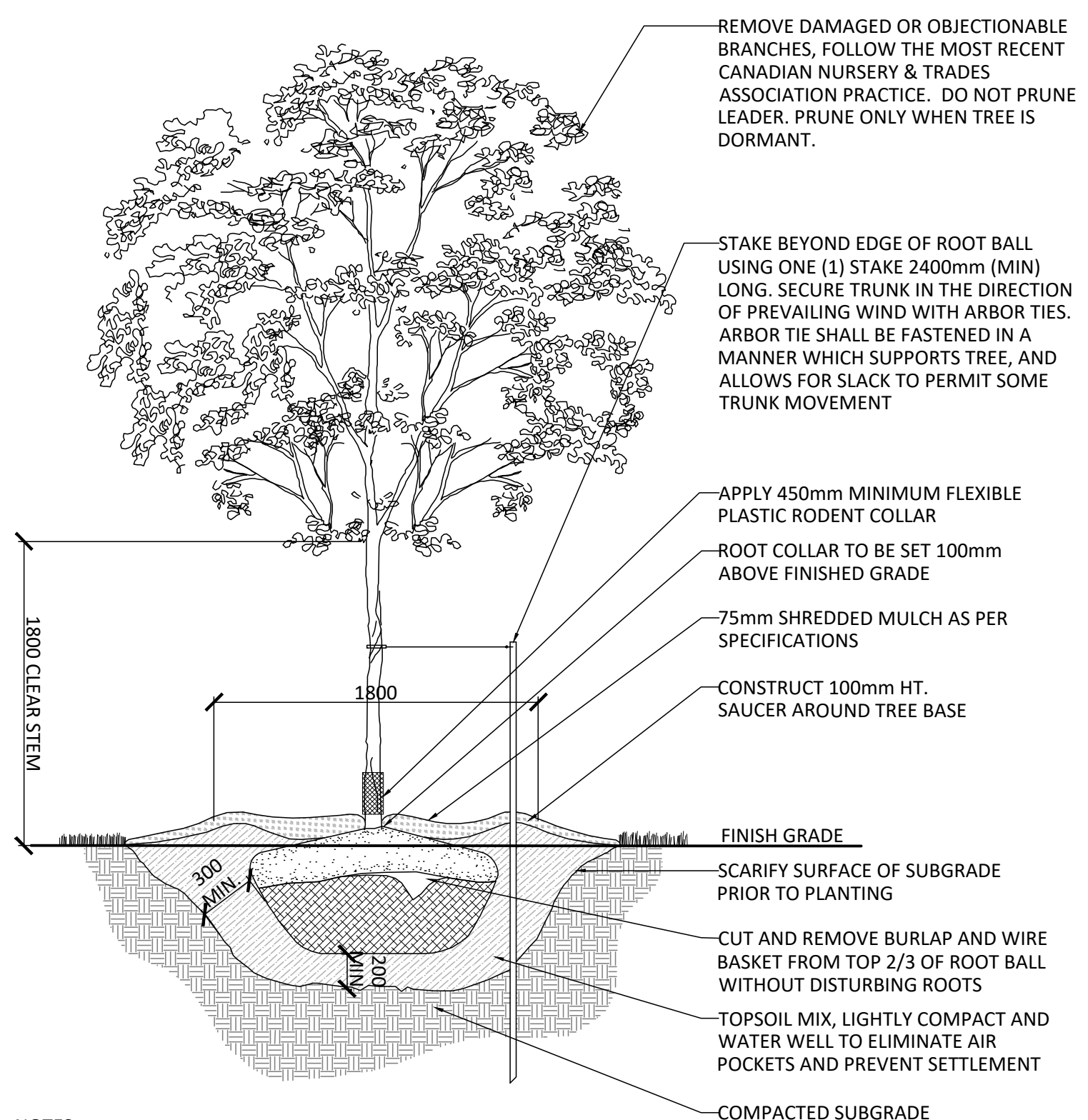

NOTES:

- REMOVE STAKE AFTER ONE YEAR OR UNTIL TAKEOVER, UNLESS OTHERWISE DIRECTED BY THE LANDSCAPE ARCHITECT.
- TOPSOIL MIXTURE AND SHREDDED MULCH AS PER SPECIFICATION
- REMOVE TREE WRAP AFTER PLANTING
- CALIPER TO BE MEASURED AT THE BASE OF TREE AT ROOT BALL.

1 DECIDUOUS TREE PLANTING
1:30

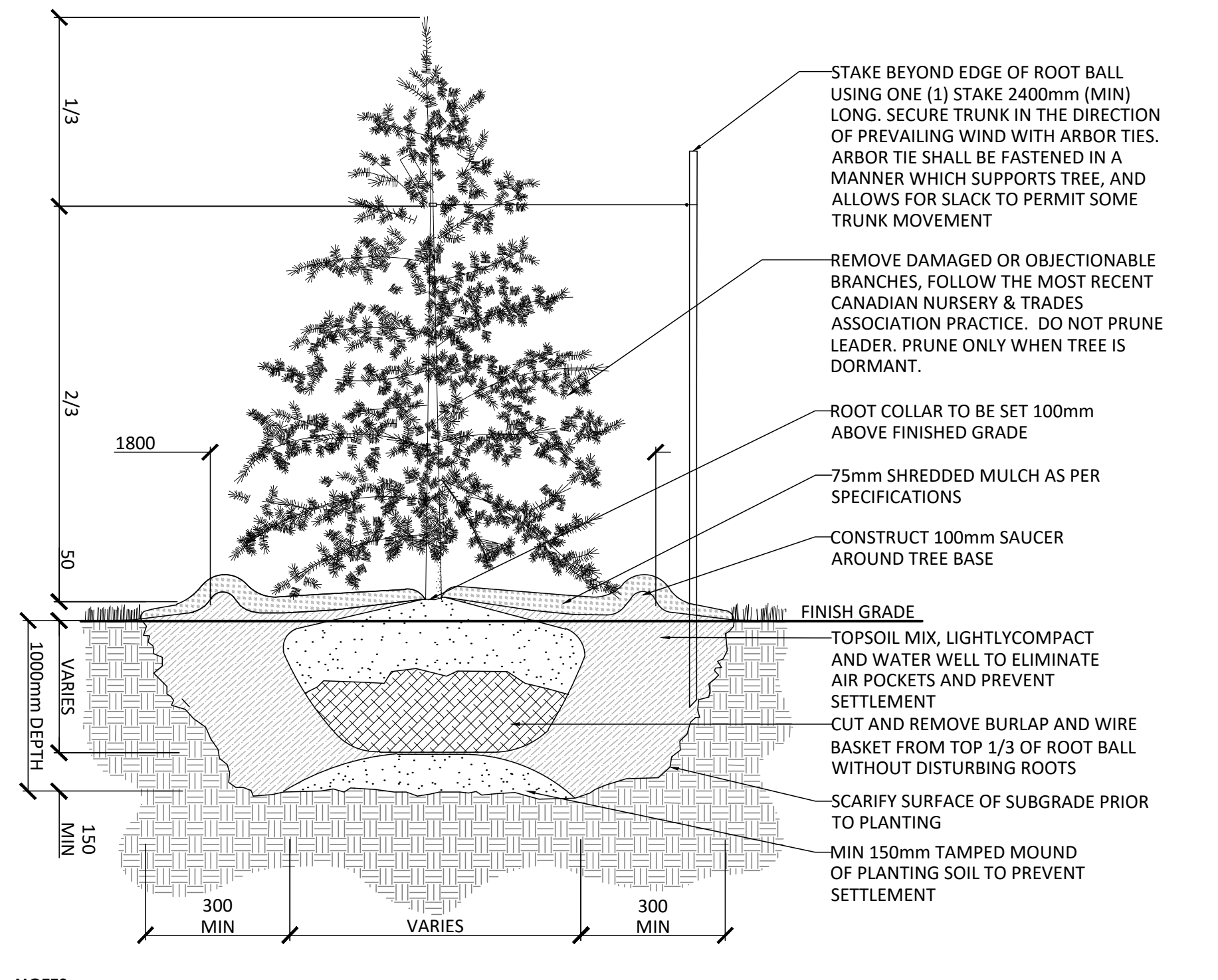

NOTES:

- REMOVE STAKE AFTER ONE YEAR OR UNTIL TAKEOVER UNLESS OTHERWISE DIRECTED BY THE LANDSCAPE ARCHITECT.
- TOPSOIL MIXTURE AND SHREDDED MULCH AS PER SPECIFICATION

3 CONIFEROUS TREE PLANTING
1:30

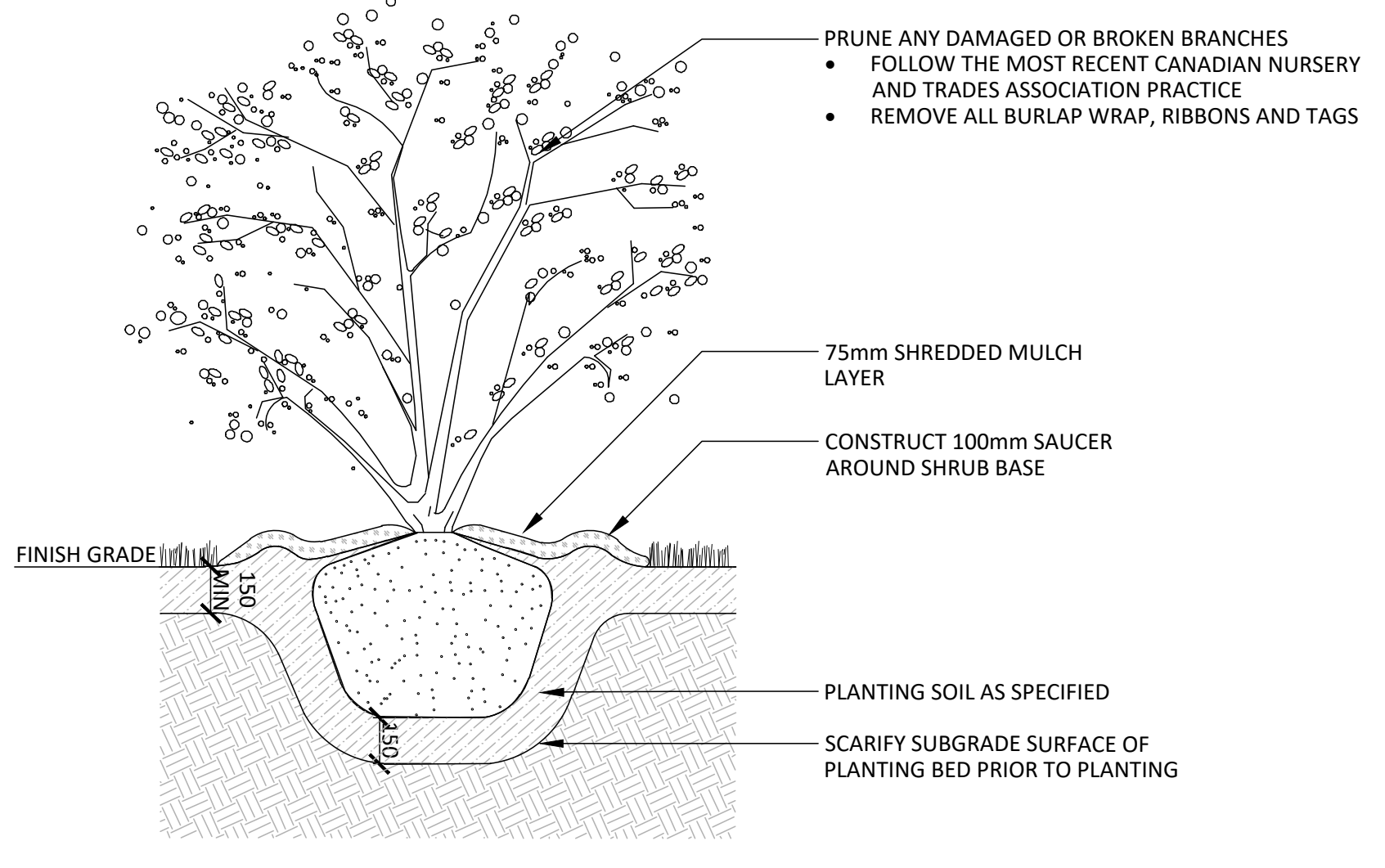

NOTES:

- SHRUBS SPECIFIED TO BE PLANTED SO THAT ROOTS ARE FULLY EXTENDED IN PLANTING HOLE WITH SOIL MIX BACKFILLED CAREFULLY TO PREVENT ROOT DAMAGE
- PROVIDE 100mm HIGH EARTH SAUCER AROUND SHRUB BED

5 MULTI-STEM SHRUB PLANTING
1:20

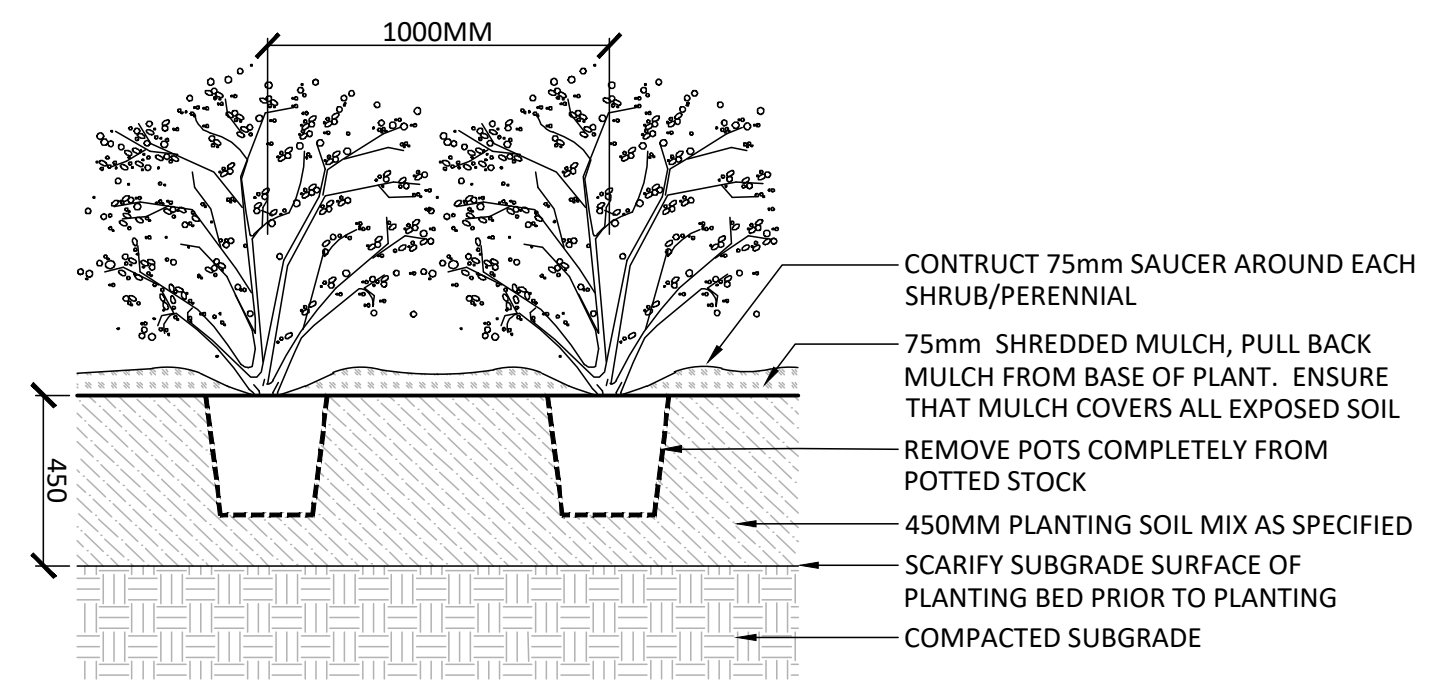

6 CONTINUOUS SHRUB BED PLANTING
1:20

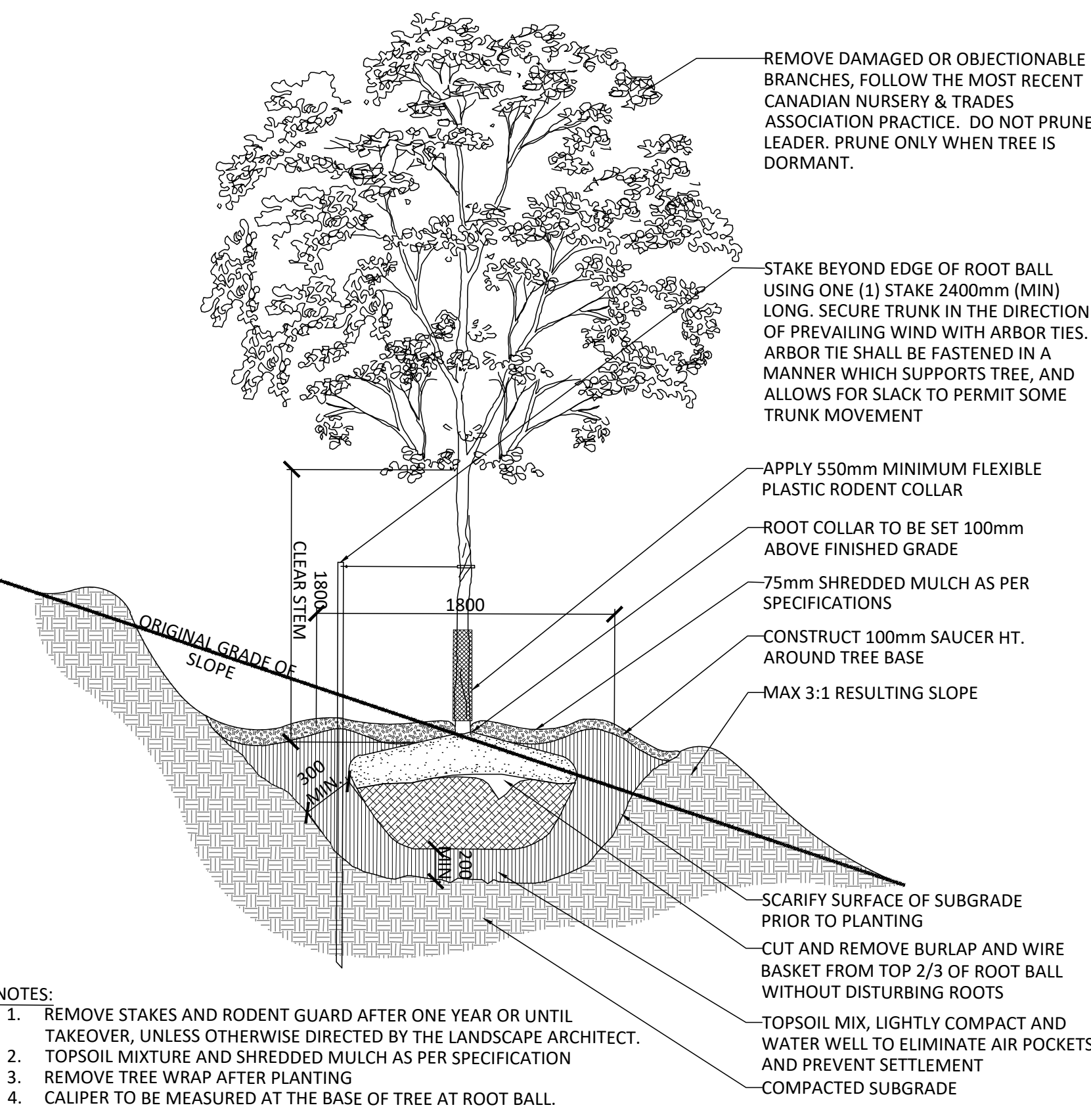

NOTES:

- REMOVE STAKES AND RODENT GUARD AFTER ONE YEAR OR UNTIL TAKEOVER, UNLESS OTHERWISE DIRECTED BY THE LANDSCAPE ARCHITECT.
- TOPSOIL MIXTURE AND SHREDDED MULCH AS PER SPECIFICATION
- REMOVE TREE WRAP AFTER PLANTING
- CALIPER TO BE MEASURED AT THE BASE OF TREE AT ROOT BALL.

2 DECIDUOUS TREE PLANTING ON A SLOPE
1:30

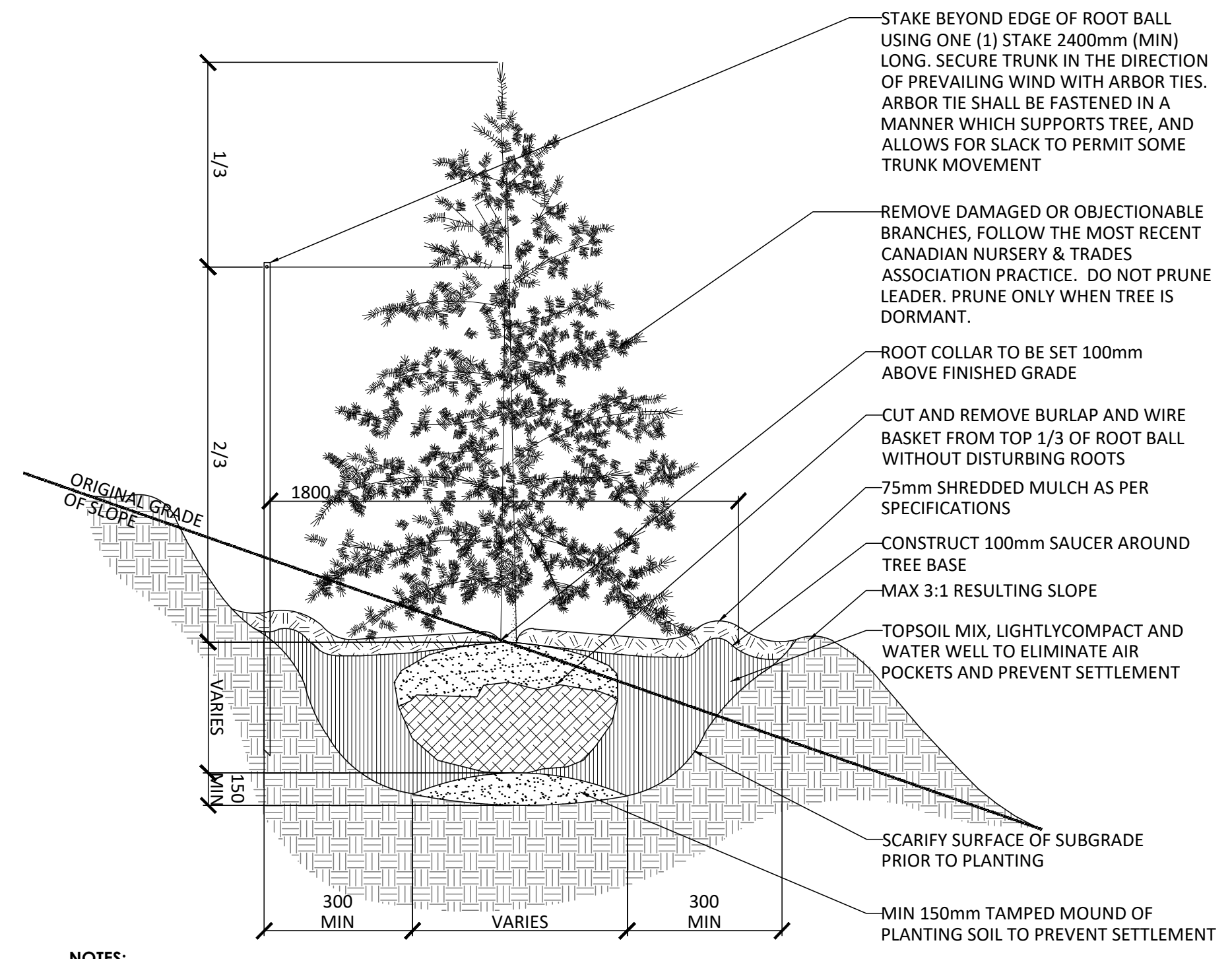

NOTES:

- REMOVE STAKES AFTER ONE YEAR OR UNTIL TAKEOVER UNLESS OTHERWISE DIRECTED BY THE LANDSCAPE ARCHITECT.
- TOPSOIL MIXTURE AND SHREDDED MULCH AS PER SPECIFICATION
- STAKES TO BE REMOVED AT COMPLETION OF TWO YEAR WARRANTY PERIOD.

4 CONIFEROUS TREE PLANTING ON A SLOPE
1:30

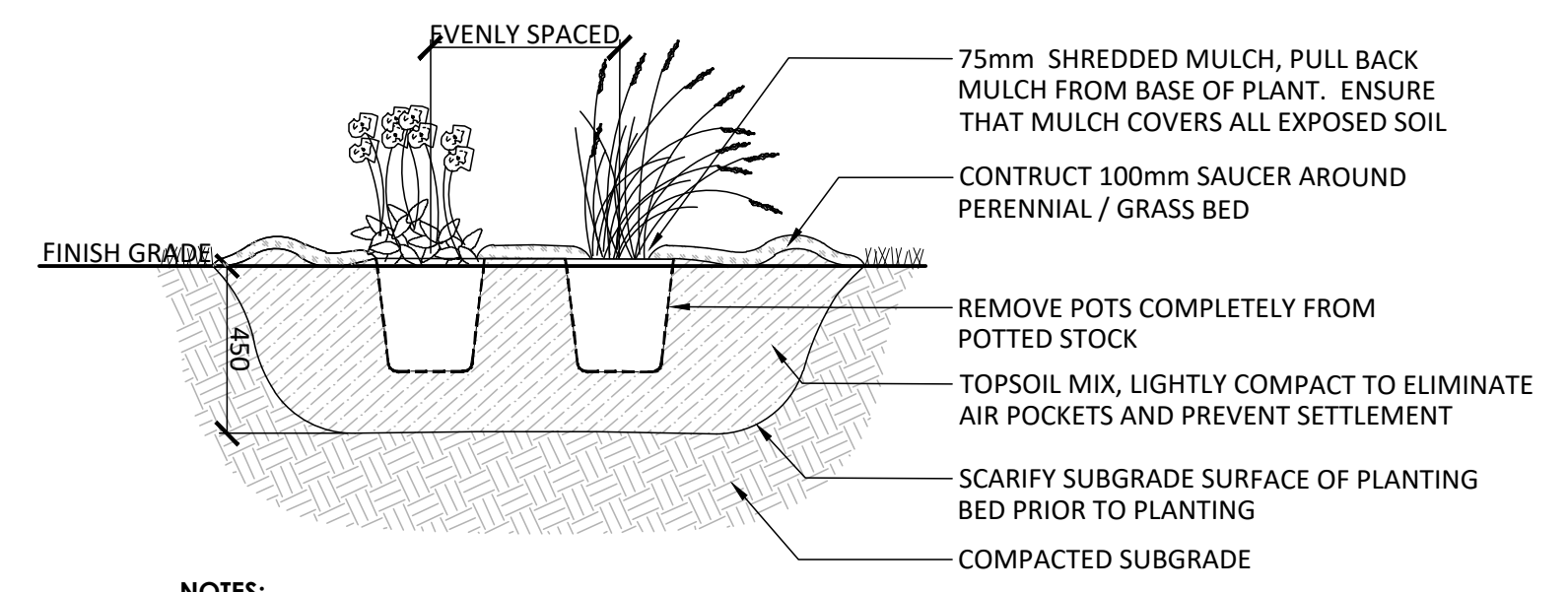

NOTES:

- TOPSOIL MIXTURE AND SHREDDED MULCH AS PER SPECIFICATION.
- PROVIDE 100mm HIGH EARTH SAUCER AROUND PERENNIAL BED.
- EVENLY DISTRIBUTE SPECIES IN GROUPS OF 2-5.
- EVENLY SPACE ALL PLANTS

7 PERENNIAL PLANTING
1:20

3	Issued for SPA First Submission	3/20/2026
2	Issued for Coordination	3/13/2026
1	Issued for Coordination	2/18/2026
No.	Description	Date

OWNERSHIP	TRANSPORTATION
MATTAMY HOMES 50 Howe Rd., Suite 100, Ottawa ON K2C 2M5	NOVATECH 240 Michael Cowland Dr., Suite 200, Ottawa, ON, K2M1P6
ARCHITECT	NOISE
KORSIAK 277 Lakeshore Rd., #R206, Oakville ON L6J 1M5	GRADIENT WIND 127 Walgreen Rd., Carp ON K0A 1J0
CIVIL	SURVEY
STANTEC 380-1531 Clyde Ave., Ottawa ON K2C 2G4	ANNEX O'SULLIVAN, HOLLEBERG LTD. 14 Concourse Gate, Suite 500, Nepean, ON K2E 7S6
LANDSCAPE ARCHITECT	GEOTECH
NAK DESIGN STRATEGIES 1285 Wellington St., Ottawa ON K1Y 3A8	PATERSON GROUP 9 Angus Drive, Ottawa ON K2E 779
ELECTRICAL	
ILL 5430 Carleton Rd., Ottawa ON K3J 9G2	

PROPERTY INFORMATION
PART OF LOTS 21, 22 AND 23 CONVESSION 1 (OTTAWA FRONT) AND PART OF RESERVE BLOCK 14 AND ALL OF RESERVE BLOCKS 15 AND 16 REGISTERED PLAN 4M-1653 CITY OF OTTAWA

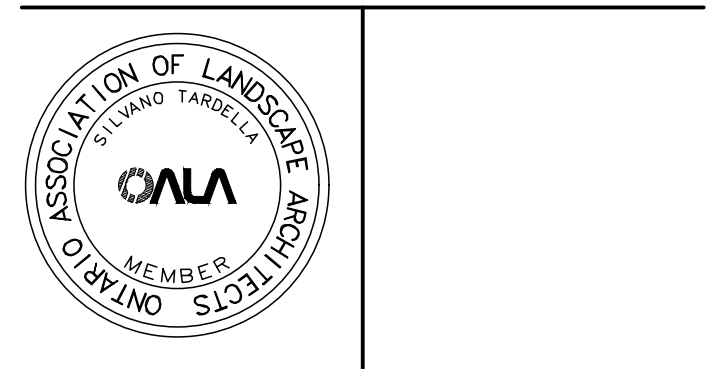

NAK
design strategies

1285 WELLINGTON STREET, OTTAWA, ON K1Y 3A8 CANADA
T 613.237.2345 NAKDESIGNSTRATEGIES.COM

WATERIDGE BLOCK 22&23
200 Codd's Road, Ottawa ON K1K 2E3

Date	2026-01-30	Sheet	
Scale	1:500		
Drawn	JE		
Checked	SC		
Job No.	25-438		

L2.0

PLAN N° XXXXX

CITY FILE N° DXX-XX-XX-XXXX

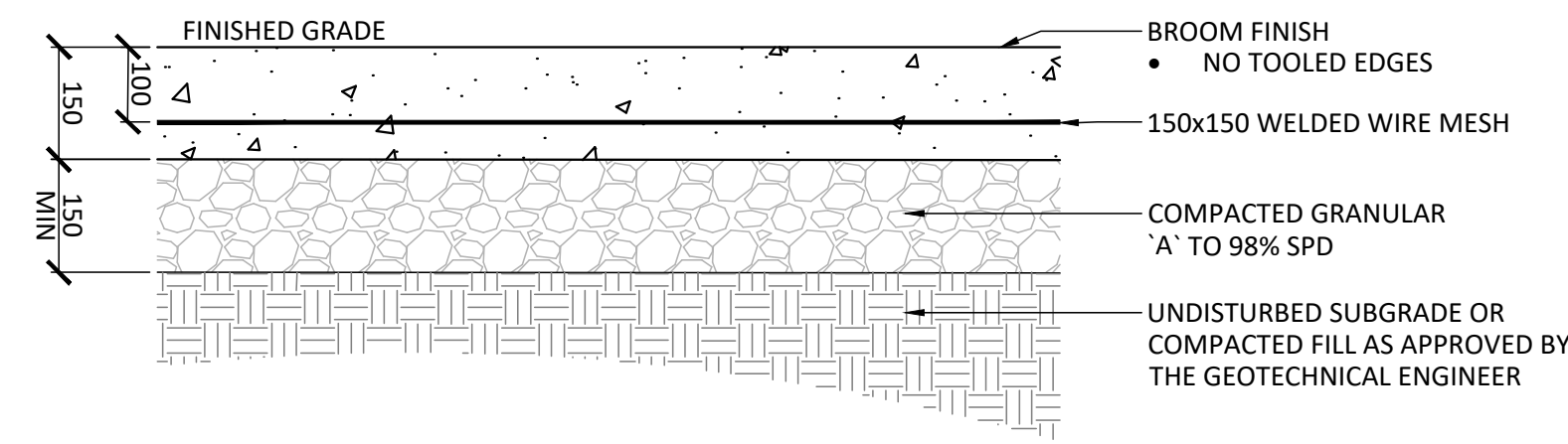

1 LIGHT DUTY CONCRETE
1:10

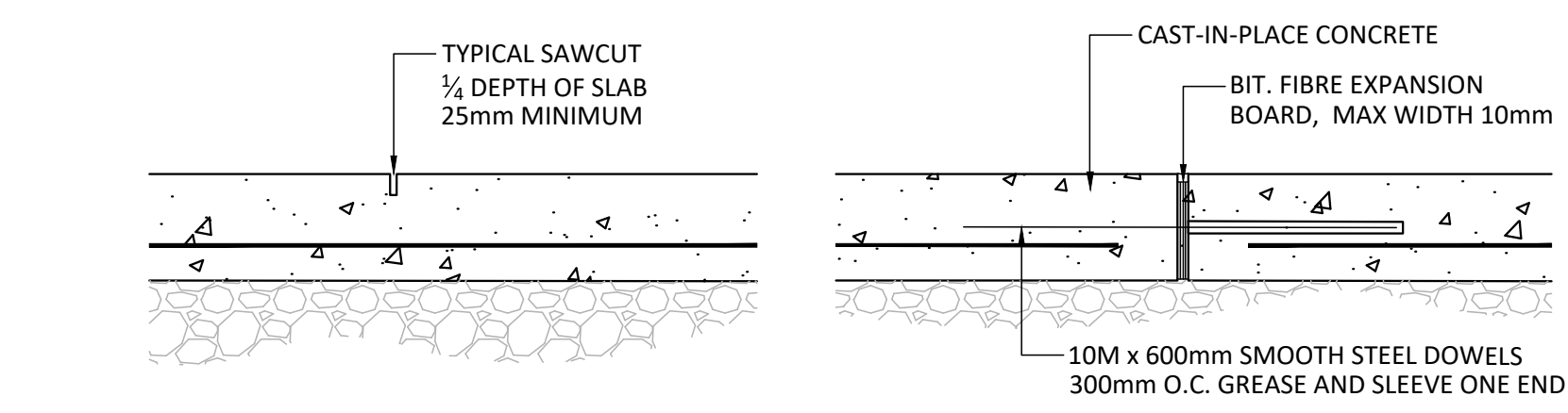

CONTROL JOINT (C)

NOTES:
1. REFER TO DRAWINGS FOR JOINT LAYOUT
2. SAWCUT WITHIN 48 HOURS OF POUR

EXPANSION JOINT (E)

NOTES:
1. REFER TO DRAWINGS FOR JOINT LAYOUT
2. NO CAULKED JOINTS

2 LIGHT DUTY CONCRETE - JOINTING
1:10

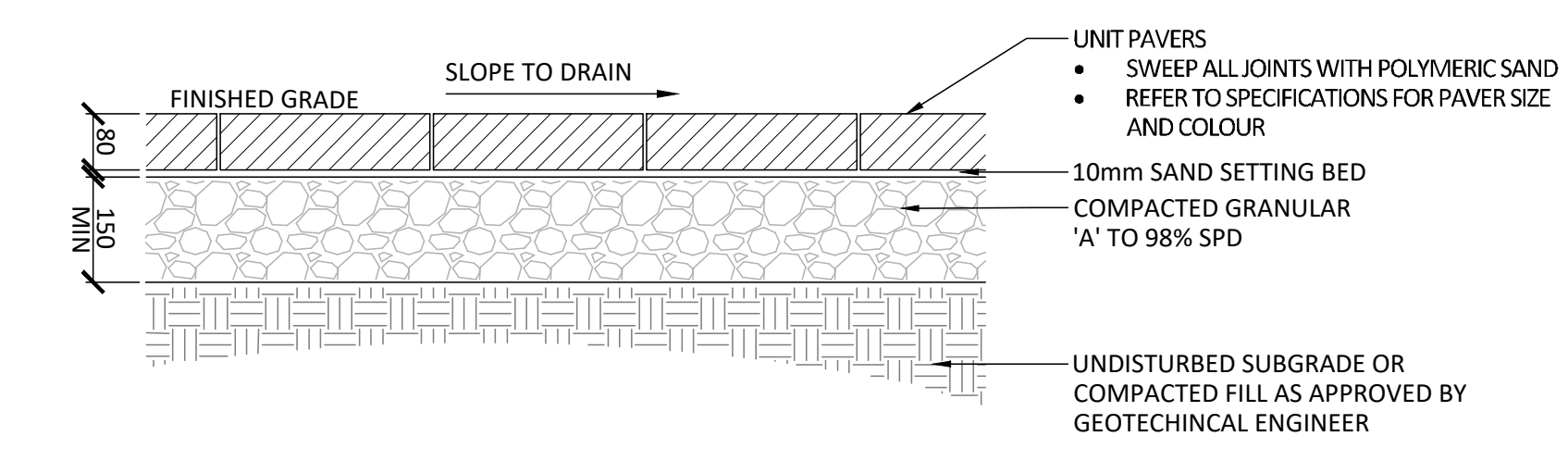

3 UNIT PAVERS
1:10

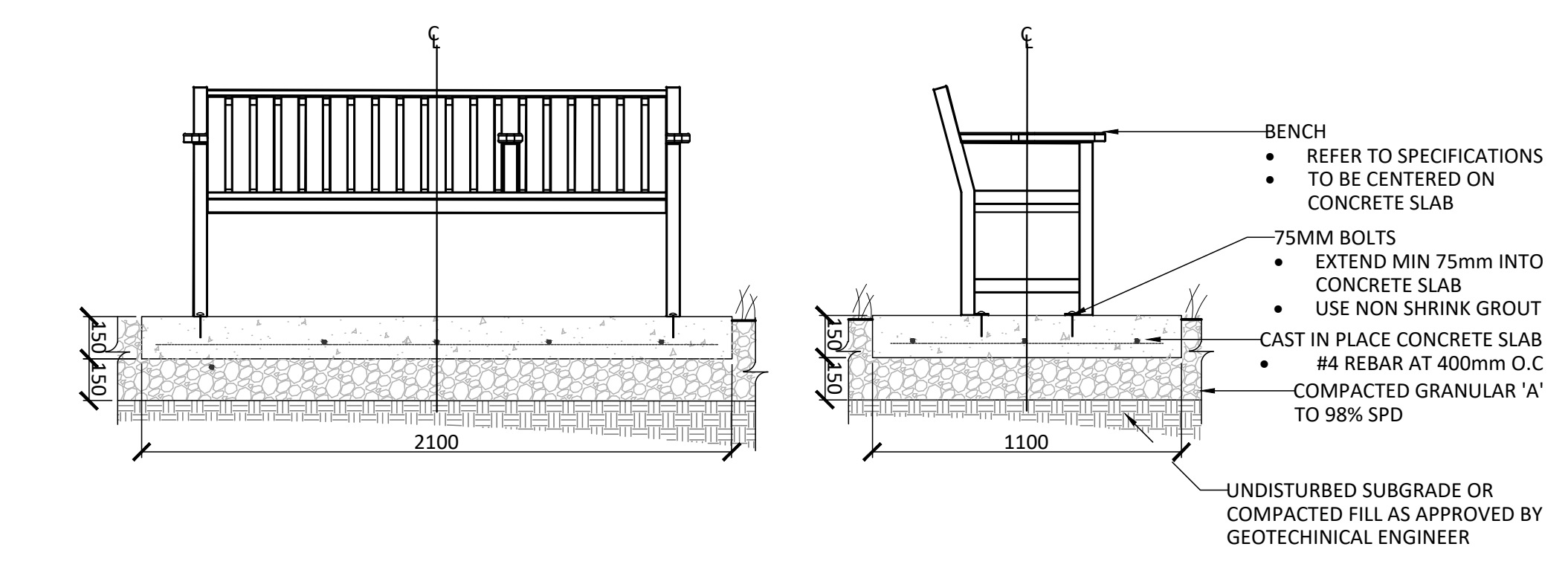

4 BENCH ON CONCRETE PAD
1:20

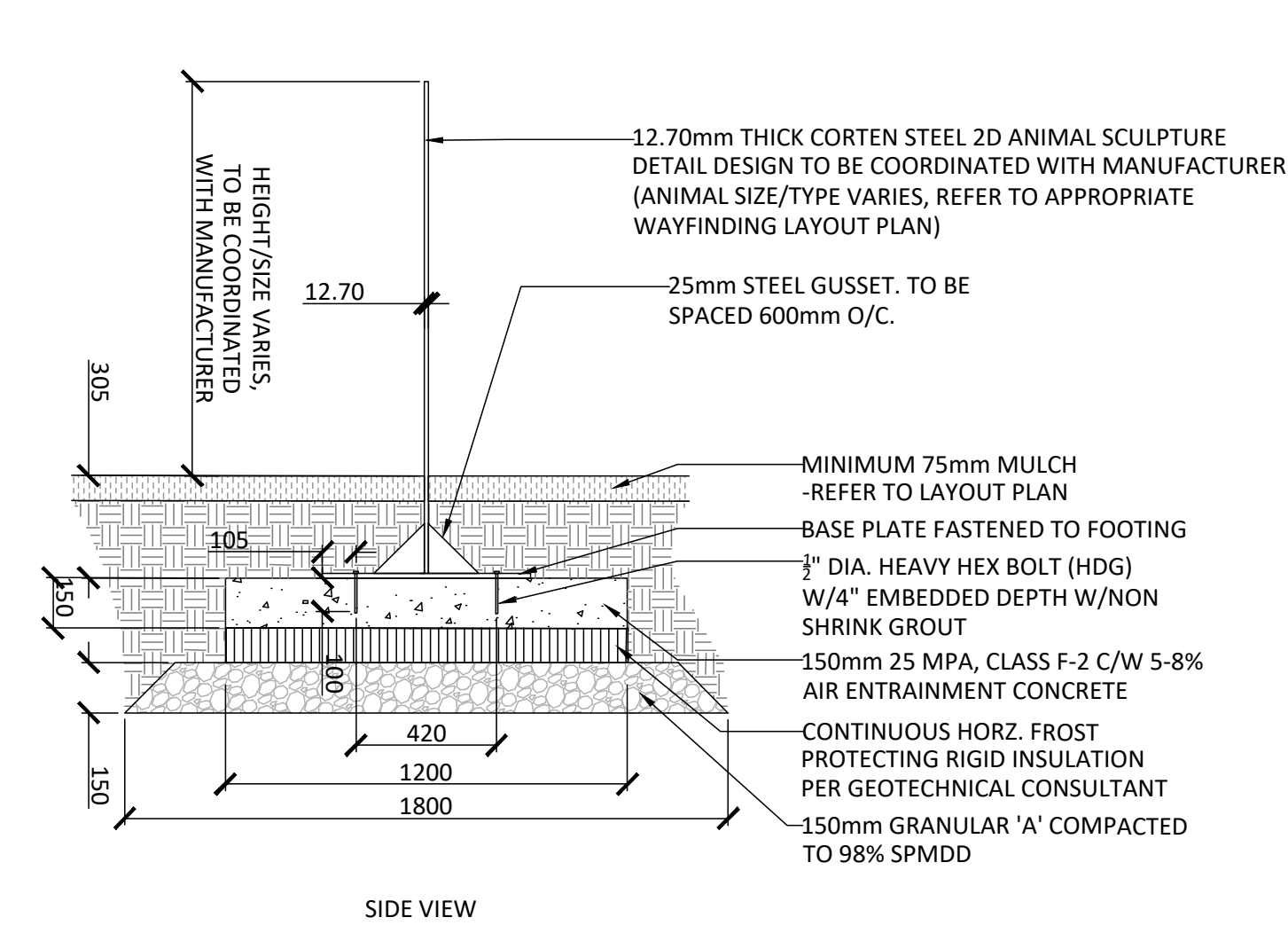

5 2D ANIMAL SCULPTURE
1:20

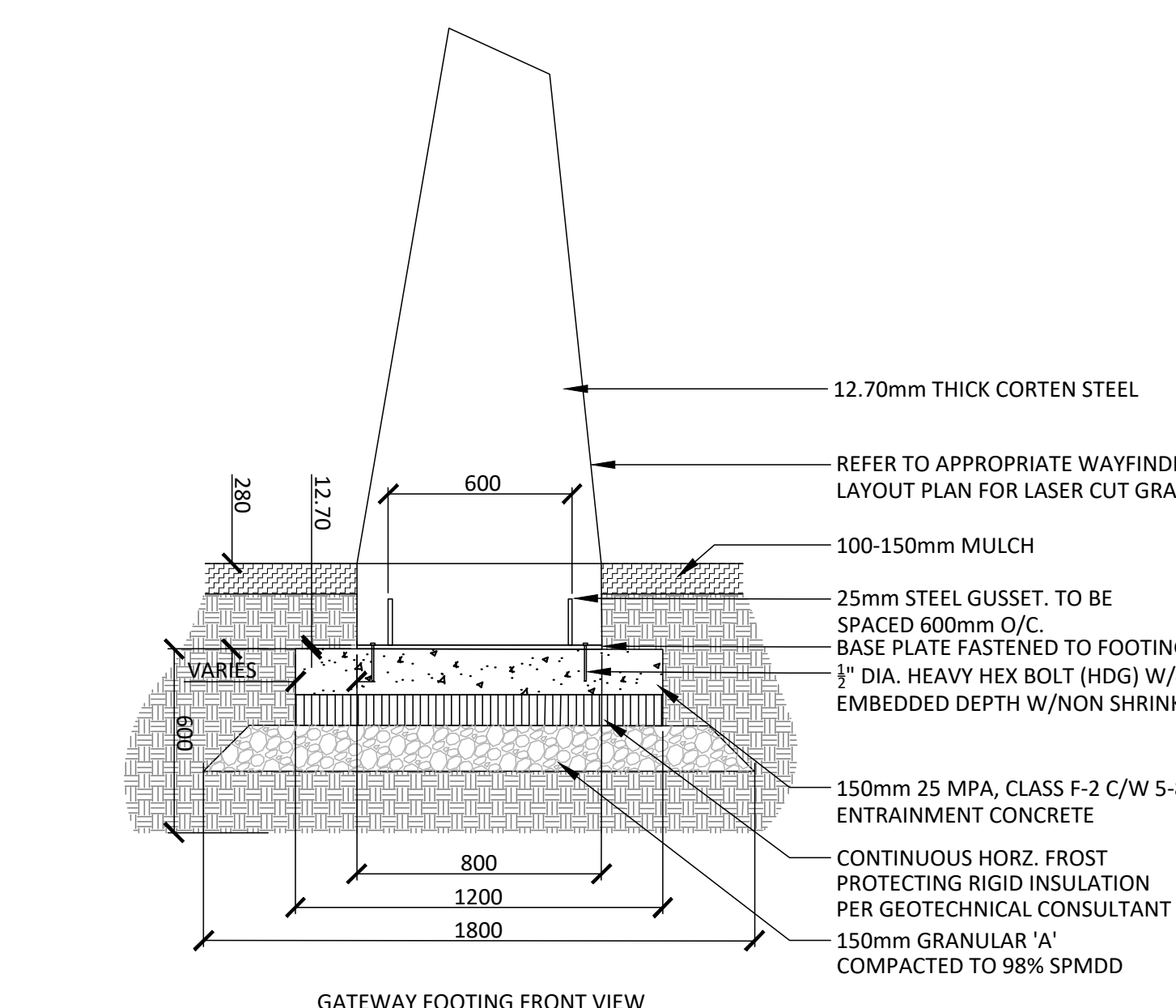
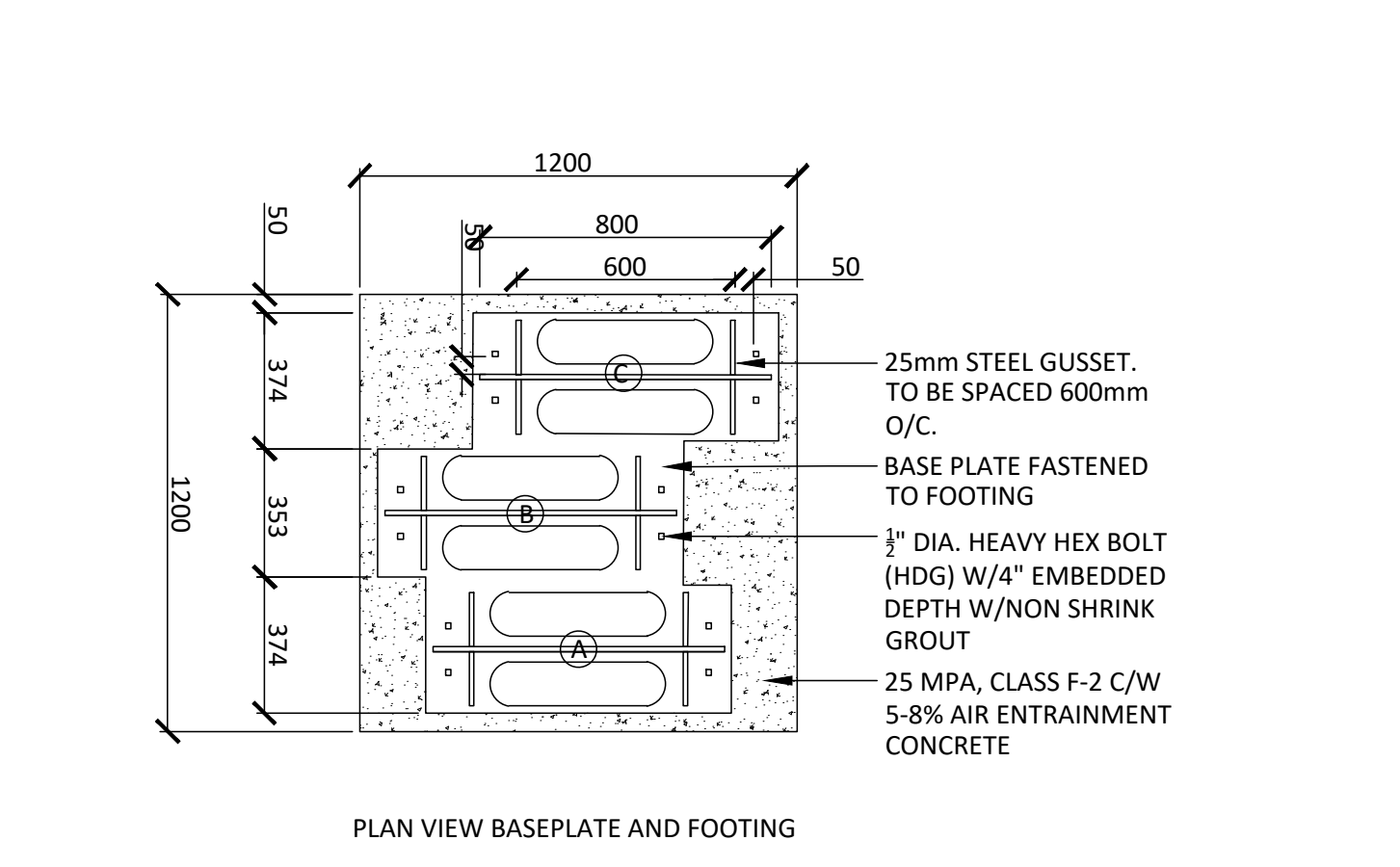

6 WAYFINDING SCULPTURE
1:20

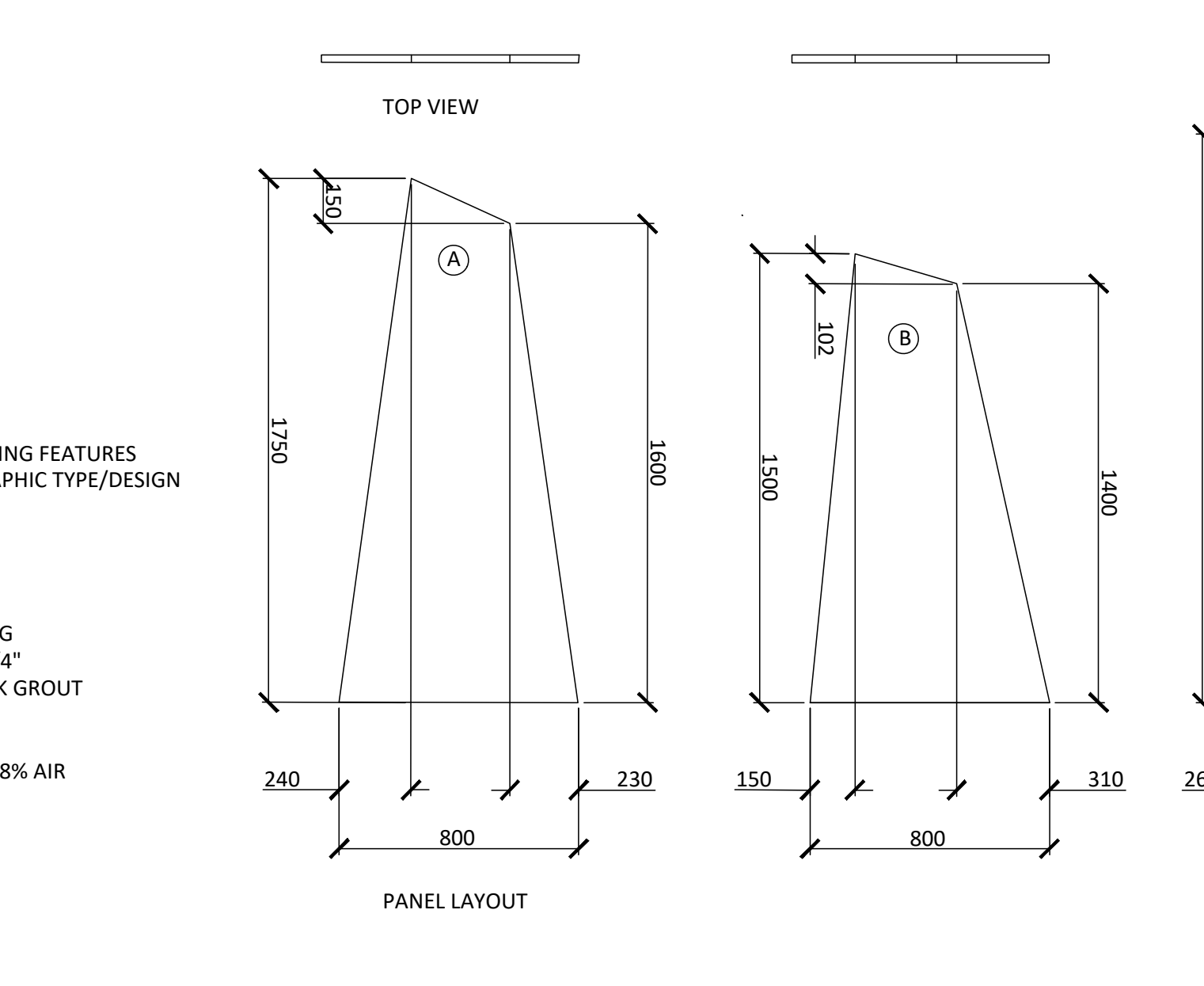
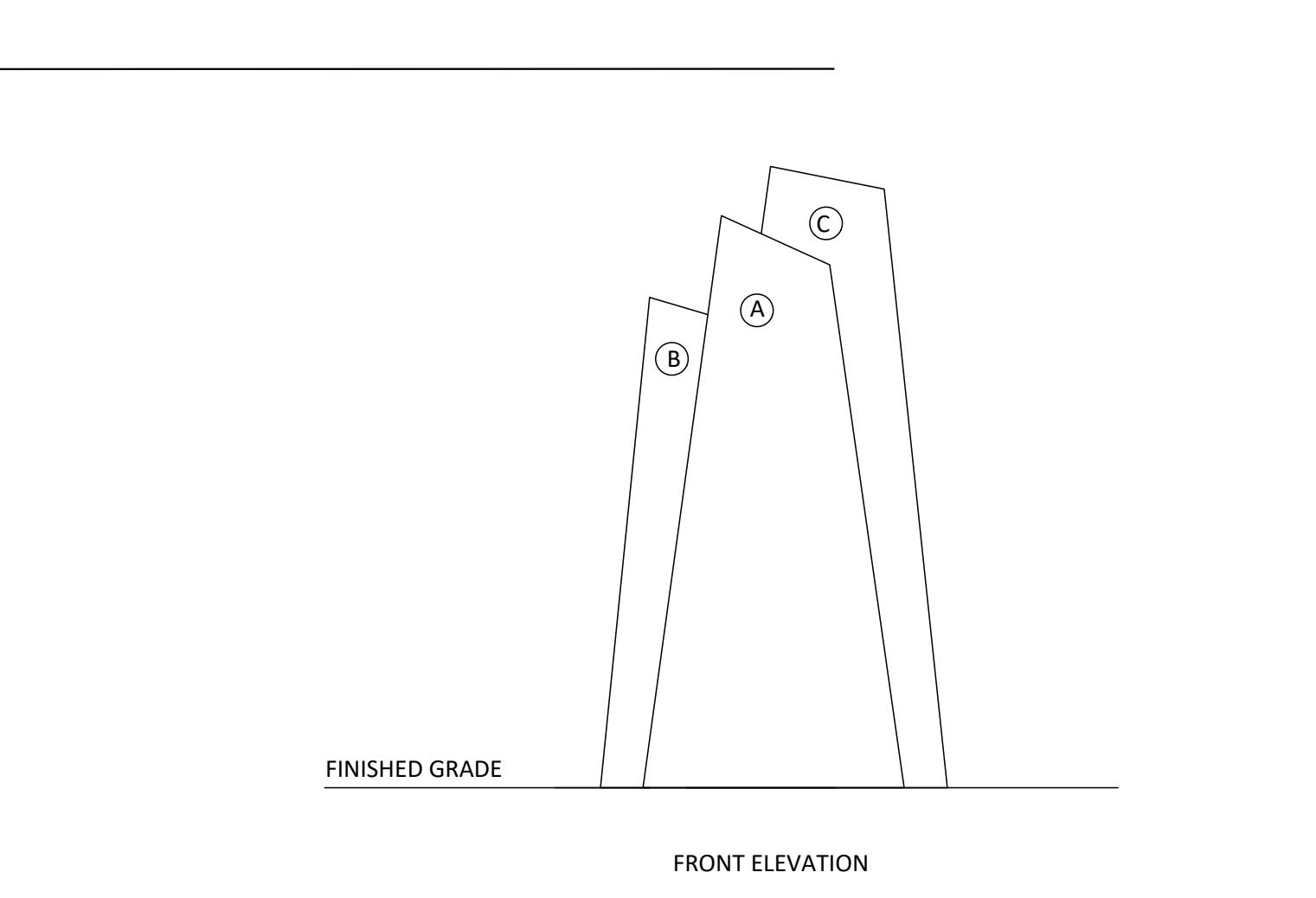
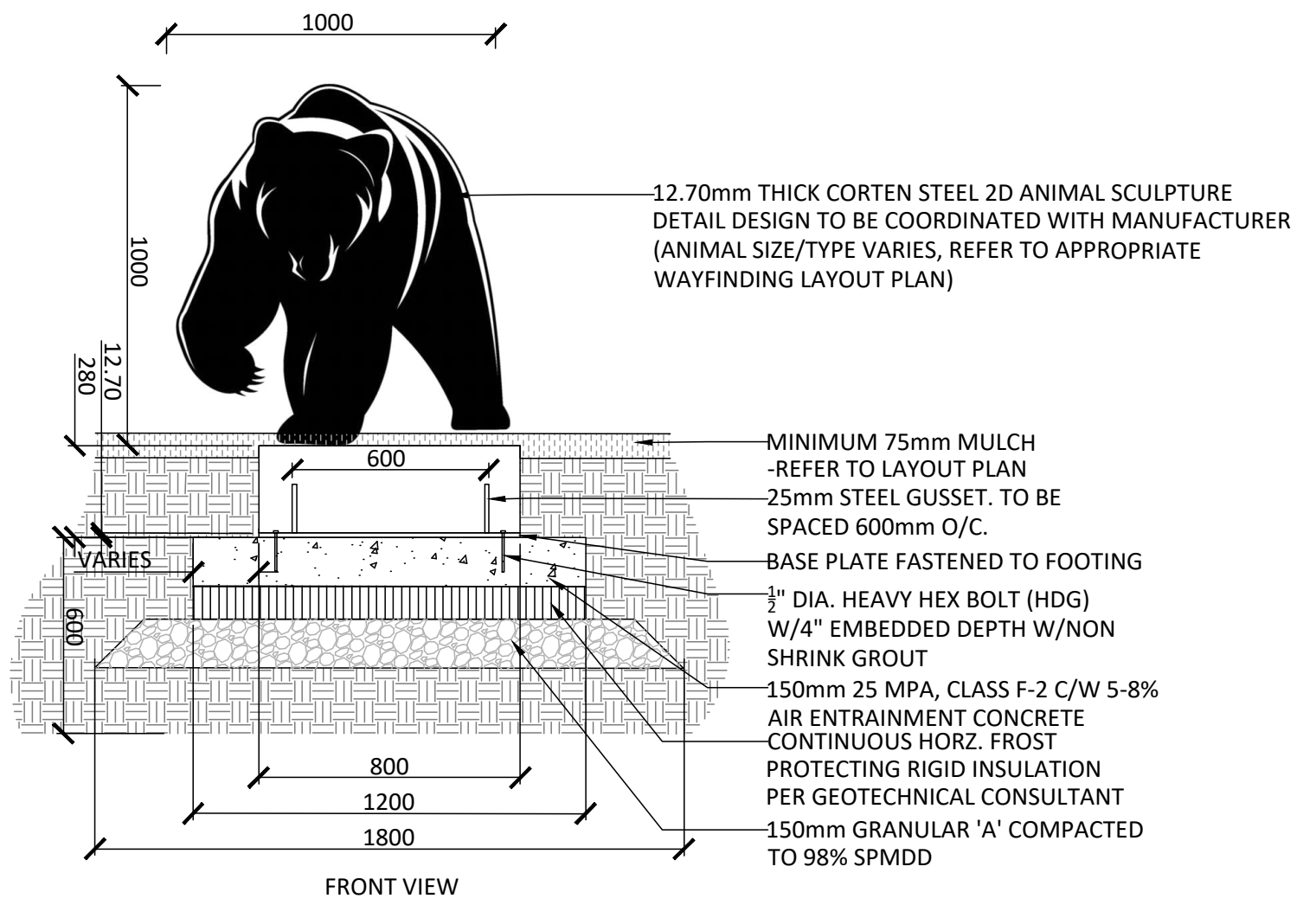

Contractor shall check all dimensions on the work and report any discrepancy to the Landscape Architect before proceeding. All drawings and specifications are the property of the Landscape Architect and must be returned at the completion of the work. This drawing is not to be used for construction until signed by the Landscape Architect.

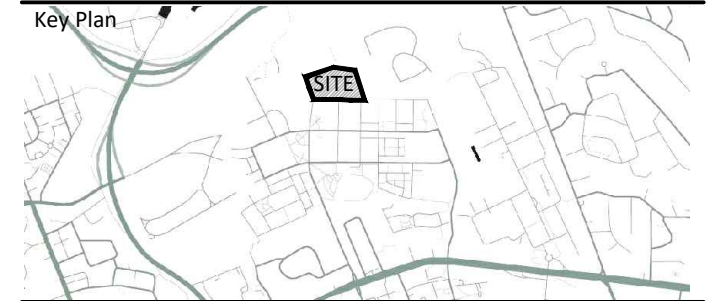

LEGEND

--- PROPERTY LINE

1.5m HT. CHAIN LINK FENCE

○ POST AND RAIL FENCE

PLANTING

○ LARGE DECIDUOUS TREE

○ MEDIUM DECIDUOUS TREE

○ CONIFEROUS TREE

○ SMALL DECIDUOUS TREE

○ MULTI-STEM SHRUB

○ DECIDUOUS SHRUB

PAVING

□ CIP CONCRETE PAVING

□ UNIT PAVING

□ NATURALIZED PLANTING

□ PERENNIAL WILDFLOWER SEED MIX

FURNISHINGS & FEATURES

□ BENCH

□ WAYFINDING, 2D ANIMAL SCULPTURES

PLANTING KEY

XX TREE SPECIES

00 QUANTITY

XX SHRUB SPECIES

00 QUANTITY

DETAIL KEY

1 DETAIL NO.

L1 SHEET NO.

No.	Description	Date
3	Issued for SPA First Submission	3/20/2026
2	Issued for Coordination	3/13/2026
1	Issued for Coordination	2/18/2026

OWNERSHIP	TRANSPORTATION
MATTAMY HOMES 50 Howe Rd., Suite 100, Ottawa ON K2K 2M5	NOVATECH 240 Michael Cowland Dr., Suite 200, Ottawa, ON, K2M1P6
ARCHITECT	NOISE
KORSIAK 277 Lakeshore Rd., #R206, Oakville ON L6J 1H5	GRADIENT WIND 127 Walgreen Rd., Carp ON K0A 1J0
CIVIL	SURVEY
STANTEC 380-1511 Clyde Ave., Ottawa ON K2C 2G4	ANNIE O'SULLIVAN, VOLLEBERG LTD. 14 Concourse Gate, Suite 500, Nepean, ON K2E 7S6
LANDSCAPE ARCHITECT	GEOTECH
NAK DESIGN STRATEGIES 1285 Wellington St., Ottawa ON K1Y 3A8	PATERSON GROUP 9 Angus Drive, Ottawa ON K2E 779
ELECTRICAL	
ULI 5430 Carleton Rd., Ottawa ON K1J 9G2	

PROPERTY INFORMATION
PART OF LOTS 21, 22 AND 23 CONCESSION 1 (LOTTANIA FRONT) AND PART OF RESERVE BLOCK 14 AND ALL OF RESERVE BLOCKS 15 AND 16 REGISTERED PLAN 4M-1653 CITY OF OTTAWA

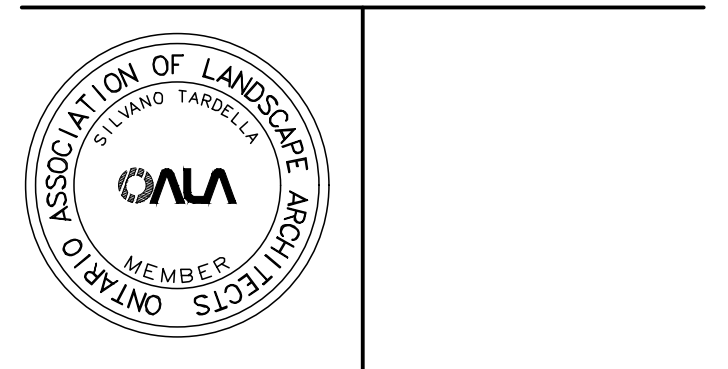

NAK
design strategies

1285 WELLINGTON STREET, OTTAWA, ON K1Y 3A8 CANADA
T 613.237.2345 NAKDESIGNSTRATEGIES.COM

WATERIDGE BLOCK 22&23
200 Codd's Road, Ottawa ON K1K 2E3

Title

DETAILS

Date	2026-01-30	Sheet	L2.1
Scale	1:500		
Drawn	JE		
Checked	SC		
Job No.	25-438		

PLANNING

CITY FILE N° DXX-XX-XXXX

Contractor shall check all dimensions on the work and report any discrepancy to the Landscape Architect before proceeding. All drawings and specifications are the property of the Landscape Architect and must be returned at the completion of the work. This drawing is not to be used for construction until signed by the Landscape Architect.

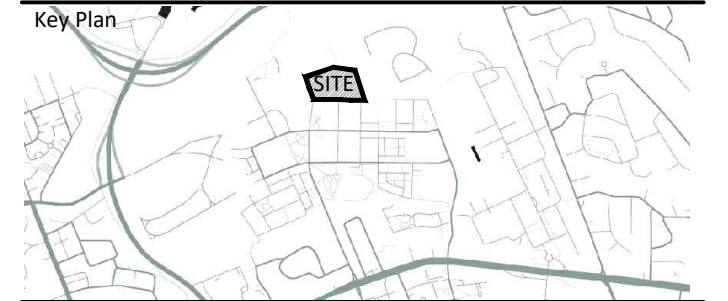

LEGEND

- PROPERTY LINE
- 1.5m HT. CHAIN LINK FENCE
- POST AND RAIL FENCE

PLANTING

- LARGE DECIDUOUS TREE
- MEDIUM DECIDUOUS TREE
- CONIFEROUS TREE
- SMALL DECIDUOUS TREE
- MULTI-STEM SHRUB
- DECIDUOUS SHRUB

PAVING

- ▨ CIP CONCRETE PAVING
- ▨ UNIT PAVING
- ▨ NATURALIZED PLANTING
- ▨ PERENNIAL WILDFLOWER SEED MIX

FURNISHINGS & FEATURES

- ▨ BENCH
- ▨ WAYFINDING, 2D ANIMAL SCULPTURES

PLANTING KEY

- XX TREE SPECIES
- 00 QUANTITY
- XX SHRUB SPECIES
- 00 QUANTITY

DETAIL KEY

- 1 DETAIL NO.
- L1 SHEET NO.

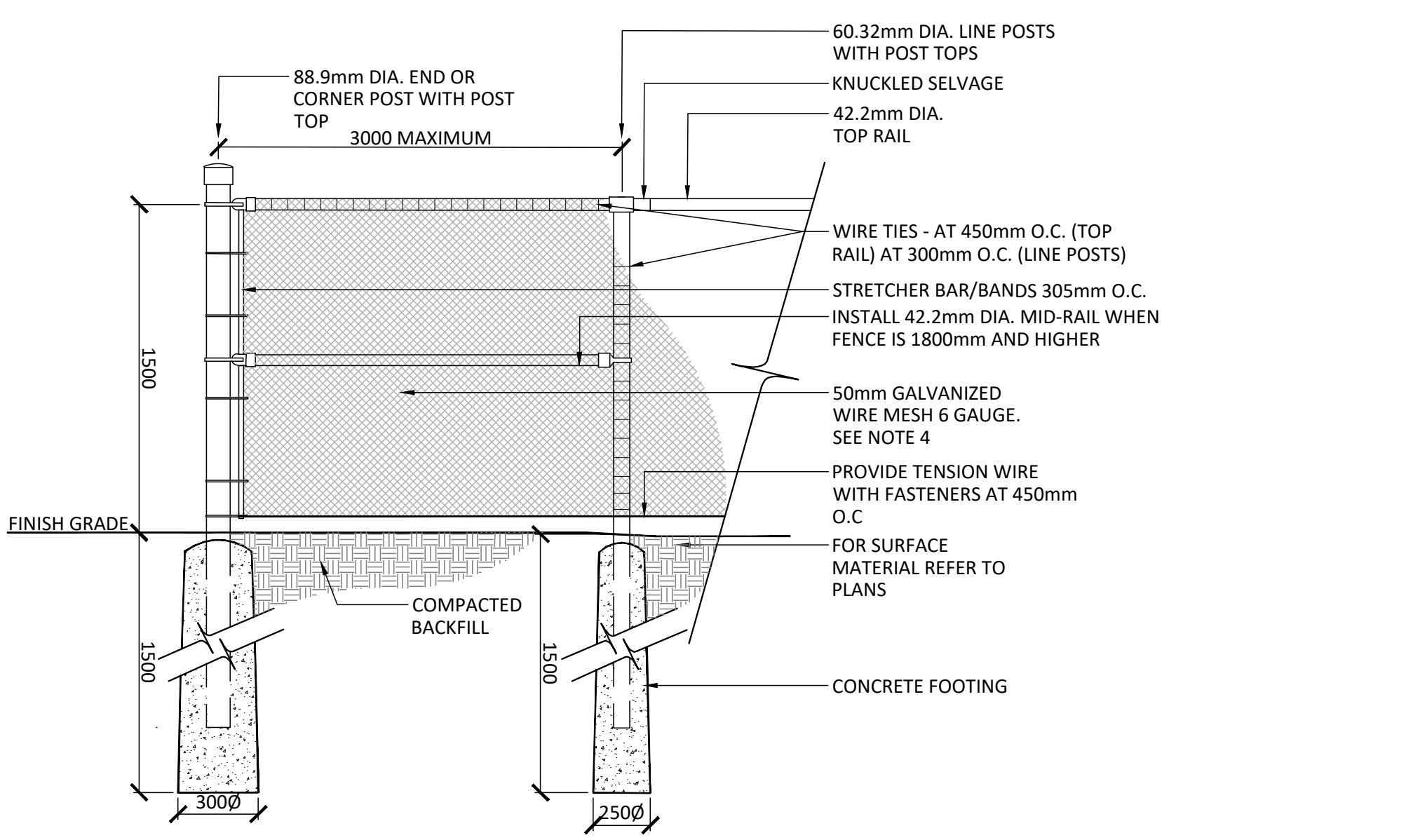

- NOTES:**
- IF FENCE IS TO BE BLACK VINYL, THE FENCE SHOULD BE 9 GAUGE GALVANIZED WIRE CORE WITH BLACK VINYL COATING TO PROVIDE A TOTAL OF 6 GAUGE THICKNESS
 - POSTS, RAILS AND ALL OTHER HARDWARE SHOULD BE ELECTROSTATIC PAINTED
 - CONCRETE FOOTING SHALL BE CSA 30MPa CLASS F-1

1 1.5m HEIGHT CHAIN LINK FENCE
1:20

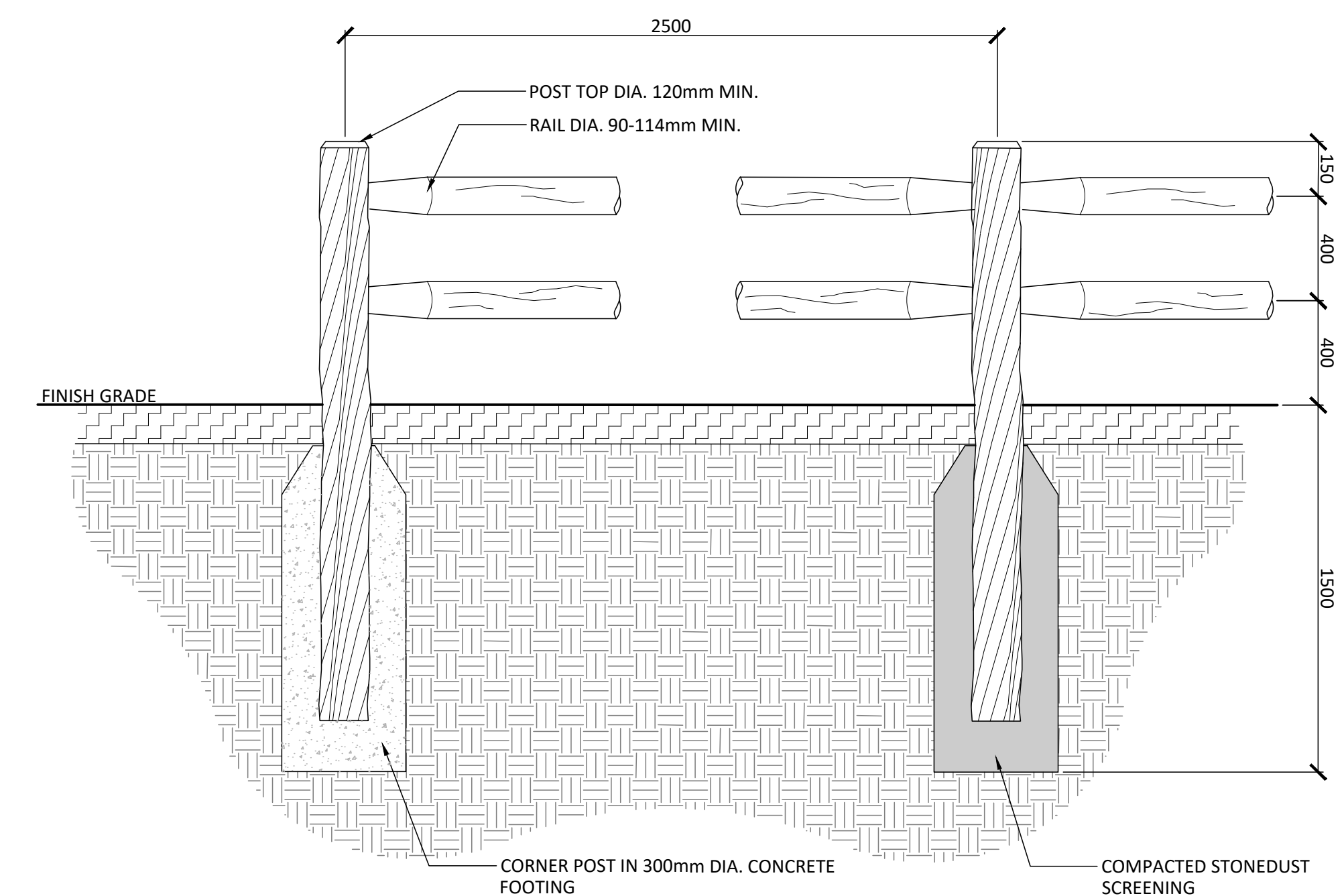
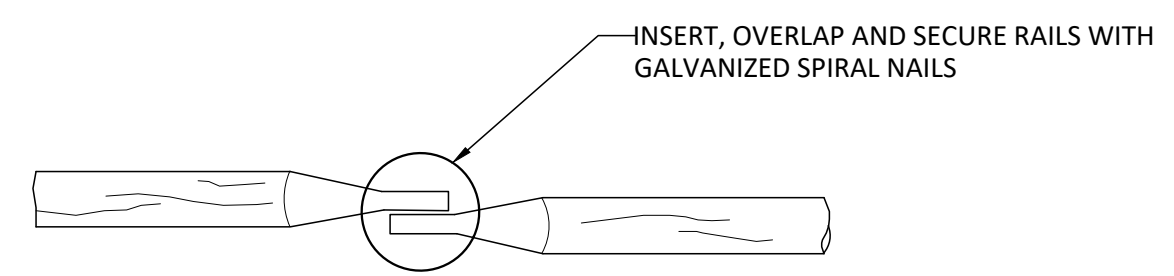

- NOTES:**
- POST AND RAILS TO BE WELL PEELER CEDAR, WITH NO PEELER MARKS
 - CORNER AND END POSTS TO HAVE MINIMUM 25 x 100mm OBLONG HOLES FOR RAILS LINE POSTS TO HAVE MINIMUM 64 x 100mm OBLONG HOLES FOR RAILS.
 - SOURCE OF WOOD FENCING TO BE APPROVED BY THE LANDSCAPE ARCHITECT.
 - CONCRETE FOOTING SHALL BE CSA 30MPa CLASS F-1

2 TWO RAIL POST AND RAIL FENCE
1:20

No.	Description	Date
3	Issued for SPA First Submission	3/20/2026
2	Issued for Coordination	3/13/2026
1	Issued for Coordination	2/18/2026

OWNERSHIP MATTAMY HOMES 50 Howe Rd., Suite 100, Ottawa ON K2K 2M5	TRANSPORTATION NOVATECH 240 Michael Cowland Dr., Suite 200, Ottawa, ON, K2M1P6
ARCHITECT KORSIAK 277 Lakeshore Rd., #R206, Oakville ON L6J 1H5	NOISE GRADIENT WIND 127 Walgreen Rd., Carp ON K0A 1J0
CIVIL STANTEC 300-1511 Clyde Ave., Ottawa ON K2C 2G4	SURVEY ANNIE O'SULLIVAN, VOLLEBERG LTD. 14 Concourse Gate, Suite 500, Nepean, ON K2E 756
LANDSCAPE ARCHITECT NAK DESIGN STRATEGIES 1285 Wellington St., Ottawa ON K1Y 3A8	GEOTECH PATERSON GROUP 9 Auriga Drive, Ottawa ON K2E 779
ELECTRICAL ULI 5430 Carotek Rd., Ottawa ON K1J 9G2	

PROPERTY INFORMATION
PART OF LOTS 21, 22, AND 23 CONCESSION 1 (LOTTANIA FRONT) AND PART OF RESERVE BLOCK 14 AND ALL OF RESERVE BLOCKS 15 AND 16 REGISTERED PLAN 4M-1653 CITY OF OTTAWA



NAK
design strategies

1285 WELLINGTON STREET, OTTAWA, ON K1Y 3A8 CANADA
T 613.237.2345 NAKDESIGNSTRATEGIES.COM

WATERIDGE BLOCK 22&23
200 Codd's Road, Ottawa ON K1K 2E3

Title	
DETAILS	
Date 2026-01-30	Sheet
Scale 1:500	L2.2
Drawn JE	
Checked SC	
Job No. 25-438	

CITY FILE N° DXX-XX-XXXX