

02 PLANTING PLAN ENLARGEMENT PLAN 1:100

03 PLANTING PLAN ENLARGEMENT PLAN 1:100

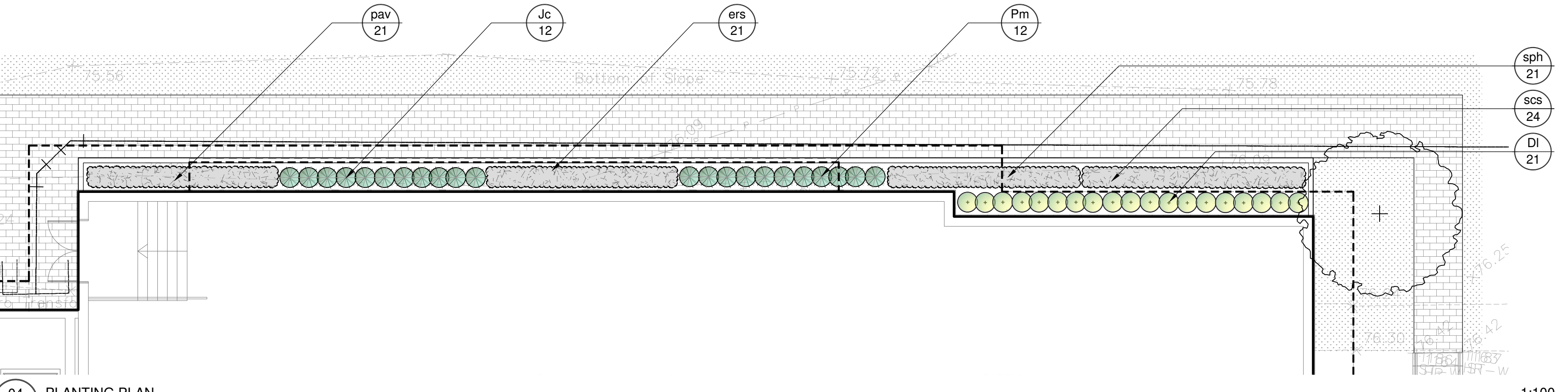

04 PLANTING PLAN ENLARGEMENT PLAN 1:100

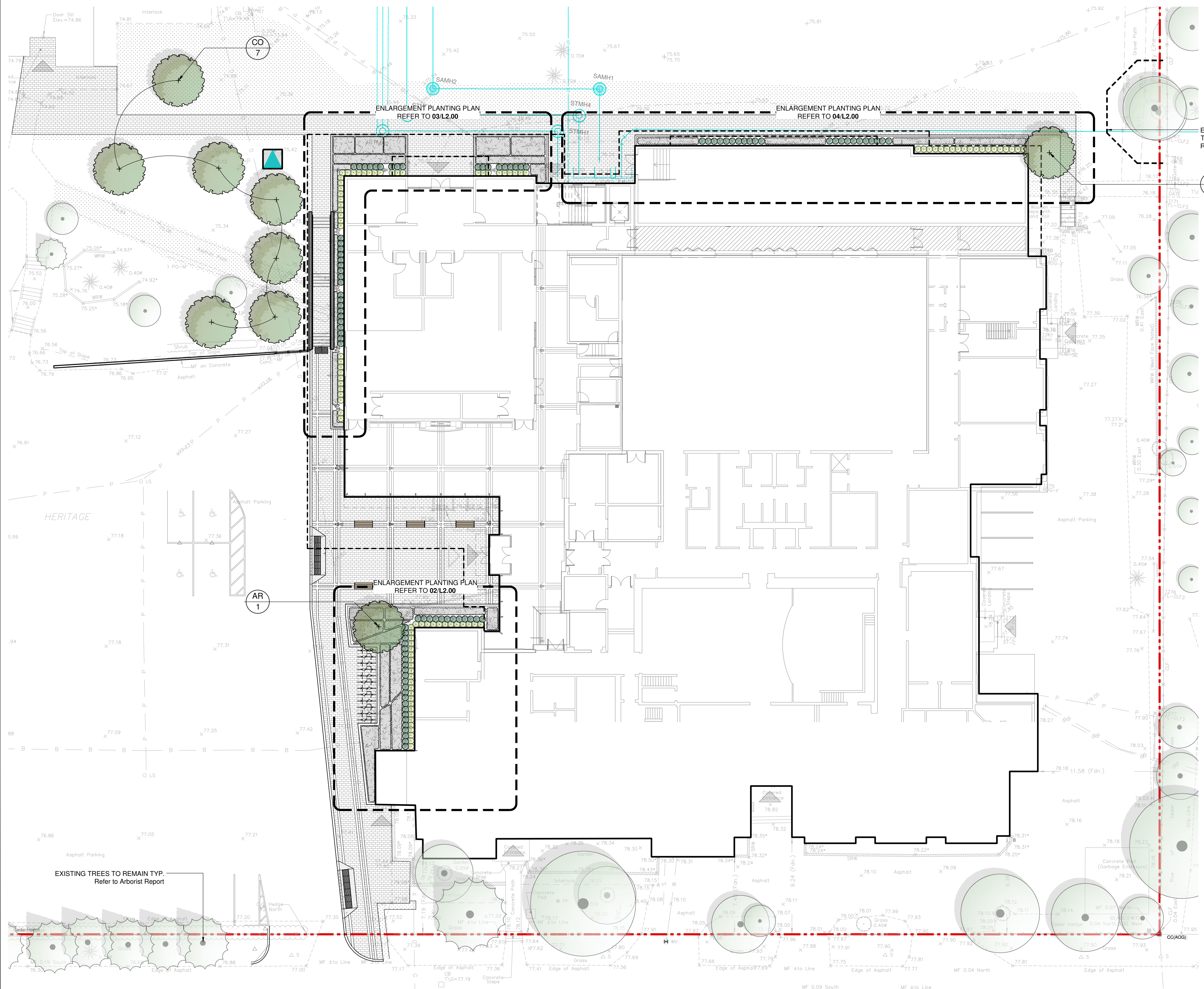

01 OVERALL PLANTING PLAN 1:200

KEY / QTY	BOTANICAL NAME	COMMON NAME	CALIPER	HT.	ROOT	SPACING	COMMENTS	NATIVE	POLLINATOR	DROUGHT TOL.	HT. (m)	SPREAD (m)
<b>TREES - DECIDUOUS - LARGE GROWING SHADE TREE</b>												
AR 2	<i>Acer rubrum</i> 'Armstrong'	Armstrong Maple			WB	As shown	full vigorous specimen	Cultivar	Yes		14m	7m
CO 7	<i>Celtis occidentalis</i>	Hackberry			WB	As shown	full vigorous specimen	Yes			15m	15m
<b>SHRUBS - DECIDUOUS</b>												
CA 1	<i>Cornus sericea</i> 'Flaviramea'	Yellowtwig Dogwood	3 gal.						Yes	Yes	200cm	200cm
DI 33	<i>Dierwilla lonicera</i>	Bush Honeysuckle	3 gal.					Yes	Yes	Yes	100cm	100cm
<b>SHRUBS - EVERGREEN</b>												
JC 54	<i>Juniperus chinensis</i> 'Gold Lace'	Gold Lace Juniper	3 gal.					Yes		Yes	100cm	150cm
PM 42	<i>Pinus mugo</i> 'Slowmound'	Slowmound Mugo Pine	3 gal.					Yes		Yes	90cm	100cm
<b>PERENNIALS</b>												
agf 50	<i>Agastache foeniculum</i>	Anise Hyssop	1 gal.					Yes	Yes	Yes	100cm	70cm
aso 72	<i>Aster obovatus</i>	Sky Blue Aster	1 gal.					Yes	Yes	Yes	60cm	30cm
cov 68	<i>Coneopsis verticillata</i> 'Moonbeam'	Tweedleaf Coneopsis	1 gal.					Yes	Yes	Yes	60cm	60cm
ecp 64	<i>Echinacea purpurea</i>	Purple Coneflower	1 gal.					Yes	Yes	Yes	90cm	50cm
gem 57	<i>Geranium maculatum</i>	Wild Geranium	1 gal.					Yes	Yes	Yes	50cm	50cm
lis 32	<i>Liatris spicata</i>	Dense Blazing Star	1 gal.					Yes	Yes	Yes	80cm	40cm
sof 28	<i>Oenothera fruticosa</i> ssp. 'glauca'	Sundrapps	1 gal.					Yes	Yes	Yes	50cm	50cm
ves 42	<i>Verbena stricta</i>	Hoary Vervain	1 gal.					Yes	Yes	Yes	90cm	60cm
<b>ORNAMENTAL GRASSES</b>												
boc 10	<i>Bouteloua curtipendula</i>	Side-Oats Grama	1 gal.					Yes	Yes	Yes	40 cm	60 cm
ers 54	<i>Eragrostis spectabilis</i>	Purple Lovg grass	1 gal.					Yes	Yes	Yes	60cm	60cm
pav 58	<i>Panicum virgatum</i> 'Apache Rose'	Apache Rose Switch Grass	1 gal.					Yes	Yes	Yes	100cm	80cm
sca 45	<i>Schizachyrium scoparium</i>	Little Bluestem	1 gal.					Yes	Yes	Yes	100cm	50cm
sph 51	<i>Sporobolus heterolepis</i>	Prairie Dropseed	1 gal.					Yes	Yes	Yes	60 cm	40 cm

PLANT LIST

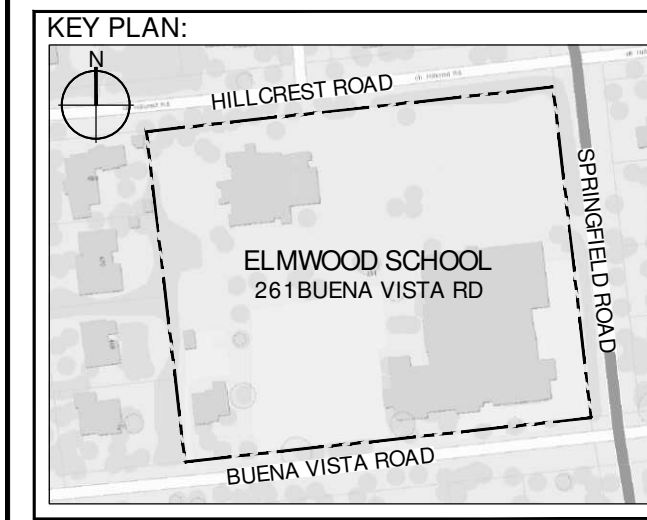

- LEGEND**
- EXISTING TREES TO REMAIN
  - EXISTING TREE TO BE REMOVED
  - PROPOSED TREE
  - PROPOSED SHRUBS
  - MIXED PERENNIALS
  - SOD

**NOT FOR CONSTRUCTION**

OWNER: ELMWOOD SCHOOL  
 ARCHITECT: FAYROW PARTNERS  
 STRUCTURAL ENGINEER: LEA Consulting Ltd.  
 M/E ENGINEER: WSP  
 CIVIL ENGINEER: MSP  
 GEOTECHNICAL ENGINEER: TERRAFAC  
 SURVEYOR: AINIS O'BRIEN/HAN VOLLEBROEK  
 SUBSURFACE UTILITY SURVEYOR: T2 UTILITY ENGINEERS

PROGRESS PLOT  
 01 2025.06.11 ISSUED FOR SPA SUBMISSION  
 DATE: 2025.06.11  
 ISSUE / REVISION BY: [Signature]

GENERAL NOTES:  
 THIS DRAWING, AS AN INSTRUMENT OF SERVICE, IS PROVIDED BY AND IS THE PROPERTY OF QUINN DESIGN ASSOCIATES INC. THE CONTRACTOR MUST VERIFY AND ACCEPT RESPONSIBILITY FOR ALL DIMENSIONS AND CONDITIONS ON SITE AND MUST NOTIFY QUINN DESIGN ASSOCIATES INC. OF ANY VARIATIONS FROM THE DRAWINGS.  
 QUINN DESIGN ASSOCIATES INC. IS NOT RESPONSIBLE FOR THE ACCURACY OF SURVEY, STRUCTURAL, MECHANICAL, ELECTRICAL, E.T.C. ENGINEERING INFORMATION SHOWN ON THIS DRAWING.  
 REFER TO THE APPROPRIATE ENGINEERING DRAWINGS BEFORE PROCEEDING WITH WORK.  
 ALL CONSTRUCTION AND WORK SHALL BE CARRIED OUT IN ACCORDANCE WITH ALL BY-LAWS AND CODES HAVING JURISDICTION OVER THE CONSTRUCTION SITE.  
 THE DESIGN AND CONTRACT DRAWINGS ARE THE COPYRIGHT OF QUINN DESIGN ASSOCIATES INC. AND MAY NOT BE REPRODUCED, EITHER IN WHOLE OR IN PART, WITHOUT THE WRITTEN PERMISSION OF QUINN DESIGN ASSOCIATES INC.  
 THIS DRAWING IS NOT TO BE SCALED.

**QUINN**  
 Design Associates Inc.  
 Landscape Architects  
 28 Park Manor Drive, Toronto, ON  
 Canada, M8S 5C7 1 416 852 8700  
 quinn.ca

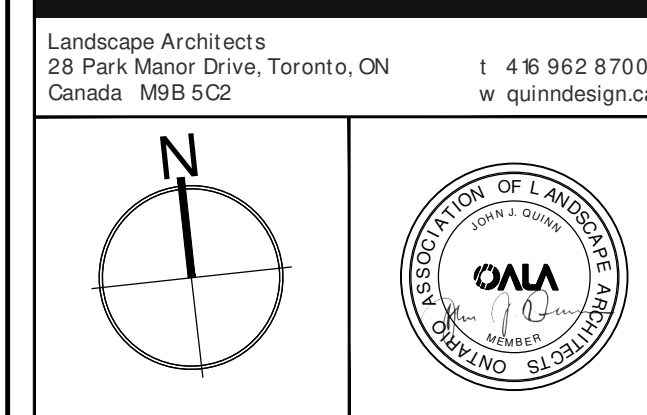

PROJECT TITLE:  
 ELMWOOD SCHOOL  
 SENIOR SCHOOL ADDITION  
 261 BUENA VISTA RD., OTTAWA, ON

SHEET TITLE:  
**PLANTING PLAN AND ENLARGEMENTS**  
 DRAWN BY: BS SCALE: AS NOTED  
 CHECKED BY: MF SHEET NO.:  
 DATE: 2025.06.11  
 ODA FILE NO.: 25-696  
 PROJECT NO.: L2.00

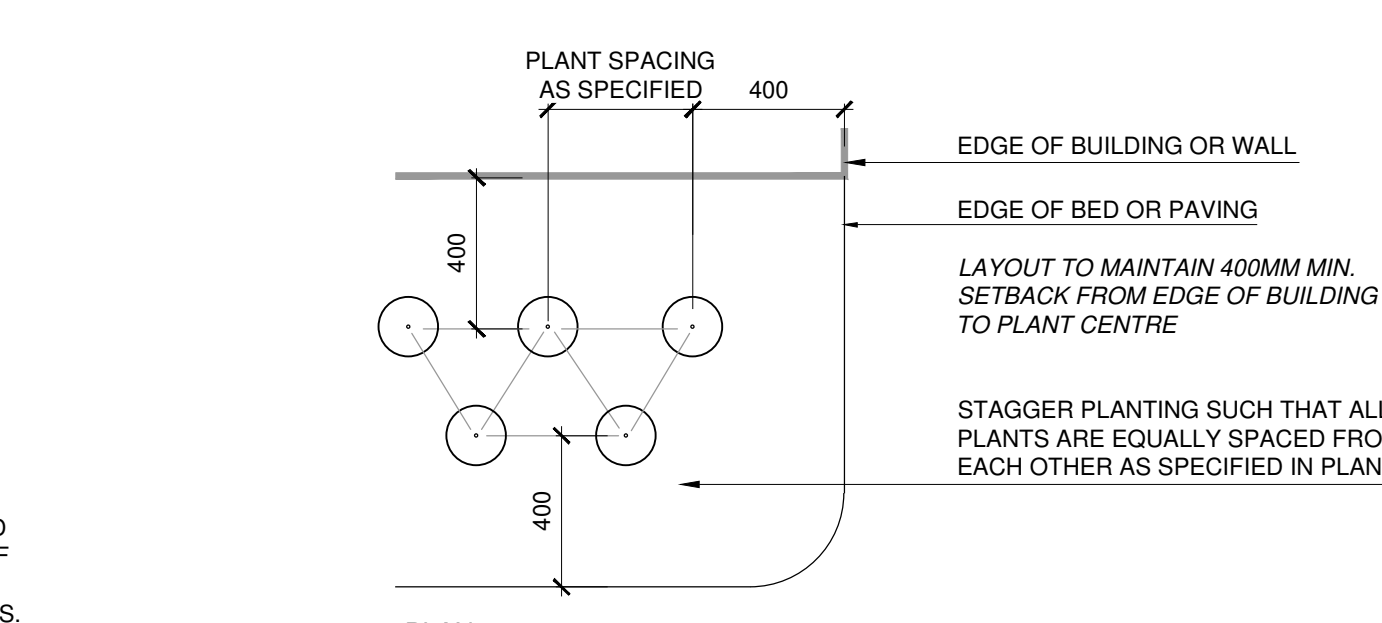
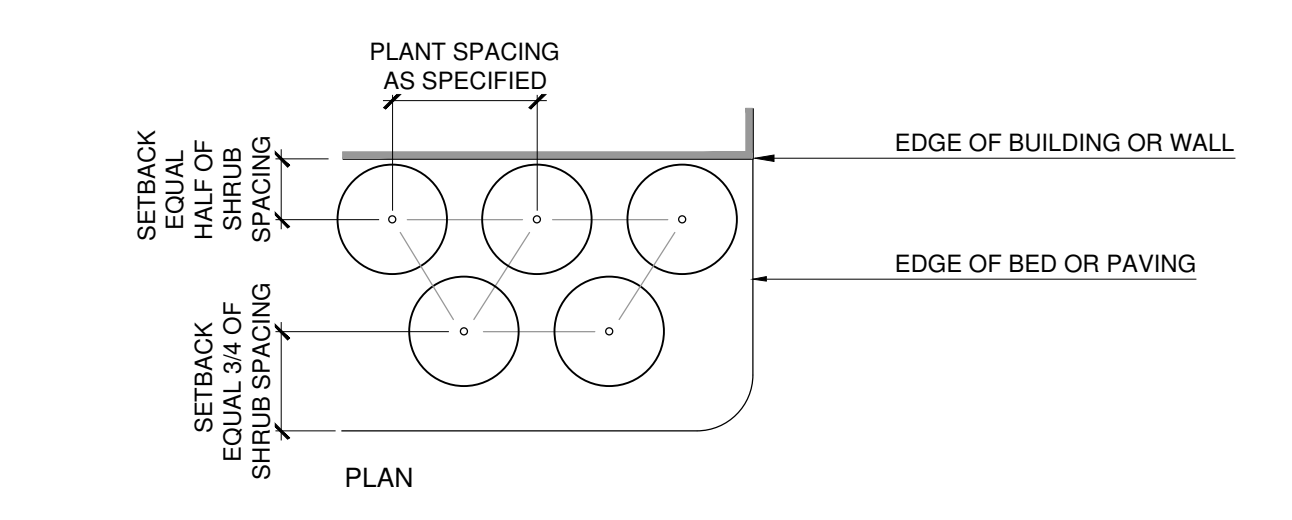
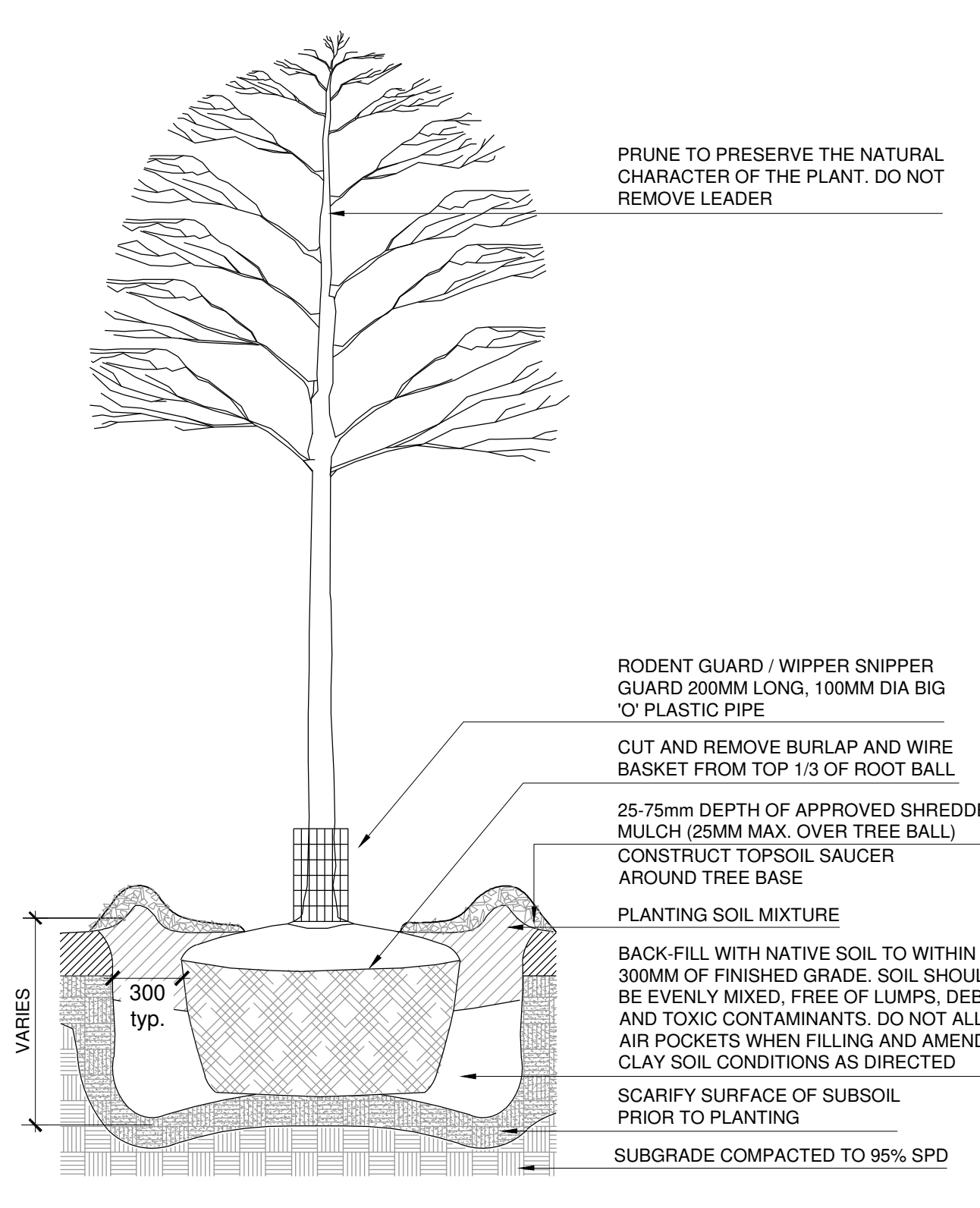
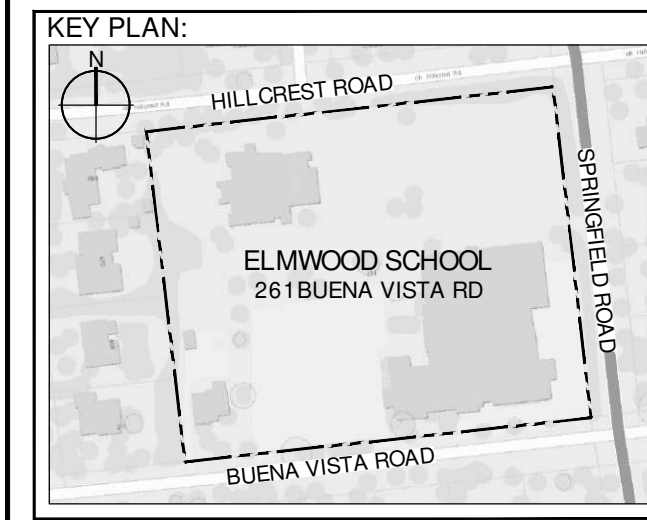

**NOTES:**  
 1. IF PLANTED IN FULL LEAF, SPRAY WITH ANTI-DESICCANT UNLESS PLANTED WITHIN 48hrs OF DIGGING  
 2. SET TREE 20mm HIGHER THAN SURROUNDING GRADE TO ALLOW FOR SETTLEMENT.  
 3. THE ABOVE DETAIL DOES NOT REPRESENT ANY PARTICULAR SPECIES.  
 4. NO TREE PITS SHALL BE LEFT OPEN OVERNIGHT.  
 5. TREE WRAP TO BE REMOVED AT TIME OF PLANTING.  
 6. MINIMUM 1.0m DEPTH OF SOIL.

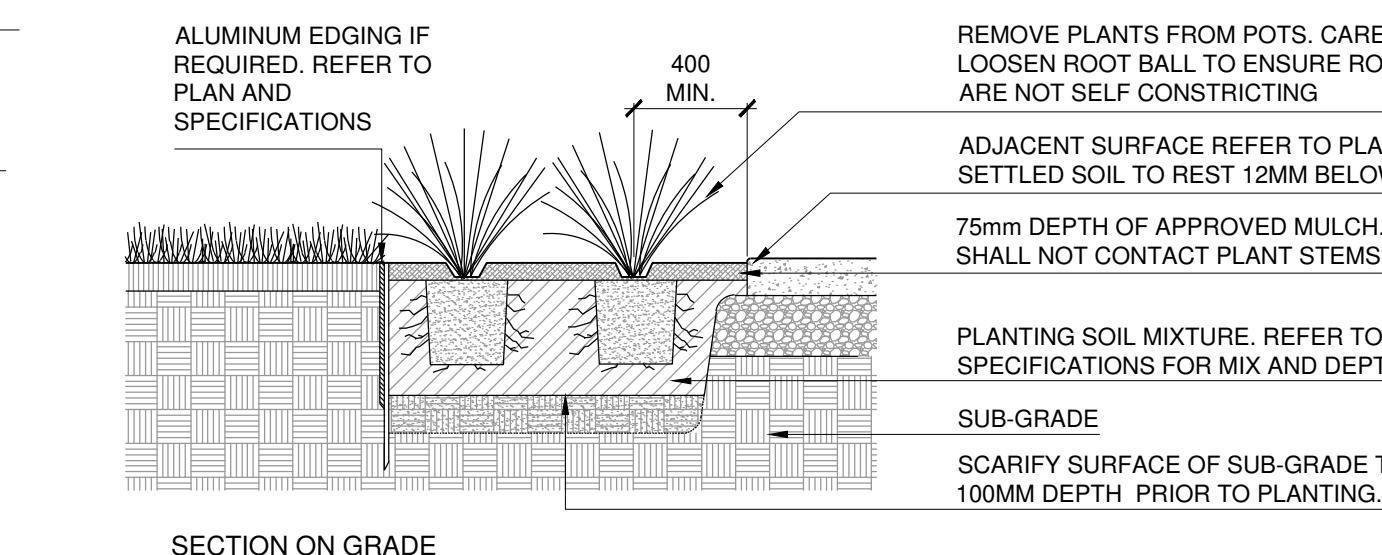
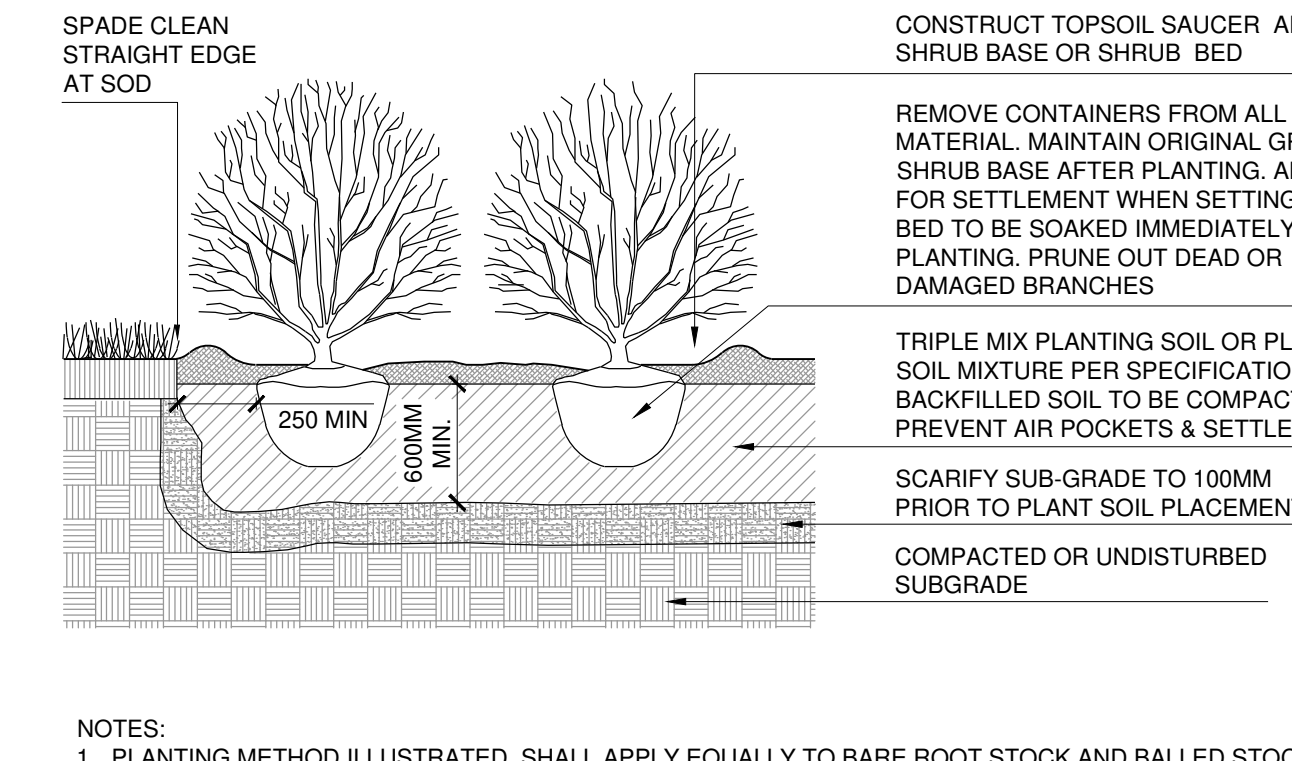

06 DECIDUOUS TREE PLANTING

07 SHRUB PLANTING

08 PERENNIAL + GRASSES

**TOPSOIL PLACEMENT & FINE GRADING:**  
 1. ENSURE THAT THE APPROVAL HAS BEEN OBTAINED FOR ROUGH GRADING PRIOR TO PROCEEDING WITH THIS SECTION OF WORK.  
 2. SCARIFY THE ROUGH GRADED AREAS TO PROVIDE A LOOSENED SURFACE IN ORDER TO ALLOW BONDING OF THE TOPSOIL.  
 3. SPREAD TOPSOIL ON THE PREPARED AND ACCEPTED ROUGH GRADED SURFACE TO A MINIMUM DEPTH OF 100 MM FIRMLY PACKED.  
 4. KEEP TOPSOIL 25 MM BELOW FINISHED GRADE FOR SODDED AREAS ELSEWHERE BRING TOPSOIL UP TO FINISHED GRADE OF ADJACENT SURFACES.  
 5. THE FINISHED SURFACE IS TO BE SMOOTH AND EVEN WITH NO RUTS, CLOSOS OR CONTAMINANTS.  
 6. REMOVE STONES IN EXCESS OF 10MM FOR AREA TO BE SEED.  
 7. HAND RAKE AREAS TO BE SEED OR SODDED AS A FINAL SURFACE PREPARATION COORDINATING THE WORK TO ENSURE THAT SEEDING OR SODDING CAN OCCUR AS SOON AS POSSIBLE AFTER RAKING HAS BEEN COMPLETED.

**SODDING:**  
 1. SCHEDULE DELIVERIES IN ORDER TO KEEP STORAGE AT JOB SITE TO A MINIMUM WITHOUT CAUSING DELAYS.  
 2. SOD:  
 2.1. SHALL BE CERTIFIED BY NURSERY GROWN SOD CONTAINING 50% MERION BLUE GRASS AND 50% KENTUCKY BLUE GRASS.  
 2.2. SHALL BE NO GREATER THAN 40MM (1 1/2") IN THICKNESS AND WITH ACCORDANCE WITH THE CLASSIFICATION OF TURF GRASS SOD FOR THE PROVINCE BY THE NATIONAL SOD GROWERS ASSOCIATION.  
 3. OBTAIN APPROVAL OF TOPSOIL GRADE AND DEPTH BEFORE STARTING SODDING. AREAS TO BE SMOOTH GRADED BY A LANDSCAPE GRADER AND HAND RAKED TO PROVIDE A COMPLETELY SMOOTH AND EVEN SURFACE.  
 4. LAY SOD IN ROWS, PERPENDICULAR TO SLOPE, SMOOTH AND EVEN WITH ADJOINING AREAS AND WITH JOINTS STAGGERED. BUTT SECTIONS CLOSELY WITHOUT OVERLAPPING OR LEAVING GAPS BETWEEN SECTIONS. CUT OUT IRREGULAR OR THIN SECTIONS WITH A SHARP KNIFE.  
 5. STAKE ALL SOD ON SLOPES GREATER THAN 15 (20%).  
 6. ROLL SOD IMMEDIATELY AFTER LAYING TO PRESS SOD FIRMLY ON TO THE SURFACE SOIL.  
 7. WATER IMMEDIATELY AFTER SOD LAYING TO OBTAIN MOISTURE PENETRATION THROUGH SOD INTO TOP 100MM (4") OF TOPSOIL, WATER BY MEANS OF A WATER TRUCK OR IF APPROVED, BY HYDRANT TO OBTAIN A COMPLETE DRENCHING. WATERING BY SMALL HOSE AND SPRINKLER IS NOT SUFFICIENT. FOR THE FIRST 30 DAYS, SOAK TO THIS DEPTH AT LEAST ONCE A WEEK. WATER IN SIMILAR MANNER THEREAFTER IF SUFFICIENT RAIN DOES NOT FALL. IN ORDER TO KEEP THE UNDERLYING SURFACE MOIST. WATERING UNTIL ACCEPTANCE OF THE SOD IS THE CONTRACTORS RESPONSIBILITY.  
 8. IMMEDIATELY CLEAN UP SOIL OR DEBRIS SPILLED ONTO PAVEMENT AND DISPOSE OF DELETERIOUS MATERIALS.  
 9. SODDED AREAS WILL BE ACCEPTED AND WARRANTY PERIOD BEGINS PROVIDED THAT:  
 9.1. SOD IS COMPLETELY GREEN  
 9.2. SODDED AREAS HAVE SEEN OUT MINIMUM OF TWO TIMES  
 9.3. SOD IS KNIT TO UNDERLYING SOIL AND CANNOT BE LIFTED WHEN TUGGED BY HAND.  
 10. MAINTENANCE:  
 10.1. IT IS THE CONTRACTORS RESPONSIBILITY TO MAINTAIN SOD UNTIL TIME OF SOD ACCEPTANCE.  
 10.2. MAINTENANCE OF SOD AFTER ACCEPTANCE IS THE RESPONSIBILITY OF OWNER.

**PLANTING:**  
 1. COORDINATE SHIPPING OF PLANTS AND EXCAVATION OF HOLES TO ENSURE MINIMUM TIME LAPSE BETWEEN DIGGING AND PLANTING.  
 2. THE BRANCHES OF TREE AND SHRUBS SECURELY AND PROTECT PLANT MATERIAL AGAINST ABRASION, EXPOSURE, AND EXTREME TEMPERATURE DURING TRANSPORT. AVOID BINDING OF PLANTING STOCK WITH ROPE OR WIRE WHICH WOULD DAMAGE BARK. BREAK BRANCHES OR DESTROY NATURAL SHAPE OF PLANT. GIVE FULL SUPPORT TO ROOT BALL OF LARGE TREES DURING LIFTING.  
 3. COVER PLANT FOLIAGE WITH TARPULIN AND PROTECT BARE ROOTS TO PREVENT LOSS OF MOISTURE DURING TRANSPORT AND STORAGE.  
 4. PROVIDE TWO YEAR WARRANTY FOR PLANT MATERIAL AS SPECIFIED ON PLANT LIST. AT END OF WARRANTY PERIOD, REMOVE TRUNK WRAPPING, TREE STAKES AND CUT WIRED AT THE END OF THE WARRANTY PERIOD. UPON REQUEST, REMOVE TRUNK WRAPPING FOR VISUAL INSPECTION AND REWRAP.  
 5. NURSERY TRADES ASSOCIATION REFER TO SIZE AND DEVELOPMENT OF PLANT MATERIAL AND ROOT BALL.  
 6.1. COMPLY WITH METRIC GUIDE - SPECIFICATION FOR NURSERY STOCK, LATEST EDITIONS OF CANADIAN NURSERY TRADES ASSOCIATION REFER TO SIZE AND DEVELOPMENT OF PLANT MATERIAL AND ROOT BALL.  
 6.2. MEASURE PLANTS WHEN BRANCHES ARE IN THEIR NATURAL POSITION. HEIGHT AND SPREAD DIMENSIONS REFER TO MAIN BODY OF PLANT AND NOT FROM BRANCH TIP TO BRANCH TIP. USE TREES AND SHRUBS OF NO. 1 GRADE.  
 7. STAKE OUT ALL TREE LOCATIONS AND PLANTING BEDS AND OBTAIN APPROVAL FROM ARCHITECT/LANDSCAPE ARCHITECT/OWNER BEFORE EXCAVATION. THE LOCATION OF TREES AND PLANTING AREAS WHERE SHOWN ON DRAWINGS IS APPROXIMATE ONLY AND MAY REQUIRE ADJUSTMENT DUE TO SITE CONDITIONS OR AS DIRECTED BY THE CONSULTANT.  
 8. PLANT ONLY UNDER CONDITIONS THAT ARE CONDUCTIVE TO HEALTH AND PHYSICAL CONDITIONS OF PLANTS.  
 9. PROVIDE PLANTING SCHEDULE, EXTENDING PLANTING OPERATIONS OVER A LONG PERIOD. USING LIMITED CREW WILL NOT BE ACCEPTED.  
 10. EXCAVATE PLANTING PITS AND BEDS TO DEPTH INDICATED ON DETAILS. FILL WITH A PLANTING MIXTURE OF ONE PART PEAT MOSS, SIX PARTS TOPSOIL WITH COMMERCIAL BONEMEAL. FOR PLANTING HOLES IN HEAVY SOILS IF NATURAL DRAINAGE DOES NOT EXIST, HAVE METHOD APPROVED.  
 11. IMMEDIATELY FOLLOWING ANY PLANTING OPERATIONS, REMOVE ALL DEBRIS AND EXCESS MATERIAL FROM SITE LEAVING THE SITE NEAT AND TIDY.  
 12. IT IS THE CONTRACTORS RESPONSIBILITY TO MAINTAIN PLANT MATERIAL FOR 30 DAYS FOLLOWING PLANTING OR UNTIL THE TIME OF FINAL ACCEPTANCE. MAINTENANCE OF PLANT MATERIAL DURING WARRANTY PERIOD IS THE OWNERS RESPONSIBILITY.  
 13. MAINTENANCE TASKS UNTIL TIME OF FINAL ACCEPTANCE TO INCLUDE ALL OF THE FOLLOWING:  
 13.1. WATERING  
 13.2. FERTILIZING  
 13.3. WEED CONTROL  
 13.4. INSECT AND FUNGUS CONTROL  
 13.5. PRUNING

**NOTES:**  
 1. REFER TO GENERAL LANDSCAPE NOTES INCLUDING:  
 1.1. TOPSOIL PLACEMENT & FINE GRADING NOTES.  
 1.2. SODDING NOTES.

09 TURF GRASS SOD

10 GENERAL PLANTING NOTES

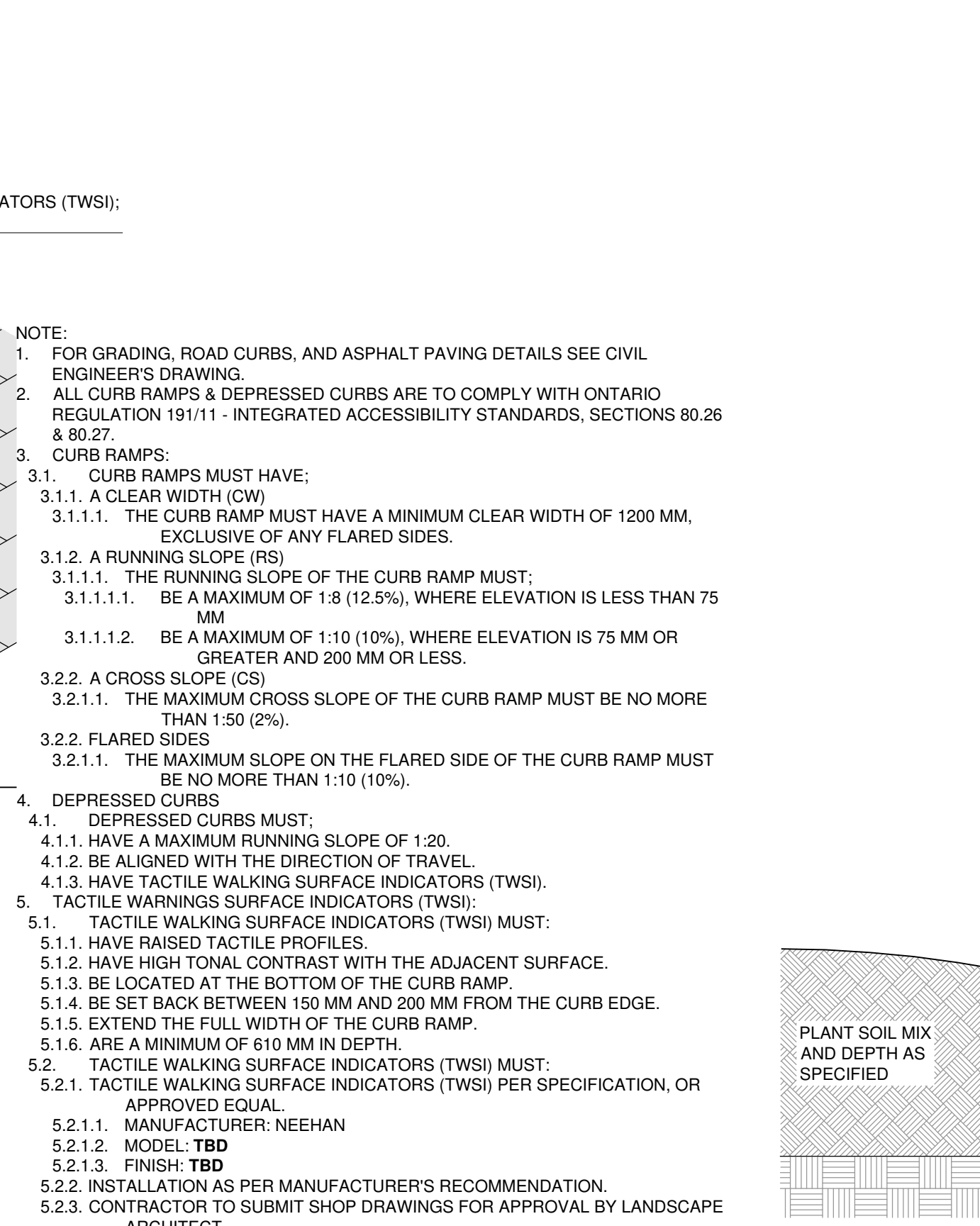
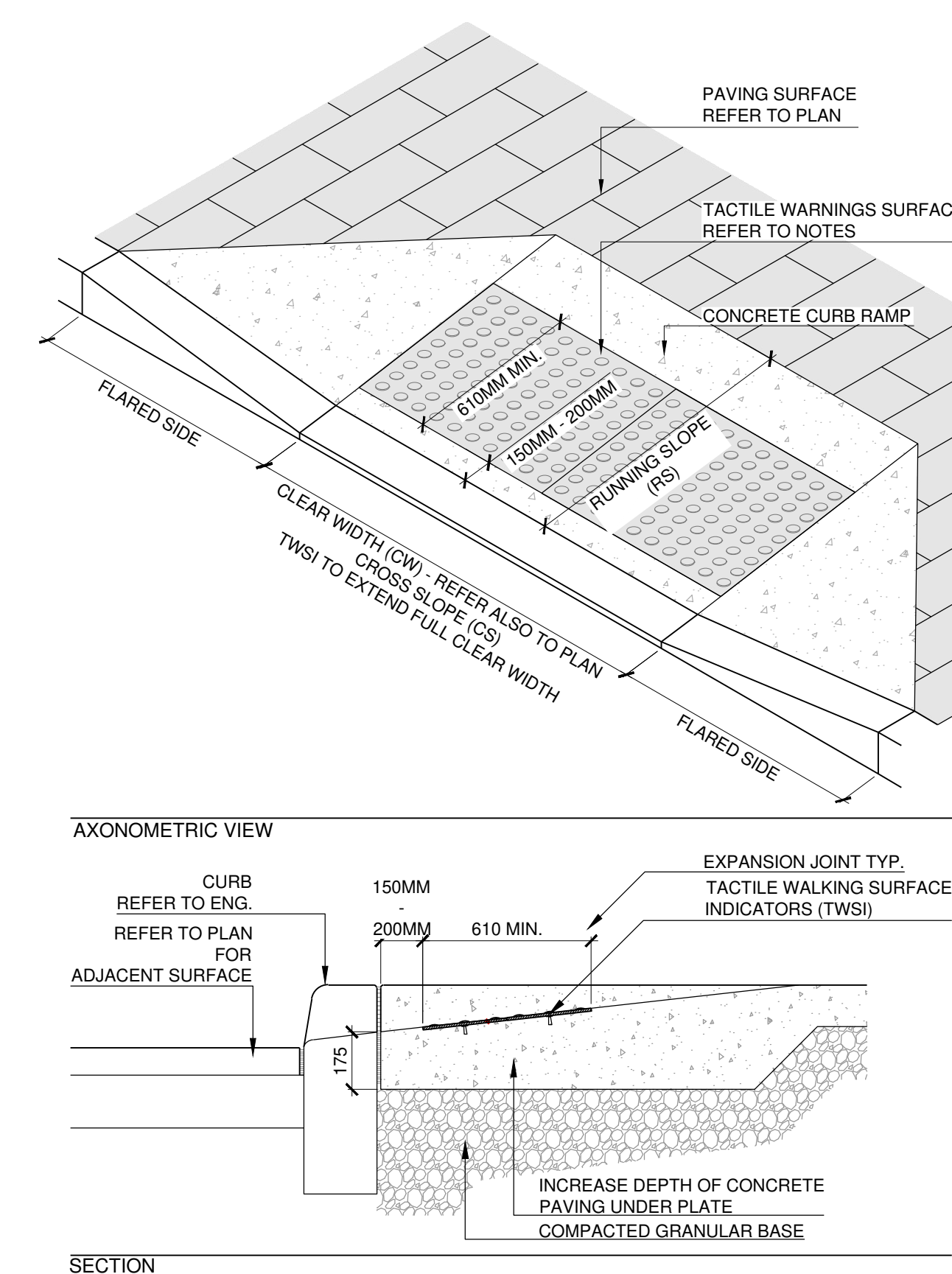
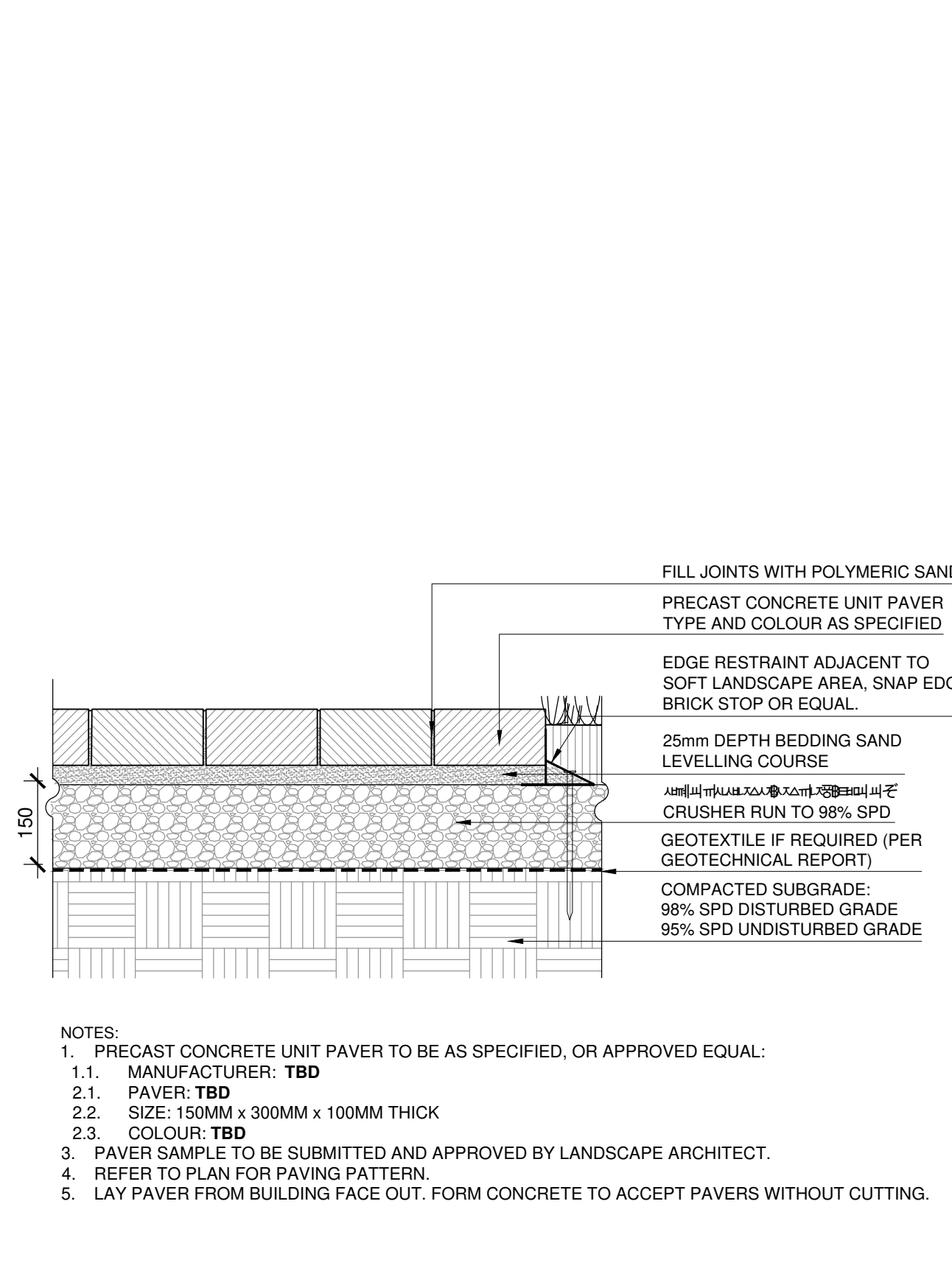

01 PRECAST CONCRETE UNIT PAVING

02 ACCESSIBLE CURB RAMP DEPRESSION DETECTABLE WARNING PLATES

03 CONCRETE PLANTER CURB

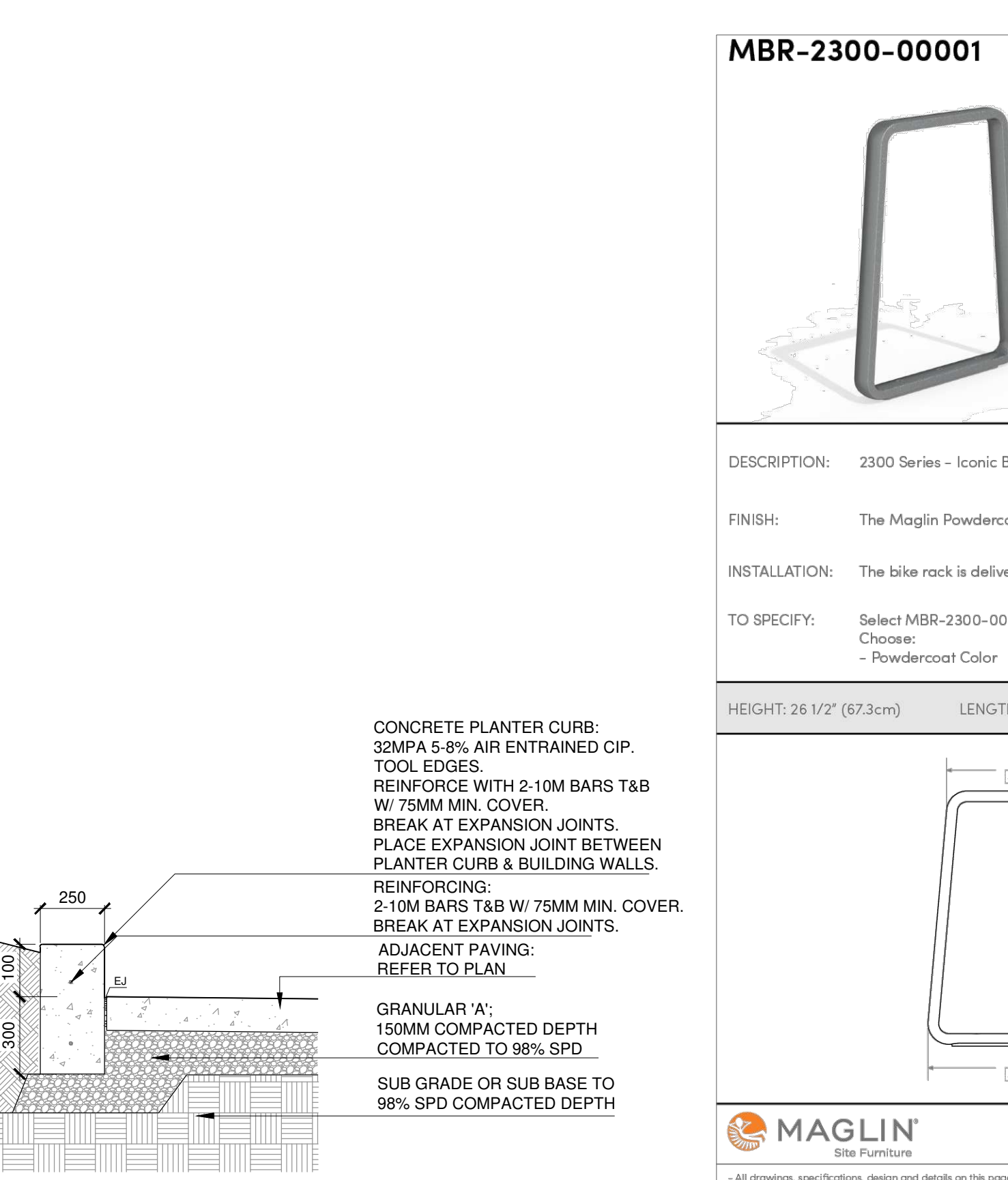

04 BICYCLE RACK

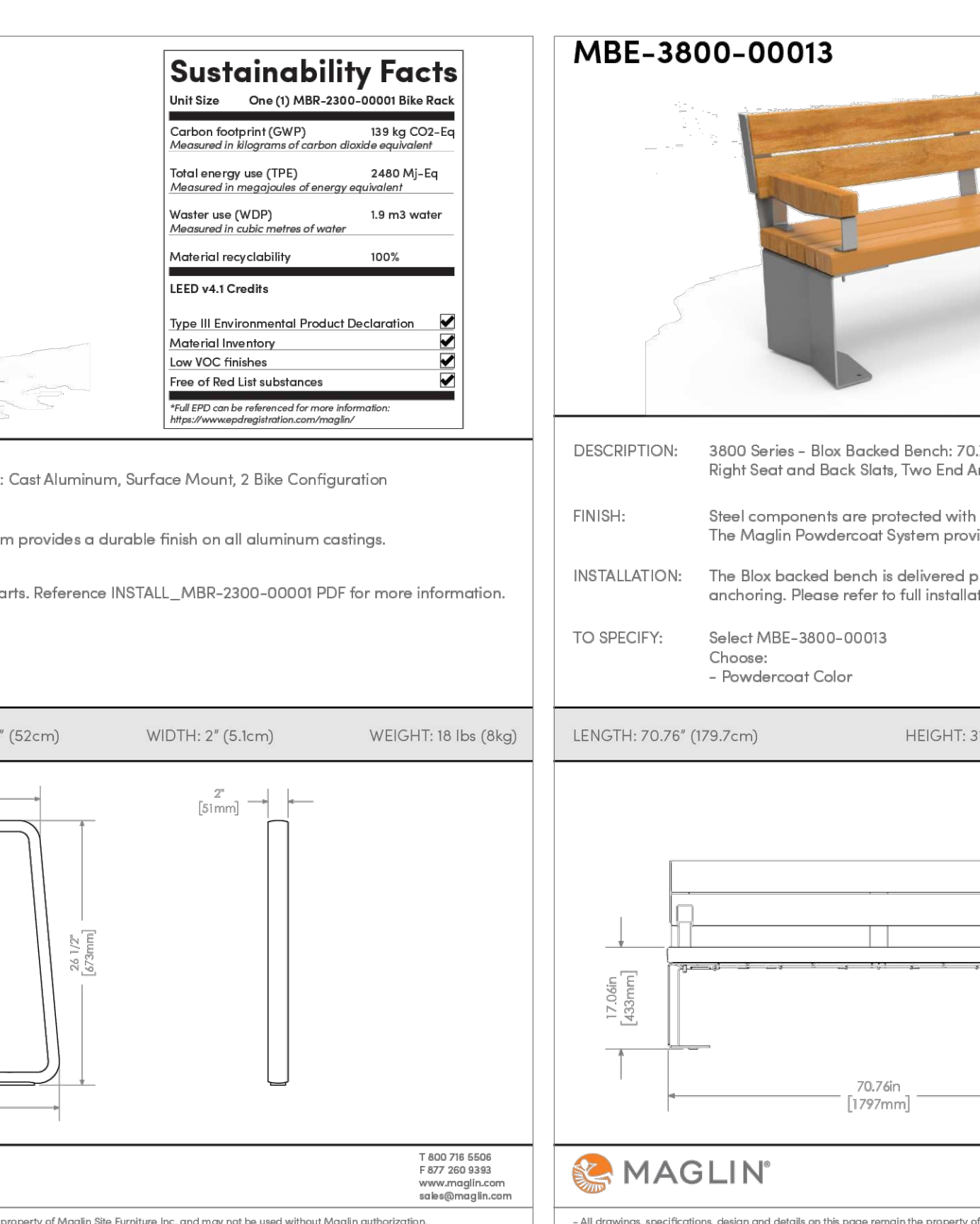

05 BENCH

DATE	DESCRIPTION	ISSUE	REVISION	BY
01	2022.03.15	ISSUED FOR SPA SUBMISSION		ME
02	2022.03.15	ISSUE / REVISION		ME
03	2022.03.15	ISSUE / REVISION		ME

**GENERAL NOTES:**  
 THIS DRAWING, AS AN INSTRUMENT OF SERVICE, IS PROVIDED BY AND IS THE PROPERTY OF QUINN DESIGN ASSOCIATES INC. THE CONTRACTOR MUST VERIFY AND ACCEPT RESPONSIBILITY FOR ALL DIMENSIONS AND COORDINATIONS ON SITE AND MUST NOTIFY QUINN DESIGN ASSOCIATES INC. OF ANY VARIATIONS FROM THE DRAWINGS.  
 QUINN DESIGN ASSOCIATES INC. IS NOT RESPONSIBLE FOR THE ACCURACY OF SURVEY, STRUCTURAL, MECHANICAL, ELECTRICAL, ETC. ENGINEERING INFORMATION PROVIDED ON THIS DRAWING. REFER TO THE APPROPRIATE ENGINEERING DRAWINGS BEFORE PROCEEDING WITH WORK.  
 ALL CONSTRUCTION AND WORK SHALL BE CARRIED OUT IN ACCORDANCE WITH ALL BY-LAWS AND CODES HAVING JURISDICTION OVER THE PROJECT SITE.  
 THE DESIGN AND CONTRACT DRAWINGS ARE THE PROPERTY OF QUINN DESIGN ASSOCIATES INC. AND MAY NOT BE REPRODUCED, COPIED, OR TRANSMITTED IN ANY FORM OR BY ANY MEANS WITHOUT THE WRITTEN PERMISSION OF QUINN DESIGN ASSOCIATES INC.  
 THIS DRAWING IS NOT TO BE SCALE.

**QUINN**  
 Design Associates Inc.  
 Landscape Architects  
 28 Park Manor Drive, Toronto, ON  
 1 416 862 8700  
 Canada, M8R 5C7

**PROJECT TITLE:**  
 ELMWOOD SCHOOL ADDITION  
 261 BUENA VISTA RD, OTTAWA, ON

**SHEET TITLE:**  
 DETAILS

**DRAWN BY:** BS **SCALE:** AS NOTED  
**CHECKED BY:** MF **SHEET NO.:**  
**DATE:** 2022.06.10  
**QDA FILE NO.:** 25-696  
**PROJECT NO.:** L3.00

**NOT FOR CONSTRUCTION**

OWNER: ELMWOOD SCHOOL  
 ARCHITECT: FAYROW PARTNERS  
 STRUCTURAL ENGINEER: LEA Consulting Ltd.  
 ME: ENGINEER: WSP  
 CIVIL ENGINEER: WSP  
 GEOTECHNICAL ENGINEER: TERRACON  
 SURVEYOR: ANNE O'SULLIVAN VOLLEBROEK  
 SUBSURFACE UTILITY SURVEYOR: T2 UTILITY ENGINEERS

**PROGRESS PHOTO**  
 2022.06.10  
 2022.06.10  
 2022.06.10

**QUINN**  
 Design Associates Inc.  
 Landscape Architects  
 28 Park Manor Drive, Toronto, ON  
 1 416 862 8700  
 Canada, M8R 5C7

**PROJECT TITLE:**  
 ELMWOOD SCHOOL ADDITION  
 261 BUENA VISTA RD, OTTAWA, ON

**SHEET TITLE:**  
 DETAILS

**DRAWN BY:** BS **SCALE:** AS NOTED  
**CHECKED BY:** MF **SHEET NO.:**  
**DATE:** 2022.06.10  
**QDA FILE NO.:** 25-696  
**PROJECT NO.:** L3.00