

**NOT FOR CONSTRUCTION**

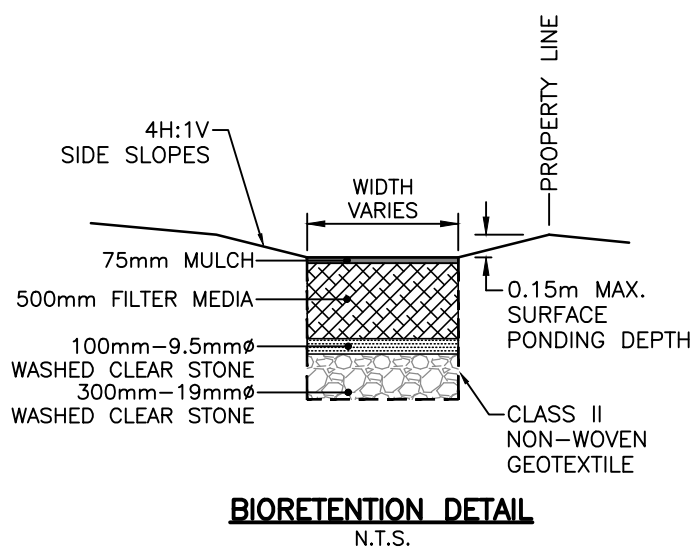

- FILTER MEDIA COMPOSITION:**
- 85 to 88% SAND
  - 8 to 12% SOIL FINES
  - 2 to 5% ORGANIC MATTER (LEAF COMPOST)
  - PHOSPHOROUS SOIL TEST INDEX (P-INDEX) BETWEEN 10 to 30 ppm
  - CATIONIC EXCHANGE CAPACITY (CEC) GREATER THAN 10 meq/100g
  - FREE OF STONES, STUMPS, ROOTS AND OTHER LARGE DEBRIS
  - pH BETWEEN 5.5 to 7.5
  - INFILTRATION RATE GREATER THAN 25 mm/hr

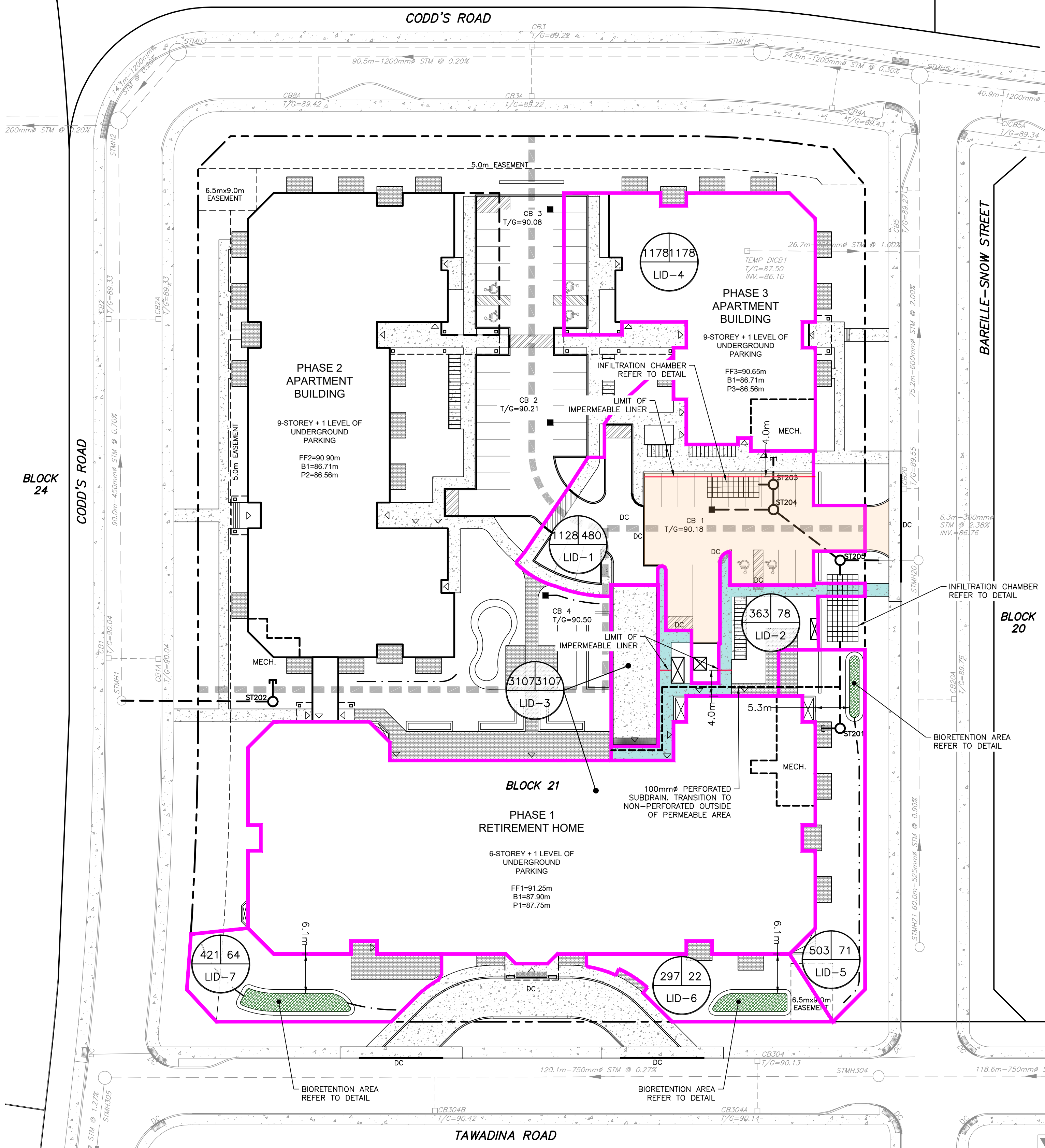
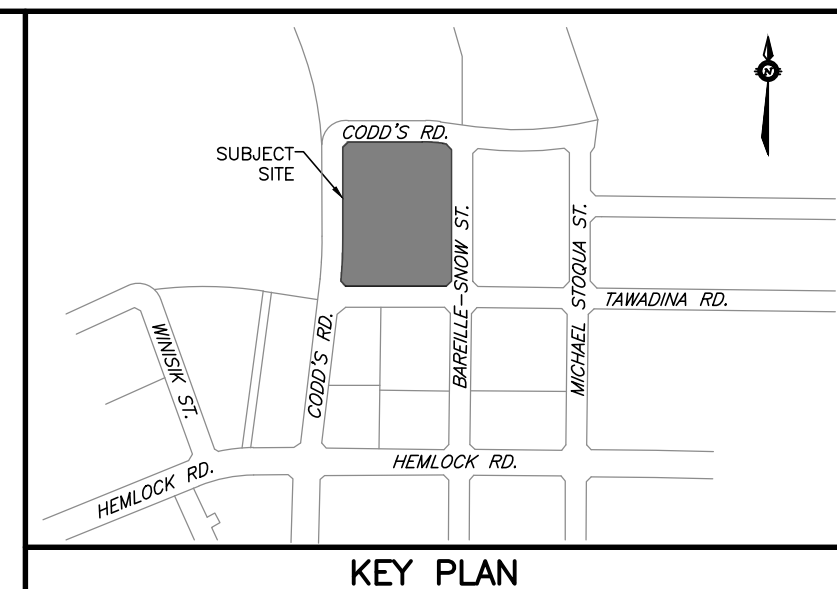
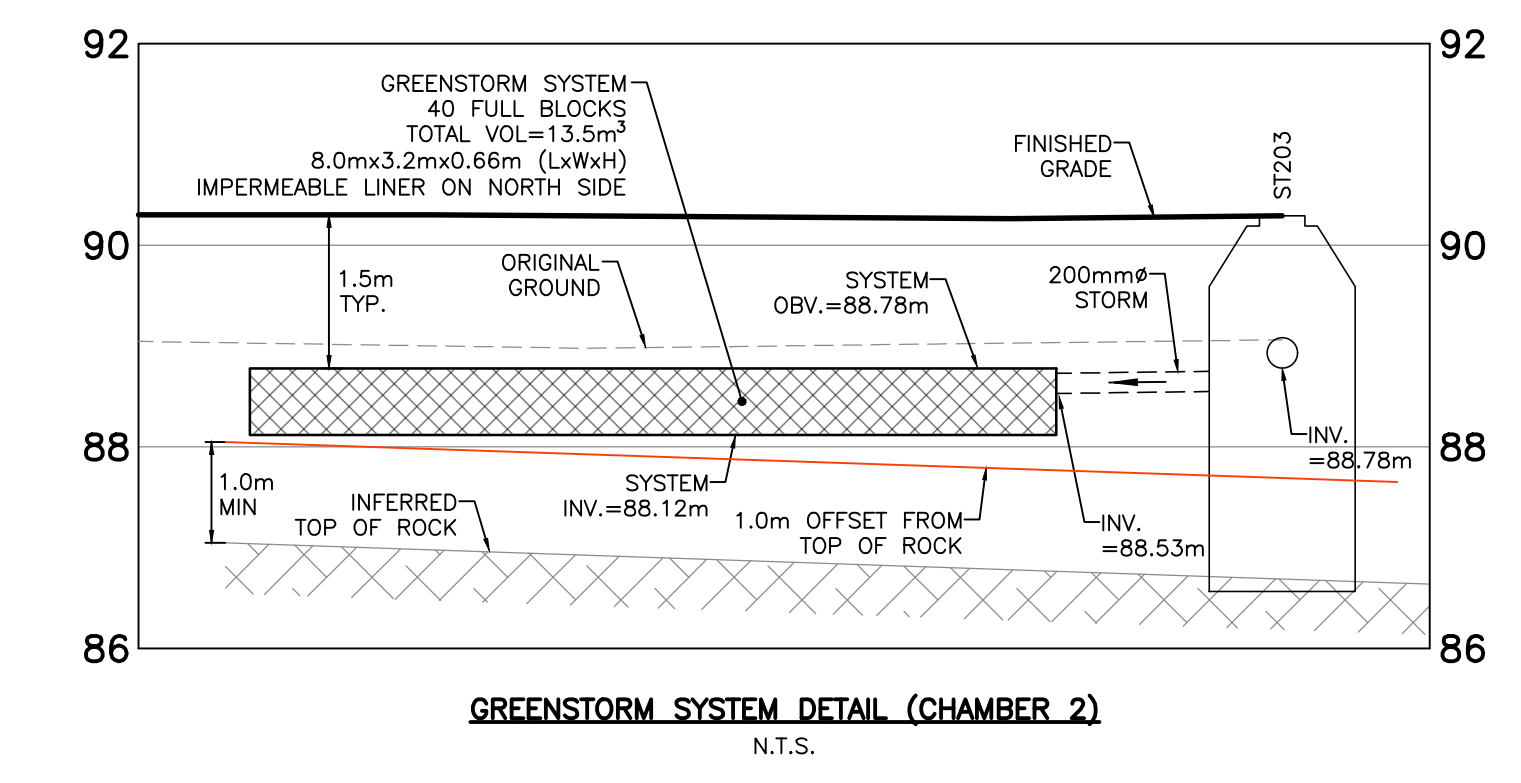
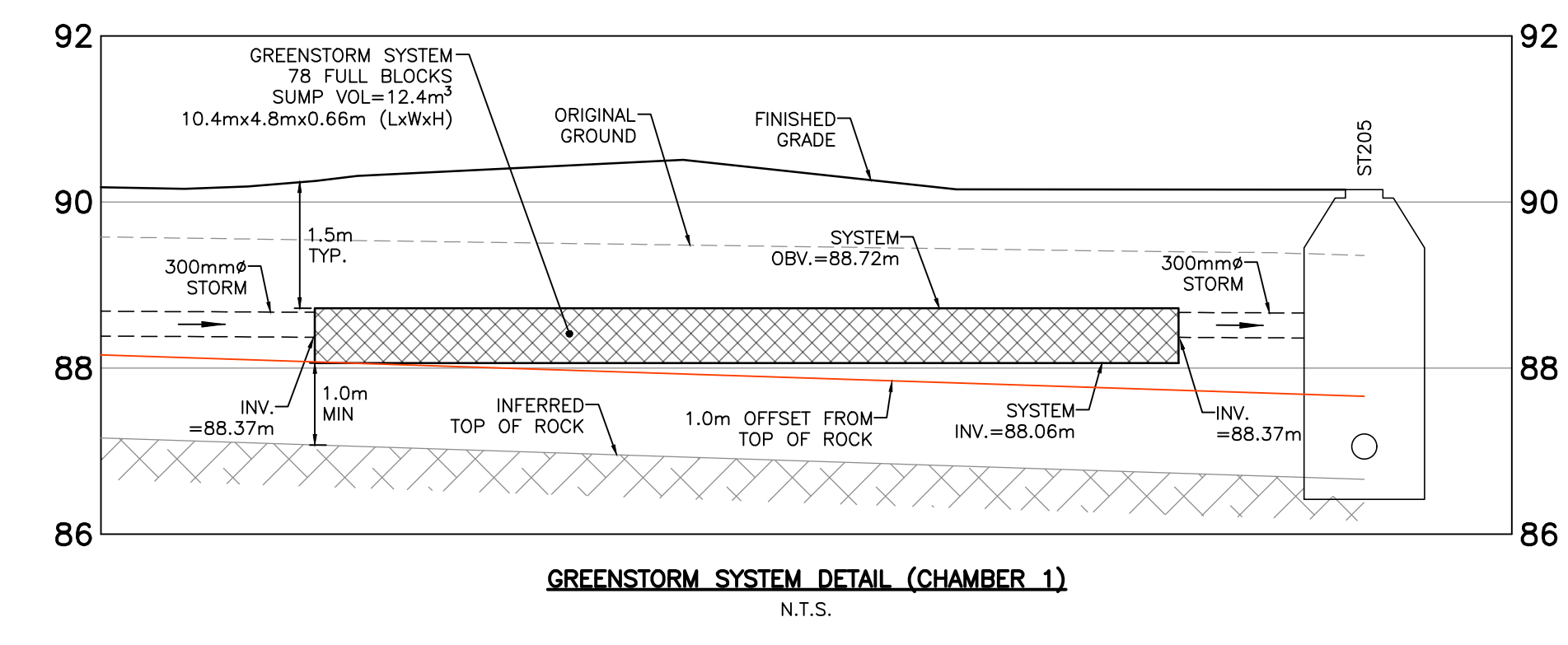
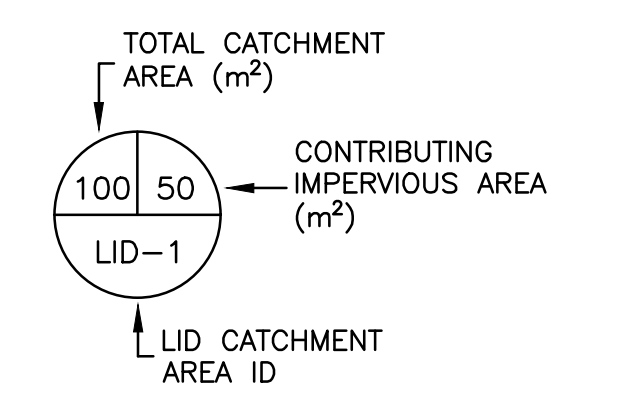
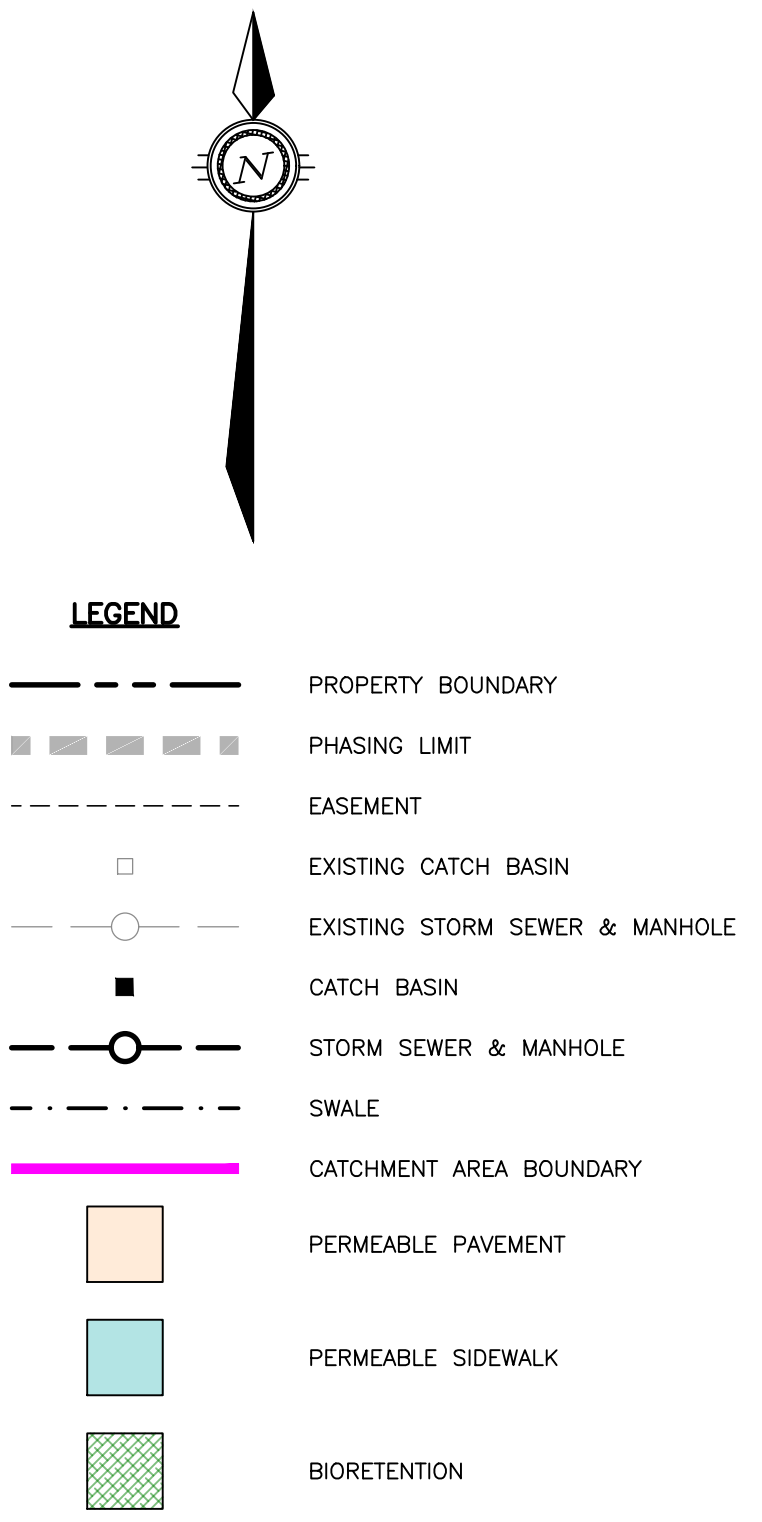
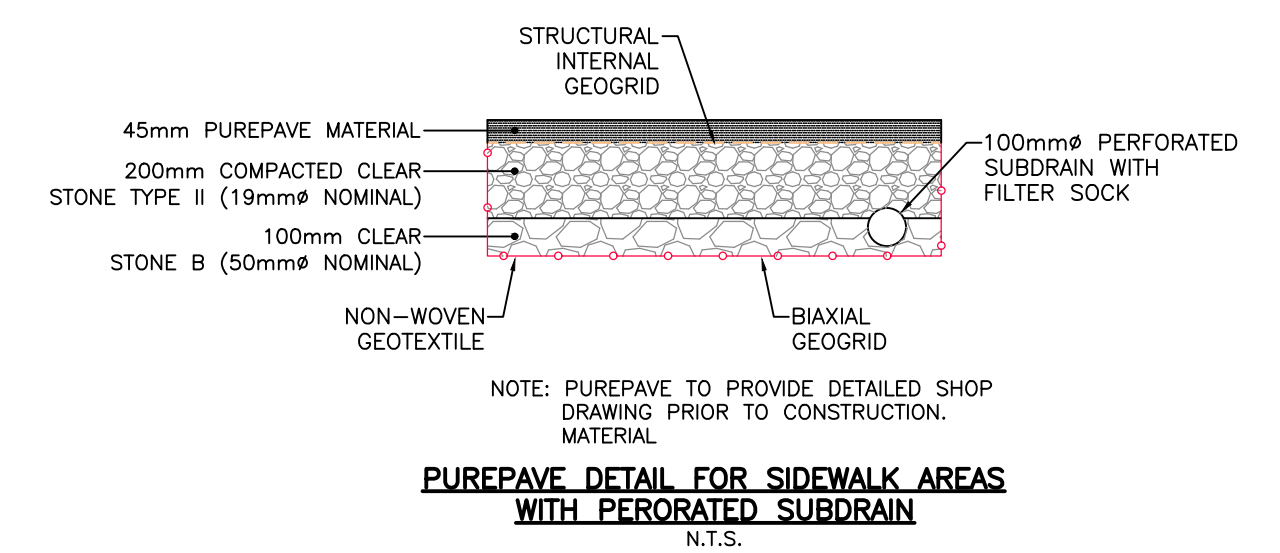
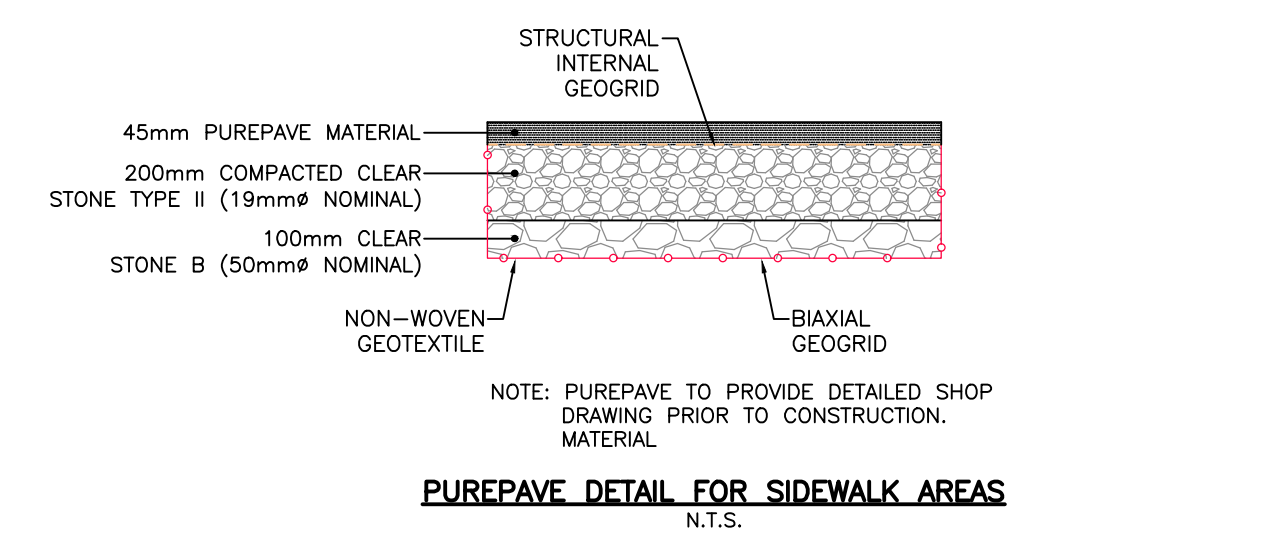
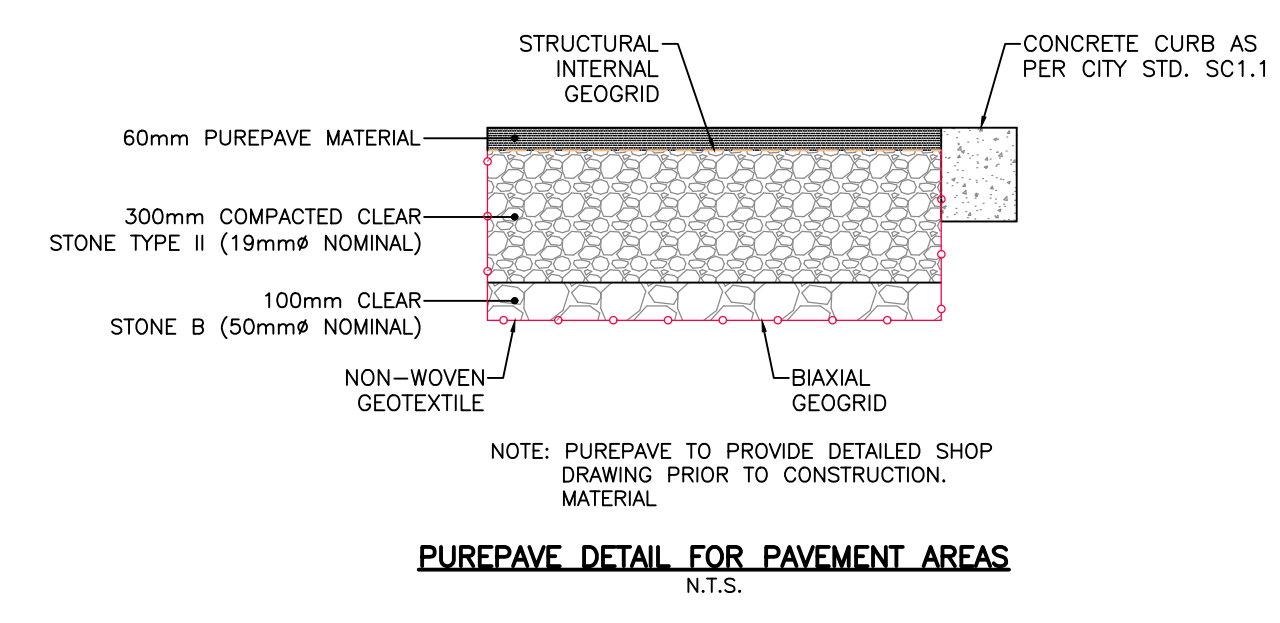

**NOTES**

THE POSITION OF ALL POLE LINES, CONDUITS, WATERMANS, SEWERS AND OTHER UNDERGROUND AND OVERGROUND UTILITIES AND STRUCTURES IS NOT NECESSARILY SHOWN ON THE CONTRACT DRAWINGS, AND WHERE SHOWN, THE ACCURACY OF THE POSITION OF SUCH UTILITIES AND STRUCTURES IS NOT GUARANTEED. BEFORE STARTING WORK, DETERMINE THE EXACT LOCATION OF ALL SUCH UTILITIES AND STRUCTURES AND ASSUME ALL LIABILITY FOR DAMAGE TO THEM.

PROPERTY BOUNDARIES ARE DERIVED FROM TOPOGRAPHIC PLAN OF PART OF WATER RIDGE DEVELOPMENT BEING SHOWN AS BLOCK 21 ON DRAFT M-PLAN LOCATED NORTH OF TAWADINA ROAD AND EAST OF CODD'S ROAD, GEOGRAPHIC TOWNSHIP OF CLOUGESTER, CITY OF OTTAWA, MONUMENT-URSO SURVEYING LTD. ELEVATIONS ARE GEODETIC AND REFERRED TO THE CANADIAN GEODETIC VERTICAL DATUM (CGVD2878).

NO.	REVISION DESCRIPTION	DATE	BY
2	REVISED PER CLC COMMENTS	27/02/26	BLM
1	ISSUED FOR REVIEW	16/01/26	BLM

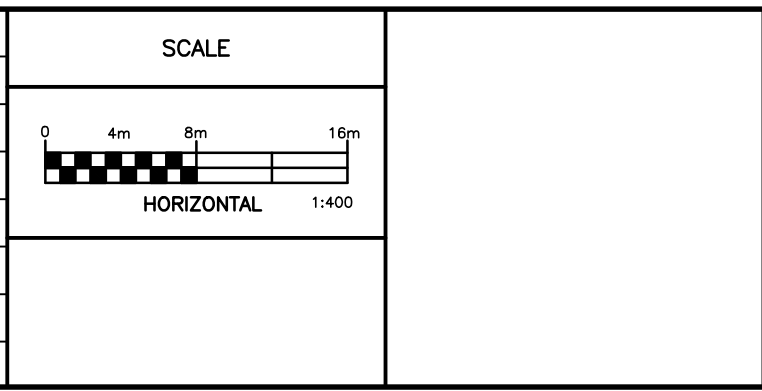

**Robinson Land Development**

2936 Baseline Road  
Suite 200  
Ottawa, ON K2H 1B3  
(613) 592-6060 rcii.com

DESIGN	BLM
CHECKED	SG
DRAWN	BLM
CHECKED	SG
APPROVED	BLM

**WATERIDGE LIFESTYLES LTD.**

**WATERIDGE VILLAGE**  
**BLOCK 21**  
**CITY OF OTTAWA, ON**

**LID DRAINAGE AREA PLAN & DETAILS**

PROJECT No.	25117
SURVEY MONUMENT-URSO SURVEYING LTD.	
DATED	FEBRUARY 2026
DWG. No.	25117-LID1