

Preliminary Construction Management Plan

Project Location: 200 Codd's Road
Block 21 on a Draft Approved Plan of Subdivision

Applicant: Wateridge Lifestyles Ltd.
1505 Carling Avenue, Ottawa, Ontario, K1Z 7L9
(Agreement of Purchase and Sale with Canada Lands Company)

Applicant's Agent: Bridgette Alchawa (Keeper Co.)

Application Submission Checklist

- Q: Will construction require the temporary detour of a bus route?
A: **No. A temporary detour of a bus route is not required.**
- Q: Will this work block a bike lane?
A: **No. The proposed work will not block any bike lanes.**
- Q: Will this work block a sidewalk?
A: **Yes. It is anticipated that a sidewalk closure may be required.**
- Q: Will this work require a lane of traffic to be closed?
A: **No. The proposed work will not involve any lane closures.**
- Q: Will this work require a road closure?
A: **No. The proposed work will not require a road closure.**



Signature of Authorized Representative of the Applicant

Date: January 15, 2026

Proposed Limit of Construction & Construction Vehicle Access Location

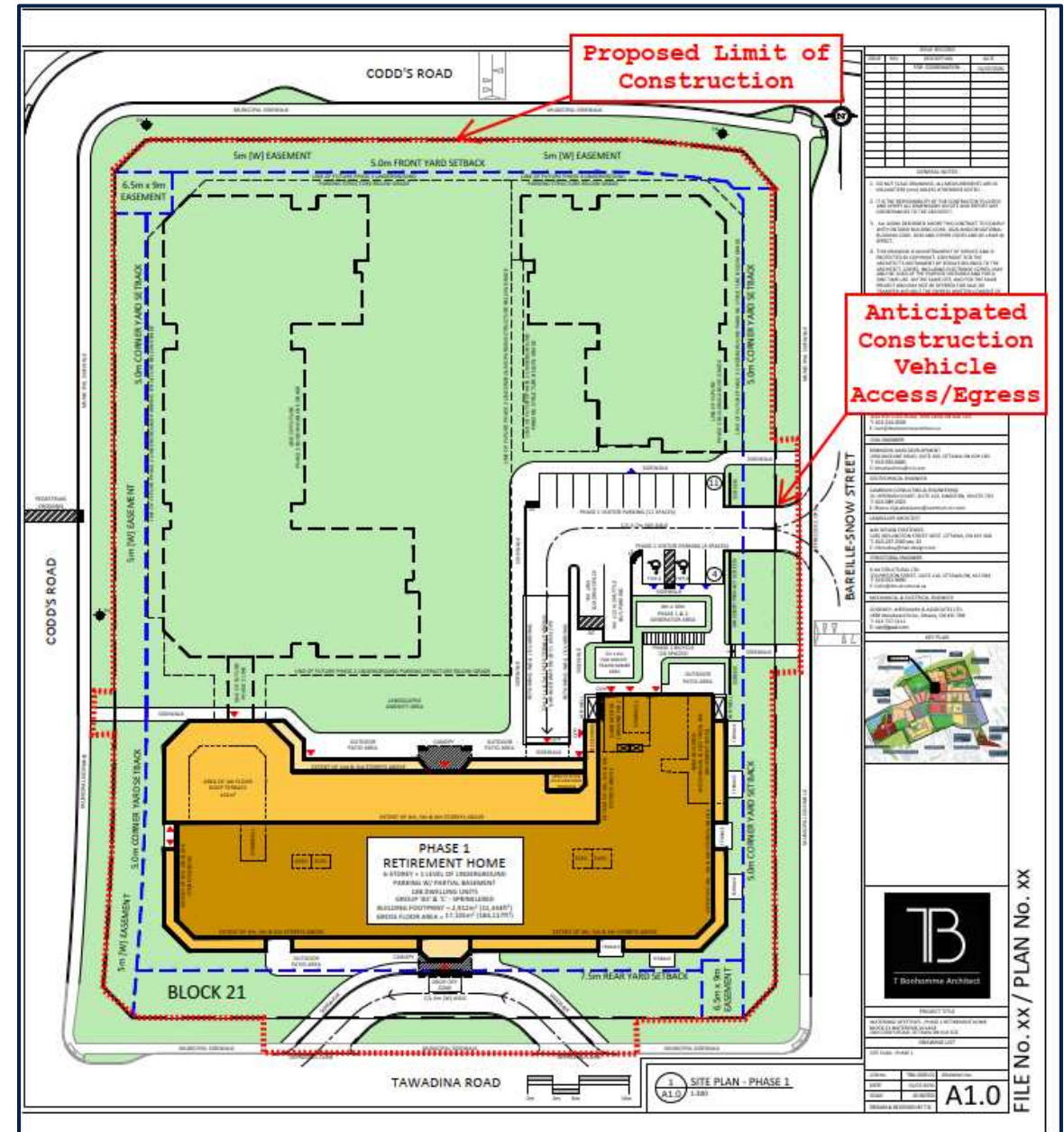

FILE No. xx / PLAN No. xx