

GENERAL NOTES:

1. THE LANDSCAPE PLAN WAS PREPARED IN CONJUNCTION WITH THE GEOTECHNICAL REPORT PREPARED BY CAMBIUM INC.: REPORT 24896-001 Rev.2
2. ALL EXISTING SITE INFORMATION AS PER SITE SURVEY PLAN DATED DECEMBER 20, 2024 AND PREPARED BY ANNIS O'SULLIVAN, VOLLEBEKK LTD.
3. ALL PLANT MATERIAL SHALL BE NURSERY GROWN STOCK UNLESS OTHERWISE NOTED.
4. TREES TO HAVE A MINIMUM 1800 CLEAR STEM ABOVE GRADE.
5. CONTRACTOR TO MAKE GOOD ALL EXISTING AREAS DAMAGED BY HIS WORK TO THE SATISFACTION OF THE CONTRACTOR.
6. ALL PLANT MATERIAL SHALL BE WARRANTED FOR TWO YEARS FROM THE DATE OF SUBSTANTIAL COMPLETION.
7. CONTRACTOR TO VERIFY LOCATION OF ALL SERVICES PRIOR TO ANY EXCAVATION.
8. ANY PROPOSED SUBSTITUTIONS OF PLANT SPECIES SHALL BE MADE WITH PLANTS OF EQUIVALENT OVERALL FORM, HEIGHT, BRANCHING HABIT, FLOWER, LEAF, COLOR, FRUIT AND CULTURE AND ONLY AFTER APPROVAL OF THE LANDSCAPE ARCHITECT.

CANOPY COVER DIAGRAM (1:800)

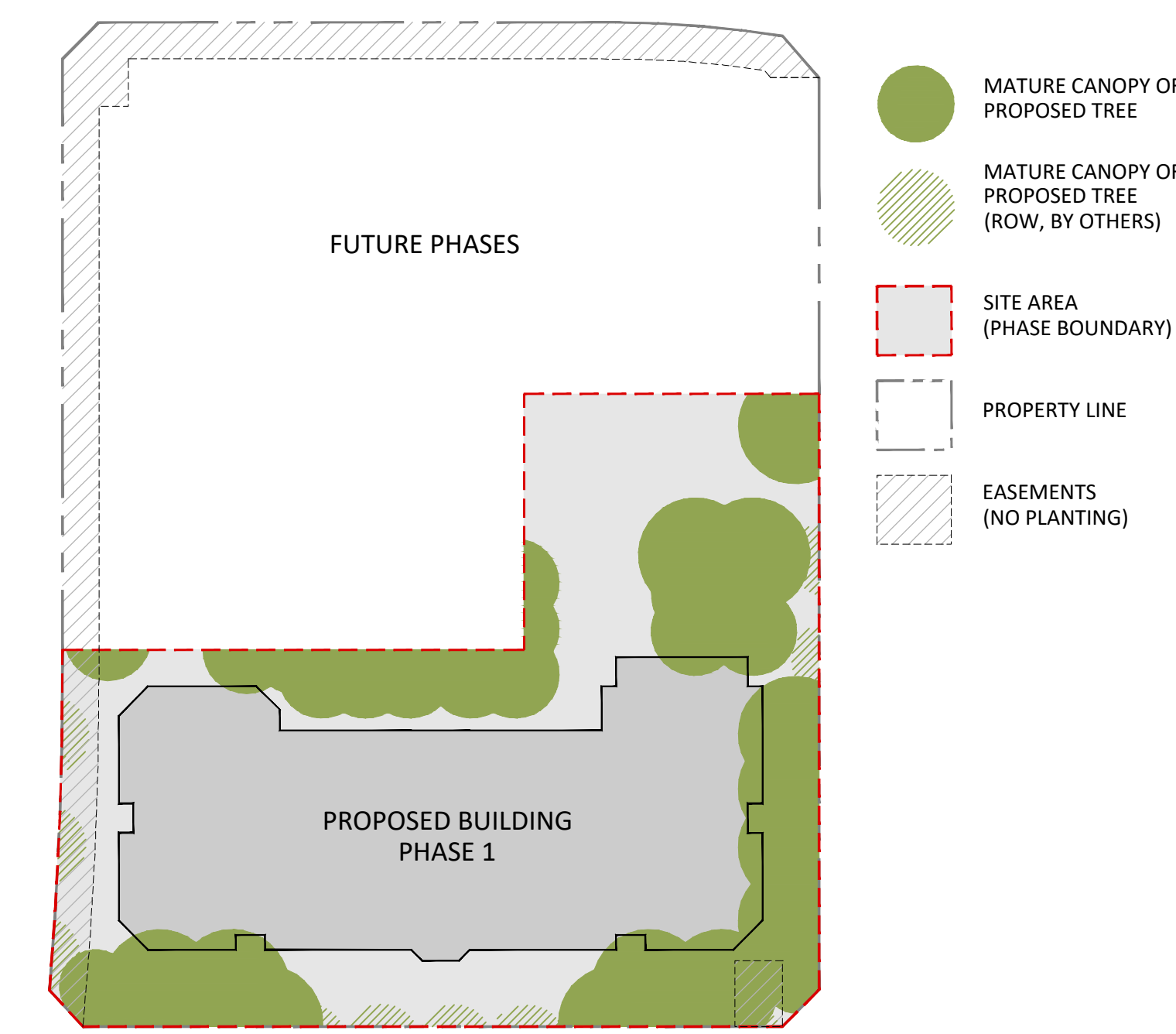

CANOPY COVER LEGEND

- MATURE CANOPY OF PROPOSED TREE
- MATURE CANOPY OF PROPOSED TREE (ROW, BY OTHERS)
- SITE AREA (PHASE BOUNDARY)
- PROPERTY LINE
- EASEMENTS (NO PLANTING)

CANOPY COVER CALCULATIONS

TREE TYPE/SIZE	CROWN AREA** PER TREE STANDARD RANGE (m ²)	AVERAGE CROWN AREA PER TREE USED FOR CALC. (m ²)	SITE CANOPY COVER
LARGE (17)	135-250*	192	2,219.41m ² (ACCOUNTS FOR OVERLAP)
MEDIUM (16)	35-135*	85	
SMALL (0)	5-35*	20	
CONIFER (2)	45-96*	70	
PROPOSED ROW TREE CANOPY, BY OTHERS			180.61m ² (ACCOUNTS FOR OVERLAP)
SITE AREA			6,747m ²
TOTAL CANOPY COVER			35.57%

*RANGE OF CROWN AREAS IS IN ACCORDANCE WITH PROPOSED TREES SPECIES
 **CROWN AREAS ARE ACCORDING TO THE AVERAGE MATURE CANOPY SIZE OF THE RESPECTIVE SPECIES. CANOPY SIZING HAS BEEN DETERMINED IN REFERENCE TO VARIOUS ARBORICULTURAL AND BOTANICAL SOURCES, SUCH AS: ONTARIO MINISTRY OF NATURAL RESOURCES & FORESTRY (OMRF); US FOREST SERVICE; FARRAR, J.L. TREES IN CANADA. UNIVERSITY OF GUELPH ARBORETUM, VARIOUS PUBLICATIONS

Contractor shall check all dimensions on the work and report any discrepancy to the Landscape Architect before proceeding. All drawings and specifications are the property of the Landscape Architect and must be returned at the completion of the work. This drawing is not to be used for construction until signed by the Landscape Architect.

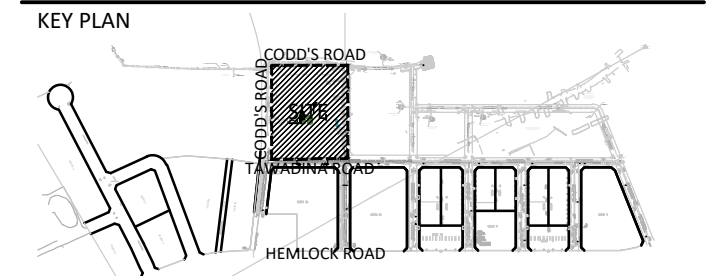

- LEGEND**
- PROPERTY LINE
 - PARKING GARAGE EXTENTS
- FENCING**
- ORNAMENTAL FENCE
 - ORNAMENTAL GATE
- PLANTING**
- LARGE DECIDUOUS TREE
 - LARGE DECIDUOUS TREE (FUTURE)
 - MEDIUM DECIDUOUS TREE
 - MEDIUM DECIDUOUS TREE (FUTURE)
 - CONIFEROUS TREE
 - MULTI-STEM SHRUB
 - DECIDUOUS SHRUBS
 - PERENNIALS AND GRASSES
 - STREET TREE (BY OTHERS)
 - SODDING
 - SEEDING
 - SHRUB/PERENNIAL BEDS
 - MULCH
 - BIORETENTION AREAS
- PAVING**
- UNIT PAVERS - TYPE 1
 - UNIT PAVERS - TYPE 2
 - LIGHT DUTY CONCRETE SIDEWALK
- FURNISHINGS**
- BENCH
 - PICNIC TABLE

No.	Description	Date
5	Issued for revised SPA First Submission	26-02-27
4	Issued for SPA First Submission	26-01-15
3	Issued for Client Review	26-01-14
2	Issued for Review & Coordination	25-12-12
1	Issued for Client Review	25-11-26

OWNER/APPLICANT	SURVEYOR
WATERIDGE LIFESTYLE LTD. 1505 Carling Avenue, Ottawa ON K1Z 7J9	MONUMENT-URSO SURVEYING LTD. 1755 Woodward Drive, #200, Ottawa ON K2C 0P9
ARCHITECT	GEOTECH ENGINEER
T BORNHARDT ARCHITECT 3541 RDS Cove Road, Portland ON K0G 3V0	CAMBIUM CONSULTING & ENGINEERING 33 Inverness Court #103, Kingston ON K7K 7G3
CIVIL	STRUCTURAL ENGINEER
ROBINSON LAND DEVELOPMENT 2936 Baseline Road, Ottawa ON K7X 7G3	E+M STRUCTURAL LTD. 333 Preston Street, #110, Ottawa ON K1S 5N4
LANDSCAPE ARCHITECT	MECHANICAL & ELECTRICAL
NAK DESIGN STRATEGIES 1285 Wellington St., Ottawa ON K1Y 3A8	GOODER, WEDDOWAY & ASSOCIATES LTD. 1888 Woodward Drive, Ottawa ON K2C 3R8

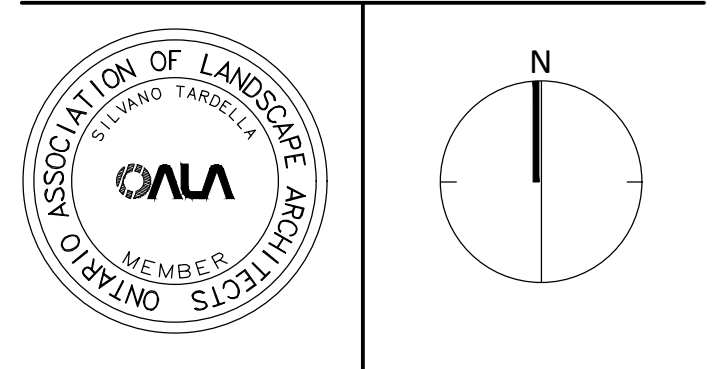

NAK design strategies

1285 WELLINGTON STREET, OTTAWA, ON K1Y 3A8 CANADA
 T 613.237.2345 NAKDESIGNSTRATEGIES.COM

WATERIDGE LIFESTYLES - PHASE 1 RETIREMENT HOME
 Block 21 Wateridge Village
 200 Codd's Road, Ottawa ON K1K 5C6

Date	2025-11-04	Sheet	L1.0
Scale	1:300	Checked	MK
Job No.	25-360	Drawn	JE