

5 TREES. +/- 25 Cubic m. Soil Available per Tree. 125 sq. m. (off Garage Roof) X 1.0 m Depth assumed = 125 Cubic m.

5 TREES. +/- 20 Cubic m. Soil Available per Tree. 200 sq. m. (on Garage Roof) X .5 m Depth assumed = 100 Cubic m.

2 TREES. +/- 15 Cubic m. Soil Available per Tree. 60 sq. m. (on Garage Roof) X .5 m Depth assumed = 30 Cubic m.

5 TREES. +/- 20 Cubic m. Soil Available per Tree. 100 sq. m. (off Garage Roof) X 1.0 m Depth assumed = 100 Cubic m.

2 STREET TREES. +/- 25 Cubic m. Soil Available per Tree. 35 sq. m. (off Garage Roof) X 1 m Depth assumed = 35 Cubic m. + 30 sq. m. (on Garage Roof) X .5 m Depth assumed = 15 Cubic m. TOTAL 50 Cubic m.

3 STREET TREES. +/- 20 Cubic m. Soil Available per Tree. 50 sq. m. (off Garage Roof) X 1 m Depth assumed = 50 Cubic m. + 20 sq. m. (on Garage Roof) X .5 m Depth assumed = 10 Cubic m. TOTAL 60 Cubic m.

**GJA Inc.**  
GNO@GJALA.COM (613) 286 5130

**CONSULTANTS SURVEY**  
ADV LIMITED  
500-14 Concession Gate K2E 756  
613 727 0850  
adv@adv.com

**ARCHITECT**  
RLA Architecture  
61 Beach Street Ottawa K1S 3J8  
613 724 9032  
info@rlaarchitecture.ca  
rla@rlaarchitecture.ca

**CIVIL**  
STANTEC  
300-1211 Oya Avenue K2C 304  
613 722 4400  
info@stantec.com  
stantec.com/en/locations/canada-locations/ottawa-office/ottawa-ottawa-ontario

**SITE LOCATION**

**SURVEY INFORMATION FROM**  
SURVEY OF REAL PROPERTY REPORT  
PART 1 Plan of  
SPLIT OF LOTS 1, 2, 3 and 4, LOT 5 and  
PART OF LANE CLOSED BY JUDGE'S ORDER  
(Instrument No. 52554)  
REGISTERED PLAN 355  
CITY OF OTTAWA

**PART OF LOTS 30**  
COMMISSION (OTTAWA FRONT)  
Geographic Township of Nepean and  
PART OF 1 FOOT RESERVE  
REGISTERED PLAN 38587  
CITY OF OTTAWA

Surveyed by Armin, O'Sullivan, Vollebæk Ltd.

Drawing Remains the Property of Copyright Reserved by GJA INC. Do Not Use or Reproduce Without Approval of Gino J. Aiello  
| PLANTING MIX TO BE APPROVED BY LANDSCAPE ARCHITECT | PLANT MATERIAL TO MEET CNLA STANDARDS/BE APPROVED BY LANDSCAPE ARCHITECT PRIOR TO PLANTING ALL MATERIALS & WORK TO BE MAINTAINED UNTIL FINAL ACCEPTANCE. INCLUDE 1 YEAR WARRANTY FROM DATE OF FINAL ACCEPTANCE | REFER TO CIVIL ENGINEER'S DRAWING FOR ELEVATIONS / GRADING |  
The Landscape Plan is to be read in conjunction with the grading, servicing, site and survey plan. All trees to be preserved on or directly adjacent to the site will be protected | Plant material size to be installed a minimum of 3.0m away from any part of any hydro transformer, 3.0m corridor between a fire hydrant and the curb, a 2.5m radius beside or behind a fire hydrant, 2.0m from any servicing/utility line or structure |

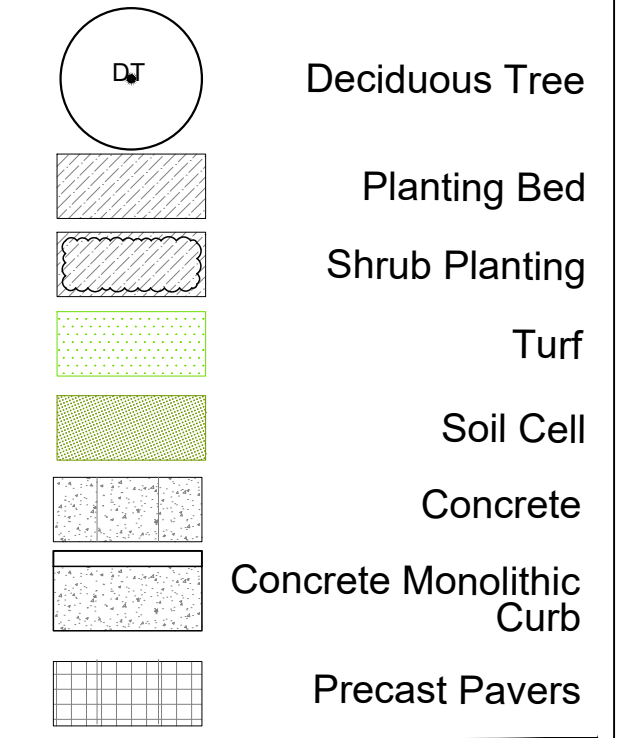

# KERR AVENUE

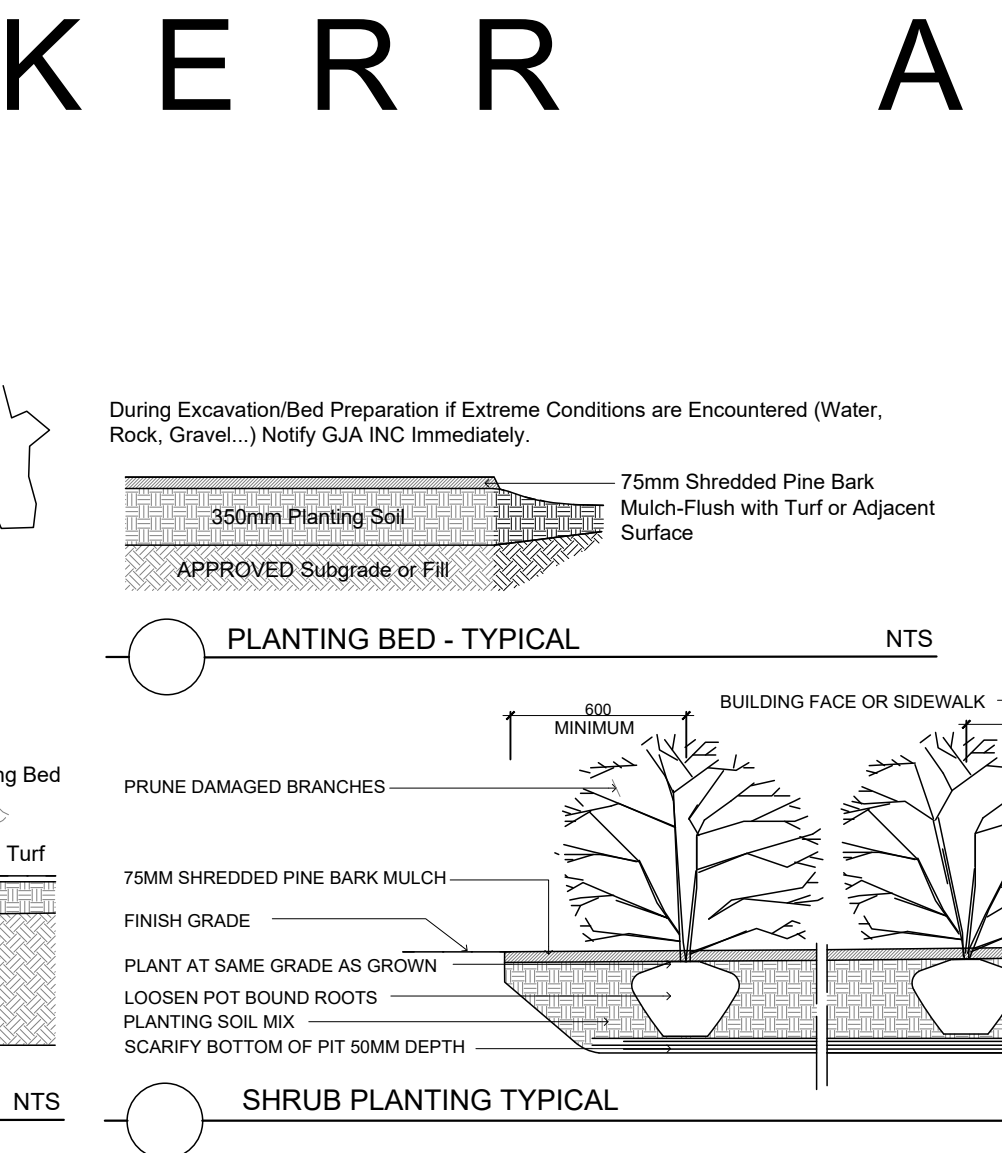
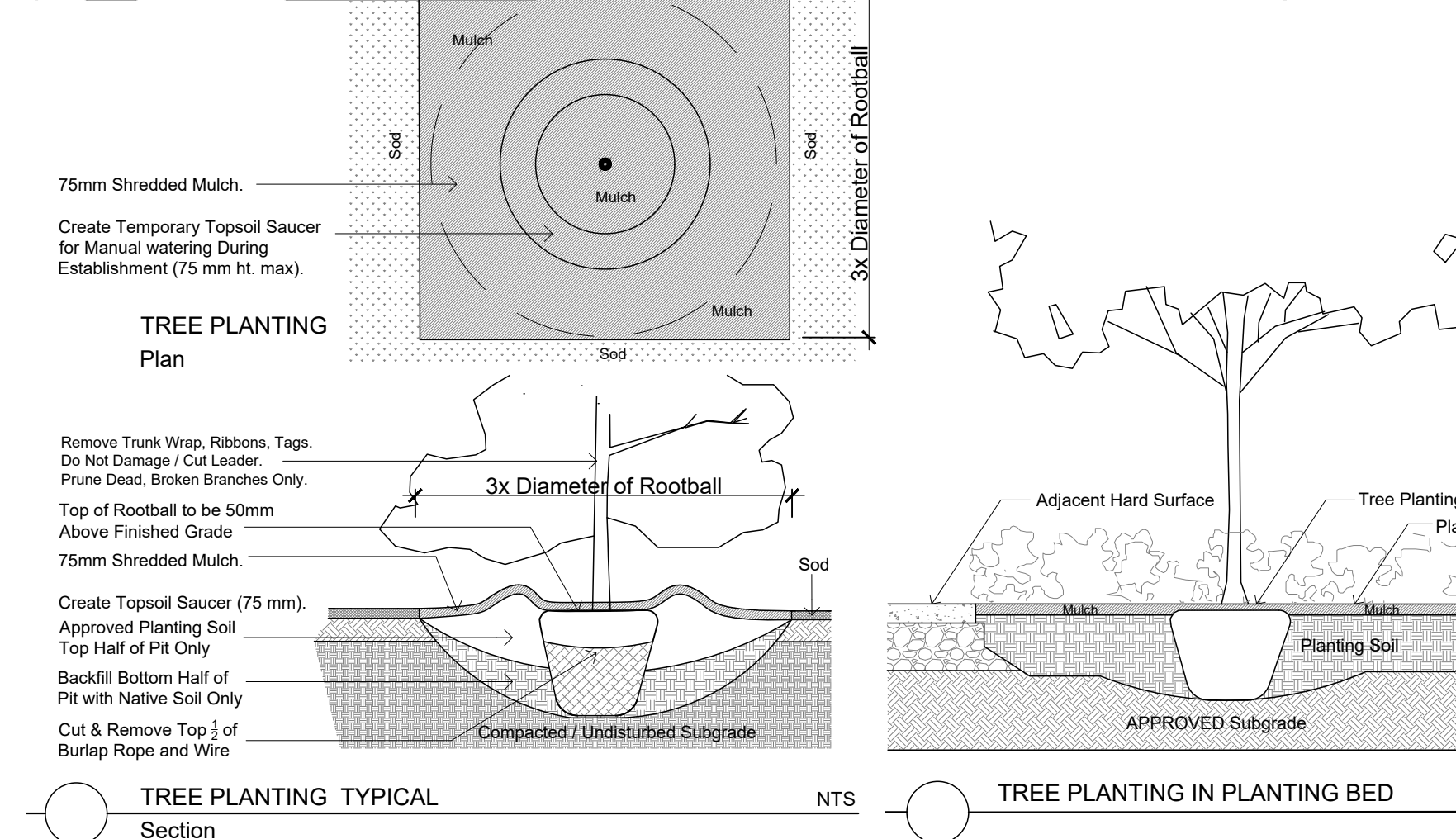

**TREE SCHEDULE - 1746 CARLING / 1755 KERR - PHASE 1 9 STOREY MULTI UNIT RESIDENTIAL BUILDING**

CODE	QTY	BOTANICAL NAME	COMMON NAME	B&B SPECIMEN	NATIVE to CANADA	FORECASTED SPREAD per City of Ottawa Ecology	Canopy Cover Contribution/Tree in Square Metres	Total Canopy Cover
AR	7	Acer rubrum	Red Maple	50mm cal	YES	10.0M	5.0M	78.5
AS	3	Acer saccharum	Sugar Maple	50mm cal	YES	14.0M	7.0M	154
BP	3	Betula papyrifera	Paper Birch	150mm cal	YES	10.0M	5.0M	78.5
CO	3	Cornus canadensis	Common Haskberry	50mm cal	YES	14.0M	7.0M	154
QM	3	Quercus macrocarpa	Bur Oak	50mm cal	YES	14.0M	7.0M	154
QR	3	Quercus rubra	Red Oak	50mm cal	YES	14.0M	7.0M	154
<b>TOTAL</b>	<b>22</b>	<b>TOTAL FORECASTED CANOPY COVER IN SQUARE METRES (based on Calculations per Tree as shown above)</b>						<b>2633</b>
<b>TOTAL FORECASTED CANOPY COVER IN SQUARE METRES ADJUSTED FOR OVERLAP WITH OTHER TREES, BUILDINGS LOT LINES, ETC</b>								<b>1550</b>
<b>SITE AREA in Square Metres - Phase 1 Only</b>								<b>2750</b>
<b>TOTAL FORECASTED CANOPY COVER as Percentage of Site Area</b>								<b>56.36%</b>

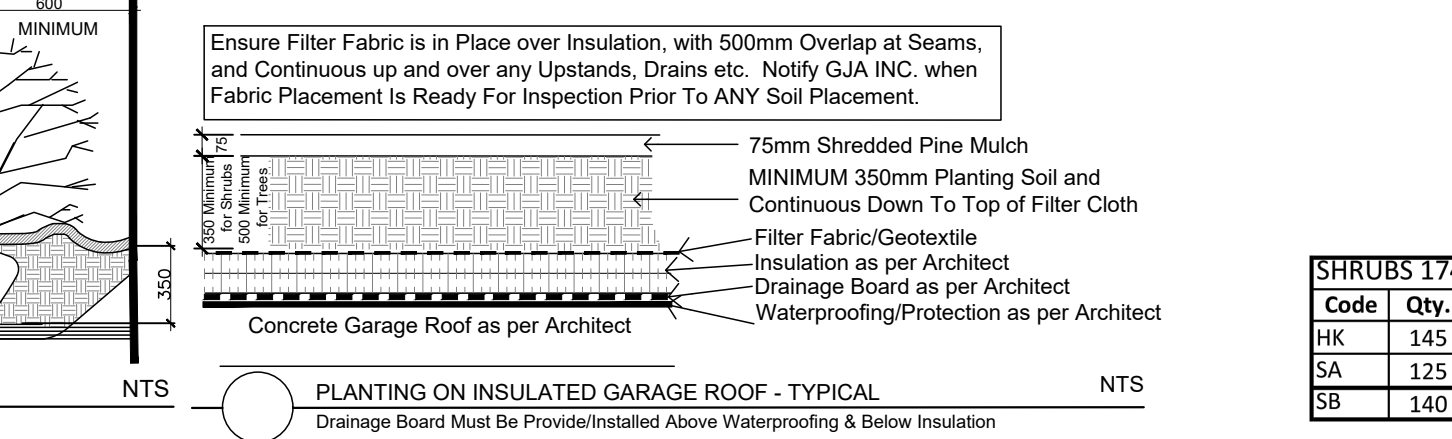

**SHRUBS 1746 CARLING 1755 KERR**

Code	Qty.	Botanical Name	Common Name	Size	Condition	Condition
HK	145	Hypericum kalmianum	Kalm St. John's Wort	30cm	Pot	YES
SA	125	Spiraea alba	Meadowsweet	60cm	Pot	YES
SB	140	Spiraea bumalda 'Dart's Red'	Dart's Red Spirea	Pot	Pot	

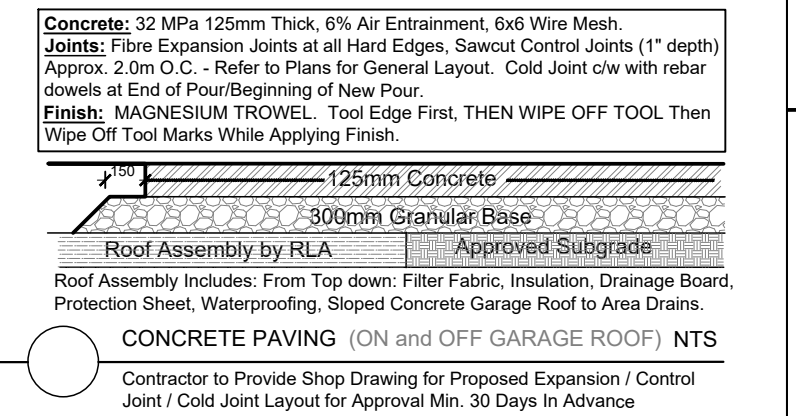

**PROPERTY OWNER**  
**KERR BROADVIEW PROPERTIES LTD.**  
236 Metcalfe Street Ottawa K2P 1R3

**GJA INC.**  
GINO J. AIELLO | LANDSCAPE ARCHITECT  
GJALA.COM | 613 286 5130 | GINO@GJALA.COM  
115 BELLEVILLE ROAD UNIT # 1 | OTTAWA ONTARIO | K1T 2C2

**PHASE 1 Tower C 9 Storey Apartment Building / Retirement Residence**  
1746 Carling / 1755 Kerr Avenues Ottawa

**Landscape Plan**  
Scale: 1:200

1 SPC SUBMISSION 1 2026 01 21  
0 REVIEW/COORDINATION 2025 07 17  
# Revision Date