

PLOT DATE: 2020-06-02 09:29:50AM

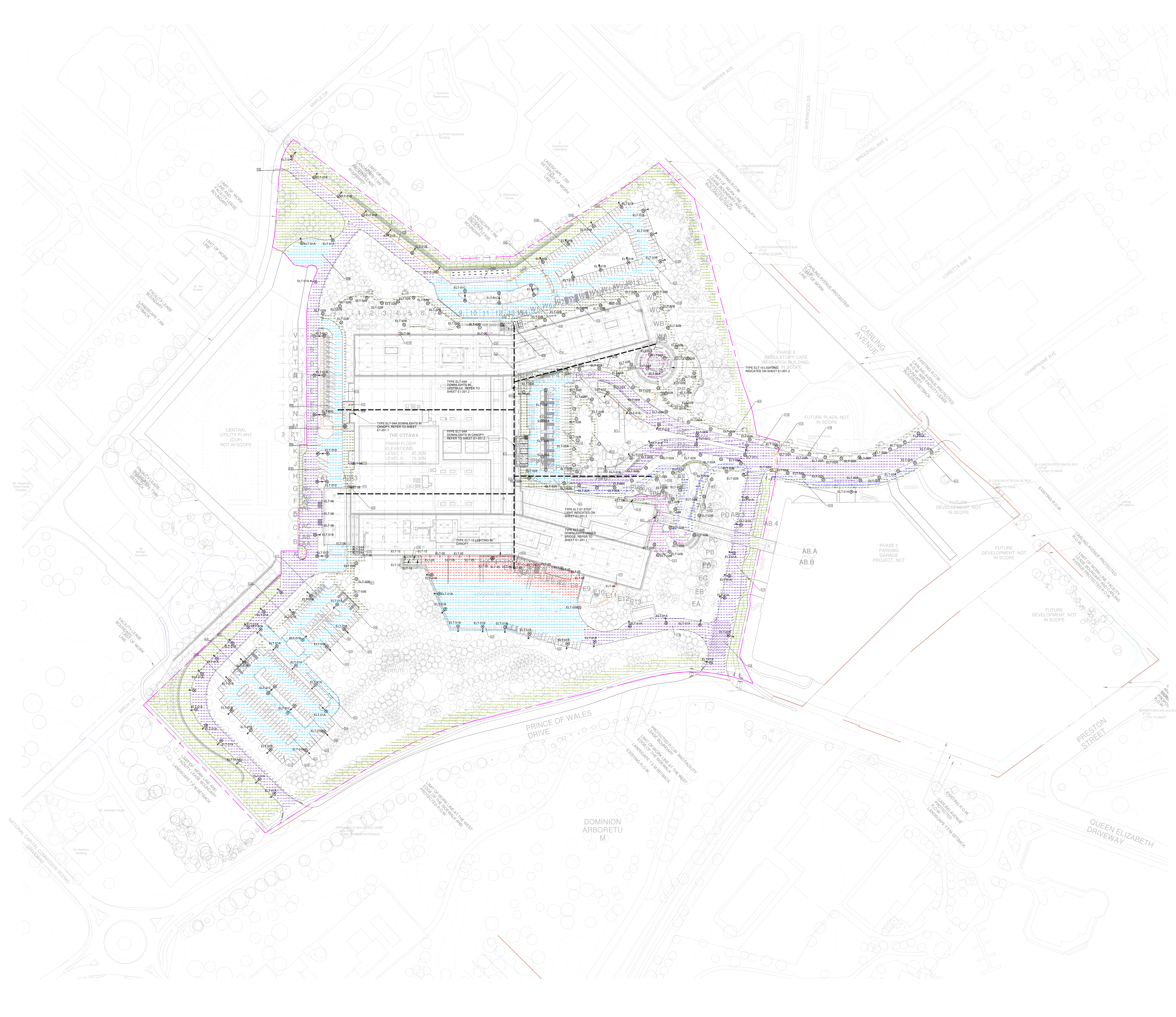

### LIGHTING FIXTURE SCHEDULE - PHOTOMETRIC SITE PLAN

TYPE	VOLTAGE	COLOR TEMPERATURE	Description	LUMENS	BEAM/SPREAD	CR	MANUFACTURER	NOTES	LOCATIONS	IMAGE
ELT-01A	120 V	3000K	ROADWAY POLE LIGHT	1200lm	375 x 4	80	Cooper Lighting Solutions	1500mm overall base for roadway lighting and 6000mm base for parking lighting Full Cut Off Optics	ROADWAYS/PARKING	
ELT-01B	150 V	3000K	ROADWAY POLE LIGHT	680lm	353 x 4	80	Cooper Lighting Solutions	1500mm overall base for roadway lighting and 6000mm base for parking lighting Full Cut Off Optics	ROADWAYS/PARKING	
ELT-01C	120 V	3000K	DUAL HEAD ROADWAY POLE LIGHT	1440lm	1468 x 4	80	Cooper Lighting Solutions	1500mm overall base for roadway lighting and 6000mm base for parking lighting Full Cut Off Optics	ROADWAYS/PARKING	
ELT-01D	120 V	3000K	DUAL HEAD ROADWAY POLE LIGHT	1440lm	1468 x 4	80	Cooper Lighting Solutions	1500mm overall base for roadway lighting and 6000mm base for parking lighting Full Cut Off Optics	ROADWAYS/PARKING	
ELT-01E	120 V	3000K	ROADWAY POLE LIGHT	680lm	353 x 4	80	Cooper Lighting Solutions	1500mm overall base for roadway lighting and 6000mm base for parking lighting Full Cut Off Optics	ROADWAYS/PARKING	
ELT-01A	150 V	3000K	DECORATIVE LUMINAIRE	3075lm	337 x 4	80	Site	1500mm overall base for roadway lighting and 6000mm base for parking lighting Full Cut Off Optics	ROADWAYS/PEDESTRIAN PATHWAYS	
ELT-01B	150 V	3000K	DECORATIVE LUMINAIRE	3135lm	313 x 4	80	Site	1500mm overall base for roadway lighting and 6000mm base for parking lighting Full Cut Off Optics	ROADWAYS/PEDESTRIAN PATHWAYS	
ELT-01A	120 V	3000K	16 Surface Mounted Low Voltage Light Fixture	1000lm	1000 x 4	90	VA Span	Mounted to Glazed Canopy assembly	Main Entrance Canopy	
ELT-01B	120 V	3000K	16 Surface Mounted Low Voltage Light Fixture	1000lm	1000 x 4	90	VA Span	Mounted to Glazed Canopy assembly	Main Entrance Canopy	
ELT-01C	120 V	3000K	16 Surface Mounted Low Voltage Light Fixture	1000lm	1000 x 4	90	VA Span	Mounted to Glazed Canopy assembly	Main Entrance Canopy	
ELT-01A	120 V	3000K	DOWNLIGHT SURFACE MOUNT	2000lm	1407 x 4	80	Cooper Lighting Solutions	Waterproof recessed in Softly Glazing Canopy	EXTERIOR CANOPY	
ELT-01B	120 V	3000K	WALL MOUNT LIGHT	800lm	800 x 4	80	Cooper Lighting Solutions	LED Linear Lighting Solutions	Building Exterior	
ELT-01C	120 V	3000K	WALL MOUNT LIGHT	1024lm	1024 x 4	80	Cooper Lighting Solutions	LED Linear Lighting Solutions	Building Exterior	
ELT-01D	120 V	3000K	STEP LIGHT	565lm	348 x 4	80	Site	Installed within exterior walls	Building Exterior	
ELT-01E	120 V	3000K	SURFACE MOUNTED DOWNLIGHT	1028lm	1028 x 4	80	Site	Surface Mounted to Exterior Walls	Building Exterior	
ELT-01F	120 V	3000K	COMPACT LINEAR LED LIGHTING	840lm	840 x 4	80	LED Linear Lighting Solutions	Mounted to Site Canopy Columns	VERTICAL COLLARS	
LIG	120 V	3000K	PARKING GARAGE LIGHT	684lm	840 x 4	80	Site	Mounted to Site Canopy Columns	BIKE PARKING	

### Calculation Results

Description	Min	Max	Average	Mean Min
1.1 Road - Emergency Garage out (east)	19.0 lx	38.7 lx	21.8 lx	1.85
1.2 Road - Emergency Garage in (west)	11.0 lx	38.4 lx	20.4 lx	2.27
1.3 Road - Main Plaza (west)	6.77 lx	36.1 lx	17.7 lx	2.51
1.4 Road - Main Plaza (west)	7.05 lx	36.3 lx	17.7 lx	1.68
1.5 Road Street D	8.65 lx	24.2 lx	14.5 lx	2.71
1.6 Road Street A	4.65 lx	22.8 lx	12.6 lx	10.70
1.7 Road Street B	1.24 lx	35.0 lx	13.3 lx	2.92
1.8 Road B, Road L Intersection	4.65 lx	22.7 lx	12.2 lx	2.71
1.9 Road Street L	4.51 lx	26.8 lx	12.2 lx	2.07
1.10 Road A, Road B Intersection	9.56 lx	49.4 lx	19.2 lx	3.03
1.11 Road Street E	0.68 lx	40.2 lx	13.5 lx	1.99
2.1 Vehicle Pathway - Main Plaza	5.00 lx	154 lx	17.4 lx	2.84
2.2 Vehicle Pathway - Zone 4, SB Parking	6.13 lx	33.3 lx	17.4 lx	1.88
2.3 Vehicle Pathway - Zone SB Parking	6.72 lx	23.5 lx	12.6 lx	2.06
2.4 Vehicle Pathway - Zone 4, SB Parking	5.90 lx	27.8 lx	11.7 lx	3.09
2.5 Vehicle Pathway - Loading Docks Area	3.59 lx	31.7 lx	11.1 lx	2.10
2.6 Vehicle Pathway - Road E South 01	9.08 lx	24.7 lx	9.18 lx	1.86
2.7 Vehicle Pathway - Zone 4, SB Parking	6.44 lx	15.4 lx	9.18 lx	2.14
2.8 Vehicle Pathway - Road D	5.43 lx	44.1 lx	13.0 lx	1.99
2.9 Vehicle Pathway - Road E West	4.76 lx	28.4 lx	14.4 lx	3.03
2.10 Vehicle Pathway - Road E South 02	6.03 lx	38.1 lx	12.0 lx	1.99
3.1 Sidewalk - To Ramp Emergency Garage in	5.00 lx	27.8 lx	12.2 lx	1.99
3.2 Sidewalk - Loading Docks 01	1.17 lx	60.5 lx	9.4 lx	8.04
3.3 Sidewalk - Zone SA Parking	5.21 lx	27.2 lx	14.7 lx	2.66
3.4 Sidewalk - Zone 1 Parking	7.92 lx	14.7 lx	10.2 lx	1.29
3.6 Sidewalk - Road D	1.15 lx	1022 lx	44.8 lx	39.9
4.1 Parking Slot - Zone 4, 6 Parking	6.17 lx	12.2 lx	6.04 lx	1.30
4.2 Parking Slot - Zone SA Parking	7.12 lx	17.0 lx	9.93 lx	1.39
4.3 Parking Slot - Zone SB, 1 Parking	6.65 lx	10.8 lx	7.52 lx	1.13
4.4 Parking Slot - Zone 3 Parking	6.07 lx	20.3 lx	13.0 lx	2.14
4.5 Parking Slot - Zone SB, 3 Parking	8.07 lx	26.3 lx	15.8 lx	1.96
4.6 Parking Slot - Zone SA, 4 Parking	10.1 lx	20.0 lx	15.0 lx	1.54
4.7 Parking Slot - Zone SB, 5 Parking	6.69 lx	11.8 lx	7.94 lx	1.19
4.8 Parking Slot - Zone SA, 5 Parking	9.03 lx	26.3 lx	16.5 lx	2.03
4.9 Parking Slot - Zone SA, 4 Parking	4.04 lx	10.8 lx	6.55 lx	1.62
4.10 Parking Slot - Zone SA, 3 Parking	11.0 lx	21.7 lx	16.4 lx	1.49
4.11 Parking Slot - Zone SA, 2 Parking	7.89 lx	19.8 lx	15.1 lx	1.91
4.12 Parking Slot - Zone 2 Parking	7.02 lx	27.8 lx	13.8 lx	1.97
4.13 Parking Slot - Zone 1, Shuttle Parking	5.86 lx	9.99 lx	7.40 lx	1.26
4.14 Parking Slot - Zone 1, 6 Parking	3.42 lx	13.8 lx	5.55 lx	1.62
4.15 Parking Slot - Road E, 1 Parking	17.2 lx	27.3 lx	20.8 lx	1.20
4.16 Parking Slot - Zone 1, 3 Parking	19.0 lx	20.8 lx	16.7 lx	1.28
4.17 Parking Slot - Zone 1, 4 Parking	4.96 lx	16.1 lx	7.90 lx	1.60
4.18 Parking Slot - Zone SB, 2 Parking	10.6 lx	17.0 lx	13.8 lx	1.30
4.19 Parking Slot - South Entrance Parking	6.79 lx	20.3 lx	15.8 lx	2.27
4.20 Parking Slot - Zone 1, 2 Parking	10.6 lx	18.3 lx	13.6 lx	1.28
4.21 Parking Slot - Zone 1, 1 Parking	5.42 lx	11.2 lx	7.01 lx	1.29
4.22 Parking Slot - Zone 1, 6 Parking	8.07 lx	17.1 lx	13.1 lx	1.46
5.1 Accessible Parking - Zone SB Parking	10.4 lx	16.4 lx	13.0 lx	1.20
5.2 Accessible Parking - Zone SB Parking	6.02 lx	16.7 lx	10.5 lx	1.61
5.3 Accessible Parking - Zone 1 Parking	5.57 lx	10.3 lx	7.02 lx	1.28
5.4 Accessible Parking - Zone 4 Parking	8.53 lx	6.1 lx	7.17 lx	1.74
6.1 Pedestrian Pathway - To Dining Terrace	18.1 lx	43.8 lx	29.0 lx	1.60
6.2 Pedestrian Pathway - Pavilion	8.03 lx	47.2 lx	21.5 lx	2.61
6.3 Pedestrian Pathway - Road A West	4.50 lx	25.3 lx	10.3 lx	2.29
6.4 Pedestrian Pathway - Showstop Steps Tower B	6.41 lx	12.9 lx	9.70 lx	1.51
6.5 Pedestrian Pathway - Main Plaza - Tower B	5.91 lx	19.0 lx	13.5 lx	3.94
6.7 Pedestrian Pathway - Main Plaza - Tower A	3.22 lx	80.3 lx	15.5 lx	4.81
6.8 Pedestrian Pathway - Zone SB Parking	5.04 lx	19.1 lx	12.7 lx	5.27
6.9 Pedestrian Pathway - South Entrance	1.55 lx	40.8 lx	9.27 lx	5.98
6.10 Pedestrian Pathway - Zone 4	6.08 lx	21.2 lx	12.5 lx	2.06
6.11 Pedestrian Pathway - Overlook	2.89 lx	44.2 lx	20.1 lx	6.96
6.12 Pedestrian Pathway - Healing Garden Area	6.54 lx	54.6 lx	20.9 lx	3.20
6.13 Pedestrian Pathway - West Area	0.95 lx	116 lx	22.7 lx	23.9
6.14 Pedestrian Pathway - Road A East	7.14 lx	33.8 lx	15.7 lx	2.20
6.15 Pedestrian Pathway - Emergency Exit - Staff Entry	3.23 lx	84.0 lx	13.4 lx	4.15
7.1 Secondary Entrance - Tower B North	30.0 lx	60.0 lx	42.1 lx	1.41
7.2 Secondary Entrance - Stairs 02 (South)	102 lx	120 lx	111 lx	1.09
7.3 Secondary Entrance - Stairs 01 (South)	134 lx	201 lx	165 lx	1.23
7.4 Secondary Entrance - East Entrance 02	28.5 lx	66.4 lx	47.4 lx	1.66
7.5 Secondary Entrance - Tower A West	72.8 lx	72.8 lx	72.8 lx	1
7.6 Secondary Entrance - Tower A Secondary Entrance 01	53.4 lx	53.4 lx	53.4 lx	1
7.7 Secondary Entrance - Tower A Secondary Entrance 02	53.2 lx	53.2 lx	53.2 lx	1
7.8 Secondary Entrance - Loading Dock 01	42.9 lx	47.1 lx	45.0 lx	1.06
7.9 Secondary Entrance - East Entrance	8.79 lx	19.0 lx	86.4 lx	9.93
7.10 Secondary Entrance - Loading Dock	88.7 lx	88.7 lx	88.7 lx	1
7.11 Secondary Entrance - Pavilion by Terrace	20.0 lx	60.0 lx	42.1 lx	1.41
7.12 Secondary Entrance - Emergency Exit and Staff Entrance	43.9 lx	63.8 lx	53.7 lx	1.24
8.1 Main Entrance - Tower B	79.9 lx	303 lx	235 lx	2.59
8.2 Main Entrance - Tower A	7.82 lx	26.7 lx	21.1 lx	2.88
8.3 Main Entrance - Staff Entrance West	89.2 lx	395 lx	294 lx	3.39
8.4 Main Entrance - South Entrance	73.5 lx	193 lx	134 lx	1.82
8.5 Main Entrance - Pavilion by Terrace	71.8 lx	130 lx	88.7 lx	1.58
9.1 Ramp to Underground Parking - Emergency Garage In	16.2 lx	89.3 lx	55.7 lx	3.44
9.2 Ramp to Underground Parking - Emergency Garage Out	16.5 lx	77.1 lx	50.1 lx	4.77
10.1 Bicycle Pathway - To Dining Terrace	8.63 lx	36.4 lx	19.5 lx	2.26
10.2 Bicycle Pathway - Pavilion	6.88 lx	34.4 lx	16.9 lx	2.46
10.3 Bicycle Pathway - Road A	5.31 lx	24.8 lx	14.1 lx	2.66
10.4 Bicycle parking zone	2.31 lx	1732 lx	141 lx	0.8
11.1 Crosswalk - Road A 01	10.5 lx	22.6 lx	15.3 lx	1.46
12.1 Dining Area - Terrace Tower B	3.87 lx	1358 lx	46.5 lx	12
12.2 Healing Garden Area	8.92 lx	541 lx	56.8 lx	6.37
13.1 Loading Docks Area	13.0 lx	404 lx	191 lx	7.77

**THE OTTAWA HOSPITAL  
NEW CAMPUS  
DEVELOPMENT -  
PHASE 4 MAIN HOSPITAL  
BUILDING**

900 CARLING AVE. OTTAWA, ONTARIO

CLIENT:

**Infrastructure Ontario**

CLIENT PROJECT NO: **1070002**

KEY PLAN: TRUE NORTH PROJECT NORTH

DRAWING NO: **E1-201** REV. NO: **06**

SCALE: 1:750 DATE: 01/08/25

GRAPHIC SCALE: 0 5 10 METERS

**NOT FOR CONSTRUCTION**

DISCREPANCIES MUST BE REPORTED IMMEDIATELY TO THE ARCHITECT BEFORE PROCEEDING. ONLY FIGURED DIMENSIONS ARE TO BE USED. CONTRACTORS MUST CHECK ALL DIMENSIONS ON SITE. THIS DRAWING IS PROTECTED BY COPYRIGHT.

ALL DIMENSIONS ARE SHOWN IN METRIC.

**AUTHOR**

**MULVEY & BANANI**

95 Sheppard Avenue East, Suite 500, Toronto, ON, M2N 1A1  
416.733.2121 | www.mba.com

**PROJECT TEAM**

**DESIGN BUILDER:** POLI D'AVONT VENTURE  
**ARCHITECTURAL:** PARON ARCHITECTS LIMITED  
JOON LAMARIE PRATTE ARCHITECTS  
ADAMSON ASSOCIATE ARCHITECTS  
880 WILSON AVENUE OTTAWA, ON  
**STRUCTURAL:** STEPHENSON ENGINEERING LTD.  
SOUTHLEITE PARBEAU INC.  
**MECHANICAL:** HR ANGLIS & ASSOCIATES LTD.  
CROSBY ENGINEERING LTD.  
**ELECTRICAL:** WSP | PARON INC.  
**CIVIL:** HERGENROT DESIGN INC.  
**LANDSCAPE:** PWP LANDSCAPE ARCHITECTURE  
**BUILDING CODE:** UMO BUILDING CODE CONSULTANTS LTD.

**AUTHOR PROJECT NO:** 2233-00

STAMP: \_\_\_\_\_

DRAWING TITLE: **LEVEL 1 - PHOTOMETRIC SITE PLAN**

DRAWN: \_\_\_\_\_ CHECKED: \_\_\_\_\_