

LEGEND

- 25,30m3 SOIL VOLUME AT A 1.5m DEPTH
PROPOSED DECIDUOUS TREE
- 25,30m3 SOIL VOLUME AT A 1.5m DEPTH
PROPOSED CONIFEROUS TREE
- PROPOSED CONIFEROUS SHRUBS
- EXISTING GRASS TO REMAIN
- EXISTING TREE TO REMAIN
- EXISTING TREE TO BE REMOVED
- PROPOSED PRECAST CONCRETE PAVERS
- PROPOSED SOD
- TREE PROTECTION FENCE

PROPOSED PLANT LIST

KEY	QTY	BOTANICAL NAME	COMMON NAME	SIZE	CONDITION	REMARKS
TREES						
*FM	2	Acer x freemanii	Freeman's Maple	50mm ø	B&B	
GI	3	Ginkgo biloba 'Princeton Sentry'	Princeton Ginkgo	50mm ø	B&B	Male tree
*HL	5	Gleditsia triacanthos	Honey Locust	50mm ø	B&B	
*SM	2	Acer saccharum	Sugar Maple	50mm ø	B&B	
*WS	2	Picea glauca	White Spruce	2000 mm ht.	B&B	
SHRUBS						
*WC	72	Thuja occidentalis 'Clumps'	White Cedar Clumps	2000 mm ht.	Bare root	Space 600mm o.c

*DENOTES NATIVE SPECIES. ALL TREES ARE PROPOSED ON PRIVATE PROPERTY

- GENERAL NOTES:**
- It is the responsibility of the appropriate contractor or official to report any errors, omissions or discrepancies on this plan with actual site conditions to the Landscape Architect before proceeding with construction.
 - The contractor is to notify all utility companies and authorities prior to any excavation and ascertain locations of underground services.
 - The contractor is to reinstate all areas and items damaged as a result of construction activity.
 - The contractor is to comply with all pertinent codes and by-laws.
 - The contractor is to maintain a positive surface run-off throughout the entire construction period.
 - The Landscape Architect is not responsible for subsurface conditions.
 - The contractor is to identify all existing trees to remain on site with the Landscape Architect prior to construction.
 - The contractor is to stake the proposed location of all plant material in conjunction with the Landscape Architect prior to excavation.
 - Minimum distances for selected deciduous trees are as follows:
 - Building Foundations 4.5m
 - Sidewalks 1.5m
 - Public Streets 2.5m
 - Underground Infrastructure 2.0m
 - All trees within 1m of underground utility trenches are to be excavated by hand.
 - Remove all protective wrapping from tree trunks after installation.
 - Staking of trees shall only be performed if necessary.
 - Ensure that mulch is pulled back a min. distance of 75mm from base of tree trunk.



Conseil des écoles publiques de l'Est de l'Ontario

Conseil des écoles publiques de l'Est de l'Ontario

key plan



40 YEAR CANOPY CALCULATION:

- 48,578m2 site area
- 50 Large existing deciduous trees (154m2 ea)
- 36 medium existing deciduous trees (79m2 ea)
- 21 large existing coniferous trees (79m2 ea)
- 4 large deciduous trees proposed (154m2 ea)
- 8 medium deciduous trees proposed (79m2 ea)
- 2 large coniferous trees proposed (79m2 ea)
- =13,609m2 canopy cover =28% canopy cover

*Large deciduous tree calculated at 14m spread, medium deciduous tree calculated at 10m spread and large coniferous tree calculated at 10m spread.

LEGAL DESCRIPTION:

PARTS OF LOT 14 AND 15
CONCESSION 3 (RIDEAU FRONT)
PIN: 045950130 & 04591752

2	January 16th 2026	Issued for Site Plan Control Application	LC
1	December 19th 2025	Issued for 33% Review	ML
no.	date	revision/issue	by

LANDSCAPE ARCHITECTS

JAMES B. LENNOX & ASSOCIATES INC.
LANDSCAPE ARCHITECTS

3333 CARLING AVE OTTAWA, ONTARIO K2H 3A8
Tel. (613) 722-5168 Fax. 1(866) 343-3942

consultants

PROVENCHER ROY

PROVENCHER ROY ASSOCIÉS ARCHITECTES INC. T 613 586 6339
47 Rue Clarence, Suite 400 T 613 686 9339
OTTAWA, ONTARIO, CANADA K1N 9K1 PROVENCHERROY.CA

CUNLIFFE & ASSOCIATES
CONSULTING STRUCTURAL ENGINEERS

LRJ
LANDSCAPE ARCHITECTS

northpoint

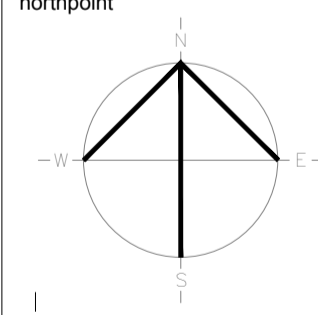

professional stamp



project title

ESP PIERRE-DE-BLOIS AUDITORIUM ADDITION

Project Address 1310 Chapman Mills Drive, Nepean, ON K2J 6L9

drawing title

TREE CONSERVATION REPORT & LANDSCAPE PLAN

date	November 17, 2025	job. no.	
scale			2622
drawn	ML		
approved	JL		
plot date	2025-12-19 11:55:12 AM		L001

1. DO NOT SCALE FROM THIS DRAWING
2. CONTRACTOR TO VERIFY ALL DIMENSIONS AND NOTIFY THE ARCHITECT OF ANY DISCREPANCIES BEFORE WORK COMMENCES
3. THIS DRAWING TO BE READ IN CONJUNCTION WITH THE FOLLOWING DRAWINGS: STRUCTURAL, MECHANICAL, ELECTRICAL

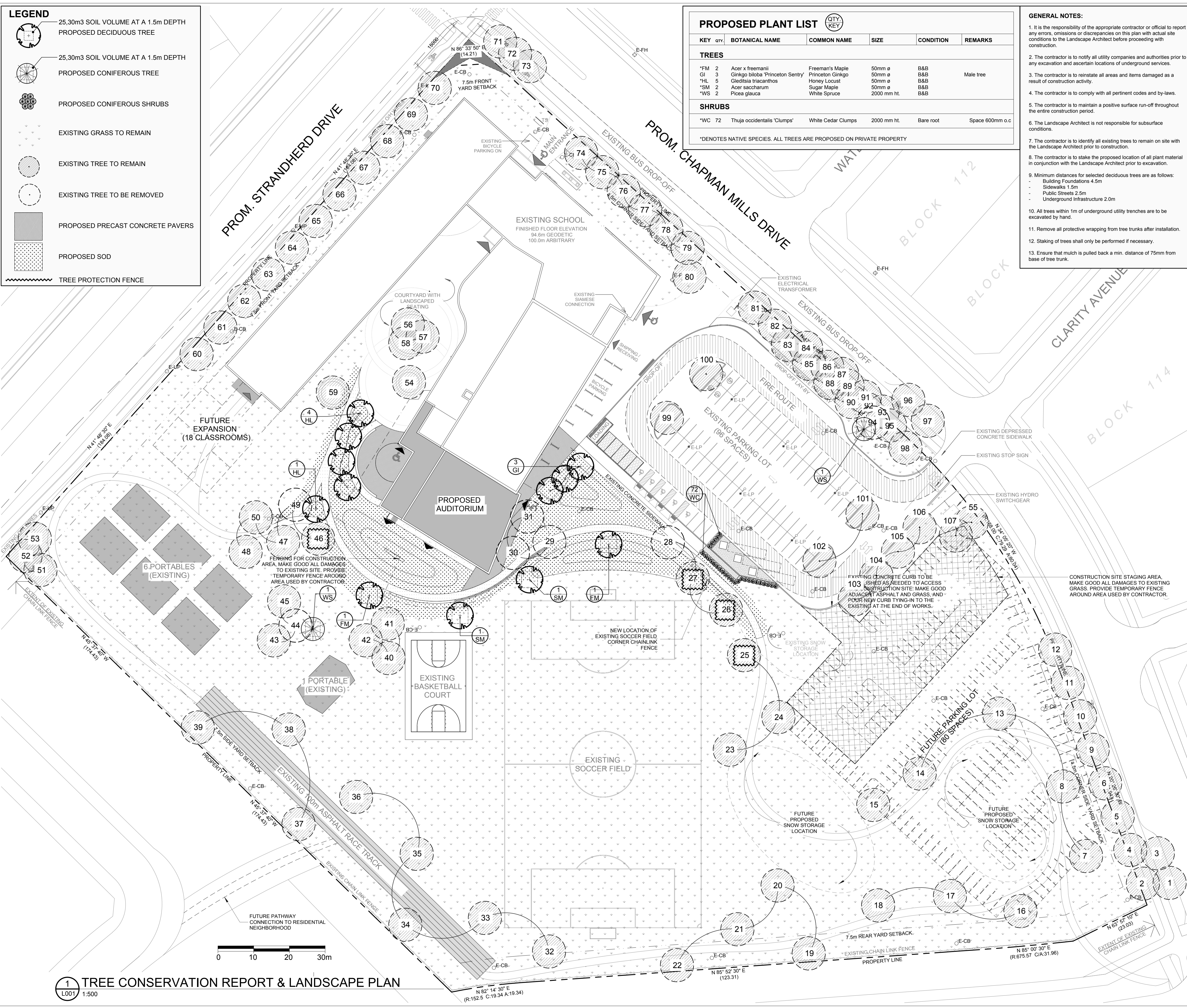

1 TREE CONSERVATION REPORT & LANDSCAPE PLAN
L001 1:500

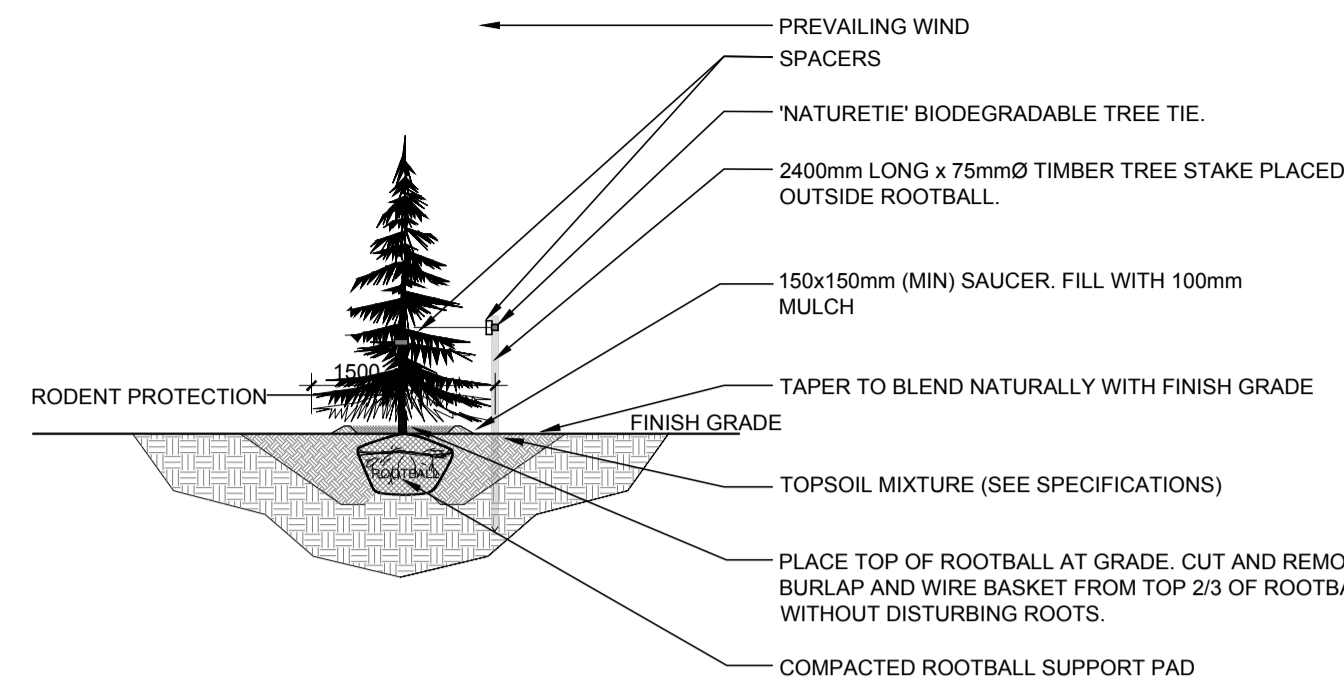

1 CONIFEROUS TREE PLANTING

L002 NTS

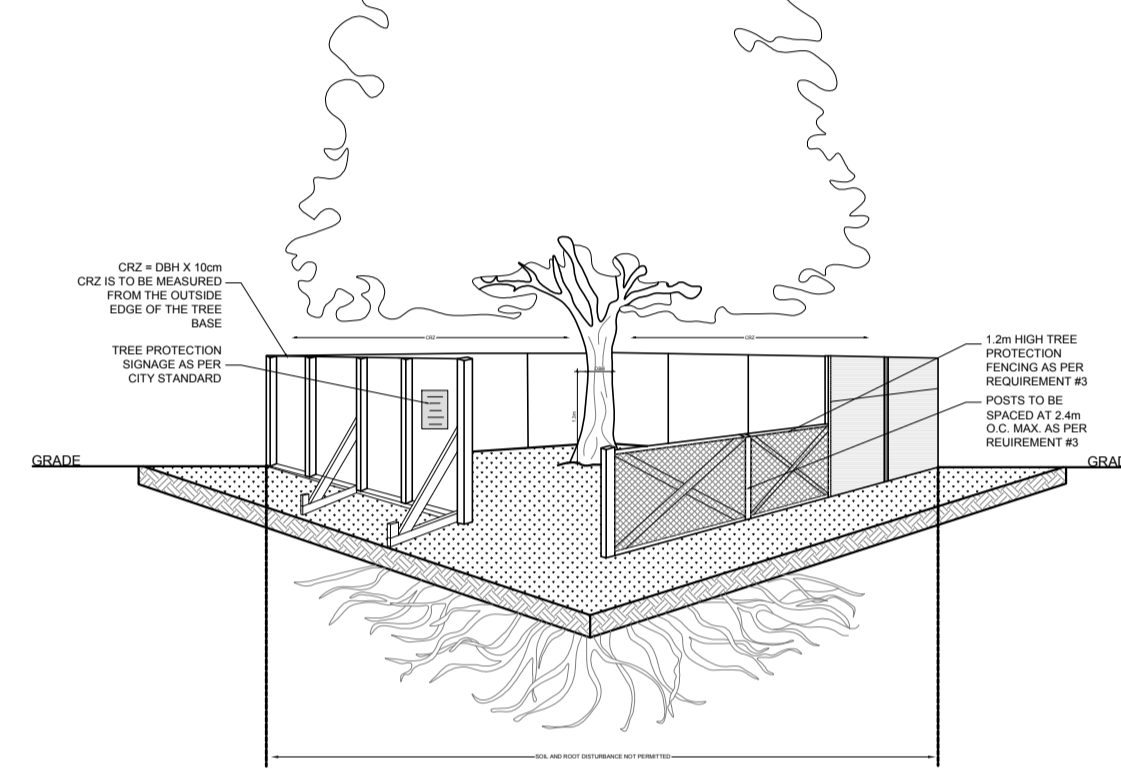
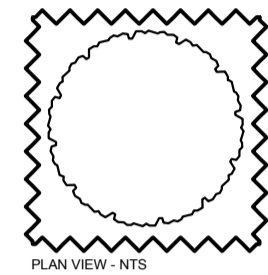

TREE PROTECTION REQUIREMENTS:

- PRIOR TO ANY WORK ACTIVITY WITHIN THE CRITICAL ROOT ZONE (CRZ) = 10x DIAMETER OF A TREE, TREE PROTECTION FENCING MUST BE INSTALLED SURROUNDING THE CRITICAL ROOT ZONE AND REMAIN IN PLACE UNTIL THE WORK IS COMPLETE.
 - DO NOT PLACE ANY MATERIAL OR EQUIPMENT INCLUDING OUTHOUSES.
 - DO NOT ATTACH ANY SIGNS, NOTICES OR POSTERS TO ANY TREE.
 - DO NOT RAISE OR LOWER THE EXISTING GRADE, TUNNEL OR BORE WHEN DIGGING.
 - DO NOT DAMAGE THE ROOT SYSTEM, TRUNK, OR BRANCHES OF ANY TREE.
 - ENSURE THAT EXHAUST FUMES FROM ALL EQUIPMENT ARE NOT DIRECTED TOWARD ANY TREE CANOPY.
 - DO NOT EXTEND HARD SURFACE OR SIGNIFICANTLY CHANGE LANDSCAPING.
- UNLESS PLANS ARE APPROVED BY CITY FORESTRY STAFF FOR WORK WITHIN THE CRZ:
 - DO NOT PLACE ANY MATERIAL OR EQUIPMENT INCLUDING OUTHOUSES.
 - DO NOT ATTACH ANY SIGNS, NOTICES OR POSTERS TO ANY TREE.
 - DO NOT RAISE OR LOWER THE EXISTING GRADE, TUNNEL OR BORE WHEN DIGGING.
 - DO NOT DAMAGE THE ROOT SYSTEM, TRUNK, OR BRANCHES OF ANY TREE.
 - ENSURE THAT EXHAUST FUMES FROM ALL EQUIPMENT ARE NOT DIRECTED TOWARD ANY TREE CANOPY.
 - DO NOT EXTEND HARD SURFACE OR SIGNIFICANTLY CHANGE LANDSCAPING.
- TREE PROTECTION FENCING MUST BE AT LEAST 1.2m IN HEIGHT, AND BE CONSTRUCTED OF RIGID OR FRAMED MATERIALS (E.G. MODULAR STEEL OR WOOD HOARDING, OR SNOW FENCE ON A 2"x4" WOOD FRAME) WITH POLES 2.4m APART SUCH THAT THE FENCE LOCATION CANNOT BE ALTERED. ALL SUPPORTS AND BRACING MUST BE PLACED OUTSIDE OF THE CRZ, AND INSTALLATION MUST MINIMIZE DAMAGE TO EXISTING ROOTS. (SEE DETAIL)
- THE LOCATION OF THE TREE PROTECTION FENCING MUST BE DETERMINED BY AN ARBORIST AND DETAILED ON ANY ASSOCIATED PLANS FOR THE SITE (E.G. TREE CONSERVATION REPORT, TREE DISCLOSURE REPORT, ETC.). THE PLAN AND CONSTRUCTED FENCING MUST BE APPROVED BY CITY FORESTRY STAFF PRIOR TO THE COMMENCEMENT OF WORK.
- IF THE FENCED TREE PROTECTION AREA MUST BE REDUCED TO FACILITATE CONSTRUCTION, MITIGATION MEASURES MUST BE PRESCRIBED BY AN ARBORIST AND APPROVED BY CITY FORESTRY STAFF. THESE MAY INCLUDE THE PLACEMENT OF PLWOOD, WOOD CHIPS OR STEEL PLATING OVER THE ROOTS FOR PROTECTION OR THE PRIOR PRUNING AND CARE OF ROOTS WHERE ENCOUNTERED.

BY-LAWS:
 ALL CITY-OWNED TREES ARE PROTECTED UNDER THE MUNICIPAL TREES AND NATURAL AREAS PROTECTION BY-LAW (2006-279), WITHIN THE URBAN AREA.
 PRIVATELY OWNED TREES GREATER THAN 100mm IN DIAMETER ON LOTS 1 HECTARE IN SIZE OR LESS, AND TREES GREATER THAN 100mm IN DIAMETER ON LOTS GREATER THAN 1 HECTARE, ARE PROTECTED UNDER THE URBAN TREE CONSERVATION BY-LAW (2020-340).

3 TREE PROTECTION FENCE

L002 NTS

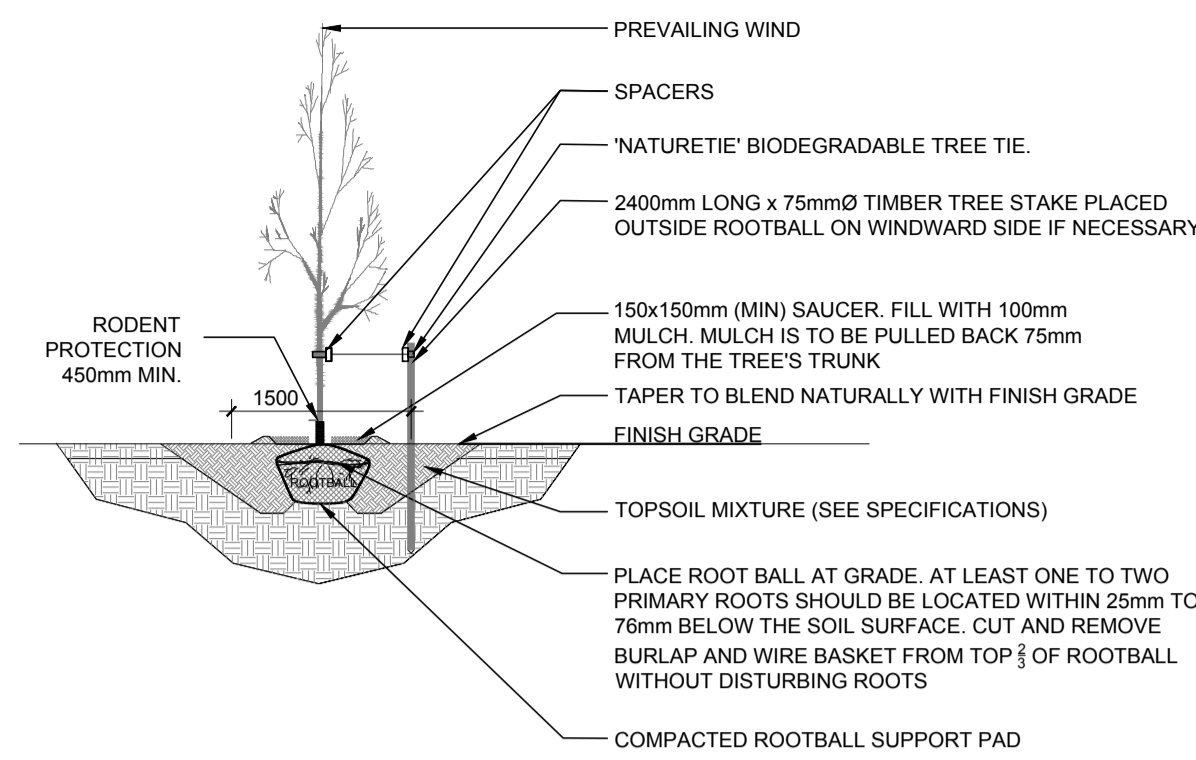

2 DECIDUOUS TREE PLANTING

L002 NTS

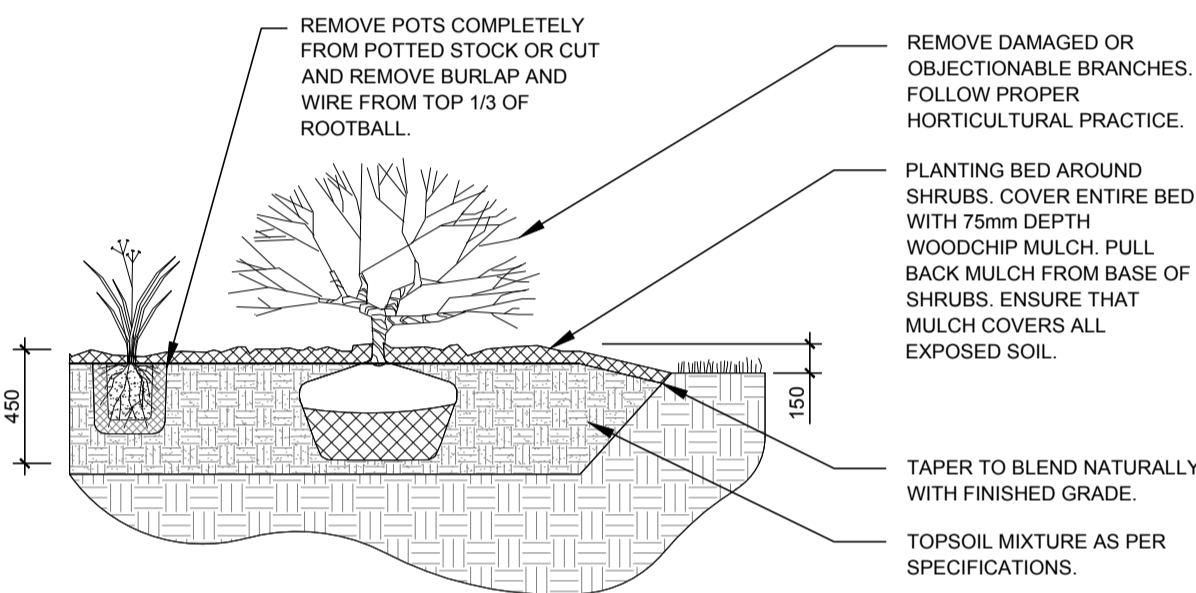

4 SHRUB PLANTING

L002 NTS

EXISTING TREE LIST							
KEY	QTY	BOTANICAL NAME	COMMON NAME	SIZE	CONDITION	ACTION	OWNERSHIP
1	1	<i>Gleditsia triacanthos</i>	Honey Locust	50mm dbh	GOOD	To Remain	City of Ottawa
2	1	<i>Quercus macrocarpa</i>	Bur Oak	50mm dbh	GOOD	To Remain	City of Ottawa
3	1	<i>Gleditsia triacanthos</i>	Honey Locust	50mm dbh	GOOD	To Remain	City of Ottawa
4	1	<i>Quercus macrocarpa</i>	Bur Oak	50mm dbh	GOOD	To Remain	City of Ottawa
5	1	<i>Quercus macrocarpa</i>	Bur Oak	50mm dbh	GOOD	To Remain	City of Ottawa
6	1	<i>Tilia cordata</i>	Littleleaf Linden	50mm dbh	GOOD	To Remain	City of Ottawa
7	1	<i>Acer x freemanii</i>	Freeman's Maple	70mm dbh	GOOD	To Remain	City of Ottawa
8	1	<i>Acer x freemanii</i>	Freeman's Maple	70mm dbh	GOOD	To Remain	1310 Chapman Mills Dr
9	1	<i>Tilia cordata</i>	Littleleaf Linden	50mm dbh	GOOD	To Remain	City of Ottawa
10	1	<i>Tilia cordata</i>	Littleleaf Linden	50mm dbh	GOOD	To Remain	City of Ottawa
11	1	<i>Celtis occidentalis</i>	Hackberry	50mm dbh	GOOD	To Remain	City of Ottawa
12	1	<i>Celtis occidentalis</i>	Hackberry	50mm dbh	GOOD	To Remain	City of Ottawa
13	1	<i>Acer x freemanii</i>	Freeman's Maple	70mm dbh	GOOD	To Remain	1310 Chapman Mills Dr
14	1	<i>Acer x freemanii</i>	Freeman's Maple	70mm dbh	GOOD	To Remain	1310 Chapman Mills Dr
15	1	<i>Acer saccharum</i>	Sugar Maple	70mm dbh	GOOD	To Remain	1310 Chapman Mills Dr
16	1	<i>Gleditsia triacanthos</i>	Honey Locust	70mm dbh	GOOD	To Remain	1310 Chapman Mills Dr
17	1	<i>Gleditsia triacanthos</i>	Honey Locust	70mm dbh	GOOD	To Remain	1310 Chapman Mills Dr
18	1	<i>Gleditsia triacanthos</i>	Honey Locust	70mm dbh	GOOD	To Remain	1310 Chapman Mills Dr
19	1	<i>Acer x freemanii</i>	Freeman's Maple	70mm dbh	GOOD	To Remain	1310 Chapman Mills Dr
20	1	<i>Acer x freemanii</i>	Freeman's Maple	70mm dbh	GOOD	To Remain	1310 Chapman Mills Dr
21	1	<i>Acer x freemanii</i>	Freeman's Maple	70mm dbh	GOOD	To Remain	1310 Chapman Mills Dr
22	1	<i>Acer x freemanii</i>	Freeman's Maple	70mm dbh	GOOD	To Remain	1310 Chapman Mills Dr
23	1	<i>Gleditsia triacanthos</i>	Honey Locust	70mm dbh	GOOD	To Remain	1310 Chapman Mills Dr
24	1	<i>Gleditsia triacanthos</i>	Honey Locust	70mm dbh	GOOD	To Remain	1310 Chapman Mills Dr
25	1	<i>Gleditsia triacanthos</i>	Honey Locust	70mm dbh	GOOD	To Remain	1310 Chapman Mills Dr
26	1	<i>Acer x freemanii</i>	Freeman's Maple	70mm dbh	GOOD	To Remain	1310 Chapman Mills Dr
27	1	<i>Acer x freemanii</i>	Freeman's Maple	70mm dbh	GOOD	To Remain	1310 Chapman Mills Dr
28	1	<i>Acer x freemanii</i>	Freeman's Maple	70mm dbh	GOOD	To be removed	1310 Chapman Mills Dr
29	1	<i>Acer x freemanii</i>	Freeman's Maple	70mm dbh	GOOD	To be removed	1310 Chapman Mills Dr
30	1	<i>Acer x freemanii</i>	Freeman's Maple	70mm dbh	GOOD	To be removed	1310 Chapman Mills Dr
31	1	<i>Acer x freemanii</i>	Freeman's Maple	70mm dbh	GOOD	To be removed	1310 Chapman Mills Dr
32	1	<i>Gleditsia triacanthos</i>	Honey Locust	70mm dbh	GOOD	To Remain	1310 Chapman Mills Dr
33	1	<i>Gleditsia triacanthos</i>	Honey Locust	70mm dbh	GOOD	To Remain	1310 Chapman Mills Dr
34	1	<i>Gleditsia triacanthos</i>	Honey Locust	70mm dbh	GOOD	To Remain	1310 Chapman Mills Dr
35	1	<i>Gleditsia triacanthos</i>	Honey Locust	70mm dbh	GOOD	To Remain	1310 Chapman Mills Dr
36	1	<i>Gleditsia triacanthos</i>	Honey Locust	70mm dbh	GOOD	To Remain	1310 Chapman Mills Dr
37	1	<i>Acer x freemanii</i>	Freeman's Maple	70mm dbh	GOOD	To Remain	1310 Chapman Mills Dr
38	1	<i>Acer x freemanii</i>	Freeman's Maple	70mm dbh	GOOD	To Remain	1310 Chapman Mills Dr
39	1	<i>Acer x freemanii</i>	Freeman's Maple	70mm dbh	GOOD	To Remain	1310 Chapman Mills Dr
40	1	<i>Picea glauca</i>	White Spruce	70mm dbh	GOOD	To Remain	1310 Chapman Mills Dr
41	1	<i>Picea glauca</i>	White Spruce	70mm dbh	GOOD	To Remain	1310 Chapman Mills Dr
42	1	<i>Picea glauca</i>	White Spruce	70mm dbh	POOR	To Remain	1310 Chapman Mills Dr
43	1	<i>Picea glauca</i>	White Spruce	70mm dbh	GOOD	To Remain	1310 Chapman Mills Dr
44	1	<i>Picea glauca</i>	White Spruce	70mm dbh	DEAD	To be removed	1310 Chapman Mills Dr
45	1	<i>Picea glauca</i>	White Spruce	70mm dbh	GOOD	To Remain	1310 Chapman Mills Dr
46	1	<i>Acer saccharum</i>	Sugar Maple	70mm dbh	GOOD	To Remain	1310 Chapman Mills Dr
47	1	<i>Acer saccharum</i>	Sugar Maple	70mm dbh	GOOD	To Remain	1310 Chapman Mills Dr
48	1	<i>Acer saccharum</i>	Sugar Maple	70mm dbh	GOOD	To Remain	1310 Chapman Mills Dr
49	1	<i>Acer saccharum</i>	Sugar Maple	70mm dbh	GOOD	To be removed	1310 Chapman Mills Dr
50	1	<i>Acer saccharum</i>	Sugar Maple	70mm dbh	GOOD	To Remain	1310 Chapman Mills Dr
51	1	<i>Picea glauca</i>	White Spruce	70mm dbh	GOOD	To Remain	1310 Chapman Mills Dr
52	1	<i>Picea glauca</i>	White Spruce	70mm dbh	GOOD	To Remain	1310 Chapman Mills Dr
53	1	<i>Picea glauca</i>	White Spruce	70mm dbh	GOOD	To Remain	1310 Chapman Mills Dr
54	1	<i>Gleditsia triacanthos</i>	Honey Locust	70mm dbh	GOOD	To Remain	1310 Chapman Mills Dr
55	1	<i>Picea glauca</i>	White Spruce	70mm dbh	GOOD	To Remain	1310 Chapman Mills Dr
56	1	<i>Acer spp.</i>	Maple	70mm dbh	GOOD	To Remain	1310 Chapman Mills Dr
57	1	<i>Acer spp.</i>	Maple	70mm dbh	GOOD	To Remain	1310 Chapman Mills Dr
58	1	<i>Acer spp.</i>	Maple	70mm dbh	GOOD	To Remain	1310 Chapman Mills Dr
59	1	<i>Gleditsia triacanthos</i>	Honey Locust	70mm dbh	GOOD	To Remain	1310 Chapman Mills Dr
60	1	<i>Gleditsia triacanthos</i>	Honey Locust	70mm dbh	GOOD	To Remain	1310 Chapman Mills Dr
61	1	<i>Gleditsia triacanthos</i>	Honey Locust	70mm dbh	GOOD	To Remain	1310 Chapman Mills Dr
62	1	<i>Gleditsia triacanthos</i>	Honey Locust	70mm dbh	GOOD	To Remain	1310 Chapman Mills Dr
63	1	<i>Gleditsia triacanthos</i>	Honey Locust	70mm dbh	GOOD	To Remain	1310 Chapman Mills Dr
64	1	<i>Gleditsia triacanthos</i>	Honey Locust	70mm dbh	GOOD	To Remain	1310 Chapman Mills Dr
65	1	<i>Gleditsia triacanthos</i>	Honey Locust	70mm dbh	GOOD	To Remain	1310 Chapman Mills Dr
66	1	<i>Gleditsia triacanthos</i>	Honey Locust	70mm dbh	GOOD	To Remain	1310 Chapman Mills Dr
67	1	<i>Gleditsia triacanthos</i>	Honey Locust	70mm dbh	GOOD	To Remain	1310 Chapman Mills Dr
68	1	<i>Gleditsia triacanthos</i>	Honey Locust	70mm dbh	GOOD	To Remain	1310 Chapman Mills Dr
69	1	<i>Gleditsia triacanthos</i>	Honey Locust	70mm dbh	GOOD	To Remain	1310 Chapman Mills Dr
70	1	<i>Gleditsia triacanthos</i>	Honey Locust	70mm dbh	GOOD	To Remain	1310 Chapman Mills Dr
71	1	<i>Ginkgo biloba</i>	Maidenhair Tree	70mm dbh	GOOD	To Remain	City of Ottawa
72	1	<i>Ginkgo biloba</i>	Maidenhair Tree	70mm dbh	GOOD	To Remain	City of Ottawa
73	1	<i>Ginkgo biloba</i>	Maidenhair Tree	70mm dbh	GOOD	To Remain	City of Ottawa
74	1	<i>Acer x freemanii</i>	Freeman's Maple	70mm dbh	GOOD	To Remain	1310 Chapman Mills Dr
75	1	<i>Acer x freemanii</i>	Freeman's Maple	70mm dbh	GOOD	To Remain	1310 Chapman Mills Dr
76	1	<i>Acer x freemanii</i>	Freeman's Maple	70mm dbh	GOOD	To Remain	1310 Chapman Mills Dr
77	1	<i>Acer x freemanii</i>	Freeman's Maple	70mm dbh	GOOD	To Remain	1310 Chapman Mills Dr
78	1	<i>Acer x freemanii</i>	Freeman's Maple	70mm dbh	GOOD	To Remain	1310 Chapman Mills Dr
79	1	<i>Acer x freemanii</i>	Freeman's Maple	70mm dbh	GOOD	To Remain	1310 Chapman Mills Dr
80	1	<i>Acer x freemanii</i>	Freeman's Maple	70mm dbh	GOOD	To Remain	1310 Chapman Mills Dr
81	1	<i>Acer x freemanii</i>	Freeman's Maple	70mm dbh	GOOD	To Remain	1310 Chapman Mills Dr
82	1	<i>Acer x freemanii</i>	Freeman's Maple	70mm dbh	GOOD	To Remain	1310 Chapman Mills Dr
83	1	<i>Picea glauca</i>	White Spruce	70mm dbh	GOOD	To Remain	1310 Chapman Mills Dr
84	1	<i>Picea glauca</i>	White Spruce	70mm dbh	GOOD	To Remain	1310 Chapman Mills Dr
85	1	<i>Picea glauca</i>	White Spruce	70mm dbh	GOOD	To Remain	1310 Chapman Mills Dr
86	1	<i>Picea glauca</i>	White Spruce	70mm dbh	GOOD	To Remain	1310 Chapman Mills Dr
87	1	<i>Quercus macrocarpa</i>	Bur Oak	70mm dbh	GOOD	To Remain	City of Ottawa
88	1	<i>Picea glauca</i>	White Spruce	70mm dbh	GOOD	To Remain	1310 Chapman Mills Dr
89	1	<i>Picea glauca</i>	White Spruce	70mm dbh	GOOD	To Remain	1310 Chapman Mills Dr
90	1	<i>Picea glauca</i>	White Spruce	70mm dbh	GOOD	To Remain	1310 Chapman Mills Dr
91	1	<i>Quercus macrocarpa</i>	Bur Oak	70mm dbh	GOOD	To Remain	City of Ottawa
92	1	<i>Picea glauca</i>	White Spruce	70mm dbh	GOOD	To Remain	1310 Chapman Mills Dr
93	1	<i>Quercus macrocarpa</i>	Bur Oak	70mm dbh	GOOD	To Remain	City of Ottawa
94	1	<i>Picea glauca</i>	White Spruce	70mm dbh	DEAD	To be removed	1310 Chapman Mills Dr
95	1	<i>Picea glauca</i>	White Spruce	70mm dbh	GOOD	To Remain	1310 Chapman Mills Dr
96	1	<i>Gleditsia triacanthos</i>	Honey Locust	70mm dbh	GOOD	To Remain	City of Ottawa
97	1	<i>Gleditsia triacanthos</i>	Honey Locust	70mm dbh	GOOD	To Remain	City of Ottawa
98	1	<i>Acer x freemanii</i>	Freeman's Maple	70mm dbh	GOOD	To Remain	1310 Chapman Mills Dr
99	1	<i>Gleditsia triacanthos</i>	Honey Locust	70mm dbh	GOOD	To Remain	1310 Chapman Mills Dr
100	1	<i>Gleditsia triacanthos</i>	Honey Locust	70mm dbh	GOOD	To Remain	1310 Chapman Mills Dr
101	1	<i>Gleditsia triacanthos</i>	Honey Locust	70mm dbh	GOOD	To Remain	1310 Chapman Mills Dr
102	1	<i>Gleditsia triacanthos</i>	Honey Locust	70mm dbh	GOOD	To Remain	1310 Chapman Mills Dr
103	1	<i>Gleditsia triacanthos</i>	Honey Locust	70mm dbh	GOOD	To Remain	1310 Chapman Mills Dr
104	1	<i>Gleditsia triacanthos</i>	Honey Locust	70mm dbh	GOOD	To Remain	1310 Chapman Mills Dr
105	1	<i>Gleditsia triacanthos</i>	Honey Locust	70mm dbh	GOOD	To Remain	1310 Chapman Mills Dr
106	1	<i>Gleditsia triacanthos</i>	Honey Locust	70mm dbh	GOOD	To Remain	1310 Chapman Mills Dr
107	1	<i>Picea glauca</i>	White Spruce	70mm dbh	GOOD	To Remain	1310 Chapman Mills Dr

NOTE: SIZE OF TREES ARE ESTIMATED. TREES ON SCHOOL BOARD PROPERTY WERE PLANTED IN 2022.

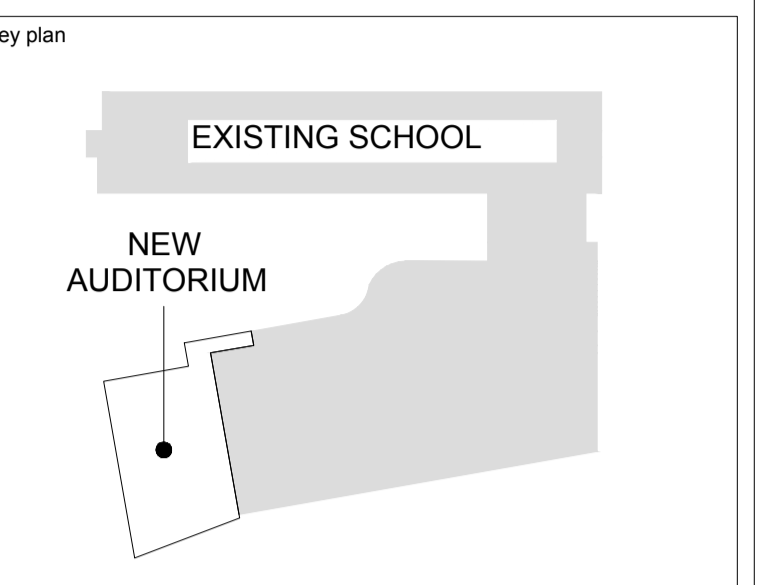

no.	date	revision/issue	by
2	January 16th 2026	Issued for Site Plan Control Application	LC
1	December 19th 2025	Issued for 33% Review	ML

LANDSCAPE ARCHITECTS

JAMES B. LENNOX & ASSOCIATES INC.
 LANDSCAPE ARCHITECTS

3332 CARLING AVE. OTTAWA, ONTARIO K2H 8S8
 Tel. (613) 722-5168 Fax. (866) 343-3942

consultants

PROVENCHE ROY
 PROVENCHE ROY ASSOCIÉS ARCHITECTES INC. T 613 595 6339
 47 Rue Clarendon, Suite 404 T 613 680 6339
 OTTAWA, ONTARIO, CANADA K1N 9K1 PROVENCHEROY.CA

CUNLIFFE & ASSOCIATES
 CONSULTING STRUCTURAL ENGINEERS

LRJ
 LANDSCAPE ARCHITECTS

northpoint

professional stamp

project title

ESP PIERRE-DE-BLOIS AUDITORIUM ADDITION

Project Address 1310 Chapman Mills Drive, Nepean, ON K2J 6L9

drawing title

DETAILS AND EXISTING TREE LIST

date	November 17, 2025	job. no.	
scale			2622
drawn	ML		
approved	JL		
plot date	2025-12-19 11:55:12 AM		L002

1. DO NOT SCALE FROM THIS DRAWING
 2. CONTRACTOR TO VERIFY ALL DIMENSIONS AND NOTIFY THE ARCHITECT OF ANY DISCREPANCIES BEFORE WORK COMMENCES
 3. THIS DRAWING TO BE READ IN CONJUNCTION WITH THE FOLLOWING DRAWINGS: STRUCTURAL, MECHANICAL, ELECTRICAL