

LEGEND

- 30m3 SOIL VOLUME AT A 1.5m DEPTH PROPOSED DECIDUOUS TREE
- 25m3 SOIL VOLUME AT A 1.5m DEPTH PROPOSED CONIFEROUS TREE
- PROPOSED SHRUBS / ORNAMENTAL GRASSES
- EXISTING GRASS TO REMAIN
- EXISTING TREE TO REMAIN
- EXISTING TREE TO BE REMOVED
- PROPOSED TYPE 1 PRECAST CONCRETE PAVERS
- PROPOSED TYPE 2 PRECAST CONCRETE PAVERS
- PROPOSED TYPE 3 PRECAST CONCRETE PAVERS
- PROPOSED SOD
- TREE PROTECTION FENCE
- PROPOSED 7-RING BIKE RACK
- PROPOSED 2.1m HT. CHAIN LINK FENCE
- PROPOSED 1.5m HT. CHAIN LINK FENCE

PROPOSED PLANT LIST

KEY	QTY	BOTANICAL NAME	COMMON NAME	SIZE	CONDITION	REMARKS
TREES						
*FM	2	Acer x freemanii	Freeman's Maple	50mm ø	B&B	
GI	3	Ginkgo biloba 'Princeton Sentry'	Princeton Ginkgo	50mm ø	B&B	Male tree
*HL	5	Gleditsia triacanthos	Honey Locust	50mm ø	B&B	
*SM	2	Acer saccharum	Sugar Maple	50mm ø	B&B	
*WS	2	Picea glauca	White Spruce	2000 mm ht.	B&B	
SHRUBS						
AC	23	Ribes alpinum	Alpine Currant	600 mm ht.	Potted	Space 1000mm o.c
*WC	63	Thuja occidentalis 'Clumps'	White Cedar Clumps	2000 mm ht.	Bare root	Space 600mm o.c
ORNAMENTAL GRASSES						
KF	45	Calamagrostis 'Karl Foerster'	Feather Reed Grass	250mm pot.	Potted	Space 800mm o.c

* INDICATES NATIVE SPECIES. ALL PLANT MATERIAL IS PROPOSED ON PRIVATE PROPERTY

GENERAL NOTES:

1. It is the responsibility of the appropriate contractor or official to report any errors, omissions or discrepancies on this plan with actual site conditions to the Landscape Architect before proceeding with construction.
2. The contractor is to notify all utility companies and authorities prior to any excavation and ascertain locations of underground services.
3. The contractor is to reinstate all areas and items damaged as a result of construction activity.
4. The contractor is to comply with all pertinent codes and by-laws.
5. The contractor is to maintain a positive surface run-off throughout the entire construction period.
6. The Landscape Architect is not responsible for subsurface conditions.
7. The contractor is to identify all existing trees to remain on site with the Landscape Architect prior to construction.
8. The contractor is to stake the proposed location of all plant material in conjunction with the Landscape Architect prior to excavation.
9. Minimum distances for selected deciduous trees are as follows:
 - Building Foundations 4.5m
 - Sidewalks 1.5m
 - Public Streets 2.5m
 - Underground Infrastructure 2.0m
10. All trees within 1m of underground utility trenches are to be excavated by hand.
11. Remove all protective wrapping from tree trunks after installation.
12. Staking of trees shall only be performed if necessary.
13. Ensure that mulch is pulled back a min. distance of 75mm from base of tree trunk.

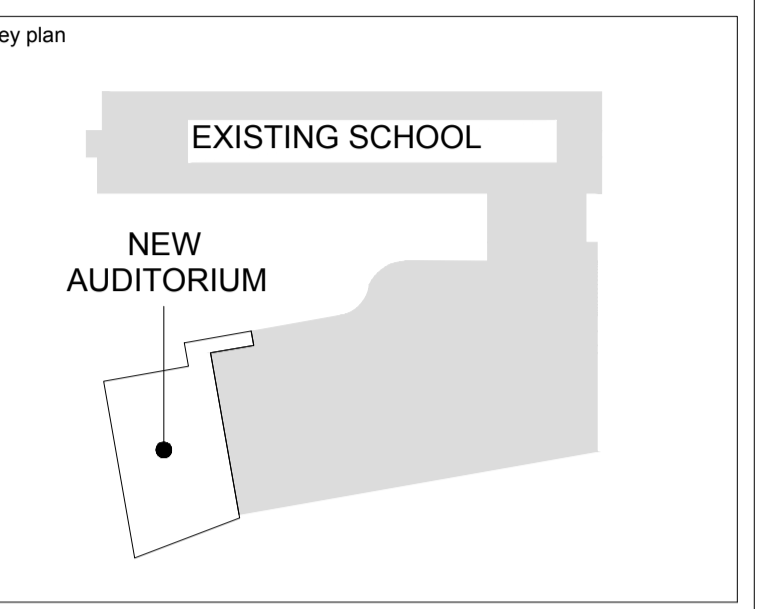

40 YEAR CANOPY CALCULATION:

-48,578m ² site area
-50 Large existing deciduous trees (154m ² ea)
-36 medium existing deciduous trees (79m ² ea)
-21 large existing coniferous trees (79m ² ea)
-4 large deciduous trees proposed (154m ² ea)
-8 medium deciduous trees proposed (79m ² ea)
-2 large coniferous trees proposed (79m ² ea)
=13,609m² canopy cover =28% canopy cover

*Large deciduous tree calculated at 14m spread, medium deciduous tree calculated at 10m spread and large coniferous tree calculated at 10m spread.

LEGAL DESCRIPTION:
 PARTS OF LOT 14 AND 15
 CONCESSION 3 (RIDEAU FRONT)
 PIN: 045950130 & 04591752

9	May 5th, 2026	Re-issued for Site Plan Control	ML
8	April 24th, 2026	Revised per City comments	ML
7	April 1st, 2026	Revised per GRC Comments	ML
6	March 27th, 2026	Issued for Building Permit	ML
5	March 23rd, 2026	Revised per City comments	ML
4	February 9th, 2026	Issued for 66% Review	ML
3	February 4th, 2026	Revised per City comments	ML
2	January 16th, 2026	Issued for Site Plan Control Application	LC
1	December 19th, 2025	Issued for 33% Review	ML
no.	date	revision/issue	by

LANDSCAPE ARCHITECTS
JAMES B. LENNOX & ASSOCIATES INC.
 LANDSCAPE ARCHITECTS
 3333 CARLING AVE OTTAWA, ONTARIO K2H 3A8
 Tel. (613) 722-5168 Fax. 1(866) 343-3942

consultants
PROVENCHER ROY
 PROVENCHER ROY ASSOCIÉS ARCHITECTES INC. T 613 566 6339
 47 Rue Clarendon, Suite 400 T 613 686 6339
 OTTAWA, ONTARIO, CANADA K1N 8N1 PROVENCHEROY.CA

CUNLIFFE & ASSOCIATES
 CONSULTING STRUCTURAL ENGINEERS

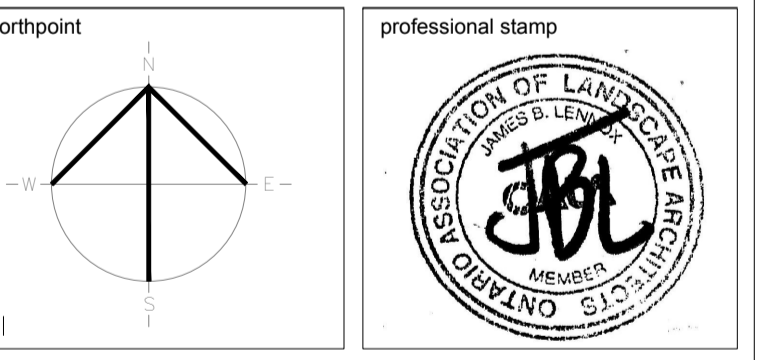

project title
ESP PIERRE-DE-BLOIS AUDITORIUM ADDITION
 Project Address 1310 Chapman Mills Drive, Nepean, ON K2J 6L9

drawing title
TREE CONSERVATION REPORT & LANDSCAPE PLAN

date	May 8th, 2026	job. no.	
scale			2622
drawn	ML		
approved	JL		
plot date	2026-02-25 11:55:12 AM		L001

1. DO NOT SCALE FROM THIS DRAWING
 2. CONTRACTOR TO VERIFY ALL DIMENSIONS AND NOTIFY THE ARCHITECT OF ANY DISCREPANCIES BEFORE WORK COMMENCES
 3. THIS DRAWING TO BE READ IN CONJUNCTION WITH THE FOLLOWING DRAWINGS: STRUCTURAL, MECHANICAL, ELECTRICAL

APPROVED
 By Sole Soyak at 4:15 pm, May 15, 2026

S. Soyak
SOLE SOYAK
 PLANNER II
 PLANNING, DEVELOPMENT AND BUILDING SERVICES
 DEPARTMENT, CITY OF OTTAWA



