

- GENERAL NOTES:**
- IT IS THE RESPONSIBILITY OF THE APPROPRIATE CONTRACTOR OR OFFICIAL TO REPORT ANY ERRORS, OMISSIONS OR DISCREPANCIES ON THIS PLAN WITH ACTUAL SITE CONDITIONS TO THE LANDSCAPE ARCHITECT BEFORE PROCEEDING WITH CONSTRUCTION.
 - THE CONTRACTOR IS TO NOTIFY ALL UTILITY COMPANIES AND AUTHORITIES PRIOR TO ANY EXCAVATION AND ASCERTAIN LOCATIONS OF UNDERGROUND SERVICES.
 - THE CONTRACTOR IS TO RESTORE ALL AREAS AND ITEMS DAMAGED AS A RESULT OF CONSTRUCTION ACTIVITY.
 - THE CONTRACTOR IS TO COMPLY WITH ALL PERTINENT CODES AND BY-LAWS.
 - THE CONTRACTOR IS TO MAINTAIN A POSITIVE SURFACE RUN-OFF THROUGHOUT THE ENTIRE CONSTRUCTION PERIOD.
 - THE LANDSCAPE ARCHITECT IS NOT RESPONSIBLE FOR SUBSURFACE CONDITIONS.
 - THE CONTRACTOR IS TO IDENTIFY ALL EXISTING TREES TO REMAIN ON SITE WITH THE LANDSCAPE ARCHITECT PRIOR TO CONSTRUCTION.
 - THE CONTRACTOR IS TO STAKE THE PROPOSED LOCATION OF ALL PLANT MATERIAL IN CONJUNCTION WITH THE LANDSCAPE ARCHITECT PRIOR TO EXCAVATION.
 - MINIMUM DISTANCES FOR SELECTED DECIDUOUS TREES ARE AS FOLLOWS:
 - BUILDING FOUNDATIONS - 7.5M
 - SIDEWALKS - 1.5M
 - PUBLIC STREETS - 2.5M
 - UNDERGROUND INFRASTRUCTURE - 2.0M
 - ALL TREES WITHIN 1M OF UNDERGROUND UTILITY TRENCHES ARE TO BE EXCAVATED BY HAND.
 - REMOVE ALL PROTECTIVE WRAPPING FROM TREE TRUNKS AFTER INSTALLATION.
 - STAKING OF TREES SHALL ONLY BE PERFORMED IF NECESSARY.
 - ENSURE THAT MULCH IS PULLED BACK A MINIMUM DISTANCE OF 75MM FROM BASE OF TREE TRUNK.

EXISTING TREE LIST								
KEY	QTY	BOTANICAL NAME	COMMON NAME	SIZE	CONDITION	CRZ	ACTION	OWNERSHIP
1	1	<i>Ulmus spp.</i>	Elm	360mm dbh	GOOD	7200mm	To be removed	1773 Baseline Rd.
2	1	<i>Acer negundo</i>	Manitoba Maple	110mm dbh	FAIR	2200mm	To be removed	1773 Baseline Rd.
3	1	<i>Thuja occidentalis</i>	Eastern White Cedar	100-150mm dbh	GOOD	3000mm	To be removed	1773 & 1769 Baseline Rd.
4	1	<i>Acer negundo</i>	Manitoba Maple	3x160-180mm dbh	GOOD	3600mm	To be removed	1767 Baseline Rd.
5	1	<i>Fraxinus spp.</i>	Ash	140,160mm dbh	DEAD	3200mm	To be removed	1767 Baseline Rd.
6	1	<i>Acer negundo</i>	Manitoba Maple	340mm dbh	GOOD	6800mm	To be removed	1767 Baseline Rd.
7	1	<i>Thuja occidentalis</i>	Eastern White Cedar	100-150mm dbh	GOOD	3000mm	To Remain	1767, 1773 Baseline Rd. & 1772 Gage crs.
8	1	<i>Thuja occidentalis</i>	Eastern White Cedar	100-150mm dbh	GOOD	3000mm	To Remain	1773 Baseline Rd. & 1815 Baseline Rd.

PROPOSED PLANT LIST						
KEY	QTY	BOTANICAL NAME	COMMON NAME	SIZE	CONDITION	REMARKS
DECIDUOUS TREES						
AF	2	<i>Acer x Freemanii</i> 'Armstrong'	Armstrong Maple	50mm cal.	B&B	
CO	3	<i>Celtis occidentalis</i>	Hackberry	50mm cal.	B&B	
SHRUBS						
Rr	16	<i>Rosa rugosa</i>	Rugosa Rose	800mm ht.	Potted	Space 1000mm o.c.
Ss	10	<i>Sorbaria sorbifolia</i> 'Sem'	Sem False Spirea	600mm ht.	Potted	Space 1000mm o.c.
Tm	7	<i>Taxus x media</i> 'Densiformis'	Dense Spreading Yew	500 mm spr.	Potted	Space 1000mm o.c.
PERENNIALS/ GRASSES						
hs	18	<i>Hemerocallis</i> 'Stella D'Oro'	Stella D'Oro Day Lily	150mm pot	Potted	Space 300mm o.c.
hr	20	<i>Hosta</i> 'Royal Standard'	Royal Standard Hosta	100mm pot	Potted	Space 400mm o.c.
st	10	<i>Sedum telephium</i> 'Autumn Joy'	Autumn Joy Sedum	150mm pot	Potted	Space 400mm o.c.
pv	24	<i>Panicum virgatum</i> 'Heavy Metal'	Heavy Metal Switch Grass	250mm pot	Potted	Space 600mm o.c.

TREE PLANTING NOTES:

- ALL TREES ARE PROPOSED ON PRIVATE PROPERTY.
- PROPOSED TREES SPACING: MIN. 7m O.C.
- ALL TREES PROPOSED WITH A SOIL DEPTH OF 1.5m.
- SOIL VOLUME REQUIREMENTS:

TREE TYPE / SIZE	SINGLE TREE SOIL VOLUME (m ³)	MULTIPLE TREE SOIL VOLUME (m ³ /tree)
Ornamental / columnar	15	9
Small	20	12
Medium / conifer	25	15
Large	30	18

LEGAL DESCRIPTION:
 LOTS 351 AND 352
 REGISTERED PLAN 372115
 CITY OF OTTAWA

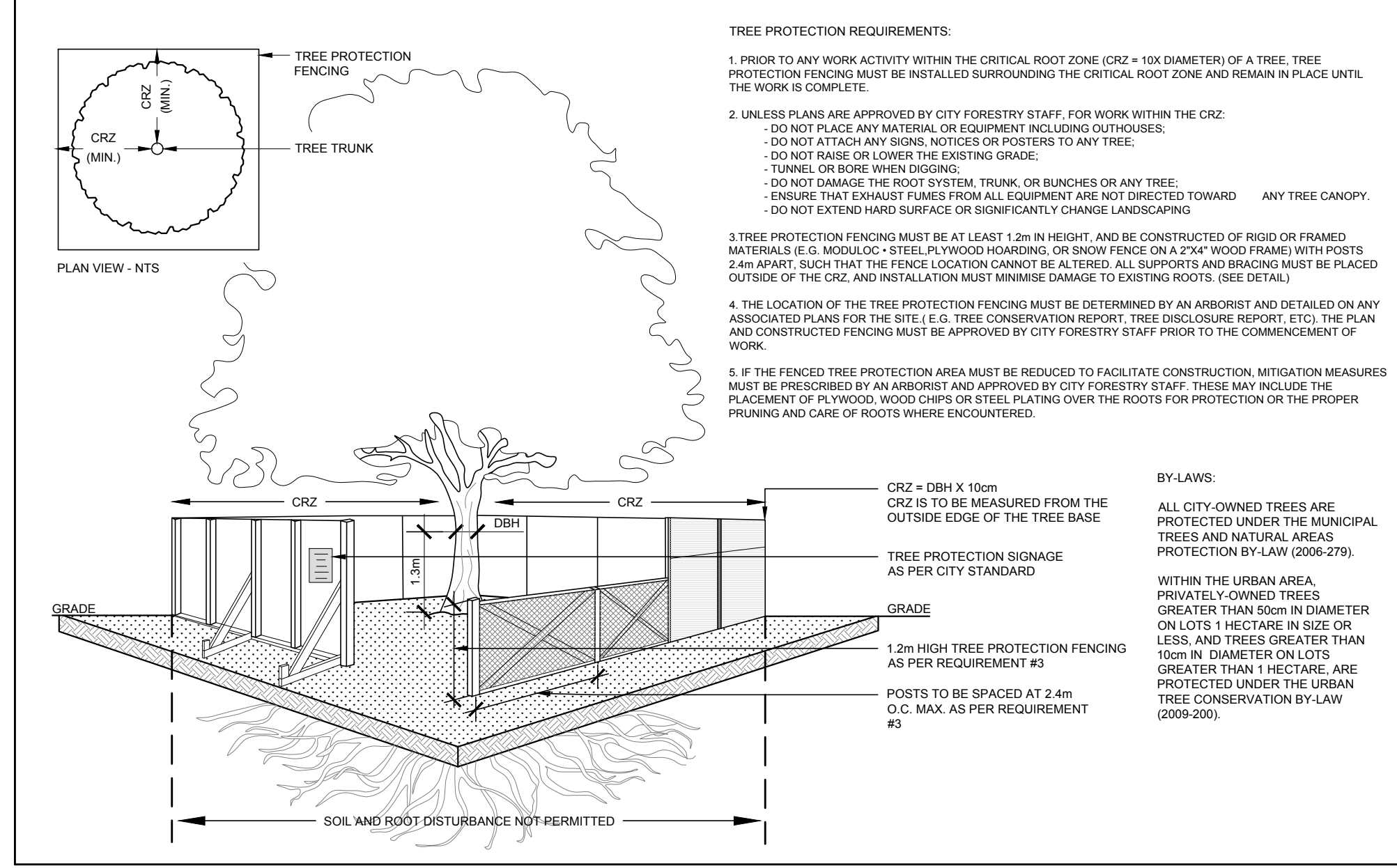
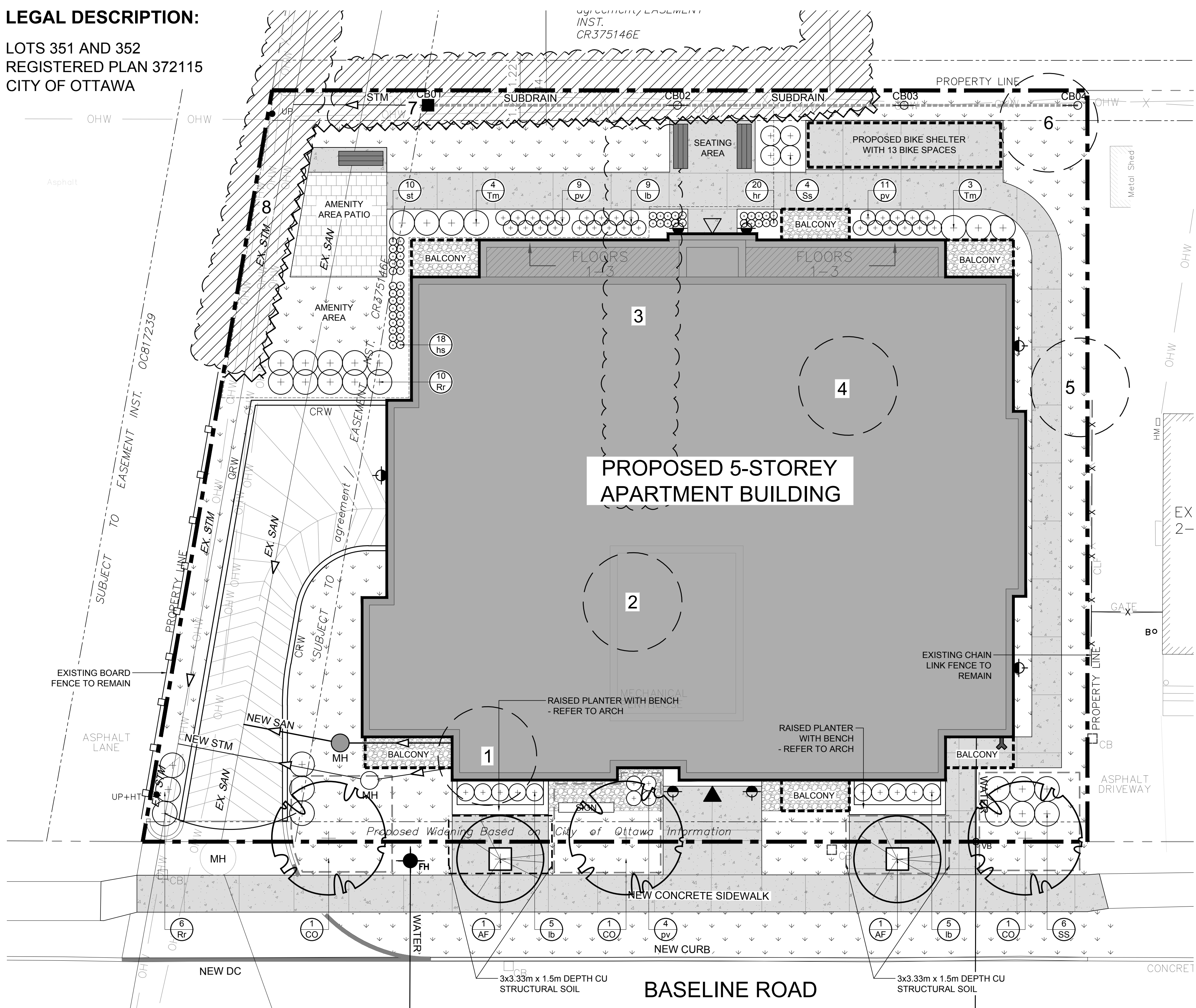

2 TREE PROTECTION FENCE SCALE NTS

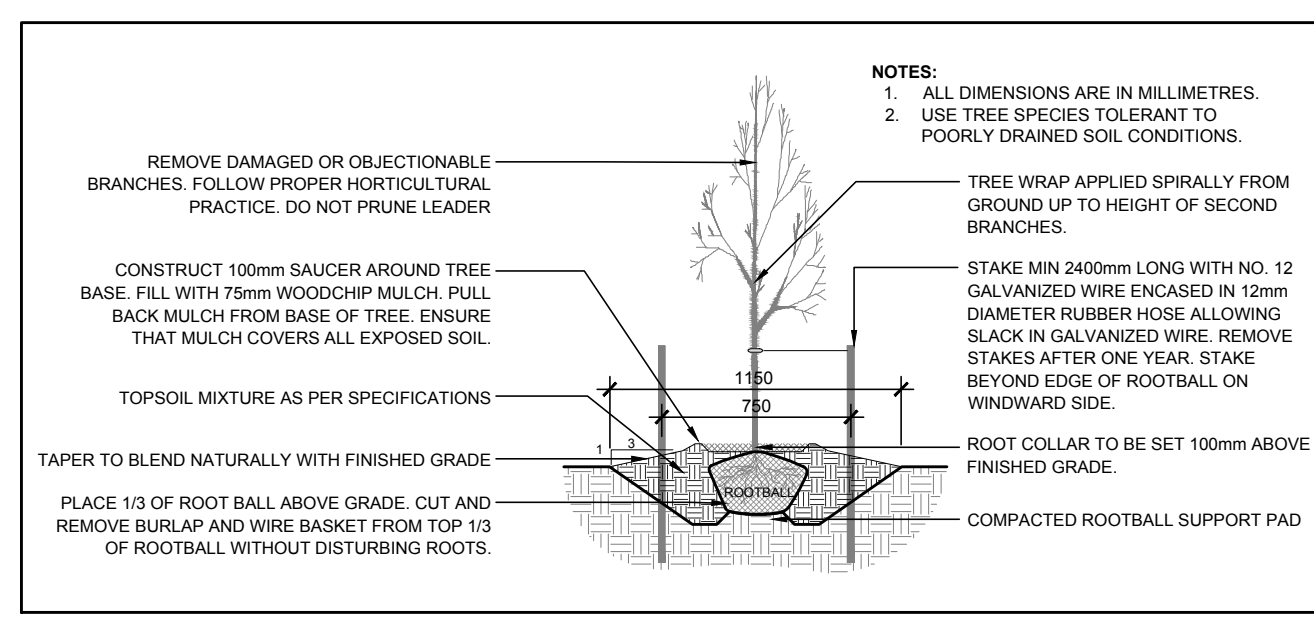

3 DECIDUOUS TREE PLANTING SCALE NTS

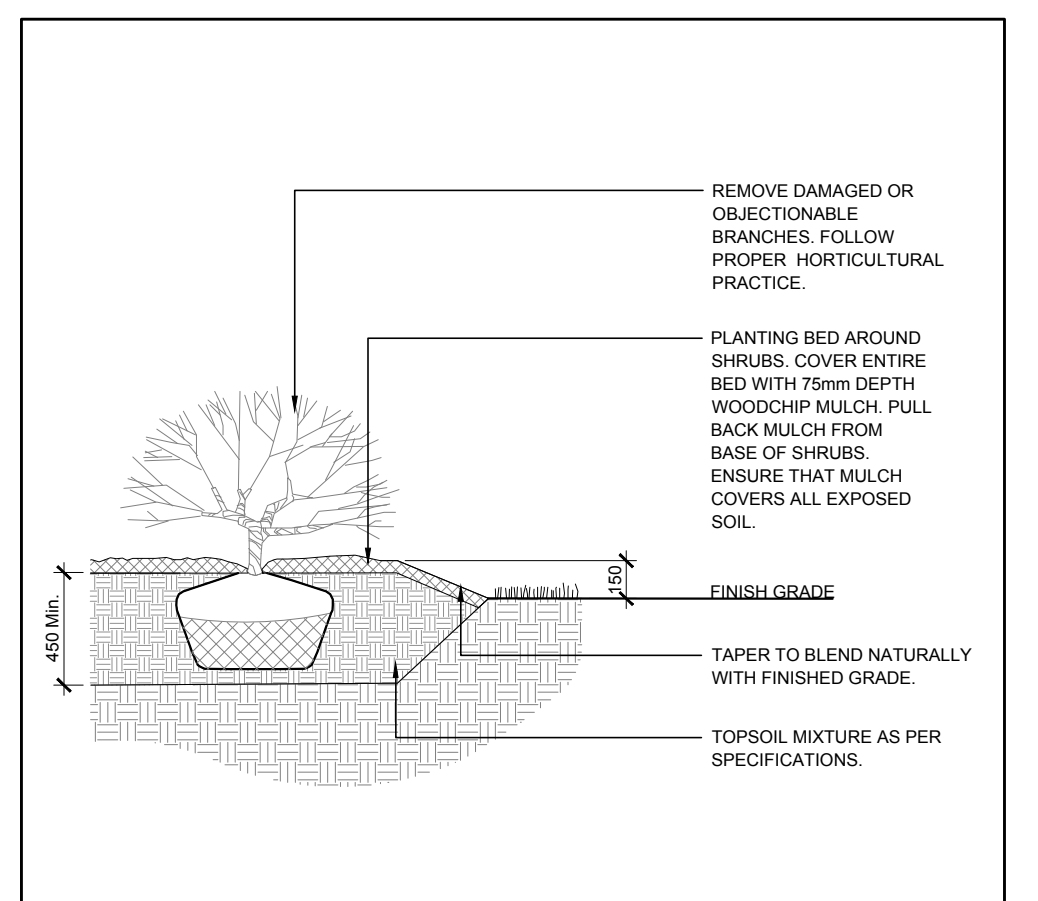

4 SHRUB PLANTING SCALE NTS

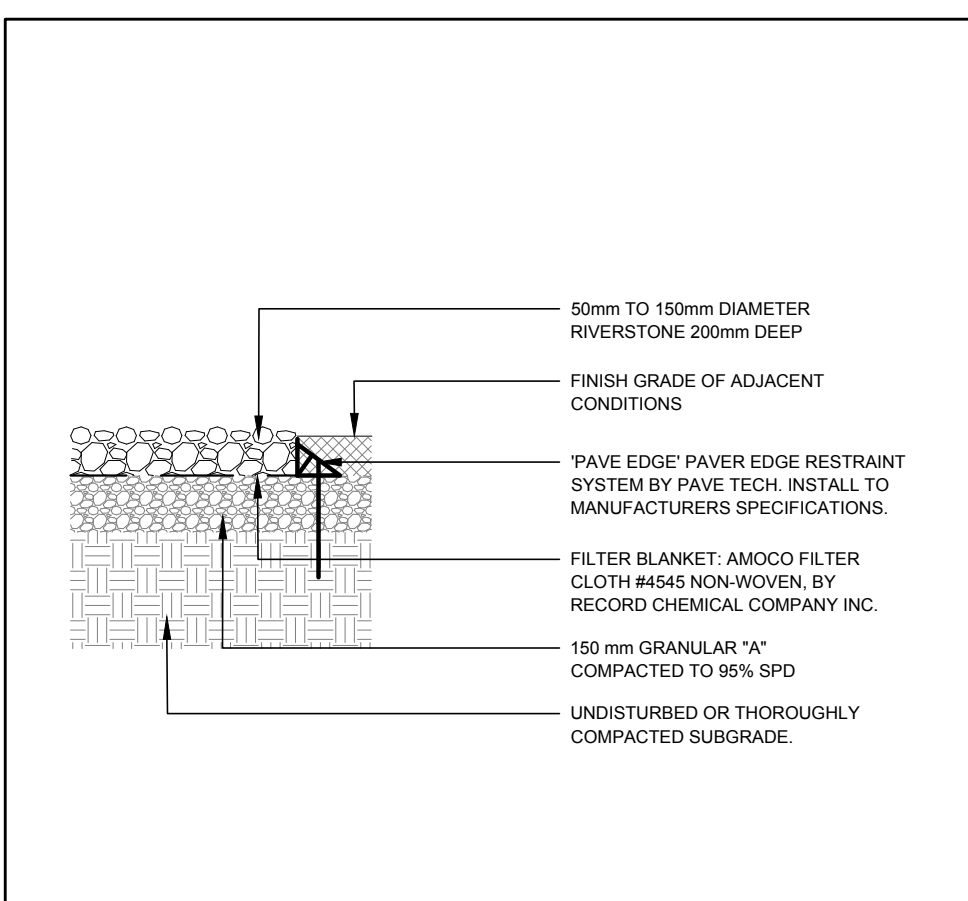

5 RIVERSTONE SCALE NTS

CLIENT

PHOENIX HOMES
 SINCE 1988

CONSULTANTS

ARCHITECTS: **M. David Blakely Architect Inc.**
 222 Prince of Wales Dr. Suite 101 Ottawa, ON, Canada
 Phone: (613) 224-8811 Fax: (613) 224-7942

CIVIL ENGINEERS: **ARCADIS**
 333 Preston Street - Suite 500
 Ottawa, ON K1S 3N4 Canada
 Tel: (613) 225-1311 www.arcadis.com

SURVEYORS: **ANNIS, O'SULLIVAN, VOLLEBEKK LTD.**
 14 Concorde Glen, Suite 500
 Nepean, ON K2E 7S8
 Phone: (613) 727-0850 / Fax: (613) 727-1079

LEGEND

- EXISTING HEDGE TO REMAIN
- EXISTING HEDGE TO BE REMOVED
- EXISTING TREE TO REMAIN
- EXISTING TREE TO BE REMOVED
- PROPOSED DECIDUOUS TREE
- SOIL VOLUME REQUIREMENTS AS PER TREE PLANTING NOTE 3
- PROPOSED COLUMNAR TREE
- PROPOSED SHRUBS / PERENNIALS
- PROPOSED SOD
- PROPOSED CONCRETE WALKWAY
- PROPOSED RIVERSTONE
- PROPOSED PRECAST CONCRETE PAVERS
- PROPOSED BENCH
- PROPERTY LINE
- EXISTING CHAIN LINK FENCE TO REMAIN
- EXISTING BOARD FENCE TO REMAIN
- TREE PROTECTION FENCE

No.	Issue	Date	WF	JL
1	ISSUED FOR REZONING	12/19/2025		

JAMES B. LENNOX & ASSOCIATES INC.
 LANDSCAPE ARCHITECTS
 3332 CARLING AVE. OTTAWA, ONTARIO K2H 5A8
 Tel: (613) 722-5168 Fax: (613) 722-3942

PROJECT
 1773 BASELINE RD.

DRAWING
 TREE CONSERVATION REPORT AND LANDSCAPE PLAN

STAMP

SCALE
 AS SHOWN

START DATE
 DECEMBER, 2025

PROJECT NO.
 26DCR2613

DRAWING NO.
 L.1

PROJECT NORTH

1 TREE CONSERVATION REPORT & LANDSCAPE PLAN SCALE 1:100

