

**COPYRIGHT**  
 This drawing has been prepared solely for the intended use, thus any reproduction or distribution for any purpose other than authorized by Arcadis is forbidden. Written dimensions shall have precedence over scaled dimensions. Contractors shall verify and be responsible for all dimensions and conditions on the job, and Arcadis shall be informed of any variations from the dimensions and conditions shown on the drawing. Shop drawings shall be submitted to Arcadis for general conformance before proceeding with fabrication.  
**Arcadis Architects (Canada) Inc.**

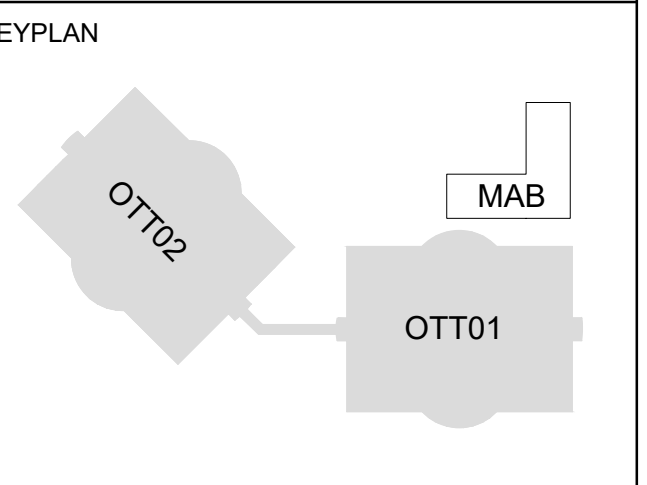

**ISSUES**

| No. | DESCRIPTION       | DATE       |
|-----|-------------------|------------|
| 1   | ISSUED FOR SPC #1 | 2025-12-12 |
| 2   | ISSUED FOR SPC #2 | 2026-05-08 |

- CONSULTANTS**
- ARUP**  
47 Clarence Street, Suite 202, Ottawa, ON, K1N 5P9
  - TEECOM**  
4770 Steeles Ave. E., Suite 100, Scarborough, ON, M1V 5P6
  - SENEZ CO**  
FIRE SCIENCE & ENGINEERING  
93 Skyway Avenue, Suite 102, Toronto, ON, M9W 6N6
  - TOTAL OPENING CONSULTANTS**  
895 Don Mills Rd., Suite 900, Toronto, ON M3C 1W3
  - CBRE**  
340 Albert Street, Suite 1900, Ottawa, ON, K1R 7Y6
  - Matrix**  
6131 Peach Street, Richmond, BC, V6V 2Z0

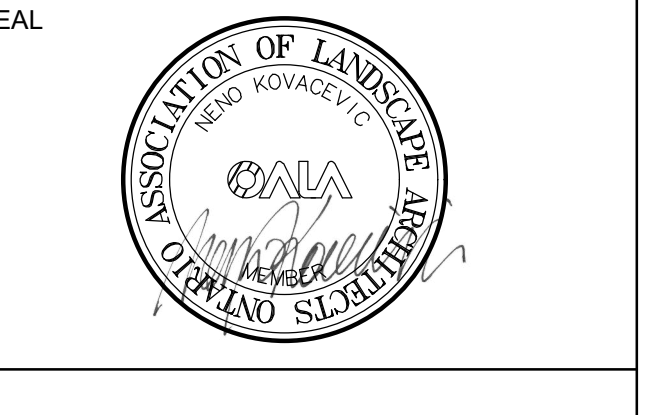

**SPC PACKAGE NOT FOR CONSTRUCTION**

**PRIME CONSULTANT**  
**ARCADIS**  
 333 Preston Street - Suite 500, Ottawa, ON K1S 5N4, Canada  
 Tel: 613 225 1311  
 www.arcadis.com

**PROJECT**  
**CISCO OTTAWA CAMPUS MAB**  
 2000 Innovation Drive, Kanata, ON K2K 3E8

|                             |                                |
|-----------------------------|--------------------------------|
| PROJECT NO:<br>MAB.30298433 | APPLICATION NO:<br>PC2025-0127 |
| DRAWN BY:<br>ARCADIS        | CHECKED BY:<br>BJ              |
| PROJECT MGR:<br>BJ          | APPROVED BY:<br>NK             |

**SHEET TITLE**  
**LANDSCAPE LAYOUT AND MATERIALS PLAN**

**SHEET NUMBER** L-100 **ISSUE** 2

- LEGEND**
- EXISTING TREES TO REMAIN
  - PROPOSED DECIDUOUS TREE
  - PROPOSED CONIFEROUS TREE
  - PROPOSED SPECIMEN SHRUB
  - NATIVE SEED MIX
  - PERENNIAL PLANTING
  - EXISTING SOD TO REMAIN
  - BOUND AGGREGATE PAVING
  - C.I.P. CONCRETE PAVING
  - GRAVEL
  - LOOSE SAND
  - TABLE AND CHAIRS
  - PROPOSED LIGHT STANDARD
  - EXISTING LIGHT STANDARD
  - ARMOURSTONE BOULDERS

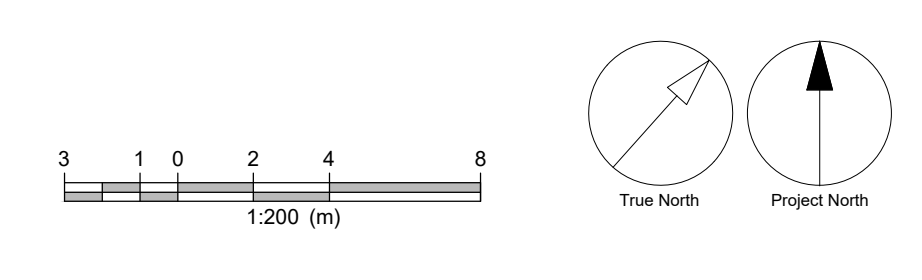

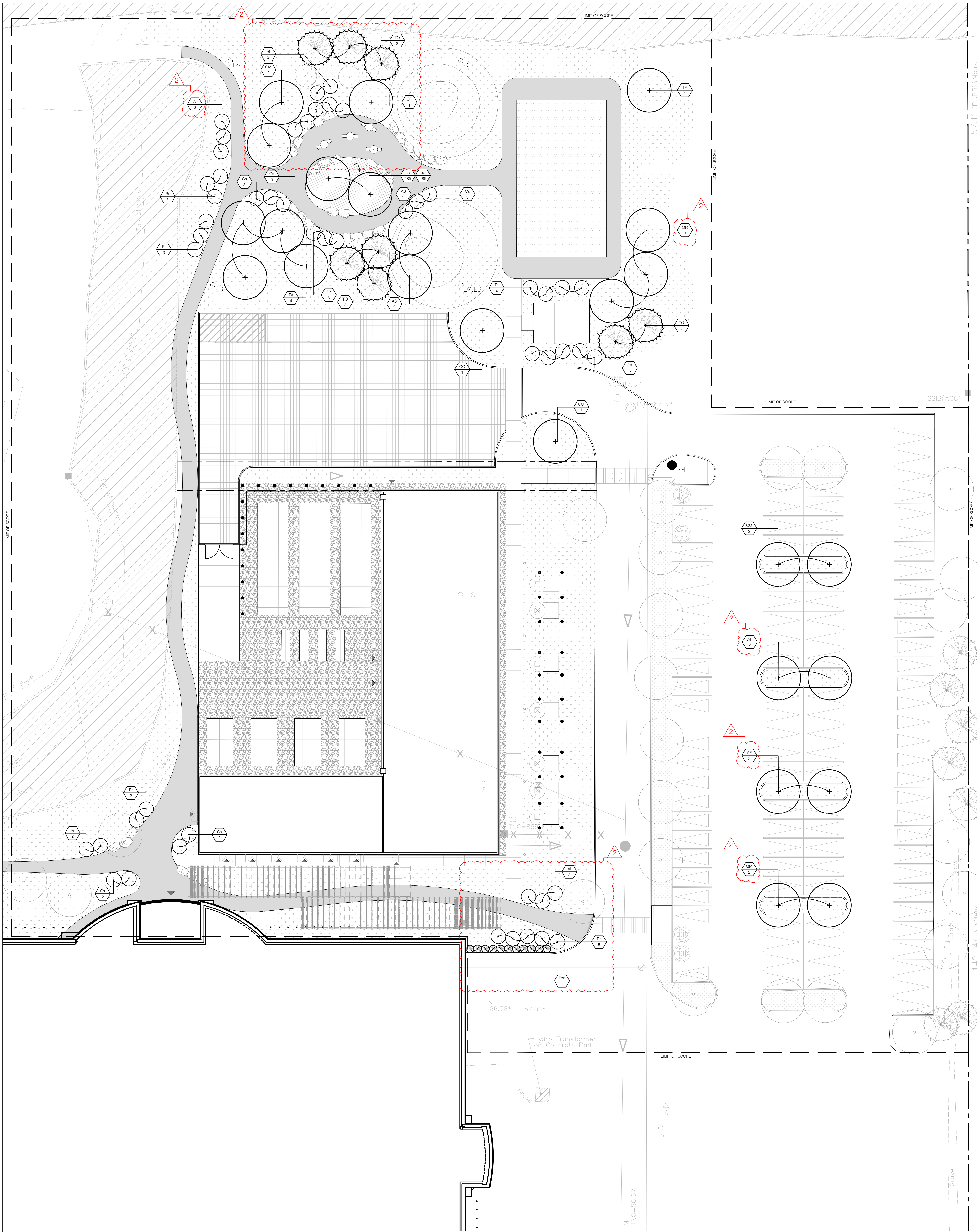

1 PLANTING PLAN  
L-200 1:200

**NATIVE PERENNIAL WILDFLOWER BLEND**  
8105 - NATIVE PERENNIAL WILDFLOWER BLEND BY OSC SEEDS OR APPROVED EQUAL

- 12% BLACK EYED SUSAN (RUDECKIA HIRTA)
- 5% BLANKET FLOWER (GAILLARDIA ARISTATA)
- 20% BLUE FLAX (LINUM PERENNE)
- 3% BUTTERFLY WEED (ASCLEPIAS TUBEROSA)
- 1% CANADA GOLDENROD (SOLIDAGO CANADENSIS)
- 5% EVENING PRIMROSE (OENOTHERA BIENNIS)
- 10% LANCE LEAF COREOPSIS (COREOPSIS LANCEOLATA)
- 5% OX EYE SUNFLOWER (HELIANTHUS HELIANTHOIDES)
- 15% PARTIDGE PEA (CHASMANTHUM LATIFOLIUM)
- 1% PRAIRIE BLAZING STAR (LIATRIS PSYCNOSTACHYA)
- 7% PURPLE CONEFLOWER (ECHINACEA PURPUREA)
- 5% SHASA DASY (CHRYSANTHEMUM MAXIMUM LUECANTHEMUM)
- 2% TALL WHITE BEARONTOUQUE (PENSTEMON DIGITALIS)
- 3% WILD BERGAMOT (MONARDA FISTULOSA)
- 5% WILD LUPINS (LUPINE PERENNIS)

SOW AT 25KG/HA (23 LBS/ACRE) OR 500G/180 SQ.M. FOR SMALLER AREAS  
TOTAL AREA SHOWN = 3647 m<sup>2</sup>

**PLANT LIST**

| KEY                     | QTY | BOTANICAL NAME                      | COMMON NAME             | SPACING     | SPECIFICATION/ NOTES | NATIVE | DROUGHT TOLERANT |
|-------------------------|-----|-------------------------------------|-------------------------|-------------|----------------------|--------|------------------|
| <b>Deciduous Trees</b>  |     |                                     |                         |             |                      |        |                  |
| AF                      | 4   | <i>Acer x Freemanii</i>             | Freeman Maple           | As per plan | 70mm WB              | X      |                  |
| AS                      | 4   | <i>Acer saccharum</i>               | Sugar Maple             | As per plan | 70mm WB              | X      |                  |
| CO                      | 4   | <i>Celtis occidentalis</i>          | Common Hackberry        | As per plan | 70mm WB              | X      |                  |
| TA                      | 5   | <i>Tilia americana</i>              | Basswood                | As per plan | 70mm WB              | X      |                  |
| QM                      | 4   | <i>Quercus Macrocarpa</i>           | Burr Oak                | As per plan | 70mm WB              | X      |                  |
| QR                      | 4   | <i>Quercus Rubra</i>                | Red Oak                 | As per plan | 70mm WB              | X      |                  |
| <b>Coniferous Trees</b> |     |                                     |                         |             |                      |        |                  |
| TO                      | 8   | <i>Thuja occidentalis</i>           | Eastern White Cedar     | As per plan | 70mm WB              | X      | X                |
| <b>Specimen Shrubs</b>  |     |                                     |                         |             |                      |        |                  |
| Al                      | 6   | <i>Amelanchier Laevis</i>           | Serviceberry            | As per plan | 80cm 5 gal           | X      |                  |
| Cs                      | 20  | <i>Cornus sericea</i>               | Red Osier Dogwood       | As per plan | 80cm 5 gal           | X      |                  |
| Rr                      | 15  | <i>Rosa rugosa</i>                  | Rugosa rose             | 1000mm O.C  | 80cm 5 gal           | X      | X                |
| Rt                      | 9   | <i>Rhus typhina 'Tiger Eyes'</i>    | Tiger Eye Cutleaf Sumac | As per plan | 80cm 5 gal           | X      | X                |
| Toe                     | 11  | <i>Thuja occidentalis 'Emerald'</i> | Emerald Cedar           | 1000mm O.C  | 80cm 5 gal           |        |                  |
| <b>Perennials</b>       |     |                                     |                         |             |                      |        |                  |
| cp                      | 185 | <i>Carex pensylvanica</i>           | Pennsylvania Sedge      | 450mm O.C   | 3 gal                | X      | X                |
| ep                      | 185 | <i>Echinacea purpurea</i>           | Purple Coneflower       | 450mm O.C   | 3 gal                | X      | X                |

**SOIL VOLUME MATRIX (REFER TO SOIL VOLUME PLAN)**

| PLANTING ZONES | VOLUME CALCULATION AT 1.5m SOIL DEPTH          | TREE QUANTITY | OTTAWA TARGET SOIL VOLUME (m <sup>3</sup> ) | DESIGN SOIL VOLUME (m <sup>3</sup> ) | ADEQUACY PERCENTAGE |
|----------------|--|---------------|---|--------------------------------------|---------------------|
| A              | 274m <sup>2</sup> x 1.5m = 411m <sup>3</sup>   | 8             | 144   | 411                                  | 288%                |
| B              | 385m <sup>2</sup> x 1.5m = 577.5m <sup>3</sup> | 9             | 162   | 577                                  | 356%                |
| C              | 72m <sup>2</sup> x 1.5m = 108m <sup>3</sup>    | 2             | 36  | 108                                  | 300%                |
| D              | 30m <sup>2</sup> x 1.5m = 45m <sup>3</sup>     | 1             | 30  | 45                                   | 150%                |
| E              | 182m <sup>2</sup> x 1.5m = 273m <sup>3</sup>   | 5             | 90  | 273                                  | 303%                |
| F              | 30m <sup>2</sup> x 1.5m = 45m <sup>3</sup>     | 1             | 30  | 45                                   | 150%                |
| G              | 30m <sup>2</sup> x 1.5m = 45m <sup>3</sup>     | 1             | 30  | 45                                   | 150%                |
| H              | 25m <sup>2</sup> x 1.5m = 37.5m <sup>3</sup>   | 2             | 36  | 37.5                                 | 104%                |
| I              | 25m <sup>2</sup> x 1.5m = 37.5m <sup>3</sup>   | 2             | 36  | 37.5                                 | 104%                |
| J              | 25m <sup>2</sup> x 1.5m = 37.5m <sup>3</sup>   | 2             | 36  | 37.5                                 | 104%                |
| K              | 25m <sup>2</sup> x 1.5m = 37.5m <sup>3</sup>   | 2             | 36  | 37.5                                 | 104%                |

- TREE PLANTING IN SENSITIVE CLAY**
- The landscape plans have been developed in accordance with the geotechnical report: Geotechnical Investigation, Proposed MAB Building, Cisco Campus, Ottawa, Ontario. Prepared by WSP Canada Inc., March 2, 2025.
  - The following City of Ottawa clay soils guideline applies: Guidelines for Tree Planting in Sensitive Marine Clay Soils (2017).
  - The soil volumes provided are sufficient for a reasonable chance of tree survival. All new trees meet the minimum soil volume requirements of the following, based on a depth of 1.5m below finished grade:
    - Where one tree is planted: minimum of 30m<sup>3</sup> of soil provided.
    - Where multiple trees share a continuous soil volume: minimum of 18m<sup>3</sup> of soil provided per tree.

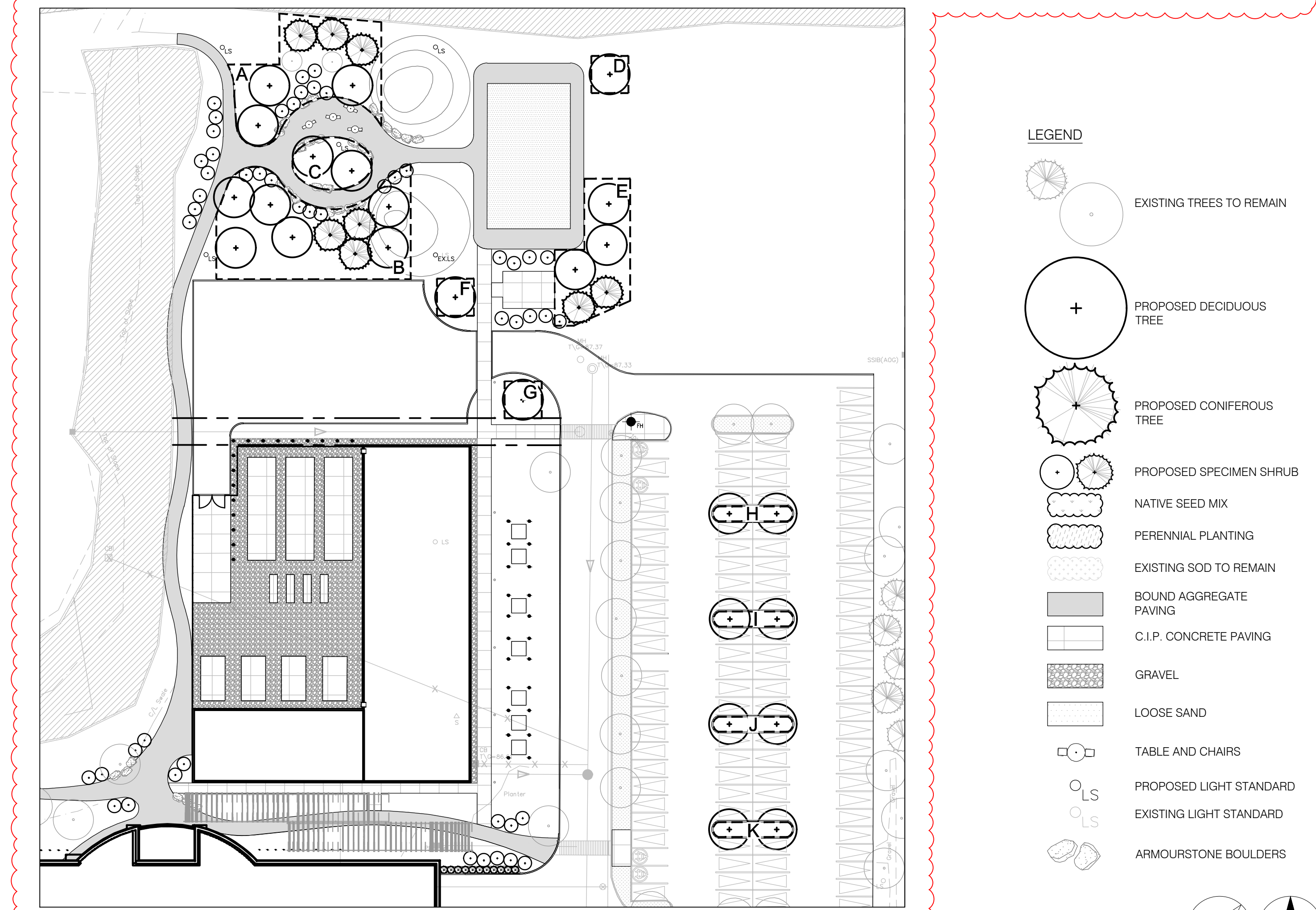

2 SOIL VOLUME PLAN  
L-200 1:500

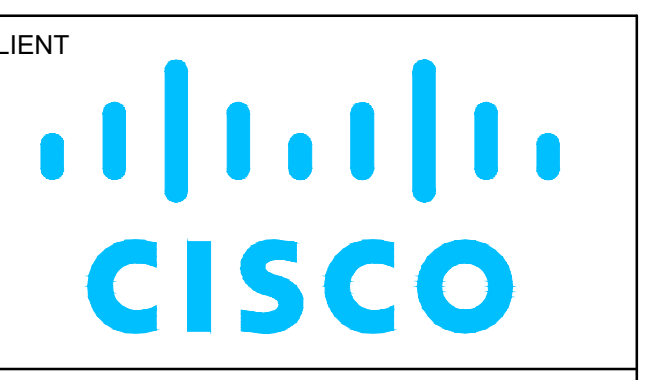

**COPYRIGHT**  
This drawing has been prepared solely for the intended use, thus any reproduction or distribution for any purpose other than authorized by Arcadis is forbidden. Written dimensions shall have precedence over scaled dimensions. Contractors shall verify and be responsible for all dimensions and conditions on the job, and Arcadis shall be informed of any variations from the dimensions and conditions shown on the drawing. Shop drawings shall be submitted to Arcadis for general conformance before proceeding with fabrication.

Arcadis Architects (Canada) Inc.

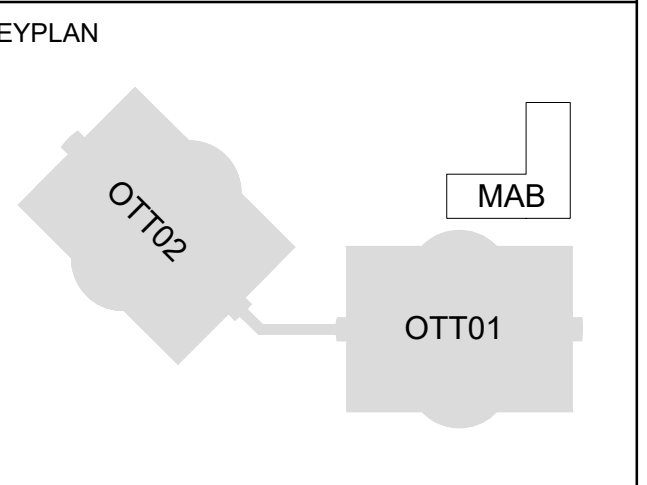

**ISSUES**

| No. | DESCRIPTION       | DATE       |
|-----|-------------------|------------|
| 1   | ISSUED FOR SPC #1 | 2025-12-12 |
| 2   | ISSUED FOR SPC #2 | 2025-05-08 |

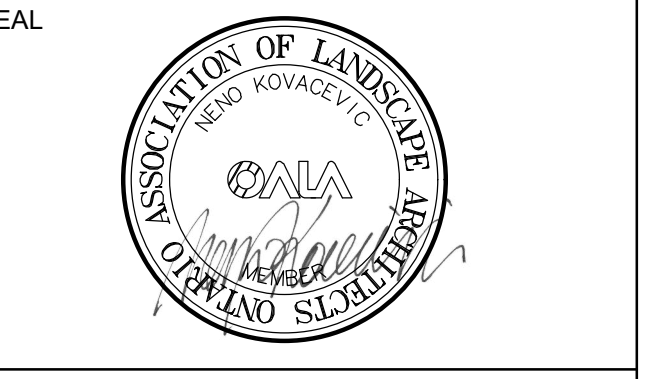

**SPC PACKAGE NOT FOR CONSTRUCTION**



**PROJECT**  
CISCO OTTAWA CAMPUS MAB  
2000 Innovation Drive, Kanata, ON K2K 3E8

**PROJECT NO:** MAB.30298433  
**APPLICATION NO:** PC2025-0127

**DRAWN BY:** ARCADIS  
**CHECKED BY:** BJ

**PROJECT MGR:** BJ  
**APPROVED BY:** NK

**SHEET TITLE**  
PLANTING PLAN

**SHEET NUMBER** L-200 **ISSUE** 2

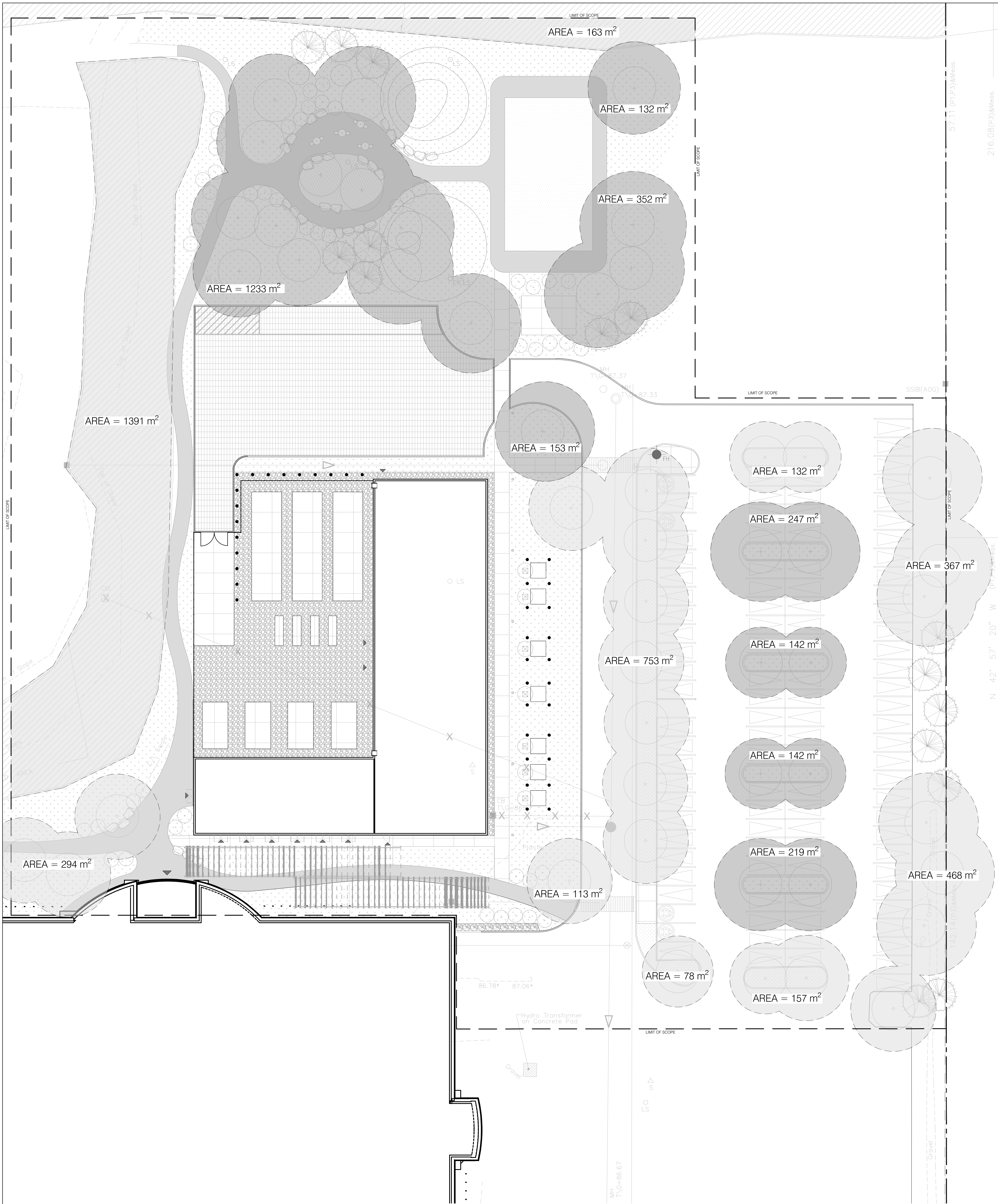

**40-YEAR CANOPY PROJECTION:**  
 PROPOSED CANOPY COVER AT MATURITY = 2,620 m<sup>2</sup>  
 EXISTING CANOPY COVER (PROJECTED AT MATURITY) = 3,916 m<sup>2</sup>  
 TOTAL PROJECTED CANOPY AREA = 6,536 m<sup>2</sup>  
 TOTAL SCOPE AREA = 15,776 m<sup>2</sup>  
 PROJECTED CANOPY COVER = 41.4%

- 40-YEAR CANOPY CALCULATION METHODOLOGY:**
- TREE SPECIES DIAMETER AT MATURITY WAS SOURCED FROM NVKNURSERIES.COM
  - CIRCLES WERE PLACED AROUND EACH CANOPY TREE WITH CORRESPONDING DIAMETER
  - CANOPY AREA WAS DETERMINED BY A POLYLINE DRAWN AROUND THE PERIMETER OF EACH TREE, OR GROUPINGS OF TREES WITH OVERLAPPING CANOPIES.
  - THE ADDED AREA OF ALL POLYLINES WAS USED TO CALCULATE SITE COVERAGE PERCENTAGE.
  - FOR THE PURPOSE OF THIS CALCULATION, THE TOTAL SITE AREA USED IS DENOTED BY THE 'LIMIT OF SCOPE' LINE.

- LEGEND**
- EXISTING TREES TO REMAIN
  - PROPOSED DECIDUOUS TREE
  - PROPOSED CONIFEROUS TREE
  - PROPOSED SPECIMEN SHRUB
  - NATIVE SEED MIX
  - PERENNIAL PLANTING
  - EXISTING SOD TO REMAIN
  - SOUND AGGREGATE PAVING
  - C.I.P. CONCRETE PAVING
  - GRAVEL
  - LOOSE SAND
  - TABLE AND CHAIRS
  - PROPOSED LIGHT STANDARD
  - EXISTING LIGHT STANDARD
  - ARMOURSTONE BOULDERS
  - EXISTING CANOPY 40-YEAR PROJECTION
  - PROPOSED CANOPY 40-YEAR PROJECTION

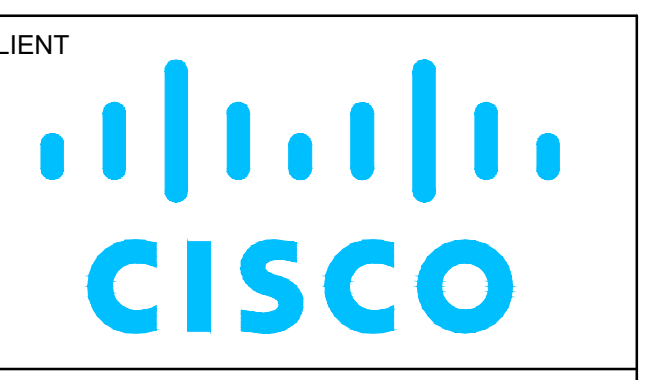

**COPYRIGHT**  
 This drawing has been prepared solely for the intended use, thus any reproduction or distribution for any purpose other than authorized by Arcadis is forbidden. Written dimensions shall have precedence over scaled dimensions. Contractors shall verify and be responsible for all dimensions and conditions on the job, and Arcadis shall be informed of any variations from the dimensions and conditions shown on the drawing. Shop drawings shall be submitted to Arcadis for general conformance before proceeding with fabrication.  
 Arcadis Architects (Canada) Inc.

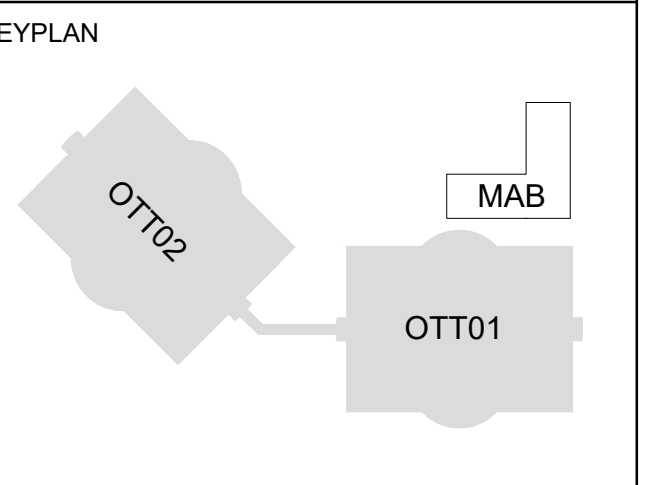

**ISSUES**

| No. | DESCRIPTION       | DATE       |
|-----|-------------------|------------|
| 1   | ISSUED FOR SPC #1 | 2025-12-12 |
| 2   | ISSUED FOR SPC #2 | 2025-05-08 |

**CONSULTANTS**

**ARUP**  
 47 Clarence Street, Suite 202,  
 Ottawa, ON, K1N 5P9

**TEECOM**  
 4000 Steeles Ave. E., Suite 100,  
 Scarborough, ON, M1V 5P6

**SENEZ CO**  
 FIRE SCIENCE & ENGINEERING  
 93 Skyway Avenue, Suite 102  
 Toronto, ON, M9W 6N6

**TOTAL OPENING CONSULTANTS**  
 895 Don Mills Rd., Suite 900,  
 Toronto, ON M3C 1W3

**CBRE**  
 340 Albert Street, Suite 1900  
 Ottawa, ON, K1R 7Y6

**Matrix**  
 8131 31st Street  
 Richmond, ON, K0A 2Z0

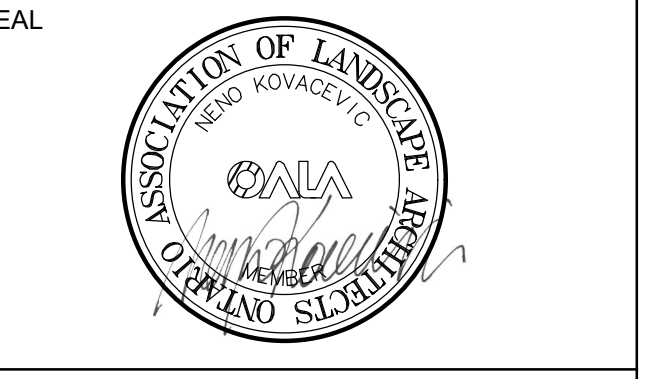

**SPC PACKAGE**  
 NOT FOR CONSTRUCTION

**PRIME CONSULTANT**

**ARCADIS**  
 333 Preston Street - Suite 500  
 Ottawa ON K1S 5N4 Canada  
 tel 613 225 1311  
 www.arcadis.com

**PROJECT**  
 CISCO OTTAWA CAMPUS  
 MAB  
 2000 Innovation Drive,  
 Kanata, ON K2K 3E8

**PROJECT NO:** MAB.30298433  
**APPLICATION NO:** PC2025-0127

**DRAWN BY:** ARCADIS  
**CHECKED BY:** BJ

**PROJECT MGR:** BJ  
**APPROVED BY:** NK

**SHEET TITLE**  
 40-YEAR CANOPY PROJECTION

**SHEET NUMBER** L-201 **ISSUE** 2

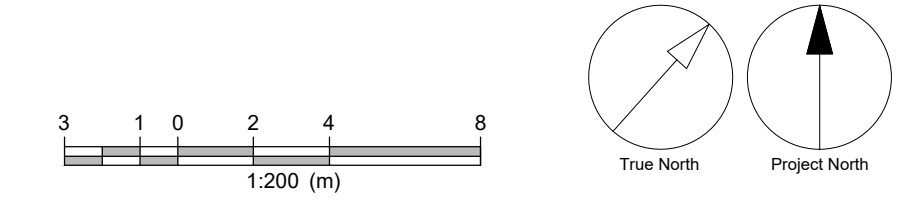

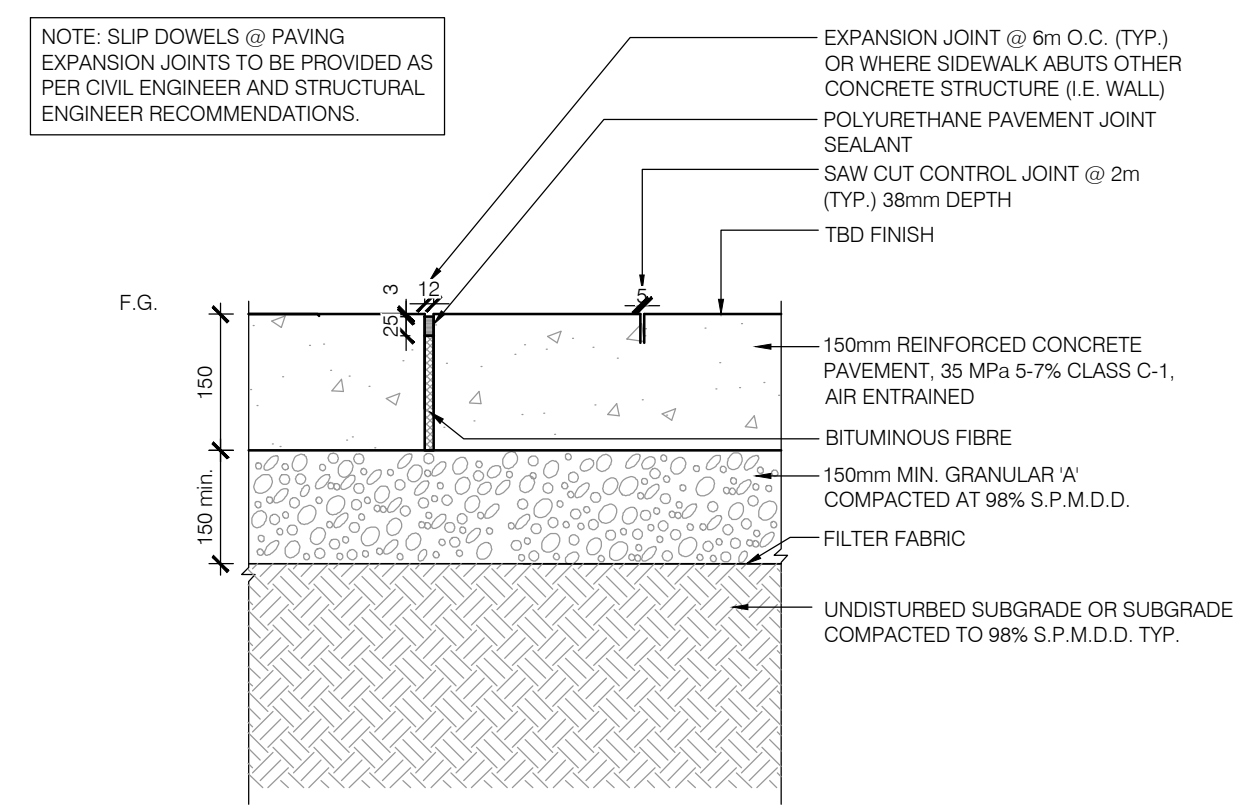

1 C.I.P. CONCRETE PAVING  
L-500 1:10

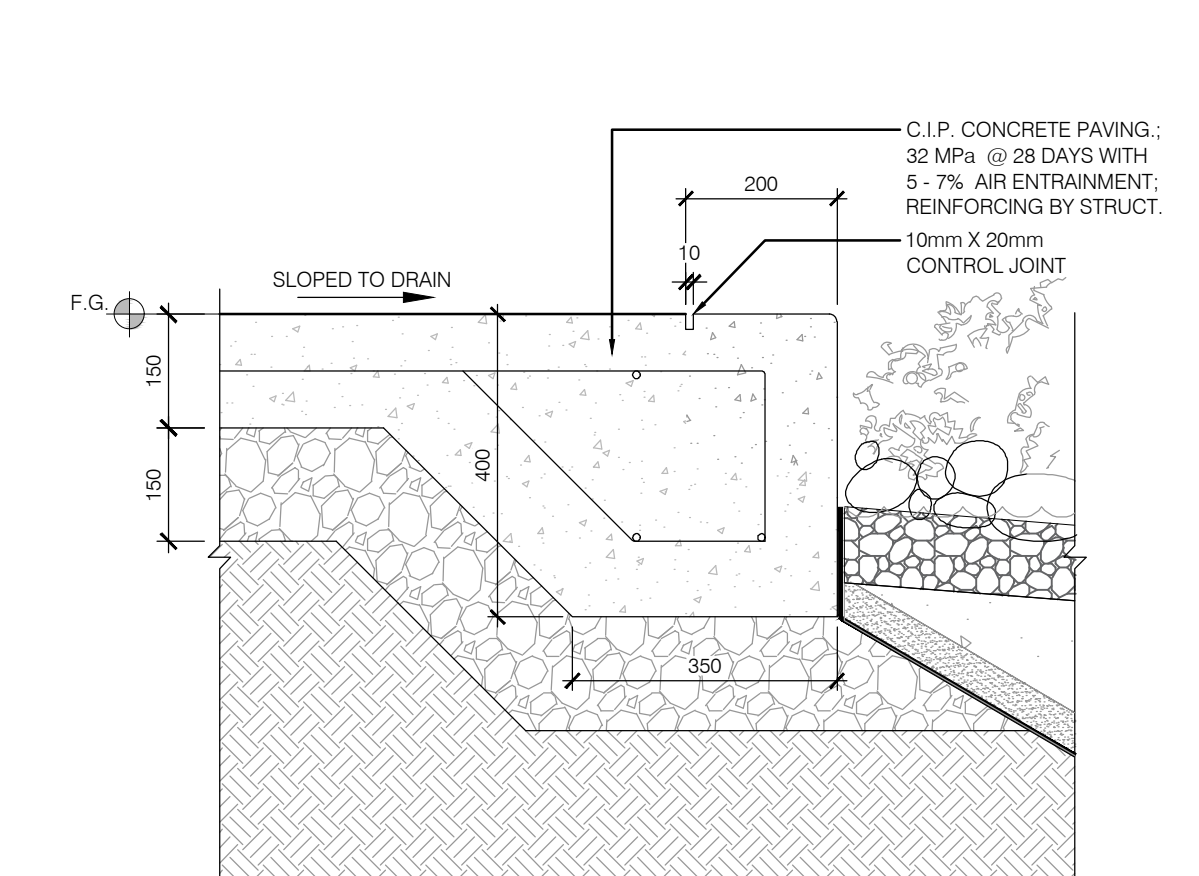

2 C.I.P. CONCRETE EDGE  
L-500 1:10

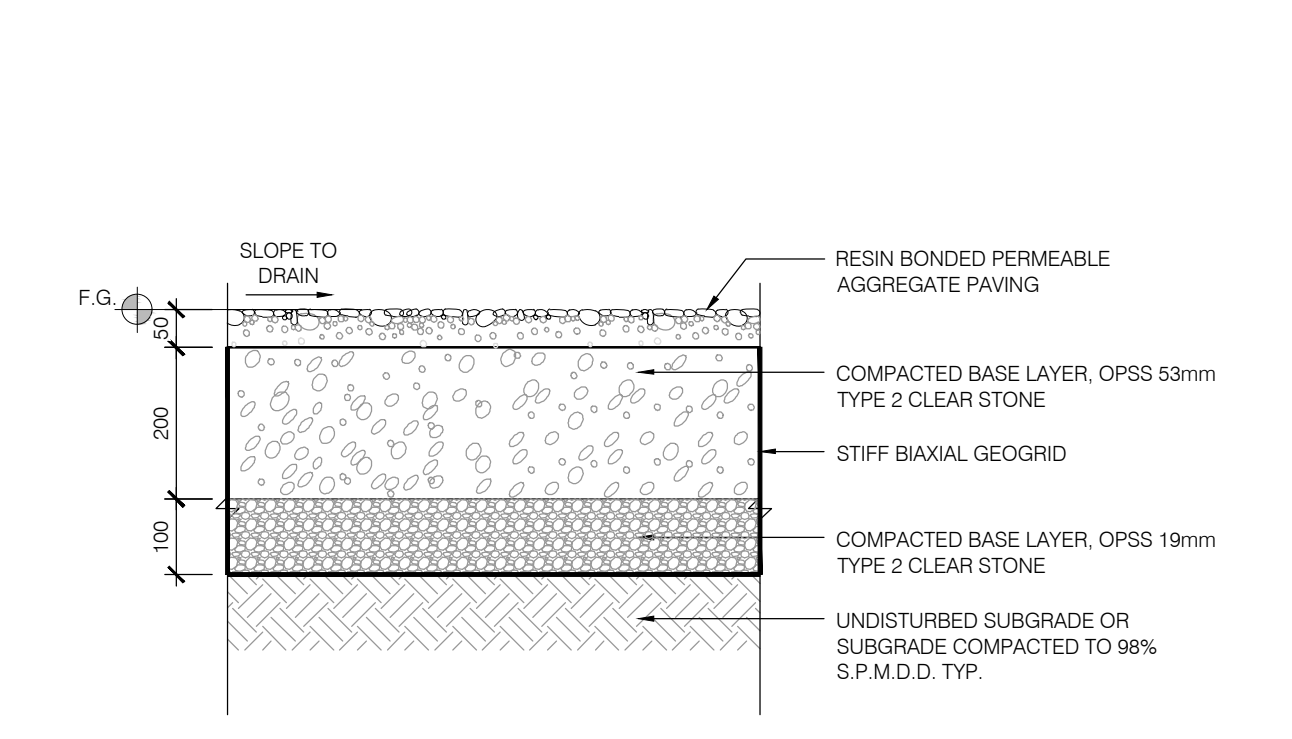

3 BOUND AGGREGATE PAVING  
L-500 1:10

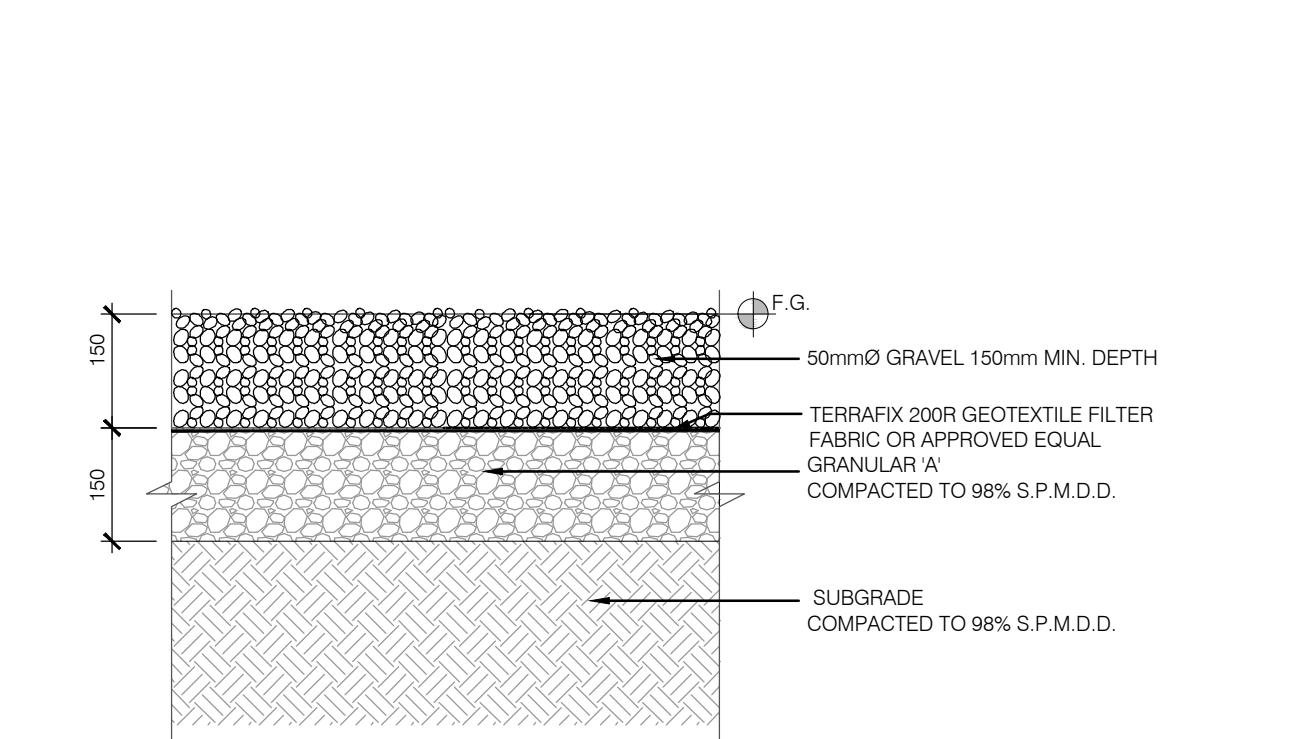
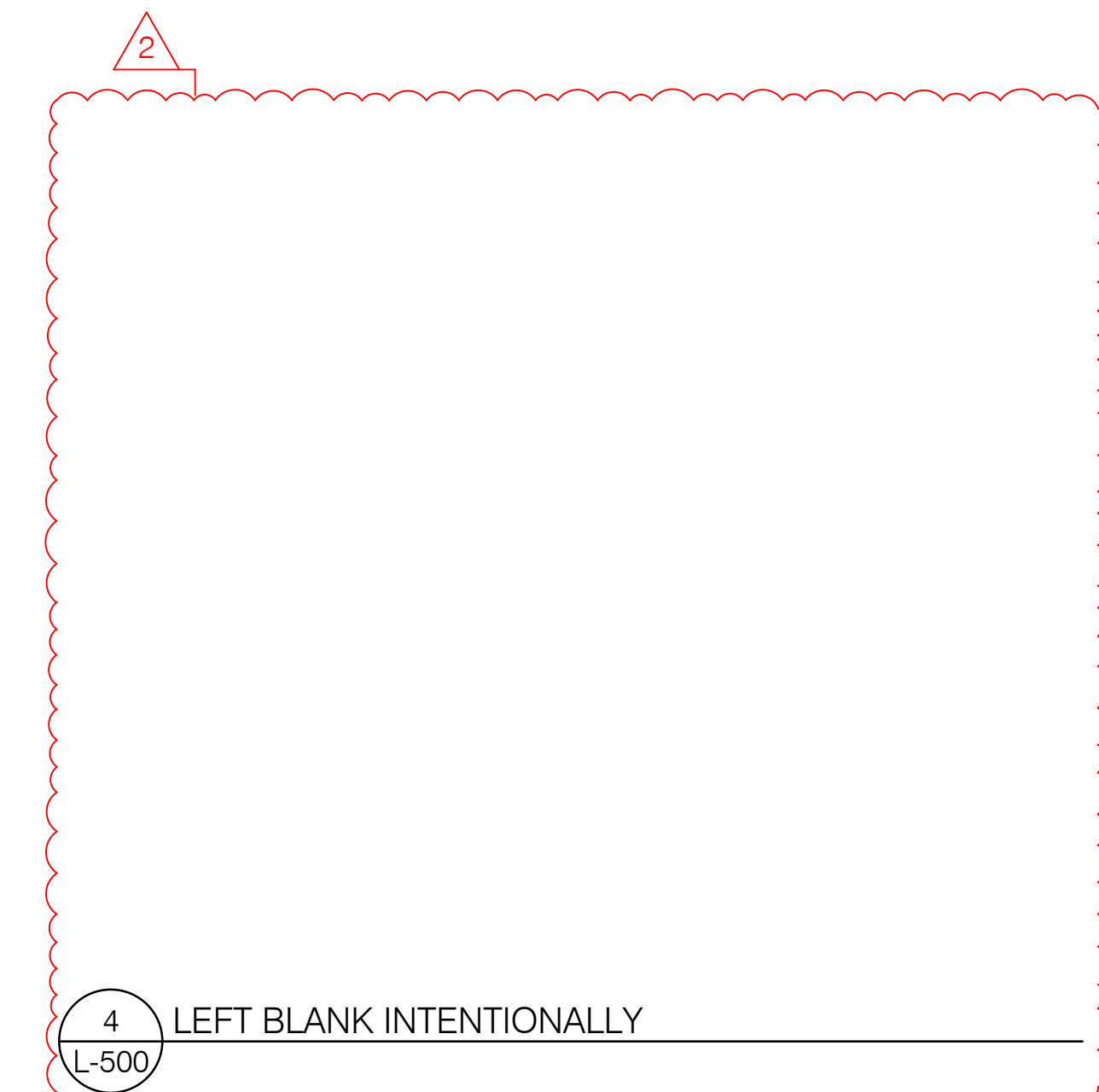

5 GRAVEL SURFACE  
L-500 1:10

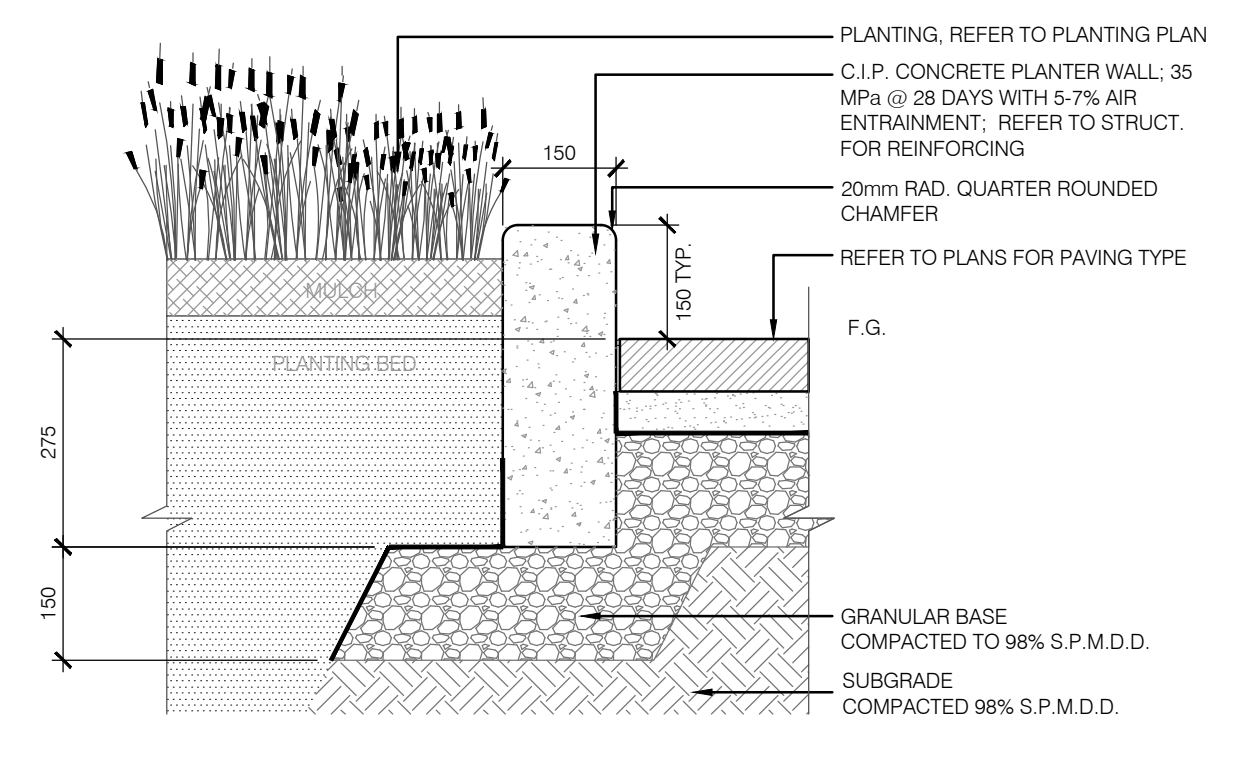

6 C.I.P. CONCRETE CURB AT PLANTERS  
L-500 1:10

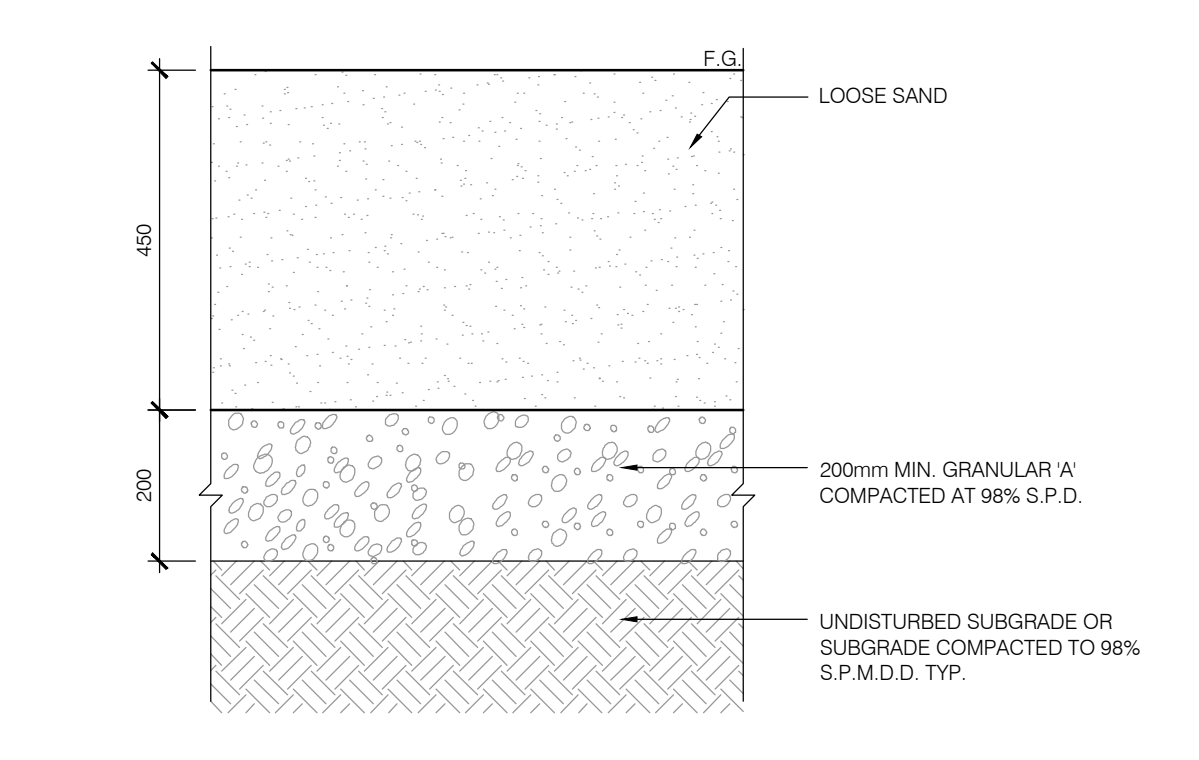

7 SAND VOLLEYBALL COURT  
L-500 1:10

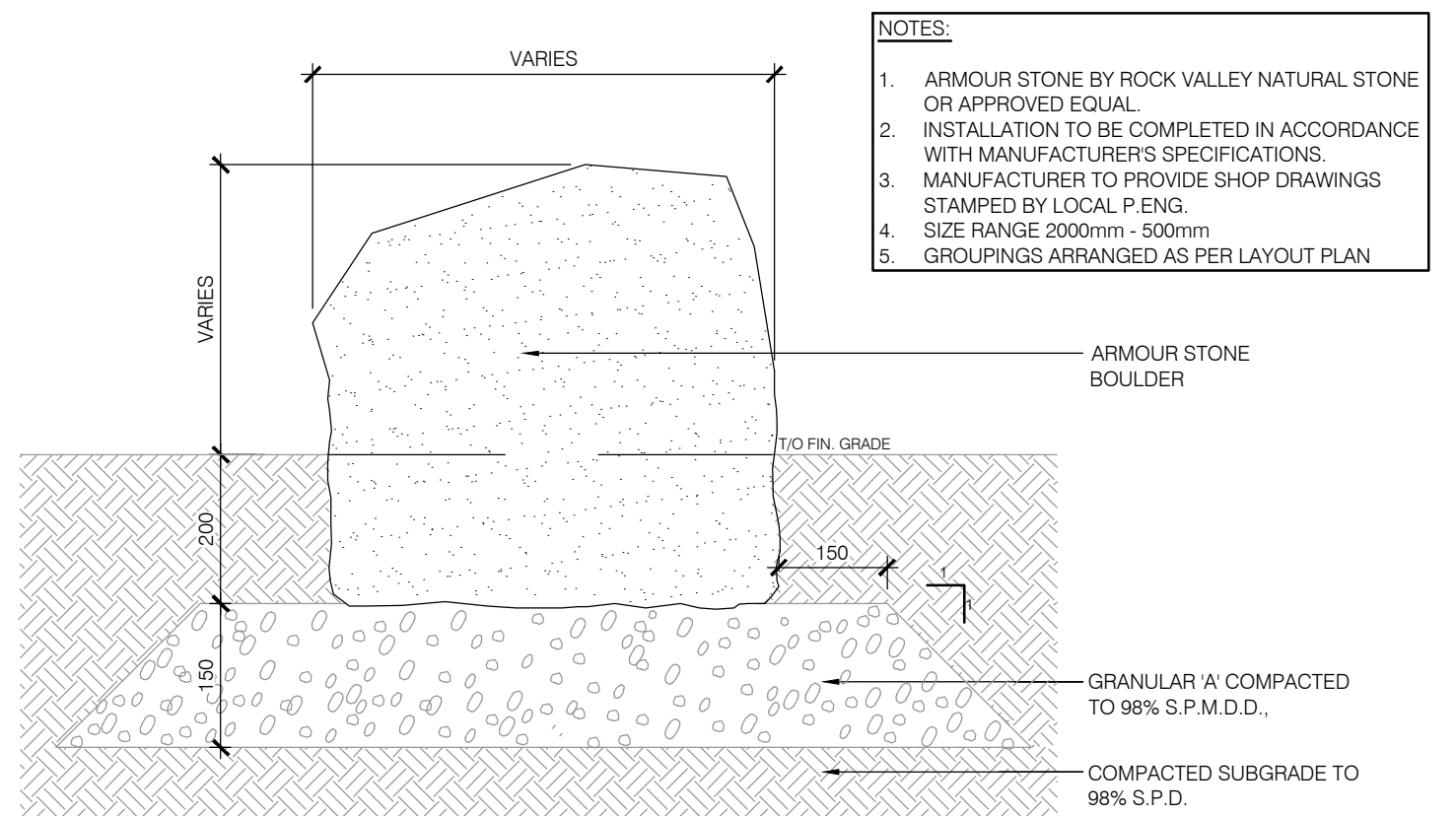

8 BOULDER (ARMOURSTONE)  
L-500 1:20

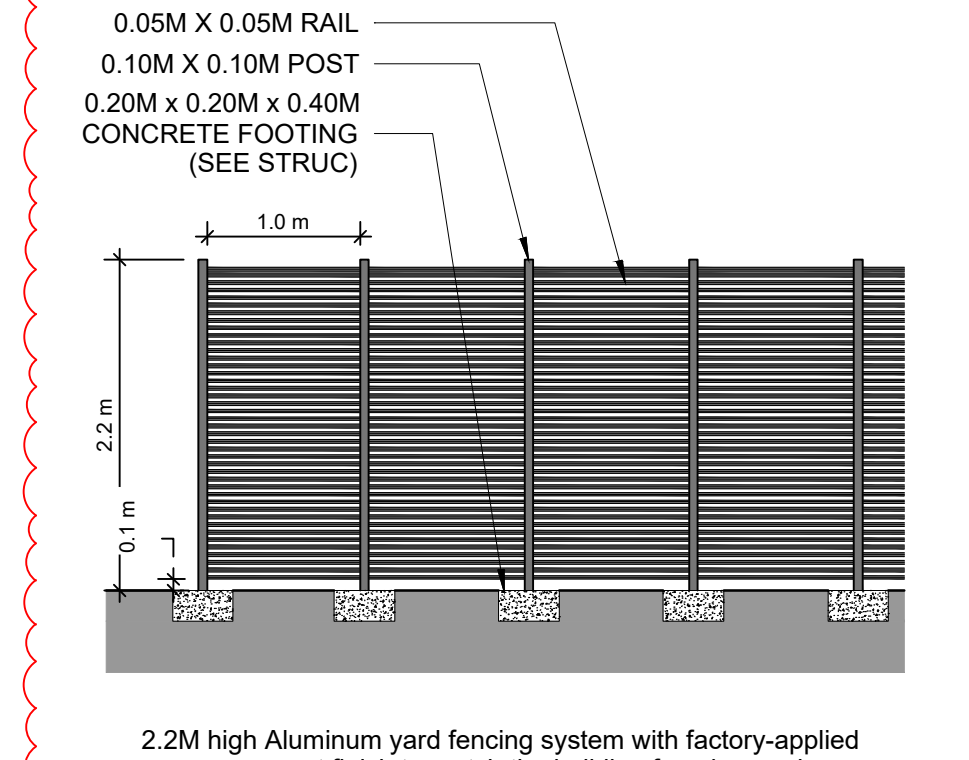

9 METAL FENCE  
L-500 1:50



CLIENT

**CISCO**

COPYRIGHT  
This drawing has been prepared solely for the intended use, thus any reproduction or distribution for any purpose other than authorized by Arcadis is forbidden. Written dimensions shall have precedence over scaled dimensions. Contractors shall verify and be responsible for all dimensions and conditions on the job, and Arcadis shall be informed of any variations from the dimensions and conditions shown on the drawing. Shop drawings shall be submitted to Arcadis for general conformance before proceeding with fabrication.

Arcadis Architects (Canada) Inc.

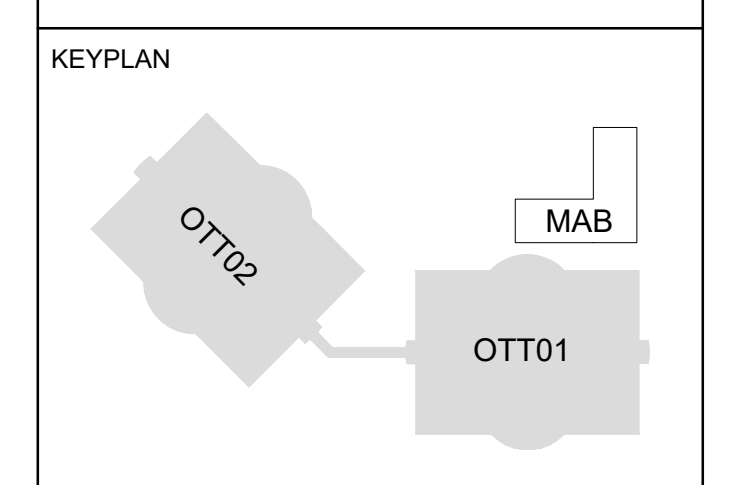

ISSUES

| No. | DESCRIPTION       | DATE       |
|-----|-------------------|------------|
| 1   | ISSUED FOR SPC #1 | 2025-12-12 |
| 2   | ISSUED FOR SPC #2 | 2026-05-08 |

CONSULTANTS

**ARUP**  
47 Clarence Street, Suite 202,  
Ottawa, ON, K1N 5P9

**TEECOM**  
98 California Street  
Suite 100  
San Francisco, CA  
94111  
2018-07-2020  
www.teecom.com

**SENEZ CO**  
FIRE SCIENCE & ENGINEERING  
93 Skyway Avenue, Suite 102  
Toronto, ON, M9W 6R6

**TOTAL OPENING CONSULTANTS**  
895 Don Mills Rd. Suite 900,  
Toronto, ON M3C 1W3

**CBRE**  
340 Albert Street, Suite 1900  
Ottawa, ON, K1R 7Y6

**Matrix**  
6131 Perth Street  
Richmond, ON, K9A 2Z0



SPC PACKAGE  
NOT FOR CONSTRUCTION

PRIME CONSULTANT

**ARCADIS**  
333 Preston Street - Suite 500  
Ottawa ON K1S 5N4 Canada  
tel 613 225 1311  
www.arcadis.com

PROJECT  
CISCO OTTAWA CAMPUS  
MAB  
2000 Innovation Drive,  
Kanata, ON K2K 3E8

|  |   |
|--|---|
| PROJECT NO:<br>MAB-30298433                | APPLICATION NO:<br>PC2025-0127          |
| DRAWN BY:<br>ARCADIS<br>PROJECT MGR:<br>BJ | CHECKED BY:<br>BJ<br>APPROVED BY:<br>NK |

SHEET TITLE  
LANDSCAPE  
DETAILS

SHEET NUMBER  
L-500

ISSUE  
2

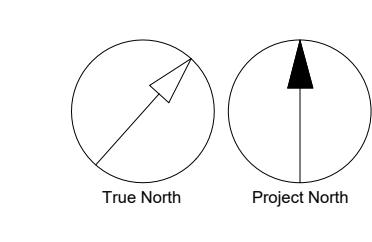

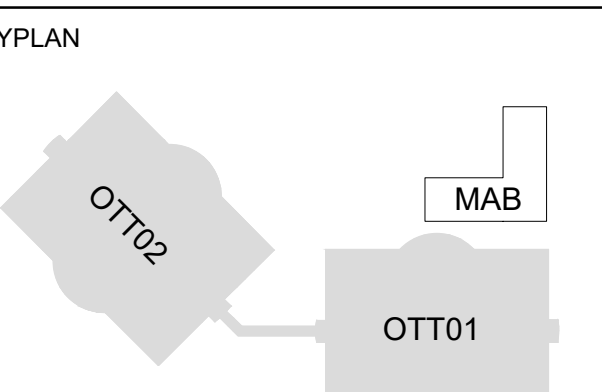

**ISSUES**

| No. | DESCRIPTION       | DATE       |
|-----|-------------------|------------|
| 1   | ISSUED FOR SPC #1 | 2025-12-12 |
| 2   | ISSUED FOR SPC #2 | 2026-05-08 |

**CONSULTANTS**

**ARUP**  
47 Clarence Street, Suite 202,  
Ottawa, ON, K1N 5P9

**TEECOM**  
30 Colborne Street  
Ottawa, Ontario, CA  
K1P 1K1  
(613) 577-2888  
www.teecom.com

**SENEZCO**  
FIRE SCIENCE & ENGINEERING  
93 Skyway Avenue, Suite 102  
Toronto, ON, M9W 6R6

**TOTAL OPENING CONSULTANTS**  
895 Don Mills Rd., Suite 900,  
Toronto, ON M3C 1W3

**CBRE**  
340 Albert Street, Suite 1900  
Ottawa, ON, K1R 7Y6

**Matrix**  
6131 Perth Street  
Richmond, ON, N6A 2Z0



**SPC PACKAGE**  
NOT FOR CONSTRUCTION

**PRIME CONSULTANT**

**ARCADIS**  
333 Preston Street - Suite 500  
Ottawa ON K1S 5N4 Canada  
tel 613 225 1311  
www.arcadis.com

**PROJECT**  
CISCO OTTAWA CAMPUS  
MAB  
2000 Innovation Drive,  
Kanata, ON K2K 3E8

|                                    |                                       |
|------------------------------------|---------------------------------------|
| <b>PROJECT NO:</b><br>MAB-30298433 | <b>APPLICATION NO:</b><br>PC2025-0127 |
| <b>DRAWN BY:</b><br>ARCADIS<br>BJ  | <b>CHECKED BY:</b><br>BJ              |
| <b>PROJECT MGR:</b><br>BJ          | <b>APPROVED BY:</b><br>NK             |

**SHEET TITLE**  
PLANTING  
DETAILS

|                              |                   |
|------------------------------|-------------------|
| <b>SHEET NUMBER</b><br>L-501 | <b>ISSUE</b><br>2 |
|------------------------------|-------------------|

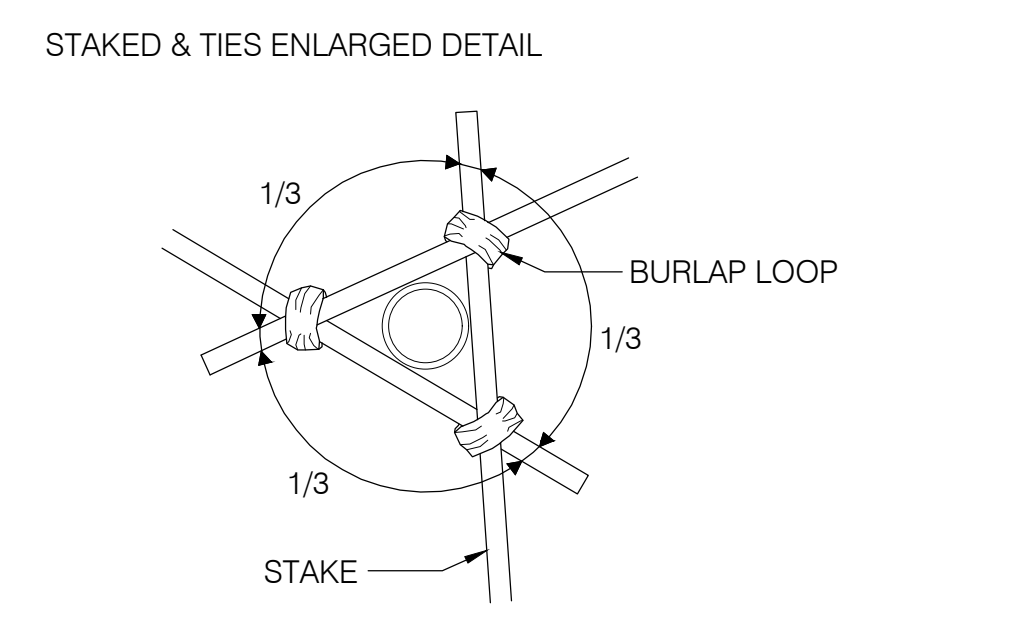
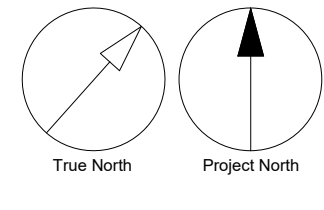

- STAKES & TIES:**
- STAKE BEFORE PLANTING USE ONE ROUNDED WOODEN STAKE, MINIMUM 2m LONG, 75mm AVERAGE DRIVEN 300mm INTO SUBSOIL PRIOR TO PLANTING
  - TIE USING BIODEGRADABLE MATERIAL SUCH AS FOLDED BURLAP, STAPLED TO STAKE WITH FENCE STAPLES OR ROOFING NAILS
  - APPLY RODENT PROTECTION WHERE REQUIRED. (TREES UNDER 45mm CALIPER)

- NOTES:**
- OBTAIN WRITTEN CONFIRMATION OF UTILITY LOCATES PRIOR TO COMMENCEMENT OF DIGGING
  - DIG ALL HOLES BY HAND WHEN CLOSER THAN 1.0M TO UNDERGROUND POWER, TELEPHONE AND GAS ALIGNMENTS
  - USE ROOT DEFLECTOR ON THE UTILITY SIDE OF REQUIRED
  - ENSURE BASE OF TREE PIT IS STABLE IN ORDER TO MAINTAIN THE DESIRED TREE LEVEL AND GRADE
  - TREES TO BE SPRAYED WITH APPROVED ANTI-DESICCANT PRIOR TO TRANSPLANTING UNLESS PLANTED WITHIN 48 HOURS OF DIGGING (IF PLANTED IN FULL LEAF)
  - SET TREE 50mm HIGHER THAN SURROUNDING GRADE TO ALLOW FOR SETTLEMENT
  - SCARIFY COMPACTED SUBGRADE TO 500MM DEEP IN AREA 5 X ROOTBALL DIAMETER
  - DIG PIT 300MM WIDER THAN ROOTBALL PERIMETER
  - MULCH WITH SHREDDED BARK OR COMPOSTED HARDWOOD CHIPS
  - TRUNK PROTECTION MECHANICAL INJURY: USE PLASTIC TREE COLLAR ANIMAL INJURY: USE SPIRAL TREE GUARDS OR SCREEN COLLARS SUNSCALD INJURY: PAINT TRUNK WITH WHITE LATEX OR WHITE-WASH, OR WRAP WITH BURLAP, 'KRAFT WRAP' INSTALLED FROM THE GROUND UP TO ABOVE LOWEST BRANCHES LAWN MOWER INJURY: USE SPLIT CORRUGATED BRAIN COLLARS
  - REMOVE TREE STAKES AND TREE WRAP AFTER ONE SEASON

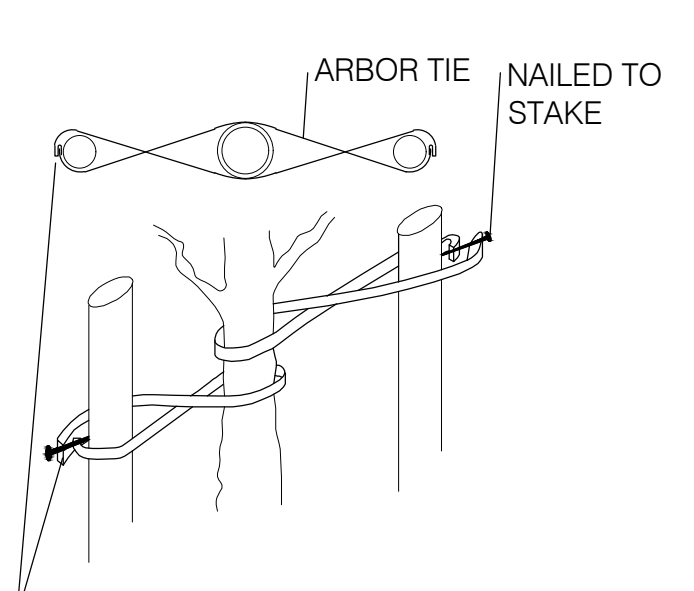

FOLD ENDS OF ARBOR TIE BACK, SECURE TO STAKE WITH 1" GALVANIZED ROOFING NAIL OR USE A KNOT.

- NOTES:**
- OBTAIN WRITTEN CONFIRMATION OF UTILITY LOCATES PRIOR TO COMMENCEMENT OF DIGGING
  - DIG ALL HOLES BY HAND WHEN CLOSER THAN 1.0M TO UNDERGROUND POWER, TELEPHONE AND GAS ALIGNMENTS
  - USE ROOT DEFLECTOR ON THE UTILITY SIDE OF REQUIRED
  - ENSURE BASE OF TREE PIT IS STABLE IN ORDER TO MAINTAIN THE DESIRED TREE LEVEL AND GRADE
  - TREES TO BE SPRAYED WITH APPROVED ANTI-DESICCANT PRIOR TO TRANSPLANTING UNLESS PLANTED WITHIN 48 HOURS OF DIGGING (IF PLANTED IN FULL LEAF)
  - SET TREE 50mm HIGHER THAN SURROUNDING GRADE TO ALLOW FOR SETTLEMENT
  - SCARIFY COMPACTED SUBGRADE TO 500MM DEEP IN AREA 5 X ROOTBALL DIAMETER
  - DIG PIT 300MM WIDER THAN ROOTBALL PERIMETER
  - MULCH WITH SHREDDED BARK OR COMPOSTED HARDWOOD CHIPS
  - TRUNK PROTECTION MECHANICAL INJURY: USE PLASTIC TREE COLLAR ANIMAL INJURY: USE SPIRAL TREE GUARDS OR SCREEN COLLARS SUNSCALD INJURY: PAINT TRUNK WITH WHITE LATEX OR WHITE-WASH, OR WRAP WITH BURLAP, 'KRAFT WRAP' INSTALLED FROM THE GROUND UP TO ABOVE LOWEST BRANCHES LAWN MOWER INJURY: USE SPLIT CORRUGATED BRAIN COLLARS
  - REMOVE TREE STAKES AND TREE WRAP AFTER ONE SEASON

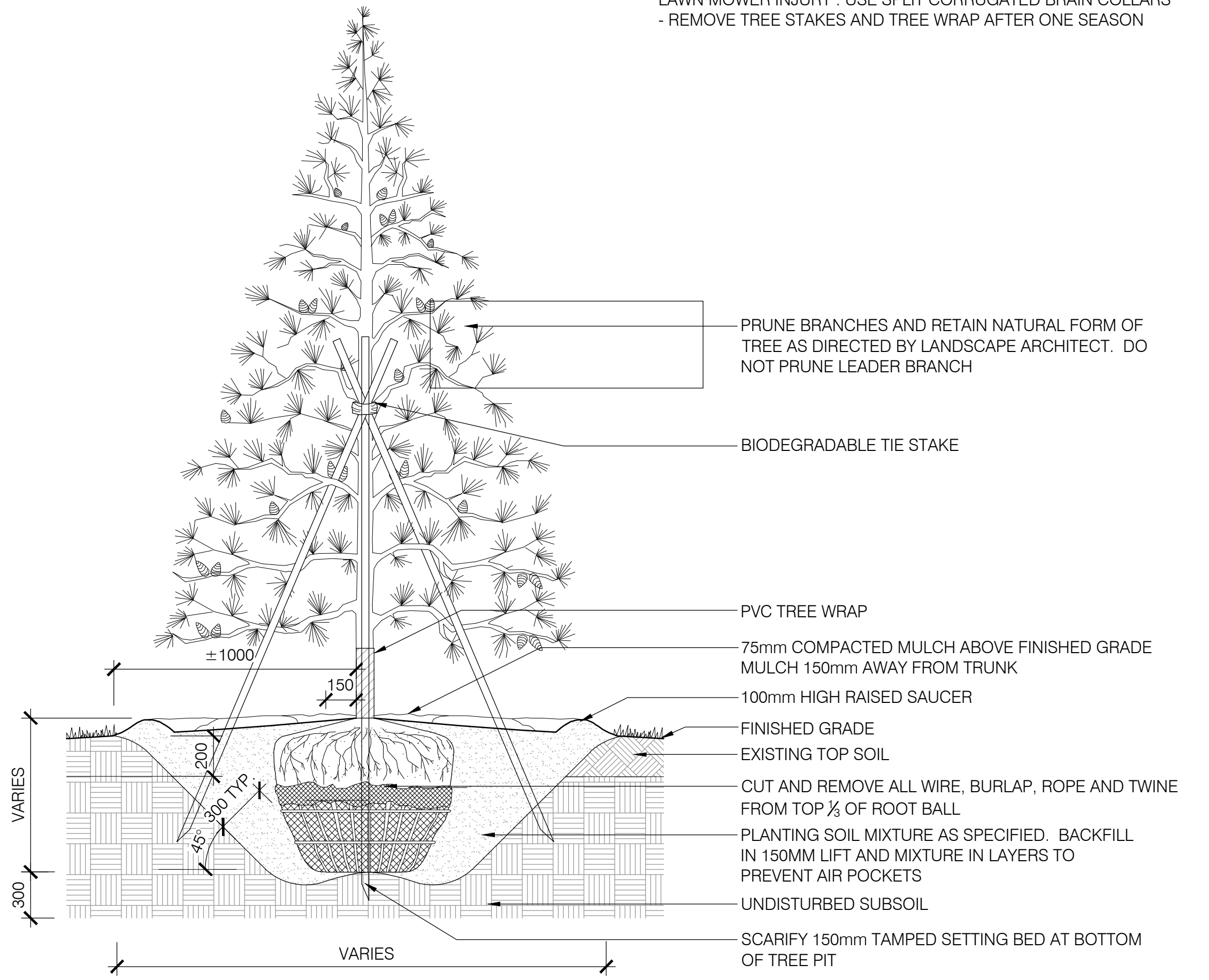

**1 CONIFEROUS TREE PLANTING**  
L-501 / 1:20

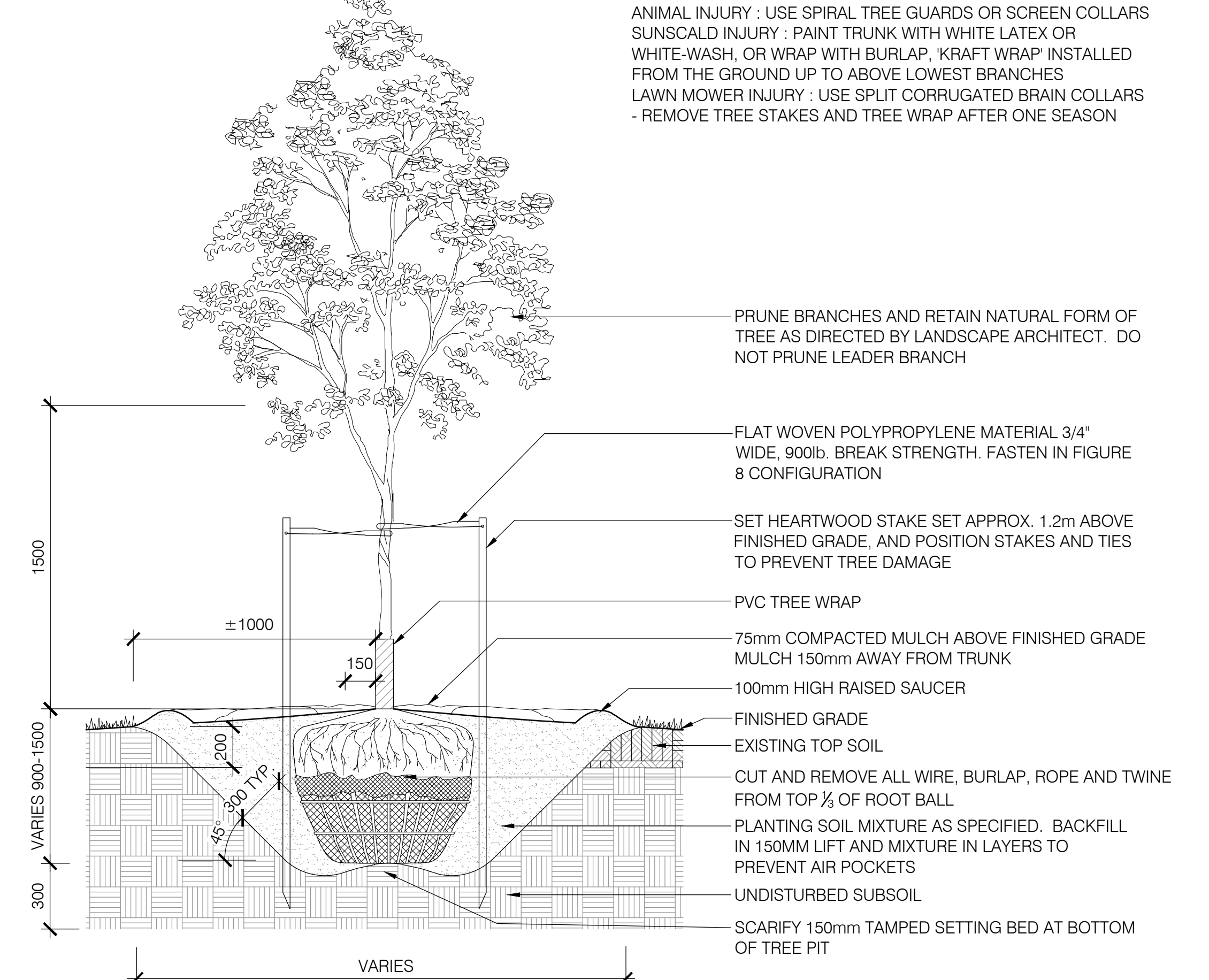

**2 DECIDUOUS TREE PLANTING**  
L-501 / 1:20

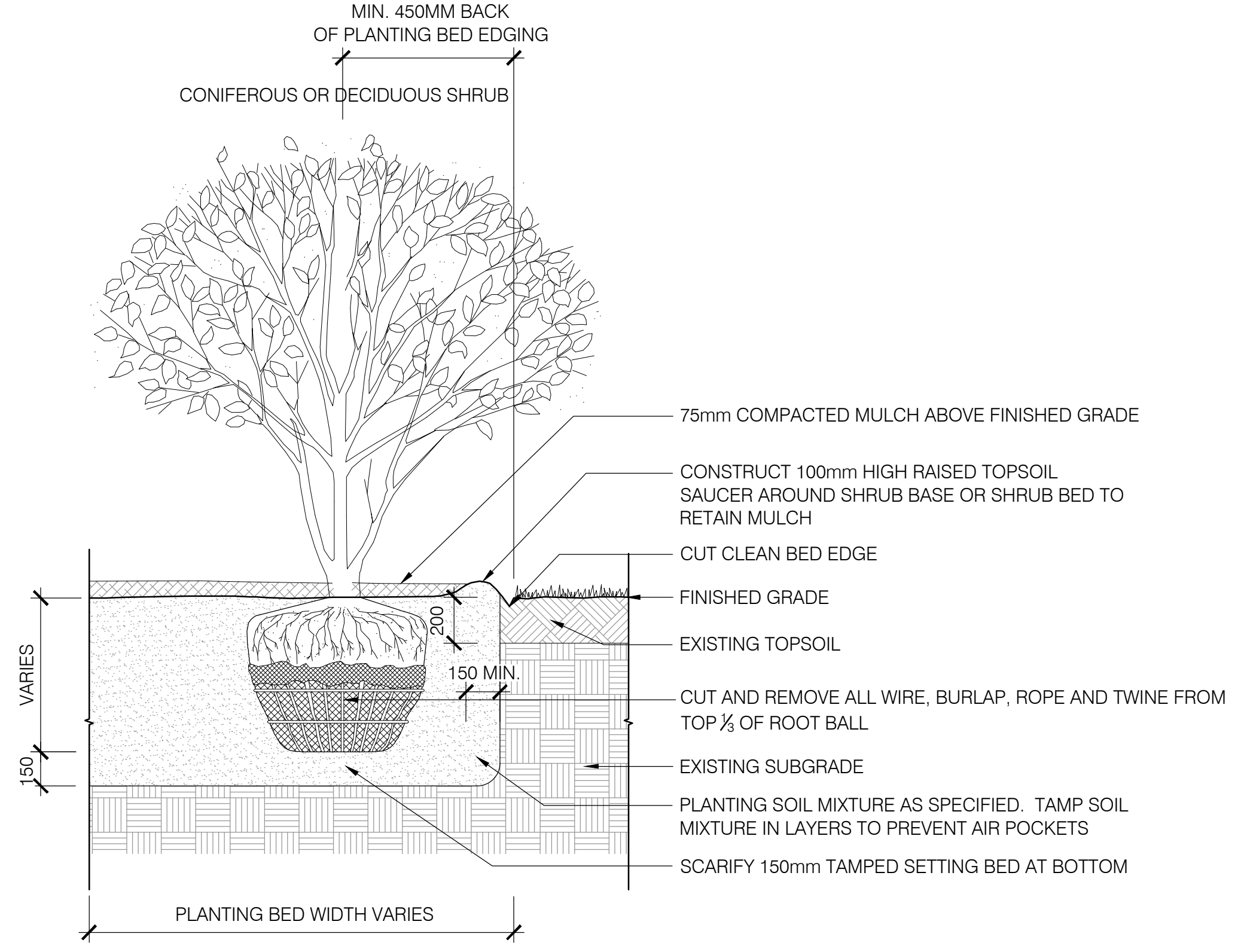

**3 SHRUB PLANTING**  
L-501 / 1:20

- NOTES:**
- PREPARATION: EXCAVATE PLANTING BED TO SIZE OUTLINED ON DRAWINGS. MAINTAIN MINIMUM 350mm DEPTH
  - PLANTING BED TO BE RAISED A MINIMUM OF 150mm ABOVE THE FINISHED GRADE OF SOD AND/OR SURROUNDING AREA
  - SET PERENNIAL 50mm HIGHER THAN SURROUNDING GRADE TO ALLOW FOR SETTLEMENT
  - PLANTING IN GROUPS SHALL BE SET IN EQUAL ON CENTRE SPACING
  - SPACING PER PLANT LIST DIRECTIONS, IN STAGGERED ROWS
- FERTILIZER:**
- APPLY APPROVED WATER SOLUBLE FERTILIZER AT A RATE OF 9kg PER 100 m<sup>2</sup>
  - ENSURE FERTILIZER IS CONTAINED WITHIN SAUCER AND EVENLY RAKED INTO PLANTING SOIL MIXTURE.
- BARE ROOT (B.R. IN PLANT LIST):**
- SET ALL PLANT MATERIAL SLIGHTLY HIGHER THAN ADJACENT GRADE. SET BARE ROOT PLANT MATERIAL SO THAT ROOTS LIE IN NATURAL STATE. GENTLY BACKFILL WITH SOIL MIXTURE, WORKING SOIL BETWEEN ROOTS. LIGHTLY TAMP SOIL TO ELIMINATE AIR POCKETS AND REDUCE SETTLEMENT. WATER PLANTING BED THOROUGHLY, IMMEDIATELY AFTER PLANTING.

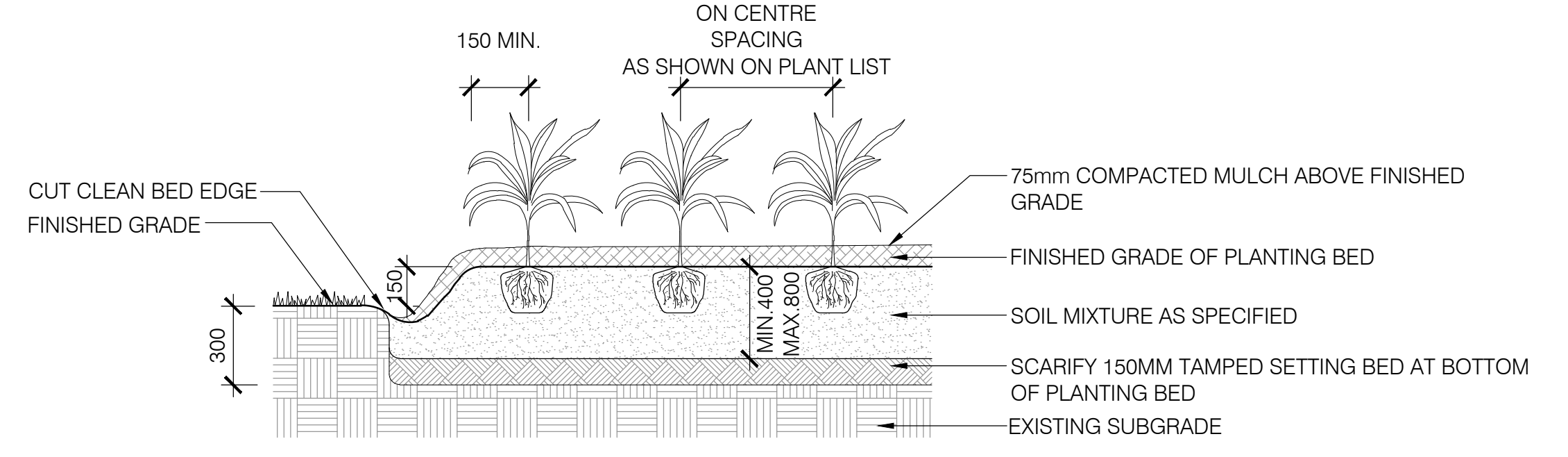

**4 PERENNIAL PLANTING**  
L-501 / 1:20