

LEGEND

	SITE BOUNDARY
	PROPOSED ELEVATION
	EXISTING ELEVATION
	PROPOSED TOP OF WALL ELEVATION
	PROPOSED BOTTOM OF WALL ELEVATION
	PROPOSED TOP OF CURB ELEVATION
	PROPOSED SWALE ELEVATION
	PROPOSED TOP OF GRATE ELEVATION
	PROPOSED CENTERLINE OF DITCH ELEVATION
	PROPOSED RETAINING WALL
	FINISHED FLOOR ELEVATION
	TOP OF FOUNDATION ELEVATION
	UNDERSIDE OF FOOTING ELEVATION
	MINIMUM UNDERSIDE OF FOOTING ELEVATION
	PROPOSED TERRACE ELEVATION
	MAXIMUM 3:1 SIDESLOPE
	PROPOSED CENTERLINE SWALE
	PROPOSED GRADE AND DIRECTION
	MAJOR OVERLAND FLOW ROUTE
	PROPOSED HYDRANT LOCATION
	PROPOSED TOP OF BOTTOM FLANGE
	PROPOSED VALVE & VALVE BOX
	PROPOSED CURB STOP LOCATION
	PROPOSED WATER CHAMBER (AS PER CITY OF OTTAWA DETAIL W3)
	PROPOSED VALVE & VALVE CHAMBER (AS PER CITY OF OTTAWA DETAIL W3)
	PROPOSED SANITARY MANHOLE
	PROPOSED STORM MANHOLE
	PROPOSED ROAD CATCHBASIN
	PROPOSED CATCHBASIN MANHOLE
	PROPOSED REAR YARD ELBOW
	PROPOSED REAR YARD TEE
	PROPOSED WATER METER LOCATION
	PROPOSED REMOTE WATER METER LOCATION
	PROPOSED TWSI AS PER CITY OF OTTAWA DETAIL 7.2
	100YR PONDING LIMITS AND ELEVATION
	1.5YR PONDING AREA AND ELEVATION
	EXISTING CONTOUR LINE AND ELEVATION
	EXISTING FIRE HYDRANT
	EXISTING SANITARY MANHOLE
	EXISTING STORM MANHOLE
	EXISTING WATER VALVE
	EXISTING HYDRO POLE
	EXISTING CATCH BASIN

PAVEMENT STRUCTURE DETAILS
*REFER TO GEOTECHNICAL REPORT FOR SUBSURFACE CONDITIONS AND CONSTRUCTION RECOMMENDATIONS.

ACCESS LANES AND HEAVY DUTY TRUCK PARKING

- 40mm SUPERPAVE 12.5
- 50mm SUPERPAVE 19.0
- 150mm GRANULAR 'A'
- 400mm GRANULAR 'B' TYPE II
- SUBGRADE TO BE FILL, IN SITU SOIL, OR O.P.S.S. GRANULAR 'B' TYPE 1 OR 2 MATERIAL PLACED OVER IN SITU SOIL OR FILL

LIGHT DUTY PARKING

- 50mm HL3 OR SUPERPAVE 12.5
- 150mm GRANULAR 'A'
- 300mm GRANULAR 'B' TYPE II
- SUBGRADE TO BE FILL, IN SITU SOIL, OR O.P.S.S. GRANULAR 'B' TYPE 1 OR 2 MATERIAL PLACED OVER IN SITU SOIL OR FILL

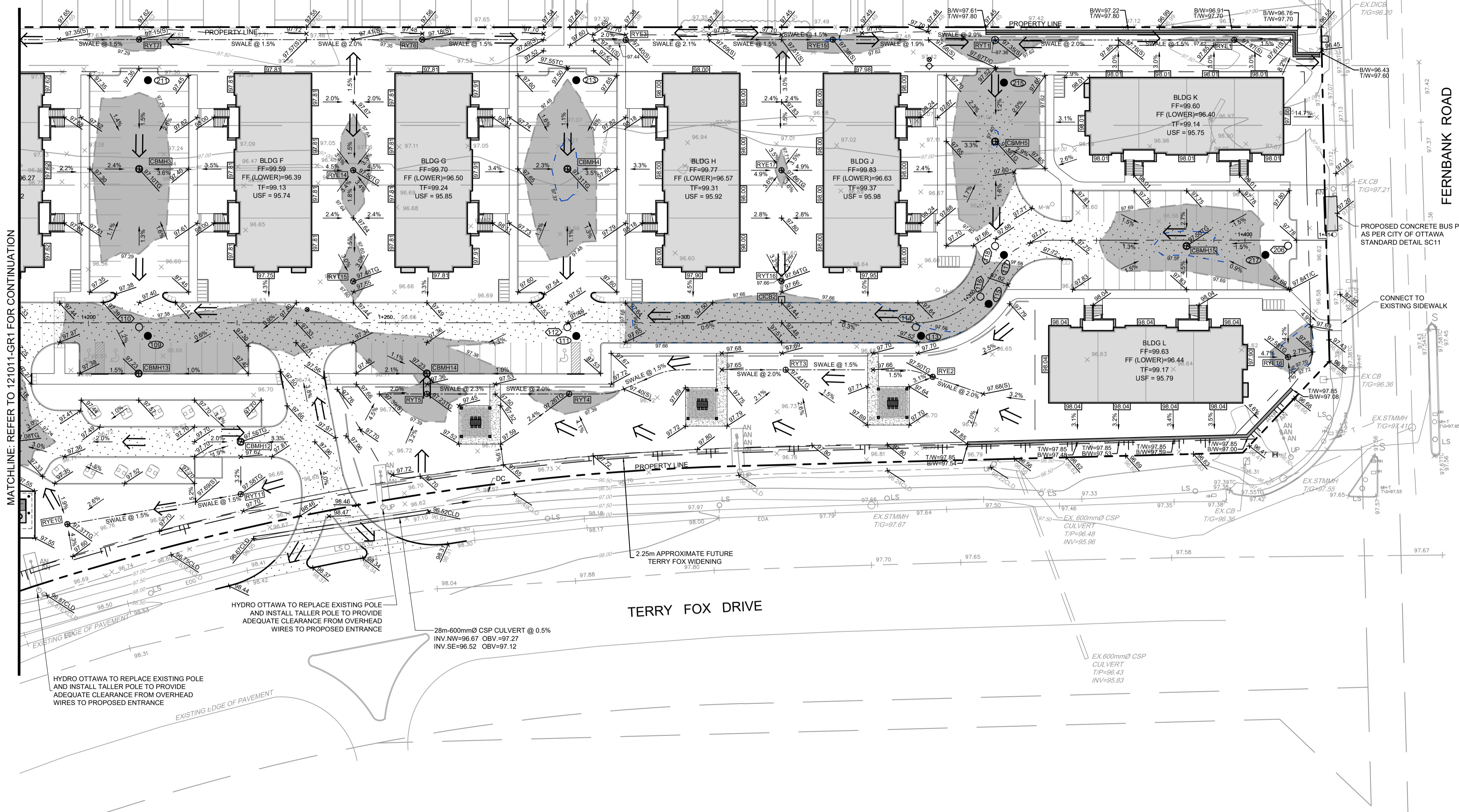

NOTE:
THE POSITION OF ALL POLE LINES, CONDUITS, WATERMANS, SEWERS AND OTHER UNDERGROUND AND OVERGROUND UTILITIES AND STRUCTURES IS NOT NECESSARILY SHOWN ON THE CONTRACT DRAWINGS, AND WHERE SHOWN, THE ACCURACY OF THE POSITION OF SUCH UTILITIES AND STRUCTURES IS NOT GUARANTEED. BEFORE STARTING WORK, DETERMINE THE EXACT LOCATION OF ALL SUCH UTILITIES AND STRUCTURES AND ASSUME ALL LIABILITY FOR DAMAGE TO THEM.

No.	REVISION	DATE	BY
8.	REVISED PER CITY COMMENTS	MAR 18/26	DOB
7.	REVISED SITE PLAN SUBMISSION	NOV 14/25	DOB
6.	RE-ISSUED FOR TENDER	JAN 18/24	DOB
5.	ISSUED FOR ADDENDUM #2	JUNE 8/22	DOB
4.	ISSUED FOR TENDER	MAY 20/22	DOB
3.	REVISED PER CITY COMMENTS	FEB 17/22	DOB
2.	REVISED PER CITY COMMENTS	NOV 5/21	DOB
1.	ISSUED FOR CITY OF OTTAWA REVIEW	JUN 2/21	DOB

DESIGN	SCALE
BM	1:400
DOB	1:400
ATE	1:400
BM	1:400
DOB	1:400

FOR REVIEW ONLY

DESIGN: BM
CHECKED: DOB
DRAWN: ATE
CHECKED: BM
APPROVED: DOB

LICENSED PROFESSIONAL ENGINEER
D. D. BLAIR
100122737
MAY 18 2026
PROVINCE OF ONTARIO

NOVATECH
Engineers, Planners & Landscape Architects
Suite 200, 240 Michael Cowpland Drive
Ottawa, Ontario, Canada K2M 1P6
Telephone: (613) 254-9643
Facsimile: (613) 254-5867
Website: www.novatech-eng.com

CITY OF OTTAWA
5331 FERNBANK ROAD
IRON VALLEY 2

DRAWING NAME
GRADING PLAN

PROJECT No: 121011-00
REV: REV # 8
DRAWING No: 121011-GR2
#18539

M:\2021\121011-GR2\Drawings\GR2_Mar_18_2026 - 12:41pm.dwg