

KEY PLAN, NTS

GENERAL NOTES

1. ALL SITE INFORMATION AND GENERAL CONDITIONS COMPILED FROM THE ARCHITECTS, SURVEY AND ENGINEERS PLANS AND REVIEWS.
2. DO NOT SCALE THIS DRAWING.
3. REPORT ANY ANOMALIES BEFORE THE BEGINNING OF THE ROADWORKS. THE LANDSCAPE ARCHITECT IS NOT RESPONSIBLE FOR UNKNOWN UNDERGROUND CONDITIONS.
4. RESTORE ALL DAMAGED AREAS AND FEATURES AS A RESULT OF CONSTRUCTION ACTIVITIES TO THE SATISFACTION OF THE LANDSCAPE ARCHITECT.
5. THE DRAWING CANNOT BE USED FOR CONSTRUCTION UNTIL HAVING BEEN SIGNED BY THE LANDSCAPE ARCHITECT AS ISSUED FOR CONSTRUCTION.
6. THE ACCURACY OF UTILITY POSITIONS IS NOT GUARANTEED.
7. EACH UTILITY COMPANY MUST BE CONTACTED TO CONFIRM THE EXISTENCE AND LOCATION OF UTILITIES BEFORE DIGGING. MUST BE CONTACTED TO CONFIRM THE EXISTENCE AND LOCATION OF PUBLIC SERVICES BEFORE DIGGING.
8. THIS DRAWING IS A SERVICE INSTRUMENT AND ITS USE REQUIRES AUTHORIZATION OF THE LANDSCAPE ARCHITECT. COPYRIGHT RESERVED BY LANDSCAPE ARCHITECT, DAVID LASHLEY.
9. THERE IS 1.5m SEPARATION BETWEEN THE PROPOSED TREES AND SERVICE LATERALS.

CLIENT:

2	2026-05-29	ISSUED FOR ENGINEER COORDINATION
1	2025-09-11	SITE PLAN CONTROL APPLICATION

NO. DATE DESCRIPTION

SEAL:		NORTH:	
-------	--	--------	--

LASHLEY & ASSOCIATES
 202-950 GLADSTONE
 OTTAWA, ONTARIO
 CANADA
 K1Y 3E6
 T: 613-233-8579
 F: 613-233-4051

CONSULTANT:

PROJECT:

3210 Albion Road
 3210 Albion road South
 Ottawa ON

DRAWING TITLE:
**EXISTING CONDITIONS AND
 DEMOLITION PLAN**

DATE:	2025-07-24	DRAWING NO.:	
SCALE:	AS NOTED		
DRAWN BY:	IS		
LA PROJECT NO.:	125901-1		

1 EXISTING TREE PLAN
 TP-01 Scale: 1:200

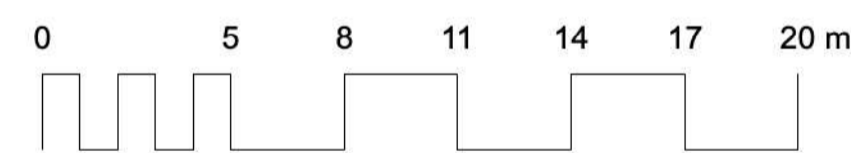

Existing Tree Report

ID	Botanical Name	Common Name	Average Spread	Height	DBH	No. of Stems	Condition	Action	Date Assessed	Notes
E01	Populus. orandidentata	Larretooth aspen	10	5	0.53	1	Good	Retain	2025-07-18	HYDROVAC ROOTS AT PERIMETER
E02	Populus. orandidentata	Larretooth aspen	11	5	0.65	1	Average	Retain	2025-07-18	HYDROVAC ROOTS AT PERIMETER
E03	Populus. orandidentata	Larretooth aspen	5	5	0.255	1	Average	Retain	2025-07-18	
E04	Populus. orandidentata	Larretooth aspen	5	5	0.145	1	Average	Retain	2025-07-18	
E05	Populus. orandidentata	Larretooth aspen	5	5	0.301	6	Poor	Remove	2025-07-18	Growing into fence
E06	Acer. neundo	Manitoba Maple	5	5	0.12	1	Poor	Remove	2025-07-18	Growing into fence
E07	Populus. tremuloides	Trembling Aspen	5	5	0.105	3	Average	Remove	2025-07-18	
E08	Acer. neundo	Manitoba Maple	4	5	0.211	3	Average	Retain	2025-07-18	
E09	Fraxinus. pensylvanica	Green Ash	5	5	0.13	1	Average	Remove	2025-07-18	
E10	Salix. Niora	Black Willow	5	5	0.27	1	Average	Retain	2025-07-18	
E11	Salix. Niora	Black Willow	5	5	0.235	1	Average	Retain	2025-07-18	
E12	Salix. Niora	Black Willow	5	5	0.13	1	Average	Retain	2025-07-18	
E13	Salix. Niora	Black Willow	5	5	0.22	2	Average	Retain	2025-07-18	

LEGEND

- PROPERTY LINE
- EXISTING TREE TO BE REMOVED
- EXISTING TREE TO BE RETAINED





KEY PLAN, NTS

GENERAL NOTES

1. ALL SITE INFORMATION AND GENERAL CONDITIONS COMPILED FROM THE ARCHITECTS, SURVEY AND ENGINEERS PLANS AND REVIEWS.
2. DO NOT SCALE THIS DRAWING.
3. REPORT ANY ANOMALIES BEFORE THE BEGINNING OF THE ROADWORKS. THE LANDSCAPE ARCHITECT IS NOT RESPONSIBLE FOR UNKNOWN UNDERGROUND CONDITIONS.
4. RESTORE ALL DAMAGED AREAS AND FEATURES AS A RESULT OF CONSTRUCTION ACTIVITIES TO THE SATISFACTION OF THE LANDSCAPE ARCHITECT.
5. THE DRAWING CANNOT BE USED FOR CONSTRUCTION UNTIL HAVING BEEN SIGNED BY THE LANDSCAPE ARCHITECT AS ISSUED FOR CONSTRUCTION.
6. THE ACCURACY OF UTILITY POSITIONS IS NOT GUARANTEED.
7. EACH UTILITY COMPANY MUST BE CONTACTED TO CONFIRM THE EXISTENCE AND LOCATION OF UTILITIES BEFORE DIGGING. MUST BE CONTACTED TO CONFIRM THE EXISTENCE AND LOCATION OF PUBLIC SERVICES BEFORE DIGGING.
8. THIS DRAWING IS A SERVICE INSTRUMENT AND ITS USE REQUIRES AUTHORIZATION OF THE LANDSCAPE ARCHITECT. COPYRIGHT RESERVED BY LANDSCAPE ARCHITECT, DAVID LASHLEY.
9. THERE IS 1.5m SEPARATION BETWEEN THE PROPOSED TREES AND SERVICE LATERALS.

CLIENT:

2	2026-05-29	ISSUED FOR ENGINEER COORDINATION
1	2025-09-11	SITE PLAN CONTROL APPLICATION

NO.	DATE	DESCRIPTION
-----	------	-------------

SEAL: NORTH:

LASHLEY & ASSOCIATES
202-950 GLADSTONE
OTTAWA, ONTARIO
CANADA
K1Y 3E6
T: 613-233-8579
F: 613-233-4051

CONSULTANT:

PROJECT:

3210 Albion Road
3210 Albion road South
Ottawa ON

DRAWING TITLE:

PROPOSED PLANTING PLAN

DATE:	2025-09-08	DRAWING NO.:	
SCALE:	AS NOTED		
DRAWN BY:	IS		
LA PROJECT NO.:	125901-1		

TP-02

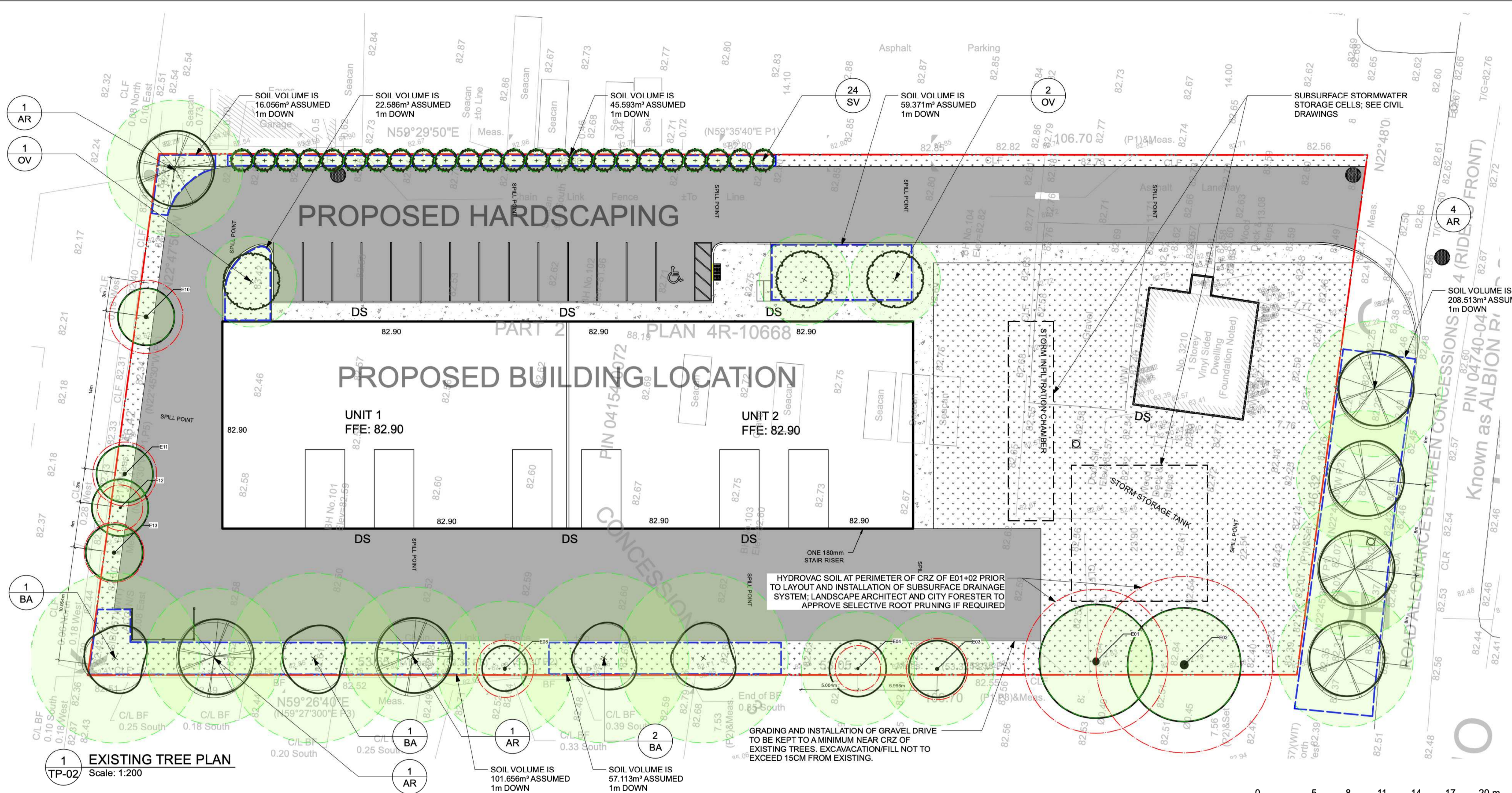

1 EXISTING TREE PLAN
TP-02 Scale: 1:200

- LEGEND**
- PROPERTY LINE
 - - - TREE PROTECTION FENCING
 - - - SOIL VOLUME FOR NEW TREES
 - APPROX. 40-YEAR TREE CANOPY
 - SOD
 - ASPHALT
 - CONCRETE
 - PROPOSED TREE
 - EXISTING TREE TO BE RETAINED

Existing Tree Report

ID	Botanical Name	Common Name	DBH	No. of Stems	Notes
E01	Populus grandidentata	Largetooth aspen	0.53	1	
E02	Populus grandidentata	Largetooth aspen	0.65	1	
E03	Populus grandidentata	Largetooth aspen	0.225	1	
E04	Populus grandidentata	Largetooth aspen	0.145	1	
E08	Acer negundo	Manitoba Maple	0.211	3	
E10	Salix Niora	Black Willow	0.27	1	
E11	Salix Niora	Black Willow	0.235	1	
E12	Salix Niora	Black Willow	0.13	1	
E13	Salix Niora	Black Willow	0.22	2	

Proposed Tree Report

ID	Botanical Name	Common Name	QTY	Scheduled Planting Size	Notes
AR	Acer Rubrum	Red Maple	7	50mm cal POT	
BA	Betula alleghaniensis	Yellow Birch	4	45mm Cal Pot	
OV	Ostrya virginiana	American Hoopbeam	3	45mm Cal Pot	
SV	Syringaa Vulcans	Common Lilac	24	150-200cm POT	

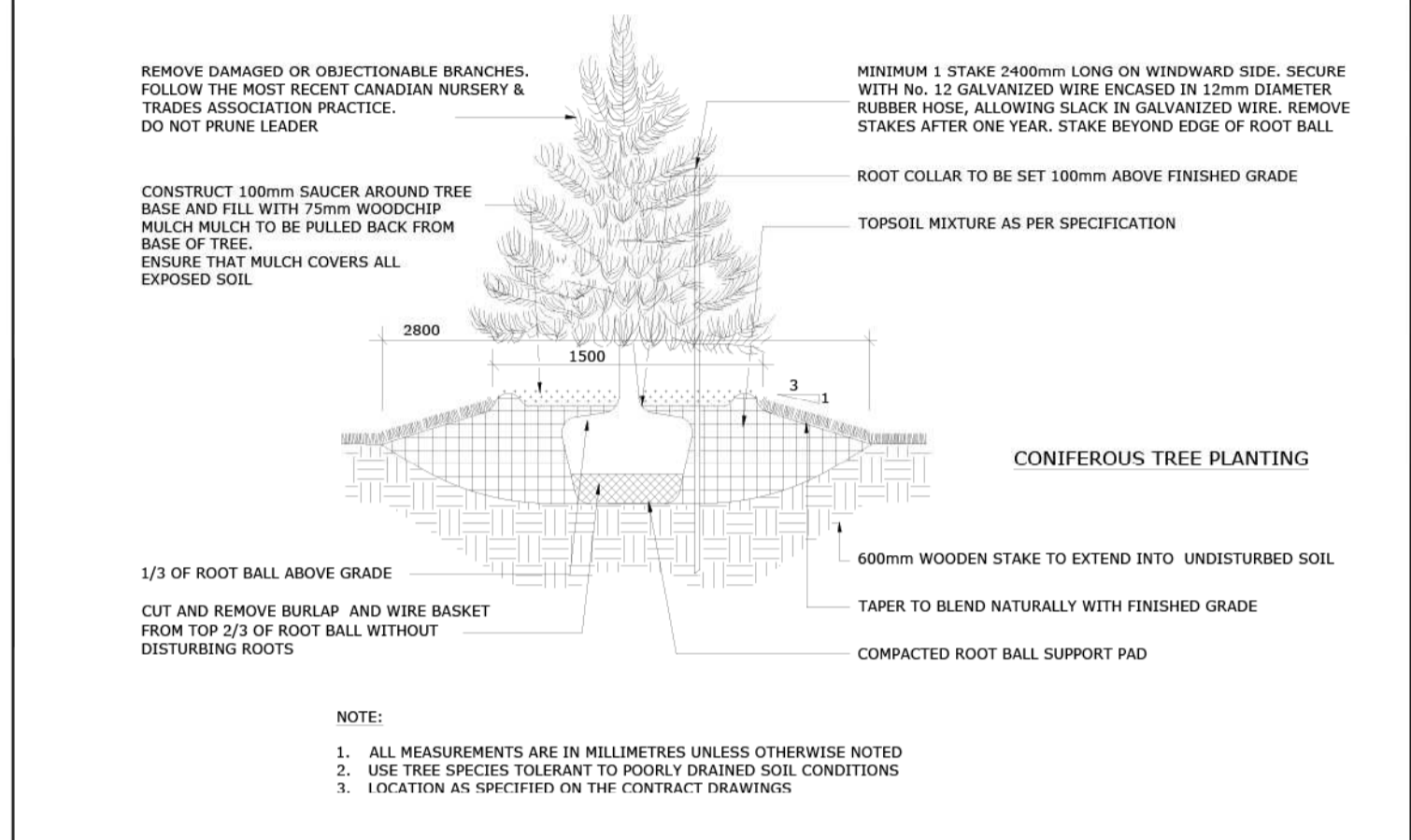
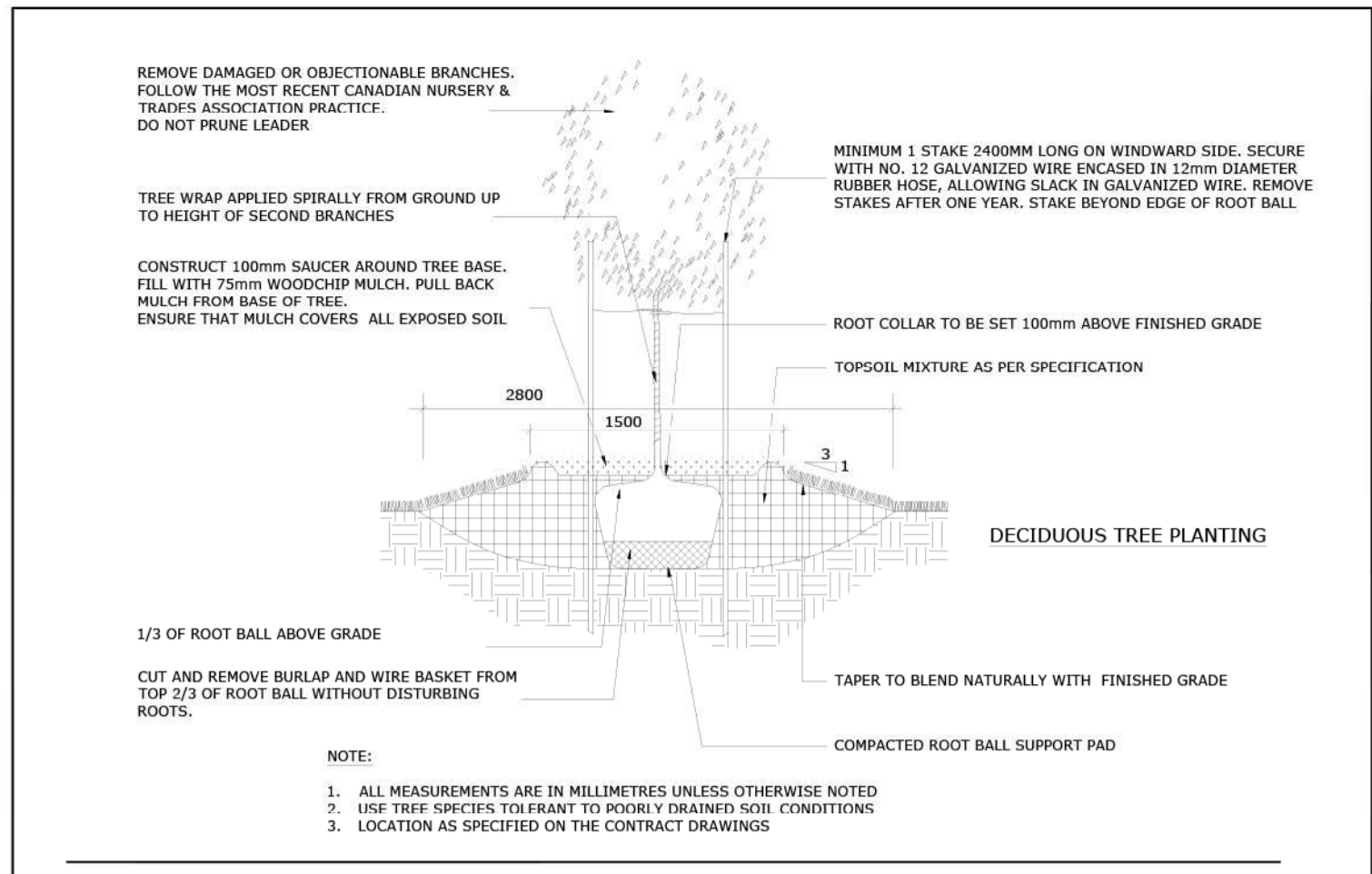

Ottawa TITLE: PLANTING PIT POORLY DRAINED SOILS DATE: MAY 2001
 REV: FEB 2017
 DWG No: L6

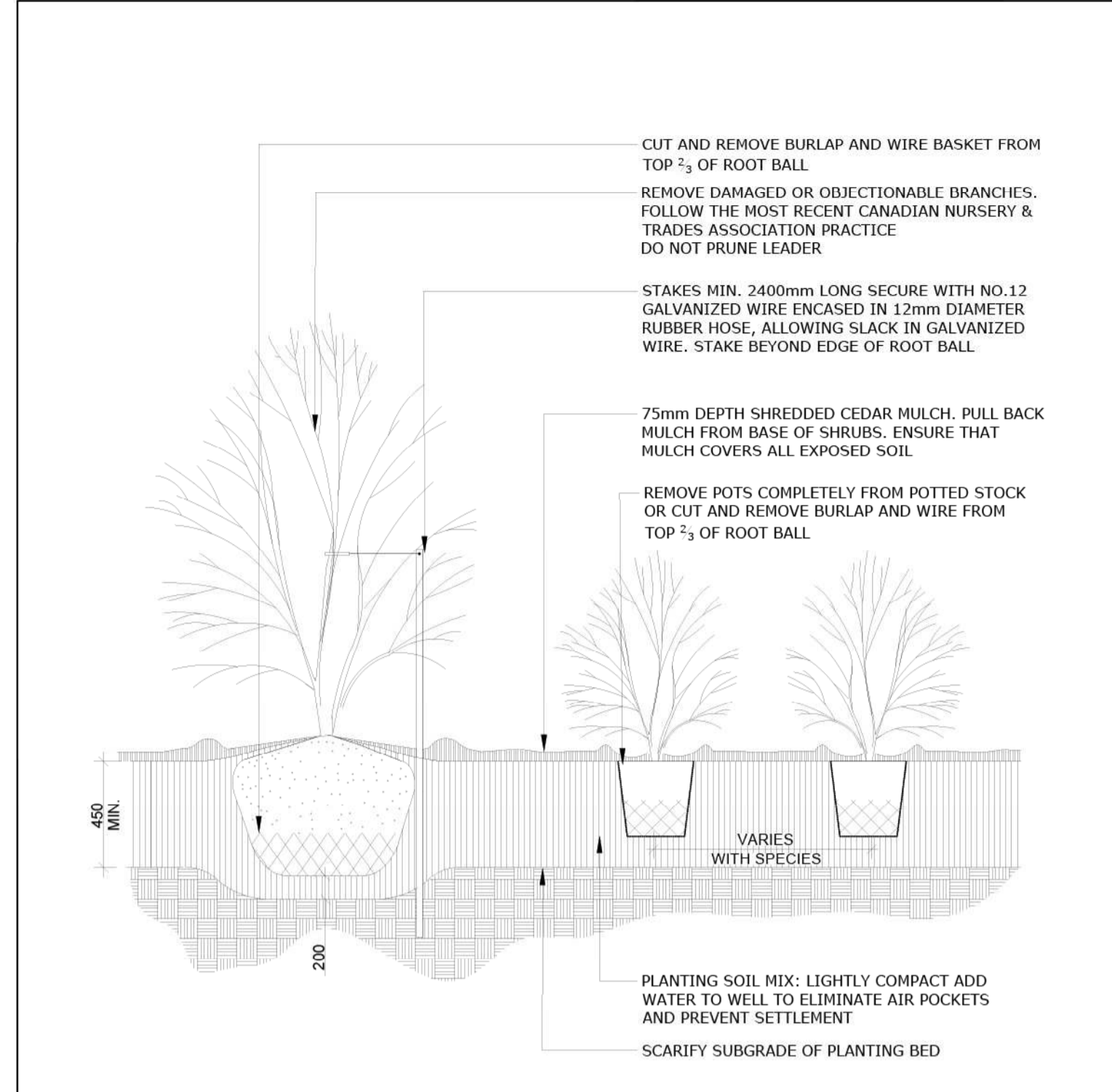

Ottawa TITLE: CONTINUOUS SHRUB BED PLANTING DATE: FEB 2013
 REV: FEB 2014
 DWG No: L17

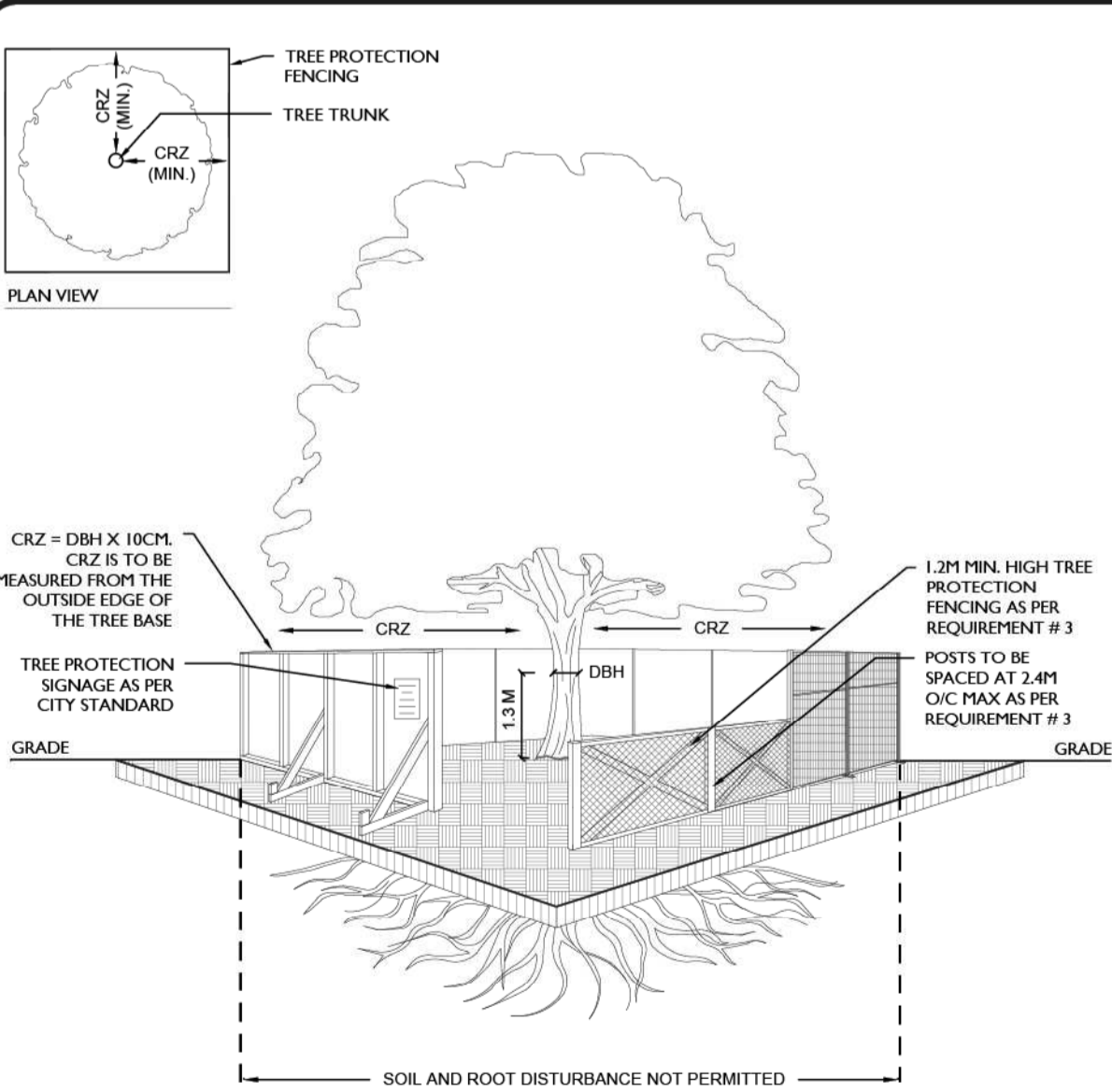

Ottawa TITLE: TREE PROTECTION SPECIFICATION DATE: MARCH 2021
 SCALE: NTS
 DATE: MARCH 2021
 DRAWING NO: 1 of 1

Ottawa TO BE IMPLEMENTED FOR RETAINED TREES, BOTH ON SITE AND ON ADJACENT SITES, PRIOR TO ANY TREE REMOVAL OR SITE WORKS AND MAINTAINED FOR THE DURATION OF WORK ACTIVITIES ON SITE.



Subject Site
 ALBION ROAD SOUTH
 JOHNSTON ROAD

KEY PLAN, NTS

GENERAL NOTES

1. ALL SITE INFORMATION AND GENERAL CONDITIONS COMPILED FROM THE ARCHITECTS, SURVEY AND ENGINEERS PLANS AND REVIEWS.
2. DO NOT SCALE THIS DRAWING.
3. REPORT ANY ANOMALIES BEFORE THE BEGINNING OF THE ROADWORKS.
4. RESTORE ALL DAMAGED AREAS AND FEATURES AS A RESULT OF CONSTRUCTION ACTIVITIES TO THE SATISFACTION OF THE LANDSCAPE ARCHITECT.
5. THE DRAWING CANNOT BE USED FOR CONSTRUCTION UNTIL HAVING BEEN SIGNED BY THE LANDSCAPE ARCHITECT AS ISSUED FOR CONSTRUCTION.
6. THE ACCURACY OF UTILITY POSITIONS IS NOT GUARANTEED.
7. EACH UTILITY COMPANY MUST BE CONTACTED TO CONFIRM THE EXISTENCE AND LOCATION OF UTILITIES BEFORE DIGGING. MUST BE CONTACTED TO CONFIRM THE EXISTENCE AND LOCATION OF PUBLIC SERVICES BEFORE DIGGING.
8. THIS DRAWING IS A SERVICE INSTRUMENT AND ITS USE REQUIRES AUTHORIZATION OF THE LANDSCAPE ARCHITECT. COPYRIGHT RESERVED BY LANDSCAPE ARCHITECT, DAVID LASHLEY.
9. THERE IS 1.5m SEPARATION BETWEEN THE PROPOSED TREES AND SERVICE LATERALS.

CLIENT:

2	2026-05-29	ISSUED FOR ENGINEER COORDINATION
1	2025-10-10	SITE PLAN CONTROL APPLICATION

NO.	DATE	DESCRIPTION
2	2026-05-29	ISSUED FOR ENGINEER COORDINATION
1	2025-10-10	SITE PLAN CONTROL APPLICATION

SEAL: [Signature of David Lashley, Landscape Architect]

NORTH: [North Arrow]

LASHLEY & ASSOCIATES
 202-950 GLADSTONE
 OTTAWA, ONTARIO
 CANADA
 K1Y 3E6
 T: 613-233-8579
 F: 613-233-4051

CONSULTANT:

PROJECT:

3210 Albion Road
 3210 Albion road South
 Ottawa ON

DRAWING TITLE:
**LANDSCAPE AND PLANTING
 DETAILS**

DATE: 2025-10-10 DRAWING NO.:
 SCALE: AS NOTED
 DRAWN BY:
 LA PROJECT NO.: 125901-1

TP-03