

**TOPOGRAPHIC PLAN OF SURVEY OF  
PART OF LOTS 23 & 22  
CONCESSION 8  
AND  
PART OF BLOCK 79  
REGISTERED PLAN 4M-896  
(GEOGRAPHIC TOWNSHIP OF OSGOODE)  
CITY OF OTTAWA  
Stantec Geomatics Ltd.  
ONTARIO LAND SURVEYORS**

Drawing Remains the Property of Copyright Reserved by GJA INC. Do Not Use or Reproduce Without Approval of Gino J. Aiello  
| PLANTING MIX TO BE APPROVED BY LANDSCAPE ARCHITECT | PLANT MATERIAL TO MEET CNLA STANDARDS/BE APPROVED BY LANDSCAPE ARCHITECT PRIOR TO PLANTING ALL MATERIALS & WORK TO BE MAINTAINED UNTIL FINAL ACCEPTANCE. INCLUDE 1 YEAR WARRANTY FROM DATE OF FINAL ACCEPTANCE | REFER TO CIVIL ENGINEER'S DRAWING FOR ELEVATIONS / GRADING |  
The Landscape Plan is to be read in conjunction with the grading, servicing, site and survey plan. All trees to be preserved on or directly adjacent to the site will be protected | Plant material are to be installed a minimum of 3.0m away from any part of any hydro transformer, 3.0m corridor between a fire hydrant and the curb, a 2.5m radius beside or behind a fire hydrant, 2.0m from any servicing/utility line or structure |

KEY PLAN

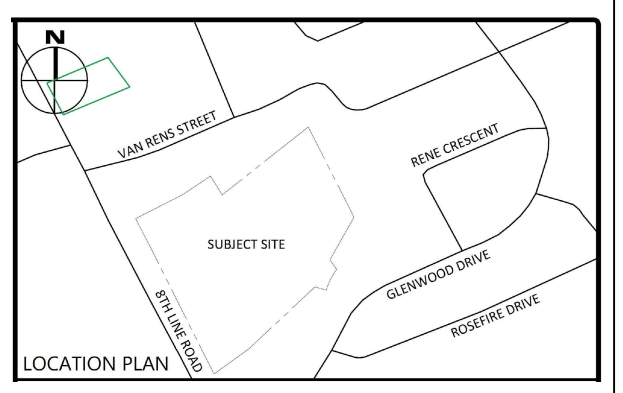

**CONSULTANT TEAM**  
ARCHITECT: DESIGN ARCHITECTURE  
CIVIL: EGB  
LANDSCAPE ARCHITECT: GJA INC.  
SURVEYOR: STANTEC GEOMATICS

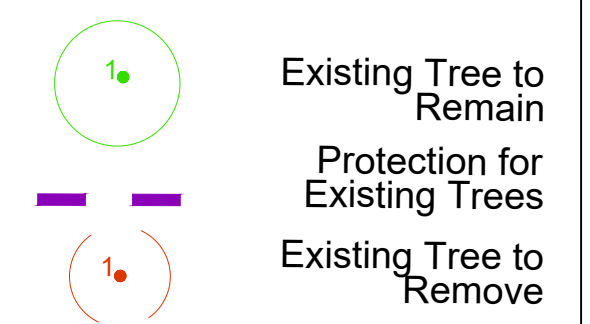
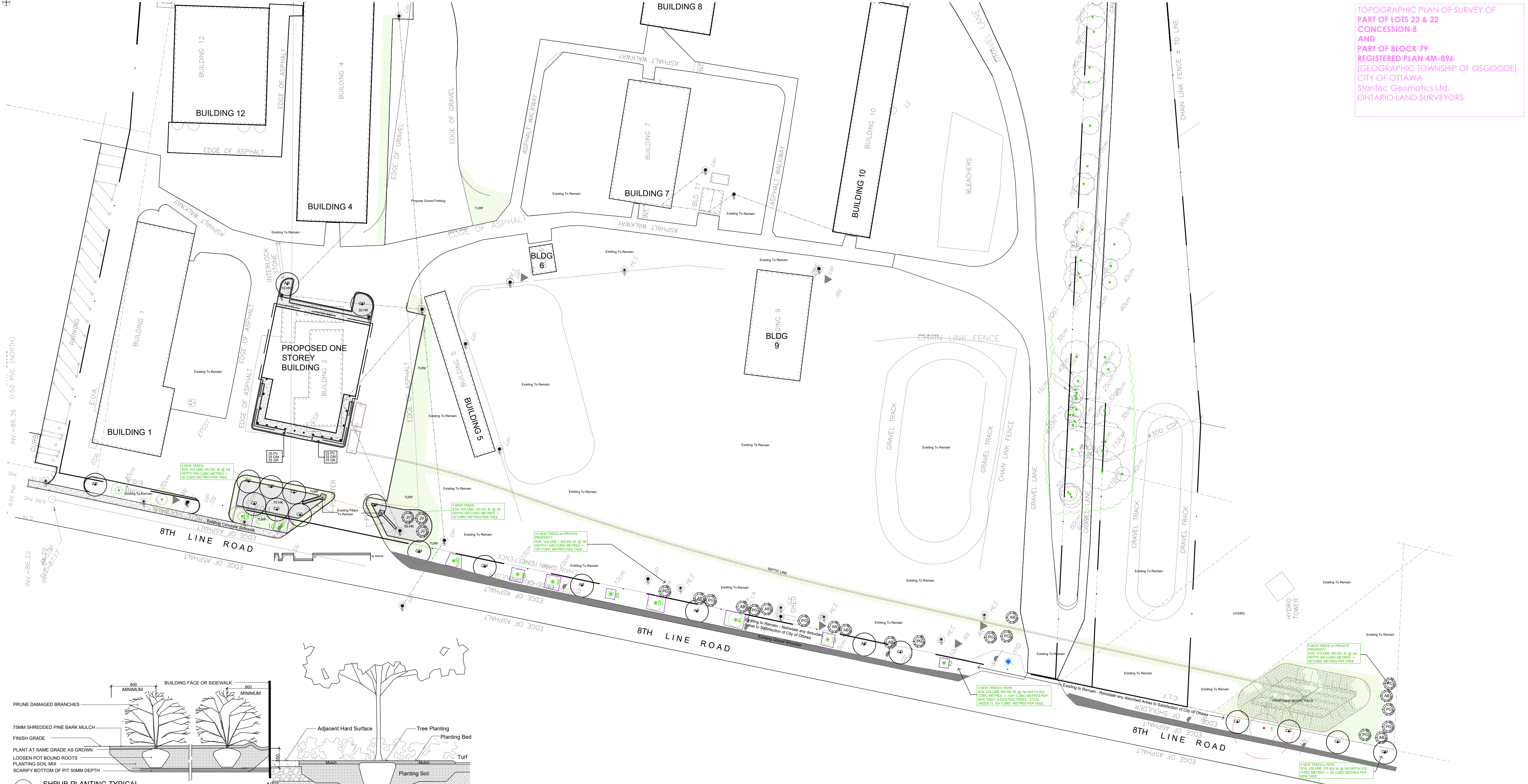

**LEGEND  
LANDSCAPE PROPOSED**

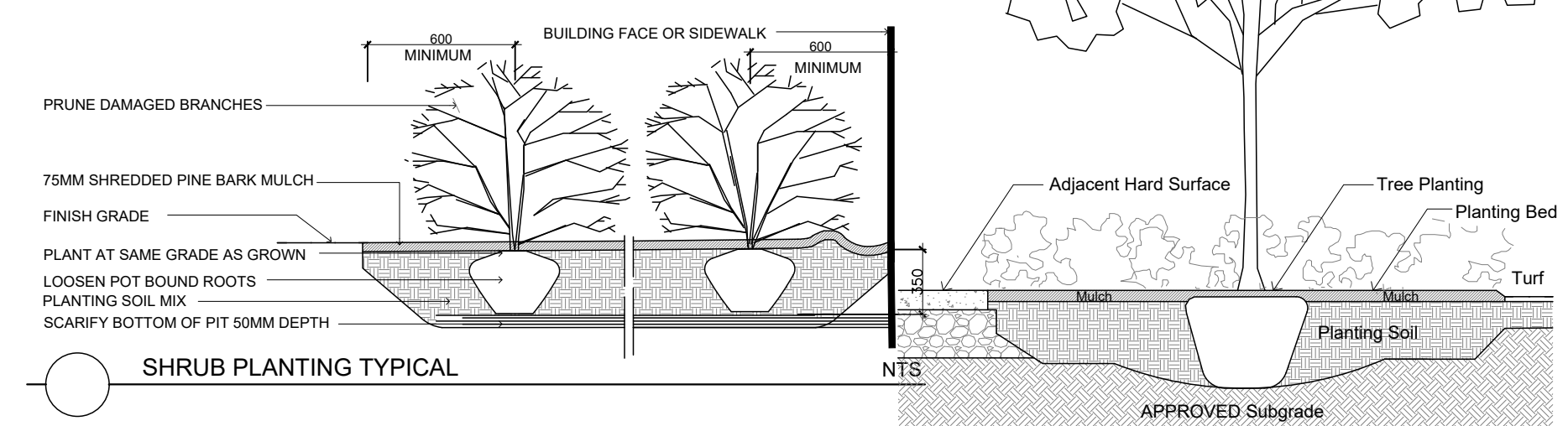
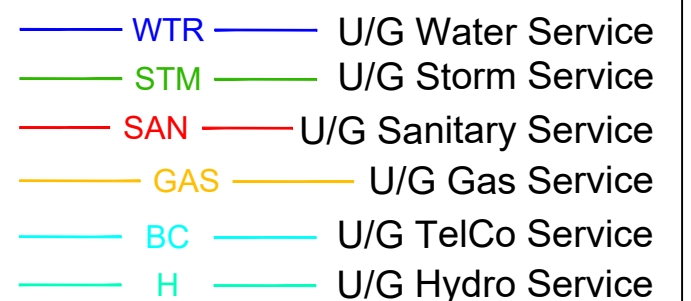
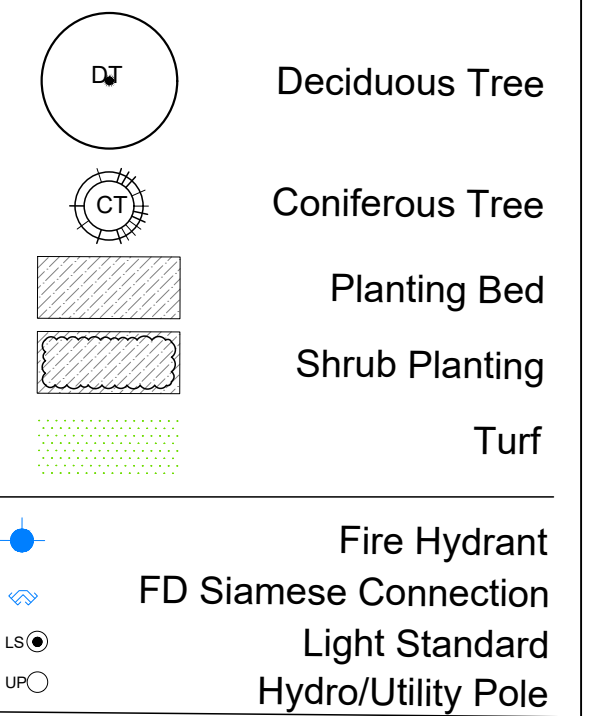

During Excavation/Bed Preparation if Extreme Conditions are Encountered (Water, Rock, Gravel...) Notify GJA INC Immediately.

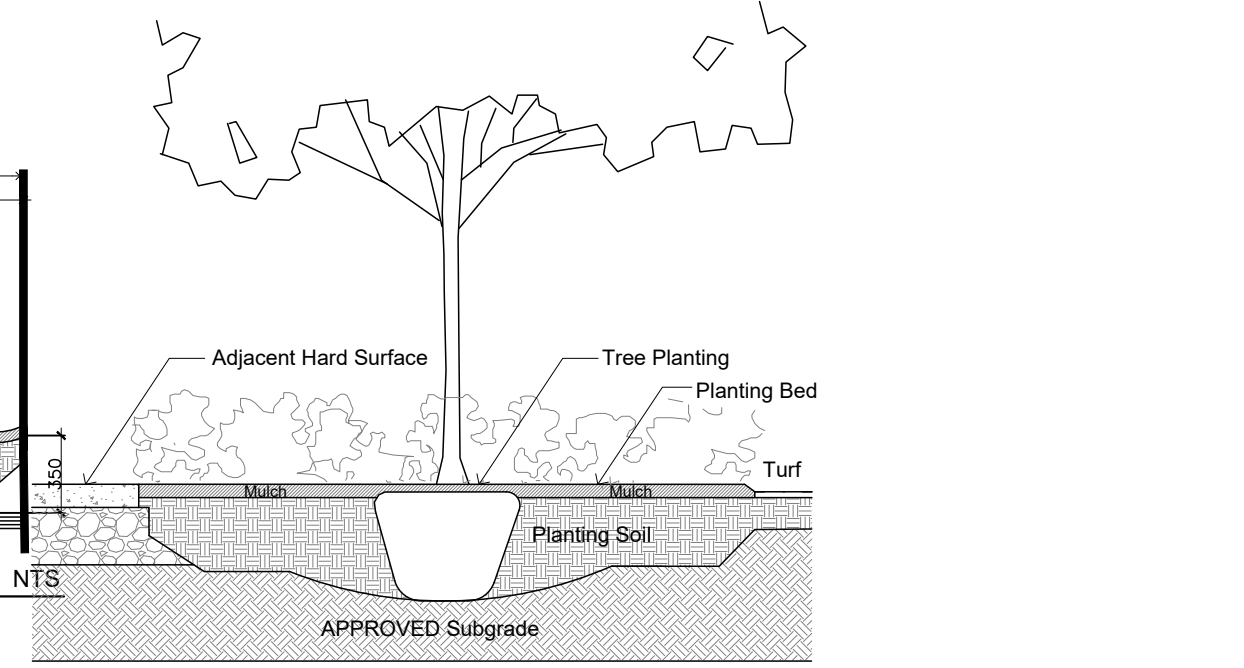

TREE PLANTING IN PLANTING BED NTS

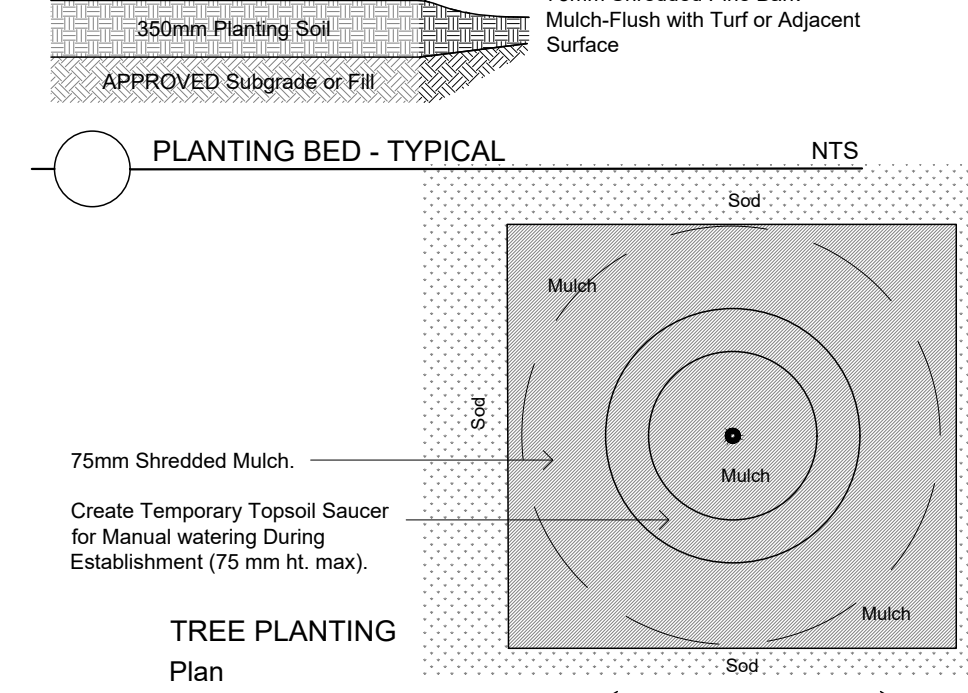

PLANTING BED - TYPICAL NTS

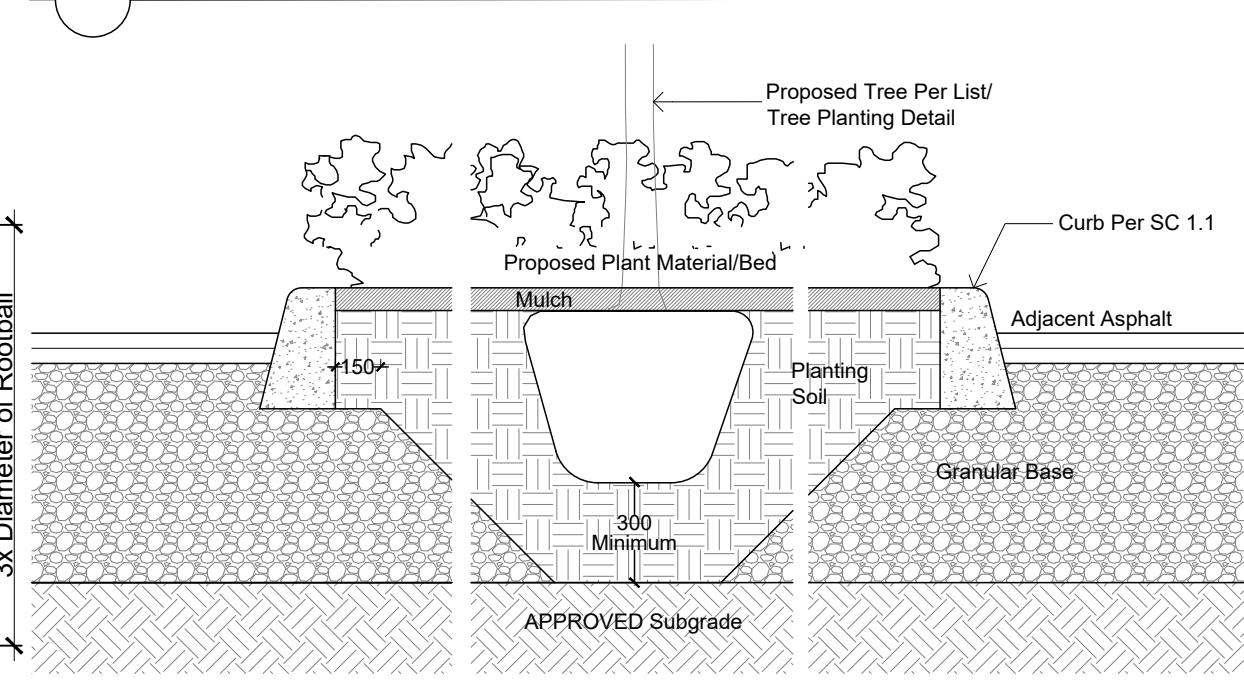

PLANTING IN ISLAND SECTION - TYPICAL NTS

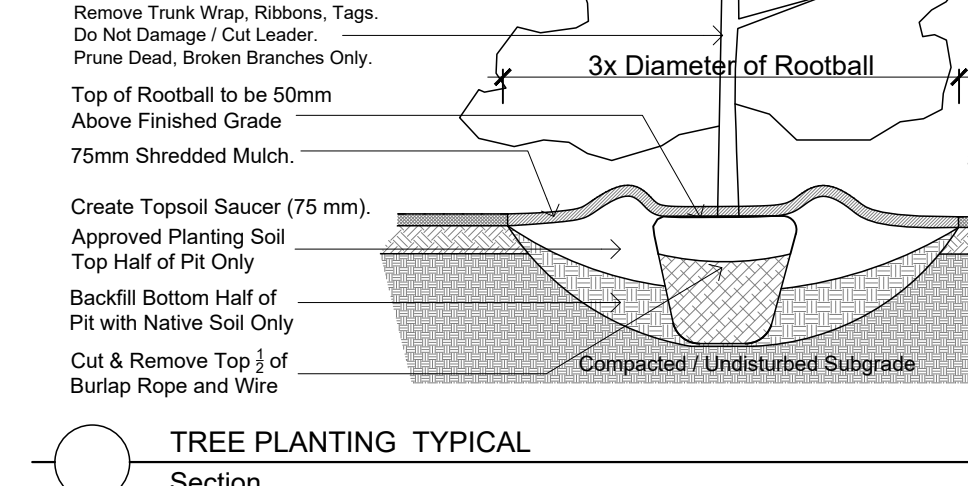

TREE PLANTING TYPICAL Section NTS

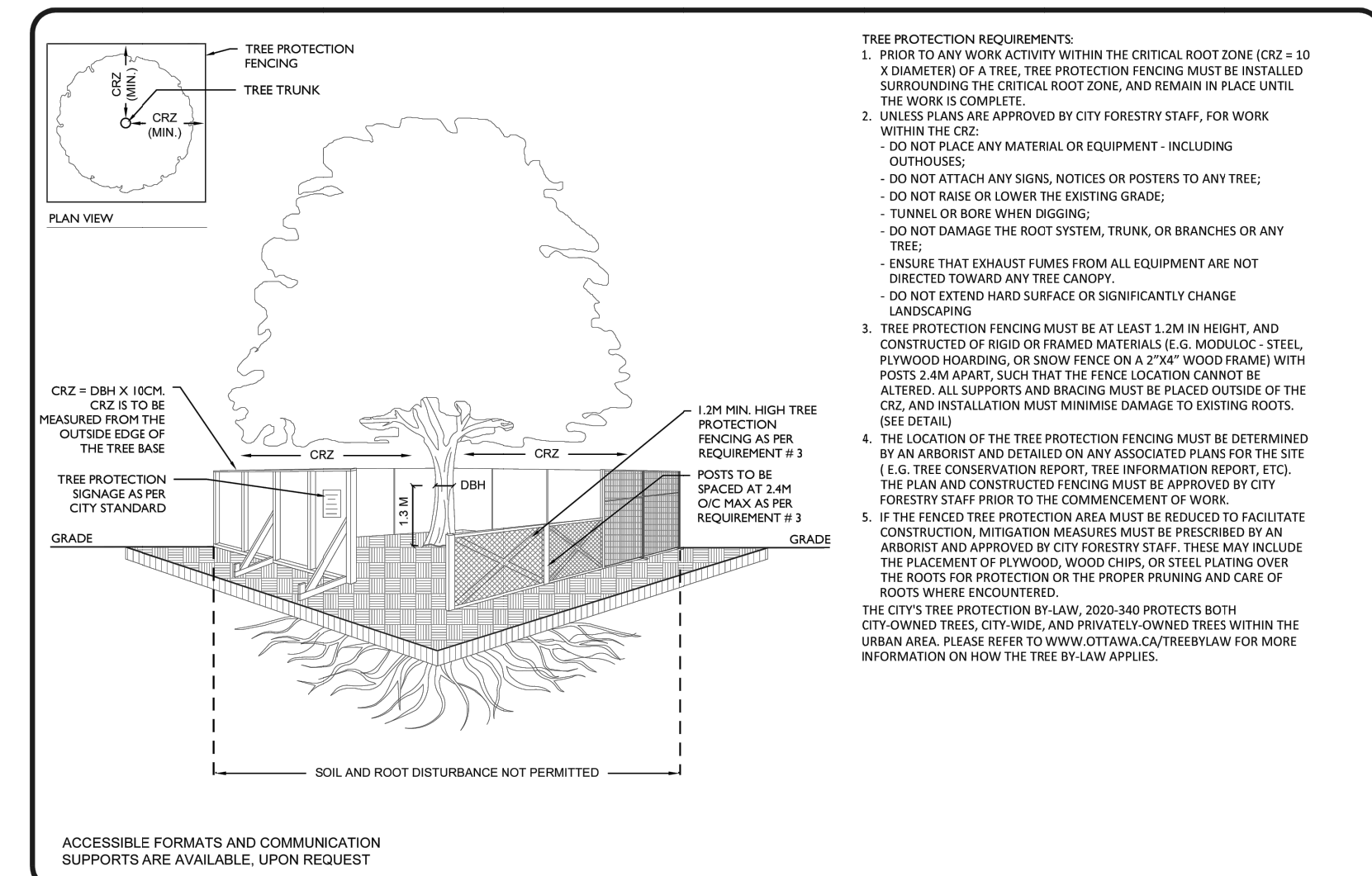

**TREE PROTECTION SPECIFICATION**  
TO BE IMPLEMENTED FOR RETAINED TREES, BOTH ON SITE AND ON ADJACENT SITES, PRIOR TO ANY TREE REMOVAL OR SITE WORKS AND MAINTAINED FOR THE DURATION OF WORK ACTIVITIES ON SITE.  
SCALE: NTS  
DATE: MARCH 2021  
DRAWING NO: 1 of 1

**TREE SCHEDULE - METCALFE FAIRGROUNDS NEW OFFICE 2821 8th Line Road**

CODE	QUANTITY	BOTANICAL NAME	COMMON NAME	B&B SPECIMEN	NATIVE to CANADA	FORECASTED SPREAD per City of Ottawa Forestry	Canopy Cover Contribution/Trees in Square Metres	Total Canopy Cover			
SITE	OFF SITE	TOTAL									
AR	1	4	5	Acer rubrum	Red Maple	50mm cal	YES	10.0M	5.0M	78.5	392.5
CO	6	3	9	Celtis occidentalis	Common Hackberry	50mm cal	YES	14.0M	7.0M	154	1385
CM	2	3	5	Quercus macrocarpa	Bur Oak	50mm cal	YES	14.0M	7.0M	154	770
<b>TOTAL</b>	<b>9</b>	<b>10</b>	<b>19</b>	<b>Total Forecasted Canopy Cover Contribution Estimate for Proposed Deciduous Trees in sq. m.</b>				<b>2548.5</b>			
AB	9	0	9	Abies balsamea	Balsam Fir	1.5m HL	YES	5.0M	2.5M	20	180
JV	3	0	3	Liriodendron virginiana	Eastern Red Cedar	1.5m HL	YES	3.0M	1.5M	7	21
PG	11	0	11	Picea glauca	White Spruce	1.5m HL	YES	5.0M	2.5M	20	220
<b>TOTAL</b>	<b>23</b>	<b>0</b>	<b>23</b>	<b>Total Forecasted Canopy Cover Contribution Estimate for Proposed Trees in sq. m.</b>				<b>421</b>			

**METCALFE FAIRGROUNDS NEW OFFICE EXISTING TREE INVENTORY**

TCR Tree No.	CITY #.	REMOVE/RETAIN	Species	DBH in Centimetres	CRZ Radius in Metres	Condition / Age / Notes / Species Origin
1	8390403	REMOVE	Manitoba Maple	33 & 50	8.0M R	Fair; mature; double-stemmed at 1m; southwest bisect at 2m; generally upright in form; naturalized species
2	8404338	RETAIN	Red oak	12	1.2M R	Fair; maturing; native species
3	8404340	RETAIN	Hackberry	14	1.4M R	Good; maturing; native species
4	8404341	RETAIN	Hackberry	19	1.9M R	Good; maturing; native species
5	8390405	RETAIN	Hackberry	19	1.9M R	Good; maturing; native species
6	8390406	RETAIN	Red oak	7	7M R	Fair; immature; basal damage; native species
7	8404342	RETAIN	Red oak	16	1.6M R	Good; maturing; native species
8	8404343	RETAIN	Red oak	14	1.4M R	Good; maturing; native species
9	8390407	RETAIN	Hackberry	16	1.2M R	Good; maturing; native species
10	8390408	RETAIN	Honey-locust	16	1.6M R	Good; restricted rooting area; introduced species to Eastern Ontario
11	8390409	RETAIN	White elm	25	2.5M R	Good; restricted rooting area; native cultivar

1 SPC SUBMISSION 1 2025 10 24  
0 REVIEW COORDINATOR 2025 09 29  
# Revision: \_\_\_\_\_ Date: \_\_\_\_\_

PROPERTY OWNER  
**Metcalfe Fairgrounds**

**GJA INC.**  
GINO J. AIELLO | LANDSCAPE ARCHITECT  
GJAL.COM | 613 286 5130 | GINO@GJAL.COM  
1155 BROADVIEW ROAD UNIT #11, OTTAWA ON K1K 0E2

**METCALFE FAIRGROUNDS OFFICE**  
2821 Eighth Line Road Metcalfe

**Landscape Plan / TCR**  
Scale: 1:500

PLAN NO: L1