

# 1670 TENTH LINE ROAD

## LIST OF DRAWINGS

- L1.0 NOTES AND SCHEDULES
- L1.1 TREE CONSERVATION REPORT
- L1.2 VALIDATING INFO. PLAN
- L1.3 LANDSCAPE PLAN
- L2.0 LANDSCAPE DETAILS 1

## CONSULTANTS

project1  
studio

PROJECT 1 STUDIO  
300 - 260 ST. PATRICK STREET,  
OTTAWA, ON, CANADA, K1N 5K5  
PH: 613. 884. 3939

Urbantypology

UNIT 101 - 45 SPENCER STREET  
OTTAWA, ON, CANADA, K1Y 2P5  
PH: 613.867.3042 / 613.897.1237











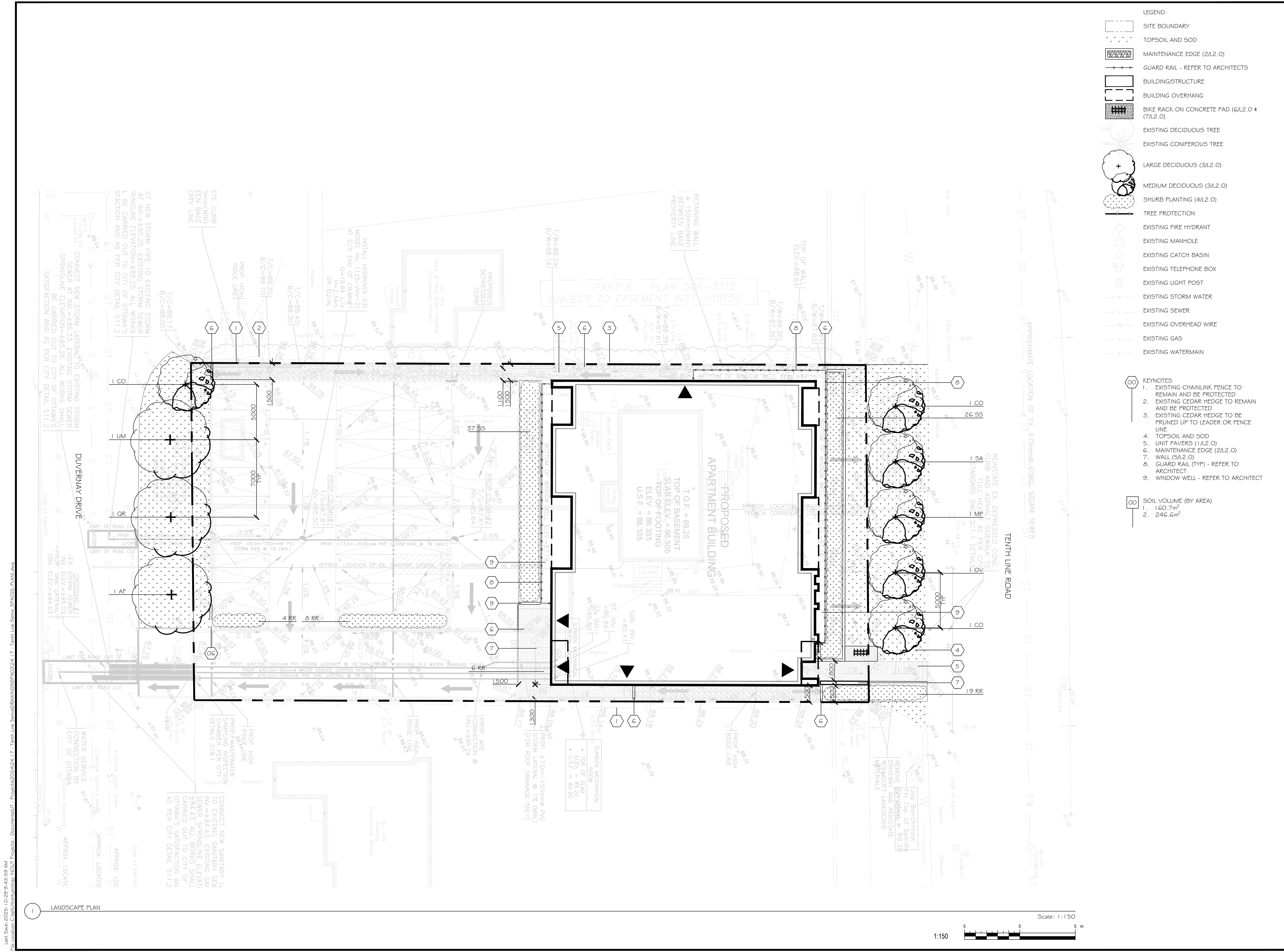

- LEGEND:
- SITE BOUNDARY
  - TOPSOIL AND SOD
  - MAINTENANCE EDGE (2/L2.0)
  - GUARD RAIL - REFER TO ARCHITECTS
  - BUILDING/STRUCTURE
  - BUILDING OVERHANG
  - BIKE RACK ON CONCRETE PAD (6/L2.0 & 7/L2.0)
  - EXISTING DECIDUOUS TREE
  - EXISTING CONIFEROUS TREE
  - LARGE DECIDUOUS (3/L2.0)
  - MEDIUM DECIDUOUS (3/L2.0)
  - SHRUB PLANTING (4/L2.0)
  - TREE PROTECTION
  - EXISTING FIRE HYDRANT
  - EXISTING MANHOLE
  - EXISTING CATCH BASIN
  - EXISTING TELEPHONE BOX
  - EXISTING LIGHT POST
  - EXISTING STORM WATER
  - EXISTING SEWER
  - EXISTING OVERHEAD WIRE
  - EXISTING GAS
  - EXISTING WATERMAIN

- KEYNOTES
1. EXISTING CHAINLINK FENCE TO REMAIN AND BE PROTECTED
  2. EXISTING CEDAR HEDGE TO REMAIN AND BE PROTECTED
  3. EXISTING CEDAR HEDGE TO BE PRUNED UP TO LEADER OR FENCE LINE
  4. TOPSOIL AND SOD
  5. UNIT PAVERS (1/L2.0)
  6. MAINTENANCE EDGE (2/L2.0)
  7. WALL (5/L2.0)
  8. GUARD RAIL (TYP) - REFER TO ARCHITECT
  9. WINDOW WELL - REFER TO ARCHITECT
- SOIL VOLUME (BY AREA)
1. 160.7m<sup>2</sup>
  2. 246.6m<sup>2</sup>

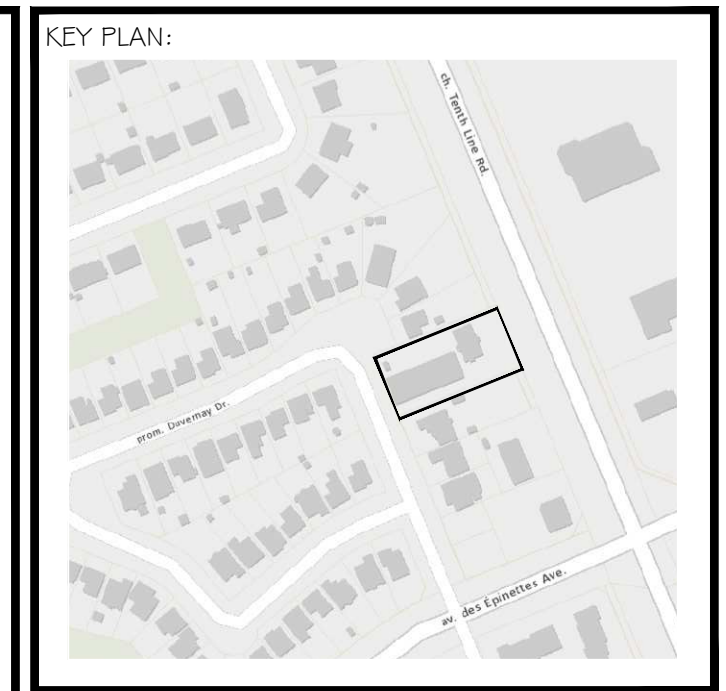

**ASSOCIATION OF LANDSCAPE ARCHITECTS**  
**SCOTT W. MASON**  
**LANDSCAPE ARCHITECT**

**Urbantypology**  
 UNIT 10-163 STERLING ROAD TORONTO, ON, CANADA, M6R 2B2 PH: 437.700.5466  
 UNIT 101-45 SPENCER STREET OTTAWA, ON, CANADA, K1T 2P5 PH: 613.867.3042 / 613.897.1237

NO.	REVISION:	DATE:
2	ISSUED FOR SITE PLAN CONTROL	28 OCT, 2025
1	ISSUED FOR SITE PLAN CONTROL	08 AUG, 2025

PROJECT: **1670 TENTH LINE RD PART OF LOT B**  
 LOCATION: **1670 TENTH LINE RD OTTAWA, ON**

SCALE: 1:150 PAGE SIZE: 24X36  
 PROJECT NUMBER: 24.17  
 NORTH: SHEET NO.: **L1.3**

DRAWN: **SS** START DATE: **15 JULY, 2025**  
 CHECKED: **SM**

DRAWING: **LANDSCAPE PLAN**

SCALE: 1:150 PAGE SIZE: 24X36  
 PROJECT NUMBER: 24.17  
 NORTH: SHEET NO.: **L1.3**

Lett Save: 6025-10-29 9:43:59 AM  
 File Location: C:\p\urbantypology\LC01\Projects - Documents\17 - Tenth Line - 24\DWG\6025-10-29-9-43-59-59-2025-PL1.MXD

0900-25-22-02



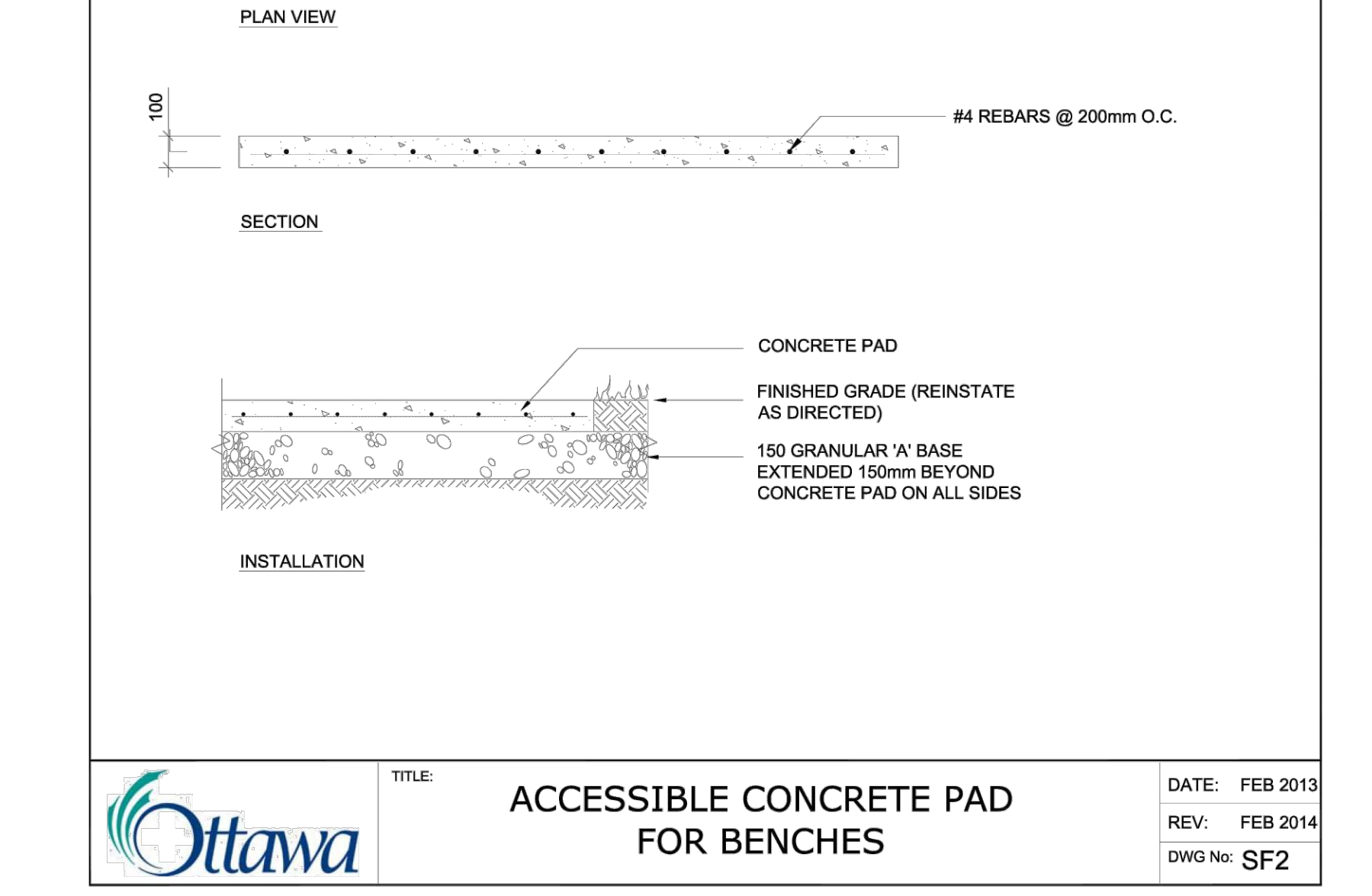
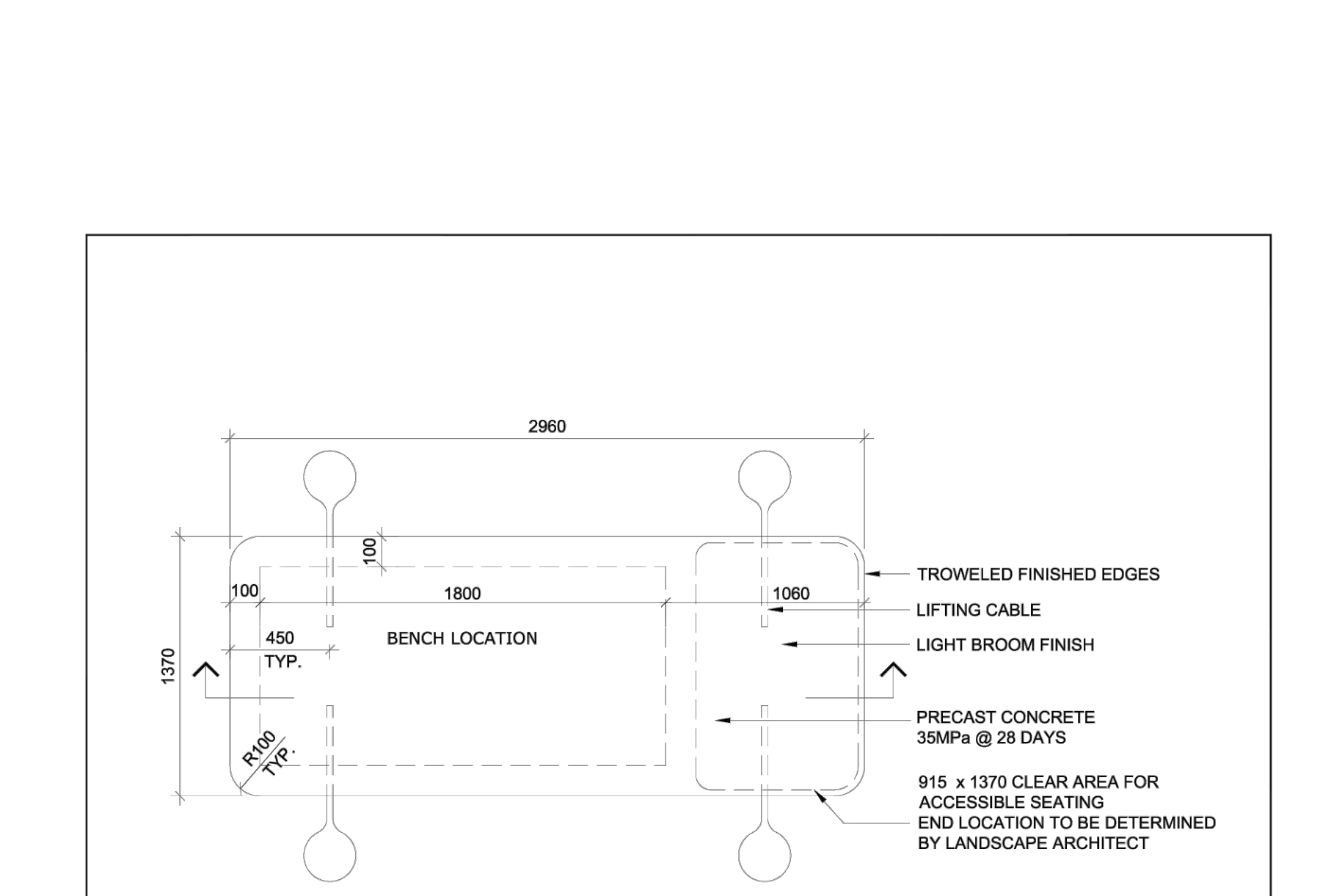
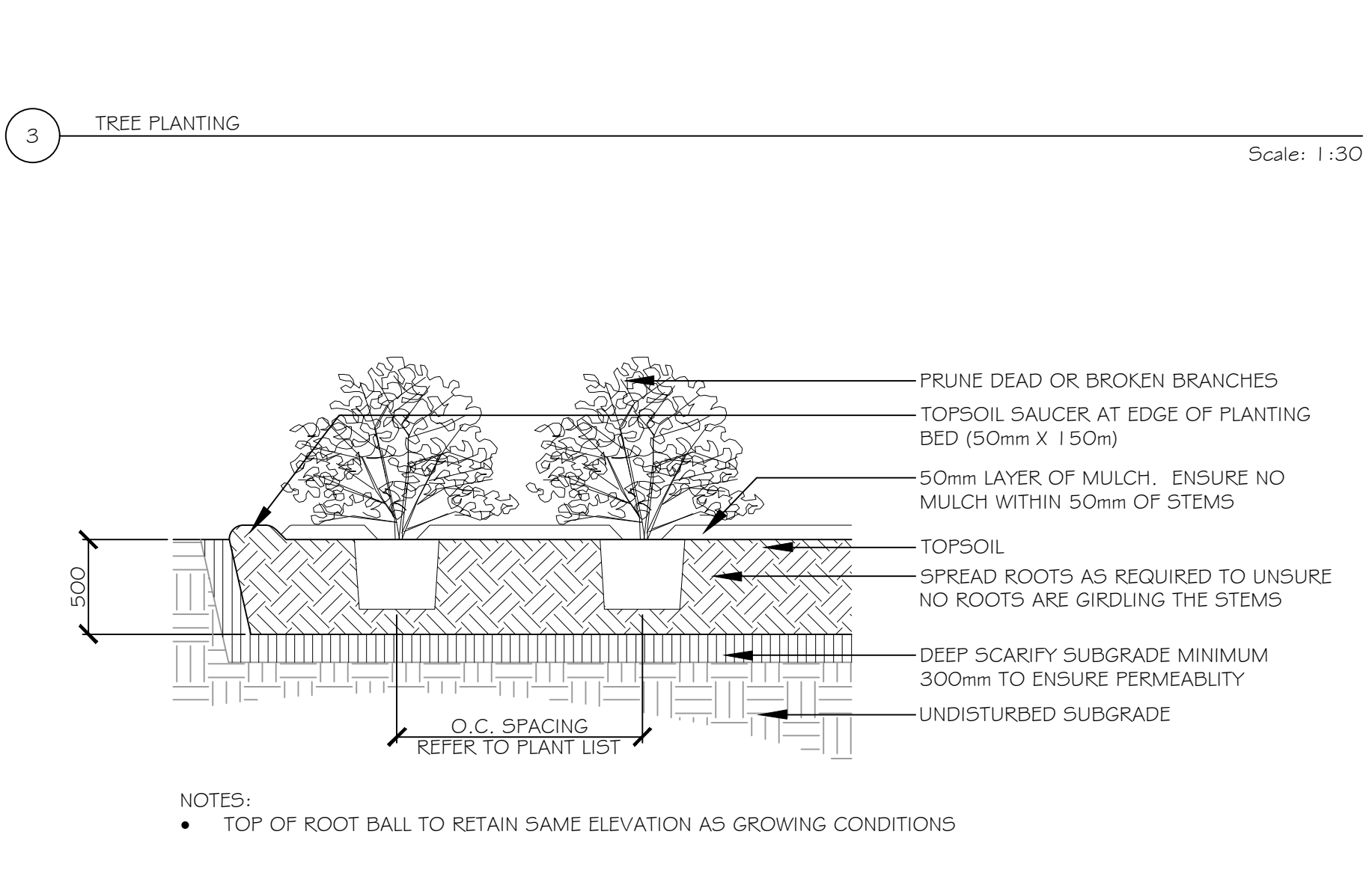
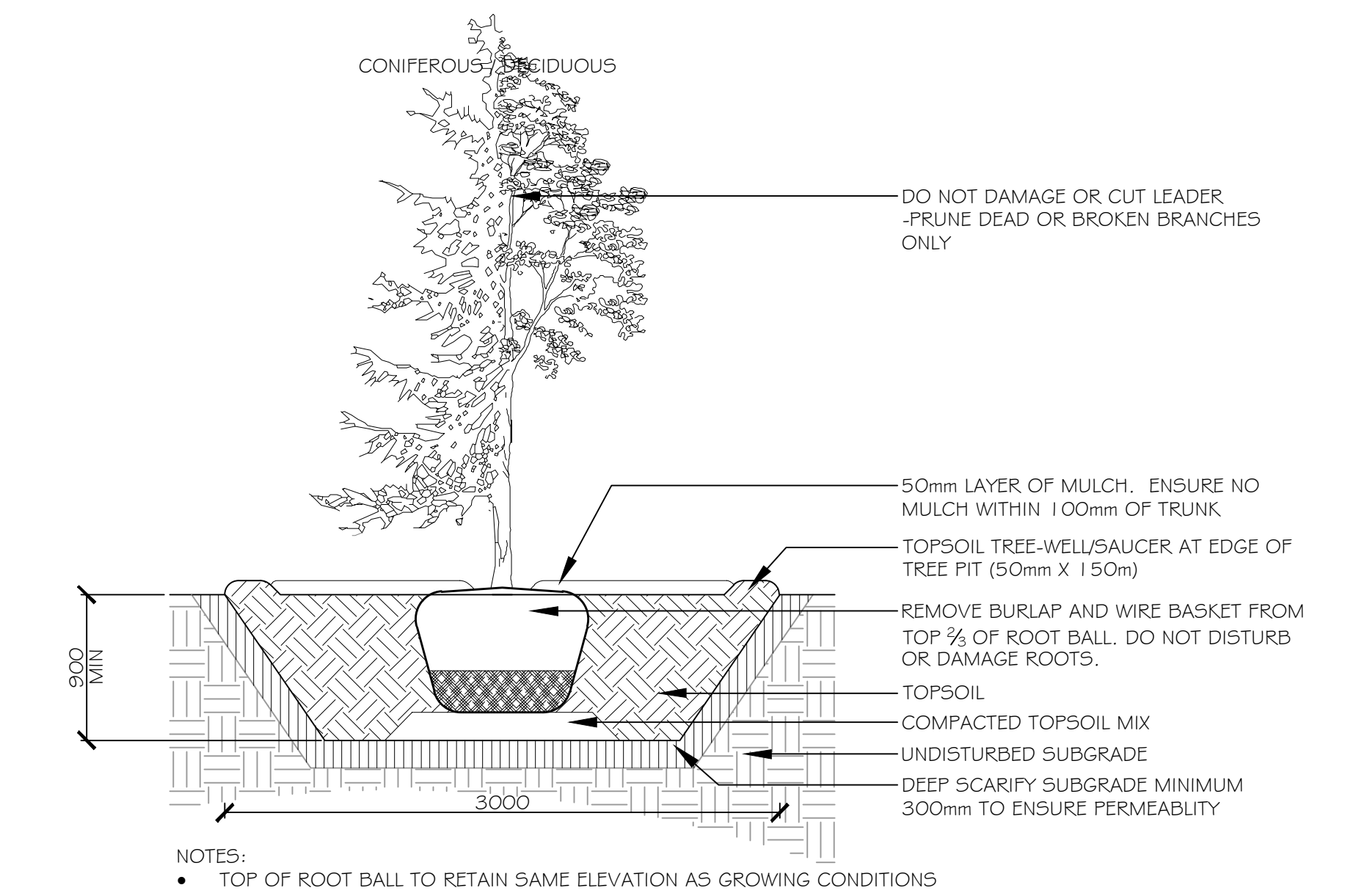
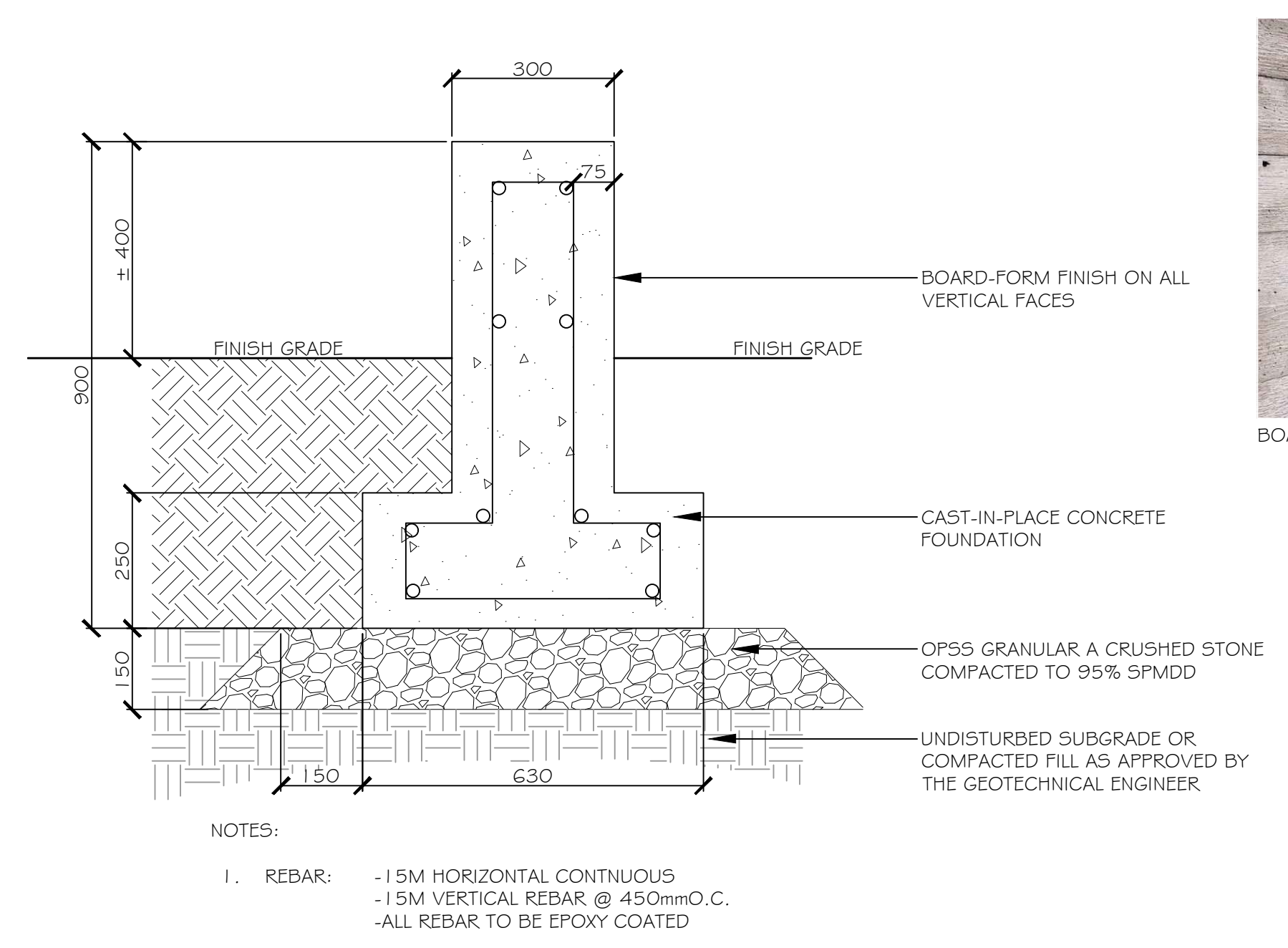
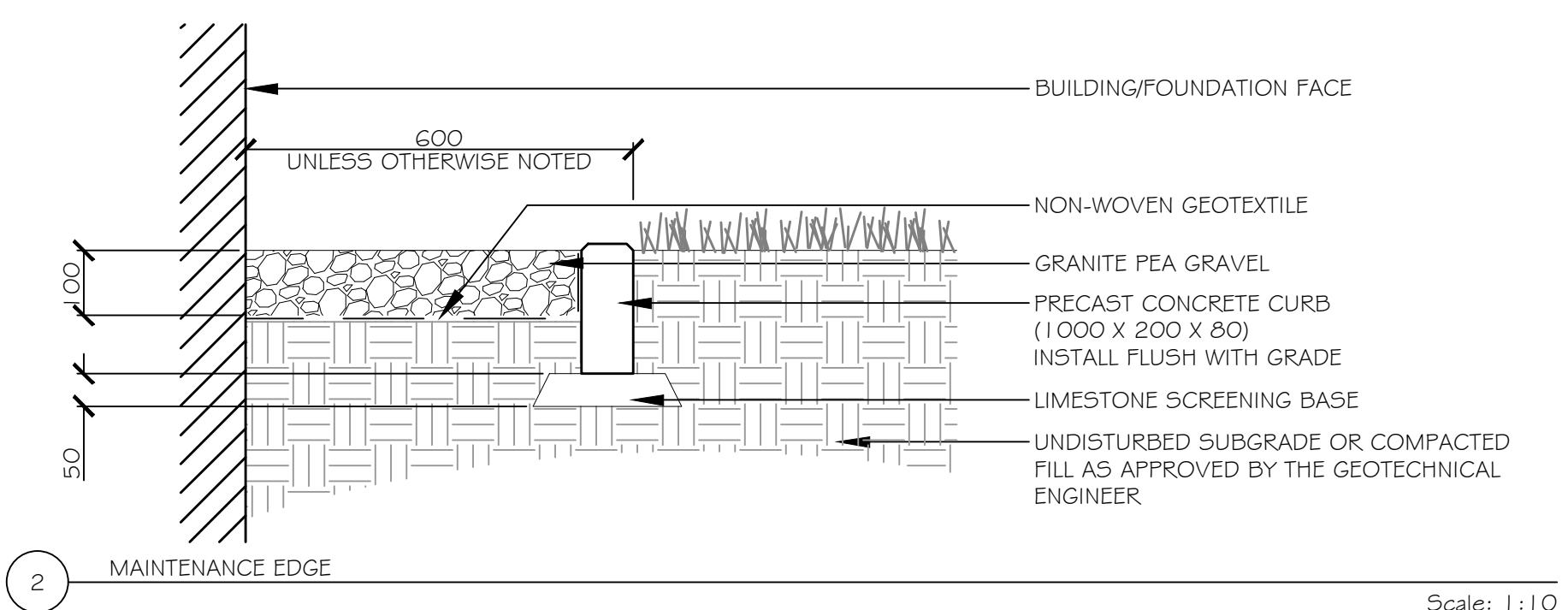
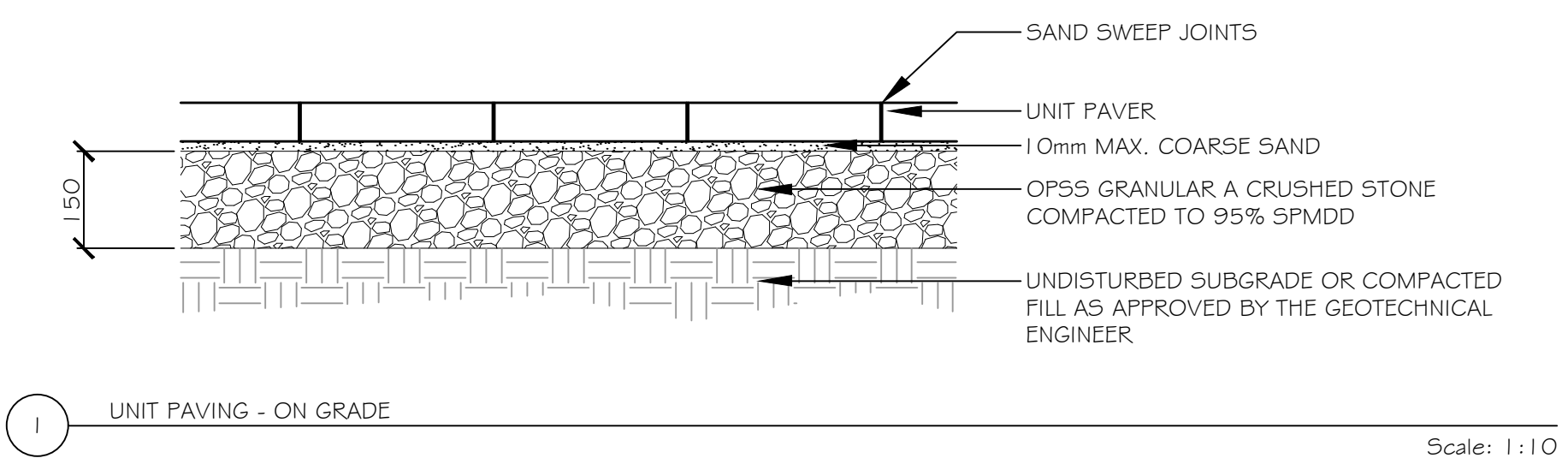

### 300 SERIES

#### MBR-0350-00001

Legacy # MBR350-4-S

Sustainability Facts	
Unit Size	One (1) MBR-0350-00001 Bike Rack
Carbon footprint (GWP)	178 kg CO2-Eq <i>Measured in kilograms of carbon dioxide equivalent</i>
Total energy use (TPE)	3050 MJ-Eq <i>Measured in megajoules of energy equivalent</i>
Water use (WDP)	1.4 m3 water <i>Measured in cubic metres of water</i>
Material recyclability	100%
LEED v4.1 Credits	
Type III Environmental Product Declaration	<input checked="" type="checkbox"/>
Material Inventory	<input checked="" type="checkbox"/>
Low VOC finishes	<input checked="" type="checkbox"/>
Free of Red List substances	<input checked="" type="checkbox"/>

DESCRIPTION: 300 Series - 350 Bike Rack: H.S. Steel Tube, Formed Steel and Solid Steel Angle, Surface Mount, 4 Loops, 3 Bike Configuration

FINISH: All steel components are protected with E-Coat rust proofing. The Maglin Powdercoat System provides a durable finish on all metal surfaces.

INSTALLATION: The bike rack is delivered pre-assembled. It is available with a surface mount installation.

TO SPECIFY: Select MBR-0350-00001  
Choose:  
- Powdercoat Color

HEIGHT: 23.81" (60.48cm) LENGTH: 37.25" (94.62cm) DIAMETER: 24.63" (62.56cm) WEIGHT: 63.2 lbs (28.7kg)

7 BIKE RACK  
NTS

**MAGLIN**  
Site Furniture

T 800 716 8508  
F 617 260 8383  
www.maglin.com  
sales@maglin.com

- All drawings, specifications, design and details on this page remain the property of Maglin Site Furniture Inc. and may not be used without Maglin authorization.  
- Details and specifications may vary due to continuing improvements of our products.

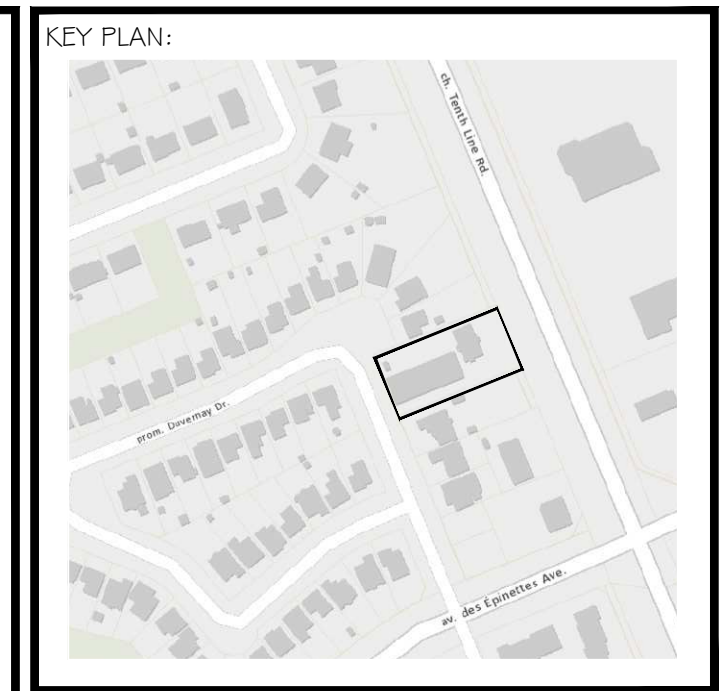

**Urbantypology**

UNIT 10-163 STERLING ROAD TORONTO, ON, CANADA, M6R 2E2 PH: 437.700.5466

UNIT 101 - 45 SPENCER STREET OTTAWA, ON, CANADA, K1T 2P5 PH: 613.867.3042 / 613.897.1237

NO.	REVISION:	DATE:
2	ISSUED FOR SITE PLAN CONTROL	29 OCT, 2025
1	ISSUED FOR SITE PLAN CONTROL	08 AUG, 2025

ALL MEASUREMENTS ARE IN MILLIMETERS UNLESS SPECIFIED OTHERWISE. DO NOT SCALE THE DRAWINGS. ALL DRAWINGS TO BE READ IN CONJUNCTION WITH CONTRACT SPECIFICATIONS.

COPYRIGHT RESERVED. THIS DRAWING IS THE EXCLUSIVE PROPERTY OF URBANTYPOLOGY INC. AND SHALL NOT BE REPRODUCED OR USED FOR PURPOSES OTHER THAN INTENDED BY THE OWNER, WITHOUT PERMISSION.

THIS DRAWING SHALL ONLY BE USED FOR CONSTRUCTION WHEN FIXED WITH A PROFESSIONAL SEAL AND SIGNATURE BY THE LANDSCAPE ARCHITECT. IT IS THE RESPONSIBILITY OF THE CONTRACTOR TO:

- VERIFY ALL DIMENSIONS AND CONDITIONS ON SITE.
- REPORT ALL ERRORS AND/OR OMISSIONS TO THE CONTRACT ADMINISTRATOR.
- COMPLY WITH ALL PERTINENT CODES, BY-LAWS AND LAWS.
- VERIFY LOCATION OF ALL UNDERGROUND SERVICES AND UTILITIES WITH RESPECTIVE AUTHORITIES PRIOR TO COMMENCEMENT OF WORK.

PROJECT:  
**1670 TENTH LINE RD**  
PART OF LOT B

LOCATION:  
1670 TENTH LINE RD  
OTTAWA, ON

DRAWN: SS START DATE:  
CHECKED: SM 16 JUNE, 2025

DRAWING:  
**NOTES AND SCHEDULES**

SCALE: AS NOTED PAGE SIZE: 24X36

PROJECT NUMBER: 24.17

NORTH: SHEET NO.:

**L2.0**

List Save: 2025-08-08 4:05:21 PM  
 File Location: C:\projects\1670 Tenth Line - Urban Typology\1670 Tenth Line - Urban Typology - SPAG21-DRAWING

XXX-XXX-XXX