

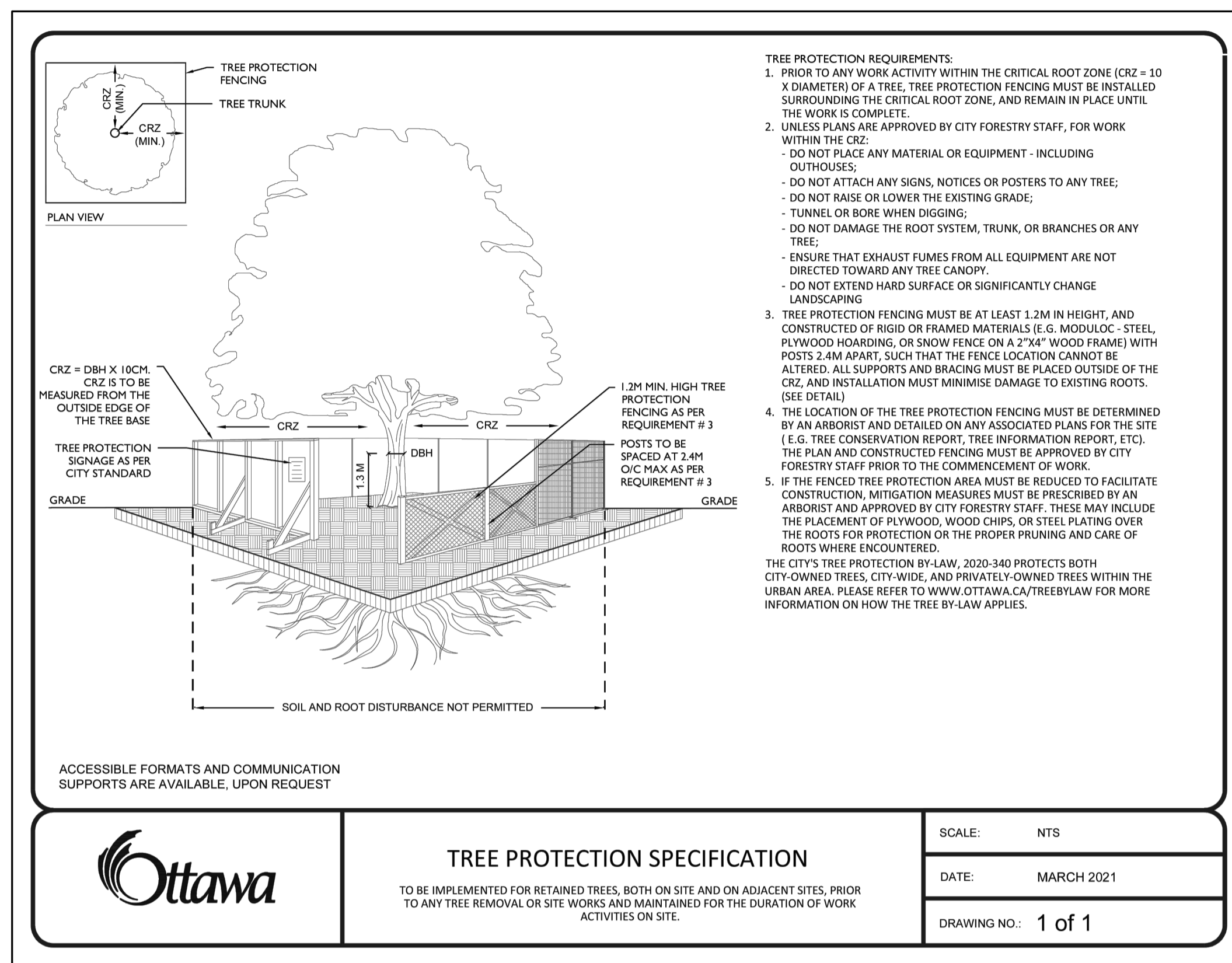

- PROPERTY LINE
- APPROXIMATE LINE OF REQUIRED SETBACK
- APPROXIMATE EXTENT OF BUILDING BELOW
- APPROXIMATE EXTENT OF BUILDING ABOVE
- DECIDUOUS TREE FORM SHRUB (SEE LANDSCAPE NOTES & SCHEDULE FOR SPECIES AND QUANTITIES)
- EXISTING TREES TO BE PROTECTED
- CIP CONCRETE
- UNIT PAVING
- RIVERWASH STONE
- BUILDING OVERHANG ABOVE

| PLANTING SCHEDULE | | | | |
|-------------------------------|------|---------------------------|----------------|---|
| KEY | QTY. | BOTANICAL NAME | COMMON NAME | SIZE / CONDITION / SPACING |
| DECIDUOUS TREES | | | | |
| CA | 1 | Cornus alternifolia | Pagoda Dogwood | 60mm cal. / W.B., (tree form, specimen) |
| SHRUBS / GRASSES / PERENNIALS | | | | |
| Ms | 5 | Matteuccia struthiopteris | ostrich Fern | #1 Pot /45cm o.c. |

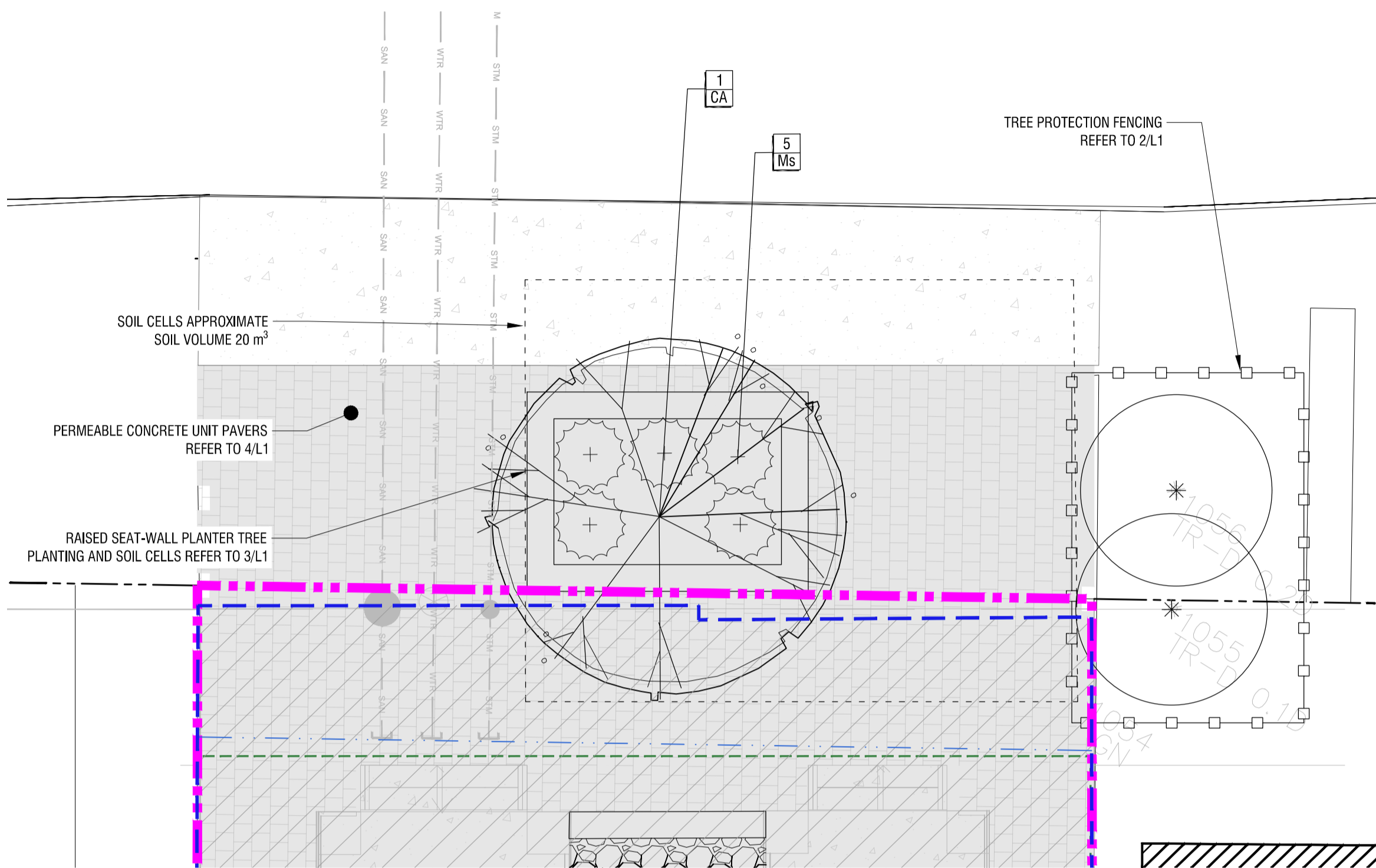

1
L1
LANDSCAPE PLANTING PLAN
1:50

2
L1
CITY OF OTTAWA TREE PROTECTION DETAIL
NTS

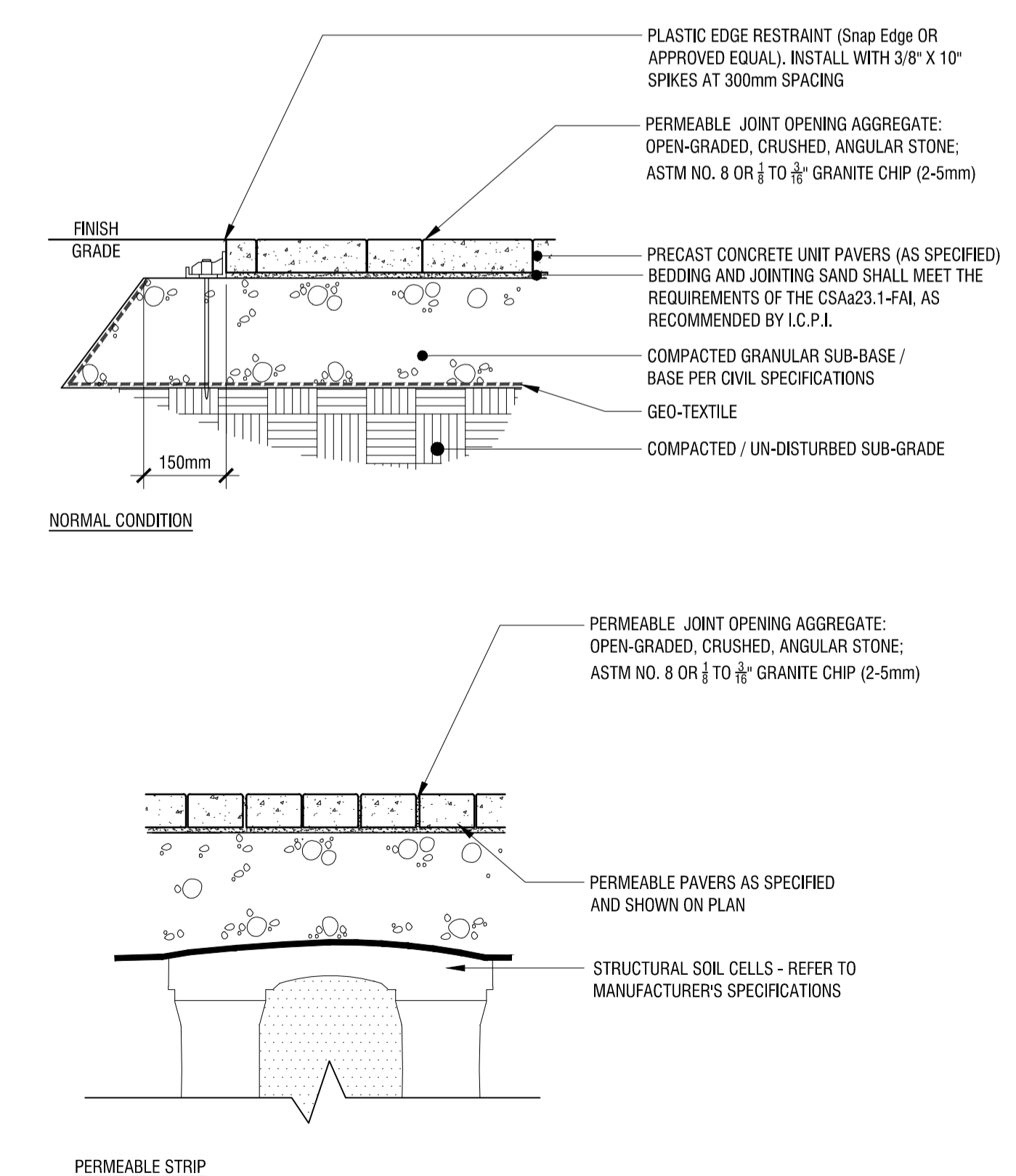

3
L1
CONCRETE UNIT PAVERS
NTS

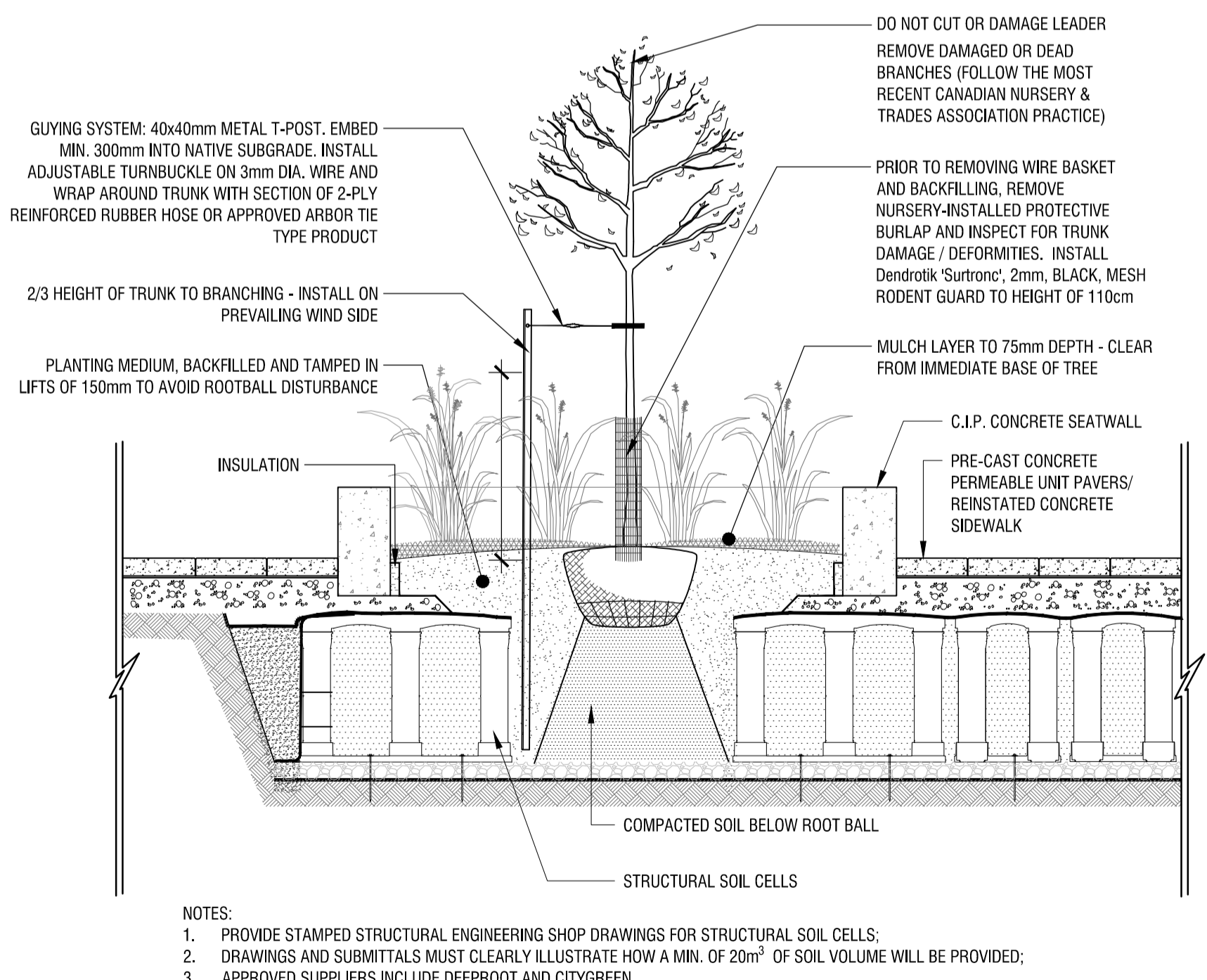

- NOTES:
 1. PROVIDE STAMPED STRUCTURAL ENGINEERING SHOP DRAWINGS FOR STRUCTURAL SOIL CELLS;
 2. DRAWINGS AND SUBMITTALS MUST CLEARLY ILLUSTRATE HOW A MIN. OF 20m³ OF SOIL VOLUME WILL BE PROVIDED;
 3. APPROVED SUPPLIERS INCLUDE DEEPROOT AND CITYGREEN.

4
L1
RAISED SEAT-WALL PLANTER
NTS

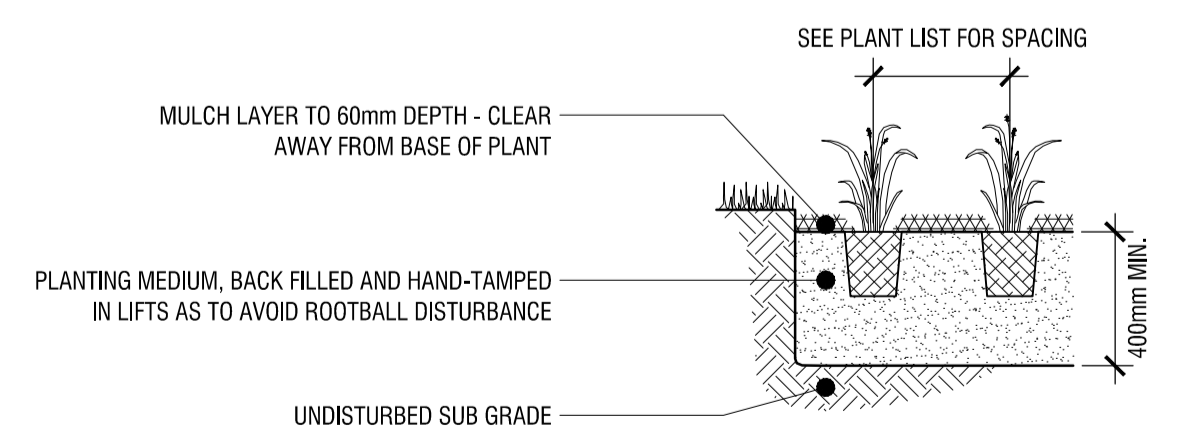

5
L1
PERENNIAL PLANTING
NTS

NOT FOR CONSTRUCTION

| | | |
|----|-----------------------------|------------|
| 01 | Issue for Site Plan Control | 2025/07/28 |
| 00 | Issue for Client review | 2025/06/10 |

FOTENN Planning + Design
 420 O'Connor Street
 Ottawa, ON, CANADA K2P 1W4
 613.730.5709
 fotenn.com

north / le nord stamp / le cachet

project / projet
312 Lisgar St.
 drawing / dessin

LANDSCAPE PLAN

| | | |
|------------------|--------------------------------|--------------------|
| designed / conçu | drawn / dessiné | reviewed / examiné |
| ST / DF | ST | DF |
| date | project number / No. du projet | |
| MAY 2025 | | |

drawing number / No. du dessin
L1