

REFER TO NOTES & DETAILS ON DRAWING No. C-11 TO C-13

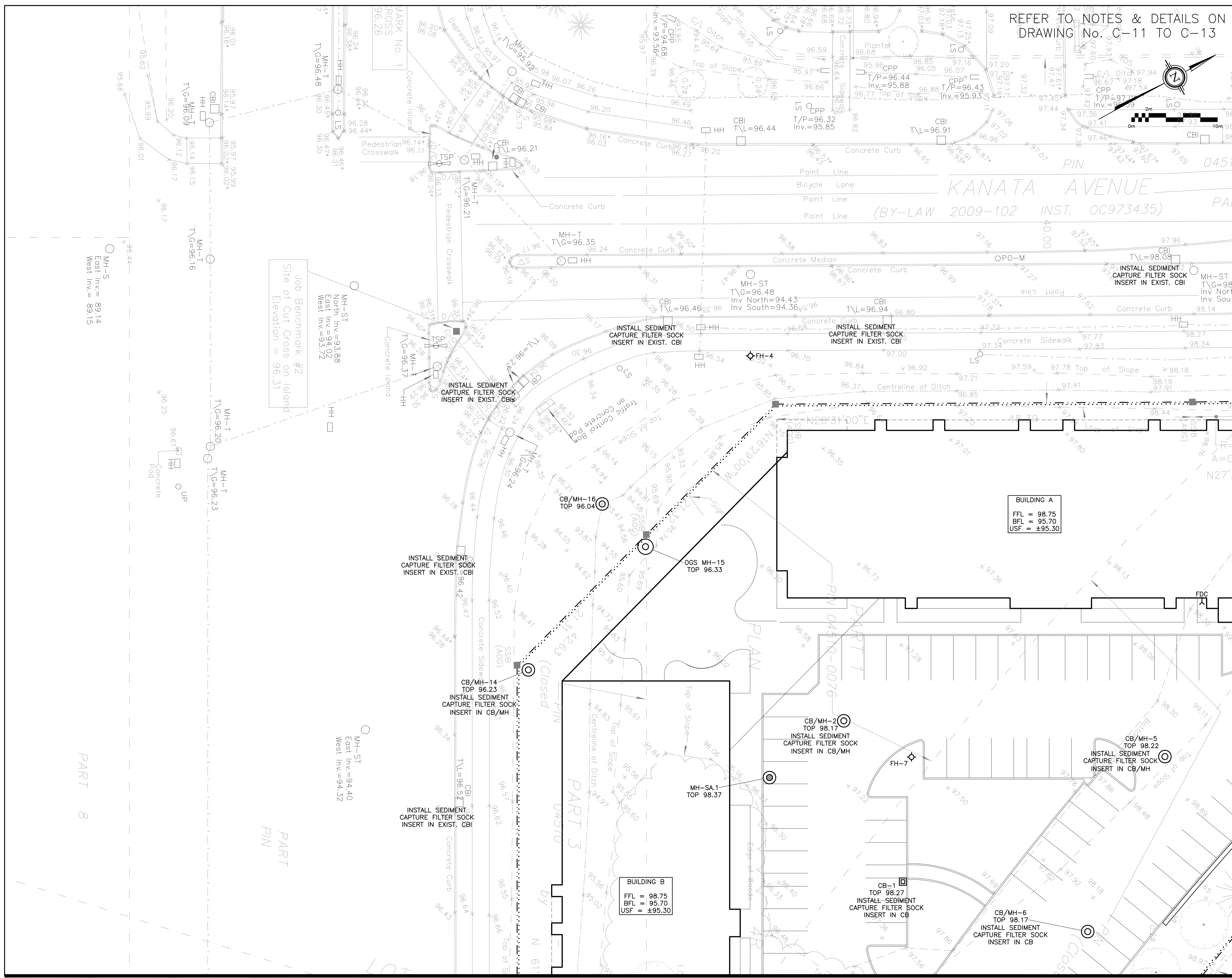

LEGEND

- FFL FINISHED FLOOR ELEVATION
- BFL BASEMENT FLOOR ELEVATION
- USF UNDERSIDE OF FOOTING
- PROPERTY LINE
- CB [Symbol] CATCH-BASIN
- MH [Symbol] STORM MANHOLE
- CB/MH [Symbol] CATCH-BASIN/MANHOLE
- MH [Symbol] SANITARY MANHOLE
- DMAC [Symbol] DMA CHAMBER
- FH [Symbol] FIRE HYDRANT
- FDC [Symbol] FIRE DEPARTMENT CONNECTION
- x99.99 EXISTING ELEVATION
- +99.99 PROPOSED ELEVATION
- 2% PROPOSED SLOPE
- [Symbol] EMERGENCY OVERLAND FLOW
- CENTERLINE OF SWALE
- 150mm BARRIER CURB
- DC DEPRESSED CURB
- SILT FENCE BARRIER

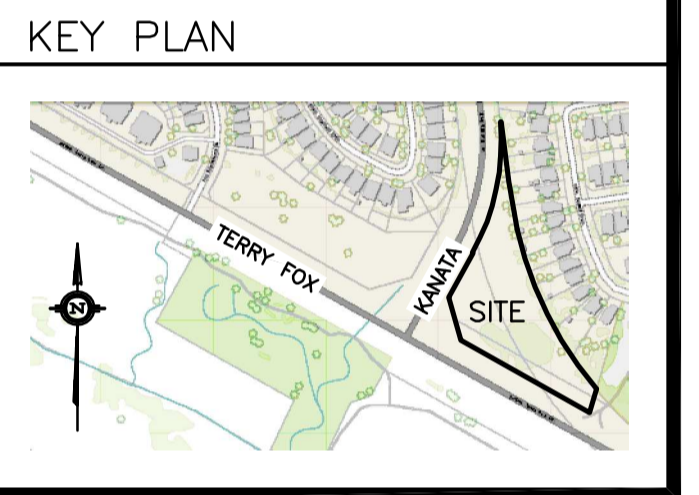

No.	DATE	REVISION
3	JAN 26-26	RE-ISSUED FOR APPROVAL
2	OCT 28-25	RE-ISSUED FOR APPROVAL
1	JUL 11-25	ISSUED FOR APPROVAL

D. B. GRAY ENGINEERING INC.
 Stormwater Management - Grading & Drainage - Storm & Sanitary Sewers - Watermain
 700 Long Point Circle 613-425-8044
 Ottawa, Ontario d.gray@dbgrayengineering.com

Project
**PROPOSED 6-STORY APARTMENT BUILDINGS
 475 TERRY FOX DRIVE
 OTTAWA, ONTARIO**

Drawing Title
**EROSION & SEDIMENT CONTROL PLAN
 (SW CORNER)**

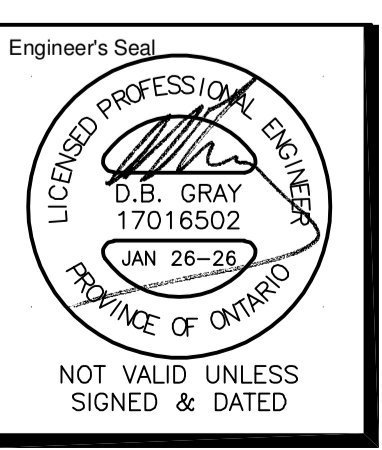

Engineer's Seal
 D.B. GRAY
 17016502
 JAN 26-26
 PROVINCE OF ONTARIO
 NOT VALID UNLESS SIGNED & DATED

Drawn D.B.G.
 H. Scale 1:200
 V. Scale
 Date JUL 11-25
 Job No. 24103

Drawing No.
C-8
 of 19

BUILDING A
 FFL = 98.75
 BFL = 95.70
 USF = ±95.30

BUILDING B
 FFL = 98.75
 BFL = 95.70
 USF = ±95.30