

ARCH D 24' x 36'

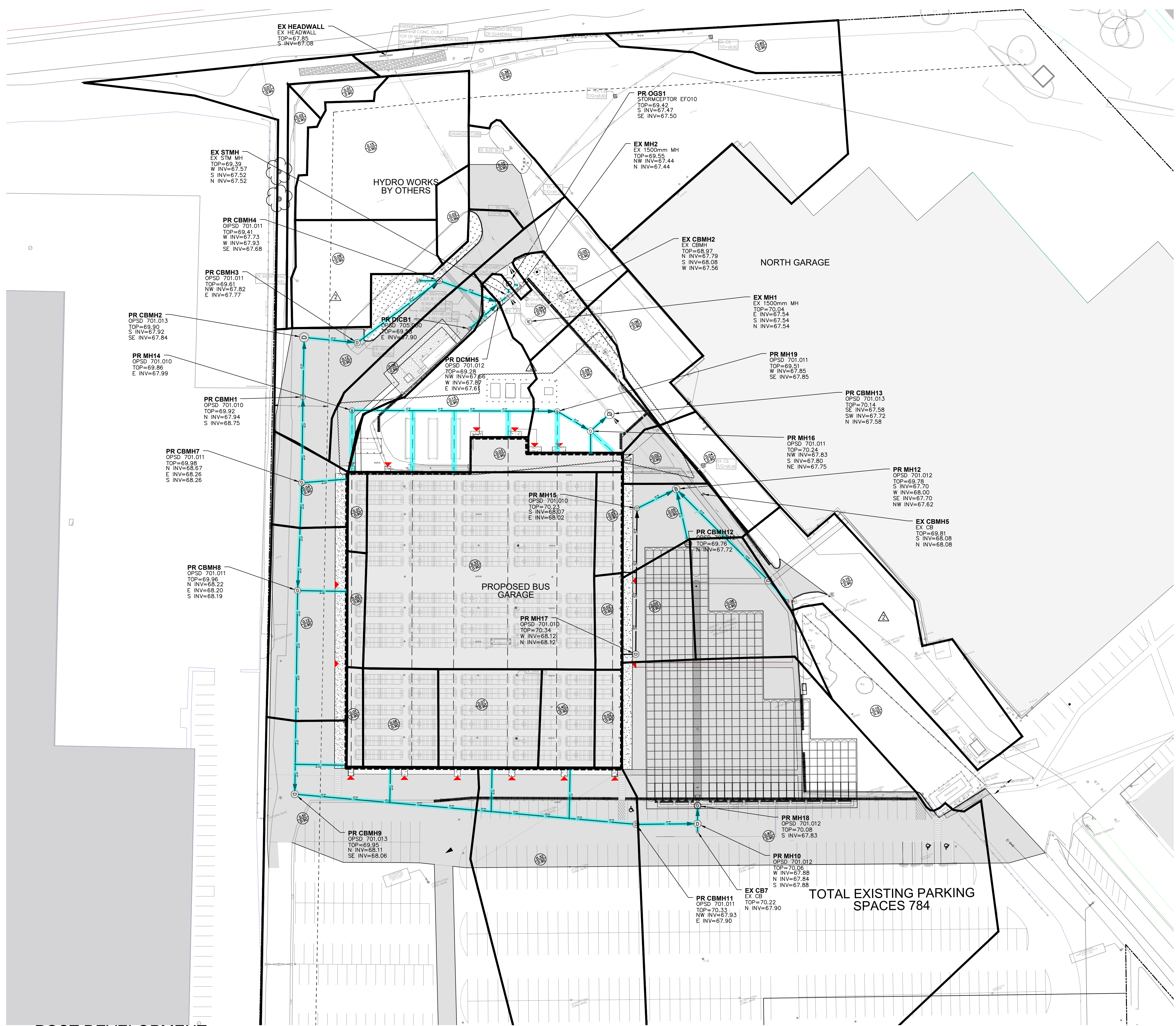

LEGEND

---	EX STORM SEWER
---	EX SANITARY SEWER
---	EX WATERMAIN
---	PROP STORM SEWER
---	PROP SANITARY SEWER
---	PROP WATERMAIN



SERVICES D'INFRASTRUCTURE
DIRECTION DE CONCEPTION ET DE CONSTRUCTION

FOR / POUR
Client - Department
**Infrastructure and Water Services Department
Design & Construction**



PRIME:
AECOM Canada Architects Ltd.
50 Sportsworld Crossing Road, Suite 200
Kitchener, Ontario, N2P 0A4



SUBCONSULTANT:
GRC ARCHITECTS INC.
47 Clarence Street, Suite 401
Ottawa, Ontario, K1N 9K1

NOTE:
IT IS THE RESPONSIBILITY OF THE CONTRACTORS TO INFORM THEMSELVES OF THE EXACT LOCATION OF AND ASSUME ALL LIABILITY FOR DAMAGE TO ALL UTILITIES, SERVICES AND STRUCTURES WHETHER ABOVE GROUND OR BELOW GRADE BEFORE COMMENCING THE WORK. SUCH INFORMATION IS NOT NECESSARILY SHOWN ON THE DRAWING AND WHERE SHOWN, THE ACCURACY CANNOT BE GUARANTEED. WITH THE SOLE EXCEPTION OF THE RECOMMENDATIONS SPECIFICALLY DESCRIBED FOR THIS PROJECT, NO ELEVATION INDICATED OR ASSUMED HEREON IS TO BE USED AS A REFERENCE ELEVATION FOR ANY PURPOSE.

4	ISSUED FOR SPA	2020/03/26	TG
3	REISSUED FOR TENDER	2020/03/26	TG
2	REISSUED FOR TENDER	2020/03/12	TG
1	ISSUED FOR TENDER	2020/12/15	TG

DESIGNED BY / CONÇU PAR	CG/UCI	CHECKED BY / VÉRIFIÉ PAR	CG/UCI
DRAWN BY / DÉSSINÉ PAR	SS	SCALE / ÉCHELLE	1 : 500

1 DRAWING TITLE
SHEET NUMBER

THIS DRAWING IS THE PROPERTY OF THE CITY OF OTTAWA AND ALL COPYRIGHT IS RESERVED. DIMENSIONS ON DRAWINGS ARE FOR ESTIMATING PURPOSES ONLY. IT IS THE RESPONSIBILITY OF EACH CONTRACTOR AND SUB-CONTRACTOR OR CONSULTANT TO CHECK AND VERIFY ALL DIMENSIONS AND CONDITIONS ON SITE. NOTIFY OWNER OF ANY ERRORS OR OMISSIONS PRIOR TO COMMENCING THE WORK. DO NOT SCALE THE DRAWINGS.

CE DESSIN CONSTITUE LA PROPRIÉTÉ DE LA VILLE D'OTTAWA ET TOUT DROIT D'AUTEUR EST RÉSERVÉ. LES DIMENSIONS UTILISÉES LE SONT À DES FINS DESTINATION SEULEMENT. IL INCOMBE À CHAQUE ENTREPRENEUR, SOUS-CONTRACTANT OU CONSULTANT DE VÉRIFIER TOUTES LES DIMENSIONS ET LES CONDITIONS SUR LE CHANTIER. VEUILLEZ INFORMER LE PROPRIÉTAIRE DE TOUTE ERREUR OU OMISSION AVANT D'ENTAMER LES TRAVAUX. NE DRESSÉZ PAS LES PLANS À L'ÉCHELLE.

ARCHITECT / ARCHITECTE
CONSULTANT / EXPERT-CONSEIL

CONSULTANT / EXPERT-CONSEIL
CONSULTANT / EXPERT-CONSEIL

PROJECT / LOCATION / PROJET / ENDROIT
OTC ZEB-New Garage

Enter address here.

OTTAWA, ONTARIO

DRAWING / DESSIN
POST DEVELOPMENT DRAINAGE AREAS

File Number D07-12-25-0095
Plan Number 19357

1 POST DEVELOPMENT DRAINAGE AREAS
C015

SCALE: 1 : 500

BUSINESS ENTITY / NUMÉRO DE L'ENTITÉ
BUILDING NUMBER / NUMÉRO DU BÂTIMENT
SHEET NO. / FEUILLE NO.
OMF1
CITY PROJECT NO. / NUMÉRO DE PROJET
60716350
CONS_PROJECT NO. / NUMÉRO DE PROJET
C015