

*Allison Hamlin*

**ALLISON HAMLIN**  
**MANAGER, DEVELOPMENT REVIEW ALL WARDS**  
**PLANNING, DEVELOPMENT & BUILDING SERVICES**  
**DEPARTMENT, CITY OF OTTAWA**

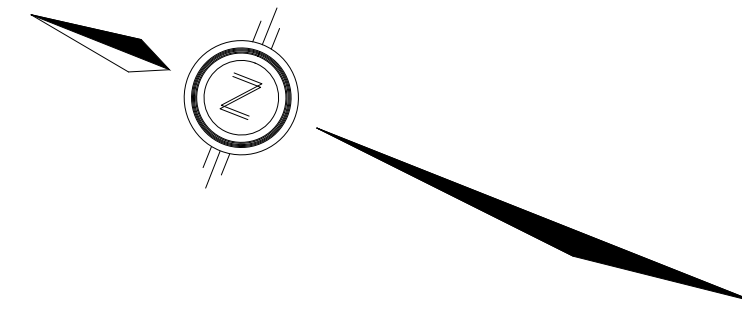

**APPROVED**  
 By Allison Hamlin at 3:34 pm, Mar 06, 2026

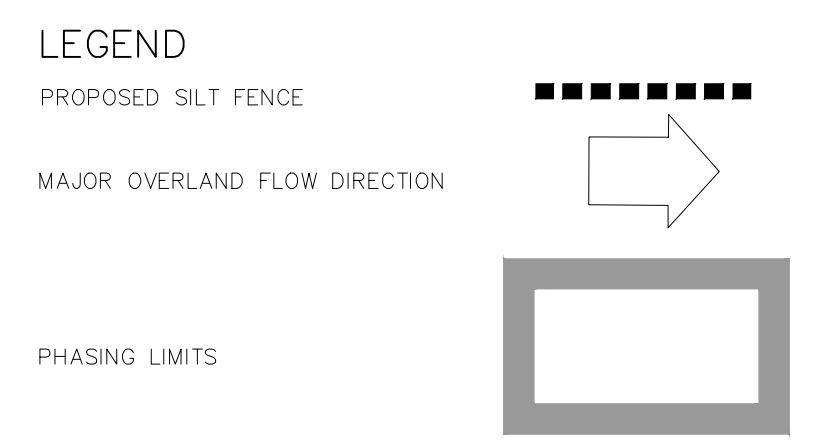
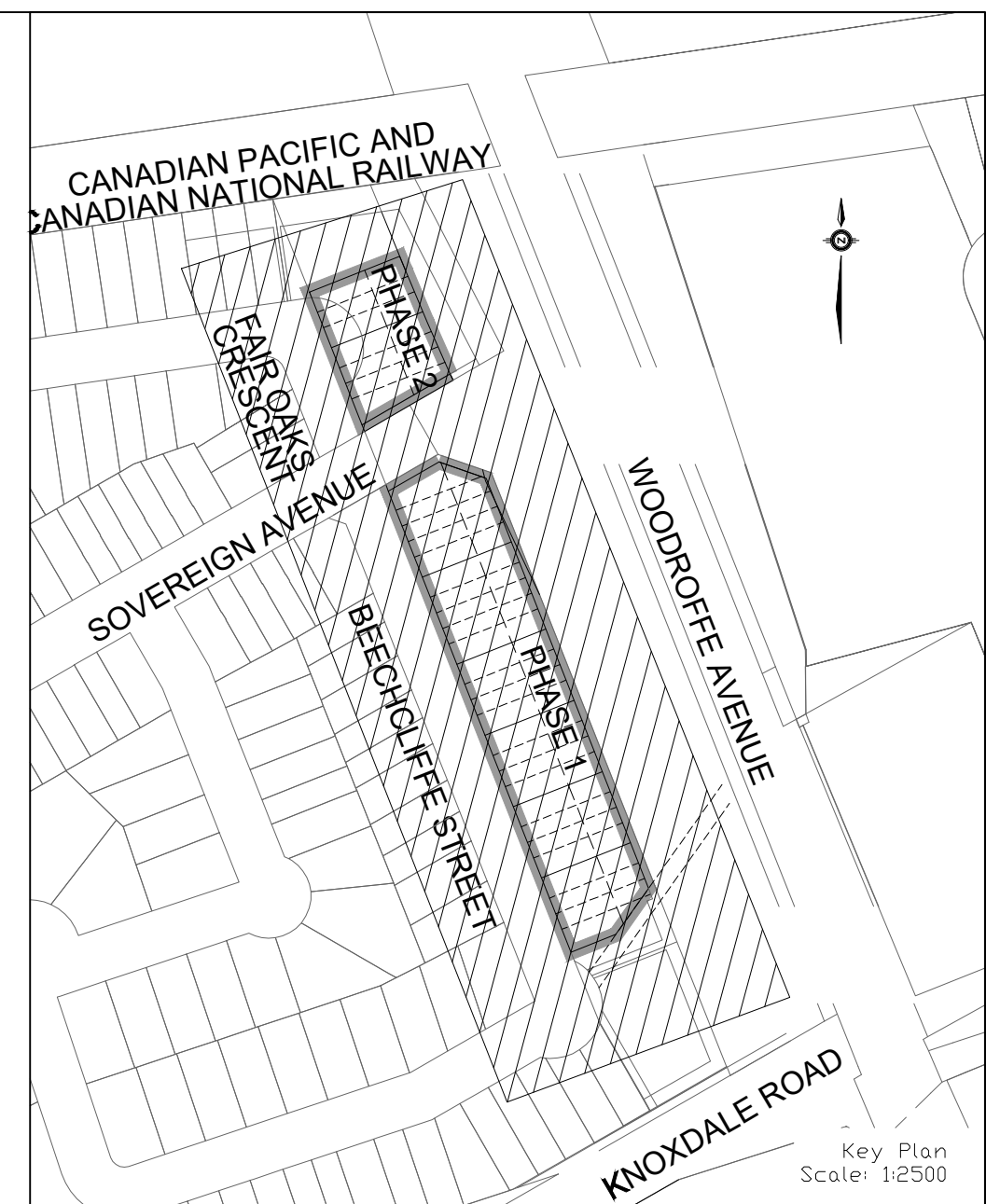
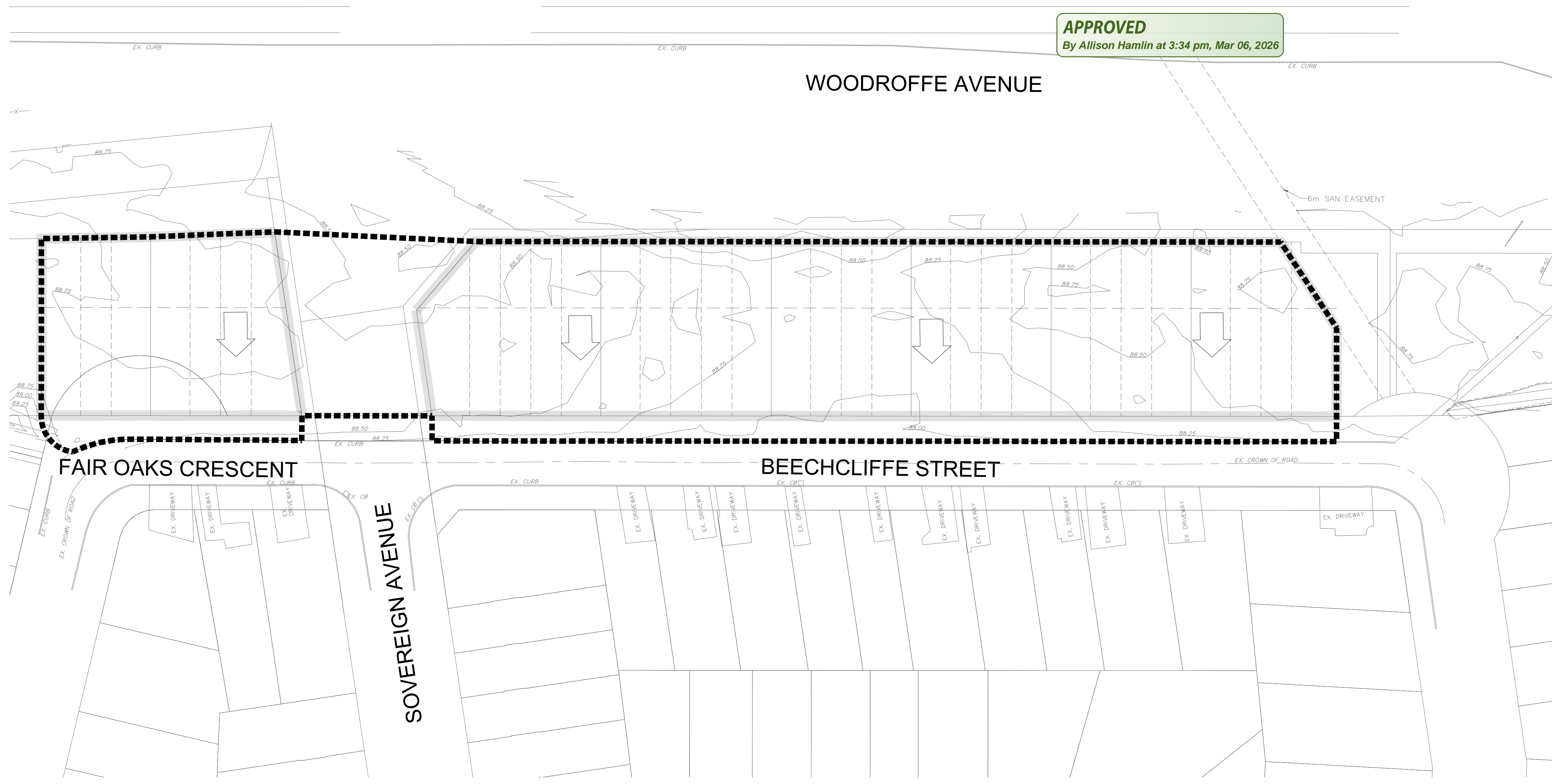

**TOPOGRAPHIC INFORMATION**  
 TOPOGRAPHIC INFORMATION PROVIDED BY CITY OF OTTAWA, PROJECT 40 BEECHCLIFFE STREET, SURVEY DATED JANUARY 2025.  
 ADDITIONAL TOPOGRAPHIC INFORMATION PROVIDED BY AOV LTD., PROJECT No. 25159-25, SURVEY DATED MAY 2025 AND JUNE 2025.

**LEGAL INFORMATION**  
 REGISTERED PLAN PROVIDED BY AOV LTD., PROJECT No. 25159-25, RECEIVED ON MAY 14, 2025.

**ELEVATION NOTE**  
 ELEVATIONS SHOWN ON THIS PLAN ARE GEODETIC AND ARE REFERRED TO THE CGVD28 GEODETIC DATUM. SITE BENCH MARK ON TOP OF F#1 SPRINKLE FRONTING CIVIC ADDRESS 33 BEECHCLIFFE STREET. ELEVATION=88.966m.

No.	BY	DATE	DESCRIPTION
6	W.L.	26-03-09	UPDATE FOR SPA
5	W.L.	26-02-17	4th SUBMISSION
4	W.L.	25-09-19	3rd SUBMISSION
3	W.L.	25-08-01	2nd SUBMISSION
2	W.L.	25-07-15	ISSUED FOR TENDER
1	W.L.	25-06-20	1st SUBMISSION



PROJECT No. 24-1416

**HABITAT FOR HUMANITY**      **40 BEECHCLIFFE STREET**

120 Iber Road, Unit 103  
 Stittsville, ON K2S 1E9  
 Tel: (613) 836-0856  
 Fax: (613) 836-7183  
 www.DSEL.ca

**EROSION AND SEDIMENT CONTROL PLAN**  
**STAGE 1**

DRAWN BY:	CHECKED BY:	SHEET NO.
A.S.	W.L.	11 OF 12
DESIGNED BY:	CHECKED BY:	
A.S.		
SCALE: 1:500	DATE: JUNE 2025	

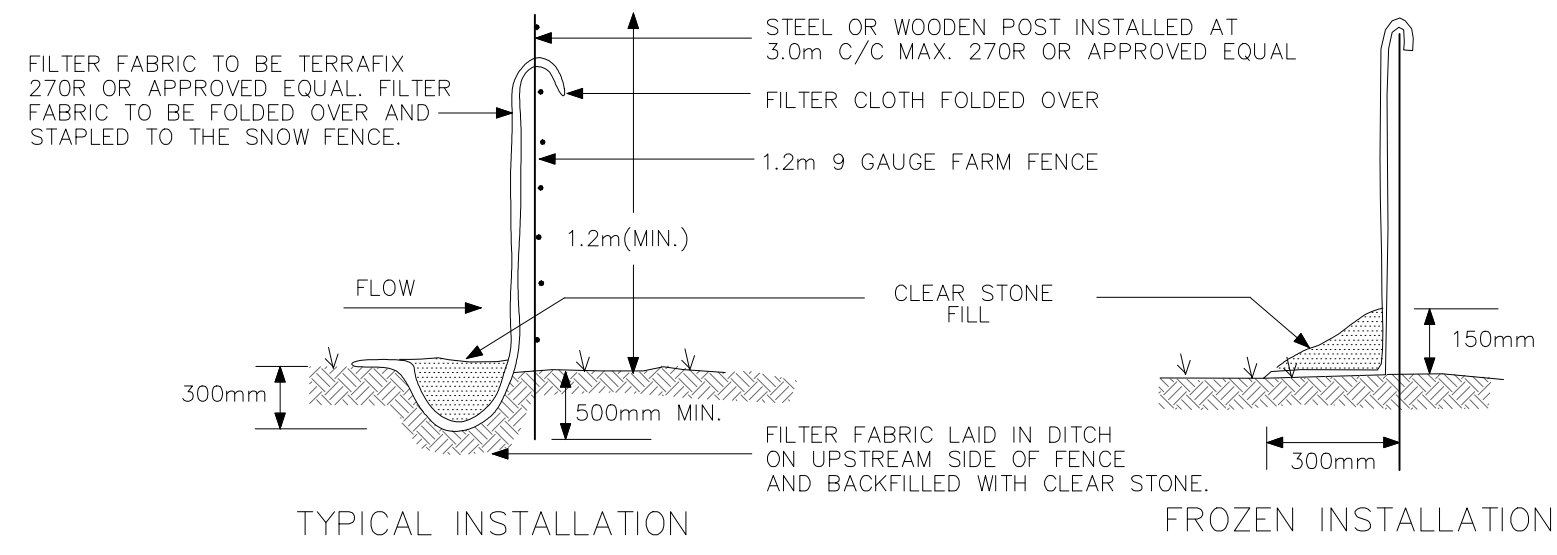

**SILT CONTROL FENCE**  
 SCALE: N.T.S.

**MONITORING OF SEDIMENT AND EROSION CONTROLS**  
 MONITORING AND REPORTING TO BE COMPLETED IN ACCORDANCE WITH THE MINISTRY OF THE ENVIRONMENT, CONSERVATION AND PARKS (MECP) AND RIDEAU VALLEY CONSERVATION AUTHORITY (RVCA) APPROVALS.

**MAINTENANCE PROGRAM**  
 ALL DAMAGED ESC MEASURES SHOULD BE REPAIRED AND/OR REPLACEMENT WITHIN 48 HOURS OF THE INSPECTION.  
 THE ENVIRONMENTAL MONITOR IS REQUIRED TO SUBMIT UPDATES TO THE TOWN/ REGION/ CONSERVATION AUTHORITY BY EMAIL IN A TIMELY MANNER.  
 SEDIMENT SHOULD BE REMOVED FROM THE SEDIMENT CONTROL FENCING ONCE SEDIMENT HAS ACCUMULATED TO A LEVEL OF ONE-THIRD THE HEIGHT OF FENCING OR TO A HEIGHT OF 30 cm. ANY AMOUNT OF ACCUMULATED SEDIMENT SHOULD BE REMOVED PRIOR TO THE REMOVAL OF THE CONTROL MEASURES.

**SEQUENCE OF ACTIVITIES**  
 THE EROSION AND SEDIMENT CONTROL MEASURES MUST BE INSTALLED IN ACCORDANCE WITH THE FOLLOWING SEQUENCE:

- INSTALLATION OF THE SEDIMENT CONTROL FENCING WHERE INDICATED. THE OPTIMIZED LOCATION, TIMING, AND EXTENTS OF SILT FENCE INSTALLATION WILL BE ESTABLISHED BASED UPON THE SITE CONSTRUCTION STAGING WITH INPUTS FROM THE PROJECT ENVIRONMENTAL ENGINEER
- REMOVAL OF SITE VEGETATION IN ACCORDANCE WITH ALL APPLICABLE BY-LAWS, PERMITS, APPROVALS, ETC.
- REGULAR MONITORING OF THE SEDIMENT CONTROL FENCES BY THE CONTRACTOR TO VERIFY THAT THE FENCES ARE FUNCTIONING AS INTENDED.
- REMOVAL OF THE EROSION AND SEDIMENT CONTROL DEVICES ONCE THE SITE HAS BEEN STABILIZED.

THE SILTATION CONTROL PLAN IS INTENDED TO ASSIST THE CONTRACTOR IN THE LAYOUT AND CONSTRUCTION OF THE SILTATION CONTROL FEATURES ONLY. THIS DRAWING SHALL NOT BE USED FOR CONSTRUCTION OF SITE SERVICES.

**SPILLS CONTROL NOTES**

ALL CONSTRUCTION EQUIPMENT SHALL BE REFUELED, MAINTAINED AND STORED NO LESS THAN 30 METERS FROM THE WATERCOURSES, STREAMS, CREEKS, WOODLOTS AND ANY ENVIRONMENTALLY SENSITIVE AREAS, OR AS OTHERWISE SPECIFIED.

THE CONTRACTOR MUST IMPLEMENT ALL NECESSARY MEASURES IN ORDER TO PREVENT LEAKS, DISCHARGES OR SPILLS OF POLLUTANTS, DELETERIOUS MATERIALS, OR OTHER SUCH MATERIALS OR SUBSTANCES WHICH WOULD OR COULD CAUSE AN ADVERSE IMPACT TO THE NATURAL ENVIRONMENT.

IN THE EVENT OF A LEAK, DISCHARGE OR SPILL OF A POLLUTANT, DELETERIOUS MATERIAL OR OTHER SUCH MATERIAL OR SUBSTANCE WHICH WOULD OR COULD CAUSE AN ADVERSE IMPACT TO THE NATURAL ENVIRONMENT, THE CONTRACTOR SHALL:

1. IMMEDIATELY NOTIFY THE APPROPRIATE FEDERAL, PROVINCIAL AND LOCAL GOVERNMENT MINISTRIES, DEPARTMENTS, AGENCIES AND AUTHORITIES OF THE INCIDENT IN ACCORDANCE WITH ALL CURRENT LAWS, LEGISLATION, ACTS, BY-LAWS, PERMITS, APPROVALS, ETC.
2. TAKE IMMEDIATE MEASURES TO CONTAIN THE MATERIAL OR SUBSTANCE, AND TO TAKE SUCH MEASURES AS THEY DEEM APPROPRIATE TO MITIGATE AGAINST THE ANY ADVERSE IMPACTS TO THE NATURAL ENVIRONMENT.
3. THE CONTRACT SHALL RESTORE THE AFFECTED AREA TO ORIGINAL CONDITION OR BETTER, ALL TO THE SATISFACTION OF THE AUTHORITIES HAVING JURISDICTION.

CITY PLAN No. 19322  
 CITY FILE No. \_D07-12-25-0091