

*Allison Hamlin*

ALLISON HAMLIN  
MANAGER, DEVELOPMENT REVIEW ALL WARDS  
PLANNING, DEVELOPMENT & BUILDING SERVICES  
DEPARTMENT, CITY OF OTTAWA

**APPROVED**  
By Allison Hamlin at 3:33 pm, Mar 06, 2026

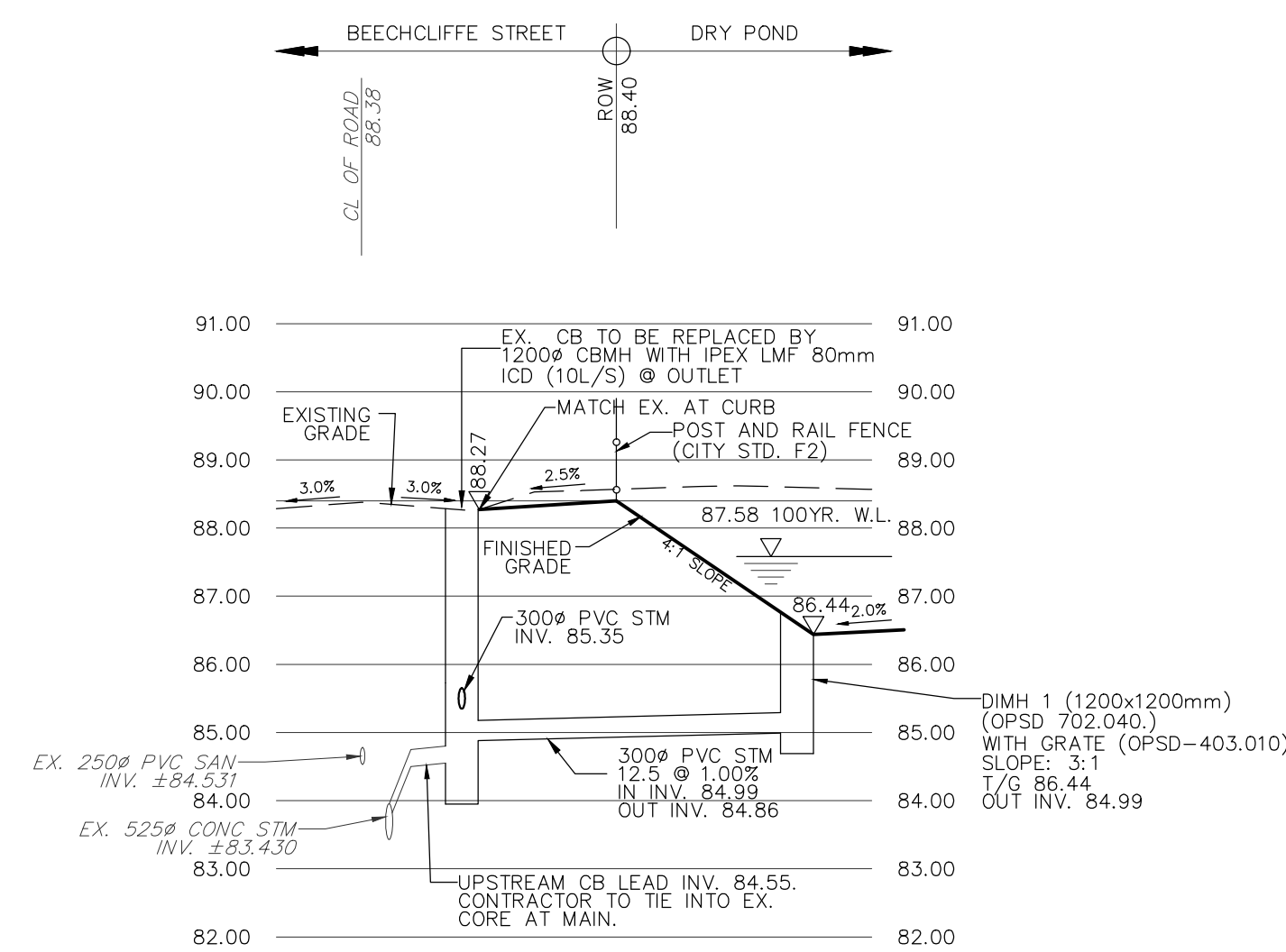
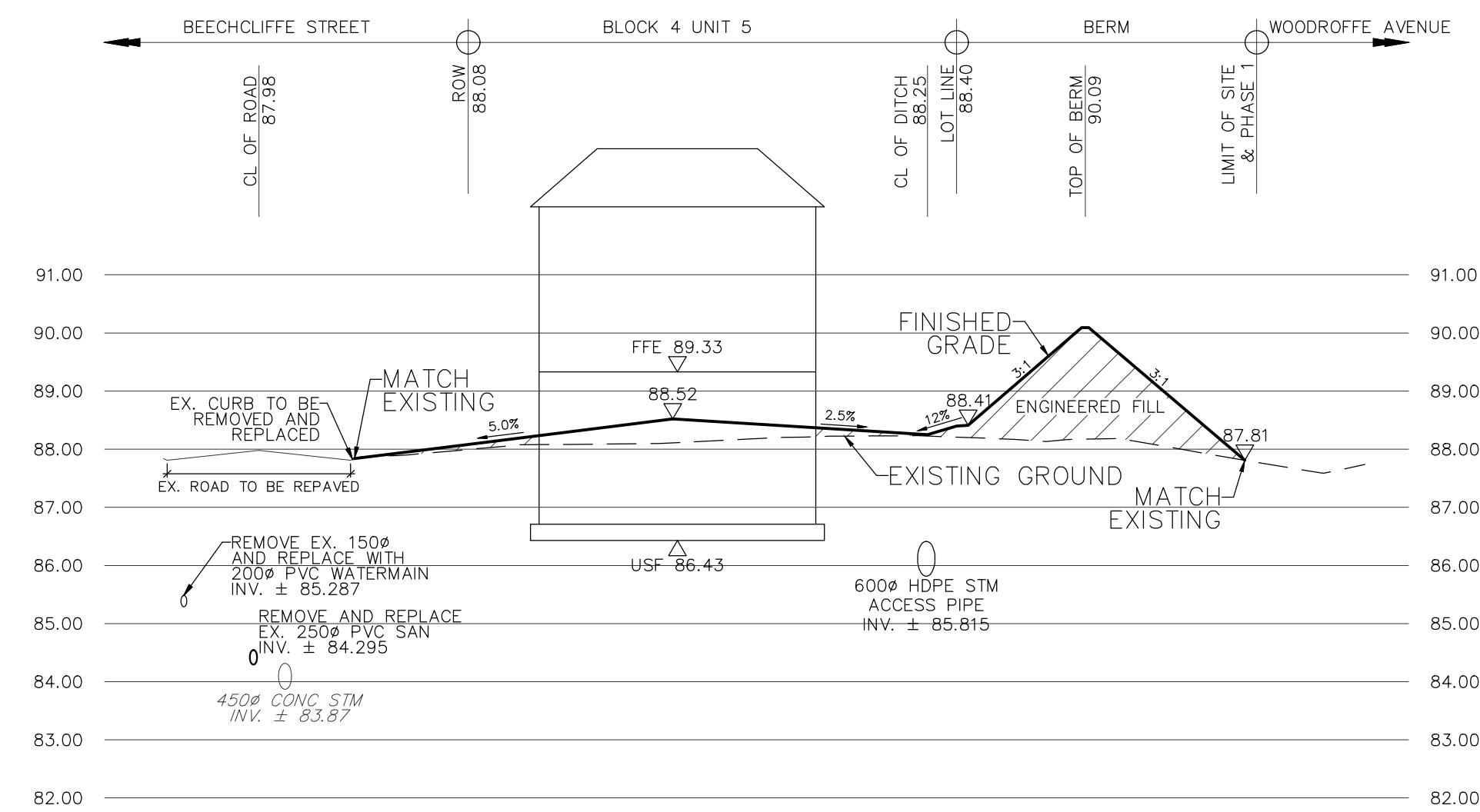

**TOPOGRAPHIC INFORMATION**  
TOPOGRAPHIC INFORMATION PROVIDED BY CITY OF OTTAWA.  
PROJECT 40 BEECHCLIFFE STREET, SURVEY DATED JANUARY 2025.  
ADDITIONAL TOPOGRAPHIC INFORMATION PROVIDED BY AOV LTD.  
PROJECT No. 25159-25, SURVEY DATED MAY 2025 AND JUNE 2025.

**LEGAL INFORMATION**  
REGISTERED PLAN PROVIDED BY AOV LTD., PROJECT No. 25159-25, RECEIVED ON MAY 12, 2025.

**ELEVATION NOTE**  
ELEVATIONS SHOWN ON THIS PLAN ARE GEODETIC AND ARE REFERRED TO THE CGVD28 GEODETIC DATUM. SITE BENCH MARK ON TOP OF FH SPINDLE FRONTING CIVIC ADDRESS 33 BEECHCLIFFE STREET. ELEVATION=88.966m

No.	BY	DATE	DESCRIPTION
6	W.L.	26-03-05	UPDATE FOR SPA
5	W.L.	26-02-17	4th SUBMISSION
4	W.L.	25-09-15	3rd SUBMISSION
3	W.L.	25-08-01	2nd SUBMISSION
2	W.L.	25-07-15	ISSUED FOR TENDER
1	W.L.	25-06-20	1st SUBMISSION

**CITY OF OTTAWA**

PROJECT No. 24-1416

**PROFESSIONAL ENGINEER**  
W. LIU  
100167932  
26-09-06  
PROVINCE OF ONTARIO

HABITAT FOR HUMANITY

40 BEECHCLIFFE STREET

**DSEL**

120 Iher Road, Unit 103  
Stittsville, ON K2S 1E9  
Tel: (613) 836-8856  
Fax: (613) 836-7183  
www.DSEL.ca

**CROSS SECTIONS**

© DSEL

DRAWN BY: A.S.	CHECKED BY: W.L.	SHEET NO.
DESIGNED BY: A.S.	CHECKED BY:	2A OF 12
SCALE: AS SHOWN	DATE: JUNE 2025	

CITY PLAN No. 19322  
CITY FILE No. \_D07-12-25-0091