

FILTER BAG DETAIL
NOT TO SCALE

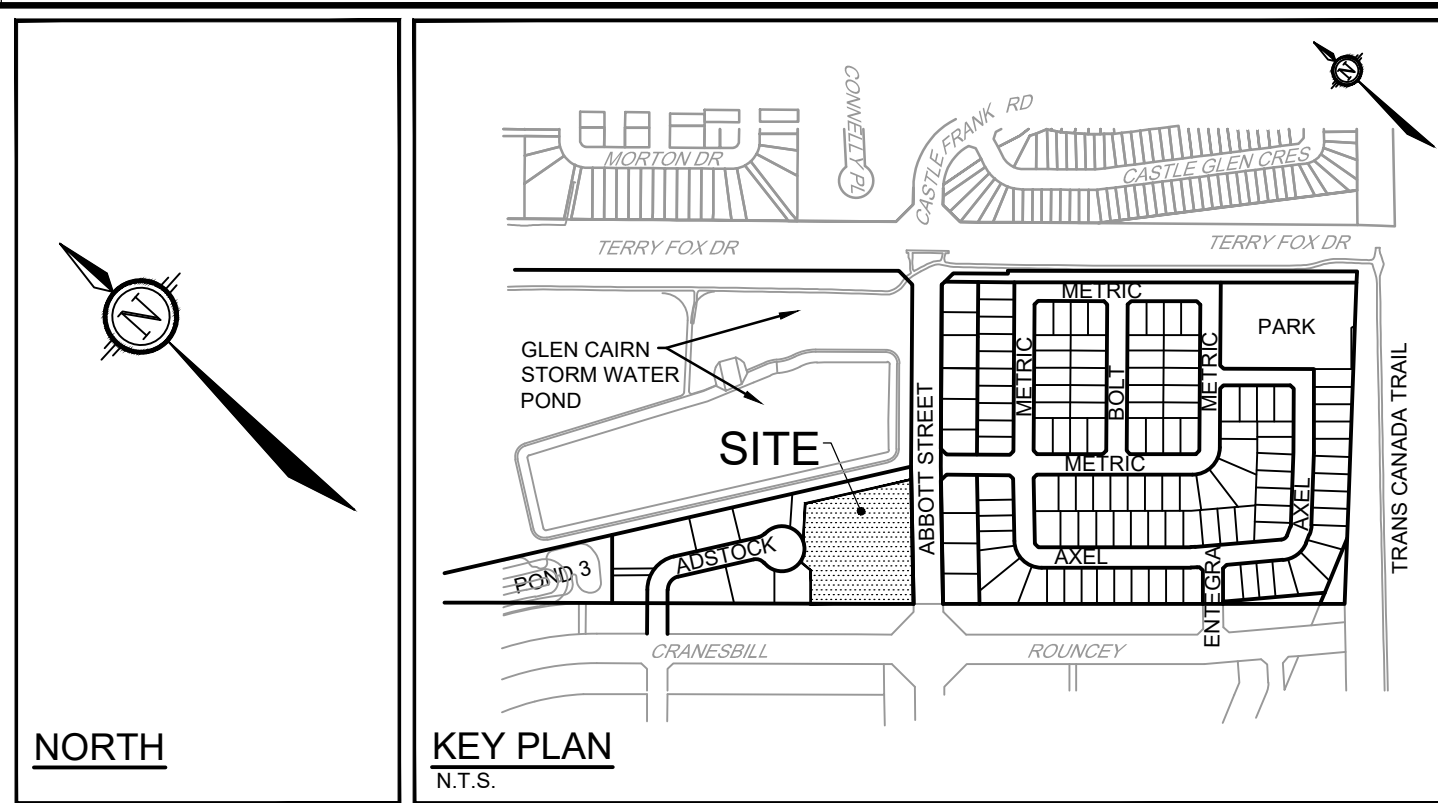

- EROSION AND SEDIMENT CONTROL NOTES:**
1. THE OWNER AGREES TO PREPARE AND IMPLEMENT AN EROSION AND SEDIMENT CONTROL PLAN TO THE SATISFACTION OF THE CITY OF OTTAWA, APPROPRIATE TO THE SITE CONDITIONS, PRIOR TO UNDERTAKING ANY SITE ALTERATIONS (FILLING, GRADING, REMOVAL OF VEGETATION, ETC.) AND DURING ALL PHASES OF SITE PREPARATION AND CONSTRUCTION IN ACCORDANCE WITH THE CURRENT BEST MANAGEMENT PRACTICES FOR EROSION AND SEDIMENT CONTROL, SUCH AS BUT NOT LIMITED TO INSTALLING FILTER CLOTHS ACROSS MANHOLE/CATCHBASIN LIDS TO PREVENT SEDIMENTS FROM ENTERING STRUCTURES AND INSTALL AND MAINTAIN A LIGHT DUTY SILT FENCE BARRIER AS REQUIRED.
 2. THE CONTRACTOR SHALL PLACE FILTER BAGS UNDER THE CATCHBASIN AND MANHOLE GRATES FOR THE DURATION OF CONSTRUCTION AND WILL REMAIN IN PLACE DURING ALL PHASES OF CONSTRUCTION.
 3. SILT FENCING FOR ENTIRE PERIMETER OF SITE, SHALL BE UTILIZED TO CONTROL EROSION FROM THE SITE DURING CONSTRUCTION.
 4. THE CONTRACTOR ACKNOWLEDGES THAT FAILURE TO IMPLEMENT EROSION AND SEDIMENT CONTROL MEASURES MAY BE SUBJECT TO PENALTIES IMPOSED BY ANY APPLICABLE REGULATORY AGENCY.
 5. CONTRACTOR TO INSPECT ALL ESC DAILY AND IMMEDIATELY AFTER EVERY RAINFALL EVENT AND REPAIR ANY DAMAGED OR NON-FUNCTIONING MEASURES IMMEDIATELY.
 6. THE PLAN IS TO BE CONSIDERED A "LIVING DOCUMENT" WHICH MAY BE MODIFIED IN THE EVENT THE EROSION AND SEDIMENT CONTROL MEASURES ARE INSUFFICIENT.
 7. ROADWAYS ARE TO BE SWEEP AS REQUIRED OR AS DIRECTED BY THE ENGINEER AND/OR THE REPRESENTATIVE OF THE CITY OF OTTAWA.

Measure	Symbol	OPSD No.	During Construction		After Construction Prior to Final Acceptance		After Final Acceptance
			Installation Responsibility	Inspection Responsibility	Inspection/Maintenance Responsibility	Removal Responsibility	Inspection/Maintenance Responsibility
Temporary Measures	Light-Duty Silt Fence	219.110	Developer's Contractor	Developer's Contractor	Builder	Builder	N/A
	Straw Bale Flow Check Dam	219.180	Developer's Contractor	Developer's Contractor	Builder	Builder	N/A
	Filter Bags	Erosion and Sediment Control Notes and Details	Developer's Contractor	Developer's Contractor	Builder	Builder	N/A
	Mud Mats	N/A	Developer's Contractor	Developer's Contractor	N/A	N/A	N/A
Permanent Measures	Roof Leaders Directed to Grassed Areas	N/A	Builder	Builder	Developer/Site Owner	N/A	Developer/Site Owner

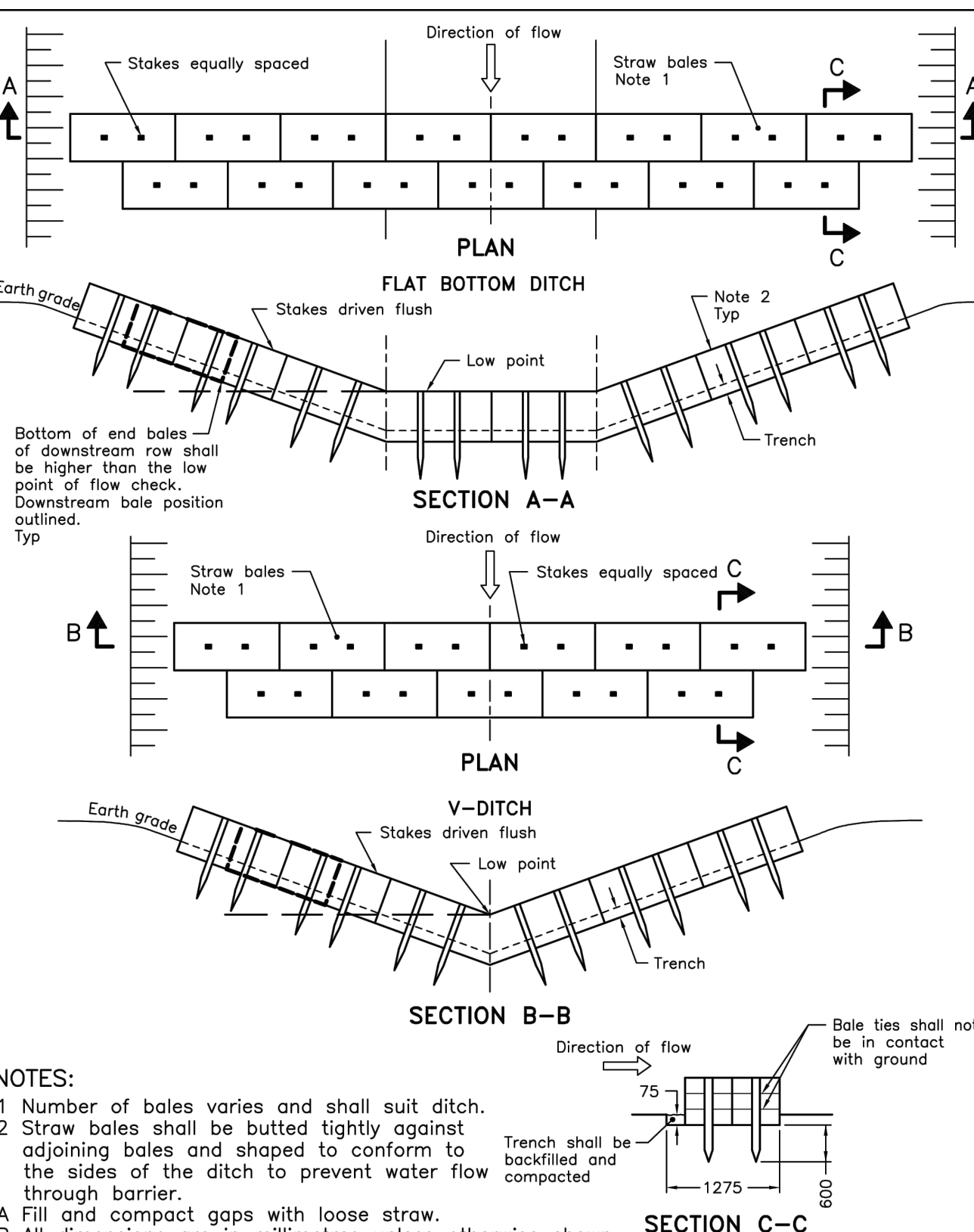

- NOTES:**
- 1 Number of bales varies and shall suit ditch.
 - 2 Straw bales shall be butted tightly against adjoining bales and shaped to conform to the sides of the ditch to prevent water flow through barrier.
 - A Fill and compact gaps with loose straw.
 - B All dimensions are in millimetres unless otherwise shown.

ONTARIO PROVINCIAL STANDARD DRAWING Nov 2021 Rev 3
STRAW BALE FLOW CHECK DAM
 OPSD 219.180

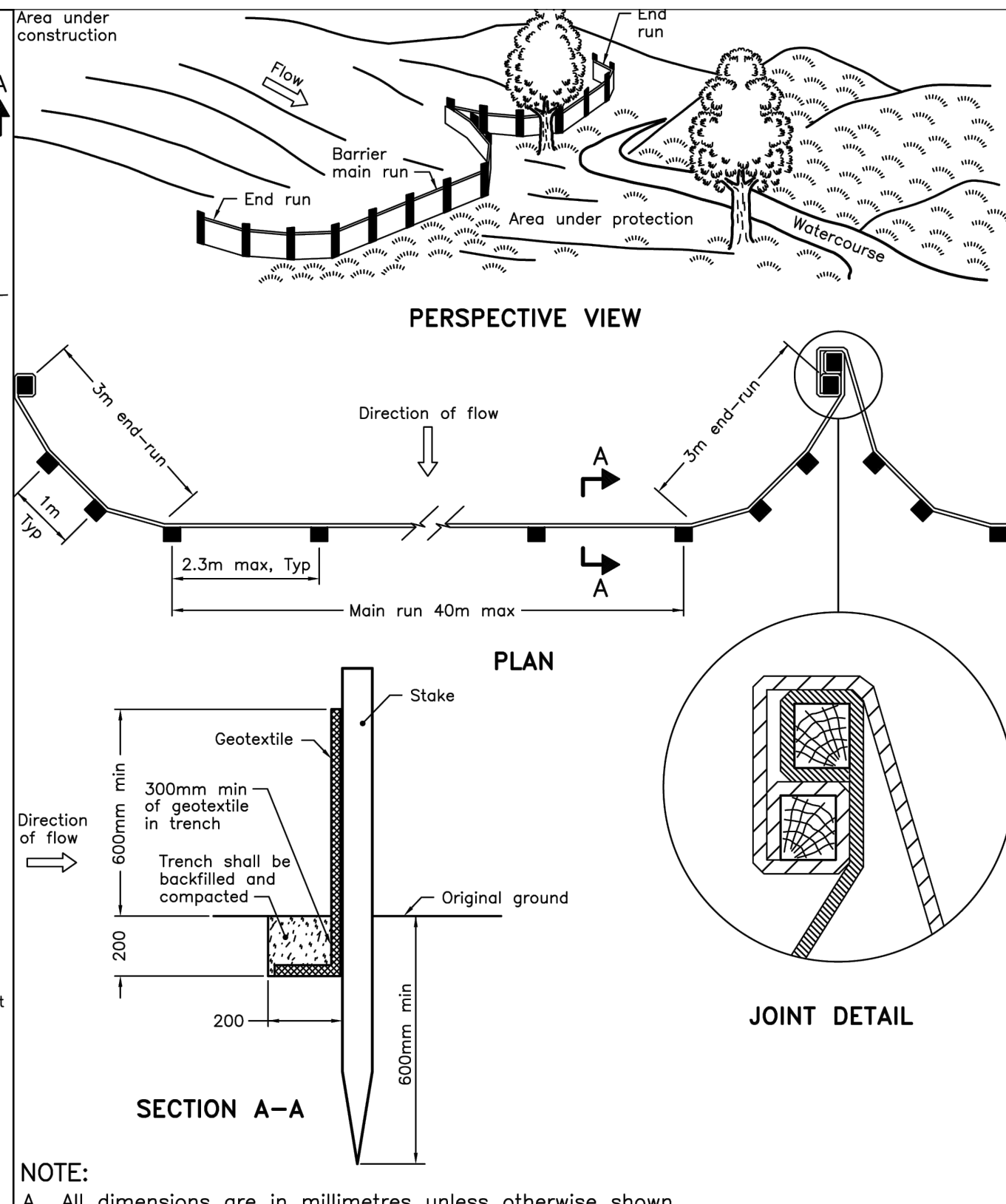

NOTE:
A All dimensions are in millimetres unless otherwise shown.

ONTARIO PROVINCIAL STANDARD DRAWING Nov 2021 Rev 3
LIGHT-DUTY SILT FENCE BARRIER
 OPSD 219.110

NOTE:
THE POSITION OF ALL POLE LINES, CONDUITS, WATERMANS, SEWERS AND OTHER UNDERGROUND AND OVERGROUND UTILITIES AND STRUCTURES IS NOT NECESSARILY SHOWN ON THE CONTRACT DRAWINGS, AND WHERE SHOWN, THE ACCURACY OF THE POSITION OF SUCH UTILITIES AND STRUCTURES IS NOT GUARANTEED. BEFORE STARTING WORK, DETERMINE THE EXACT LOCATION OF ALL SUCH UTILITIES AND STRUCTURES AND ASSUME ALL LIABILITY FOR DAMAGE TO THEM.

APPROVED
By Sean Moore at 1:07 pm, May 27, 2026

SEAN MOORE MCIP, RPP
 MANAGER, DEVELOPMENT REVIEW - WEST
 PLANNING, INFRASTRUCTURE & ECONOMIC
 DEVELOPMENT DEPARTMENT, CITY OF OTTAWA

No.	REVISION	DATE	BY
4.	REVISED PER CITY AND MVCA COMMENTS	APR 24/26	ARM
3.	REVISED PER CITY AND MVCA COMMENTS	FEB 11/26	ARM
2.	REVISED PER CITY AND MVCA COMMENTS	FEB 2/26	ARM
1.	ISSUED FOR REVIEW	JUL 22/25	ARM

SCALE
1:200

DESIGN: DKM
 CHECKED: MJB
 DRAWN: DKM
 CHECKED: ARM
 APPROVED: ARM

PROFESSIONAL ENGINEER
A.R. MCALLEY
 100141256
 April 24, 2022
 PROVINCE OF ONTARIO

NOVATECH
 Engineers, Planners & Landscape Architects
 Suite 200, 240 Michael Copland Drive
 Ottawa, Ontario, Canada K2M 1P6
 Telephone: (613) 254-9643
 Facsimile: (613) 254-5867
 Website: www.novatech-eng.com

LOCATION
(METRIC HOMES) SUBDIVISION - BLOCK 123
 4829 ABBOTT ST EAST

DRAWING NAME
EROSION & SEDIMENT CONTROL PLAN

PROJECT No.: 110037
 REV: #4
 DRAWING No.: 110037-ESC

#19360