

**CONSTRUCTION MANAGEMENT PLAN NOTES:**

- SOMME STREET IS A TWO WAY STREET. ROAD CONSTRUCTION WORK IS TO BE CONDUCTED IN A SINGLE STAGE. THIS WILL REQUIRE A SECTION OF ROAD BEING RESTRICTED DURING CONSTRUCTION.
- THIS CLOSURE WILL CONSIST OF RESTRICTING THE STREET IN FRONT OF THE DEVELOPMENT, CLOSING THE NORTHBOUND LANE, AND UTILIZING SOUTHBOUND LANE FOR TRAFFIC. DURING THIS PERIOD THE ROAD CONNECTION WILL BE CONSTRUCTED.
- THE GRAVEL SHOULDER OF THE NORTH BOUND LANE IS ALSO TO BE RESTRICTED DURING THIS PERIOD.
- TEMPORARY ROAD CLOSURE FOR APPROXIMATELY 6 WEEKS IN DURATION, DURING CONSTRUCTION FOR BUILDING AND ROAD CONNECTION. ALL NEIGHBORING PRIVATE ACCESSES TO BE MAINTAINED DURING TEMPORARY ROAD CLOSURE.
- A DETAILED CONSTRUCTION MANAGEMENT PLAN TO BE PREPARED AND PROVIDED BY THE CONTRACTOR, ONCE ONE IS RETAINED.

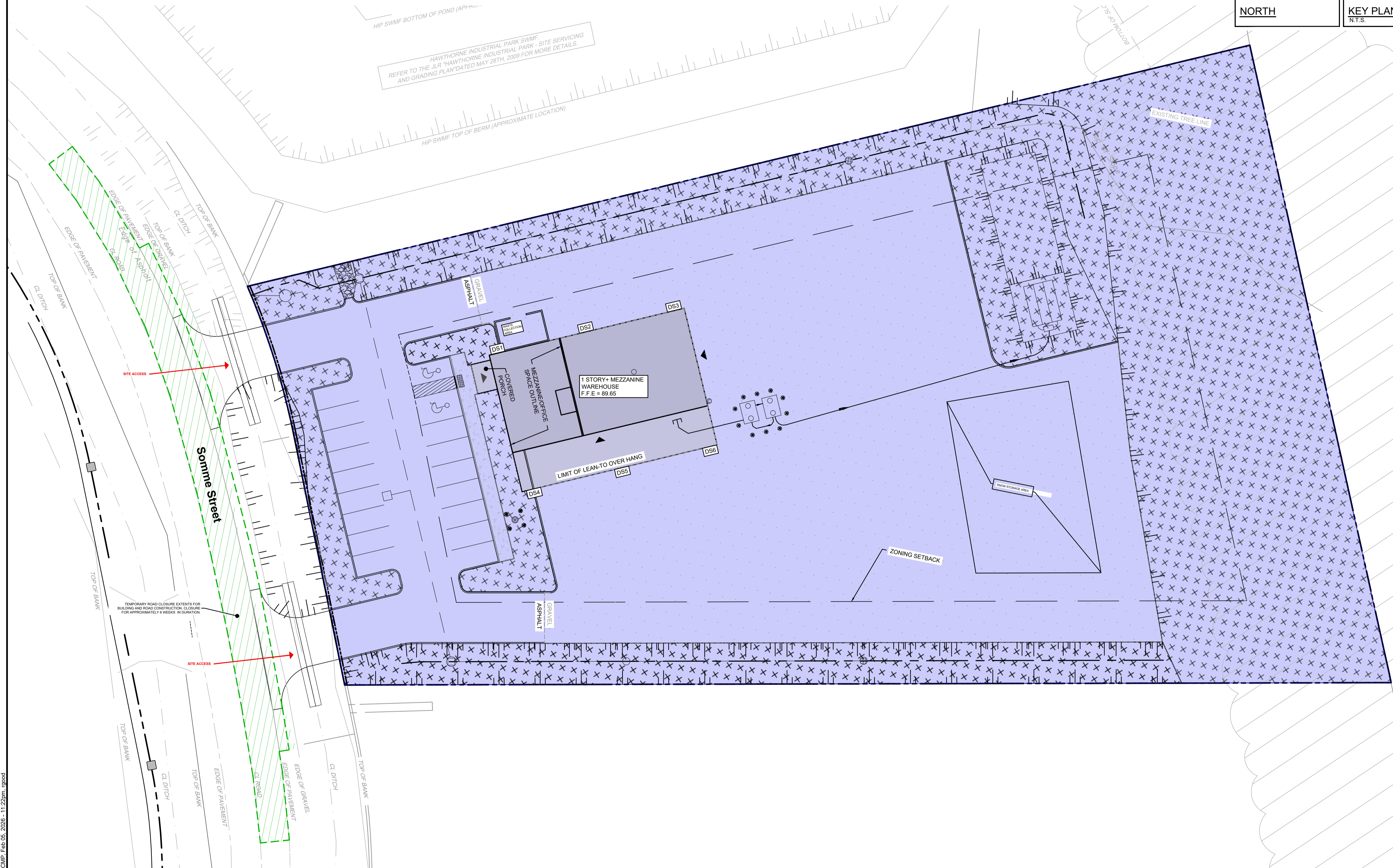
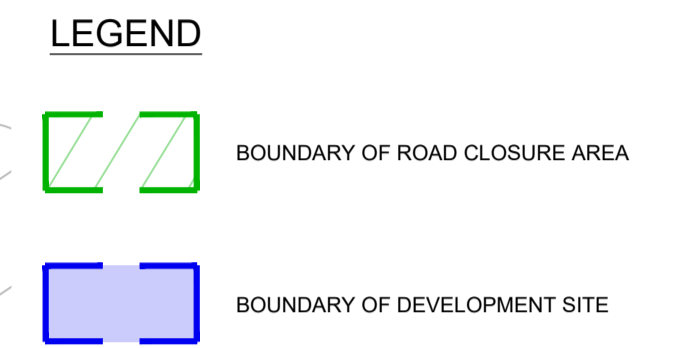
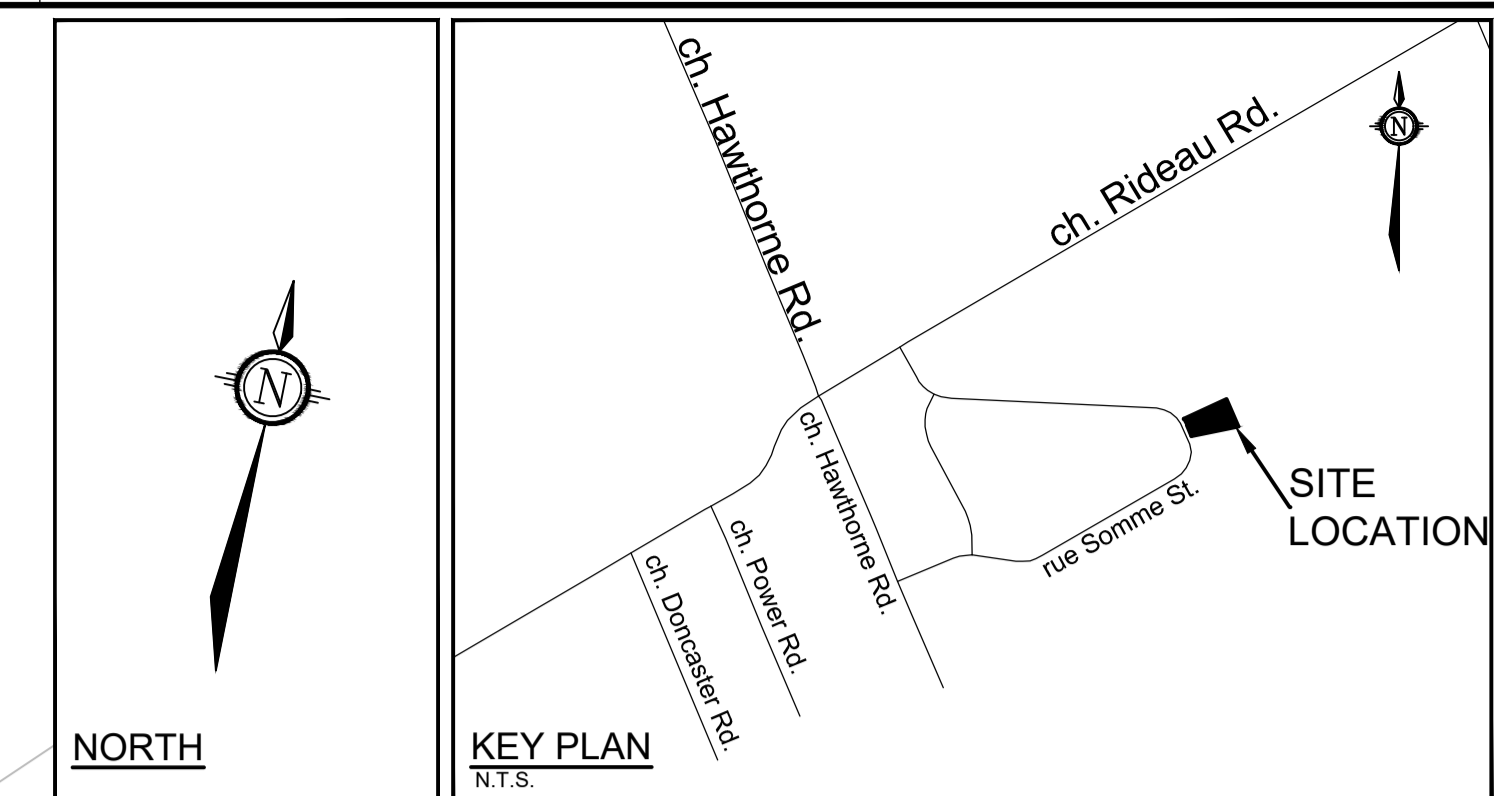

**NOTE:**  
THE POSITION OF ALL POLE LINES, CONDUITS, WATERMANS, SEWERS AND OTHER UNDERGROUND AND OVERGROUND UTILITIES AND STRUCTURES IS NOT NECESSARILY SHOWN ON THE CONTRACT DRAWINGS, AND WHERE SHOWN, THE ACCURACY OF THE POSITION OF SUCH UTILITIES AND STRUCTURES IS NOT GUARANTEED. BEFORE STARTING WORK, DETERMINE THE EXACT LOCATION OF ALL SUCH UTILITIES AND STRUCTURES AND ASSUME ALL LIABILITY FOR DAMAGE TO THEM.

No.	REVISION	DATE	BY
3.	ISSUED TO ADDRESS CITY COMMENTS	FEB 06/2026	GJM
2.	ISSUED TO ADDRESS CITY COMMENTS	SEP 23/2025	GJM
1.	ISSUED FOR SITE PLAN APPLICATION	JUN 03/2025	GJM

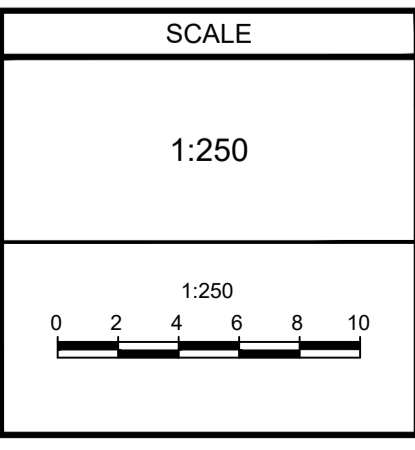

DESIGN	RJG
CHECKED	ARM
DRAWN	RJG
CHECKED	ARM
APPROVED	GJM

**FOR REVIEW ONLY**

**NOVATECH**  
Engineers, Planners & Landscape Architects  
Suite 200, 240 Michael Cowpland Drive  
Ottawa, Ontario, Canada K2M 1P6  
Telephone (613) 254-9643  
Facsimile (613) 254-5867  
Website www.novatech-eng.com

LOCATION  
CITY OF OTTAWA  
541 SOMME STREET

DRAWING NAME  
**PRELIMINARY CONSTRUCTION MANAGEMENT PLAN**

PROJECT No. 124111  
REV # 3  
DRAWING No. 124111-CMP

M:\2024\124111\CAD\Civil\124111-CMP.dwg, CMP, Feb 05, 2026 - 11:22pm, rjg

FILE # D07-12-25-0077 PLAN # 19398