

- NOTES:**
- ALL DIMENSIONS ARE IN MILLIMETERS OR METERS.
 - TOP OF FOUNDATION SHALL BE TROWELED SMOOTH & LEVEL.
 - CLASS OF CONCRETE SHALL BE 25MPa. CONCRETE SHALL BE VIBRATED.
 - MINIMUM OF TWO SLEEVES REQUIRED FOR EACH CONCRETE FOUNDATION UNLESS OTHERWISE SHOWN.
 - PROVIDE 4 19mm DIA. 300mm STEEL COPPER COATED GROUND ROD ADJACENT TO POLES AS SPECIFIED ON PLAN AND CONNECT TO METAL POLE WITH BARE COPPER CONDUCTOR.
 - CONTRACTOR TO VERIFY OPENING SIZE IN POLE BASE PLATE PRIOR TO SETTING CONDUIT SLEEVES. CONTRACTOR TO PROVIDE STRUCTURAL ENGINEER APPROVAL FOR BASE DESIGN.
 - SUBJECT TO SOIL CONDITIONS, REFER TO SOIL REPORT.
 - FORM RELEASE AGENT HAS BEEN FACTORY - APPLIED TO INSIDE SURFACE OF "4"FORM".

NOTE:
CONCRETE BASES FOR LUMINAIRES TO BE SUPPLIED AND INSTALLED BY THIS ELECTRICAL CONTRACTOR.

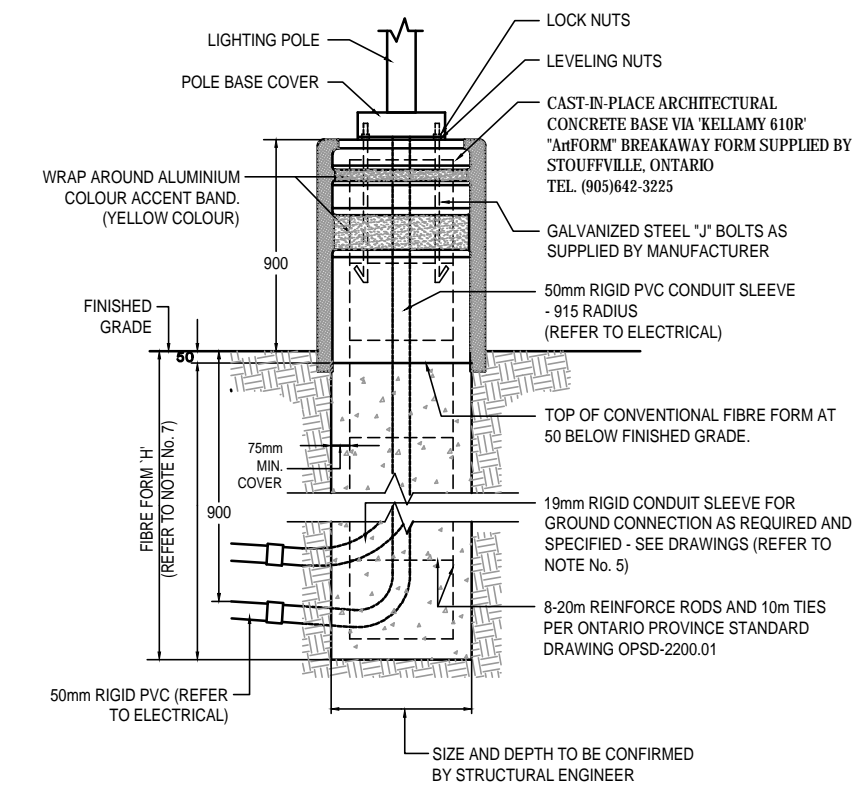

POLE LENGTH (M)	BASE BURIAL DEPTH (M)	REIN. ROD LENGTH (M)
3.0	1.50	1.25
5.0	2.15	2.00
7.0	2.15	2.00
7.5	2.15	2.00
8.7	2.45	2.30
9.0	2.45	2.30
10.5	2.80	2.45
12.0	2.75	2.60
13.8	2.90	2.75
15.1	3.05	2.90

Symbol	Qty	Label	Arrangement	LLF	Description	Lum. Watts	Lum. Lums
CC	5	CC	SINGLE	0.900	HC630D104HM3040840-1MDC	28	3776
EX4	3	EX4	SINGLE	0.800	GLEON-SAYC-740-U-74FT-HSS	391	35228
AA	2	AA	4 @ 90°	0.900	GLEON-SAYC-740-U-5WQ	391	52697
EX3	2	EX3	3 @ 120 DEGREES	0.900	GLEON-SAYC-740-U-5WQ	391	52697
AA2	1	AA2	Back-Back	0.900	GLEON-SAYC-740-U-5WQ-HSS	391	52697
EX2	3	EX2	2 @ 180 DEGREES	0.900	GLEON-SAYC-740-U-5WQ	391	52697
EX1	2	EX1	SINGLE	0.900	GLEON-SAYC-740-U-5WQ	391	52697
AA1	1	AA1	SINGLE	0.900	GLEON-SAYC-740-U-5WQ-HSS	391	52697
EX-W1	3	EX-W1	SINGLE	0.900	ASWPLED2S-50W-4000K	50.2	7433
EX-W	5	EX-W	SINGLE	0.900	ASWPLED1S-24W-4000K	23.1	3076
BB1	20	BB1	SINGLE	0.900	XTOR3B-W	25.5	331.5
BB	7	BB	SINGLE	0.900	XTOR4B-W	37.7	640.9

Label	CalcType	Units	Avg	Max	Min	Avg/Min	Max/Min
PROPERTY LINE - LIGHT TRESPASS	Illuminance	Lux	2.01	50	0	N.A.	N.A.
ROADWAY - LIGHT TRESPASS	Illuminance	Lux	0.33	5	0	N.A.	N.A.
SITE @ GRADE	Illuminance	Lux	33.67	186	0	N.A.	N.A.
AREA OF SCOPE	Illuminance	Lux	44.56	186	0	N.A.	N.A.
PARKING LOT	Illuminance	Lux	61.21	186	1	61.21	186.00

ALL LIGHTING FIXTURES TO BE FULL CUT OFF.

2 TYPICAL CONCRETE BASE FOR LUMINAIRE
SCALE: N.T.S.

DRAWING No.	DESCRIPTION	SCALE
E-SPA1	ELECTRICAL SITE PLAN LIGHTING PHOTOMETRIC	1 : 500
E-SPA2	ISOMETRIC PLAN - AND ORIENTATION ANGLE LIGHTING	N.T.S.

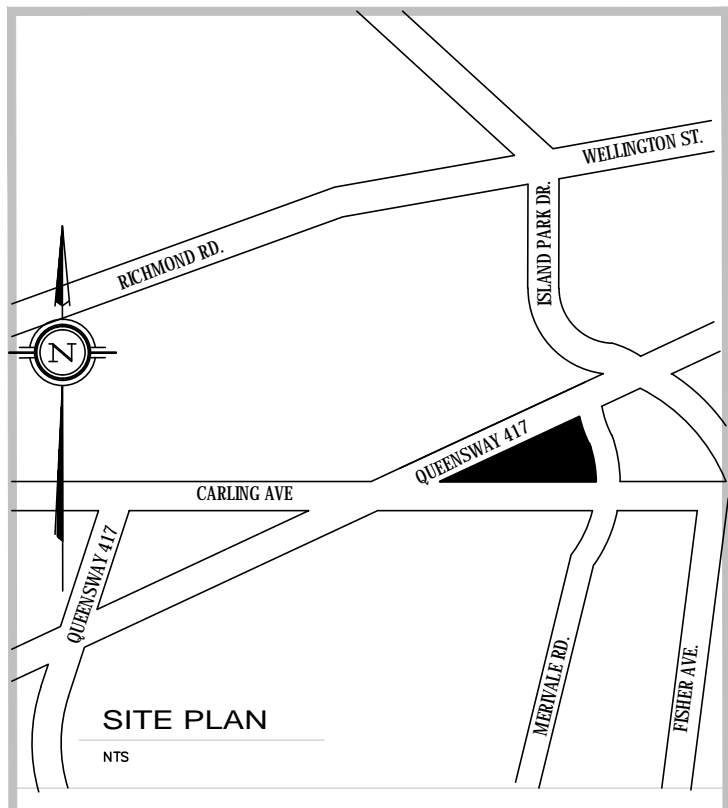
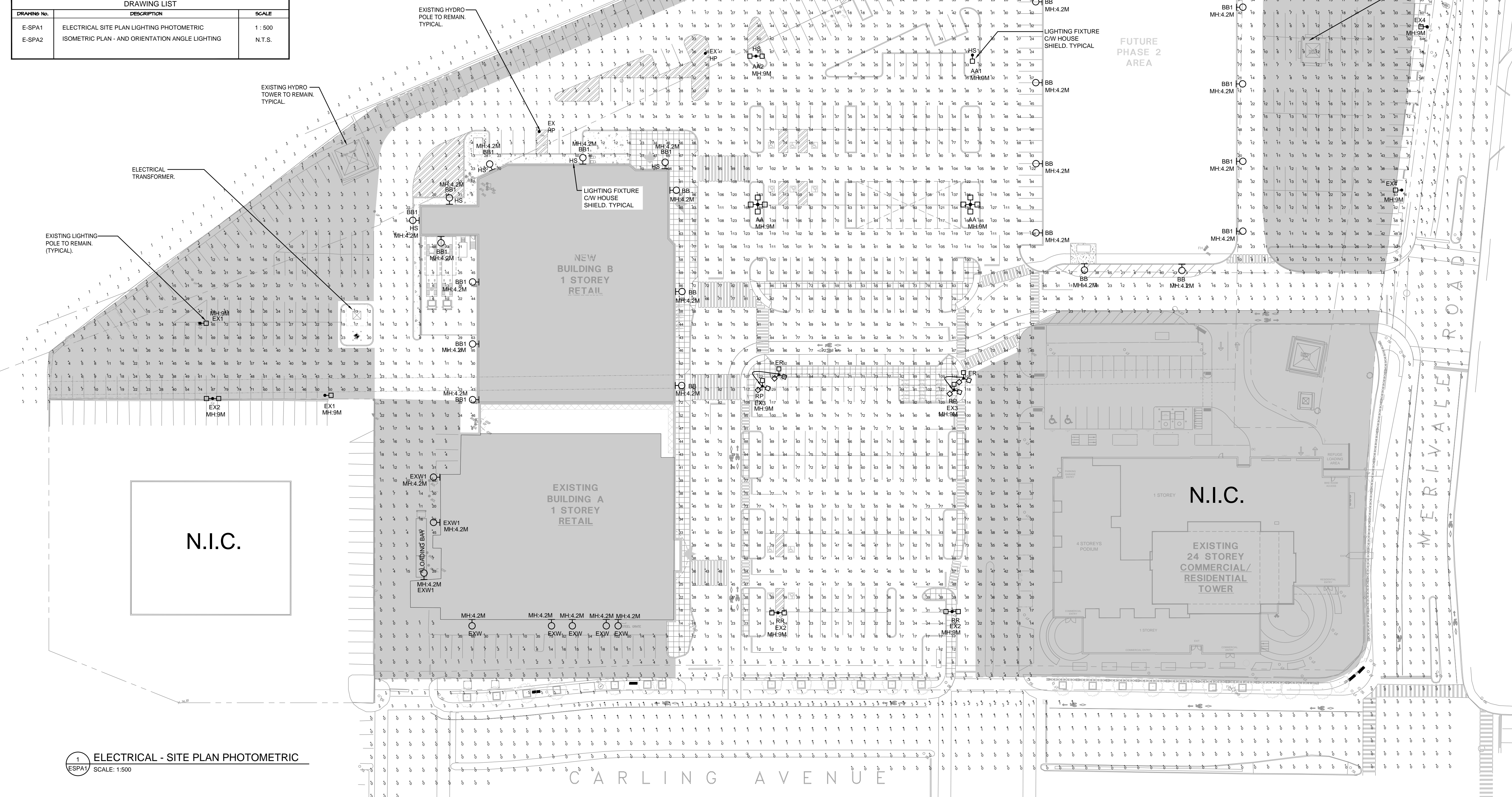

G. Wildman
GERALDINE WILDMAN
MANAGER, DEVELOPMENT REVIEW SOUTH
PLANNING, DEVELOPMENT AND BUILDING SERVICES
DEPARTMENT, CITY OF OTTAWA

APPROVED
By wildmange at 3:40 pm, Jun 19, 2026

REV	BY	DESCRIPTION	DATE
02	QV	REVISED PER CITY COMMENTS 1	31-OCT-2025
01	QV	ISSUED FOR COORDINATION	03-MAR-2025

h HAMMERSCHLAG & JOFFE INC.
43 Leavel Road, Toronto, Ontario
Canada M3B 2T8
T: (416) 444-5283
F: (416) 444-1483
E: daw@hampj.com

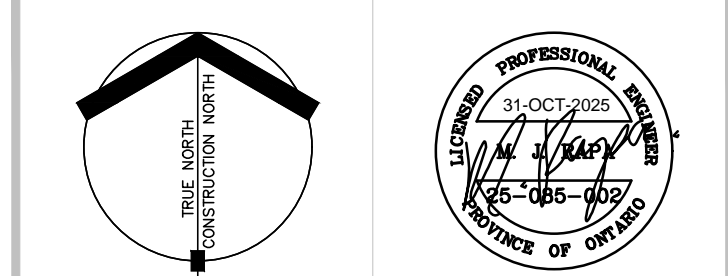

PROJECT
PROPOSED REDEVELOPMENT OF WESTGATE SC
1309 CARLING AVENUE OTTAWA, ONTARIO
DRAWING TITLE
SITE PLAN - PHOTOMETRIC

DRAWN BY	MT.	COMM. NO.	25-085-002
CHECKED	QV.	DRAWING NO.	
SCALE	AS NOTED		ESPA1
DATE	JAN-2025		

1 ELECTRICAL - SITE PLAN PHOTOMETRIC
SCALE: 1:500

