

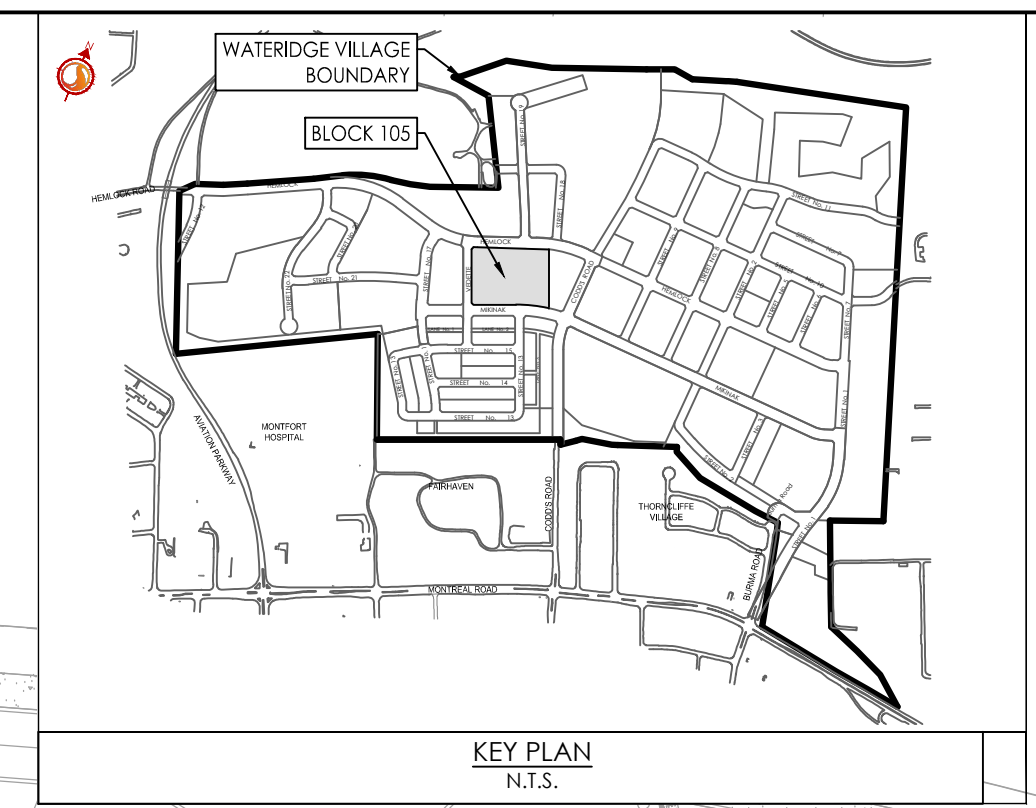

A. McCreight

ANDREW MCCREIGHT
MANAGER, DEVELOPMENT REVIEW CENTRAL
PLANNING, DEVELOPMENT & BUILDING SERVICES
DEVELOPMENT DEPARTMENT, CITY OF OTTAWA

APPROVED
 By Andrew McCreight at 1:03 pm, Mar 02, 2026



Stantec Consulting Ltd.
 400 - 1331 Clyde Avenue
 Ottawa ON
 Tel. 613.722.4420
 www.stantec.com

Copyright Reserved
 The Contractor shall verify and be responsible for all dimensions. DO NOT scale the drawing - any errors or omissions shall be reported to Stantec without delay.
 The Copyrights to all designs and drawings are the property of Stantec. Reproduction or use for any purpose other than that authorized by Stantec is forbidden.

- Legend**
- R10A** SANITARY DRAINAGE AREA ID#
 - 0.31 50** POPULATION COUNT
 - SANITARY DRAINAGE AREA ha.
 - G10A** SANITARY DRAINAGE AREA ID#
 - 0.11 INFL** INFILTRATION RATE OF 0.33 L/ha HO APPLIED
 - SANITARY DRAINAGE AREA ha.
 - SANITARY DRAINAGE AREA
 - PROPOSED SANITARY MH AND SEWER
 - EXISTING SANITARY MH AND SEWER

Notes

Revision	By	Appd.	YY.MM.DD
5	JP	PM	26.01.20
4	JP	PM	25.11.25
3	JP	PM	25.11.03
2	JP	PM	25.07.04
1	JP	PM	25.04.04

File Name:	JP	PM	JP	25.03.24
160402127-08				



Client/Project
MATTAMY HOMES

WATERIDGE VILLAGE
BLOCK 105
 OTTAWA, ON, CANADA

Title
SANITARY DRAINAGE PLAN

Project No.	Scale	0	4	12	20m
160402127	1:400				
Drawing No.	Sheet	Revision			

SA-1 8 of 11 **4**
 PLAN # 19303

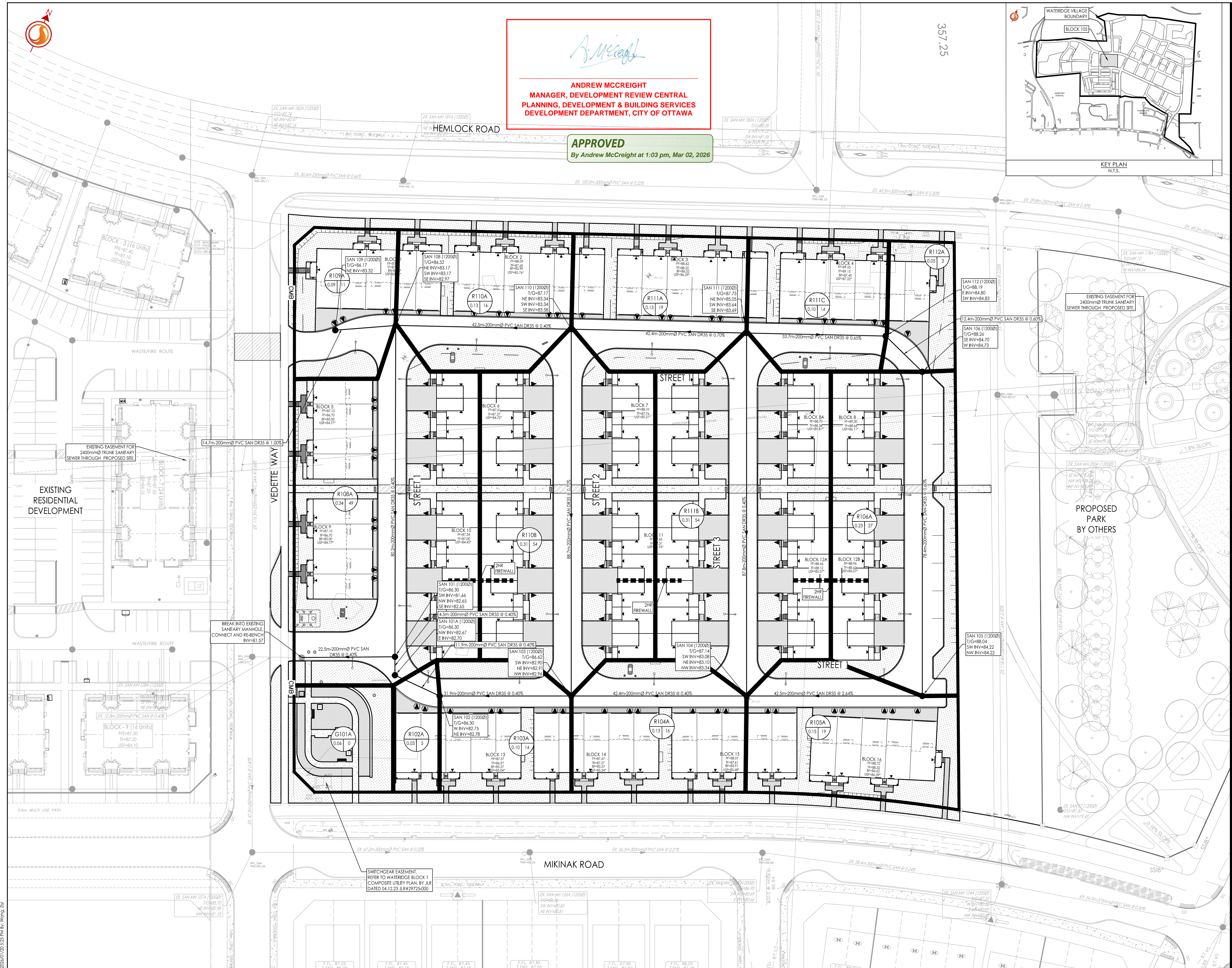

I:\2025\160402127\design\drawings\160402127-08.dwg
 2026/01/25 09:51 AM by [redacted]
 ORIGINAL SHEET - ARCH D

D07-12-25-0063