

This drawing, as an instrument of service, is provided by and is the property of Turner Fleischer Architects Inc. The contractor must verify and accept responsibility for all dimensions and conditions on site and must notify Turner Fleischer Architects Inc. of any variations from the supplied information. This drawing is not to be scaled. The architect is not responsible for the accuracy of survey, structural, mechanical, electrical, etc. information shown on this drawing. Refer to the appropriate consultant drawings before proceeding with the work. Contractor must conform to all applicable codes and requirements of applicable building jurisdiction. The contractor working from drawings not specifically marked "for Contractor" must assume full responsibility and bear costs for any corrections or damages resulting from his work.

### SHADOW STUDY LEGEND

- EXISTING SHADOWS
- PROPOSED BUILDING  
28 STOREYS
- PUBLIC SPACES
- NET NEW SHADOWS BY  
PROPOSED DEVELOPMENT
- PROPOSED SHADOW  
OUTLINE
- AS-OF-RIGHT SHADOW  
OUTLINE
- PROPOSED MASTER PLAN  
SHADOW OUTLINE

Assuming Site is Flat

### SCALE BAR

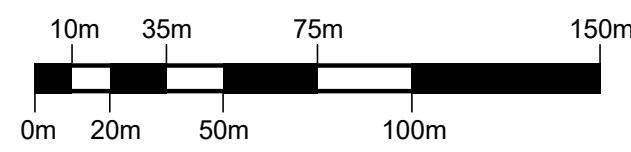

1 JUNE 21 SHADOW STUDIES 08:00AM  
SPA811 1:2000



2 JUNE 21 SHADOW STUDIES 09:00AM  
SPA811 1:2000

4	2026-01-13	ISSUED FOR SITE PLAN APPROVAL #3	HHO
3	2025-04-04	ISSUED FOR SITE PLAN APPROVAL #2	AYU
2	2024-11-01	ISSUED FOR SITE PLAN APPROVAL	AYU
1	2024-01-30	ISSUED FOR PRE-CONSTRUCTION	AYU
#	DATE	DESCRIPTION	BY



PROJECT  
**PROPOSED 28-STOREY RESIDENTIAL BUILDING**  
PHASE 1 - 500 COVENTRY ROAD, OTTAWA, ON.  
FILE #D07-12-24-0151  
PLAN #19272

### JUNE SHADOW STUDIES

PROJECT NO.  
18.050 P01  
PROJECT DATE  
2026-01-13  
DRAWN BY  
RYT  
CHECKED BY  
HHO  
SCALE  
1:2000

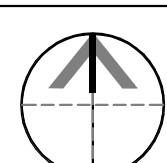

DRAWING NO. SPA811 REV. 4

2026-01-13 11:01:13 AM

This drawing, as an instrument of service, is provided by and is the property of Turner Fleischer Architects Inc. The contractor must verify and accept responsibility for all dimensions and conditions on site and must notify Turner Fleischer Architects Inc. of any variations from the supplied information. This drawing is not to be scaled. The architect is not responsible for the accuracy of survey, structural, mechanical, electrical, etc. information shown on this drawing. Refer to the appropriate consultant drawings before proceeding with the work. Contractor must conform to all applicable codes and requirements of applicable building jurisdiction. The contractor working from drawings not specifically marked "For Contractor" must assume full responsibility and bear costs for any corrections or damages resulting from his work.

### SHADOW STUDY LEGEND

-  EXISTING SHADOWS
-  PROPOSED BUILDING 28 STOREYS
-  PUBLIC SPACES
-  NET NEW SHADOWS BY PROPOSED DEVELOPMENT
-  PROPOSED SHADOW OUTLINE
-  AS-OF-RIGHT SHADOW OUTLINE
-  PROPOSED MASTER PLAN SHADOW OUTLINE

Assuming Site is Flat

### SCALE BAR

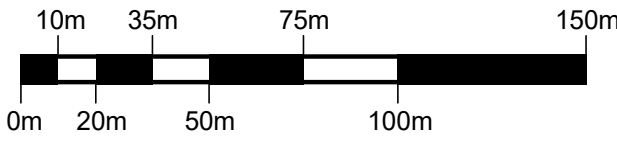

1 JUNE 21 SHADOW STUDIES 10:00AM  
SPA812 1:2000

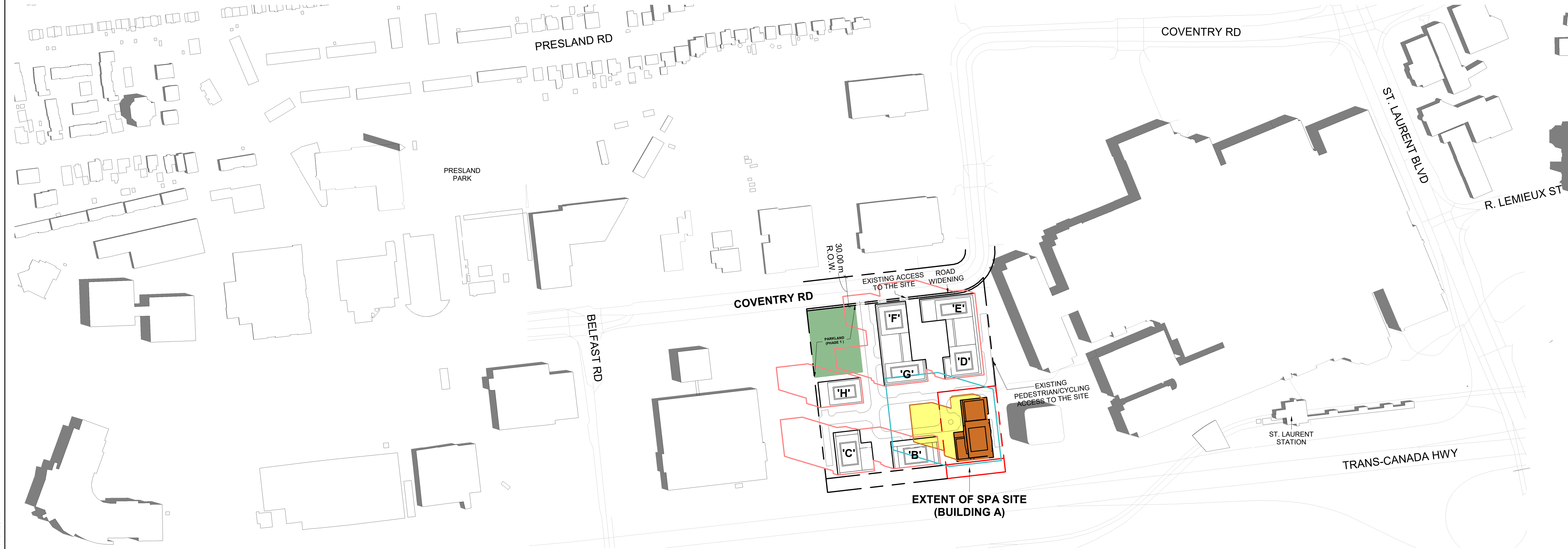

2 JUNE 21 SHADOW STUDIES 11:00AM  
SPA812 1:2000

4	2026-01-13	ISSUED FOR SITE PLAN APPROVAL #3	HHO
3	2025-04-04	ISSUED FOR SITE PLAN APPROVAL #2	AYU
2	2024-11-01	ISSUED FOR SITE PLAN APPROVAL	AYU
1	2024-01-30	ISSUED FOR PRE-CONSTRUCTION	AYU
#	DATE	DESCRIPTION	BY



PROJECT  
**PROPOSED 28-STOREY RESIDENTIAL BUILDING**  
PHASE 1 - 500 COVENTRY ROAD, OTTAWA, ON.  
FILE #D07-12-24-0151  
PLAN #19272

### JUNE SHADOW STUDIES

PROJECT NO.  
18.050 P01  
PROJECT DATE  
2026-01-13  
DRAWN BY  
RYT  
CHECKED BY  
HHO  
SCALE  
1:2000

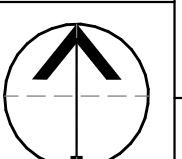

DRAWING NO. SPA812 REV. 4

2026-01-13 11:01:25 AM

This drawing, as an instrument of service, is provided by and is the property of Turner Fleischer Architects Inc. The contractor must verify and accept responsibility for all dimensions and conditions on site and must notify Turner Fleischer Architects Inc. of any variations from the supplied information. The drawing is not to be scaled. The architect is not responsible for the accuracy of survey, structural, mechanical, electrical, etc. information shown on this drawing. Refer to the appropriate consultant drawings before proceeding with the work. Contractor must conform to all applicable codes and requirements of applicable building jurisdiction. The contractor working from drawings not specifically marked "for Contractor" must assume full responsibility and bear costs for any corrections or damages resulting from his work.

### SHADOW STUDY LEGEND

- EXISTING SHADOWS
- PROPOSED BUILDING  
28 STOREYS
- PUBLIC SPACES
- NET NEW SHADOWS BY  
PROPOSED DEVELOPMENT
- PROPOSED SHADOW  
OUTLINE
- AS-OF-RIGHT SHADOW  
OUTLINE
- PROPOSED MASTER PLAN  
SHADOW OUTLINE

Assuming Site is Flat

### SCALE BAR

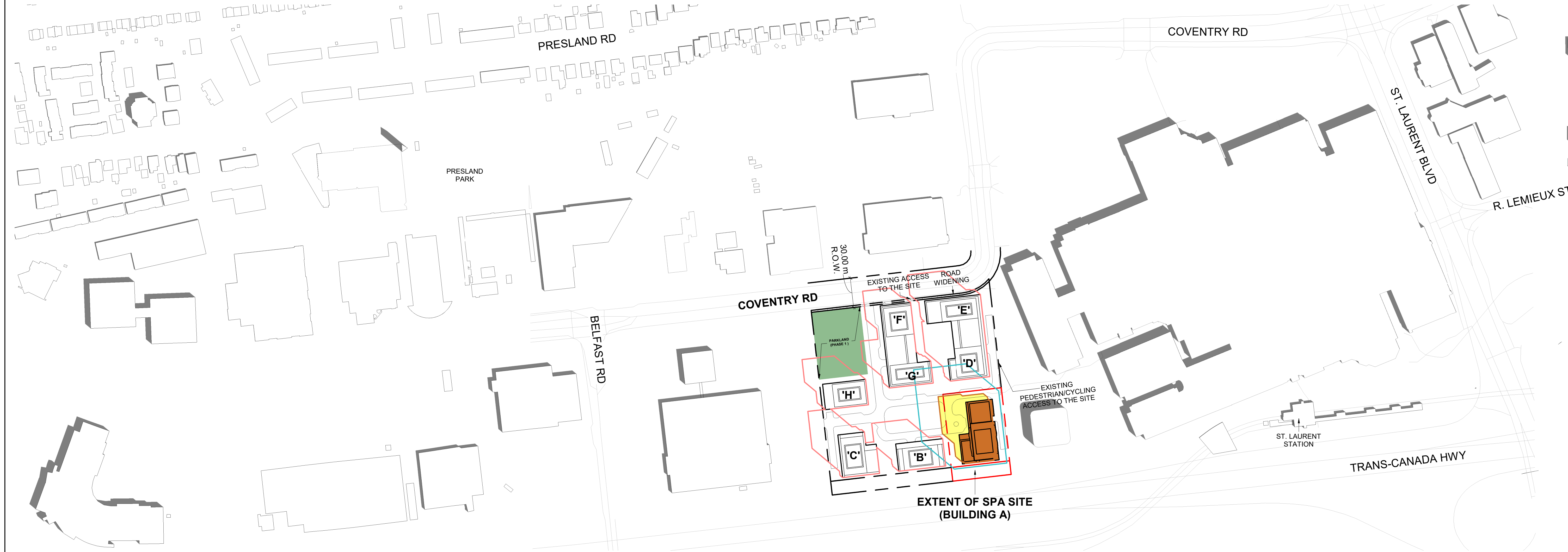
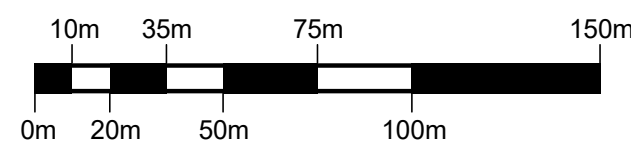

1 JUNE 21 SHADOW STUDIES 12:00PM  
SPA813 1:2000

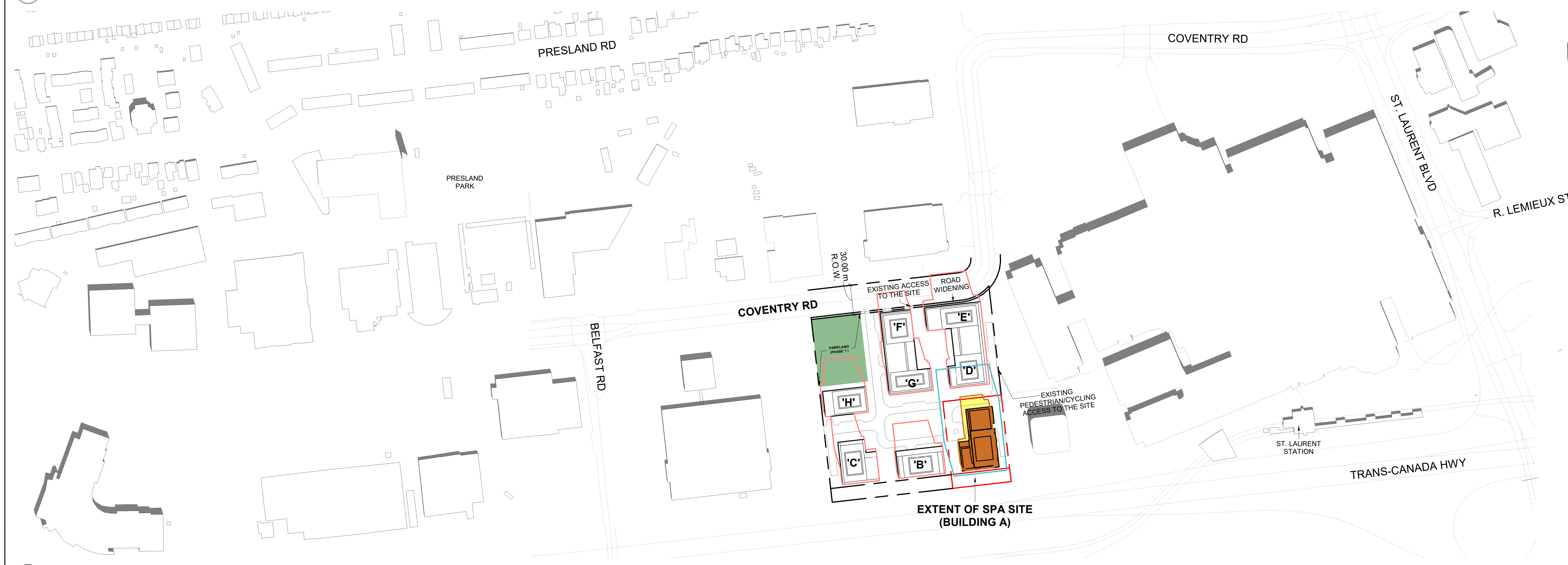

2 JUNE 21 SHADOW STUDIES 01:00PM  
SPA813 1:2000

4	2026-01-13	ISSUED FOR SITE PLAN APPROVAL #3	HHO
3	2025-04-04	ISSUED FOR SITE PLAN APPROVAL #2	AYU
2	2024-11-01	ISSUED FOR SITE PLAN APPROVAL	AYU
1	2024-01-30	ISSUED FOR PRE-CONSTRUCTION	AYU
#	DATE	DESCRIPTION	BY



PROJECT  
**PROPOSED 28-STOREY RESIDENTIAL BUILDING**  
PHASE 1 - 500 COVENTRY ROAD, OTTAWA, ON.  
FILE #D07-12-24-0151  
PLAN #19272

### JUNE SHADOW STUDIES

PROJECT NO.  
18.050 P01  
PROJECT DATE  
2026-01-13  
DRAWN BY  
RYT  
CHECKED BY  
HHO  
SCALE  
1:2000

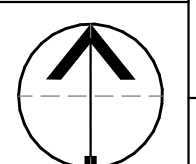

DRAWING NO. SPA813 REV. 4

This drawing, as an instrument of service, is provided by and is the property of Turner Fleischer Architects Inc. The contractor must verify and accept responsibility for all dimensions and conditions on site and must notify Turner Fleischer Architects Inc. of any variations from the supplied information. The drawing is not to be scaled. The architect is not responsible for the accuracy of survey, structural, mechanical, electrical, etc. information shown on this drawing. Refer to the appropriate consultant drawings before proceeding with the work. Contractor must conform to all applicable codes and requirements of applicable building jurisdiction. The contractor working from drawings not specifically marked "for Contractor" must assume full responsibility and bear costs for any corrections or damages resulting from his work.

### SHADOW STUDY LEGEND

-  EXISTING SHADOWS
-  PROPOSED BUILDING  
28 STOREYS
-  PUBLIC SPACES
-  NET NEW SHADOWS BY  
PROPOSED DEVELOPMENT
-  PROPOSED SHADOW  
OUTLINE
-  AS-OF-RIGHT SHADOW  
OUTLINE
-  PROPOSED MASTER PLAN  
SHADOW OUTLINE

Assuming Site is Flat

### SCALE BAR

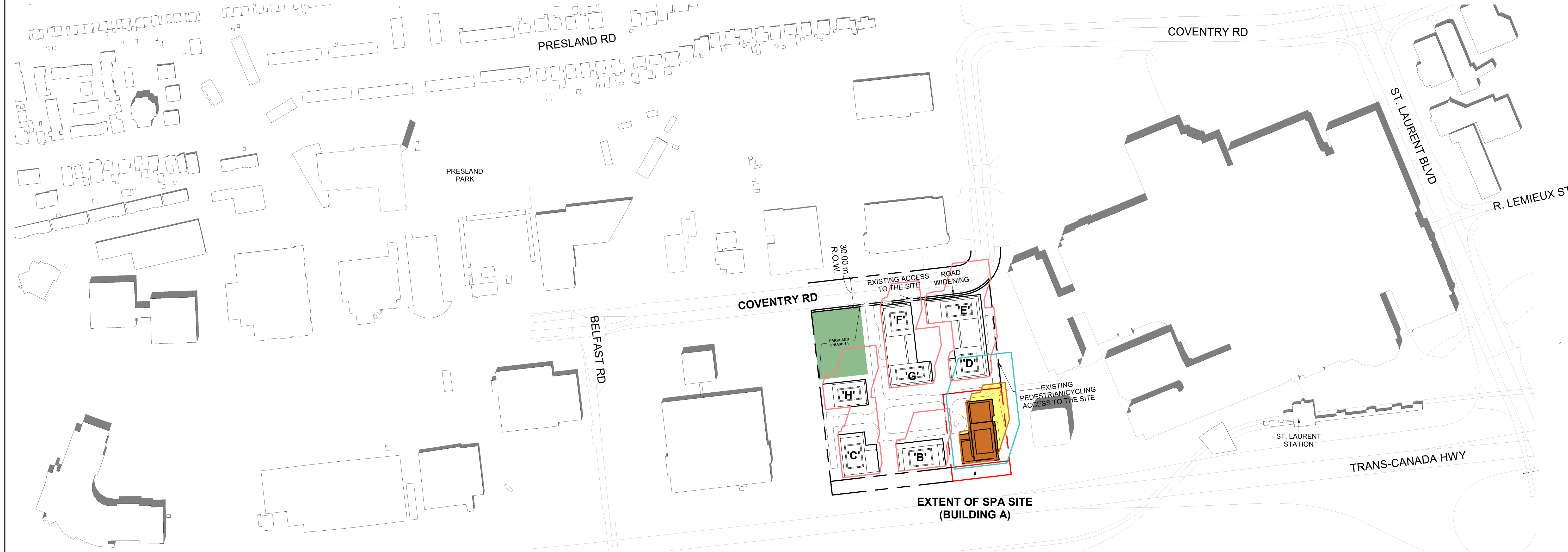
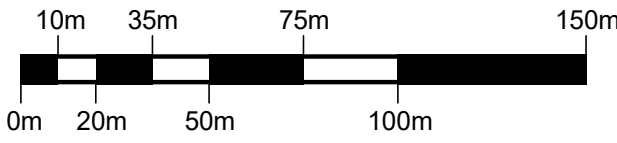

1 JUNE 21 SHADOW STUDIES 02:00PM  
SPAB14 1:2000

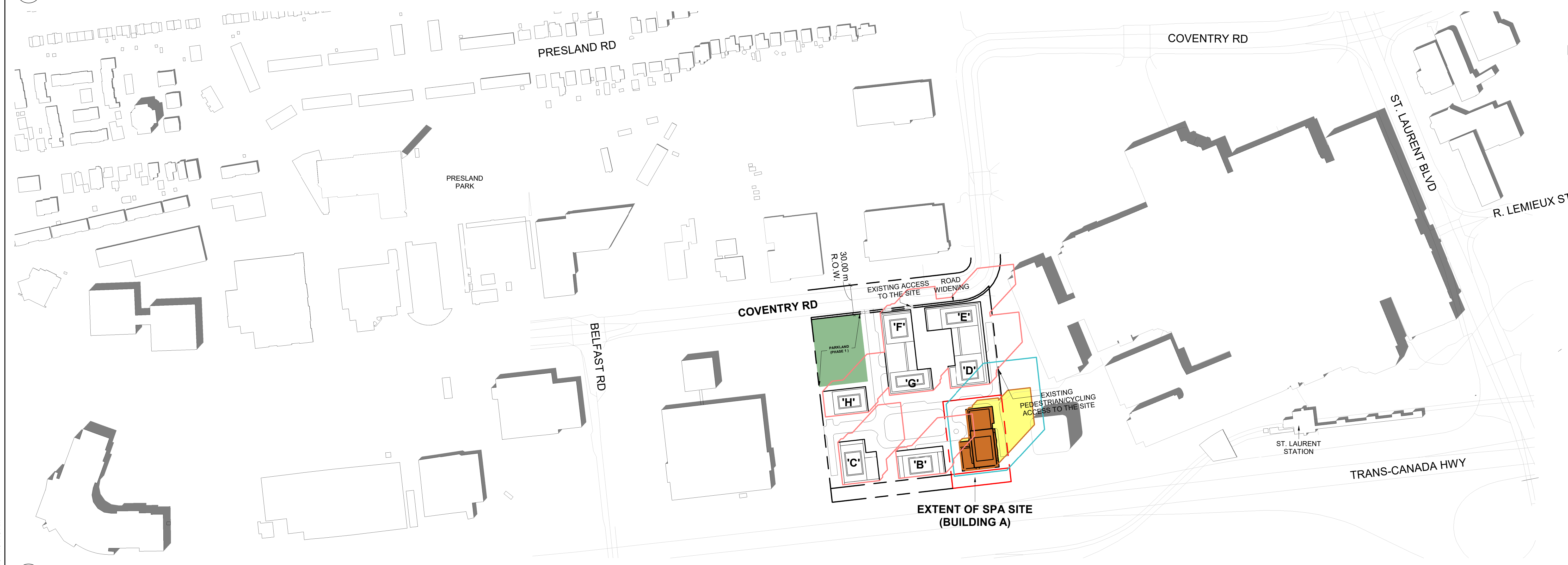

2 JUNE 21 SHADOW STUDIES 03:00PM  
SPAB14 1:2000

4	2026-01-13	ISSUED FOR SITE PLAN APPROVAL #3	HHO
3	2025-04-04	ISSUED FOR SITE PLAN APPROVAL #2	AYU
2	2024-11-01	ISSUED FOR SITE PLAN APPROVAL	AYU
1	2024-01-30	ISSUED FOR PRE-CONSTRUCTION	AYU
#	DATE	DESCRIPTION	BY



PROJECT  
**PROPOSED 28-STOREY RESIDENTIAL BUILDING**  
PHASE 1 - 500 COVENTRY ROAD, OTTAWA, ON.  
FILE #D07-12-24-0151  
PLAN #19272

### JUNE SHADOW STUDIES

PROJECT NO.  
18.050 P01  
PROJECT DATE  
2026-01-13  
DRAWN BY  
RYT  
CHECKED BY  
HHO  
SCALE  
1:2000

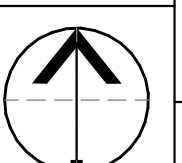

DRAWING NO. SPA814 REV 4

This drawing, as an instrument of service, is provided by and is the property of Turner Fleischer Architects Inc. The contractor must verify and accept responsibility for all dimensions and conditions on site and must notify Turner Fleischer Architects Inc. of any variations from the supplied information. The drawing is not to be scaled. The architect is not responsible for the accuracy of survey, structural, mechanical, electrical, etc. information shown on this drawing. Refer to the appropriate consultant drawings before proceeding with the work. Contractor must conform to all applicable codes and requirements of applicable building jurisdiction. The contractor working from drawings not specifically marked "for Contractor" must assume full responsibility and bear costs for any corrections or damages resulting from his work.

### SHADOW STUDY LEGEND

- EXISTING SHADOWS
- PROPOSED BUILDING  
28 STOREYS
- PUBLIC SPACES
- NET NEW SHADOWS BY  
PROPOSED DEVELOPMENT
- PROPOSED SHADOW  
OUTLINE
- AS-OF-RIGHT SHADOW  
OUTLINE
- PROPOSED MASTER PLAN  
SHADOW OUTLINE

Assuming Site is Flat

### SCALE BAR

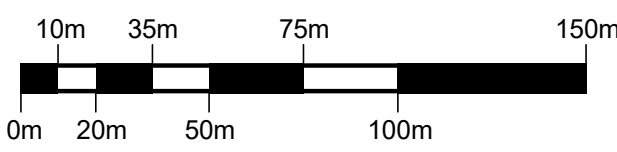

1 JUNE 21 SHADOW STUDIES 04:00PM  
SPA815 1:2000

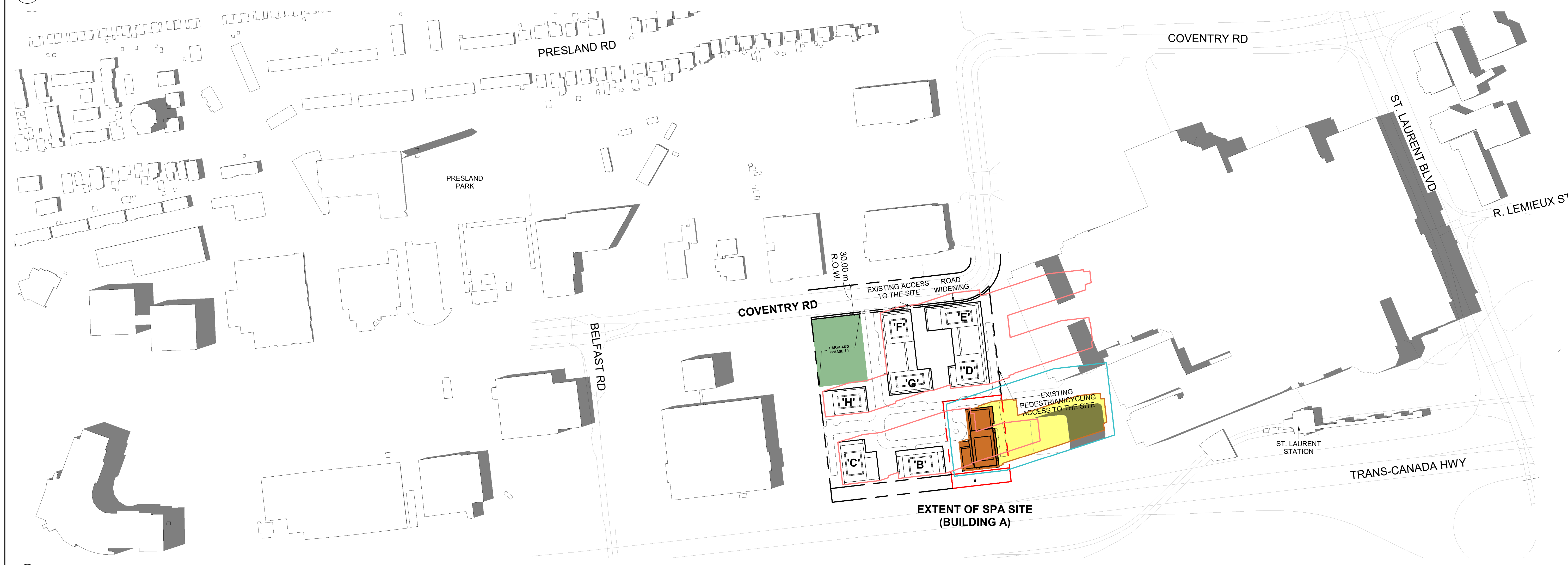

2 JUNE 21 SHADOW STUDIES 05:00PM  
SPA815 1:2000

4	2026-01-13	ISSUED FOR SITE PLAN APPROVAL #3	HHO
3	2025-04-04	ISSUED FOR SITE PLAN APPROVAL #2	AYU
2	2024-11-01	ISSUED FOR SITE PLAN APPROVAL	AYU
1	2024-01-30	ISSUED FOR PRE-CONSTRUCTION	AYU
#	DATE	DESCRIPTION	BY



PROJECT  
**PROPOSED 28-STOREY RESIDENTIAL BUILDING**  
PHASE 1 - 500 COVENTRY ROAD, OTTAWA, ON.  
FILE #D07-12-24-0151  
PLAN #19272

DRAWING  
**JUNE SHADOW STUDIES**

PROJECT NO.  
18.050 P01  
PROJECT DATE  
2026-01-13  
DRAWN BY  
RYT  
CHECKED BY  
HHO  
SCALE  
1:2000

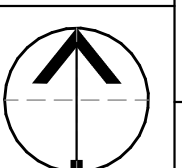

DRAWING NO. SPA815 REV. 4

This drawing, as an instrument of service, is provided by and is the property of Turner Fleischer Architects Inc. The contractor must verify and accept responsibility for all dimensions and conditions on site and must notify Turner Fleischer Architects Inc. of any variations from the supplied information. This drawing is not to be scaled. The architect is not responsible for the accuracy of survey, structural, mechanical, electrical, etc. information shown on this drawing. Refer to the appropriate consultant drawings before proceeding with the work. Contractor must conform to all applicable codes and requirements of applicable building jurisdiction. The contractor working from drawings not specifically marked "for Contractor" must assume full responsibility and bear costs for any corrections or damages resulting from his work.

### SHADOW STUDY LEGEND

- EXISTING SHADOWS
- PROPOSED BUILDING  
28 STOREYS
- PUBLIC SPACES
- NET NEW SHADOWS BY  
PROPOSED DEVELOPMENT
- PROPOSED SHADOW  
OUTLINE
- AS-OF-RIGHT SHADOW  
OUTLINE
- PROPOSED MASTER PLAN  
SHADOW OUTLINE

Assuming Site is Flat

### SCALE BAR

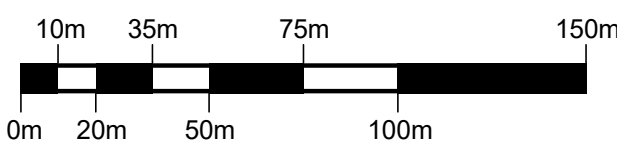

1 JUNE 21 SHADOW STUDIES 06:00PM  
SPA816 1:2000



2 JUNE 21 SHADOW STUDIES 07:00PM  
SPA816 1:2000

4	2026-01-13	ISSUED FOR SITE PLAN APPROVAL #3	HHO
3	2025-04-04	ISSUED FOR SITE PLAN APPROVAL #2	AYU
2	2024-11-01	ISSUED FOR SITE PLAN APPROVAL	AYU
1	2024-01-30	ISSUED FOR PRE-CONSTRUCTION	AYU
#	DATE	DESCRIPTION	BY



PROJECT  
**PROPOSED 28-STOREY RESIDENTIAL BUILDING**  
PHASE 1 - 500 COVENTRY ROAD, OTTAWA, ON.  
FILE #D07-12-24-0151  
PLAN #19272

DRAWING  
**JUNE SHADOW STUDIES**

PROJECT NO.  
18.050 P01  
PROJECT DATE  
2026-01-13  
DRAWN BY  
RYT  
CHECKED BY  
HHO  
SCALE  
1:2000

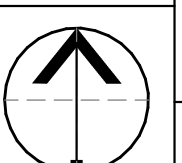

DRAWING NO. SPA816 REV. 4

2026-01-13 11:02:12 AM



1 JUNE 21 SHADOW STUDIES 08:00PM  
SPA817 1:2000

This drawing, as an instrument of service, is provided by and is the property of Turner Fleischer Architects Inc. The contractor must verify and accept responsibility for all dimensions and conditions on site and must notify Turner Fleischer Architects Inc. of any variations from the supplied information. This drawing is not to be scaled. The architect is not responsible for the accuracy of survey, structural, mechanical, electrical, etc. information shown on this drawing. Refer to the appropriate consultant's drawings before proceeding with the work. Contractor must conform to all applicable codes and requirements of all applicable laws and regulations. The contractor working from drawings not specifically marked "for Contractor" must assume full responsibility and bear costs for any corrections or damages resulting from his work.

- ### SHADOW STUDY LEGEND
- EXISTING SHADOWS
  - PROPOSED BUILDING  
28 STOREYS
  - PUBLIC SPACES
  - NET NEW SHADOWS BY  
PROPOSED DEVELOPMENT
  - PROPOSED SHADOW  
OUTLINE
  - AS-OF-RIGHT SHADOW  
OUTLINE
  - PROPOSED MASTER PLAN  
SHADOW OUTLINE

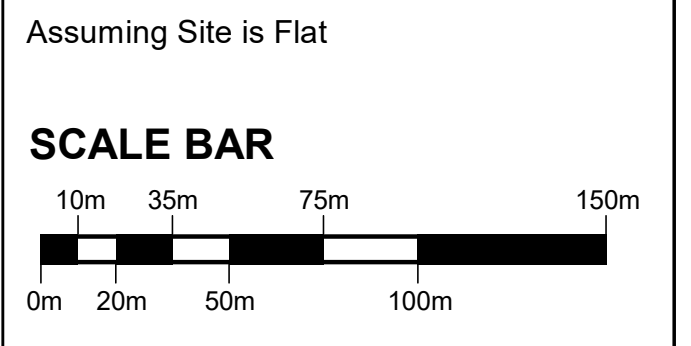

4	2026-01-13	ISSUED FOR SITE PLAN APPROVAL #3	HHO
3	2025-04-04	ISSUED FOR SITE PLAN APPROVAL #2	AYU
2	2024-11-01	ISSUED FOR SITE PLAN APPROVAL	AYU
1	2024-01-30	ISSUED FOR PRE-CONSTRUCTION	AYU
#	DATE	DESCRIPTION	BY



PROJECT  
**PROPOSED 28-STOREY RESIDENTIAL BUILDING**

PHASE 1 - 500 COVENTRY ROAD, OTTAWA, ON.  
FILE #D07-12-24-0151  
PLAN #19272

### JUNE SHADOW STUDIES

PROJECT NO.  
18.050 P01  
PROJECT DATE  
2026-01-13  
DRAWN BY  
RYT  
CHECKED BY  
HHO  
SCALE  
1:2000

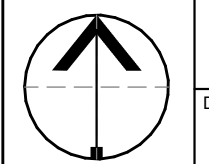

DRAWING NO. SPA817 REV. 4

This drawing, as an instrument of service, is provided by and is the property of Turner Fleischer Architects Inc. The contractor must verify and accept responsibility for all dimensions and conditions on site and must notify Turner Fleischer Architects Inc. of any variations from the supplied information. This drawing is not to be scaled. The architect is not responsible for the accuracy of survey, structural, mechanical, electrical, etc. information shown on this drawing. Refer to the appropriate consultant drawings before proceeding with the work. Contractor must conform to all applicable codes and requirements of applicable building jurisdiction. The contractor working from drawings not specifically marked "for Contractor" must assume full responsibility and bear costs for any corrections or damages resulting from his work.

### SHADOW STUDY LEGEND

- EXISTING SHADOWS
- PROPOSED BUILDING  
28 STOREYS
- PUBLIC SPACES
- NET NEW SHADOWS BY  
PROPOSED DEVELOPMENT
- PROPOSED SHADOW  
OUTLINE
- AS-OF-RIGHT SHADOW  
OUTLINE
- PROPOSED MASTER PLAN  
SHADOW OUTLINE

Assuming Site is Flat

### SCALE BAR

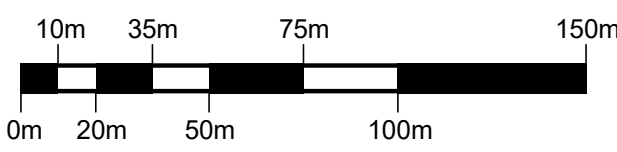

1 SEPTEMBER 21 SHADOW STUDIES 08:00AM  
1:2000



2 SEPTEMBER 21 SHADOW STUDIES 09:00AM  
1:2000

4	2026-01-13	ISSUED FOR SITE PLAN APPROVAL #3	HHO
3	2025-04-04	ISSUED FOR SITE PLAN APPROVAL #2	AYU
2	2024-11-01	ISSUED FOR SITE PLAN APPROVAL	AYU
1	2024-01-30	ISSUED FOR PRE-CONSTRUCTION	AYU
#	DATE	DESCRIPTION	BY



PROJECT  
**PROPOSED 28-STOREY RESIDENTIAL BUILDING**  
PHASE 1 - 500 COVENTRY ROAD, OTTAWA, ON.  
FILE #D07-12-24-0151  
PLAN #19272

### SEPTEMBER SHADOW STUDIES

PROJECT NO.  
18.050 P01  
PROJECT DATE  
2026-01-13  
DRAWN BY  
RYT  
CHECKED BY  
HHO  
SCALE  
1:2000

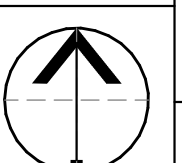

DRAWING NO. SPA818 REV. 4

2026-01-13 11:02:31 AM

This drawing, as an instrument of service, is provided by and is the property of Turner Fleischer Architects Inc. The contractor must verify and accept responsibility for all dimensions and conditions on site and must notify Turner Fleischer Architects Inc. of any variations from the supplied information. This drawing is not to be scaled. The architect is not responsible for the accuracy of survey, structural, mechanical, electrical, etc. information shown on this drawing. Refer to the appropriate consultant drawings before proceeding with the work. Contractor must conform to all applicable codes and requirements of applicable building jurisdiction. The contractor working from drawings not specifically marked "for Contractor" must assume full responsibility and bear costs for any corrections or damages resulting from his work.

### SHADOW STUDY LEGEND

- EXISTING SHADOWS
- PROPOSED BUILDING  
28 STOREYS
- PUBLIC SPACES
- NET NEW SHADOWS BY  
PROPOSED DEVELOPMENT
- PROPOSED SHADOW  
OUTLINE
- AS-OF-RIGHT SHADOW  
OUTLINE
- PROPOSED MASTER PLAN  
SHADOW OUTLINE

Assuming Site is Flat

### SCALE BAR

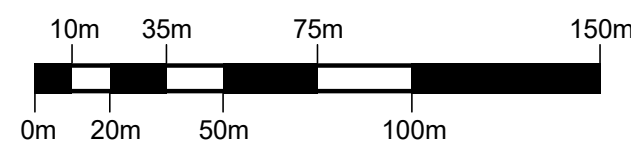

1 SEPTEMBER 21 SHADOW STUDIES 10:00AM  
SPA819 1:2000



2 SEPTEMBER 21 SHADOW STUDIES 11:00AM  
SPA819 1:2000

4	2026-01-13	ISSUED FOR SITE PLAN APPROVAL #3	HHO
3	2025-04-04	ISSUED FOR SITE PLAN APPROVAL #2	AYU
2	2024-11-01	ISSUED FOR SITE PLAN APPROVAL	AYU
1	2024-01-30	ISSUED FOR PRE-CONSTRUCTION	AYU
#	DATE	DESCRIPTION	BY



PROJECT  
**PROPOSED 28-STOREY RESIDENTIAL BUILDING**  
PHASE 1 - 500 COVENTRY ROAD, OTTAWA, ON.  
FILE #D07-12-24-0151  
PLAN #19272

### SEPTEMBER SHADOW STUDIES

PROJECT NO.  
18.050 PD1  
PROJECT DATE  
2026-01-13  
DRAWN BY  
RYT  
CHECKED BY  
HHO  
SCALE  
1:2000

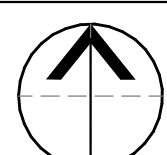

DRAWING NO. SPA819 REV. 4

2026-01-13 11:02:43 AM

This drawing, as an instrument of service, is provided by and is the property of Turner Fleischer Architects Inc. The contractor must verify and accept responsibility for all dimensions and conditions on site and must notify Turner Fleischer Architects Inc. of any variations from the supplied information. This drawing is not to be scaled. The architect is not responsible for the accuracy of survey, structural, mechanical, electrical, etc. information shown on this drawing. Refer to the appropriate consultant's drawings before proceeding with the work. Contractor must conform to all applicable codes and requirements of applicable building jurisdiction. The contractor working from drawings not specifically marked "for Contractor" must assume full responsibility and bear costs for any corrections or damages resulting from his work.

### SHADOW STUDY LEGEND

-  EXISTING SHADOWS
-  PROPOSED BUILDING  
28 STOREYS
-  PUBLIC SPACES
-  NET NEW SHADOWS BY  
PROPOSED DEVELOPMENT
-  PROPOSED SHADOW  
OUTLINE
-  AS-OF-RIGHT SHADOW  
OUTLINE
-  PROPOSED MASTER PLAN  
SHADOW OUTLINE

Assuming Site is Flat

### SCALE BAR

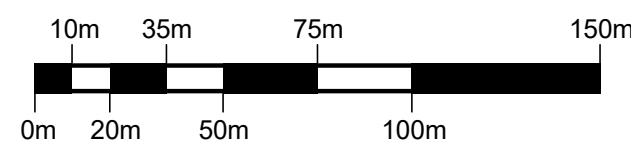

1 SEPTEMBER 21 SHADOW STUDIES 12:00PM  
SPA820 1:2000



2 SEPTEMBER 21 SHADOW STUDIES 01:00PM  
SPA820 1:2000

4	2026-01-13	ISSUED FOR SITE PLAN APPROVAL #3	HHO
3	2025-04-04	ISSUED FOR SITE PLAN APPROVAL #2	AYU
2	2024-11-01	ISSUED FOR SITE PLAN APPROVAL	AYU
1	2024-01-30	ISSUED FOR PRE-CONSTRUCTION	AYU
#	DATE	DESCRIPTION	BY



PROJECT  
**PROPOSED 28-STOREY RESIDENTIAL BUILDING**  
PHASE 1 - 500 COVENTRY ROAD, OTTAWA, ON.  
FILE #D07-12-24-0151  
PLAN #19272

### SEPTEMBER SHADOW STUDIES

PROJECT NO.  
18.050 P01  
PROJECT DATE  
2026-01-13  
DRAWN BY  
RYT  
CHECKED BY  
HHO  
SCALE  
1:2000

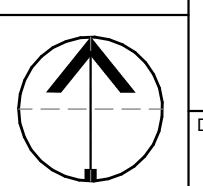

DRAWING NO. SPA820 REV. 4

2026-01-13 11:02:55 AM

This drawing is an instrument of service, it is provided by and is the property of Turner Fleischer Architects Inc. The contractor must verify and accept responsibility for all dimensions and conditions on site and must notify Turner Fleischer Architects Inc. of any variations from the supplied information. This drawing is not to be scaled. The architect is not responsible for the accuracy of survey, structural, mechanical, electrical, etc. information shown on this drawing. Refer to the appropriate consultant drawings before proceeding with the work. Contractor must conform to all applicable codes and requirements of applicable building jurisdiction. The contractor working from drawings not specifically marked 'for Contractor' must assume full responsibility and bear costs for any corrections or damages resulting from his work.

### SHADOW STUDY LEGEND

-  EXISTING SHADOWS
-  PROPOSED BUILDING  
28 STOREYS
-  PUBLIC SPACES
-  NET NEW SHADOWS BY  
PROPOSED DEVELOPMENT
-  PROPOSED SHADOW  
OUTLINE
-  AS-OF-RIGHT SHADOW  
OUTLINE
-  PROPOSED MASTER PLAN  
SHADOW OUTLINE

Assuming Site is Flat

### SCALE BAR

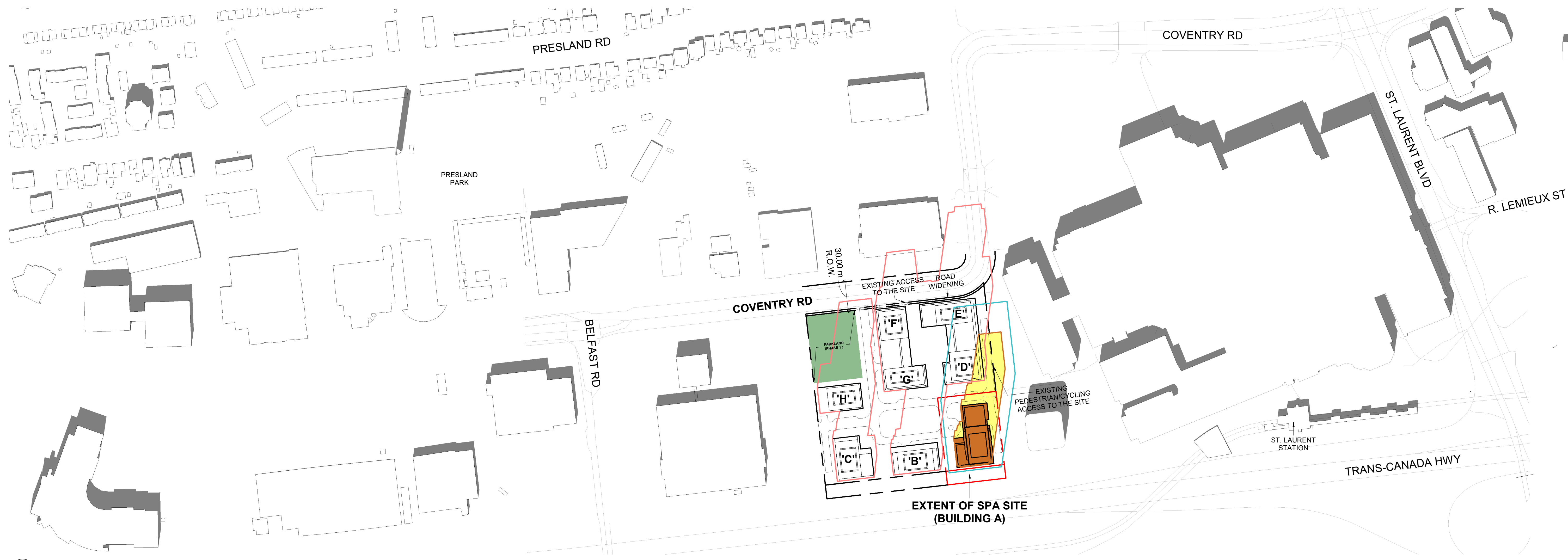
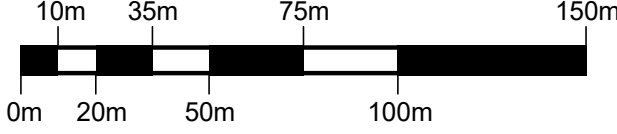

1 SEPTEMBER 21 SHADOW STUDIES 02:00PM  
SPA821 1:2000

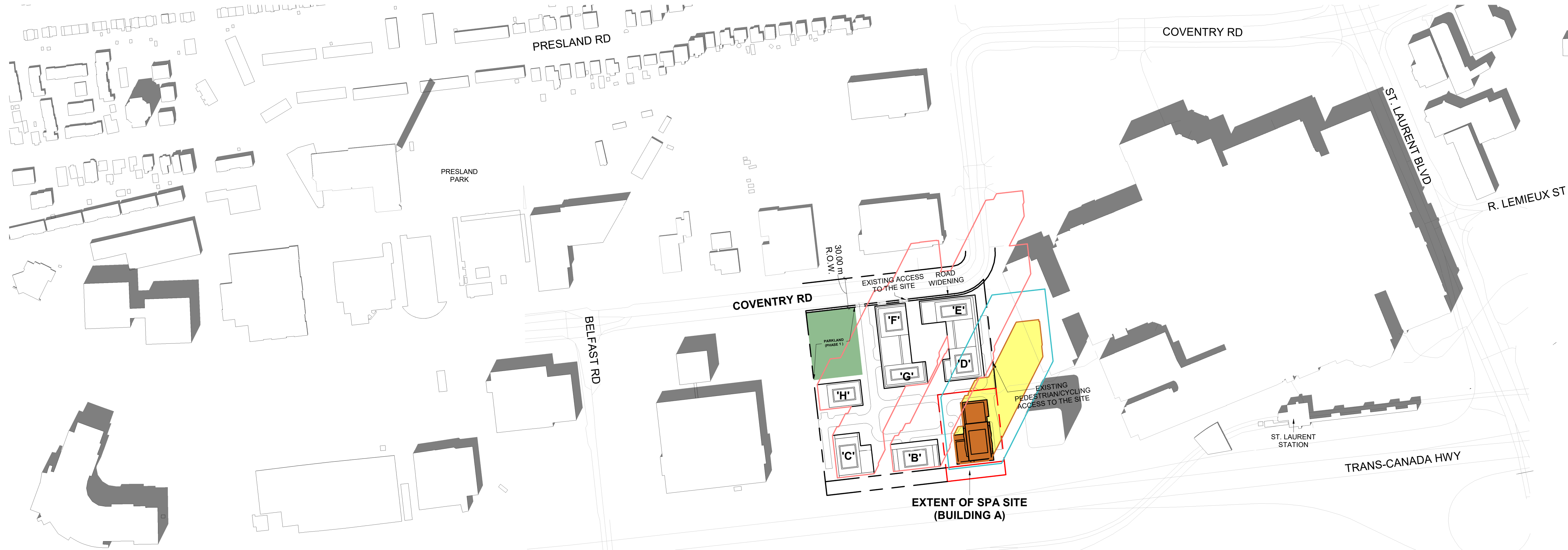

2 SEPTEMBER 21 SHADOW STUDIES 03:00PM  
SPA821 1:2000

4	2026-01-13	ISSUED FOR SITE PLAN APPROVAL #3	HHO
3	2025-04-04	ISSUED FOR SITE PLAN APPROVAL #2	AYU
2	2024-11-01	ISSUED FOR SITE PLAN APPROVAL	AYU
1	2024-01-30	ISSUED FOR PRE-CONSTRUCTION	AYU
#	DATE	DESCRIPTION	BY



PROJECT  
**PROPOSED 28-STOREY RESIDENTIAL BUILDING**  
PHASE 1 - 500 COVENTRY ROAD, OTTAWA, ON.  
FILE #D07-12-24-0151  
PLAN #19272

### SEPTEMBER SHADOW STUDIES

PROJECT NO.  
18.050 P01  
PROJECT DATE  
2026-01-13  
DRAWN BY  
RYT  
CHECKED BY  
HHO  
SCALE  
1:2000



DRAWING NO. SPA821 REV. 4

This drawing, as an instrument of service, is provided by and is the property of Turner Fleischer Architects Inc. The contractor must verify and accept responsibility for all dimensions and conditions on site and must notify Turner Fleischer Architects Inc. of any variations from the supplied information. This drawing is not to be scaled. The architect is not responsible for the accuracy of survey, structural, mechanical, electrical, etc. information shown on this drawing. Refer to the appropriate consultant drawings before proceeding with the work. Contractor must conform to all applicable codes and requirements of applicable building jurisdiction. The contractor working from drawings not specifically marked "for Contractor" must assume full responsibility and bear costs for any corrections or damages resulting from his work.

### SHADOW STUDY LEGEND

- EXISTING SHADOWS
- PROPOSED BUILDING  
28 STOREYS
- PUBLIC SPACES
- NET NEW SHADOWS BY  
PROPOSED DEVELOPMENT
- PROPOSED SHADOW  
OUTLINE
- AS-OF-RIGHT SHADOW  
OUTLINE
- PROPOSED MASTER PLAN  
SHADOW OUTLINE

Assuming Site is Flat

### SCALE BAR

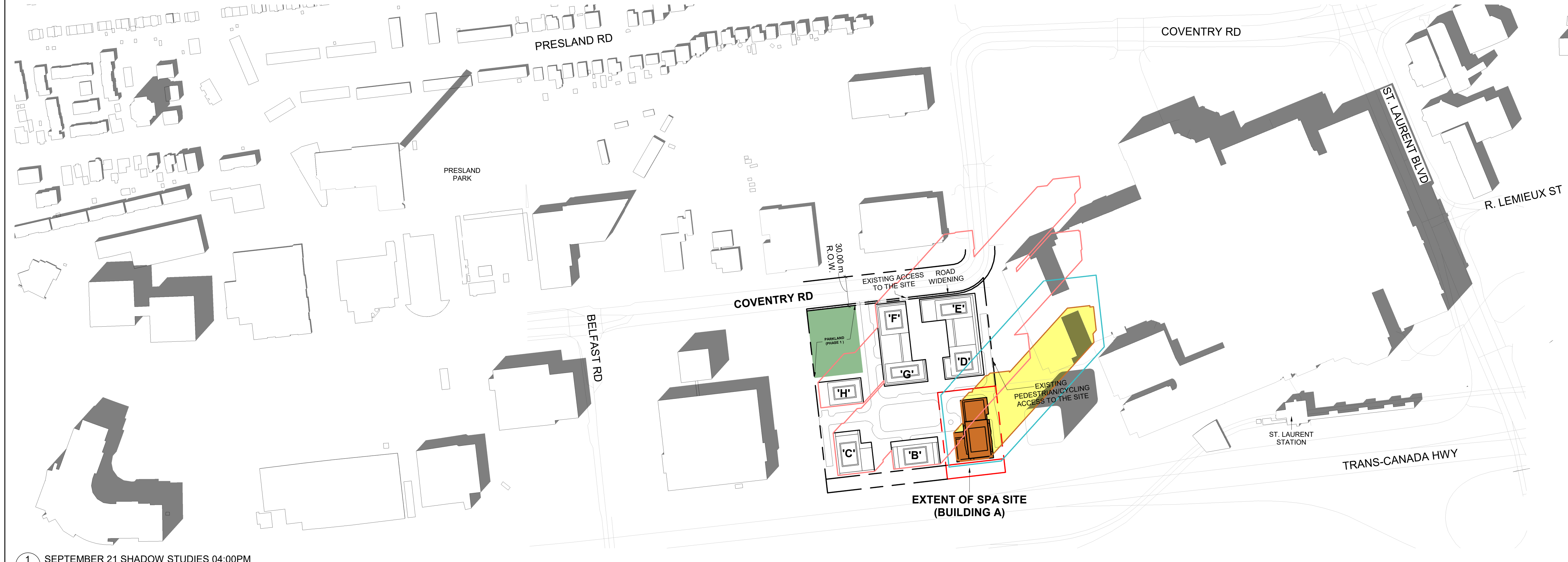
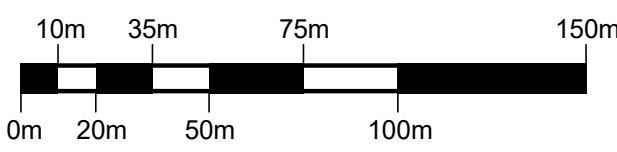

1 SEPTEMBER 21 SHADOW STUDIES 04:00PM  
SPA822 1:2000



2 SEPTEMBER 21 SHADOW STUDIES 05:00PM  
SPA822 1:2000

4	2026-01-13	ISSUED FOR SITE PLAN APPROVAL #3	HHO
3	2025-04-04	ISSUED FOR SITE PLAN APPROVAL #2	AYU
2	2024-11-01	ISSUED FOR SITE PLAN APPROVAL	AYU
1	2024-01-30	ISSUED FOR PRE-CONSTRUCTION	AYU
#	DATE	DESCRIPTION	BY



PROJECT  
**PROPOSED 28-STOREY RESIDENTIAL BUILDING**  
PHASE 1 - 500 COVENTRY ROAD, OTTAWA, ON.  
FILE #D07-12-24-0151  
PLAN #19272

DRAWING  
**SEPTEMBER SHADOW STUDIES**

PROJECT NO.  
18.050 P01  
PROJECT DATE  
2026-01-13  
DRAWN BY  
RYT  
CHECKED BY  
HHO  
SCALE  
1:2000

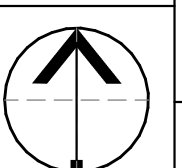

DRAWING NO. SPA822 REV. 4

2026-01-13 11:03:19 AM



This drawing, as an instrument of service, is provided by and is the property of Turner Fleischer Architects Inc. The contractor must verify and accept responsibility for all dimensions and conditions on site and must notify Turner Fleischer Architects Inc. of any variations from the supplied information. This drawing is not to be scaled. The architect is not responsible for the accuracy of survey, structural, mechanical, electrical, etc. information shown on this drawing. Refer to the appropriate consultant's drawings before proceeding with the work. Contractor must conform to all applicable codes and requirements of all applicable building jurisdictions. The contractor working from drawings not specifically marked "for Contractor" must assume full responsibility and bear costs for any corrections or damages resulting from his work.

- ### SHADOW STUDY LEGEND
- EXISTING SHADOWS
  - PROPOSED BUILDING  
28 STOREYS
  - PUBLIC SPACES
  - NET NEW SHADOWS BY PROPOSED DEVELOPMENT
  - PROPOSED SHADOW OUTLINE
  - AS-OF-RIGHT SHADOW OUTLINE
  - PROPOSED MASTER PLAN SHADOW OUTLINE

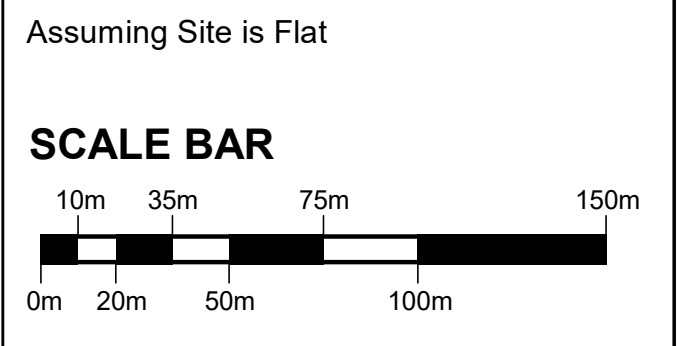

1 SEPTEMBER 21 SHADOW STUDIES 06:00PM  
 SPA823 1 : 2000

4	2026-01-13	ISSUED FOR SITE PLAN APPROVAL #3	HHO
3	2025-04-04	ISSUED FOR SITE PLAN APPROVAL #2	AYU
2	2024-11-01	ISSUED FOR SITE PLAN APPROVAL	AYU
1	2024-01-30	ISSUED FOR PRE-CONSTRUCTION	AYU
#	DATE	DESCRIPTION	BY



PROJECT  
**PROPOSED 28-STOREY RESIDENTIAL BUILDING**  
 PHASE 1 - 500 COVENTRY ROAD, OTTAWA, ON.  
 FILE #D07-12-24-0151  
 PLAN #19272

DRAWING  
**SEPTEMBER SHADOW STUDIES**

PROJECT NO.  
18.050 P01  
 PROJECT DATE  
2026-01-13  
 DRAWN BY  
RYT  
 CHECKED BY  
HHO  
 SCALE  
1:2000

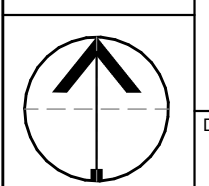

DRAWING NO. SPA823 REV. 4

This drawing, as an instrument of service, is provided by and is the property of Turner Fleischer Architects Inc. The contractor must verify and accept responsibility for all dimensions and conditions on site and must notify Turner Fleischer Architects Inc. of any variations from the supplied information. This drawing is not to be scaled. The architect is not responsible for the accuracy of survey, structural, mechanical, electrical, etc. information shown on this drawing. Refer to the appropriate consultant's drawings before proceeding with the work. Contractor must conform to all applicable codes and requirements of all relevant governing jurisdictions. The contractor working from drawings not specifically marked "for Contractor" must assume full responsibility and bear costs for any corrections or damages resulting from his work.

### SHADOW STUDY LEGEND

- EXISTING SHADOWS
- PROPOSED BUILDING  
28 STOREYS
- PUBLIC SPACES
- NET NEW SHADOWS BY  
PROPOSED DEVELOPMENT
- PROPOSED SHADOW  
OUTLINE
- AS-OF-RIGHT SHADOW  
OUTLINE
- PROPOSED MASTER PLAN  
SHADOW OUTLINE

Assuming Site is Flat

### SCALE BAR

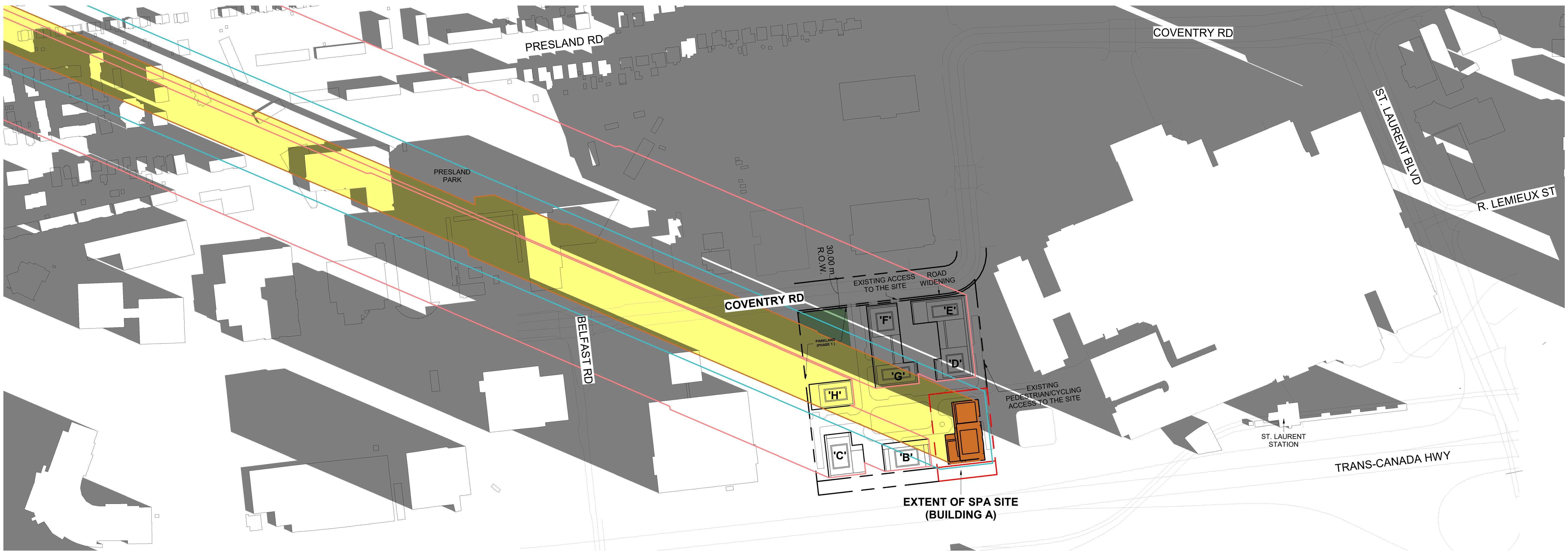

1 DECEMBER 21 SHADOW STUDIES 09:00AM  
SPAR24 1:2000

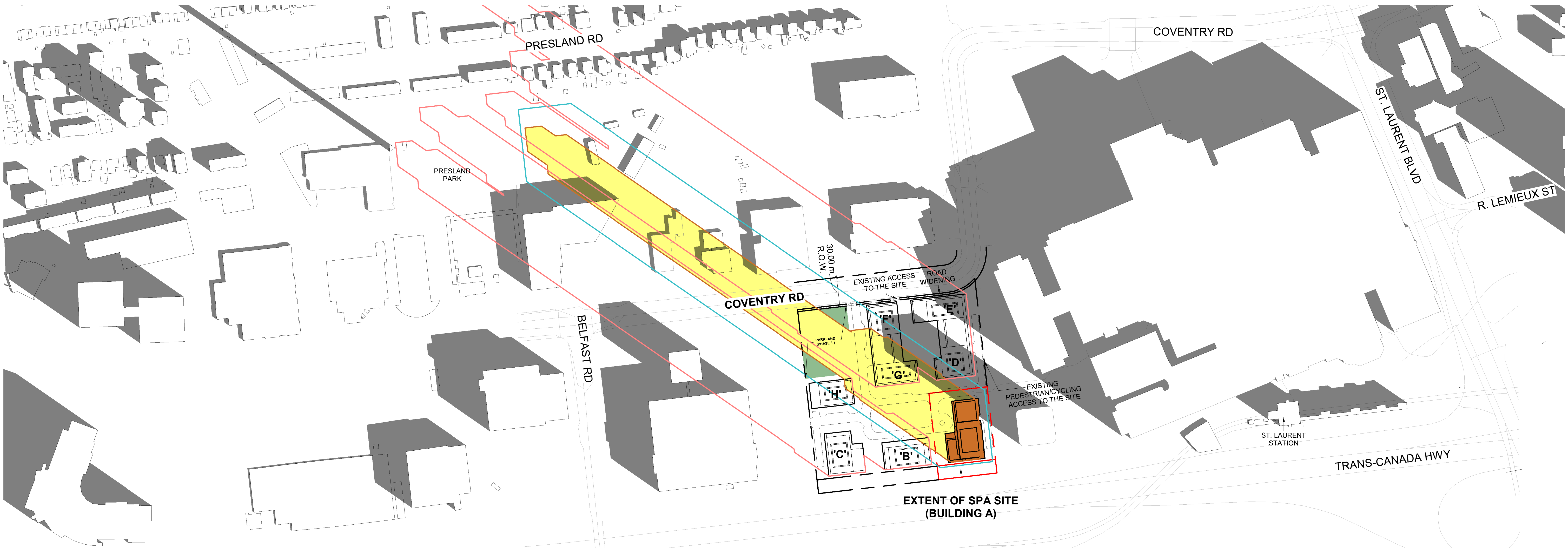

2 DECEMBER 21 SHADOW STUDIES 10:00AM  
SPAR24 1:2000

4	2026-01-13	ISSUED FOR SITE PLAN APPROVAL #3	HHO
3	2025-04-04	ISSUED FOR SITE PLAN APPROVAL #2	AYU
2	2024-11-01	ISSUED FOR SITE PLAN APPROVAL	AYU
1	2024-01-30	ISSUED FOR PRE-CONSTRUCTION	AYU
#	DATE	DESCRIPTION	BY



PROJECT  
**PROPOSED 28-STOREY RESIDENTIAL BUILDING**  
PHASE 1 - 500 COVENTRY ROAD, OTTAWA, ON.  
FILE #D07-12-24-0151  
PLAN #19272

### DECEMBER SHADOW STUDIES

PROJECT NO.  
18.050 P01  
PROJECT DATE  
2026-01-13  
DRAWN BY  
RYT  
CHECKED BY  
HHO  
SCALE  
1:2000

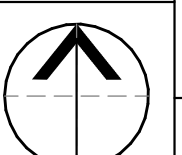
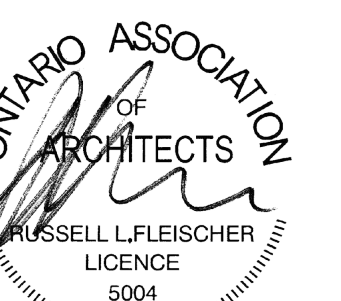

DRAWING NO. SPA824 REV. 4

This drawing, as an instrument of service, is provided by and is the property of Turner Fleischer Architects Inc. The contractor must verify and accept responsibility for all dimensions and conditions on site and must notify Turner Fleischer Architects Inc. of any variations from the supplied information. This drawing is not to be scaled. The architect is not responsible for the accuracy of survey, structural, mechanical, electrical, etc. information shown on this drawing. Refer to the appropriate consultant drawings before proceeding with the work. Contractor must conform to all applicable codes and requirements of all applicable laws and regulations. The contractor working from drawings not specifically marked "For Contractor" must assume full responsibility and bear costs for any corrections or damages resulting from his work.

### SHADOW STUDY LEGEND

-  EXISTING SHADOWS
-  PROPOSED BUILDING  
28 STOREYS
-  PUBLIC SPACES
-  NET NEW SHADOWS BY  
PROPOSED DEVELOPMENT
-  PROPOSED SHADOW  
OUTLINE
-  AS-OF-RIGHT SHADOW  
OUTLINE
-  PROPOSED MASTER PLAN  
SHADOW OUTLINE

Assuming Site is Flat

### SCALE BAR

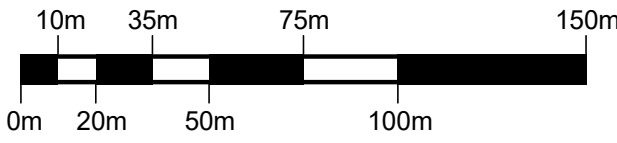

1 DECEMBER 21 SHADOW STUDIES 11:00AM  
1 : 2000



2 DECEMBER 21 SHADOW STUDIES 12:00PM  
1 : 2000

4	2026-01-13	ISSUED FOR SITE PLAN APPROVAL #3	HHO
3	2025-04-04	ISSUED FOR SITE PLAN APPROVAL #2	AYU
2	2024-11-01	ISSUED FOR SITE PLAN APPROVAL	AYU
1	2024-01-30	ISSUED FOR PRE-CONSTRUCTION	AYU
#	DATE	DESCRIPTION	BY



PROJECT  
**PROPOSED 28-STOREY RESIDENTIAL BUILDING**  
PHASE 1 - 500 COVENTRY ROAD, OTTAWA, ON.  
FILE #D07-12-24-0151  
PLAN #19272

### DECEMBER SHADOW STUDIES

PROJECT NO.  
18.050 PD1  
PROJECT DATE  
2026-01-13  
DRAWN BY  
RYT  
CHECKED BY  
HHO  
SCALE  
1:2000

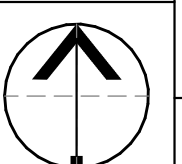

DRAWING NO. SPA825 REV. 4

2026-01-13 11:03:50 AM

This drawing, as an instrument of service, is provided by and is the property of Turner Fleischer Architects Inc. The contractor must verify and accept responsibility for all dimensions and conditions on site and must notify Turner Fleischer Architects Inc. of any variations from the supplied information. This drawing is not to be scaled. The architect is not responsible for the accuracy of survey, structural, mechanical, electrical, etc. information shown on this drawing. Refer to the appropriate consultant drawings before proceeding with the work. Contractor must conform to all applicable codes and requirements of applicable laws and regulations. The contractor working from drawings not specifically marked 'for Contractor' must assume full responsibility and bear costs for any corrections or damages resulting from his work.

### SHADOW STUDY LEGEND

- EXISTING SHADOWS
- PROPOSED BUILDING  
28 STOREYS
- PUBLIC SPACES
- NET NEW SHADOWS BY  
PROPOSED DEVELOPMENT
- PROPOSED SHADOW  
OUTLINE
- AS-OF-RIGHT SHADOW  
OUTLINE
- PROPOSED MASTER PLAN  
SHADOW OUTLINE

Assuming Site is Flat

### SCALE BAR

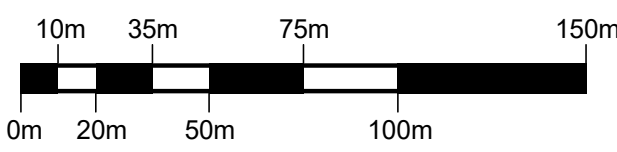

1 DECEMBER 21 SHADOW STUDIES 01:00PM  
1 : 2000



2 DECEMBER 21 SHADOW STUDIES 02:00PM  
1 : 2000

4	2026-01-13	ISSUED FOR SITE PLAN APPROVAL #3	HHO
3	2025-04-04	ISSUED FOR SITE PLAN APPROVAL #2	AYU
2	2024-11-01	ISSUED FOR SITE PLAN APPROVAL	AYU
1	2024-01-30	ISSUED FOR PRE-CONSTRUCTION	AYU
#	DATE	DESCRIPTION	BY



PROJECT  
**PROPOSED 28-STOREY RESIDENTIAL BUILDING**  
PHASE 1 - 500 COVENTRY ROAD, OTTAWA, ON.  
FILE #D07-12-24-0151  
PLAN #19272

### DECEMBER SHADOW STUDIES

PROJECT NO.  
18.050 P01  
PROJECT DATE  
2026-01-13  
DRAWN BY  
RYT  
CHECKED BY  
HHO  
SCALE  
1:2000

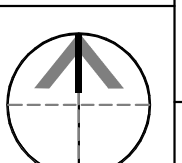

DRAWING NO. SPA826 REV. 4

2026-01-13 11:04:01 AM



This drawing, as an instrument of service, is provided by and is the property of Turner Fleischer Architects Inc. The contractor must verify and accept responsibility for all dimensions and conditions on site and must notify Turner Fleischer Architects Inc. of any variations from the supplied information. This drawing is not to be scaled. The architect is not responsible for the accuracy of survey, structural, mechanical, electrical, etc. information shown on this drawing. Refer to the appropriate consultant's drawings before proceeding with the work. Contractor must conform to all applicable codes and requirements of all applicable governing jurisdictions. The contractor working from drawings not specifically marked "for Contractor" must assume full responsibility and bear costs for any corrections or damages resulting from his work.

- SHADOW STUDY LEGEND**
- EXISTING SHADOWS
  - PROPOSED BUILDING 28 STOREYS
  - PUBLIC SPACES
  - NET NEW SHADOWS BY PROPOSED DEVELOPMENT
  - PROPOSED SHADOW OUTLINE
  - AS-OF-RIGHT SHADOW OUTLINE
  - PROPOSED MASTER PLAN SHADOW OUTLINE

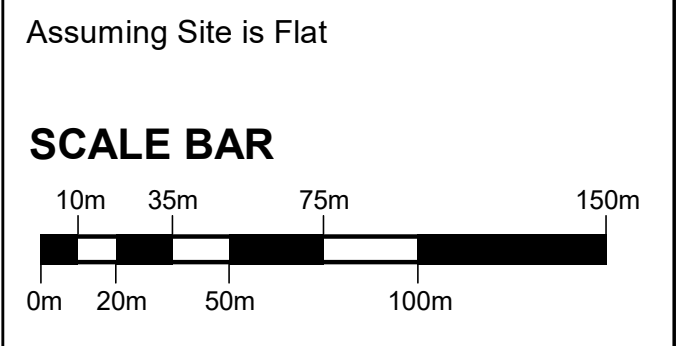

1 DECEMBER 21 SHADOW STUDIES 03:00PM  
 SPA827 1 : 2000

4	2026-01-13	ISSUED FOR SITE PLAN APPROVAL #3	HHO
3	2025-04-04	ISSUED FOR SITE PLAN APPROVAL #2	AYU
2	2024-11-01	ISSUED FOR SITE PLAN APPROVAL	AYU
1	2024-01-30	ISSUED FOR PRE-CONSTRUCTION	AYU
#	DATE	DESCRIPTION	BY



PROJECT  
**PROPOSED 28-STOREY RESIDENTIAL BUILDING**  
 PHASE 1 - 500 COVENTRY ROAD, OTTAWA, ON.  
 FILE #D07-12-24-0151  
 PLAN #19272

DRAWING  
**DECEMBER SHADOW STUDIES**

PROJECT NO. 18.050 P01	
PROJECT DATE 2026-01-13	
DRAWN BY RYT	
CHECKED BY HHO	
SCALE 1:2000	

DRAWING NO. <b>SPA827</b>	REV. <b>4</b>
------------------------------	------------------

2026-01-13 11:04:08 AM