

5510 BOUNDARY ROAD MODIFICATIONS CITY OF OTTAWA

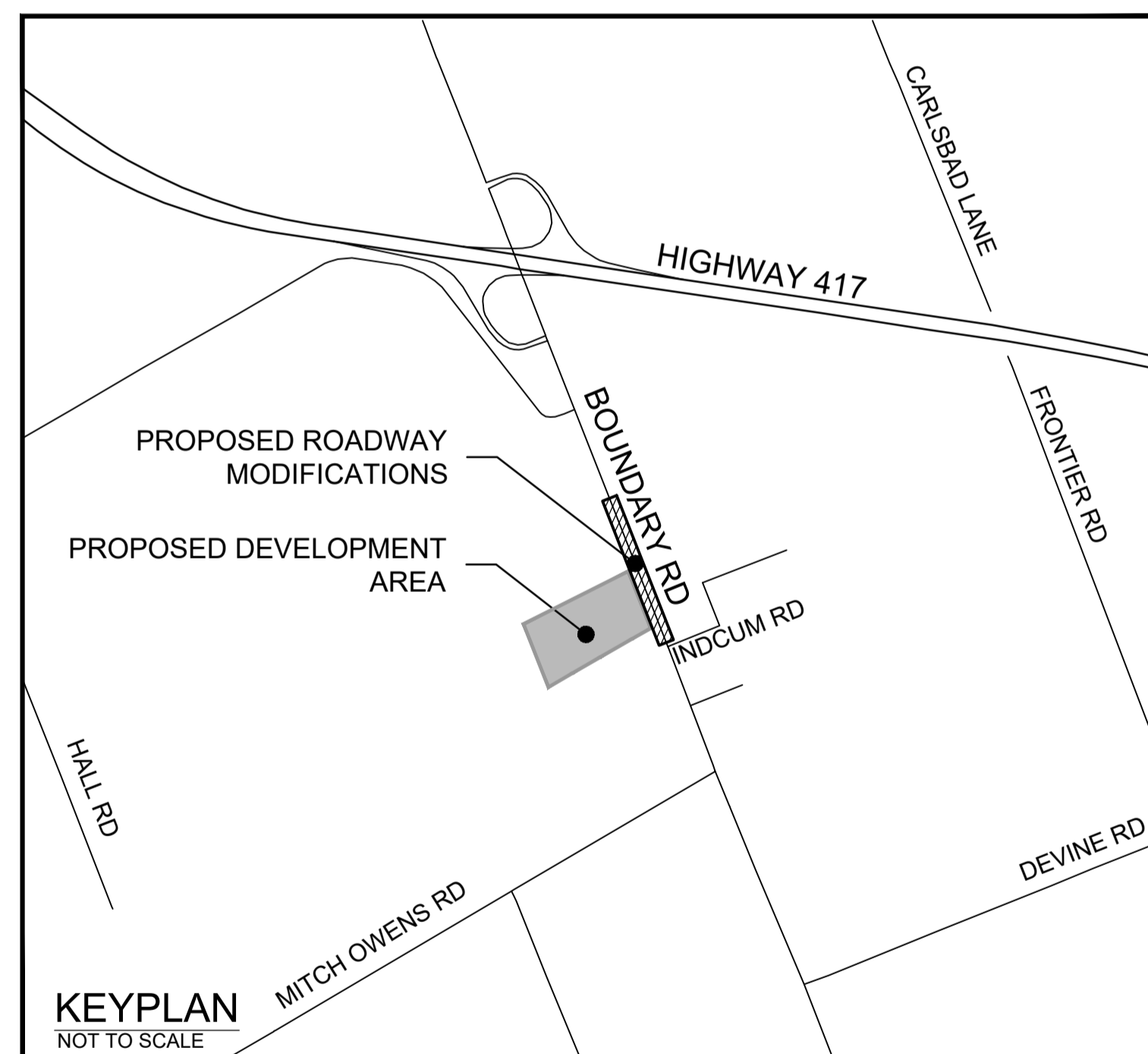

NOVATECH

Engineers, Planners & Landscape Architects
Suite 200, 240 Michael Cowpland Drive
Ottawa, Ontario, Canada K2M 1P6

Telephone (613) 254-9643
Facsimile (613) 254-5867
Website www.novatech-eng.com

INDEX

118168-RMA-LGD	LEGEND, NOTES AND DETAILS
118168-RMA-REM	REMOVALS AND ALIGNMENT
118168-RMA-GGL	GEOMETRY AND GENERAL LAYOUT
118168-RMA-PEL	PAVEMENT ELEVATIONS
118168-RMA-XPVMK	EXISTING PAVMENT MARKINGS AND SIGNAGE
118168-RMA-PVMK	PAVMENT MARKINGS AND SIGNAGE
118168-RMA-XSECO	TYPICAL CROSS SECTION OVERALL PLAN
118168-RMA-XSEC	TYPICAL CROSS SECTION SL1 TO SL4
118168-RMA-XSEC2	TYPICAL CROSS SECTION SL5 TO SL8
118168-RMA-XSEC3	TYPICAL CROSS SECTION SL9 TO SL12
118168-RMA-XSEC4	TYPICAL CROSS SECTION SL13 AND SL14

PROJECT No. 118168

ISSUED FOR CITY REVIEW

SYMBOLS

	EXISTING	PROPOSED
Concrete Curb		
Ditches and Creeks etc. over 0.6m wide		
Ditch		
Storm Sewer & Manhole		
San. Sewer & Manhole		
Water Main & Valve Chamber		
Gas Main & Valve		
Culvert		
Culvert with Headwalls		
Bell Telephone Conduit		
Hydro Conduit		
Hydro Street Lighting Conduit		
Single Catch Basin or Ditch Inlet		
Double Catch Basin		
Hydrant & Valve Box		
Bell Utility Pole & Anchor		
Hydro Utility Pole & Anchor		
Hydro Utility Pole		
Street Light		
Traffic Manhole		
Traffic Handhole		
*170" Traffic Controller Foundation		
Traffic Mast Arm Foundation		
Traffic Tubular Foundation		
Joint Use Pole Foundation		
Traffic Controller Foundation		
Detector Loop		
51 mm (2") Conduit, Conc. Encased		
76mm (3") Conduit, Conc. Encased		
102mm (4") Conduit, Conc. Encased		
127mm (5") Conduit, Conc. Encased		
Steel Hydro Tower		
BELL DUCT		
HYDRO DUCT		
HYDRO & BELL DUCT		
STREETLIGHT DUCT		
Deciduous Trees		
Coniferous Trees		
Bush Area		
Property Line		
Centre Line		
Fence & Gate		
Guide Rail		
Adjust Surface Iron Works		
Sidewalks		
Roadway, Laneways & Entrances		
Perforated Pipe Sub - Drain		

NOTE:
THE POSITION OF ALL POLE LINES, CONDUITS, WATERMANS, SEWERS AND OTHER UNDERGROUND AND OVERGROUND UTILITIES AND STRUCTURES IS NOT NECESSARILY SHOWN ON THE CONTRACT DRAWINGS, AND WHERE SHOWN, THE ACCURACY OF THE POSITION OF SUCH UTILITIES AND STRUCTURES IS NOT GUARANTEED. BEFORE STARTING WORK, DETERMINE THE EXACT LOCATION OF ALL SUCH UTILITIES AND STRUCTURES AND ASSUME ALL LIABILITY FOR DAMAGE TO THEM.

REFERENCE POINTS

	BENCH MARK
	CONCRETE MONUMENT
	ROCK BAR
	IRON TUBE OR PIPE
	IRON BAR
	WOOD STAKE
	2ND ORDER INTEGRATED SURVEY CONTROL MONUMENT
	3RD ORDER INTEGRATED SURVEY CONTROL MONUMENT
	CUT CROSS
	CUT VEE
	ROUND IRON BAR
	REINFORCING BAR
	STANDARD IRON BAR
	SHORT STANDARD IRON BAR
	WORK POINT

NOTES & SPECIFICATIONS

- GENERAL**
- ALL DIMENSIONS AND INVERTS MUST BE VERIFIED PRIOR TO CONSTRUCTION, IF THERE IS ANY DISCREPANCY THE CONTRACTOR IS TO NOTIFY THE ENGINEER PROMPTLY.
 - THE CONTRACTOR IS RESPONSIBLE FOR LOCATING AND PROTECTING ALL UTILITIES DURING CONSTRUCTION. GAS, HYDRO, TELEPHONE OR ANY OTHER UTILITY THAT MAY EXIST ON SITE OR WITHIN THE CONSTRUCTION LIMITS. STREETLIGHTS MUST BE LOCATED BY ITS OWN UTILITIES AND VERIFIED PRIOR TO CONSTRUCTION.
 - ALL DISTURBED AREAS TO BE RESTORED TO ORIGINAL CONDITION OR BETTER UNLESS OTHERWISE SPECIFIED.
 - CONTRACTOR IS RESPONSIBLE FOR ALL LAYOUT FOR CONSTRUCTION PURPOSES.
 - THE ORIGINAL TOPOGRAPHY, SERVICING AND SURVEY DATA SHOWN ON THIS PLAN ARE SUPPLIED FOR INFORMATION PURPOSES ONLY. IT SHALL BE THE RESPONSIBILITY OF THE CONTRACTOR TO VERIFY THE ACCURACY OF ALL INFORMATION OBTAINED FROM THESE PLANS.
 - REFER TO GEOTECHNICAL REPORT PREPARED BY EXP SERVICES INC. FOR SUBSURFACE CONDITIONS AND CONSTRUCTION RECOMMENDATIONS: (xxxxxxx)
 - BEFORE COMMENCING CONSTRUCTION PROVIDE PROOF OF COMPREHENSIVE ALL RISK AND OPERATIONAL LIABILITY INSURANCE INCLUDING BLASTING (ONLY IF REQUIRED), INSURANCE POLICY TO NAME THE OWNER, ENGINEER, CITY, AND PROVINCE OF ONTARIO AS CO-INSURED. AMOUNT OF INSURANCE TO BE SPECIFIED BY OWNERS AGENT.
 - DETERMINE THE EXACT LOCATION, SIZE, MATERIAL, AND ELEVATION OF ALL EXISTING UTILITIES PRIOR TO COMMENCING CONSTRUCTION. PROTECT AND ASSUME RESPONSIBILITY FOR ALL EXISTING UTILITIES WHETHER OR NOT SHOWN ON THIS DRAWING.
 - TEMPORARY SEDIMENT CONTROL MEASURES TO BE IMPLEMENTED DURING CONSTRUCTION ON ALL PROPOSED ROAD CATCHBASINS, REARYARD CATCHBASINS AND CATCH-BASIN MANHOLES
 - CONNECTION TO EXISTING SYSTEMS AS DETAILED, INCLUDING ALL RESTORATION WORK NECESSARY TO REINSTATE SURFACES TO THE CONDITION THAT EXISTED PRIOR TO CONSTRUCTION OR BETTER.
 - DETERMINE THE EXACT LOCATION, SIZE, MATERIAL AND ELEVATION OF ALL EXISTING UTILITIES PRIOR TO COMMENCING CONSTRUCTION. PROTECT AND ASSUME ALL RESPONSIBILITY FOR ALL EXISTING UTILITIES WHETHER OR NOT SHOWN ON THIS DRAWING.
 - OBTAIN AND PAY FOR ALL NECESSARY PERMITS AND APPROVALS FROM THE CITY OF OTTAWA BEFORE COMMENCING CONSTRUCTION.
 - RESTORE ALL TRENCHES AND SURFACE OF PUBLIC ROAD ALLOWANCES TO CONDITION AT LEAST EQUAL TO ORIGINAL CONDITION AND TO THE SATISFACTION OF MINISTRY AND MUNICIPALITY AUTHORITIES.
 - STANDARD ROAD CUT SHALL BE IN ACCORDANCE WITH THE MTO STANDARDS AND MUNICIPALITY STANDARDS.
 - ASPHALT RESTORATION SHALL BE IN ACCORDANCE WITH OPSS-310.
 - THICKNESS OF GRANULAR MATERIAL AND ASPHALT LAYERS SHALL MATCH EXISTING ROADWAY AS CONSTRUCTED.
 - GRASSED AREAS SHALL BE REINSTATED WITH 100mm OF TOPSOIL AND SEED AND MULCH.
 - REMOVE FROM SITE ALL EXCESS EXCAVATED MATERIAL UNLESS OTHERWISE INSTRUCTED BY ENGINEER. EXCAVATE AND DISPOSE OF OFFSITE ALL ORGANIC MATERIAL, ASPHALT, CURBING, CULVERTS AND DEBRIS. REMOVAL OF MATERIALS TO BE AT CONTRACTORS EXPENSE.
 - ALL ELEVATIONS ARE GEODETIC AND UTILIZE METRIC UNITS. ALL MEASUREMENTS UTILIZE METRIC UNITS.
 - WITH THE EXCEPTION OF THE CITY OF OTTAWA CONSTRUCTION SPECIFICATIONS & STANDARD DETAIL DRAWINGS REFERRED TO IN THE CONTRACT, ONTARIO PROVINCIAL STANDARD DRAWINGS (OPSD) & STANDARD SPECIFICATION (OPSS) SHALL APPLY TO THIS CONTRACT.
 - EXISTING TREES IN THE CONSTRUCTION AREA WHICH ARE NOT IDENTIFIED ON THE DRAWINGS TO BE REMOVED SHALL BE PRESERVED AND PROTECTED DURING THE CONSTRUCTION PERIOD.
 - LIMITS OF GRADING INDICATED MAY VARY DEPENDING ON FIELD CONDITIONS OR AS DIRECTED BY THE ENGINEER.
 - ALL DIMENSIONS ARE IN METERS UNLESS OTHERWISE NOTED.
 - THE CONTRACTOR SHALL MAINTAIN ACCESS AT ALL TIMES INTO CITY OF OTTAWA MHS, VALVE BOXES AND VALVE CHAMBERS. DURING THE PAVING PROCESS THERE ARE TO BE NO CITY OWNED COVERS OF ANY TYPE PAVED OVER PREVENTING ACCESS.
 - THE CONTRACTOR IS RESPONSIBLE FOR PROVIDING PROTECTION AND SUPPORT FOR ALL EXISTING UNDERGROUND UTILITIES DURING CONSTRUCTION. EXACT DEPTH OF UNDERGROUND UTILITY PLANT AND EQUIPMENT, AND ENCASMENT MATERIAL ARE UNKNOWN.
 - MAINTAIN A MINIMAL 1m HORIZONTAL CLEARANCE FROM THE PROPOSED ROAD SIGN POSTS AND EXISTING WATER SERVICES, AND HYDRANT LEEDS.
 - MAINTAIN A MINIMAL 2.4m HORIZONTAL CLEARANCE TO WATERMANS AND SEWERS, WHERE POSSIBLE.
 - ANY PART INDICATED IN GENERAL NOTES 22 & 23 THAT CAN NOT MAINTAIN THE NOTED CLEARANCES SHALL BE INSTALLED BY HYDRO VAC.

WATERPLANT

- THE CONTRACTOR IS TO MAINTAIN AND PROTECT ALL EXISTING VALVES WITHIN CONSTRUCTION LIMITS.

EROSION & SEDIMENT CONTROL

- THE CONTRACTOR SHALL BE RESPONSIBLE FOR CARRYING OUT HIS OPERATIONS, AND SUPPLYING AND INSTALLING ANY APPROPRIATE CONTROL MEASURES, SO AS TO PREVENT SEDIMENT LADEN RUNOFF FROM ENTERING ANY SEWER OR WATERCOURSE WITHIN OR DOWNSTREAM OF THE WORKING AREA. FOR THIS PROJECT THE SUGGESTED ON SITE MEASURES SHALL INCLUDE, BUT SHALL NOT BE LIMITED TO, THE FOLLOWING METHODS:
 - CATCH BASIN FILTERS SPECIFIC MEASURES SHALL BE INSTALLED IN ACCORDANCE WITH THE REQUIREMENTS OF OPSS 805 WHERE APPROPRIATE, OR IN ACCORDANCE WITH MANUFACTURER'S RECOMMENDATIONS.
- WHERE, IN THE OPINION OF THE CONTRACT ADMINISTRATOR OR ANY REGULATORY AGENCY, THE INSTALLED CONTROL MEASURES ARE NOT ADEQUATELY, THE CONTRACTOR SHALL SUPPLY AND INSTALL ADDITIONAL, OR ALTERNATIVE MEASURES AS DIRECTED BY THE CONTRACT ADMINISTRATOR OR THE REGULATORY AGENCY. AS SUCH, THE CONTRACTOR SHALL HAVE ADDITIONAL CONTROL MATERIALS ON SITE AT ALL TIMES WHICH ARE EASILY ACCESSIBLE AND MAY BE IMPLEMENTED BY HIM AT A MOMENTS NOTICE. REGULATORY AGENCIES AND THE SPECIFICATIONS DETAILED HEREIN.
- THE CONTRACTOR SHALL PERIODICALLY, OR WHEN REQUESTED BY THE CONTRACT ADMINISTRATOR, CLEAN OUT ACCUMULATED SEDIMENT DEPOSITS AS REQUIRED AT THE SEDIMENT CONTROL DEVICES. INCLUDING THOSE DEPOSITS THAT MAY ORIGINATE FROM OUTSIDE THE CONSTRUCTION AREA ACCUMULATED SEDIMENT SHALL BE REMOVED IN SUCH A MANNER THAT PREVENTS THE DEPOSITION OF THIS MATERIAL INTO ANY SEWER OR WATERCOURSE AND AVOIDS DAMAGE TO THE CONTROL MEASURE. THE SEDIMENT SHALL BE REMOVED FROM THE SITE AT THE CONTRACTORS EXPENSE AND MANAGED IN COMPLIANCE WITH THE REQUIREMENTS FOR EXCESS EARTH MATERIAL, AS SPECIFIED ELSEWHERE IN THE CONTRACT.
- THE CONTRACTOR ACKNOWLEDGES THAT SURFACE EROSION AND SEDIMENT RUNOFF RESULTING FROM HIS CONSTRUCTION OPERATIONS WILL HAVE A DETRIMENTAL IMPACT TO ANY DOWNSTREAM WATERCOURSE OR SEWER, AND THAT ALL CONSTRUCTION ACTIVITIES THAT MAY IMPACT UPON WATER QUALITY SHALL BE CARRIED OUT IN A MANNER THAT STRICTLY MEETS THE REQUIREMENTS OF ALL APPLICABLE LEGISLATION AND REGULATIONS.
- THE OWNER AGREES TO PREPARE AND IMPLEMENT AN EROSION AND SEDIMENT CONTROL PLAN TO THE SATISFACTION OF THE CITY OF OTTAWA, PRIOR TO UNDERTAKING ANY SITE ALTERATIONS AND DURING ALL PHASES OF THE SITE PREPARATION AND CONSTRUCTION IN ACCORDANCE WITH THE CURRENT BEST MANAGEMENT PRACTICES FOR EROSION AND SEDIMENT CONTROL, SUCH AS BUT NOT LIMITED TO INSTALLING FILTER CLOTHS ABOVE CBS AND INLET PROTECTIONS FOR CBS AND INSTALLING AND MAINTAINING LIGHT DUTY SILT FENCE BARRIERS AND ROCK FLOW CHECK DAMS AS REQUIRED.
- CONDITIONS OF THE EROSION AND SEDIMENT CONTROL MEASURES TO BE INSPECTED REGULARLY AND REPLACED OR REPAIRED AS REQUIRED OR AS INSTRUCTED BY THE ENGINEER.
- THE SEDIMENT CONTROL MEASURES SHALL ONLY BE REMOVED WHEN, IN THE OPINION OF THE ENGINEER, THE MEASURE OR MEASURES, IS NO LONGER REQUIRED. NO CONTROL MEASURE MAY BE PERMANENTLY REMOVED WITHOUT PRIOR AUTHORIZATION FROM THE ENGINEER.
- THE CONTRACTOR SHALL IMMEDIATELY REPORT TO THE ENGINEER ANY ACCIDENTAL DISCHARGES OF SEDIMENT MATERIAL INTO ANY DITCH OR STORM SEWER SYSTEM. APPROPRIATE RESPONSE MEASURES, INCLUDING ANY REPAIRS TO EXISTING CONTROL MEASURES OR THE IMPLEMENTATION OF ADDITIONAL CONTROL MEASURES, SHALL BE CARRIED OUT BY THE CONTRACTOR WITHOUT DELAY.
- THE CONTRACTOR SHALL KEEP MATERIAL FOR ADDITIONAL EROSION AND SEDIMENT CONTROLS ON SITE AT ALL TIMES. THESE MATERIALS INCLUDE BUT ARE NOT LIMITED TO: SILT FENCES, STRAW BALES, SEDIMENT BAGS AND CLEAR STONE. A CONTINGENCY PLAN TO INCLUDE THE PROVISION OF ADDITIONAL LABOUR, EQUIPMENT OR MATERIALS TO INSTALL ADDITIONAL CONTROL MEASURES, AS WELL AS PROVIDE AN EMERGENCY RESPONSE PLAN IN CASE OF AN ACCIDENTAL EVENT, AS SUCH, THE CONTRACTOR SHALL HAVE ADDITIONAL CONTROL MATERIALS ON SITE AT ALL TIMES WHICH ARE EASILY ACCESSIBLE AND MAY BE IMPLEMENTED AT A MOMENTS NOTICE.
- IN ADDITION TO ANY OTHER REMEDY AND/OR PENALTY PROVIDED BY LAW, WHERE THERE HAS BEEN DEFAULT OR NON-COMPLIANCE WITH ANY OF THE TERMS SPECIFIED HEREIN AND THE CONTRACTOR REFUSES TO PERFORM OR RECTIFY WITHIN FORTY-EIGHT (48) HOURS OF THE RECEIPT OF THE WRITTEN DEMAND OF THE CONTRACT ADMINISTRATOR TO DO SO, THE OWNER IS HEREBY ENTITLED TO ENTER UPON THE WORKING AREA AND EITHER COMPLETE THE WORK IN CONFORMANCE WITH THE CONTRACT OR HAVE THE WORK DONE THAT IT CONSIDERS NECESSARY TO COMPLETE THE WORK TO ITS INTENDED CONDITION, WHICHEVER, IN THE OWNERS SOLE OPINION IS THE MOST REASONABLE COURSE OF ACTION. THE CONTRACTOR AND THE OWNER FURTHER AGREE THAT THE COST INCURRED FOR ANY SUCH WORK SHALL BE RETAINED BY THE OWNER FROM MONIES OTHERWISE DUE TO THE CONTRACTOR.

PAVING:

- REMOVE ANY TOPSOIL/ORGANICS AND ANY SOFT, WET, OR DELETERIOUS MATERIAL IN PREPARATION OF THE SUBGRADE.
- GRANULAR BASE AND SUBGRADE TO BE COMPACTED TO AT LEAST 100% SPMDD.
- ASPHALTIC CONCRETE TO BE COMPACTED TO AT LEAST 92-97% MRD.
- ROADWAY SUBGRADE TO BE INSPECTED BY THE GEOTECHNICAL ENGINEER AT THE TIME OF CONSTRUCTION TO REVIEW THE GRANULAR 'B' DEPTH AND FOR THE NECESSITY OF A WOVEN GEOTEXTILE BELOW THE GRANULAR MATERIALS.
- CONNECT TO EXISTING ROADS AS PER CITY OF OTTAWA DETAIL R25 AND TO EXISTING CONDITIONS OR BETTER.

PAVEMENT STRUCTURE

HEAVY DUTY: 50MM HL3 OR SP12.5 CAT B
60MM HL3 OR SP19 CAT B
150MM GRANULAR A, AS PER OPSS 1010
600MM GRANULAR B, AS PER OPSS 1010

PAVEMENT MARKING AND SIGNAGE

- THE CONTRACTOR SHALL INSTALL ALL PAVEMENT MARKINGS.
- PROPOSED SIGNAGE WILL BE SUPPLIED AND INSTALLED BY THE CITY OF OTTAWA.
- THE CONTRACTOR SHALL REMOVE, SALVAGE AND STORE IN A SAFE AREA ALL EXISTING SIGNAGE AS DIRECTED BY THE ENGINEER. CITY FORCES WILL REINSTATE ALL NEW STREET SIGNAGE.

DETAILS

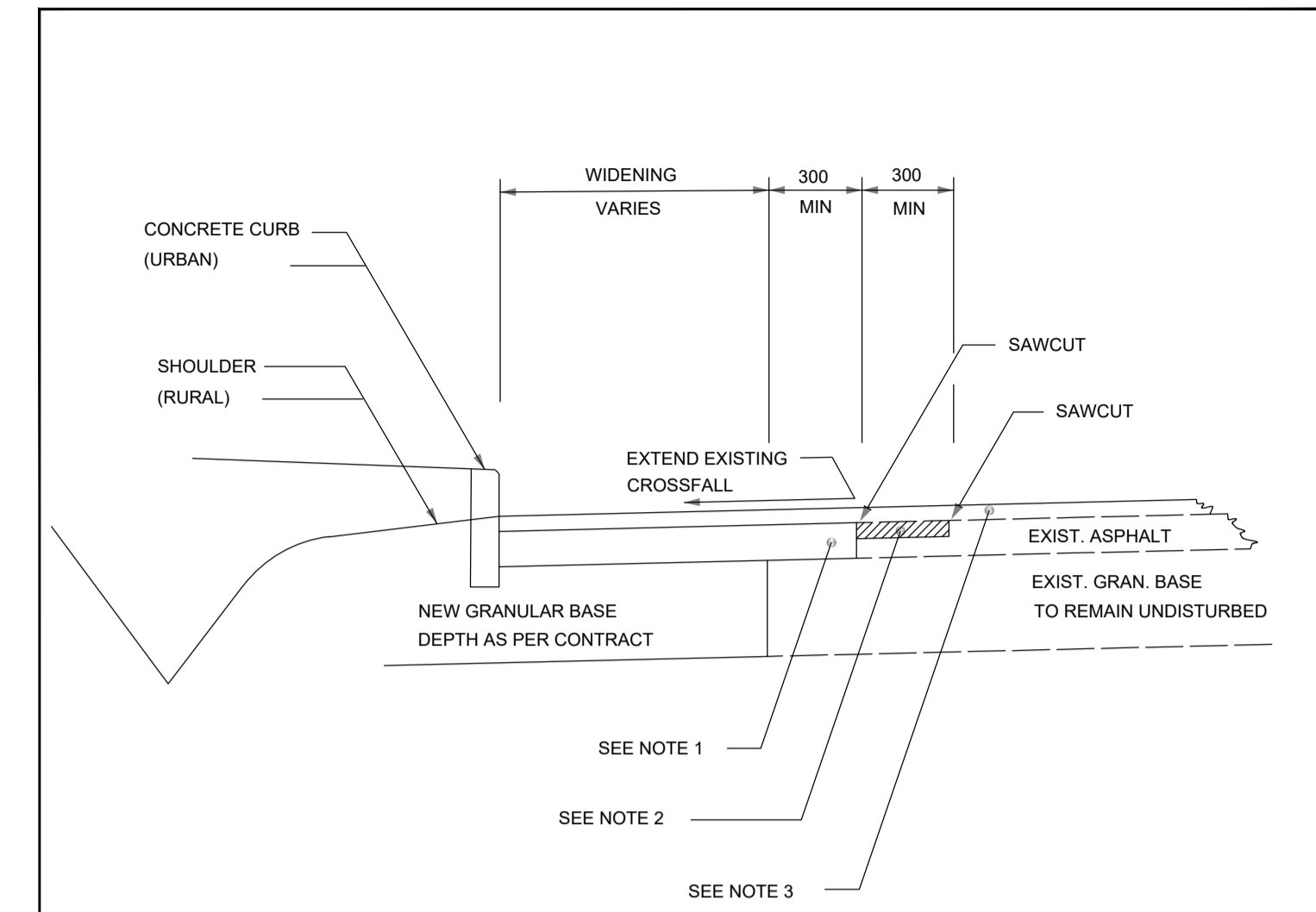

NOTES:

- SP 19.0 ASPHALT BASE COURSE TO BE LAID FLUSH WITH EXISTING ASPHALT SURFACE AND MATCH THE BOTTOM OF EXISTING ASPHALT BASE COURSE
- HATCHED AREA TO BE SAWCUT 40mm IN DEPTH MIN. AND REMOVED TO FORM KEY TO ACCEPT SP 19.0 BASE COURSE ASPHALT AS IN NOTE 1
- SURFACE TO BE OVERLAID WITH SP 12.5 - AS PER CONTRACT DRAWINGS
- IN SOME CASES THE 300mm SAWCUT FROM EXISTING PAVEMENT EDGE WILL BE WIDER SO AS TO PAVE TO A SOUND PAVEMENT EDGE
- ALL MEASUREMENTS ARE IN MILLIMETRES UNLESS OTHERWISE NOTED

	TITLE:	PAVEMENT WIDENING EXISTING URBAN & RURAL ROADS	DATE: MAY 2001
			REV: MAR 2024
			DWG No: R17

BENCHING OF EARTH SLOPES

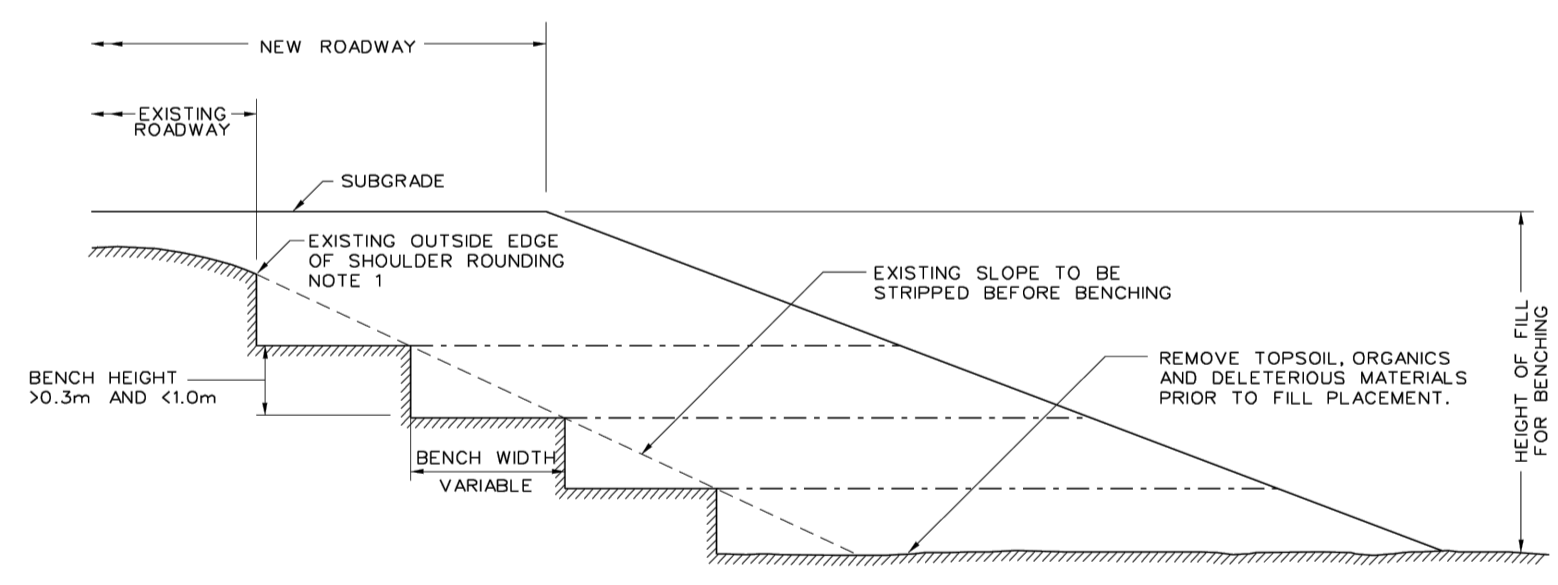

NOTES:

- WHEN THE SUBGRADE IS BELOW THE EXISTING OUTSIDE EDGE OF SHOULDER ROUNDING, BENCHING SHALL BE CARRIED OUT BELOW THE POINT WHERE THE SUBGRADE INTERSECTS THE EXISTING SLOPE.
- BENCHING IS NOT REQUIRED ON EXISTING SLOPES FLATTER THAN 3:1 OR WHERE SPECIFIED.
- BENCHES ARE TO BE EXCAVATED ONE LEVEL AT A TIME AND THE COMPACTED FILL BROUGHT UP BEFORE THE NEXT BENCHING LEVEL IS EXCAVATED.
- ALL DIMENSIONS ARE IN MILLIMETRES UNLESS SHOWN OTHERWISE.

Engineers, Planners & Landscape Architects Suite 200, 240 Michael Cowpland Drive Ottawa, Ontario, Canada K2M 1P6 Telephone: (613) 254-9643 Facsimile: (613) 254-5867 Website: www.novatech-eng.com	LOCATION CITY OF OTTAWA 5510 BOUNDARY ROAD MODIFICATION	PROJECT No: 118168
	DRAWING NAME LEGEND, NOTES AND DETAILS	REV: REV # 1
	DRAWING No. 118168-RMA-LGD	
	DATE: MARCH 2005 RJK M/JH/JLL RJK M/JH/JLL JLL	

SCALE		DESIGN	
AS SHOWN		RJK	
		M/JH/JLL	
		RJK	
		M/JH/JLL	
		JLL	
1. ISSUED FOR CITY REVIEW		MARCH 5/26	JLL
No.	REVISION	DATE	BY

M:\2011\118168\CAD\DESIGN\ROAD\MOD (BOUNDARY ROAD)\118168-LGD.DWG 3/26/2026 2:26 PM - RKARGUS

RMA#-RMA-2024-TPD-004

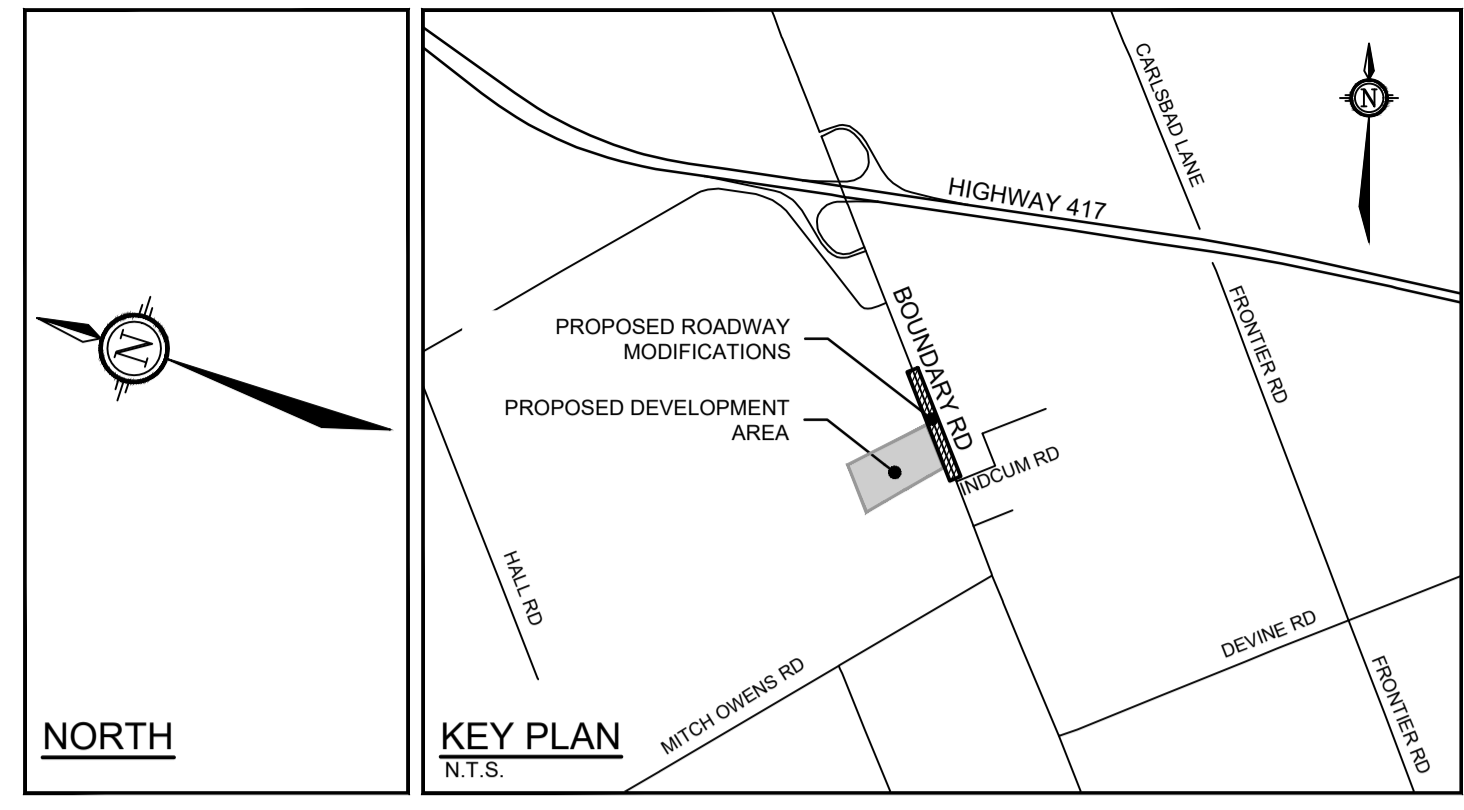
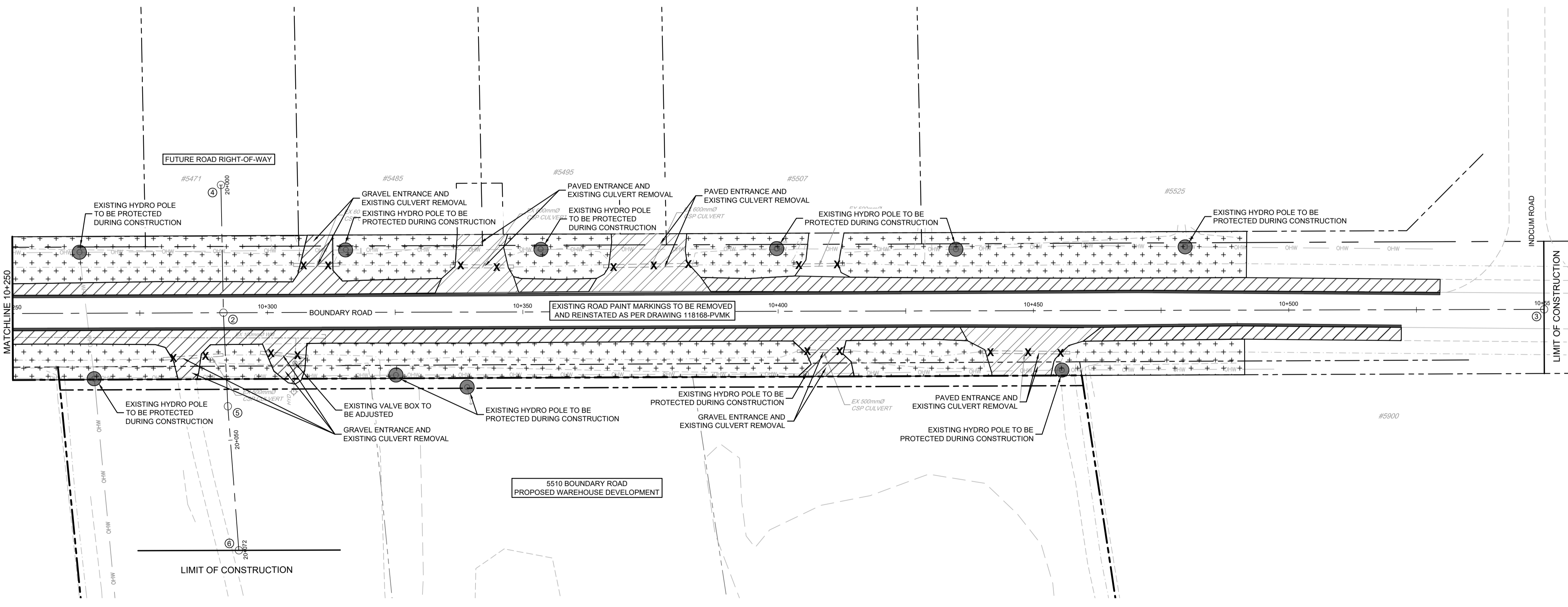
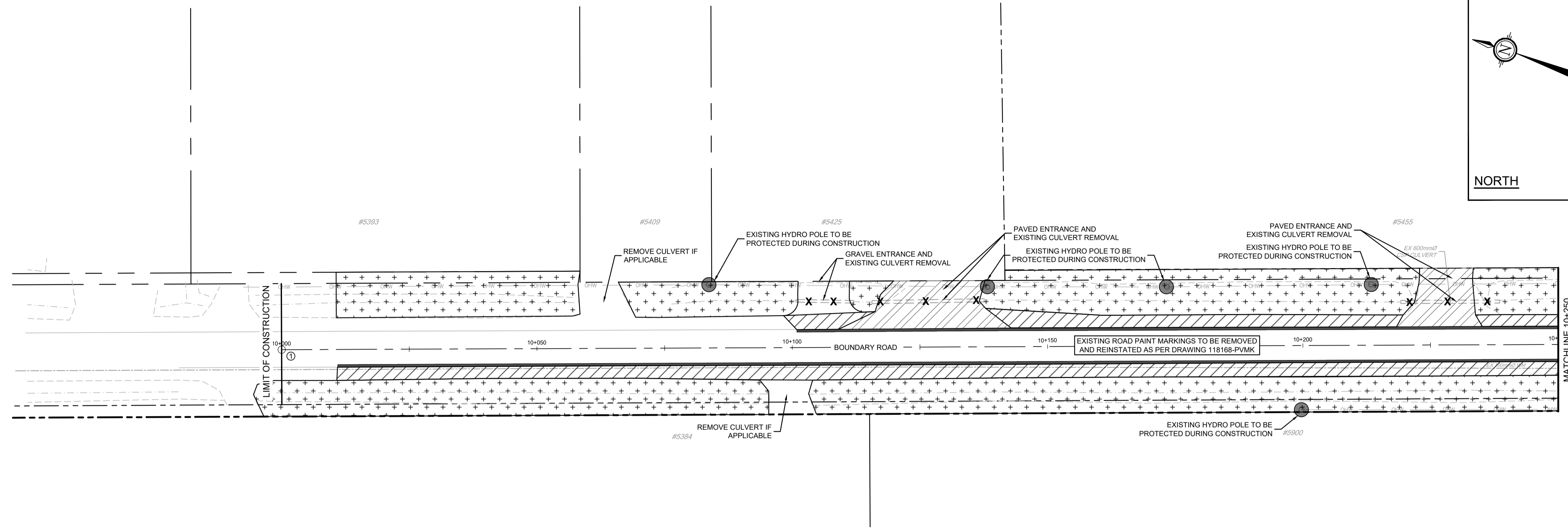

- LEGEND**
- DRY GRINDING EXISTING ASPHALT (AVERAGE DEPTH OF 60mm AND MINIMUM 0.5m BACK FROM EXISTING EDGE OF ASPHALT)
 - GRASSED AREA REMOVAL, CLEARING AND GRUBBING
 - GRAVEL SHOULDER / ENTRANCE REMOVAL
 - ASPHALT ENTRANCE REMOVAL
 - X** REMOVALS (AS NOTED)
 - EXISTING OVERHEAD WIRE
 - EXISTING DITCH CENTERLINE
 - EXISTING UTILITY POLE

ALIGNMENT LAYOUT

#	DESCRIPTION	NORTHING	EASTING
1	POT	5023088.1949	387708.2753
2	POT	5022816.7988	387814.2685
3	POT	5022575.7325	387907.9802
4	POT	5022826.2564	387837.4222
5	POT	5022809.4003	387797.4701
6	POT	5022797.2197	387771.9426

POT = POINT ON TANGENT

NOTE:
 THE POSITION OF ALL POLE LINES, CONDUITS, WATERMANS, SEWERS AND OTHER UNDERGROUND AND OVERGROUND UTILITIES AND STRUCTURES IS NOT NECESSARILY SHOWN ON THE CONTRACT DRAWINGS, AND WHERE SHOWN, THE ACCURACY OF THE POSITION OF SUCH UTILITIES AND STRUCTURES IS NOT GUARANTEED. BEFORE STARTING WORK, DETERMINE THE EXACT LOCATION OF ALL SUCH UTILITIES AND STRUCTURES AND ASSUME ALL LIABILITY FOR DAMAGE TO THEM.

No.	REVISION	DATE	BY
1.	ISSUED FOR CITY REVIEW	MARCH 5/26	JLL

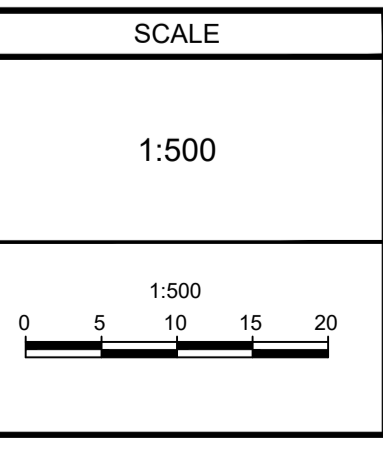

DESIGN	RJK
CHECKED	MJH/JLL
DRAWN	RJK
CHECKED	MJH/JLL
APPROVED	JLL

FOR REVIEW ONLY

NOVATECH
 Engineers, Planners & Landscape Architects
 Suite 200, 240 Michael Cowpland Drive
 Ottawa, Ontario, Canada K2M 1P6

Telephone (613) 254-9643
 Facsimile (613) 254-5867
 Website www.novatech-eng.com

LOCATION		PROJECT No.	
CITY OF OTTAWA		118168	
5510 BOUNDARY ROAD MODIFICATION		REV # 1	
DRAWING NAME		DRAWING No.	
REMOVALS AND ALIGNMENT		118168-RMA-REM	

M:\2018\118168\CAD\DESIGN\ROAD MOD (BOUNDARY ROAD)\118168 - REM.DWG 3/5/2026 2:26 PM - RKARGUS

RMA# RMA-2024-TPD-004

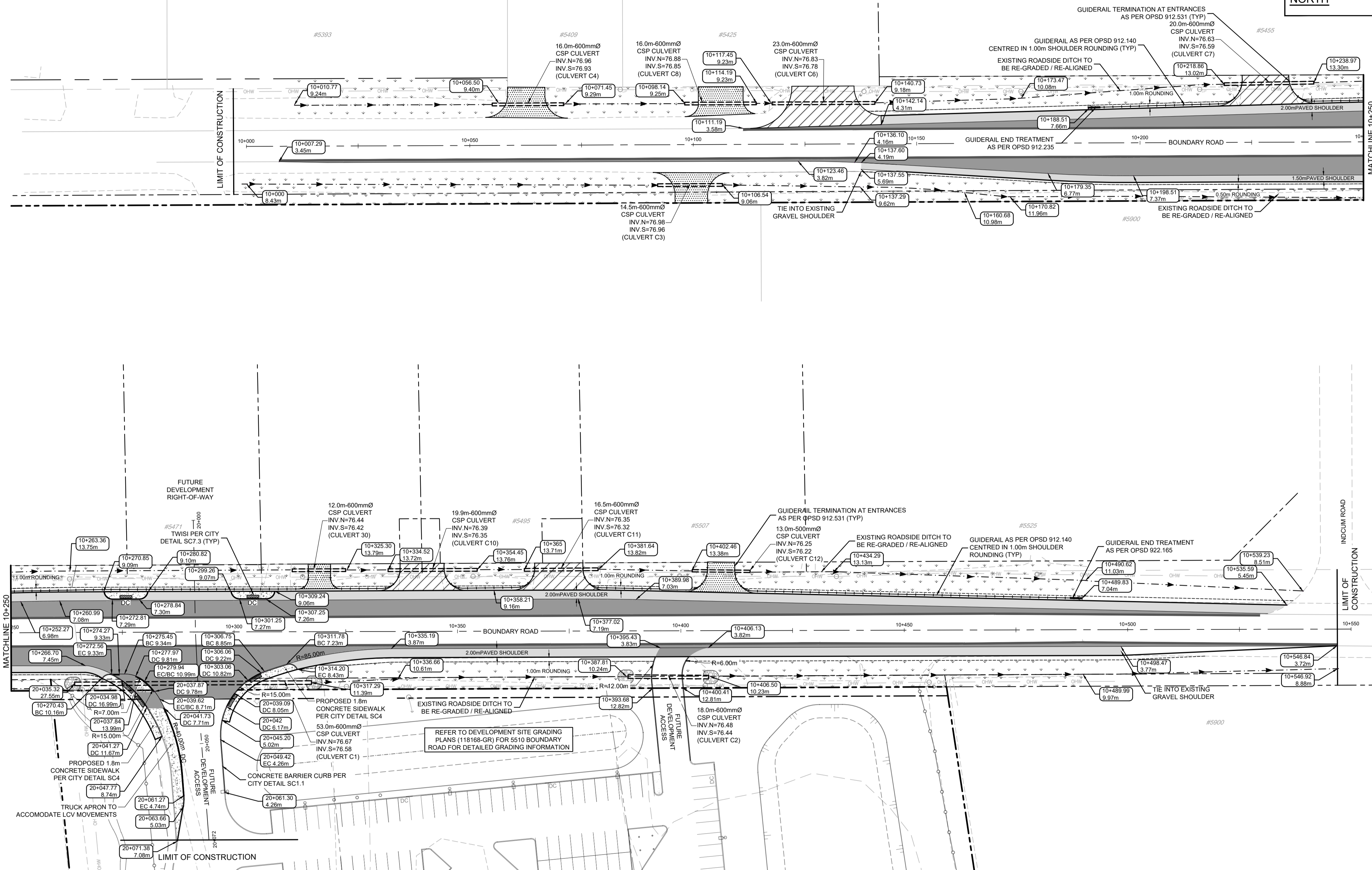
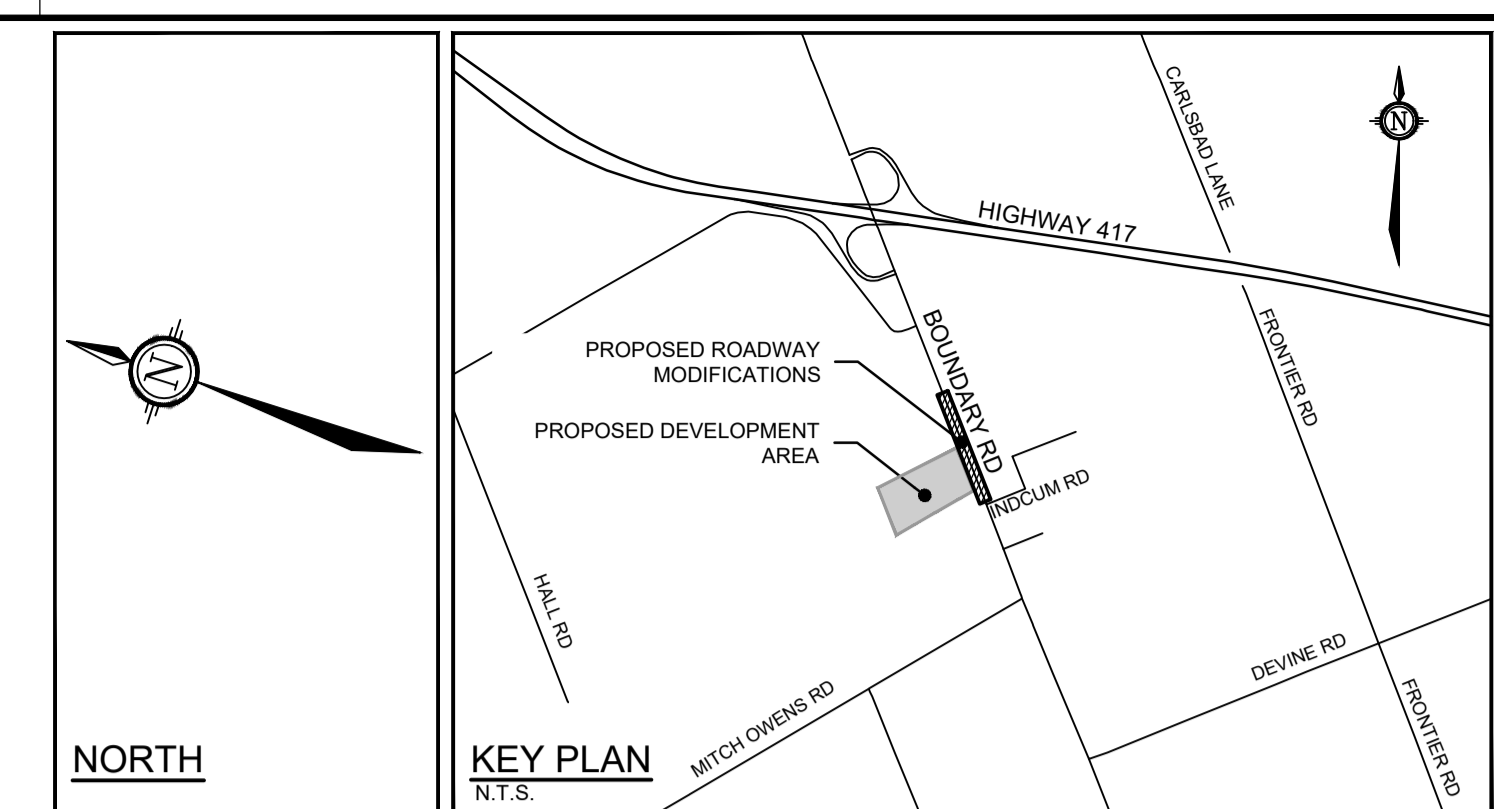

- LEGEND**
- SURFACE COURSE ASPHALT ONLY (50mm THICKNESS)
 - PROPOSED FULL DEPTH ASPHALT REINSTATEMENT
 - PROPOSED ASPHALT SHOULDER (50mm THICKNESS)
 - ASPHALT ENTRANCE REINSTATEMENT
 - GRAVEL ENTRANCE REINSTATEMENT
 - TOPSOIL, SEED AND MULCH REINSTATEMENT (100mm THICKNESS)
 - PROPOSED CONCRETE SIDEWALK / ISLAND
 - PROPOSED CURB PER CITY DETAIL SC1.1
 - PROPOSED DEPRESSED CURB
 - TACTILE WALKING SURFACE INDICATOR (TWSI) PER CITY DETAIL SC7.3
 - DITCH CENTERLINE
 - PROPOSED RIP RAP c/w NON WOVEN GEOTEXTILE PER OPSD 810.010
 - GUIDEWAY WITH END TREATMENT
 - EXISTING OVERHEAD WIRE
 - EXISTING DITCH CENTERLINE
 - EXISTING UTILITY POLE

NOTE:
 THE POSITION OF ALL POLE LINES, CONDUITS, WATERMANS, SEWERS AND OTHER UNDERGROUND AND OVERGROUND UTILITIES AND STRUCTURES IS NOT NECESSARILY SHOWN ON THE CONTRACT DRAWINGS, AND WHERE SHOWN, THE ACCURACY OF THE POSITION OF SUCH UTILITIES AND STRUCTURES IS NOT GUARANTEED. BEFORE STARTING WORK, DETERMINE THE EXACT LOCATION OF ALL SUCH UTILITIES AND STRUCTURES AND ASSUME ALL LIABILITY FOR DAMAGE TO THEM.

No.	REVISION	DATE	BY
1.	ISSUED FOR CITY REVIEW	MARCH 5/26	JLL

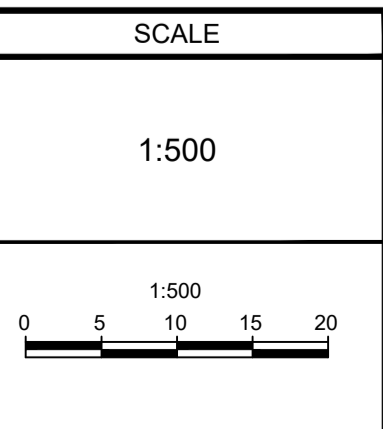

DESIGN	RJK
CHECKED	MJH/JLL
DRAWN	RJK
CHECKED	MJH/JLL
APPROVED	JLL

FOR REVIEW ONLY

Engineers, Planners & Landscape Architects
 Suite 200, 240 Michael Cowpland Drive
 Ottawa, Ontario, Canada K2M 1P6

Telephone (613) 254-9643
 Facsimile (613) 254-5867
 Website www.novatech-eng.com

LOCATION	
CITY OF OTTAWA	
5510 BOUNDARY ROAD MODIFICATION	
DRAWING NAME	
GEOMETRY AND GENERAL LAYOUT	
PROJECT No.	118168
REV	REV # 1
DRAWING No.	118168-RMA-GGL

M:\2018\118168\CAD\DESIGN\ROAD\118168-GGL.DWG 3/5/2024 2:27 PM - RKARGUS

RMA-2024-TPD-004

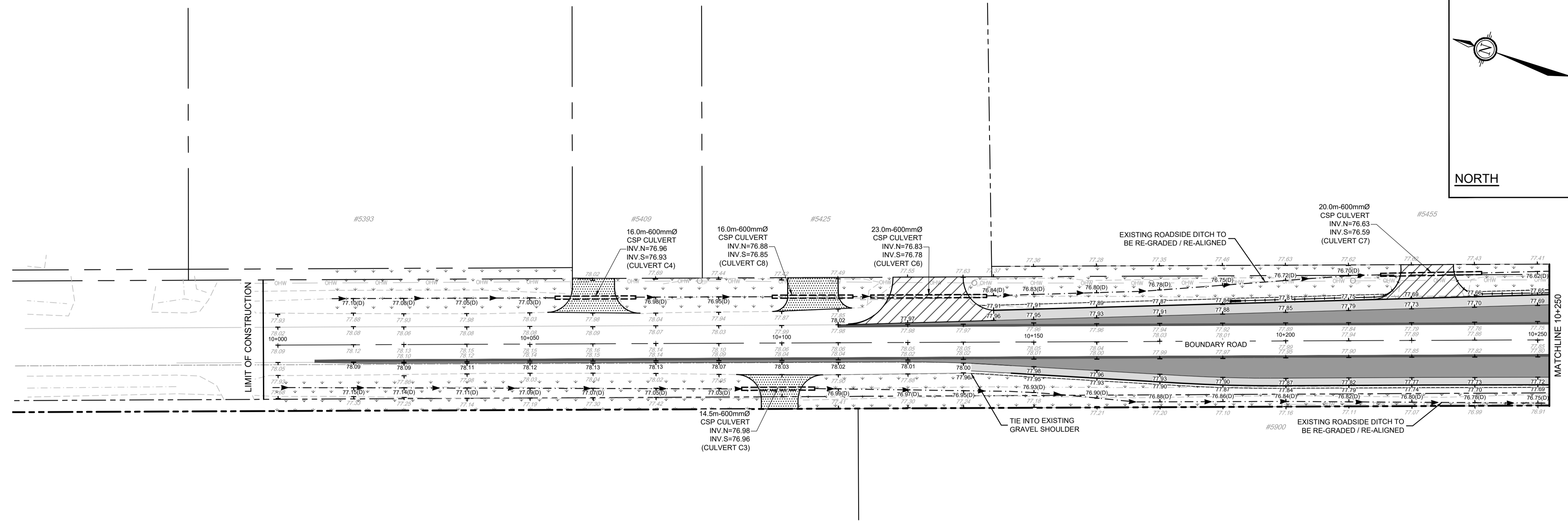
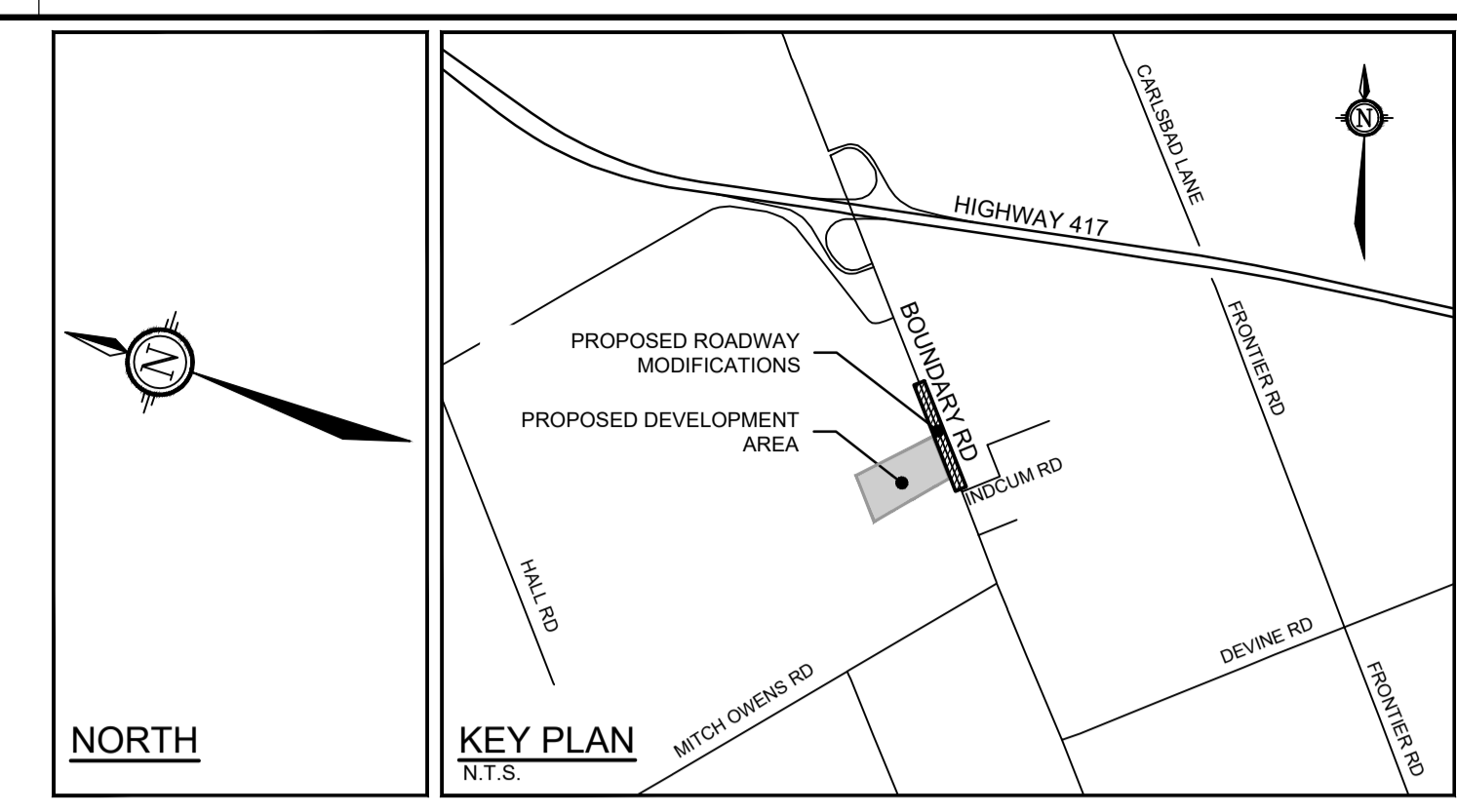

- LEGEND**
- SURFACE COURSE ASPHALT ONLY (50mm THICKNESS)
 - PROPOSED FULL DEPTH ASPHALT REINSTATEMENT
 - PROPOSED ASPHALT SHOULDER (50mm THICKNESS)
 - ASPHALT ENTRANCE REINSTATEMENT
 - GRAVEL ENTRANCE REINSTATEMENT
 - TOPSOIL, SEED AND MULCH REINSTATEMENT (100mm THICKNESS)
 - PROPOSED CONCRETE SIDEWALK / ISLAND
 - PROPOSED ELEVATION
 - EXISTING ELEVATION
 - PROPOSED DITCH GRADE
 - PROPOSED CURB PER CITY DETAIL SC1.1
 - PROPOSED DEPRESSED CURB
 - TACTILE WALKING SURFACE INDICATOR (TWSI) PER CITY DETAIL SC7.3
 - DITCH CENTERLINE
 - PROPOSED RIP RAP *c/w* NON WOVEN GEOTEXTILE PER OPSD 810.010
 - GUIDARAIL WITH END TREATMENT
 - EXISTING OVERHEAD WIRE
 - EXISTING DITCH CENTERLINE
 - EXISTING UTILITY POLE

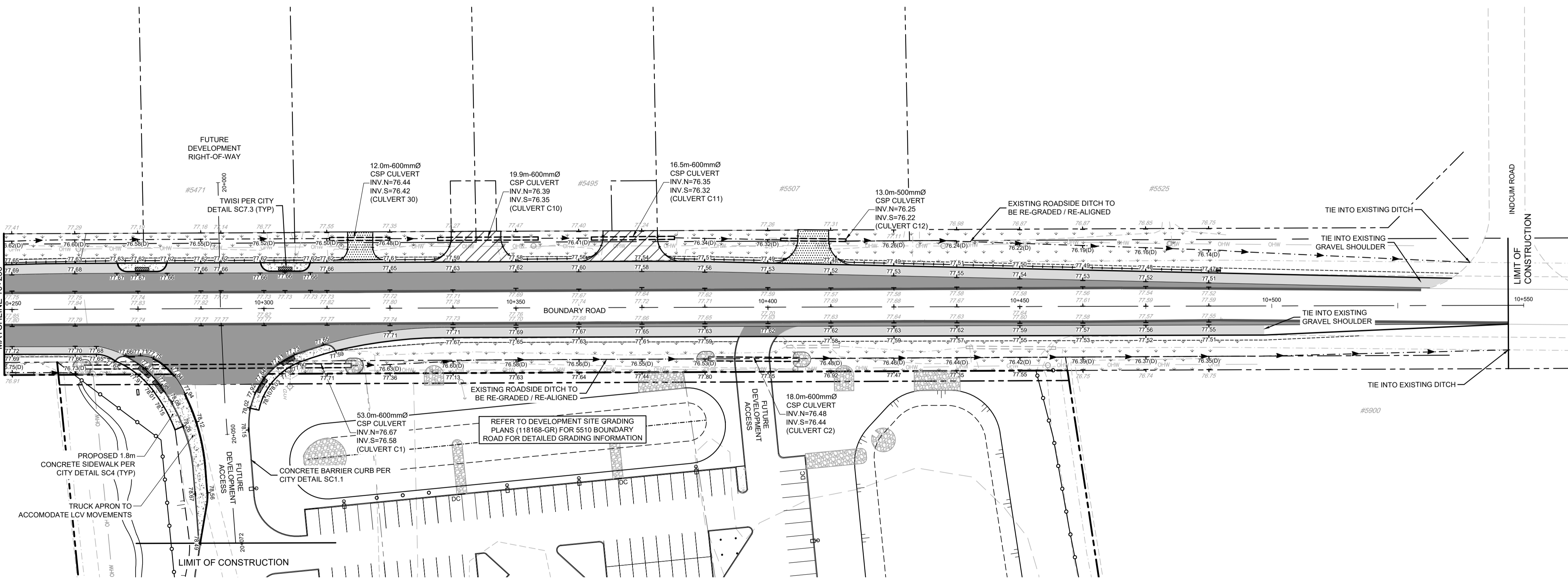

M:\2018\118168\CAD\DESIGN\ROAD\MOD\BOUNDARY ROAD\118168 - PEL.DWG, 3/5/2024, 2:27 PM - RJK/ARGLUS

NOTE:
 THE POSITION OF ALL POLE LINES, CONDUITS, WATERMANS, SEWERS AND OTHER UNDERGROUND AND OVERGROUND UTILITIES AND STRUCTURES IS NOT NECESSARILY SHOWN ON THE CONTRACT DRAWINGS, AND WHERE SHOWN, THE ACCURACY OF THE POSITION OF SUCH UTILITIES AND STRUCTURES IS NOT GUARANTEED. BEFORE STARTING WORK, DETERMINE THE EXACT LOCATION OF ALL SUCH UTILITIES AND STRUCTURES AND ASSUME ALL LIABILITY FOR DAMAGE TO THEM.

No.	REVISION	DATE	BY
1.	ISSUED FOR CITY REVIEW	MARCH 5/26	JLL

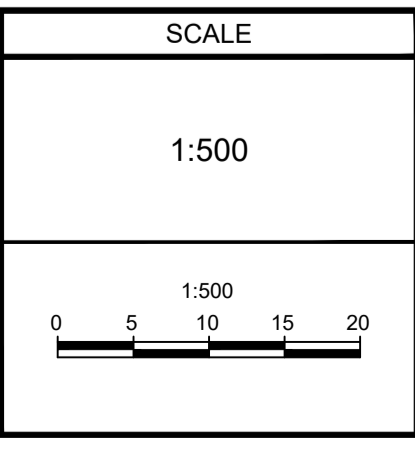

DESIGN	RJK
CHECKED	MJH/JLL
DRAWN	RJK
CHECKED	MJH/JLL
APPROVED	JLL

FOR REVIEW ONLY

NOVATECH
 Engineers, Planners & Landscape Architects
 Suite 200, 240 Michael Cowpland Drive
 Ottawa, Ontario, Canada K2M 1P6

Telephone: (613) 254-9643
 Facsimile: (613) 254-5867
 Website: www.novatech-eng.com

LOCATION CITY OF OTTAWA 5510 BOUNDARY ROAD MODIFICATION		PROJECT No. 118168
DRAWING NAME PAVEMENT ELEVATIONS		REV # 1
DRAWING No. 118168-RMA-PEL		RMA# RMA-2024-TPD-004

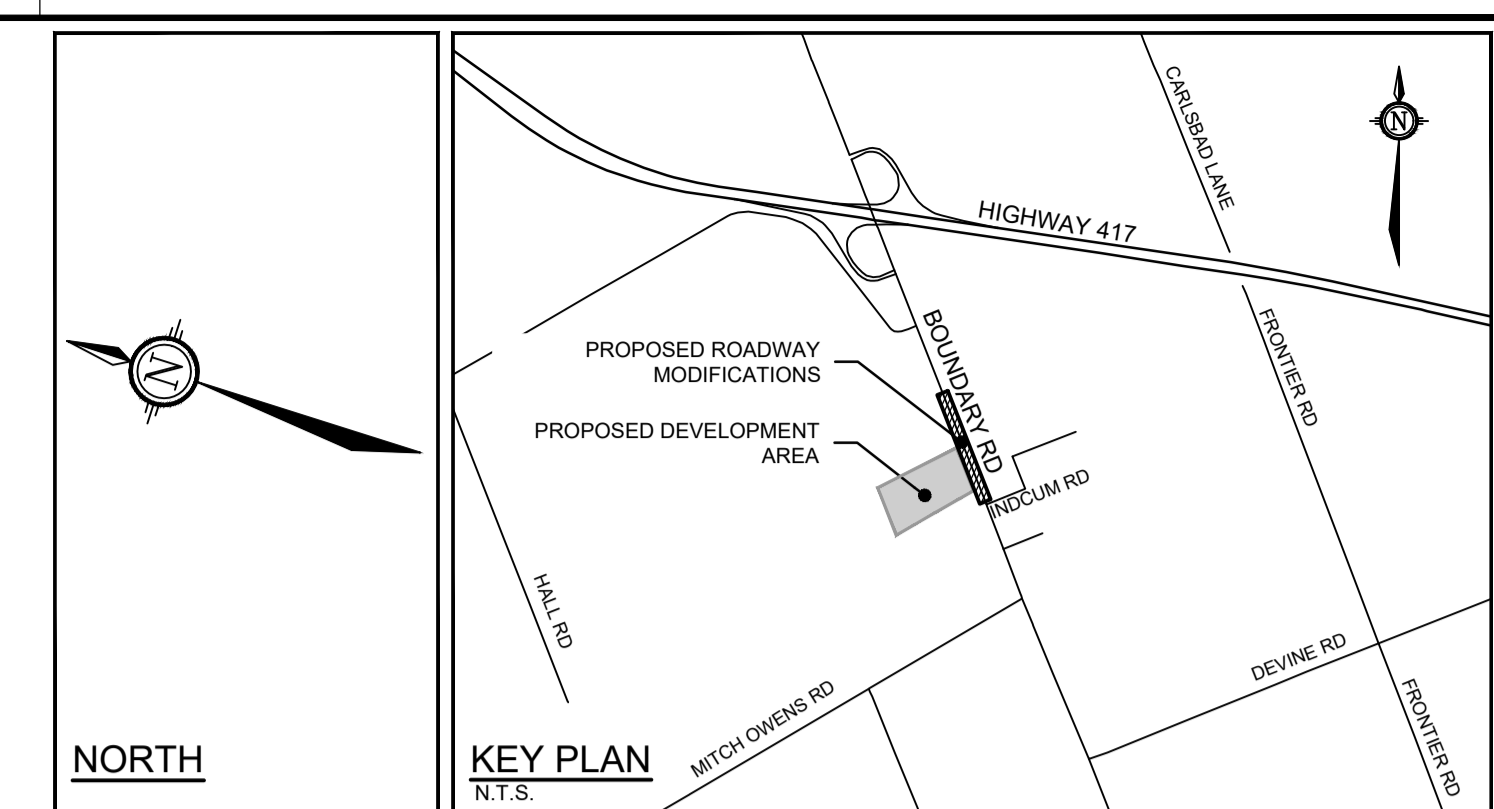

- LEGEND**
- PROPOSED RIP RAP or NON WOVEN GEOTEXTILE PER OPSD 810.010
 - EXISTING OVERHEAD WIRE
 - EXISTING DITCH CENTERLINE
 - EXISTING UTILITY POLE

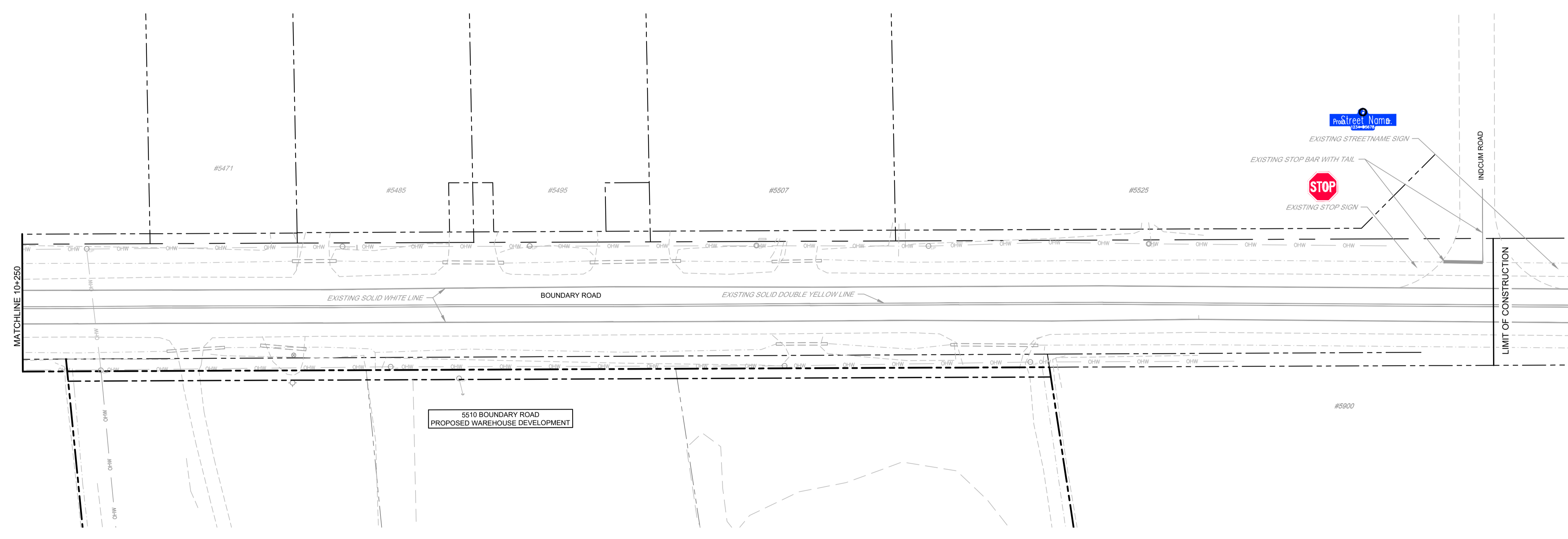
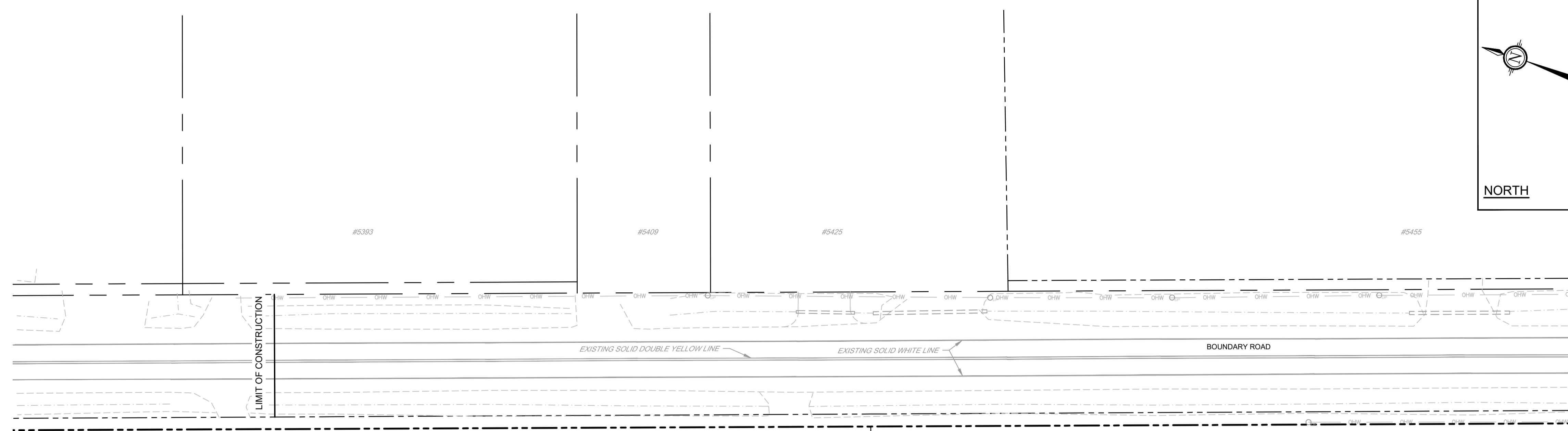

NOTE:
 THE POSITION OF ALL POLE LINES, CONDUITS, WATERMANS, SEWERS AND OTHER UNDERGROUND AND OVERGROUND UTILITIES AND STRUCTURES IS NOT NECESSARILY SHOWN ON THE CONTRACT DRAWINGS, AND WHERE SHOWN, THE ACCURACY OF THE POSITION OF SUCH UTILITIES AND STRUCTURES IS NOT GUARANTEED. BEFORE STARTING WORK, DETERMINE THE EXACT LOCATION OF ALL SUCH UTILITIES AND STRUCTURES AND ASSUME ALL LIABILITY FOR DAMAGE TO THEM.

No.	REVISION	DATE	BY
1.	ISSUED FOR CITY REVIEW	MARCH 5/26	JLL

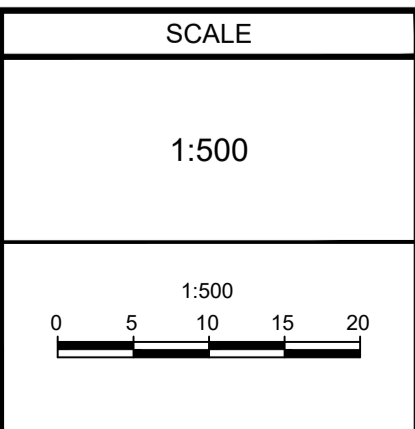

DESIGN	FOR REVIEW ONLY
RJK	
CHECKED MJH/JLL	
DRAWN RJK	
CHECKED MJH/JLL	
APPROVED JLL	

NOVATECH
 Engineers, Planners & Landscape Architects
 Suite 200, 240 Michael Cowpland Drive
 Ottawa, Ontario, Canada K2M 1P6
 Telephone (613) 254-9643
 Facsimile (613) 254-5867
 Website www.novatech-eng.com

LOCATION CITY OF OTTAWA 5510 BOUNDARY ROAD MODIFICATION		PROJECT No. 118168
DRAWING NAME EXISTING PAVEMENT MARKINGS AND SIGNAGE		REV # 1 REV # 1
DRAWING No. 118168-RMA-XPVMK		RMA#-RMA-2024-TPD-004

M:\2018\118168\CAD\DESIGN\ROAD MOD (BOUNDARY ROAD)\118168 - XPVMK.DWG, 3/25/2026 2:28 PM - RKARGJUS

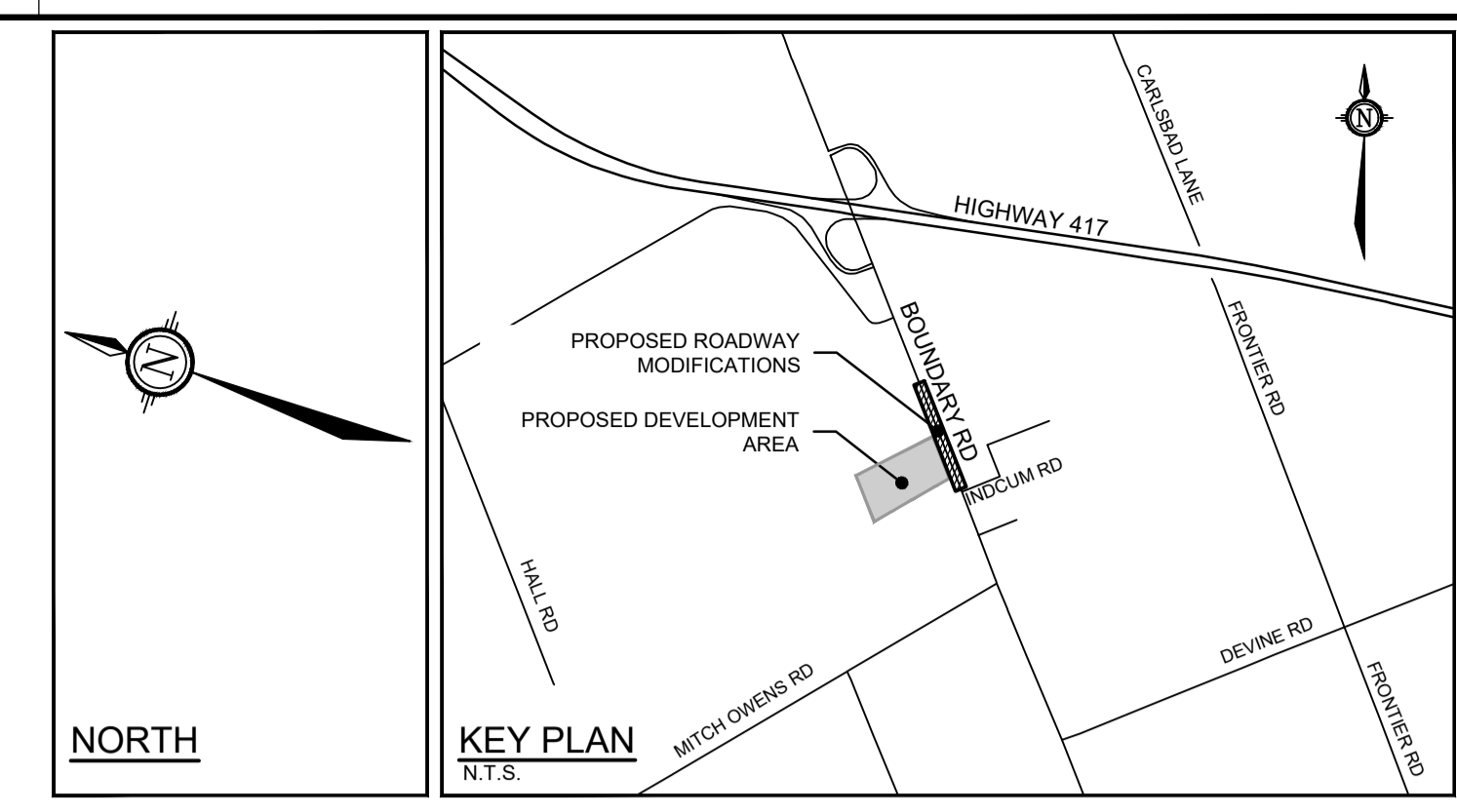

- LEGEND**
- ASPHALT ENTRANCE REINSTATEMENT
 - GRAVEL ENTRANCE REINSTATEMENT
 - PROPOSED CONCRETE SIDEWALK / ISLAND
 - PROPOSED CURB PER CITY DETAIL SC1.1
 - PROPOSED DEPRESSED CURB
 - TACTILE WALKING SURFACE INDICATOR (TWSI) PER CITY DETAIL SC7.3
 - DITCH CENTERLINE
 - PROPOSED RIP RAP c/w NON WOVEN GEOTEXTILE PER OPSD 810.010
 - GUIDERAIL WITH END TREATMENT
 - EXISTING OVERHEAD WIRE
 - EXISTING DITCH CENTERLINE
 - EXISTING UTILITY POLE

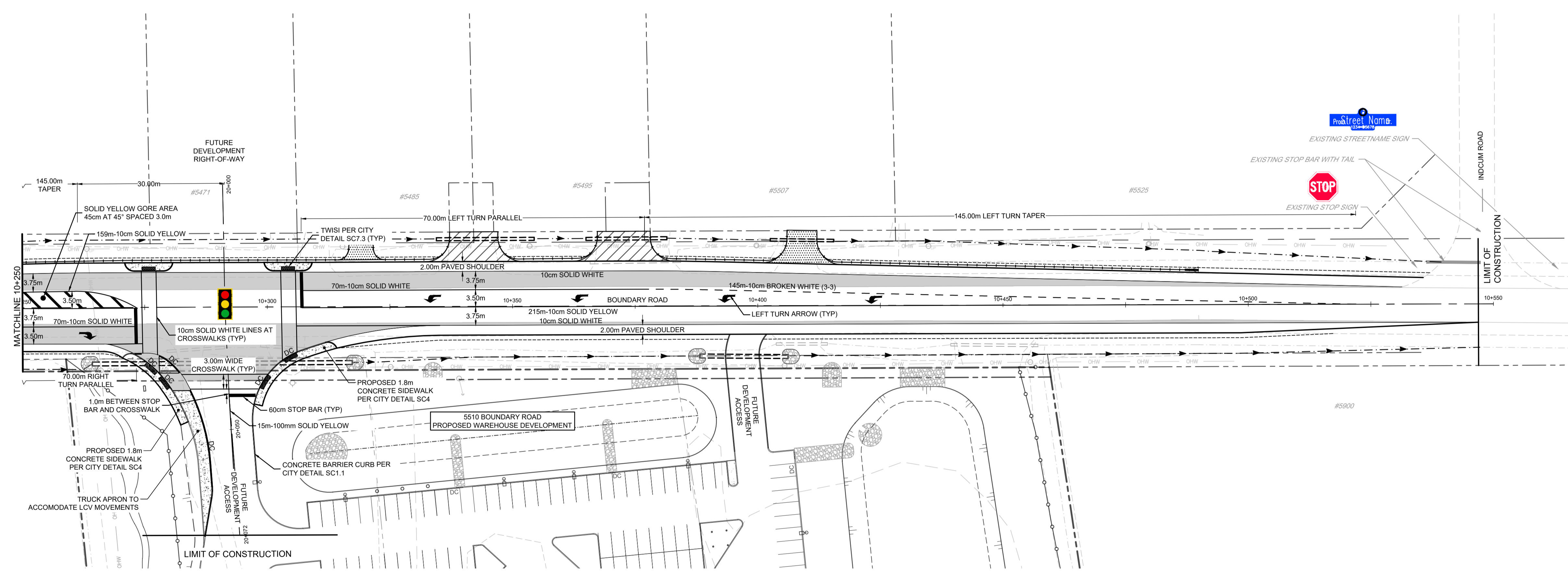
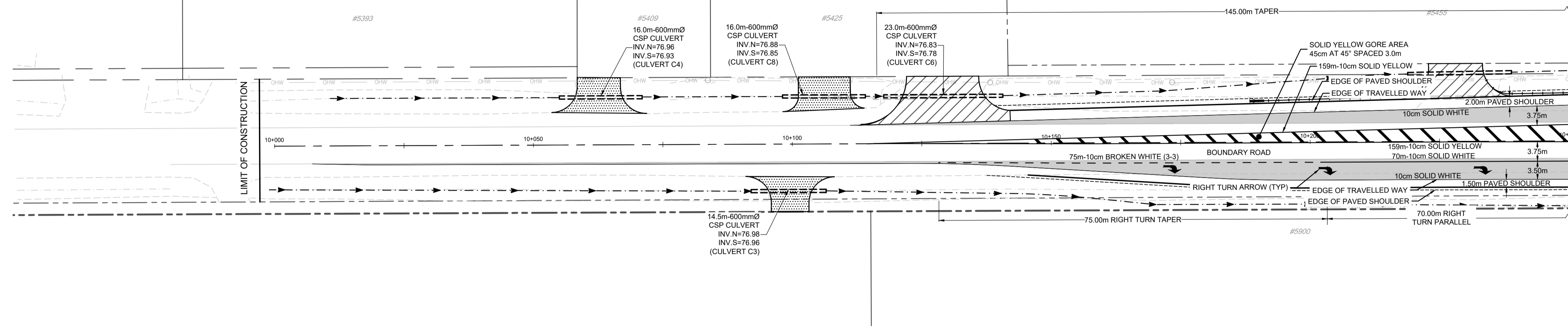

NOTE:
 THE POSITION OF ALL POLE LINES, CONDUITS, WATERMANS, SEWERS AND OTHER UNDERGROUND AND OVERGROUND UTILITIES AND STRUCTURES IS NOT NECESSARILY SHOWN ON THE CONTRACT DRAWINGS, AND WHERE SHOWN, THE ACCURACY OF THE POSITION OF SUCH UTILITIES AND STRUCTURES IS NOT GUARANTEED. BEFORE STARTING WORK, DETERMINE THE EXACT LOCATION OF ALL SUCH UTILITIES AND STRUCTURES AND ASSUME ALL LIABILITY FOR DAMAGE TO THEM.

No.	REVISION	DATE	BY
1.	ISSUED FOR CITY REVIEW	MARCH 5/26	JLL

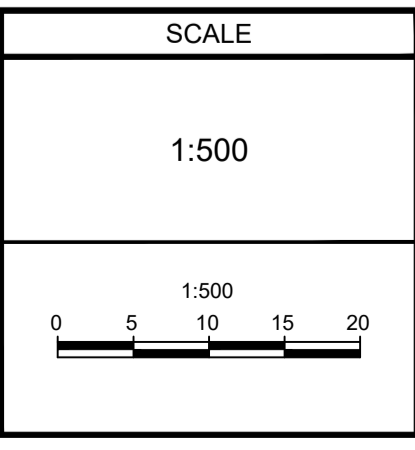

DESIGN	RJK
CHECKED	MJH/JLL
DRAWN	RJK
CHECKED	MJH/JLL
APPROVED	JLL

FOR REVIEW ONLY

NOVATECH
 Engineers, Planners & Landscape Architects
 Suite 200, 240 Michael Cowpland Drive
 Ottawa, Ontario, Canada K2M 1P6

Telephone (613) 254-9643
 Facsimile (613) 254-5867
 Website www.novatech-eng.com

LOCATION
 CITY OF OTTAWA
 5510 BOUNDARY ROAD MODIFICATION

DRAWING NAME
 PAYMENT MARKINGS AND SIGNAGE

PROJECT No.	118168
REV	REV # 1
DRAWING No.	118168-RMA-PVMK

M:\2018\118168\CAD\DESIGN\ROAD\118168 - PVMK.DWG 3/5/2026 2:28 PM - RKARGUS

RMA# RMA-2024-TPD-004

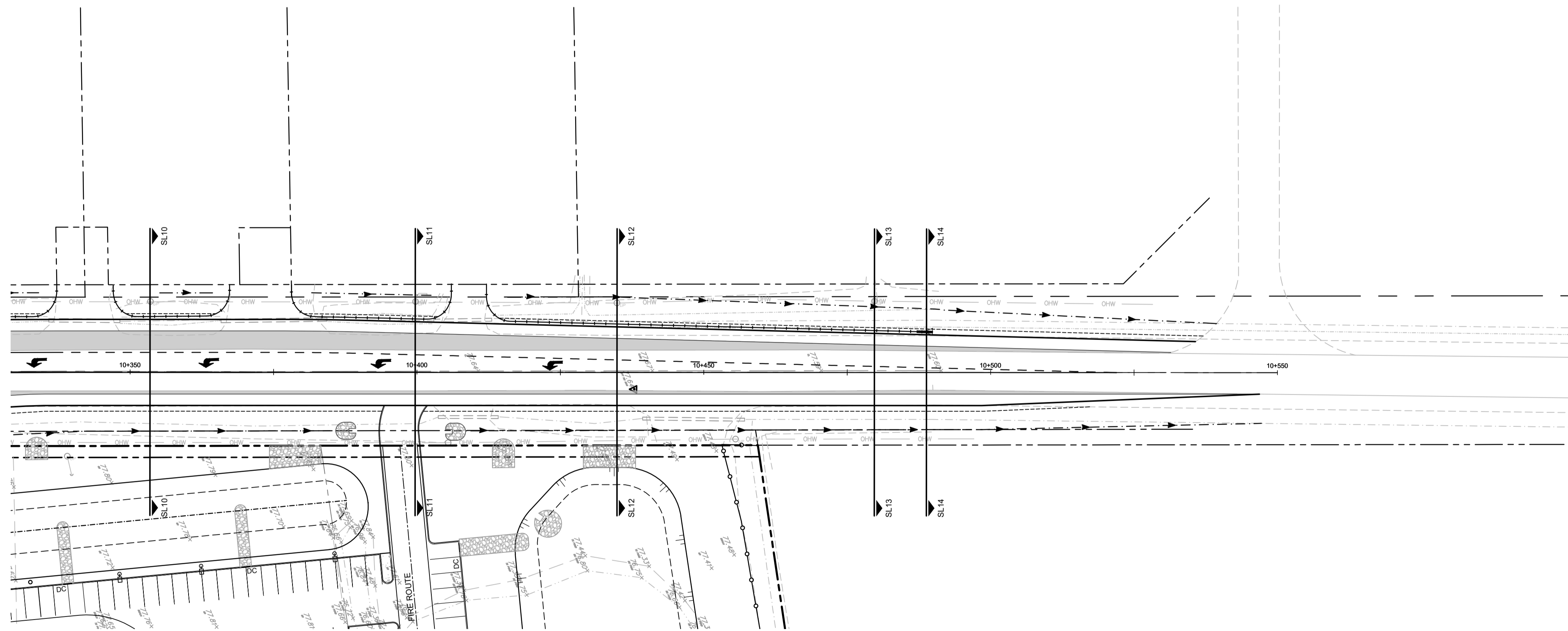
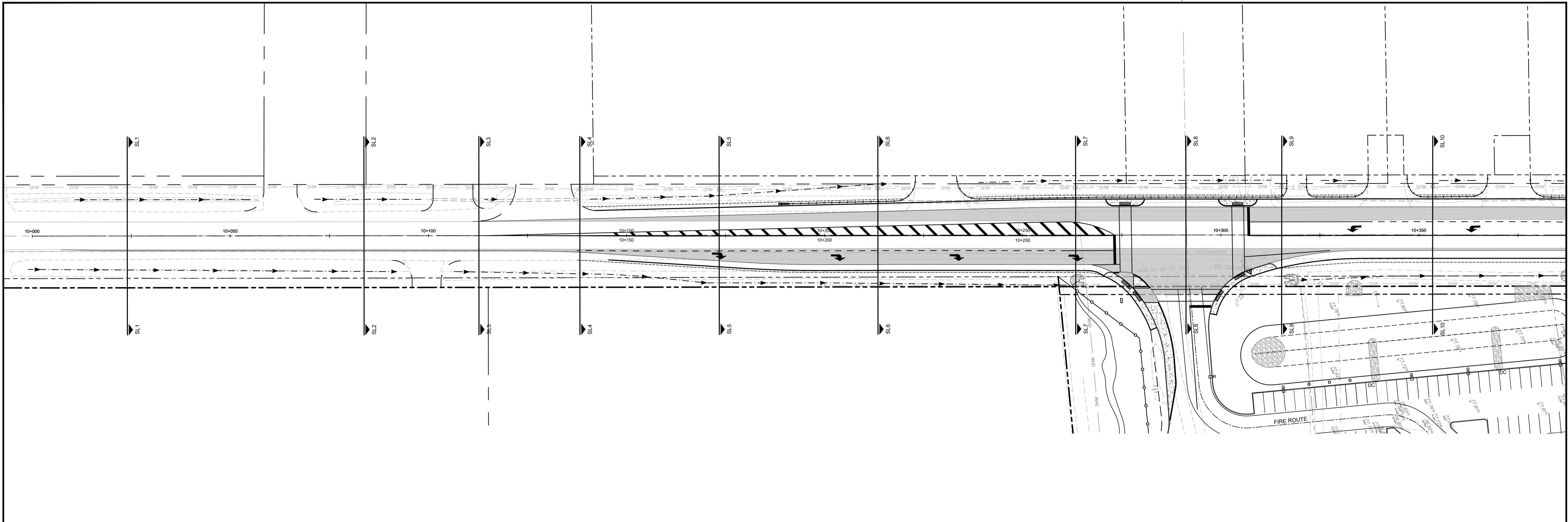

NOTE:
 THE POSITION OF ALL POLE LINES, CONDUITS,
 WATERMANS, SEWERS AND OTHER
 UNDERGROUND AND OVERGROUND UTILITIES AND
 STRUCTURES IS NOT NECESSARILY SHOWN ON
 THE CONTRACT DRAWINGS, AND WHERE SHOWN,
 THE ACCURACY OF THE POSITION OF SUCH
 UTILITIES AND STRUCTURES IS NOT GUARANTEED.
 BEFORE STARTING WORK, DETERMINE THE EXACT
 LOCATION OF ALL SUCH UTILITIES AND
 STRUCTURES AND ASSUME ALL LIABILITY FOR
 DAMAGE TO THEM.

No.	REVISION	DATE	BY
1.	ISSUED FOR CITY REVIEW	MARCH 5/26	JLL

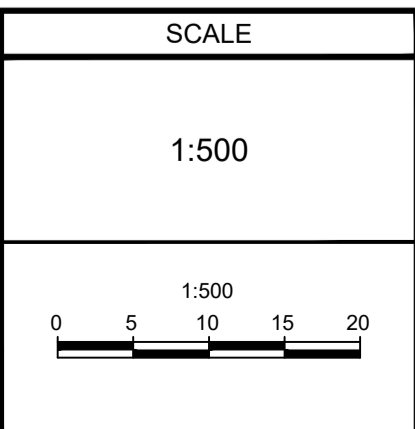

DESIGN	RJK
CHECKED	MJH/JLL
DRAWN	RJK
CHECKED	MJH/JLL
APPROVED	JLL

FOR REVIEW ONLY

NOVATECH
 Engineers, Planners & Landscape Architects
 Suite 200, 240 Michael Cowpland Drive
 Ottawa, Ontario, Canada K2M 1P6

Telephone (613) 254-9643
 Facsimile (613) 254-5867
 Website www.novatech-eng.com

LOCATION
 CITY OF OTTAWA
 5510 BOUNDARY ROAD MODIFICATION

DRAWING NAME
 TYPICAL CROSS SECTION
 OVERALL PLAN

PROJECT No.	118168
REV	REV # 1
DRAWING No.	118168-RMA-XSECO

M:\2018\118168\CAD\DESIGN\FIGURES\TRAFFIC\118168-XSEC.DWG 3/5/2026 2:29 PM - RKARGUS

RMA# RMA-2024-TPD-004

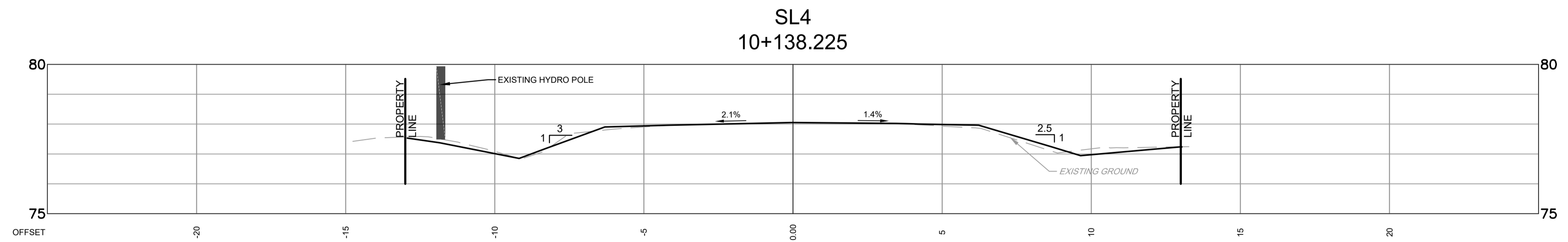
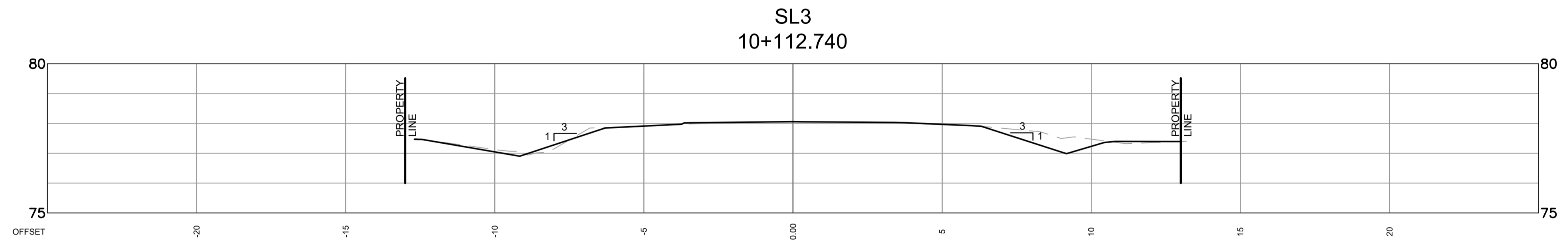
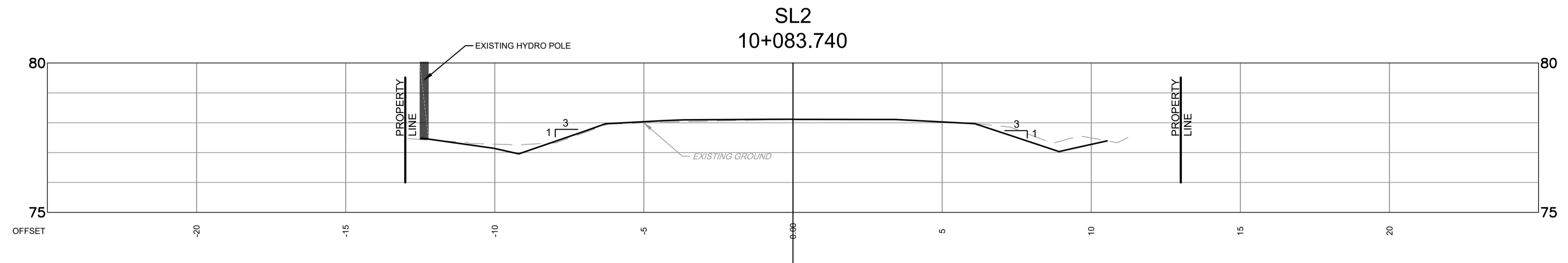
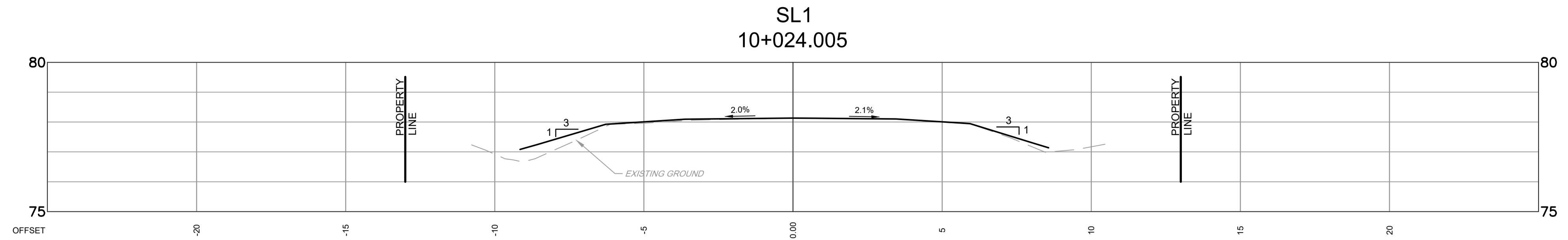

NOTE:
THE POSITION OF ALL POLE LINES, CONDUITS, WATERMANS, SEWERS AND OTHER UNDERGROUND AND OVERGROUND UTILITIES AND STRUCTURES IS NOT NECESSARILY SHOWN ON THE CONTRACT DRAWINGS, AND WHERE SHOWN, THE ACCURACY OF THE POSITION OF SUCH UTILITIES AND STRUCTURES IS NOT GUARANTEED. BEFORE STARTING WORK, DETERMINE THE EXACT LOCATION OF ALL SUCH UTILITIES AND STRUCTURES AND ASSUME ALL LIABILITY FOR DAMAGE TO THEM.

No.	REVISION	DATE	BY
1.	ISSUED FOR CITY REVIEW	MARCH 5/26	JLL

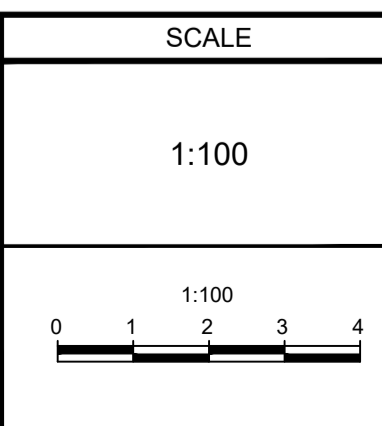

DESIGN	RJK
CHECKED	MJH/JLL
DRAWN	RJK
CHECKED	MJH/JLL
APPROVED	JLL

FOR REVIEW ONLY

NOVATECH
Engineers, Planners & Landscape Architects
Suite 200, 240 Michael Cowpland Drive
Ottawa, Ontario, Canada K2M 1P6
Telephone (613) 254-9643
Facsimile (613) 254-5867
Website www.novatech-eng.com

LOCATION CITY OF OTTAWA 5510 BOUNDARY ROAD MODIFICATION	
DRAWING NAME TYPICAL CROSS SECTION SL1 TO SL4	
PROJECT No. 118168	REV # 1
DRAWING No. 118168-RMA-XSEC	

M:\2018\118168\CAD\DESIGN\FIGURES\TRAFFIC\118168-XSEC.DWG 3/5/2026 2:29 PM - RKARGUS

RMA# RMA-2024-TPD-004

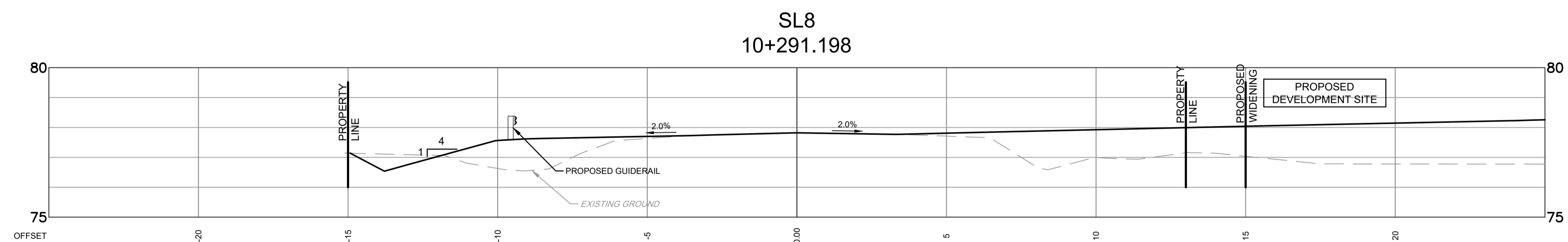
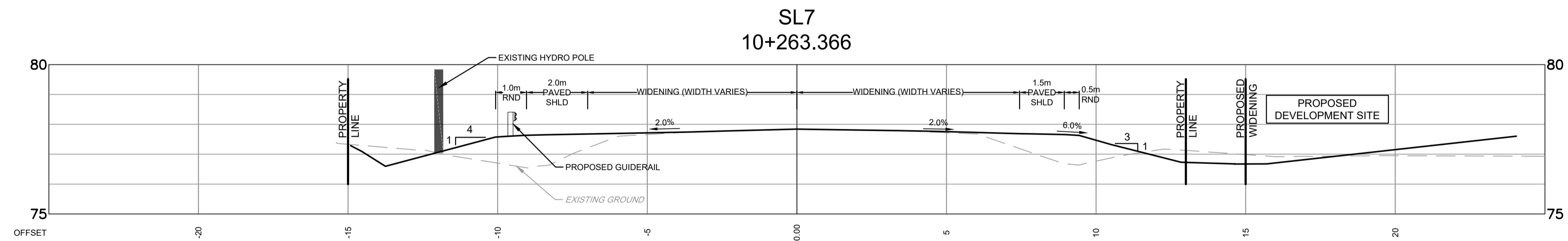
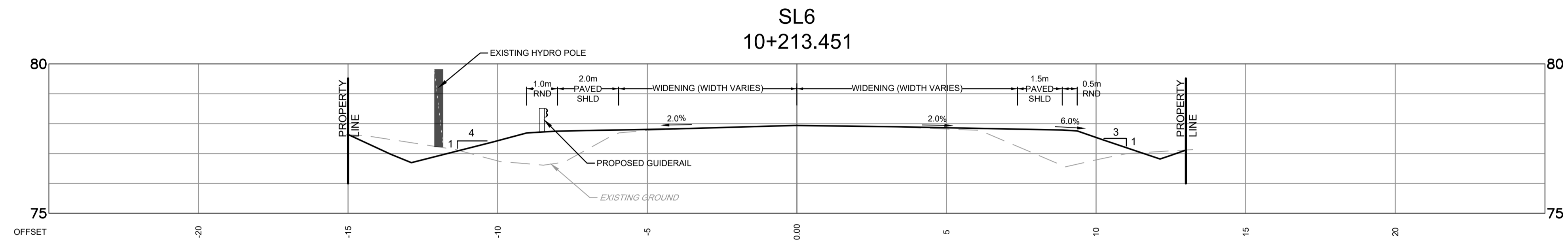
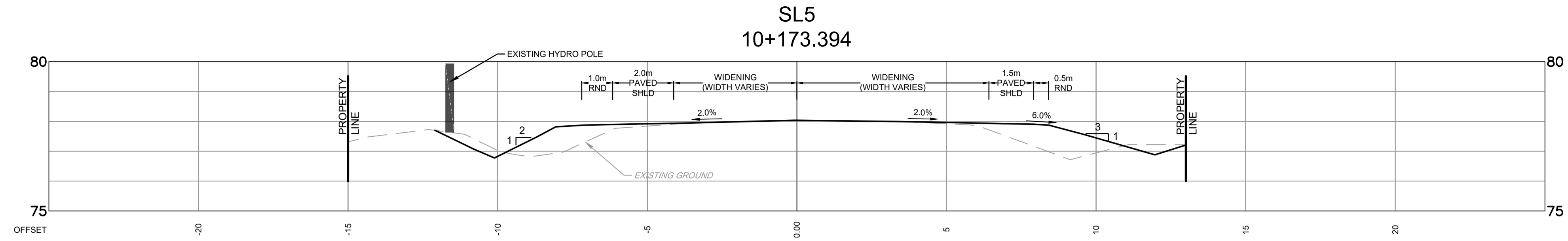

NOTE:
THE POSITION OF ALL POLE LINES, CONDUITS, WATERMANS, SEWERS AND OTHER UNDERGROUND AND OVERGROUND UTILITIES AND STRUCTURES IS NOT NECESSARILY SHOWN ON THE CONTRACT DRAWINGS, AND WHERE SHOWN, THE ACCURACY OF THE POSITION OF SUCH UTILITIES AND STRUCTURES IS NOT GUARANTEED. BEFORE STARTING WORK, DETERMINE THE EXACT LOCATION OF ALL SUCH UTILITIES AND STRUCTURES AND ASSUME ALL LIABILITY FOR DAMAGE TO THEM.

No.	REVISION	DATE	BY
1.	ISSUED FOR CITY REVIEW	MARCH 5/26	JLL

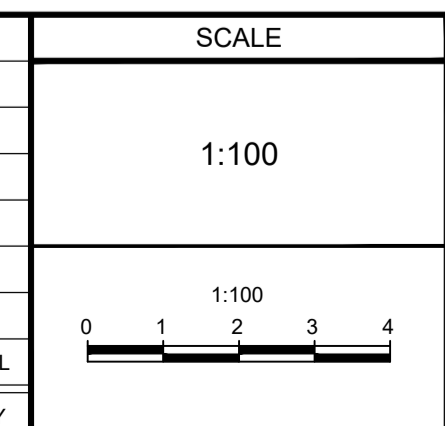

DESIGN	RJK
CHECKED	MJH/JLL
DRAWN	RJK
CHECKED	MJH/JLL
APPROVED	JLL

FOR REVIEW ONLY

NOVATECH
Engineers, Planners & Landscape Architects
Suite 200, 240 Michael Cowpland Drive
Ottawa, Ontario, Canada K2M 1P6

Telephone (613) 254-9643
Facsimile (613) 254-5867
Website www.novatech-eng.com

LOCATION CITY OF OTTAWA 5510 BOUNDARY ROAD MODIFICATION	
DRAWING NAME TYPICAL CROSS SECTION SL5 TO SL8	
PROJECT No. 118168	REV # 1
DRAWING No. 118168-RMA-XSEC2	

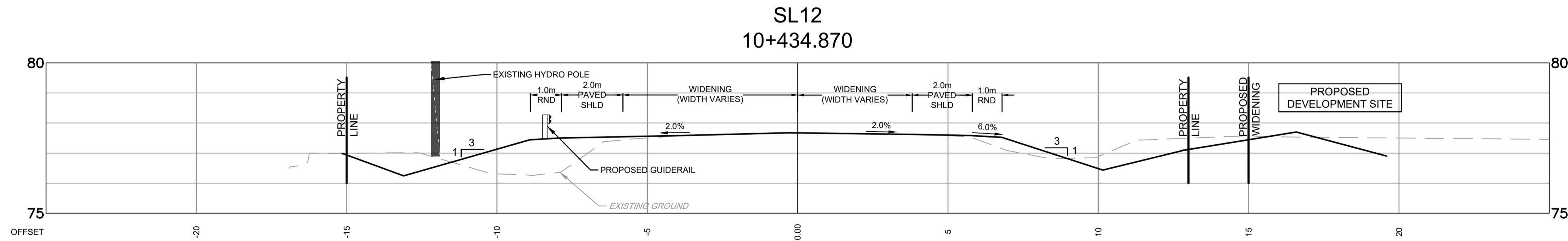
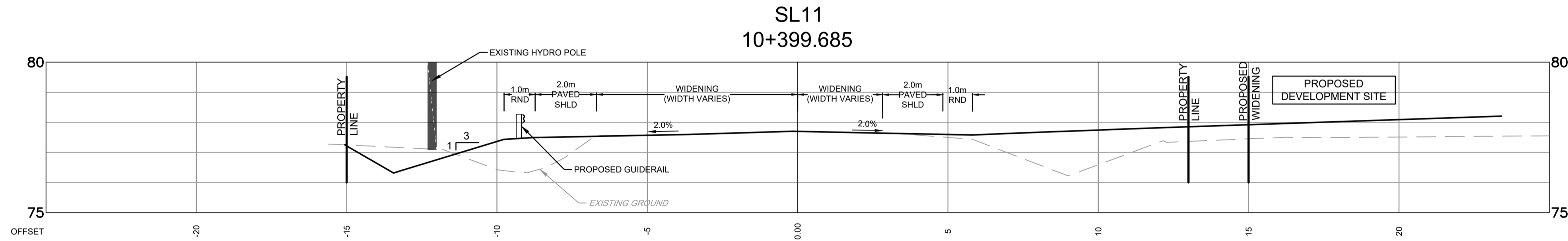
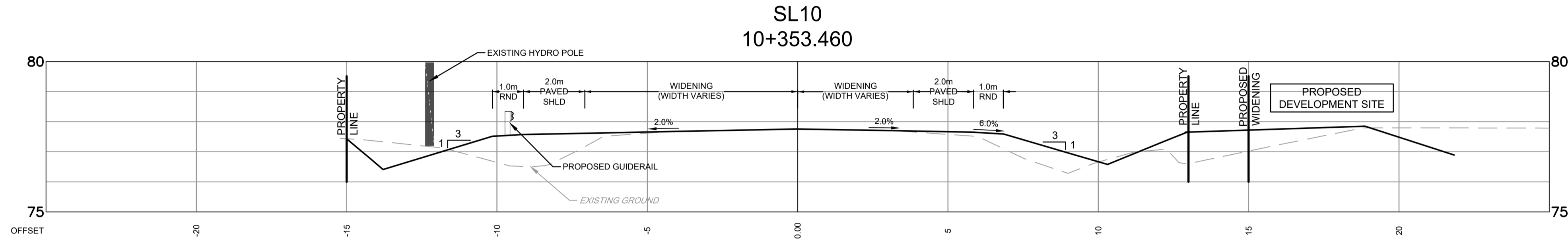
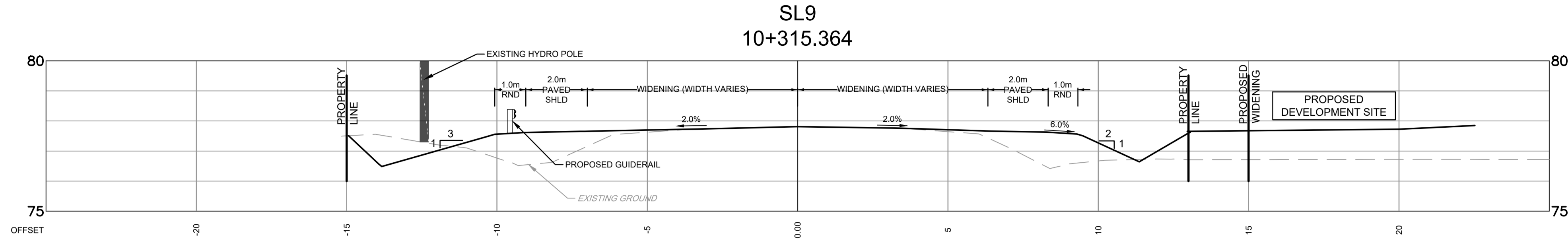

NOTE:
THE POSITION OF ALL POLE LINES, CONDUITS, WATERMANS, SEWERS AND OTHER UNDERGROUND AND OVERGROUND UTILITIES AND STRUCTURES IS NOT NECESSARILY SHOWN ON THE CONTRACT DRAWINGS, AND WHERE SHOWN, THE ACCURACY OF THE POSITION OF SUCH UTILITIES AND STRUCTURES IS NOT GUARANTEED. BEFORE STARTING WORK, DETERMINE THE EXACT LOCATION OF ALL SUCH UTILITIES AND STRUCTURES AND ASSUME ALL LIABILITY FOR DAMAGE TO THEM.

No.	REVISION	DATE	BY
1.	ISSUED FOR CITY REVIEW	MARCH 5/26	JLL

DESIGN	RJK
CHECKED	MJH/JLL
DRAWN	RJK
CHECKED	MJH/JLL
APPROVED	JLL

FOR REVIEW ONLY	

NOVATECH
Engineers, Planners & Landscape Architects
Suite 200, 240 Michael Cowpland Drive
Ottawa, Ontario, Canada K2M 1P6
Telephone (613) 254-9643
Facsimile (613) 254-5867
Website www.novatech-eng.com

LOCATION
CITY OF OTTAWA
5510 BOUNDARY ROAD MODIFICATION
DRAWING NAME
TYPICAL CROSS SECTION
SL9 TO SL12

PROJECT No.	118168
REV	REV # 1
DRAWING No.	118168-RMA-XSEC3

SL13
10+479.732

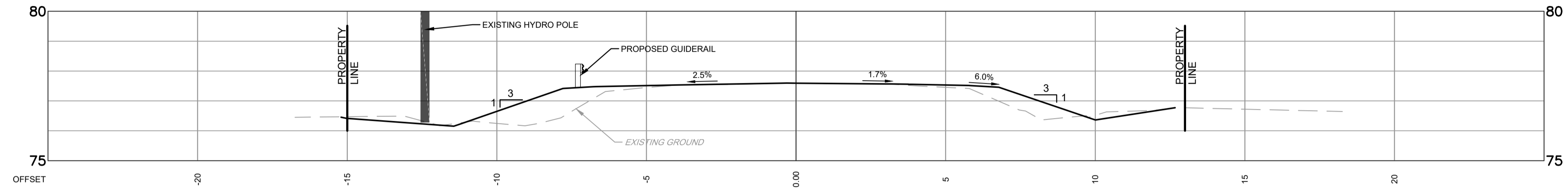

SL14
10+488.807

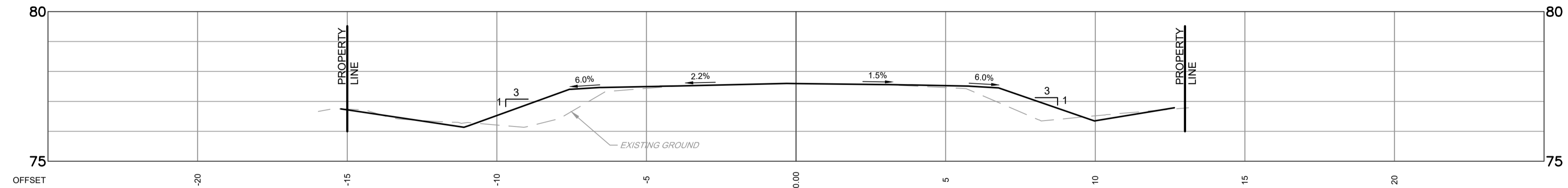

NOTE:
THE POSITION OF ALL POLE LINES, CONDUITS,
WATERMANS, SEWERS AND OTHER
UNDERGROUND AND OVERGROUND UTILITIES AND
STRUCTURES IS NOT NECESSARILY SHOWN ON
THE CONTRACT DRAWINGS, AND WHERE SHOWN,
THE ACCURACY OF THE POSITION OF SUCH
UTILITIES AND STRUCTURES IS NOT GUARANTEED.
BEFORE STARTING WORK, DETERMINE THE EXACT
LOCATION OF ALL SUCH UTILITIES AND
STRUCTURES AND ASSUME ALL LIABILITY FOR
DAMAGE TO THEM.

No.	REVISION	DATE	BY
1.	ISSUED FOR CITY REVIEW	MARCH 5/26	JLL

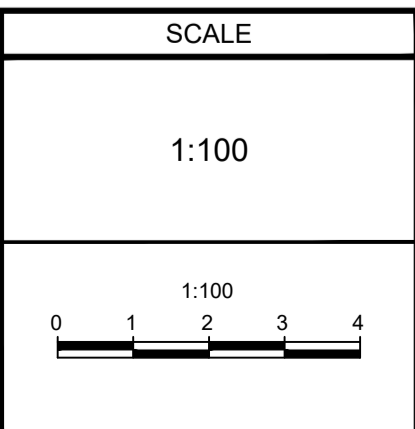

DESIGN	RJK
CHECKED	MJH/JLL
DRAWN	RJK
CHECKED	MJH/JLL
APPROVED	JLL

NOVATECH
Engineers, Planners & Landscape Architects
Suite 200, 240 Michael Cowpland Drive
Ottawa, Ontario, Canada K2M 1P6

Telephone (613) 254-9643
Facsimile (613) 254-5867
Website www.novatech-eng.com

LOCATION		PROJECT No.
CITY OF OTTAWA 5510 BOUNDARY ROAD MODIFICATION		118168
DRAWING NAME		REV
TYPICAL CROSS SECTION SL13 AND SL14		REV # 1
DRAWING No.		118168-RMA-XSEC4

M:\2018\118168\CADD\DESIGN\FIGURES\TRAFFIC\118168-XSEC.DWG 3/5/2026 2:29 PM - RKARGUS

RMA# RMA-2024-TPD-004