

Contractor shall check all dimensions on the work and report any discrepancy to the Landscape Architect before proceeding. All drawings and specifications are the property of the Landscape Architect and must be returned at the completion of the work. This drawing is not to be used for construction until signed by the Landscape Architect.

**LEGEND**

PROPERTY LINE

**PLANTING**

- LARGE DECIDUOUS TREE
- MEDIUM TREE (<7m)
- SMALL TREE (<7m)
- CONIFEROUS TREE
- PLANT LIST A
- PLANT LIST B
- PLANT LIST C
- PLANT LIST D
- SOD

**SURFACING**

- UNIT PAVER TYPE 1
- UNIT PAVER TYPE 2
- CONCRETE PATTERN 1
- CONCRETE

**PLANTING KEY**

- TREE SPECIES
- QUANTITY
- SHRUB SPECIES
- QUANTITY

**DETAIL KEY**

- DETAIL NO.
- SHEET NO.

No.	Description	Date
6	Issued for Sixth Submission	26-05-15
5	Issued for Fifth Submission	25-05-16
4	Issued for Fourth Submission	24-09-10
3	Issued for Third Submission	24-05-23
2	Issued for Second Submission	24-03-14
1	Issued for Site Plan Approval	23-05-15
No.	Revision	Date
	City Approval Stamp	

- GENERAL NOTES:**
- ALL DIMENSIONS IN MILLIMETERS UNLESS SPECIFIED OTHERWISE. DO NOT SCALE DRAWING. ALL DRAWINGS TO BE READ IN CONJUNCTION WITH WRITTEN SPECIFICATIONS.
  - THIS DRAWING MAY NOT BE USED FOR CONSTRUCTION UNTIL SIGNED BY THE LANDSCAPE ARCHITECT. IT IS THE RESPONSIBILITY OF THE CONTRACTOR TO:
    - CHECK AND VERIFY ALL DIMENSIONS ON SITE
    - REPORT ALL ERRORS AND/OR OMISSIONS TO THE CONTRACT ADMINISTRATOR
    - COMPLY WITH ALL PERTINENT CODES AND BY-LAWS
    - CHECK AND VERIFY LOCATIONS OF ALL UNDERGROUND SERVICES WITH ALL LOCAL UTILITIES PRIOR TO ANY DIGGING
  - ANY AREAS BEYOND THE LIMIT OF THE SITE DISTURBED DURING CONSTRUCTION SHALL BE RESTORED TO ORIGINAL CONDITION OR BETTER TO THE SATISFACTION OF THE AUTHORITY HAVING JURISDICTION AT THE CONTRACTOR'S EXPENSE.
  - ALL WORK SHALL BE COMPLETED IN ACCORDANCE WITH THE 'OCCUPATIONAL HEALTH AND SAFETY ACT AND REGULATIONS FOR CONSTRUCTION PROJECTS'. THE GENERAL CONTRACTOR SHALL BE DEEMED TO BE THE 'CONSTRUCTOR' AS DEFINED IN THE ACT.
  - THERE WILL BE NO SUBSTITUTION OF MATERIALS UNLESS PRIOR WRITTEN APPROVAL IS RECEIVED FROM THE CONTRACT ADMINISTRATOR.
  - THE CONTRACTOR IS RESPONSIBLE FOR OBTAINING ALL PERMITS REQUIRED AND TO BEAR THE COST OF THE SAME.
  - BENCHMARKS: IT IS THE RESPONSIBILITY OF THE CONTRACTOR TO VERIFY THAT THE SITE BENCHMARK(S) HAS NOT BEEN ALTERED OR DISTURBED AND THAT ITS RELATIVE ELEVATION AND DESCRIPTION AGREES WITH THE INFORMATION DEPICTED ON THIS PLAN.

**NAK design strategies**

1285 WELLINGTON STREET, OTTAWA, ON K1Y 3A8 CANADA  
 T 613.237.2345 [NAKDESIGNSTRATEGIES.COM](http://NAKDESIGNSTRATEGIES.COM)  
 Project

**265 CATHERINE STREET**  
OTTAWA ONTARIO

Title		LAYOUT PLAN GROUND FLOOR
Date	2023-02-03	Sheet
Scale	1:250	<b>L01</b>
Drawn	JC/E	
Checked	SC	
Job No.	23-015	

Contractor shall check all dimensions on the work and report any discrepancy to the Landscape Architect before proceeding. All drawings and specifications are the property of the Landscape Architect and must be returned at the completion of the work. This drawing is not to be used for construction until signed by the Landscape Architect.

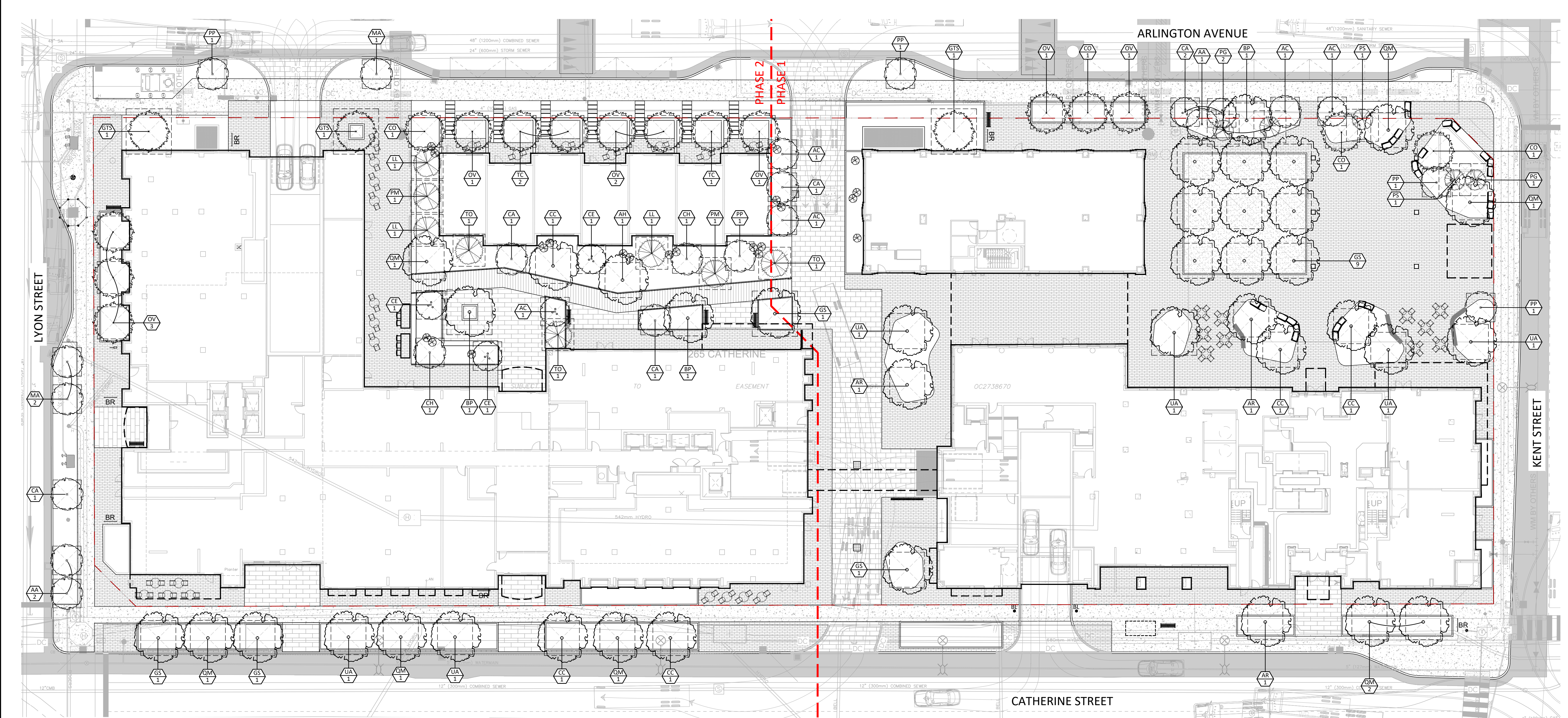

**LEGEND**

--- PROPERTY LINE

**PLANTING**

- LARGE DECIDUOUS TREE
- MEDIUM TREE (<7m)
- SMALL TREE (<7m)
- CONIFEROUS TREE
- PLANT LIST A
- PLANT LIST B
- PLANT LIST C
- PLANT LIST D
- SOD

**SURFACING**

- UNIT PAVER TYPE 1
- UNIT PAVER TYPE 2
- CONCRETE PATTERN 1
- CONCRETE

**PLANTING KEY**

- TREE SPECIES
- QUANTITY
- SHRUB SPECIES
- QUANTITY

**DETAIL KEY**

- DETAIL NO. 1
- SHEET NO. D1

No.	Description	Date
6	Issued For Sixth Submission	26-05-15
5	Issued For Fifth Submission	25-05-16
4	Issued For Fourth Submission	24-09-10
3	Issued For Third Submission	24-05-23
2	Issued For Second Submission	24-03-14
1	Issued For Site Plan Approval	23-05-15
Revision		
City Approval Stamp		

KEY	BOTANICAL NAME	COMMON NAME	QUANTITY	SIZE	REMARKS
<b>CANOPY PLANTING PALETTE</b>					
<b>DECIDUOUS TREES - 50-60mm</b>					
AH	AESCLUSUS HIPPOCASTANUM	HORSECHESNUT TREE	1	60mm	B&B
AR	ACER RUBRUM	RED MAPLE	3	60mm	B&B
BP	BETULA Papyrifera	PAPER BIRCH	3	60mm	B&B
CC	CARYA CORDIFORMIS	BITTERNUT HICKORY	5	60mm	B&B
CO	CELTIS OCCIDENTALIS	COMMON HACKBERRY	4	60mm	B&B
GS	GLEDITSIA TRIACANTHOS VAR. INERMIS	HONEYLOCUST	13	60mm	B&B
GTS	GLEDITSIA TRIACANTHOS VAR. INERMIS 'STREET KEPPER'	STREET KEEPER HONEYLOCUST	3	50mm	B&B
QM	QUERCUS MACROCARPA	BUR OAK	8	60mm	B&B
TC	TILIA CORDATA CORINTHIAN	CORINTHIAN LINDEN	3	60mm	B&B
UA	ULMUS AMERICANA 'VALLEY FORGE'	VALLEY FORGE ELM	6	60mm	B&B
<b>DECIDUOUS TREES - 40mm</b>					
AA	AMELANCHIER ALNIFOLIA	SASKATOON BERRY	3	40mm	B&B
AC	AMELANCHIER CANADENSIS	SERVICEBERRY	5	40mm	B&B
CA	CORNUS ALTERNIFOLIA	ALTERNATE LEAVED DOGWOOD	6	40mm	B&B
CE	CERCIS CANADENSIS	EASTERN REDBUD	3	40mm	B&B
CH	CARPINUS CAROLINIANA	HORNBEAM	2	40mm	B&B
MA	MALUS SPP	CRAB APPLES	3	40mm	B&B
OV	OSTRYA VIRGINIANA	IRONWOOD	9	40mm	B&B
PP	PRUNUS PENNSYLVANICA	PIN CHERRY	5	40mm	B&B
<b>CONIFEROUS TREES</b>					
LL	LARIX LARICINA (M)	TAMARACK	3	180cm	B&B
TO	THUJA OCCIDENTALIS (M)	EASTERN WHITE CEDAR	3	180cm	B&B
PG	PICEA GLAUCA	WHITE SPRUCE	3	125cm	B&B
PM	PICEA MARIANA (M)	BLACK SPRUCE	2	180cm	B&B
PS	PINUS STROBUS	WHITE PINE	2	125cm	B&B

TREE TYPE/SIZE	SINGLE TREE SOIL VOLUME (m3)	MULTIPLE TREE SOIL VOLUME (m3/TREE)
ORNAMENTAL	15	9
COLUMNAR	15	9
SMALL	20	12
MEDIUM	25	15
LARGE	30	18
CONIFER	25	15

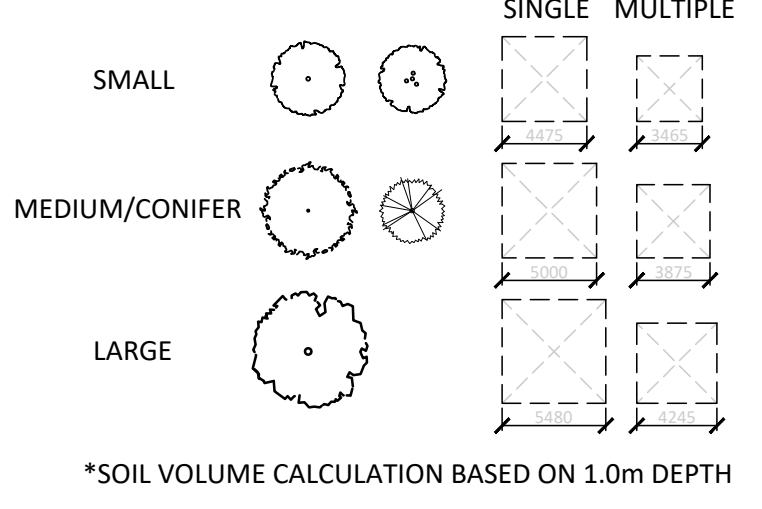

**NAK**  
design strategies

1285 WELLINGTON STREET, OTTAWA, ON K1Y 3A8 CANADA  
T 613.237.2345  
Project

**265 CATHERINE STREET**  
OTTAWA ONTARIO

Title		<b>CANOPY PLANTING PLAN GROUND FLOOR</b>
Date	2023-02-03	Sheet
Scale	1:250	<b>L02</b>
Drawn	JC/IE	
Checked	SC	
Job No.	23-015	

Contractor shall check all dimensions on the work and report any discrepancy to the Landscape Architect before proceeding. All drawings and specifications are the property of the Landscape Architect and must be returned at the completion of the work. This drawing is not to be used for construction until signed by the Landscape Architect.

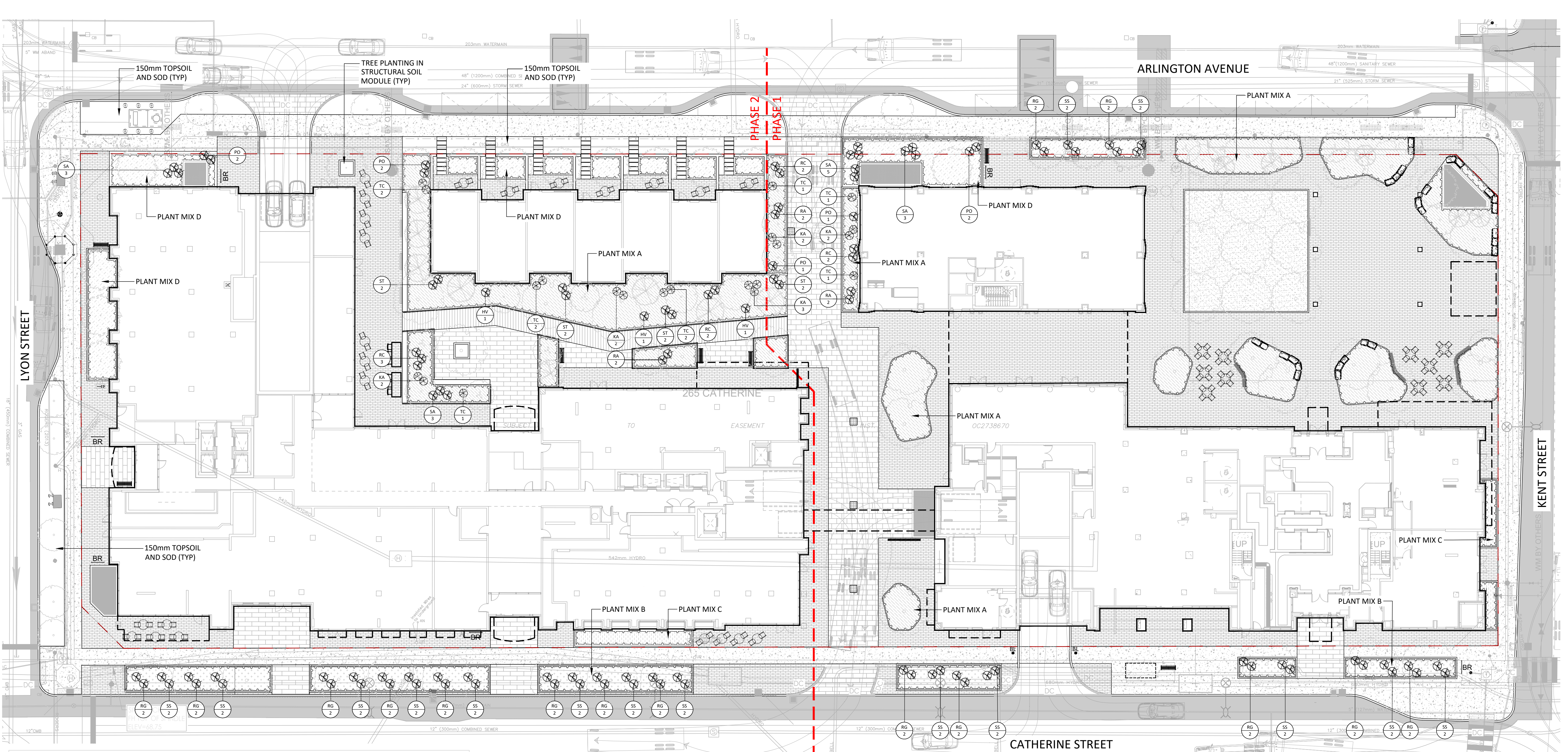

**LEGEND**

- PROPERTY LINE
- PLANTING**
- LARGE DECIDUOUS TREE
- MEDIUM TREE (<7m)
- SMALL TREE (<7m)
- CONIFEROUS TREE
- PLANT LIST A
- PLANT LIST B
- PLANT LIST C
- PLANT LIST D
- SOD
- SURFACING**
- UNIT PAVER TYPE 1
- UNIT PAVER TYPE 2
- CONCRETE PATTERN 1
- CONCRETE
- PLANTING KEY**
- TREE SPECIES
- QUANTITY
- SHRUB SPECIES
- QUANTITY
- DETAIL KEY**
- DETAIL NO.
- SHEET NO.

No.	Description	Date
6	Issued for Sixth Submission	26-05-15
5	Issued for Fifth Submission	25-05-16
4	Issued for Fourth Submission	24-09-10
3	Issued for Third Submission	24-05-23
2	Issued for Second Submission	24-03-14
1	Issued for Site Plan Approval	23-05-15

Revision  
City Approval Stamp

KEY	BOTANICAL NAME	COMMON NAME	QUANTITY	SIZE	REMARKS
<b>SHRUB AND PERENNIAL PLANTING PALETTE - AMENITY AREA (PART SUN/PART SHADE/SHADE) - MIX A (728m2)</b>					
<b>SHRUBS</b>					
RA	RIBES AUREUM	GOLDEN CURRANT	6	3 GAL.	POTTED
SA	SPIRAEA ALBA	MEADOWSWEET	3	3 GAL.	POTTED
ST	SPIRAEA TOMENTOSA	STEEPLEBUSH	8	3 GAL.	POTTED
PO	PHYSOCARPUS OPULIFOLIUS 'DIABLO'	EASTERN NINEBARK	4	3 GAL.	POTTED
HV	HAMMELIS VIRGINIANA	WITCHHAZEL	3	3 GAL.	POTTED
RC	RHODODENDRON CANADENSE	CANADIAN RHODODENDRON	9	3 GAL.	POTTED
KA	KALMIA ANGUSTIFOLIA	SHEEP LAUREL	11	3 GAL.	POTTED
TC	TAXUS CANADENSIS	CANADA YEW	10	3 GAL.	POTTED
<b>PERENNIALS</b>					
CC	CORNUS CANADENSIS	BUNCHBERRY	560	1 GAL.	POTTED
CP	COMPTONIA PEREGRINA	SWEETFERN	560	1 GAL.	POTTED
GM	GERANIUM MACULATUM	WILD GERANIUM	560	1 GAL.	POTTED
GP	GAULTHERIA PROCUMBENS	WINTERGREEN	560	1 GAL.	POTTED
SR	MAIANTHEMUM RACEMOSUM	FALSE SOLOMANS SEAL	560	1 GAL.	POTTED
SC	SYMPHYOTRICHUM CORDIFOLIUM (M)	HEART-LEAVED ASTER	560	1 GAL.	POTTED
OC	OSMUNDA CINNAMOMEA	CINNAMON FERN	560	1 GAL.	POTTED
SR	MAIANTHEMUM RACEMOSUM	FALSE SOLOMANS SEAL	560	1 GAL.	POTTED
AQ	AQUILEGIA CANADENSIS (M)	WILD COLUMBINE	560	1 GAL.	POTTED
AC	ANEMONE CANADENSIS (M)	CANADA ANEMONE	560	1 GAL.	POTTED
AF	ATHYRIUM FILIX-FEMINA	LADY FERN	560	1 GAL.	POTTED
AF	CAREX PENNSYLVANICA	OAK SEDGE	560	1 GAL.	POTTED
AF	CAREX APPALACHICA	APPALACHIAN SEDGE	560	1 GAL.	POTTED

KEY	BOTANICAL NAME	COMMON NAME	QUANTITY	SIZE	REMARKS
<b>PERENNIAL PLANTING PALETTE - BUILDING PLANTERS (FULL SUN) - MIX B (240m2)</b>					
<b>PERENNIALS</b>					
BC	BOUTELOUA CURTIPENDULA	SIDEOATS GRAMA	300	1 GAL.	POTTED
MF	MONARDA FITULOSA	WILD BERGAMOT	300	1 GAL.	POTTED
SH	SPOROBOLUS HETEROLEPIS	PRAIRIE DROPSEED	300	1 GAL.	POTTED
RH	RUDBEKIA HIRTA	BLACK EYED SUSAN	300	1 GAL.	POTTED
AL	ARTEMISIA LUDOVICIANA	SAGEBRUSH	300	1 GAL.	POTTED
EP	ECHINACEA PURPUREA	PURPLE CONEFLOWER	300	1 GAL.	POTTED
SC	SCHIZACHYRIUM SCOPARIUM	LITTLE BLUESTEM	300	1 GAL.	POTTED
CL	COREOPSIS LANCEOLATA	LANCELEAF TICK-SEED	300	1 GAL.	POTTED

KEY	BOTANICAL NAME	COMMON NAME	QUANTITY	SIZE	REMARKS
<b>SHRUB &amp; PERENNIAL PLANTING - ROW (FULL SUN) - MIX C (38m2)</b>					
<b>PERENNIALS</b>					
RG	RHUS AROMATICA GRO-LOW	GRO-LOW SUMAC	9	3 GAL.	POTTED
SS	SORBARIA SORBIFOLIA SEM	SEM FALSE SPIRAEA	9	3 GAL.	POTTED
SH	SPOROBOLUS HETEROLEPIS	PRAIRIE DROPSEED	190	1 GAL.	POTTED
BC	BOUTELOUA CURTIPENDULA	SIDEOATS GRAMA	190	1 GAL.	POTTED

KEY	BOTANICAL NAME	COMMON NAME	QUANTITY	SIZE	REMARKS
<b>SHRUB AND PERENNIAL PLANTING PALETTE - BUILDING PLANTERS (PART SUN/PART SHADE/SHADE) - MIX D (226m2)</b>					
<b>SHRUBS</b>					
SA	SPIRAEA ALBA	MEADOWSWEET	8	3 GAL.	POTTED
PO	PHYSOCARPUS OPULIFOLIUS 'DIABLO'	EASTERN NINEBARK	4	3 GAL.	POTTED
<b>PERENNIALS</b>					
AC	ANEMONE CANADENSIS (M)	CANADA ANEMONE	565	1 GAL.	POTTED
AF	ATHYRIUM FILIX-FEMINA	LADY FERN	565	1 GAL.	POTTED
AF	CAREX PENNSYLVANICA	OAK SEDGE	565	1 GAL.	POTTED
AF	CAREX APPALACHICA	APPALACHIAN SEDGE	565	1 GAL.	POTTED

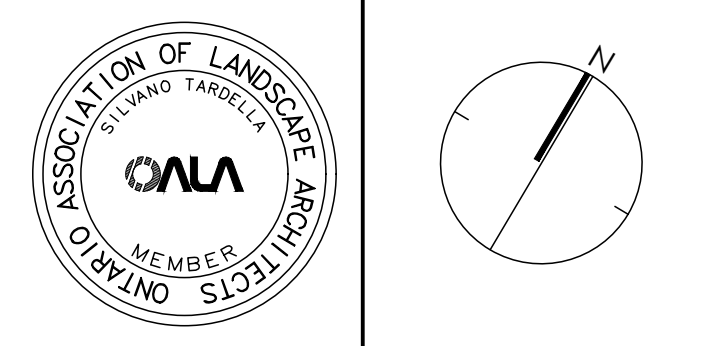

**NAK**  
design strategies  
1285 WELLINGTON STREET, OTTAWA, ON K1Y 3A8 CANADA  
T 613.237.2345  
Project

**265 CATHERINE STREET**  
OTTAWA ONTARIO

Title  
**SHRUB & PERENNIAL PLANTING PLAN**  
GROUND FLOOR

Date	2023-02-03	Sheet	<b>L03</b>
Scale	1:250		
Drawn	JC/IE		
Checked	SC		
Job No.	23-015		

Contractor shall check all dimensions on the work and report any discrepancy to the Landscape Architect before proceeding. All drawings and specifications are the property of the Landscape Architect and must be returned at the completion of the work. This drawing is not to be used for construction until signed by the Landscape Architect.

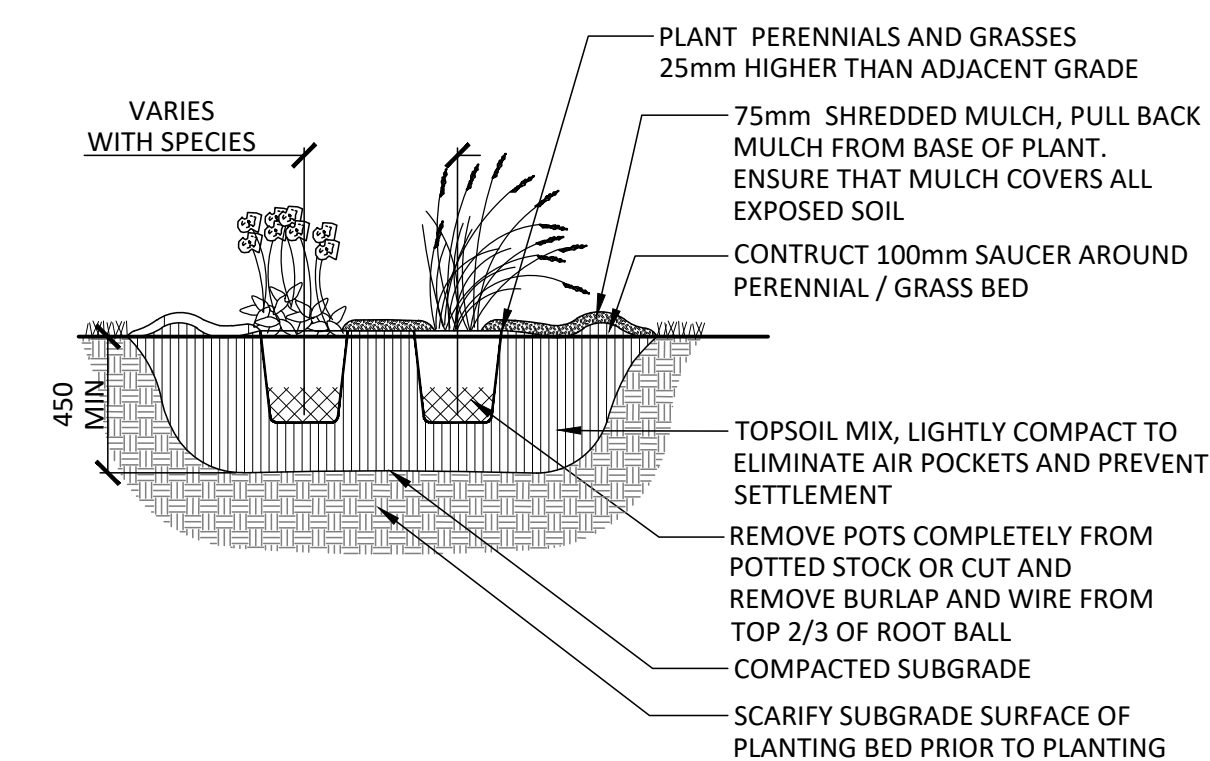
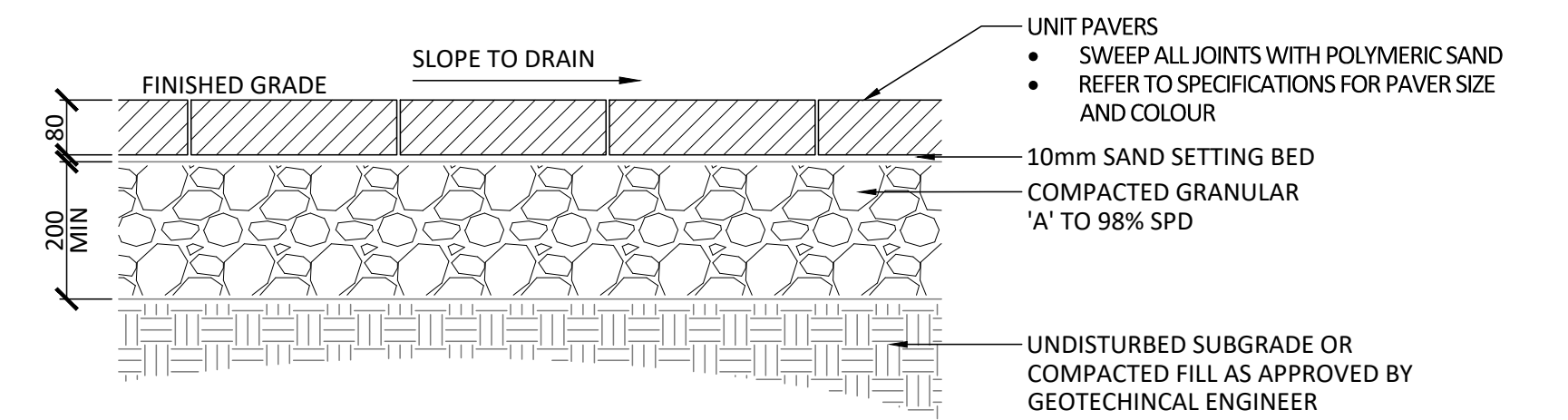
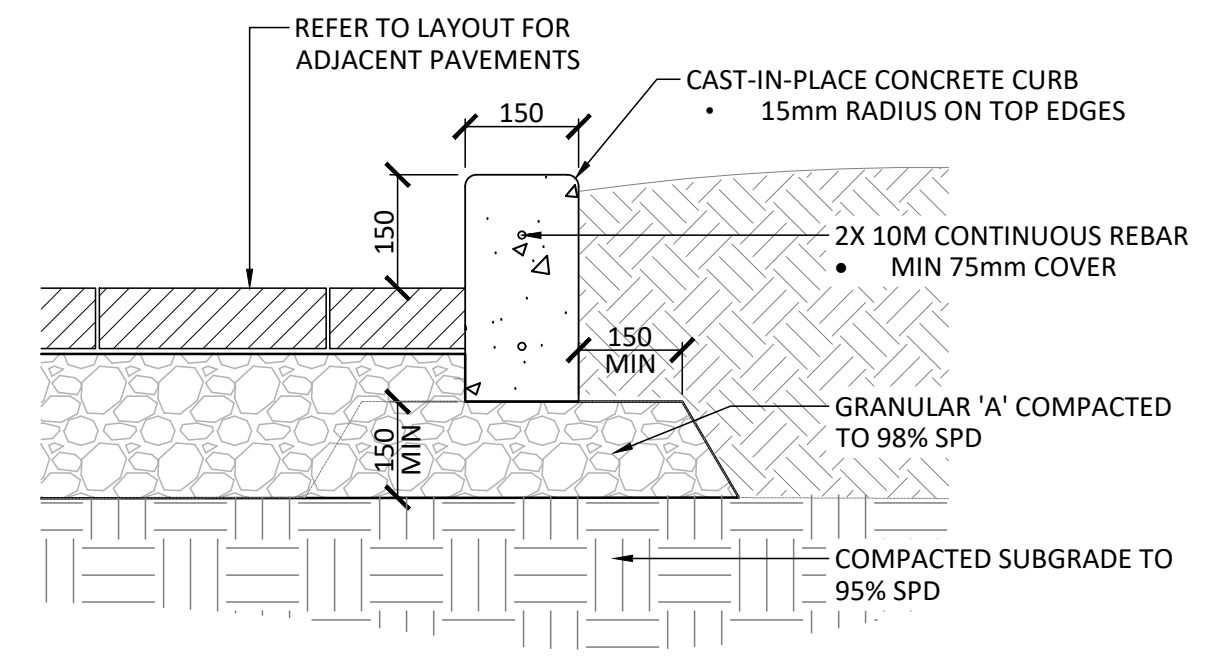
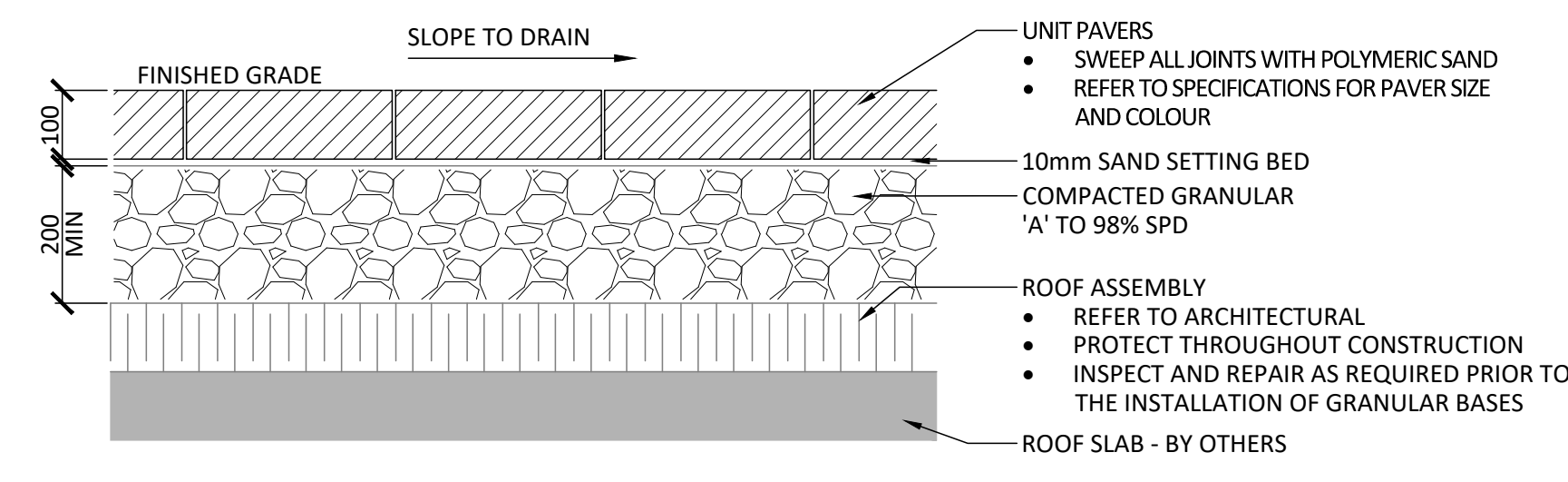

**NOTES:**  
1. TOPSOIL MIXTURE AND SHREDDED MULCH AS PER SPECIFICATION.  
2. PROVIDE 100mm HIGH EARTH SAUCER AROUND PERENNIAL/GRASS BED.

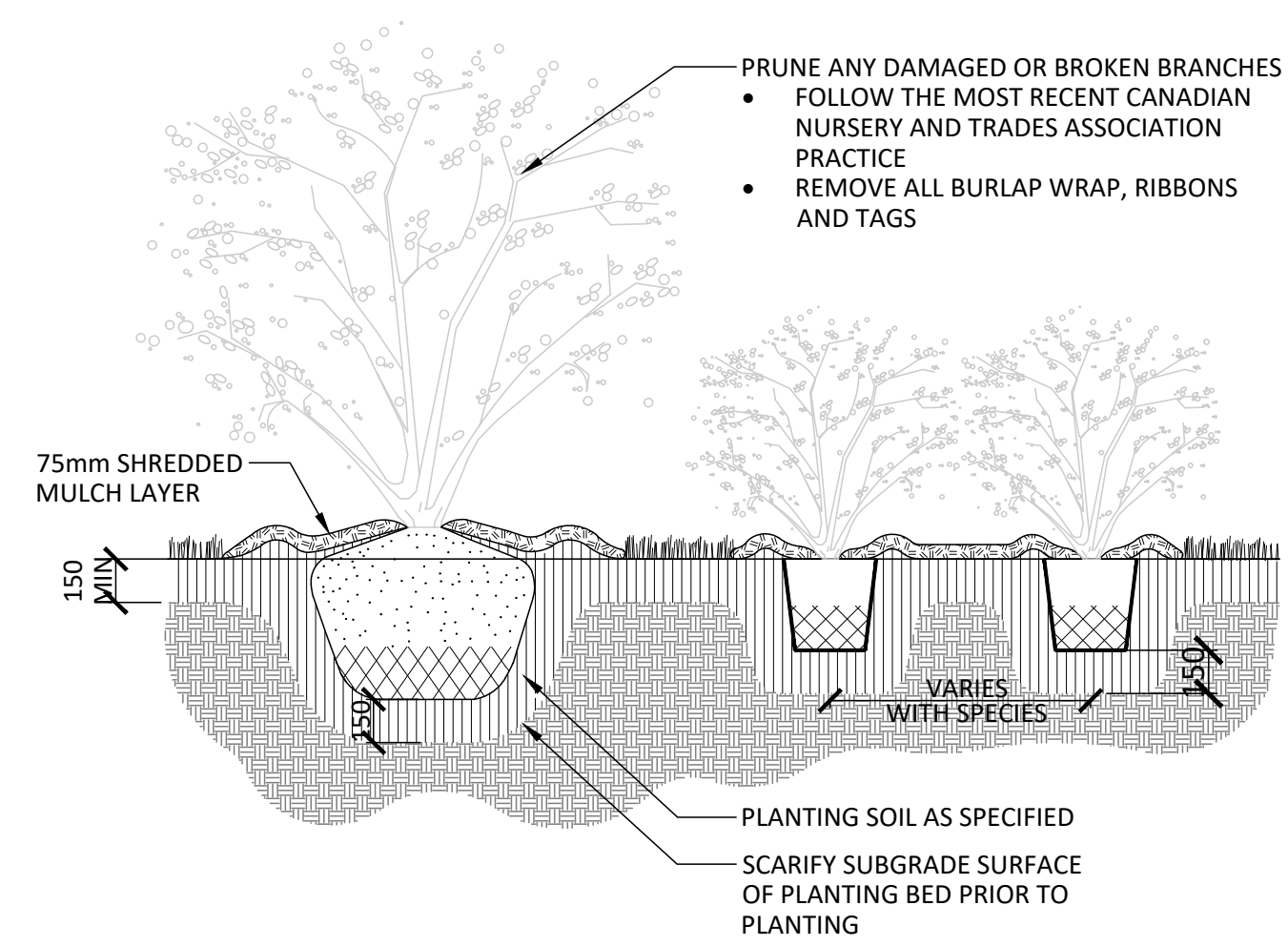
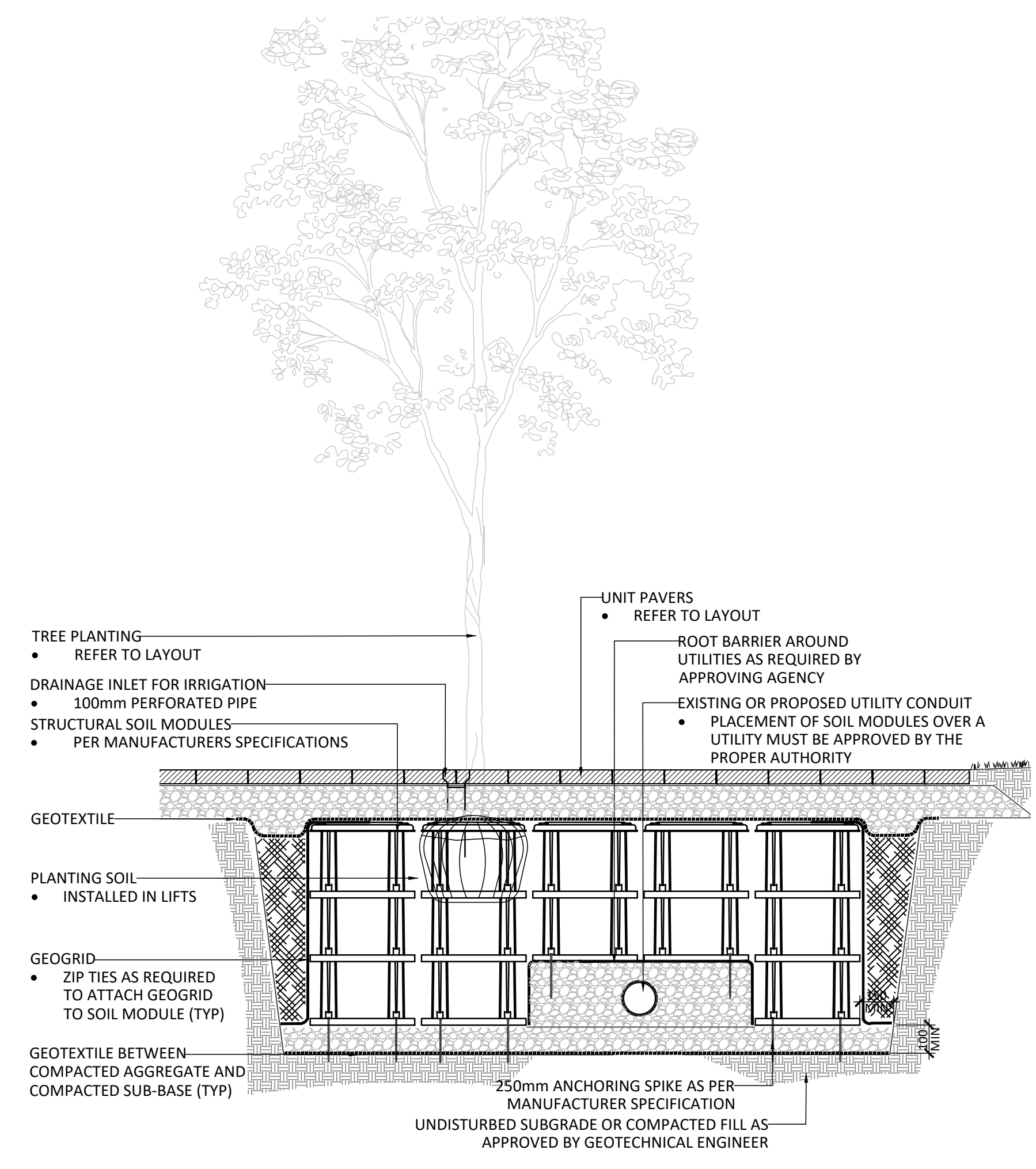

**NOTES:**  
1. SHRUBS SPECIFIED TO BE PLANTED SO THAT ROOTS ARE FULLY EXTENDED IN PLANTING HOLE WITH SOIL MIX BACKFILLED CAREFULLY TO PREVENT ROOT DAMAGE  
2. PROVIDE 100mm HIGH EARTH SAUCER AROUND SHRUB BED

No.	Description	Date
6	Issued for Sixth Submission	26-05-15
5	Issued for Fifth Submission	25-05-16
4	Issued for Fourth Submission	24-09-10
3	Issued for Third Submission	24-05-23
2	Issued for Second Submission	24-05-06
1	Issued for Site Plan Approval	23-05-15

Revision  
City Approval Stamp



**NAK** design strategies  
1285 WELLINGTON STREET, OTTAWA, ON K1Y 3A8 CANADA  
T 613.237.2345 NAKDESIGNSTRATEGIES.COM  
Project

256 CATHERINE STREET  
OTTAWA ONTARIO

Title  
DETAILS

Date	Scale	Drawn	Checked	Job No.	Sheet
2023-02-03	AS SHOWN	JE/MM	SC	23-015	L05

Contractor shall check all dimensions on the work and report any discrepancy to the Landscape Architect before proceeding. All drawings and specifications are the property of the Landscape Architect and must be returned at the completion of the work. This drawing is not to be used for construction until signed by the Landscape Architect.

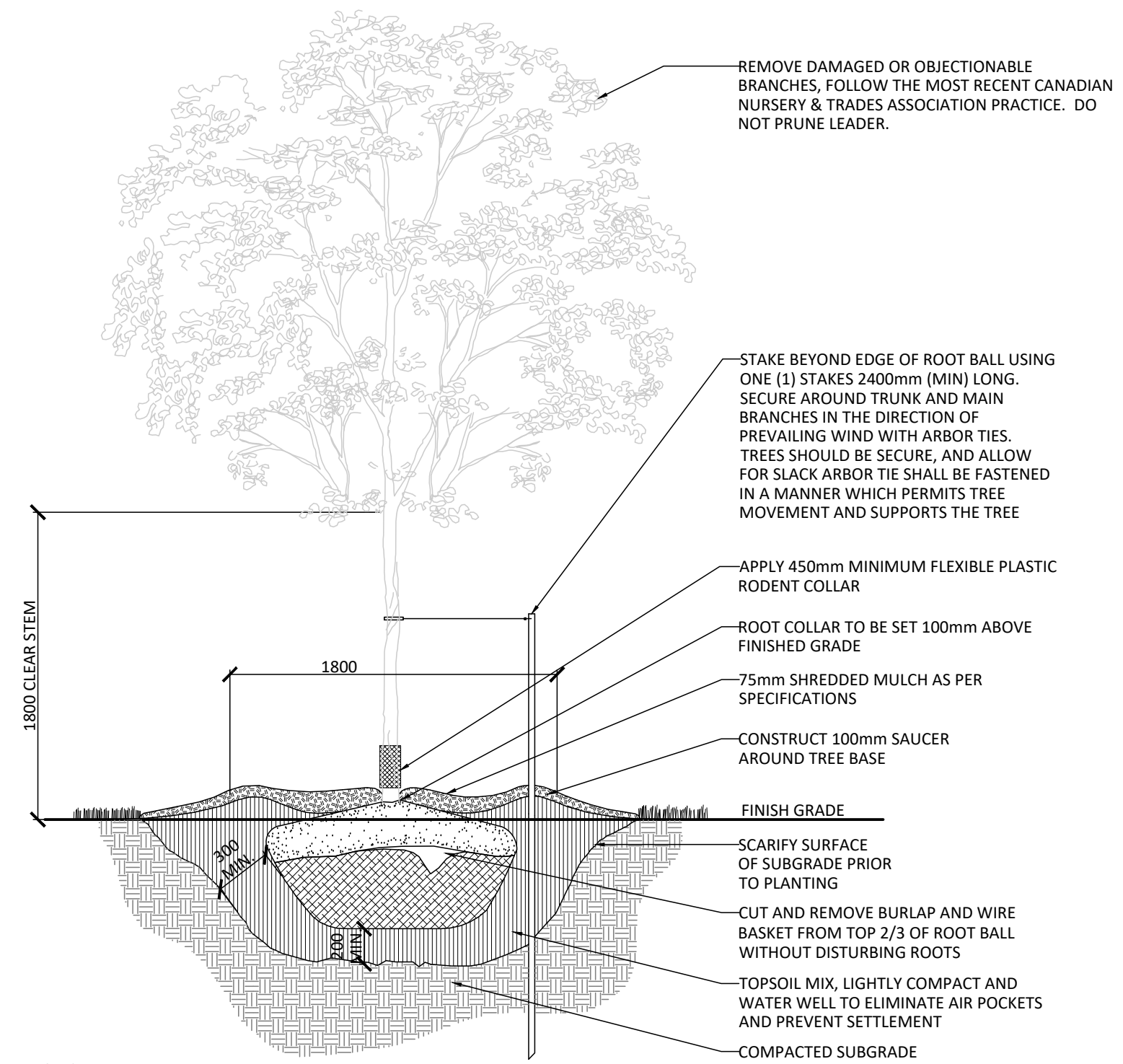

- NOTES:
1. REMOVE STAKE AFTER ONE YEAR OR UNTIL TAKEOVER, UNLESS OTHERWISE DIRECTED BY THE LANDSCAPE ARCHITECT.
  2. TOPSOIL MIXTURE AND SHREDDED MULCH AS PER SPECIFICATION
  3. REMOVE TREE WRAP AFTER PLANTING
  4. CALIPER TO BE MEASURED AT THE BASE OF TREE AT ROOT BALL.

1 DECIDUOUS TREE PLANTING (ONE STAKE W/ARBOR TIES)  
N.T.S.

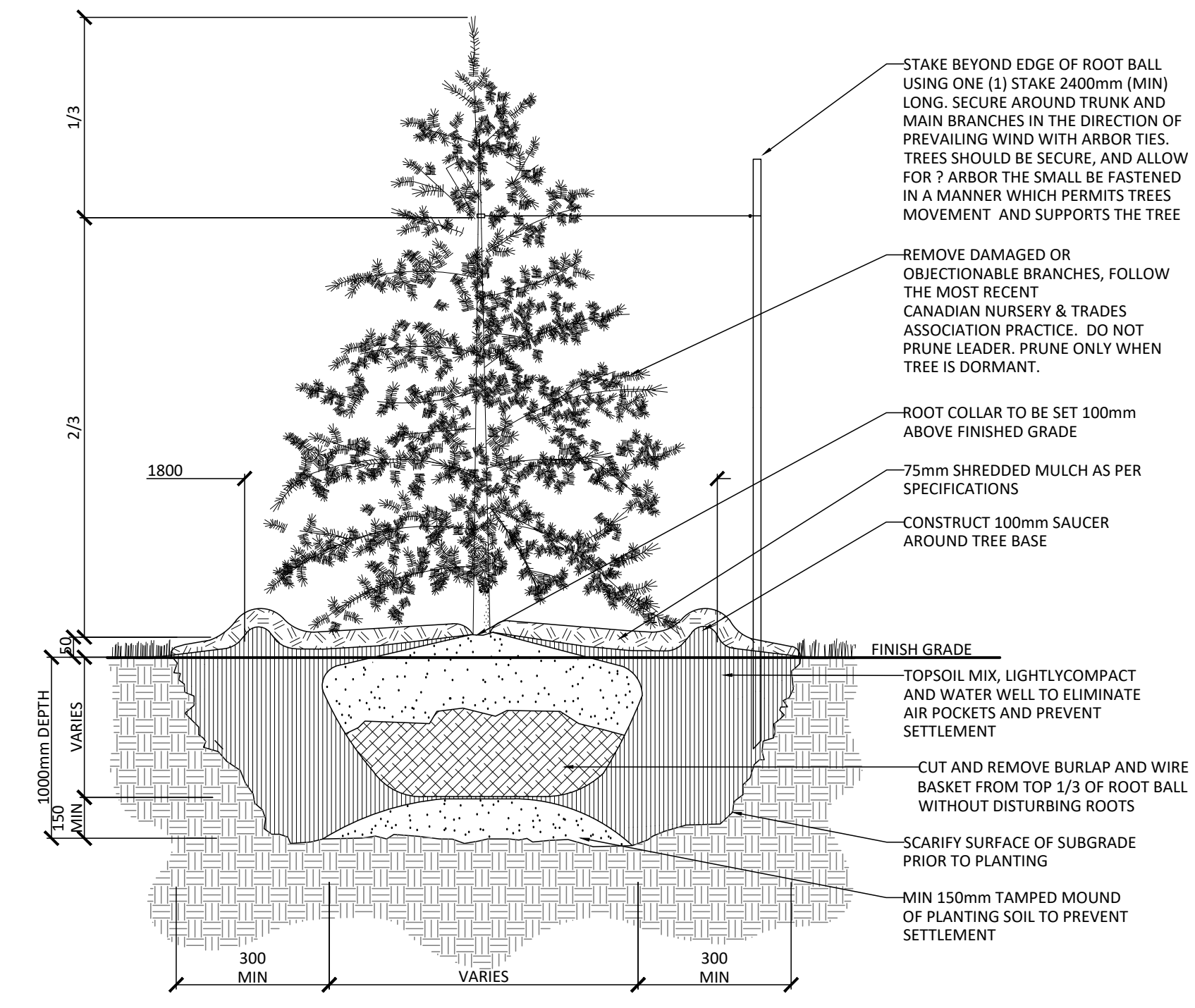

- NOTES:
1. REMOVE STAKE AFTER ONE YEAR OR UNTIL TAKEOVER UNLESS OTHERWISE DIRECTED BY THE LANDSCAPE ARCHITECT.
  2. TOPSOIL MIXTURE AND SHREDDED MULCH AS PER SPECIFICATION

3 CONIFEROUS TREE PLANTING (ONE STAKE W/ARBOR TIES)  
N.T.S.

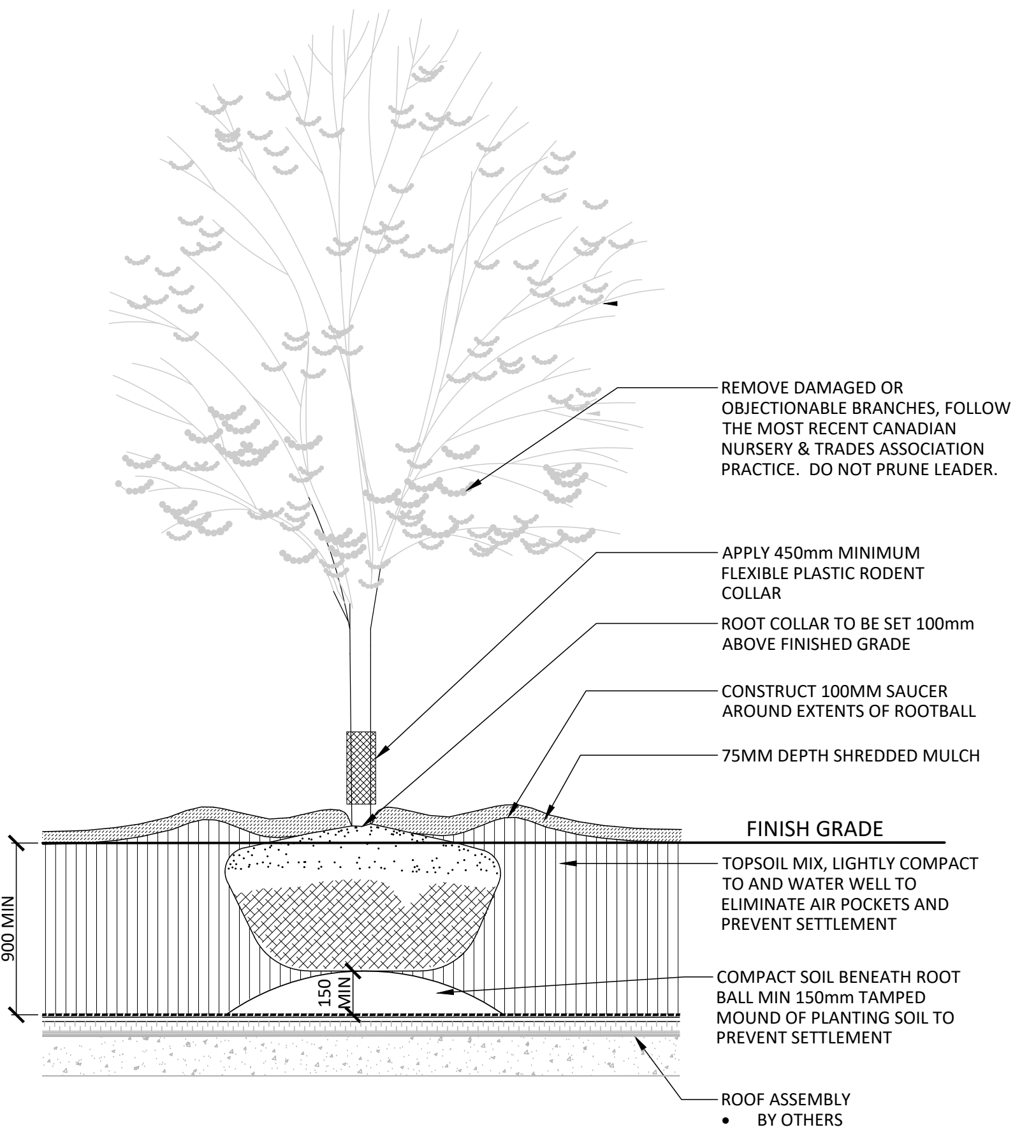

2 DECIDUOUS TREE PLANTING - ON SLAB  
N.T.S.

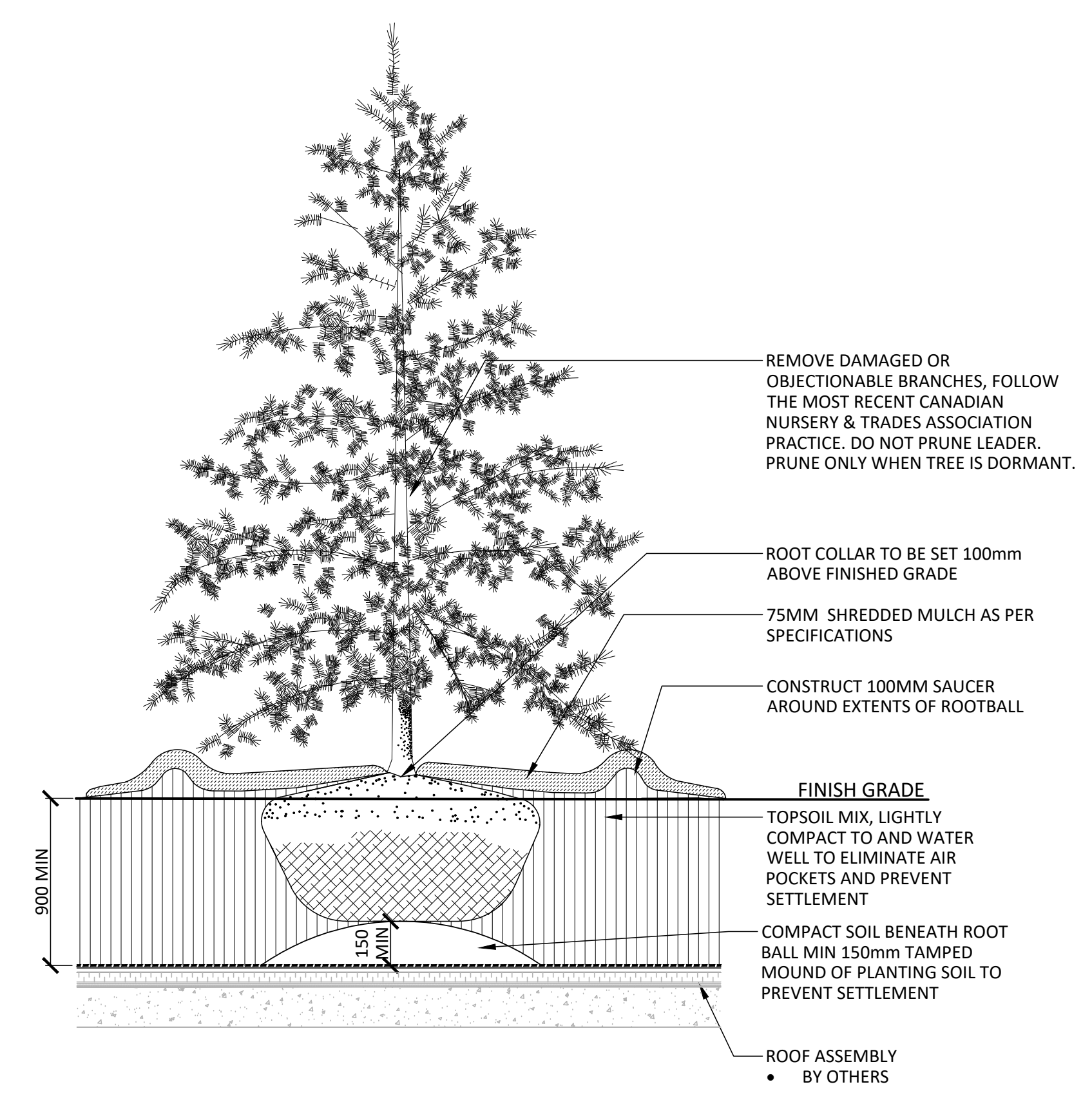

4 CONIFEROUS TREE PLANTING - ON SLAB  
N.T.S.

No.	Description	Date
6	Issued for Sixth Submission	26-05-15
5	Issued for Fifth Submission	25-05-16
4	Issued for Fourth Submission	24-09-10
3	Issued for Third Submission	24-05-23
2	Issued for Second Submission	24-05-06
1	Issued for Site Plan Approval	23-05-15

Revision

City Approval Stamp

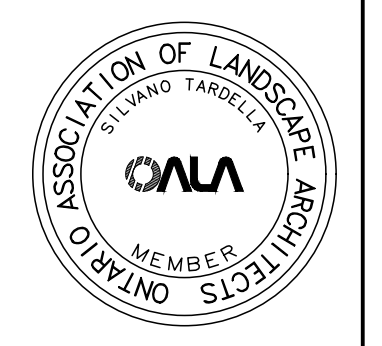

**NAK**  
design strategies

1285 WELLINGTON STREET, OTTAWA, ON K1Y 3A8 CANADA  
T 613.237.2345 NAKDESIGNSTRATEGIES.COM

256 CATHERINE STREET  
OTTAWA ONTARIO

Title

DETAILS

Date	2023-02-03	Sheet	L05
Scale	AS SHOWN		
Drawn	JE/MM		
Checked	SC		
Job No.	23-015		