

A Hamlin

ALLISON HAMLIN
 MANAGER, DEVELOPMENT REVIEW ALL WARDS
 PLANNING, DEVELOPMENT & BUILDING SERVICES
 DEPARTMENT, CITY OF OTTAWA

APPROVED

By Allison Hamlin at 1:51 pm, May 21, 2026

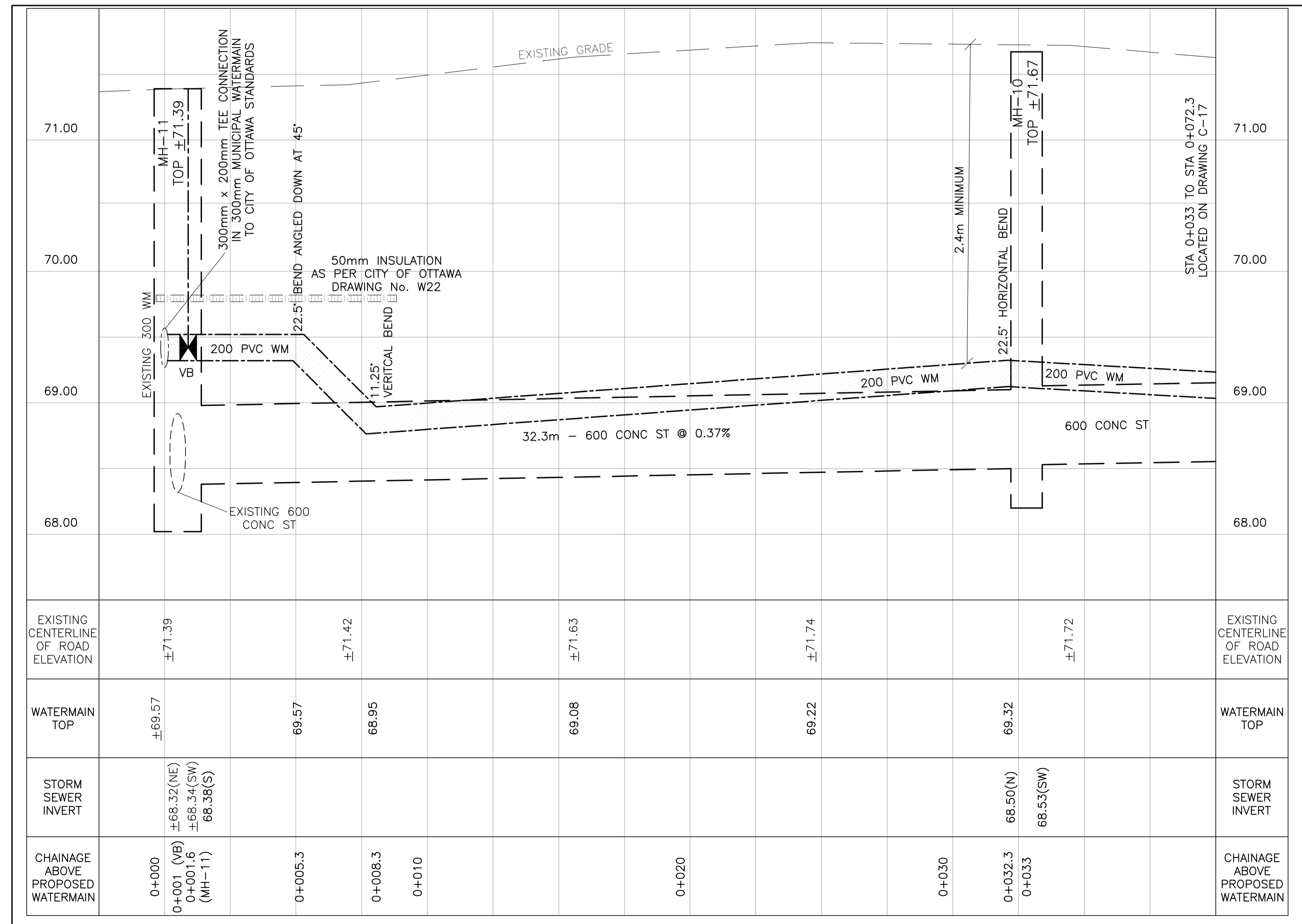
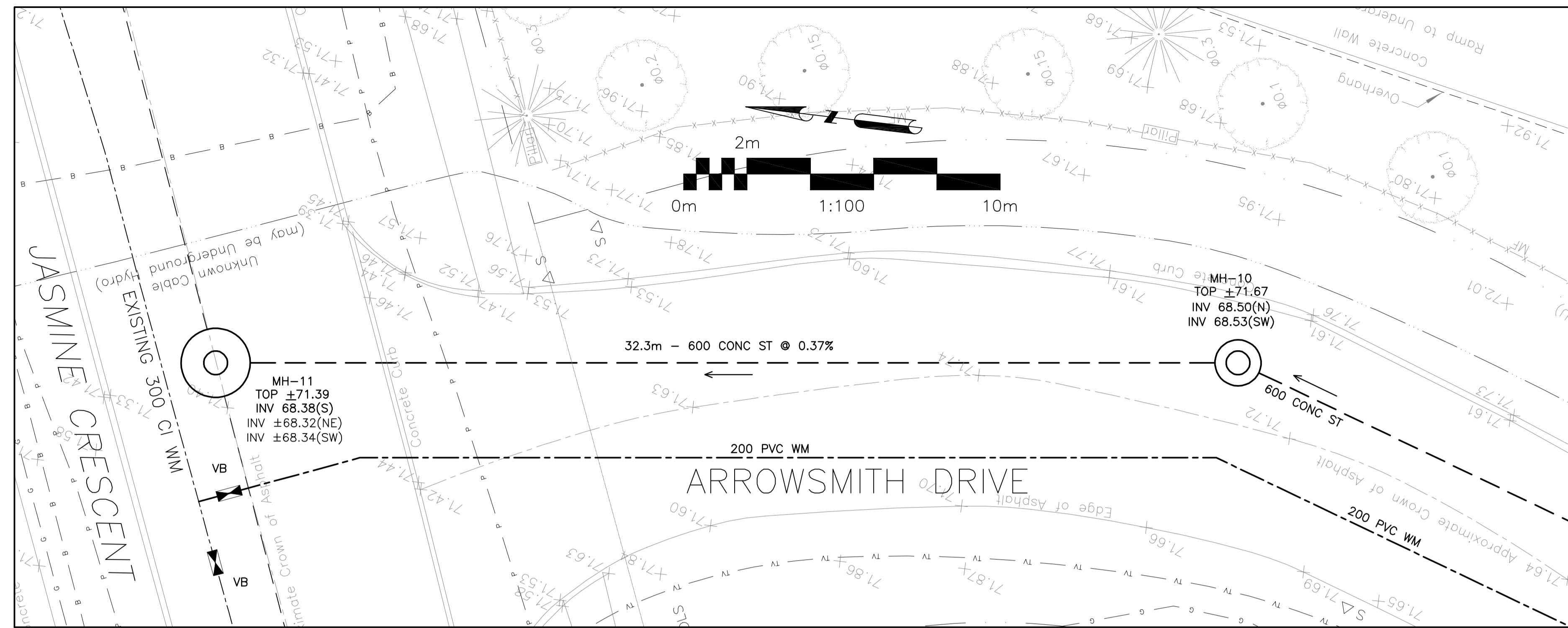

LEGEND

- FFL FINISHED FLOOR ELEVATION
- TOF TOP OF FOUNDATION
- BFL BASEMENT FLOOR ELEVATION
- USF UNDERSIDE OF FOOTING
- PROPERTY LINE
- C.R.Z. CRITICAL ROOT ZONE
- CB CATCH-BASIN
- MH STORM MANHOLE
- CB/MH CATCH-BASIN/MANHOLE
- MH SANITARY MANHOLE
- FH FIRE HYDRANT
- FDC FIRE DEPARTMENT CONNECTION
- VB VALVE & VALVE BOX
- WATER METER
- RM WATER METER
- SAN SANITARY SEWER
- ST STORM SEWER
- WS/WM WATER SERVICE/WATERMAIN
- OBV OVERTOP OF PIPE
- SPL SPRINGLINE OF PIPE
- INV INVERT OF PIPE

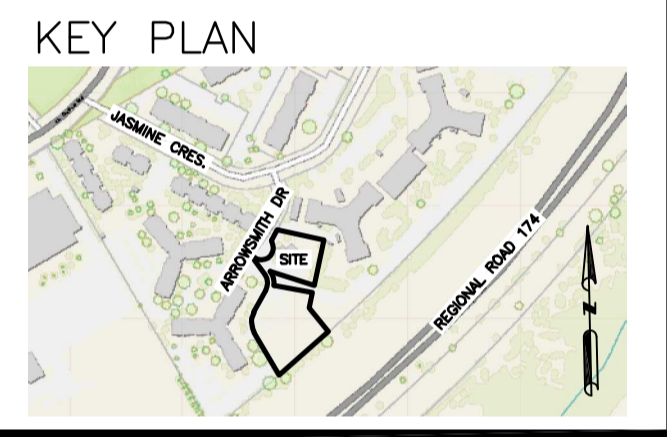

No.	DATE	REVISION
7	MAY 5-26	RE-ISSUED FOR APPROVAL
6	MAR 9-26	RE-ISSUED FOR APPROVAL
5	FEB 24-26	RE-ISSUED FOR APPROVAL
4	JAN 27-26	ISSUED FOR TENDER
3	DEC 10-25	RE-ISSUED FOR APPROVAL
2	JAN 17-25	ISSUED FOR ZONING
1	DEC 6-24	ISSUED FOR BUILDING PERMIT

D. B. GRAY ENGINEERING INC.
 Stormwater Management - Grading & Drainage - Storm & Sanitary Sewers - Watermain
 700 Long Point Circle 613-425-8044
 Ottawa, Ontario d.gray@dbgrayengineering.com

Project
PROPOSED 6-STORY MIXED-USE BUILDING
2040 ARROWSMITH DRIVE
 OTTAWA, ONTARIO

Drawing Title
PLAN AND PROFILE
 STA 0+000.0 TO 0+032.3

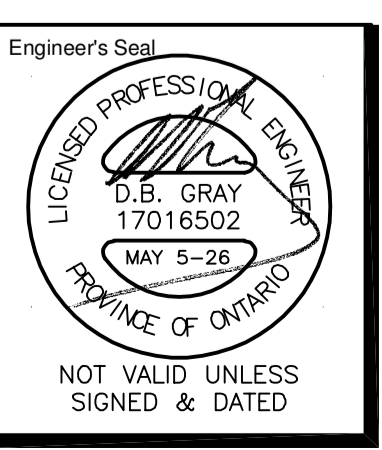

Drawn D.B.G.
 H. Scale 1:100
 V. Scale 1:20
 Date NOV 29-22
 Job No. 22062
 Drawing No.
C-16
 of 18

REFER TO NOTES, DETAILS & SCHEDULES ON DRAWINGS C-10 & C-11