

1Door4Care - CHEO Integrated Treatment Centre: Parking Garage

ISSUED FOR SPC SUBMISSION
2023-08-16

VOLUME 1 : LANDSCAPE

 **EllisDon**
INFRASTRUCTURE Healthcare



© 2023 Montgomery Sisam Architects Inc.
All rights reserved. No part of this document may
be reproduced or published in any form, without prior
written authorization by Montgomery Sisam Architects Inc.
2023-08-11 5:49:41 PM



Montgomery Sisam
ARCHITECTS INC.

ENTUITIVE

HHAngus

MODERN
NIAGARA

MULVEY & BANANI



WALTER FEDY

VERTTECHS
DESIGN
LANDSCAPE ARCHITECTS

trillium
architectural production ltd

VORTEX FIRE

CANETA Energy
A Division of Caneta Research Inc.

THE KESTON
ENVIRONMENTAL

Thornton
Tomasetti

Gensler

FOTENN

NOVATECH

THURBER

ARIUM

SHEET LIST - LANDSCAPE ARCHITECTURAL	
Sheet Number	Sheet Name
LP0000	SHEET LIST
LP0001	GENERAL LANDSCAPE AND KEY PLAN
LP0001	PARADE LANDSCAPE PLAN
LP0001	TREE PRESERVATION MEMORIAL PLAN
LP0010	PARADE LANDSCAPE UTILITY PLAN
LP0020	LANDSCAPE DETAILS



PROJECT NORTH (PN)

#	date	revision	by
3	2023-08-16	ISSUED FOR SPC APPLICATION	IWR
2	2023-07-31	ISSUED FOR 90% DD SUBMISSION	IWR
1	2023-04-20	ISSUED FOR TECHNICAL SUBMISSION	IWR

date revision by

revisions



All drawing and specifications are the property of the architect. The contractor shall verify all dimensions and information on site and report any discrepancy to architect before proceeding.

1Door4Care CHEO Integrated Treatment Centre

401 Smyth Rd
Ottawa, ON K1H 8L1

SHEET LIST

scale:
 drawn by: IWRM
 reviewed by: VK
 job number: 2207
 plot date: 2023/08/16
 drawing number:

LP0000

KEYPLAN

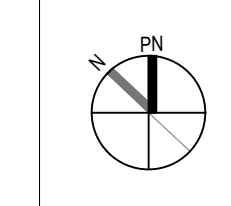

LEGEND

[Symbol]	PROPERTY LINE
[Symbol]	CONCRETE PAVING
[Symbol]	TINTED CONCRETE PAVING
[Symbol]	ASPHALT
[Symbol]	TACTILE ATTENTION INDICATOR
[Symbol]	EXISTING SOG
[Symbol]	SOG
[Symbol]	EXISTING DECIDUOUS TREE TO REMAIN
[Symbol]	EXISTING VEGETATION TO REMAIN
[Symbol]	RESTORATION PLANTING
[Symbol]	DECIDUOUS TREE
[Symbol]	MULTI-PURPOSE PATH
[Symbol]	BENCH
[Symbol]	MANHOLE REFER TO CIVIL
[Symbol]	CATCH BASIN REFER TO CIVIL
[Symbol]	FIRE HYDRANT REFER TO CIVIL

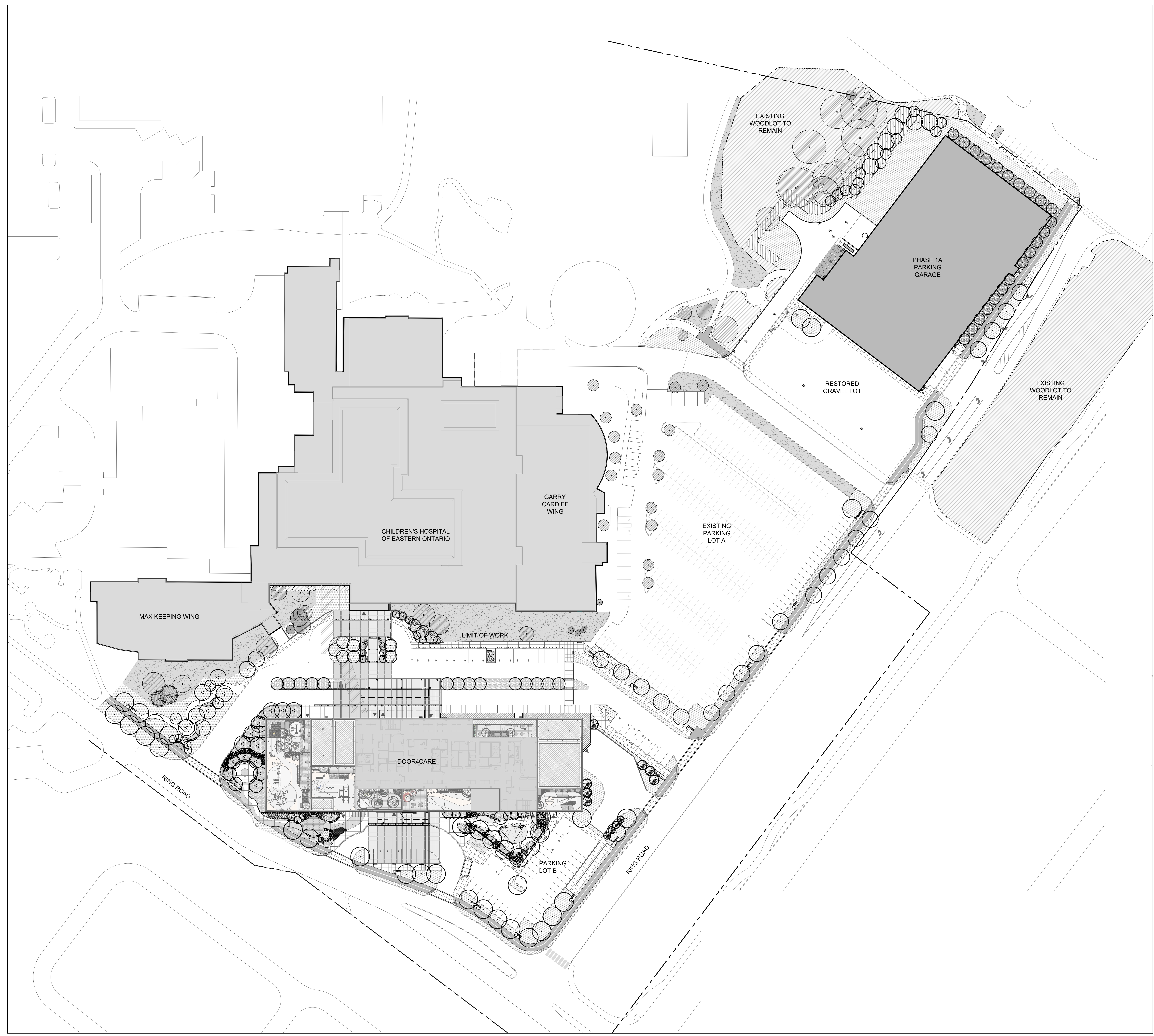

#	DATE	REVISION	BY
3	2023-08-16	ISSUED FOR SPC APPLICATION	IW
2	2023-07-31	ISSUED FOR 90% DD SUBMISSION	IW
1	2023-04-20	ISSUED FOR TECHNICAL SUBMISSION	IW

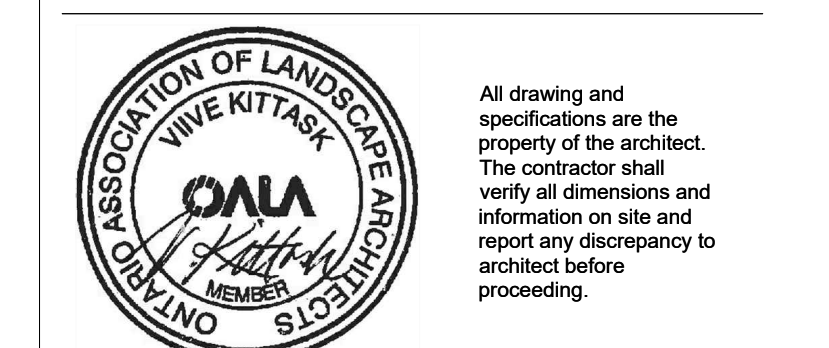

1Door4Care: CHEO Integrated Treatment Centre: Parking Garage

401 Smyth Rd, Ottawa, ON

OVERALL LANDSCAPE AND KEY PLAN

scale:	1:500
drawn by:	IWRM
reviewed by:	VK
job number:	2207
plot date:	2023/08/16
drawing number:	LP0100

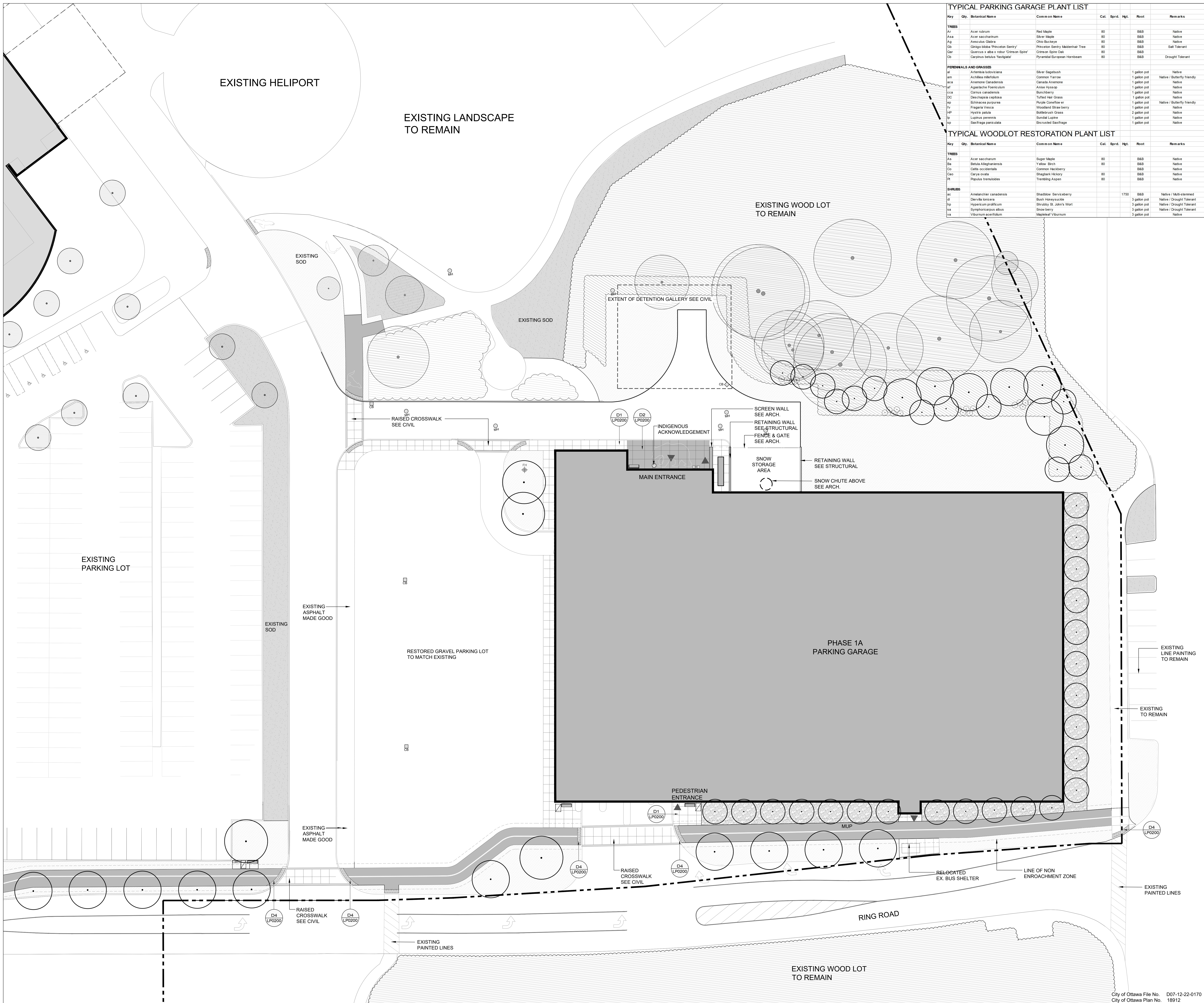

TYPICAL PARKING GARAGE PLANT LIST

Key	Qty.	Botanical Name	Common Name	Cal.	Spnd.	Hgt.	Root	Remarks
TREES								
AV		Acer rubrum	Red Maple	80		8-10	BBB	Native
ASA		Acer saccharum	Silver Maple	80		8-10	BBB	Native
AG		Aspidodermis glabra	Ohio Buckeye	80		8-10	BBB	Native
GP		Gingko biloba 'Princeton Sentry'	Princeton Sentry Maidenhair Tree	80		8-10	BBB	Salt Tolerant
GO		Quercus s. alba x robur 'Crimson Spire'	Crimson Spire Oak	80		8-10	BBB	Native
CO		Carpinus betulus 'Fastigiat'	Pyramidal European Hornbeam	80		8-10	BBB	Drought Tolerant
PERENNIALS AND GRASSES								
AL		Alchemilla adonidifolia	Silver Sagebrush			1 gallon pot		Native
AM		Arnica montana	Common Yellow			1 gallon pot		Native / Butterfly friendly
CA		Canada Anemone	Canada Anemone			1 gallon pot		Native
AF		Aquilegia scopulorum	Rock Anemone			1 gallon pot		Native
CC		Cornus canadensis	Burkberry			1 gallon pot		Native
DC		Deschampsia cespitosa	Tufted Hair Grass			1 gallon pot		Native / Butterfly friendly
HO		Hemerocallis purpurea	Purple Daylily			1 gallon pot		Native
FR		Fragaria vesca	Woodland Strawberry			1 gallon pot		Native
HP		Hyssopus officinalis	Hyssop			2 gallon pot		Native
LO		Lupinus perennis	White Lupine			1 gallon pot		Native
SP		Saxifraga paniculata	Encrusted Saxifrage			1 gallon pot		Native

TYPICAL WOODLOT RESTORATION PLANT LIST

Key	Qty.	Botanical Name	Common Name	Cal.	Spnd.	Hgt.	Root	Remarks
TREES								
ASA		Acer saccharum	Sugar Maple	80		8-10	BBB	Native
BA		Betula alleghaniensis	Yellow Birch	80		8-10	BBB	Native
CO		Cornus occidentalis	Common Hackberry	80		8-10	BBB	Native
GO		Gleditsia triacanthos	Black Locust	80		8-10	BBB	Native
PI		Populus tremuloides	Trembling Aspen	80		8-10	BBB	Native
SHRUBS								
SC		Sambucus canadensis	Shadblow Serviceberry	1750		8-10	BBB	Native / Multi-stemmed
DI		Diervilla lonicera	Bush Honeysuckle			3 gallon pot		Native / Drought Tolerant
HO		Hesperis matronalis	Shrubby St. John's Wort			2 gallon pot		Native / Drought Tolerant
SA		Symphoricarpos albus	Snow berry			3 gallon pot		Native / Drought Tolerant
VU		Viburnum acerifolium	Mapleleaf Viburnum			3 gallon pot		Native



KEYPLAN

Symbol	Description
[Solid Line]	PROPERTY LINE
[Dotted Line]	CONCRETE PAVING
[Cross-hatched]	TINTED CONCRETE PAVING
[Diagonal Lines]	ASPHALT
[Stippled]	TACTILE ATTENTION INDICATOR
[Horizontal Lines]	EXISTING SOD
[Vertical Lines]	SOD
[Circle with Dotted Line]	EXISTING DECIDUOUS TREE TO REMAIN
[Circle with Solid Line]	EXISTING VEGETATION TO REMAIN
[Circle with Dashed Line]	RESTORATION PLANTING
[Circle with Dotted Line]	DECIDUOUS TREE
[Circle with Solid Line]	MULTI-PURPOSE PATH
[Circle with Dashed Line]	BENCH
[Circle with 'CB']	MANHOLE REFER TO CIVIL
[Circle with 'MH']	CATCH BASIN REFER TO CIVIL
[Circle with 'FH']	FIRE HYDRANT REFER TO CIVIL

#	date	revision	by
3	2023-08-16	ISSUED FOR SPC APPLICATION	WW
2	2023-07-31	ISSUED FOR IWB DD SUBMISSION	WW
1	2023-04-20	ISSUED FOR TECHNICAL SUBMISSION	WW

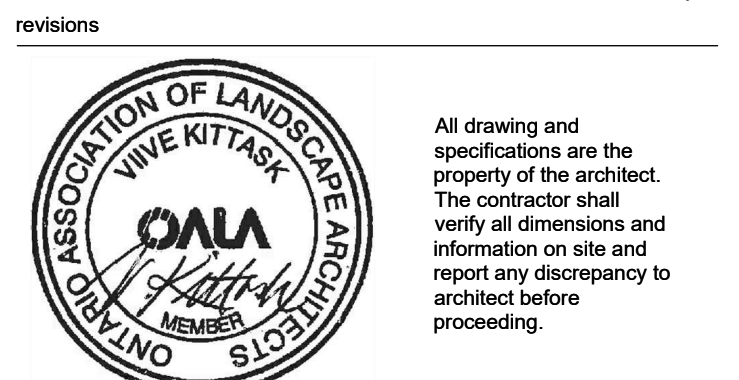

1Door4Care: CHEO Integrated Treatment Centre: Parking Garage

401 Smyth Rd, Ottawa, ON

PARKADE LANDSCAPE PLAN

scale: 1/200
 drawn by: IWRM
 reviewed by: VK
 job number: 2207
 plot date: 2023/08/16
 drawing number:

LP0101

City of Ottawa File No. D07-12-22-0170
 City of Ottawa Plan No. 18912

2023/08/16 11:31:47 AM A:\work\Drawings\22000_1204_CHEO_R22020001_LP0101_CHEO_MSA_MSA_R22020

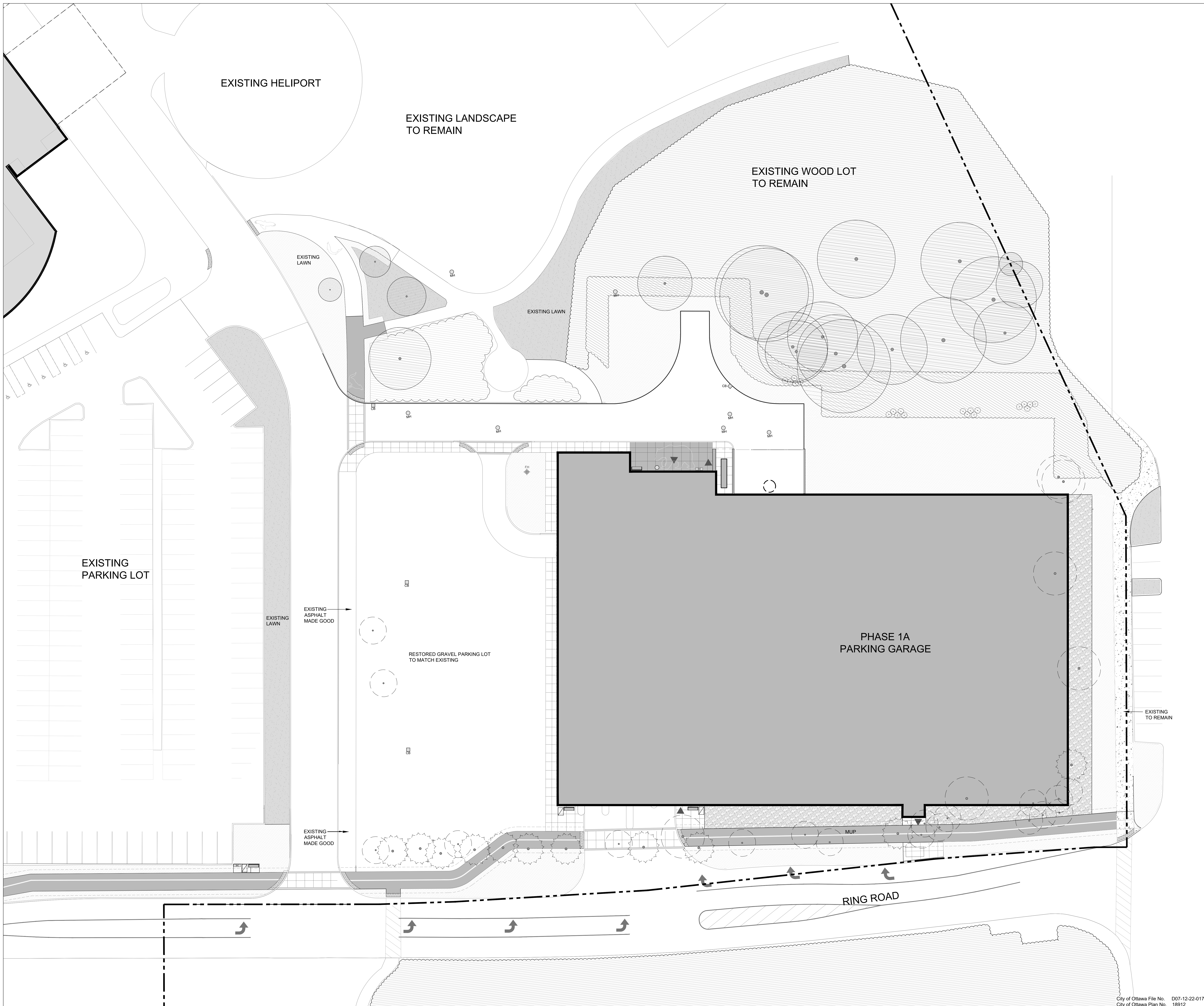

KEYPLAN

- LEGEND
- PROPERTY LINE
 - CONCRETE PAVING
 - TINTED CONCRETE PAVING
 - ASPHALT
 - TACTILE ATTENTION INDICATOR
 - EXISTING SOIL
 - SOIL
 - EXISTING DECIDUOUS TREE TO REMAIN
 - EXISTING DECIDUOUS TREE TO REMOVE
 - EXISTING CONIFEROUS TREE TO REMOVE
 - EXISTING VEGETATION TO REMAIN
 - RESTORATION PLANTING

#	date	revision	by
3	2023-08-16	ISSUED FOR SPC APPLICATION	IW
2	2023-07-31	ISSUED FOR I&M DD SUBMISSION	IW
1	2023-04-20	ISSUED FOR TECHNICAL SUBMISSION	IW

revisions

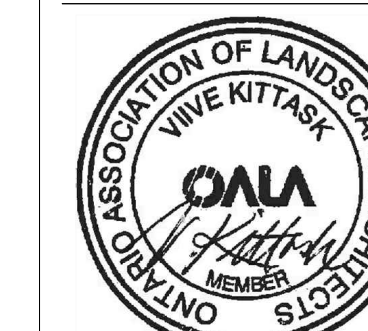

All drawing and specifications are the property of the architect. The contractor shall verify all dimensions and information on site and report any discrepancy to architect before proceeding.

1Door4Care: CHEO Integrated Treatment Centre: Parking Garage

401 Smyth Rd, Ottawa, ON

PARKADE TREE PRESERVATION & REMOVALS PLAN

scale: 1/200
drawn by: IWRM
reviewed by: VK
job number: 2207
plot date: 2023/08/16
drawing number:

LP0101T

KEYPLAN

LEGEND	
[Symbol]	PROPERTY LINE
[Symbol]	CONCRETE PAVING
[Symbol]	TINTED CONCRETE PAVING
[Symbol]	ASPHALT
[Symbol]	TACTILE ATTENTION INDICATOR
[Symbol]	EXISTING SOD
[Symbol]	EXISTING DECIDUOUS TREES TO REMAIN
[Symbol]	EXISTING VEGETATION TO REMAIN
[Symbol]	RESTORATION PLANTING
[Symbol]	DECIDUOUS TREES
[Symbol]	MULTI-PURPOSE PATH
[Symbol]	BENCH
[Symbol]	PROPOSED WATER LINE
[Symbol]	EXISTING WATER LINE
[Symbol]	PROPOSED STORM LINE
[Symbol]	EXISTING STORM LINE
[Symbol]	PROPOSED SC-740 CHAMBER SEE CIVIL
[Symbol]	PROPOSED SANITARY LINE
[Symbol]	EXISTING SANITARY LINE
[Symbol]	PROPOSED HYDRO DUCTS
[Symbol]	EXISTING UG HYDRO LINES
[Symbol]	MANHOLE REFER TO CIVIL
[Symbol]	PIPE INSULATION SEE CIVIL



#	DATE	REVISION	BY
3	2023-08-16	ISSUED FOR SPC APPLICATION	IW
2	2023-07-31	ISSUED FOR I&M DD SUBMISSION	IW
1	2023-04-20	ISSUED FOR TECHNICAL SUBMISSION	IW

revisions

All drawings and specifications are the property of the architect. The contractor shall verify all dimensions and information on site and report any discrepancy to architect before proceeding.

1Door4Care: CHEO Integrated Treatment Centre: Parking Garage

401 Smyth Rd, Ottawa, ON

PARKADE LANDSCAPE UTILITY PLAN

scale: 1/200
 drawn by: IWRM
 reviewed by: VK
 job number: 2007
 plot date: 2023/08/16
 drawing number: **L0602U**

2023-11-20 11:31:47 PM A:\work\Drawings\2023\1D-CHEO_R2\202304_1D-CHEO_MSA_MVA_R22.rvt

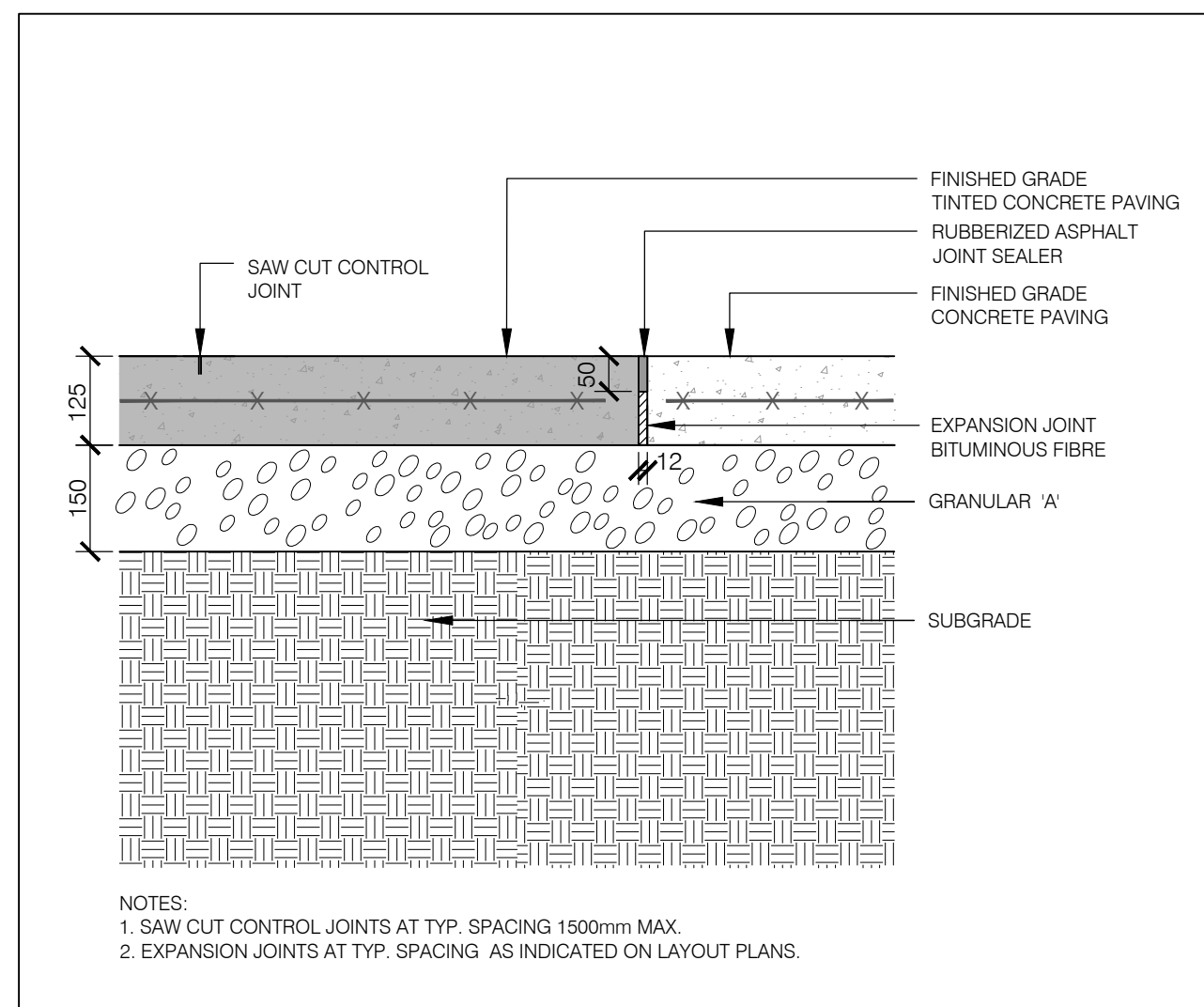

01 TYPICAL CONCRETE AND TINTED CONCRETE PAVING ON GRADE SECTION SCALE 1:10

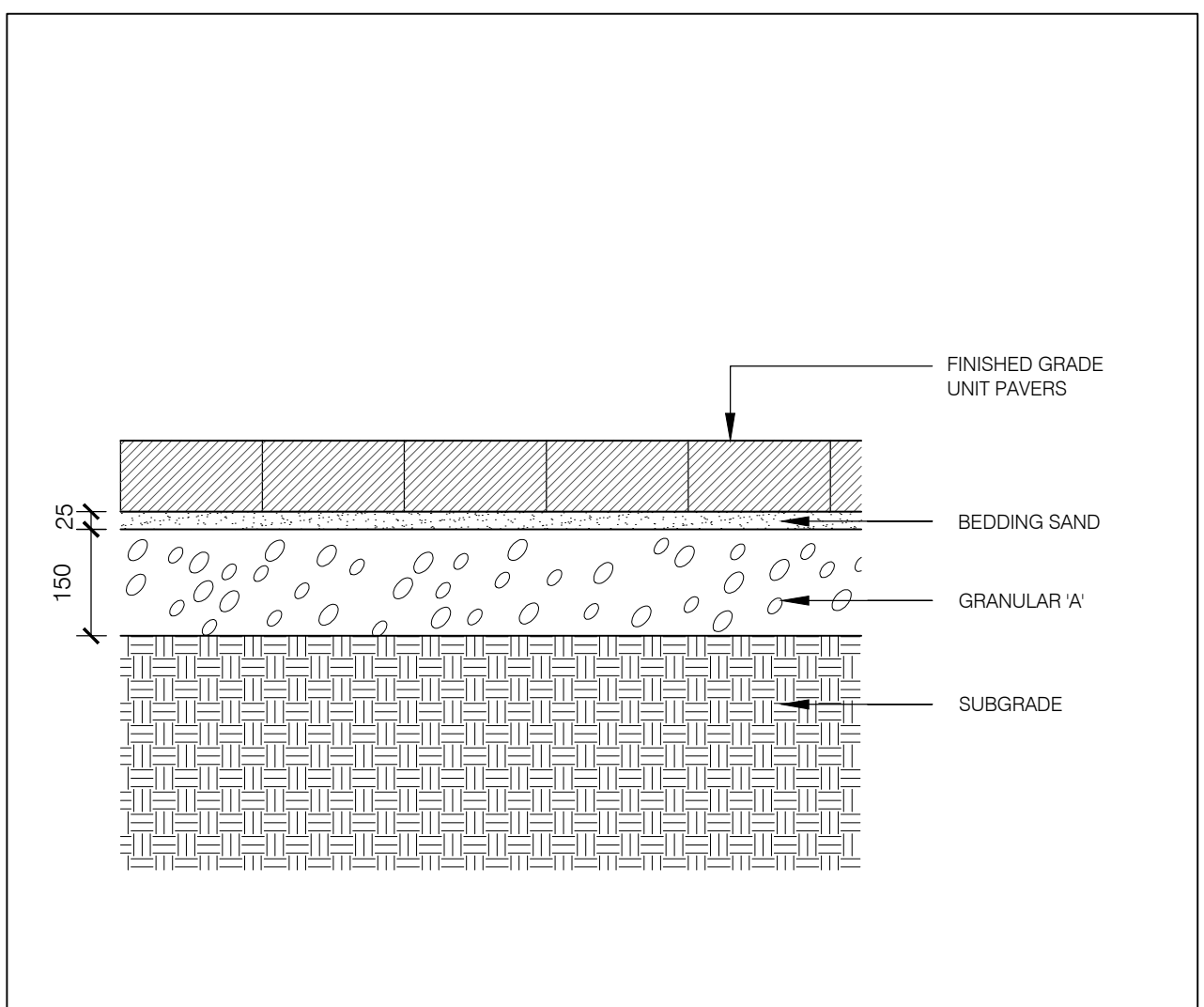

02 TYPICAL UNIT PAVING ON GRADE SECTION SCALE 1:10

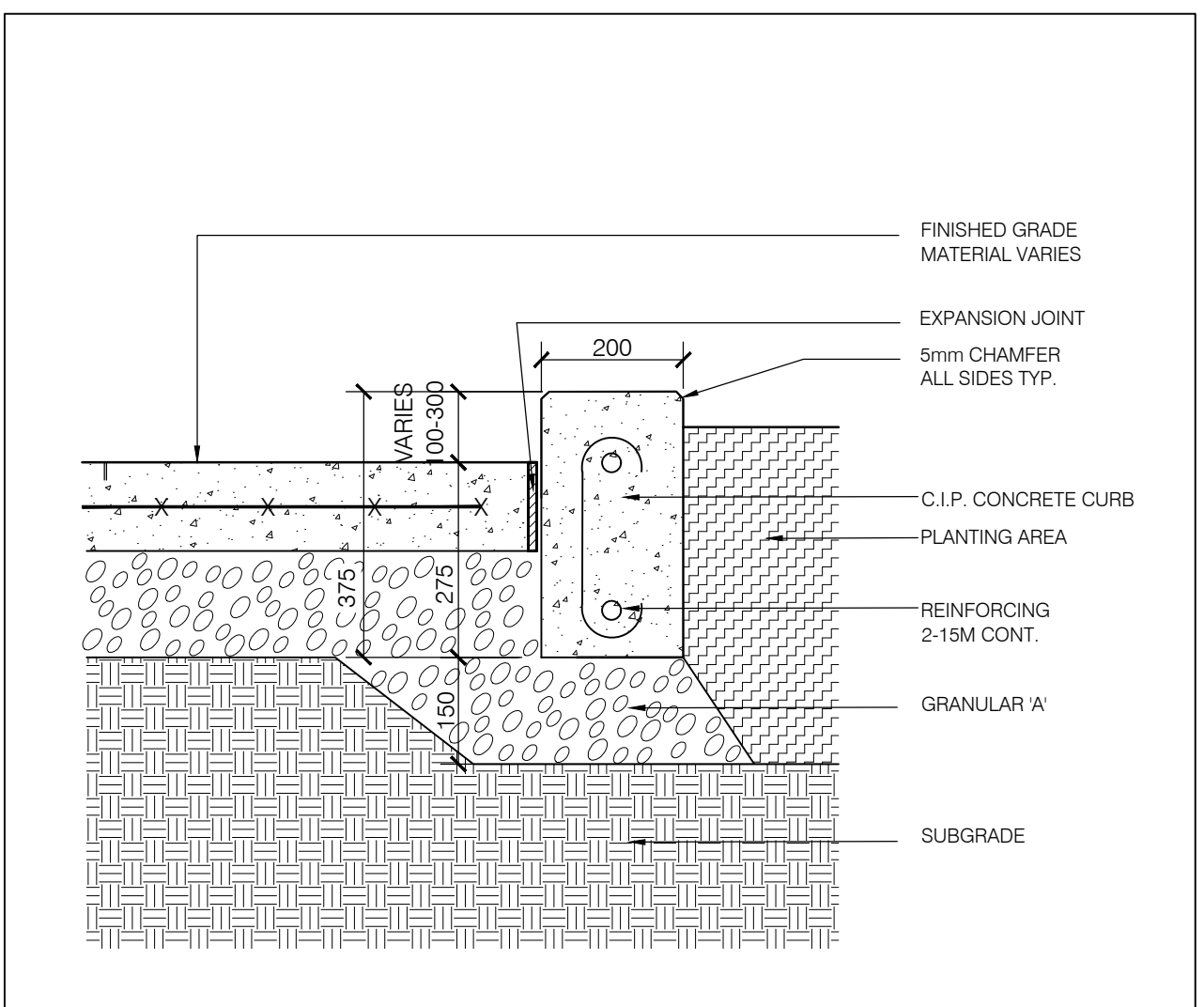

03 TYPICAL CONCRETE PLANTER CURB ON GRADE SECTION SCALE 1:10

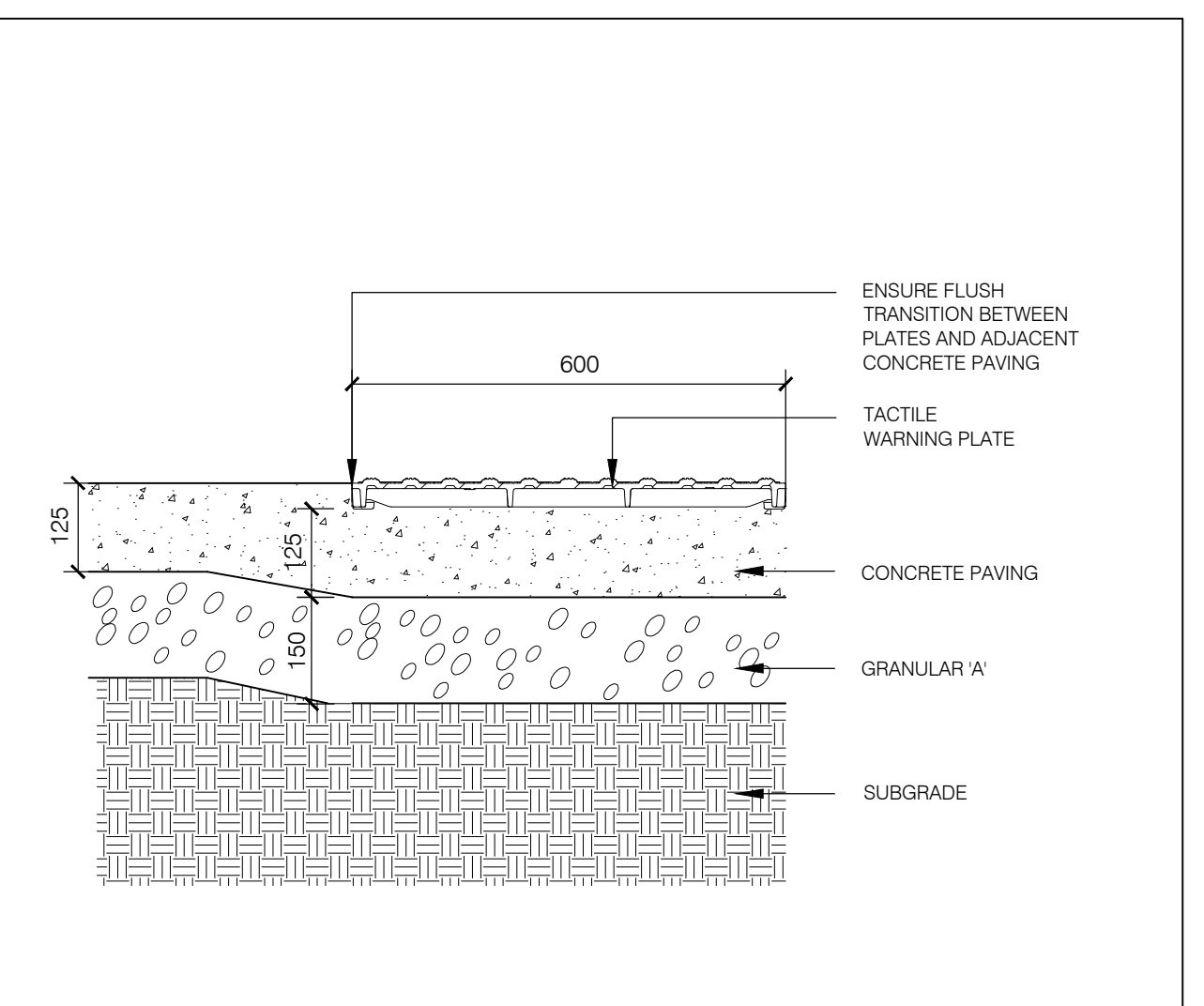

04 TYPICAL TACTILE ATTENTION INDICATOR SECTION SCALE 1:10

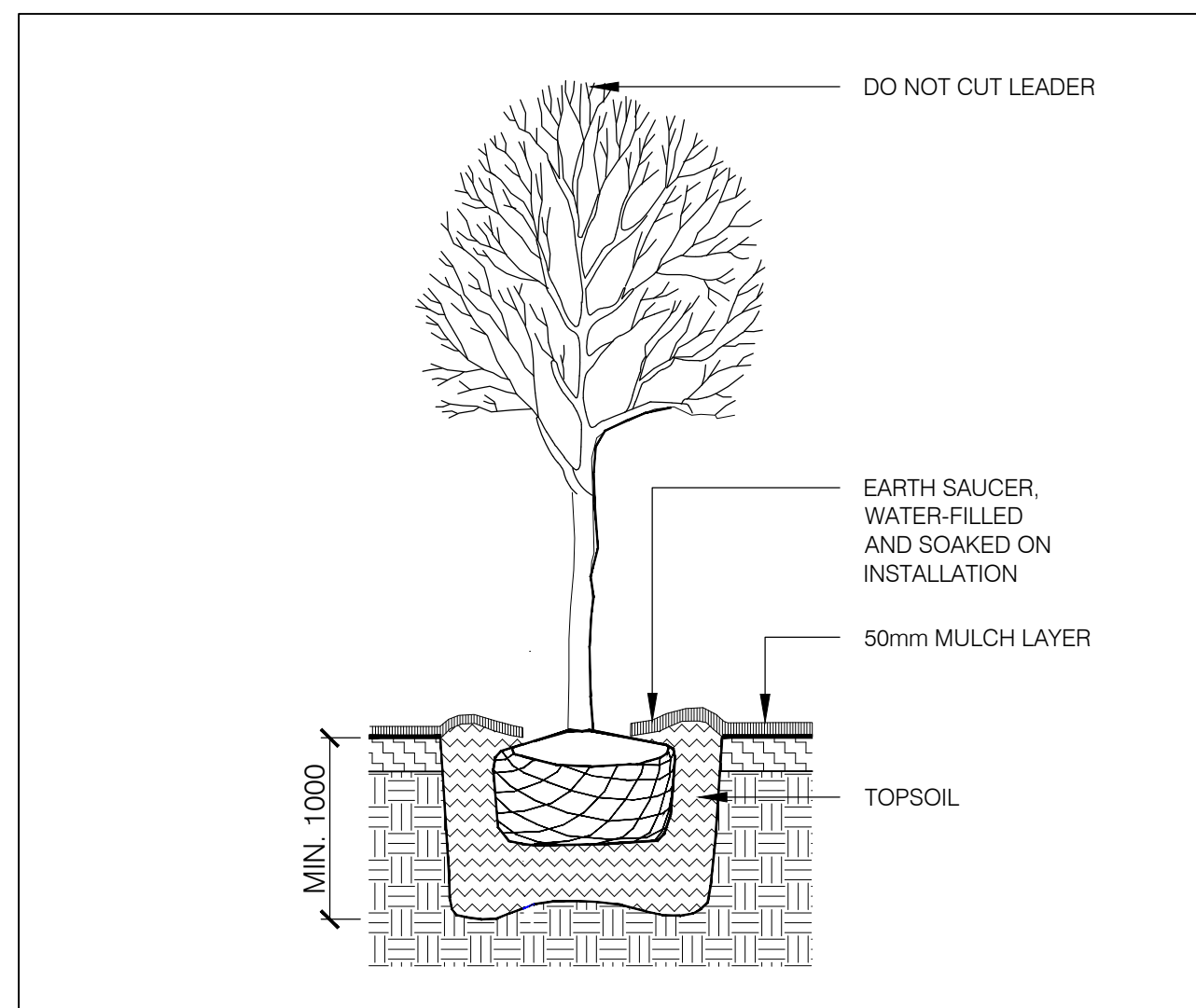

06 TYPICAL DECIDUOUS TREE PLANTING SECTION SCALE 1:25

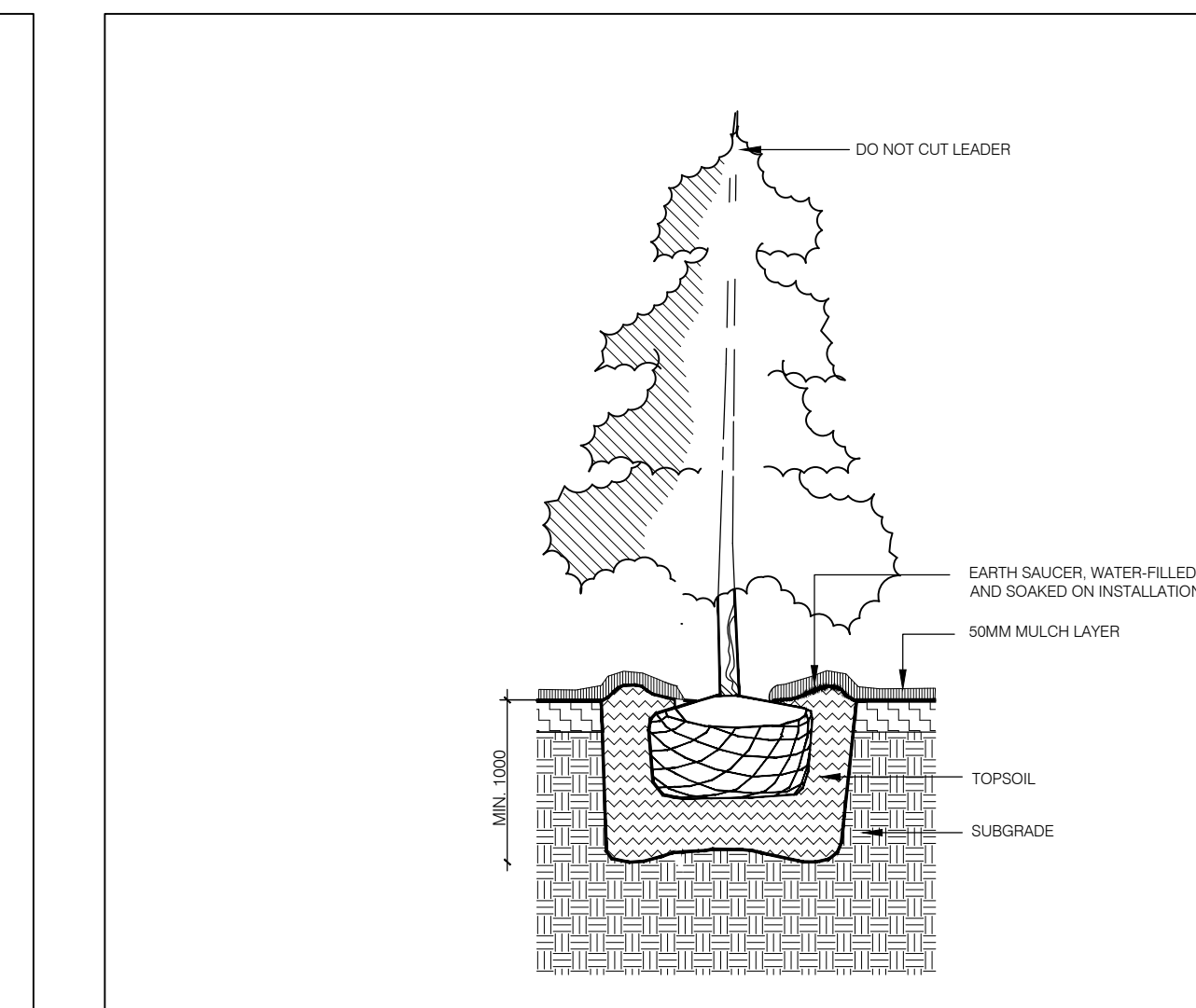

07 TYPICAL CONIFEROUS TREE PLANTING CITY OF OTTAWA STANDARD DETAIL SCALE 1:25

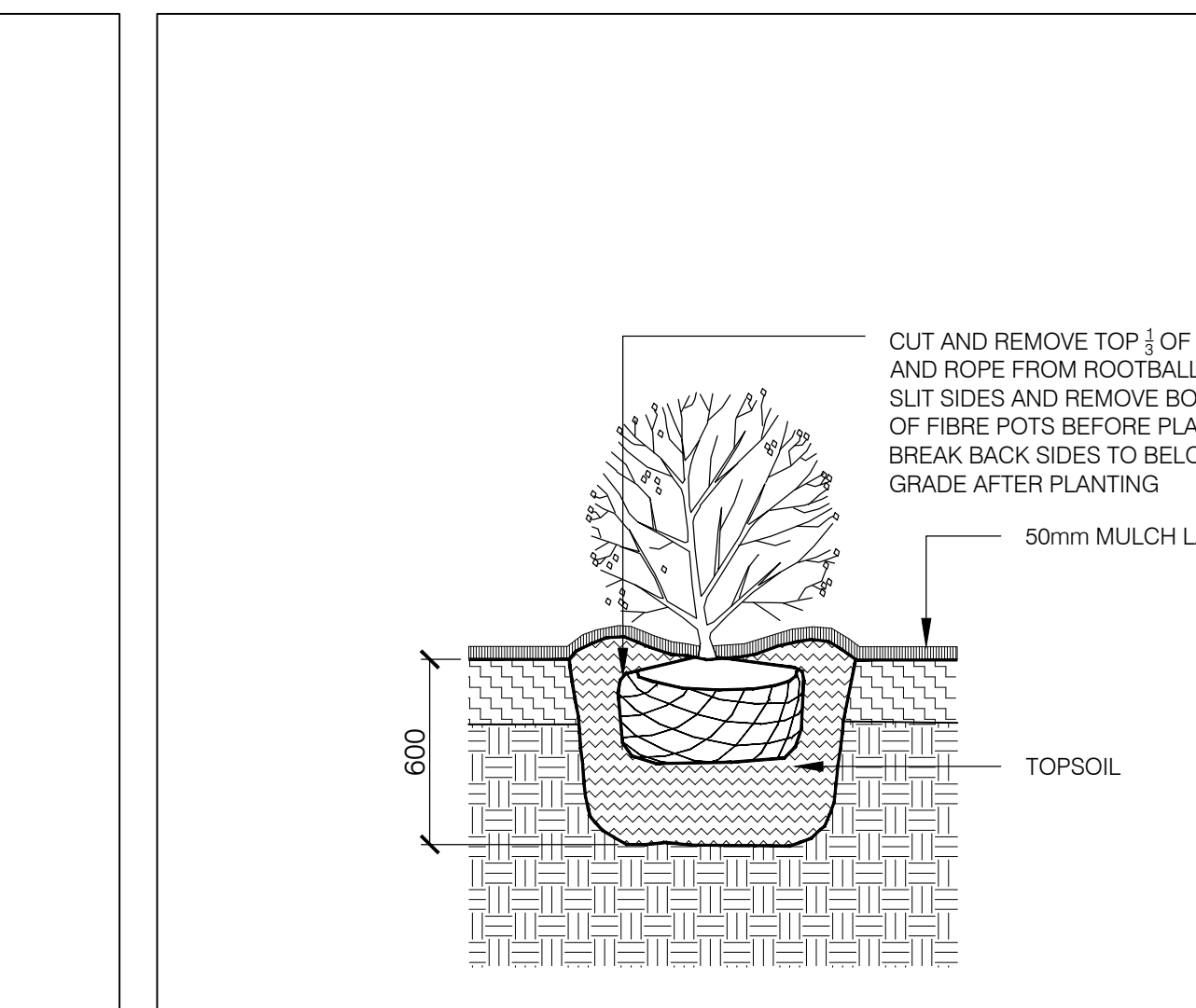

08 TYPICAL SHRUB PLANTING CITY OF OTTAWA STANDARD DETAIL SCALE 1:25

Esplanade Bench With Tropical Wood Slats

PS-840-AL-WD3-WD3-A Esplanade WD-W

Our 'Esplanade' bench features an all-welded aluminum powdercoated frame, and Tropical Wood Slats. Shown here in our 'Pewter' powdercoat finish with IPE wood slats. Available in a variety of sizes and finishes, freestanding or bolt-down.

HAUSER SITE FURNITURE

Width: 72" (182.9 cm)
Depth: 27.25" (69.2 cm)
Height: 31" (78.7 cm)
Seat Height: 18" (45.7 cm)
Arm Height: 27" (68.6 cm)

sales@hausersite.com | 1-800-268-7328 | hausersite.com

09 TYPICAL BENCH TYPE ONE MANUFACTURERS CUT SHEET NOT TO SCALE

MRR-1500-00016

Legacy #: LXR1503-48-MS-VGST-VGST-RS

LEXICON

MAGLIN SITE FURNITURE

MATERIALS: The trash/recycle unit is constructed using a steel frame with laser cut and formed steel body panels. Three 9 gallon (33 litre) commercial grade plastic bins and standard metal lids are provided.

FINISH: All steel components are protected with 5-Coat hot-dip galvanized. The Maglin Powdercoat System provides a durable finish on all metal surfaces.

INSTALLATION: The trash/recycle unit is delivered pre-assembled. Holes (3/8") are provided in each mounting foot for securing to base.

TO SPECIFY: Select MRR-1500-00016
Options:
- Powdercoat Color

HEIGHT: 47.5" (120.7 cm) LENGTH: 39" (99.1 cm) DEPTH: 18" (45.7 cm) WEIGHT: 216.24 lbs (98.1 kg)

7 430 2nd Ave. S.W.
Burien, WA 98148
www.maglin.com
sales@maglin.com

All drawings, specifications, design and details on this page remain the property of Maglin Site Furniture Inc. and may not be used without Maglin's authorization. Credits and special notes may refer to the construction requirements of our products.

10 TYPICAL WASTE RECEPTACLE TYPE ONE MANUFACTURERS CUT SHEET NOT TO SCALE

#	date	revision	by
3	2023-08-16	ISSUED FOR SPC APPLICATION	WV
2	2023-07-31	ISSUED FOR 90% DD SUBMISSION	WV
1	2023-04-20	ISSUED FOR TECHNICAL SUBMISSION	WV

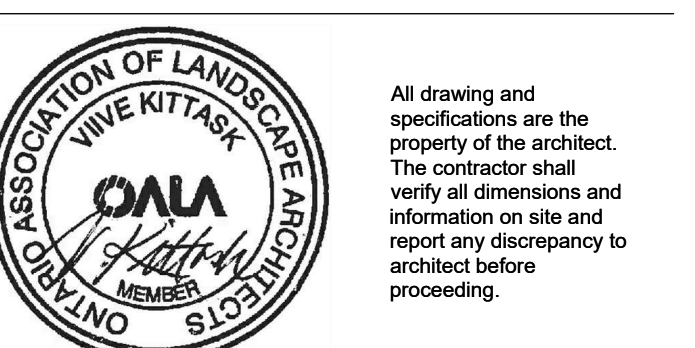

1Door4Care: CHEO Integrated Treatment Centre: Parking Garage

401 Smyth Rd, Ottawa, ON

LANDSCAPE DETAILS

scale: AS SHOWN
drawn by: WVRM
reviewed by: VK
job number: 2027
plot date: 2023/08/16
drawing number: LP0200