

TANYA FARLINGER
9 SADDLEHORN CRESCENT
KANATA, ONTARIO K2M 1W9
613-282-9882
tanya@exhalo.ca

G. Wildman

GERALDINE WILDMAN
MANAGER, DEVELOPMENT REVIEW SOUTH
PLANNING, DEVELOPMENT AND BUILDING SERVICES
DEPARTMENT, CITY OF OTTAWA

APPROVED
By Geraldine Wildman at 4:37 pm, Oct 17, 2025

CATCH-BASIN & MANHOLE SCHEDULE

REF	TOP	SIZE	TYPE	INVERT AT INLET	INVERT AT OUTLET	NOTES
CB-1	95.47	600mm x 600mm	PRE-CAST CONCRETE CATCH-BASIN	-	93.60	TO OPSD 705.010 & CITY OF OTTAWA STANDARDS - FRAME & COVER TO CITY OF OTTAWA DRAWING No. S19
DI-1	95.43	600mm x 600mm	PRE-CAST CONCRETE DITCH INLET	-	93.42	TO OPSD 705.030 & CITY OF OTTAWA STANDARDS - GRATE TO OPSD 403.010 3:1 SLOPE
CB/MH-3	±95.65	1200mm	PRE-CAST CONCRETE CATCH-BASIN/MANHOLE	93.55(W)	93.49(N)	TO OPSD 701.010 & CITY OF OTTAWA STANDARDS - FRAME & COVER TO CITY OF OTTAWA DRAWING No. S25 & S28.1 OR OPSD 401.010
CB/MH-4	95.61	1200mm	PRE-CAST CONCRETE CATCH-BASIN/MANHOLE	93.30(S)	93.24(E)	TO OPSD 701.010 & CITY OF OTTAWA STANDARDS - FRAME & COVER TO CITY OF OTTAWA DRAWING No. S25 & S28.1 OR OPSD 401.010
CB-5	94.83	600mm x 600mm	PRE-CAST CONCRETE CATCH-BASIN	-	92.58	TO OPSD 705.010 & CITY OF OTTAWA STANDARDS - FRAME & COVER TO CITY OF OTTAWA DRAWING No. S19
CB/MH-6	94.94	1200mm	PRE-CAST CONCRETE CATCH-BASIN/MANHOLE	92.62(S) 92.38(E)	92.37(W)	TO OPSD 701.010 & CITY OF OTTAWA STANDARDS - FRAME & COVER TO CITY OF OTTAWA DRAWING No. S25 & S28.1 OR OPSD 401.010
CB/MH-7	95.14	1200mm	PRE-CAST CONCRETE CATCH-BASIN/MANHOLE	92.33(E) 93.13(W)	92.27(N)	TO OPSD 701.010 & CITY OF OTTAWA STANDARDS - FRAME & COVER TO CITY OF OTTAWA DRAWING No. S25 & S28.1 OR OPSD 401.010 INSTALL ICD IN OUTLET PIPE
MH-8	95.19	CDS PMSU2015-4	PRE-CAST CONCRETE MANHOLE	92.25(S)	92.24(N)	TO OPSD 701.010 & CITY OF OTTAWA STANDARDS EXCEPT WITH A DEEP SUMP AS REQUIRED BY CDS

WATER SERVICE PROFILE TABLE

MATERIAL:

38mm COPPER ASTM B88 TYPE "K" SOFT

STATION	DESCRIPTION	GRADE ELEVATION	TOP OF PIPE	DEPTH OF COVER	NOTES
0+00.0	CONNECTION TO 200mm MUNICIPAL WATERMAIN	±94.80	±92.40	±2.40	CONNECTION BY CITY. EXCAVATION, BACKFILL & REINSTATEMENT BY CONTRACTOR.
0+02.7	-	±94.72	±92.32	2.40	BOTTOM OF CURB
0+04.7	-	94.82	92.42	2.40	BACK OF SIDEWALK
0+06.6	-	94.95	92.55	2.40	CROSSING BELL
0+07.9	38mm CURB STOP & SERVICE POST	95.00	92.60	2.40	ON PROPERTY LINE
0+13.7	-	95.30	92.90	2.40	-
0+16.1	-	95.44	92.90	2.54	-
0+19.4	-	95.53	92.90	2.63	250 ST INV 93.20 38 WS TOP 92.90
0+20.8	-	95.57	93.00	2.57	START OF INSULATION AT OPEN STRUCTURE: 125mm THICK
0+24.0	-	95.67	93.04	2.63	ENTRY INTO BUILDING

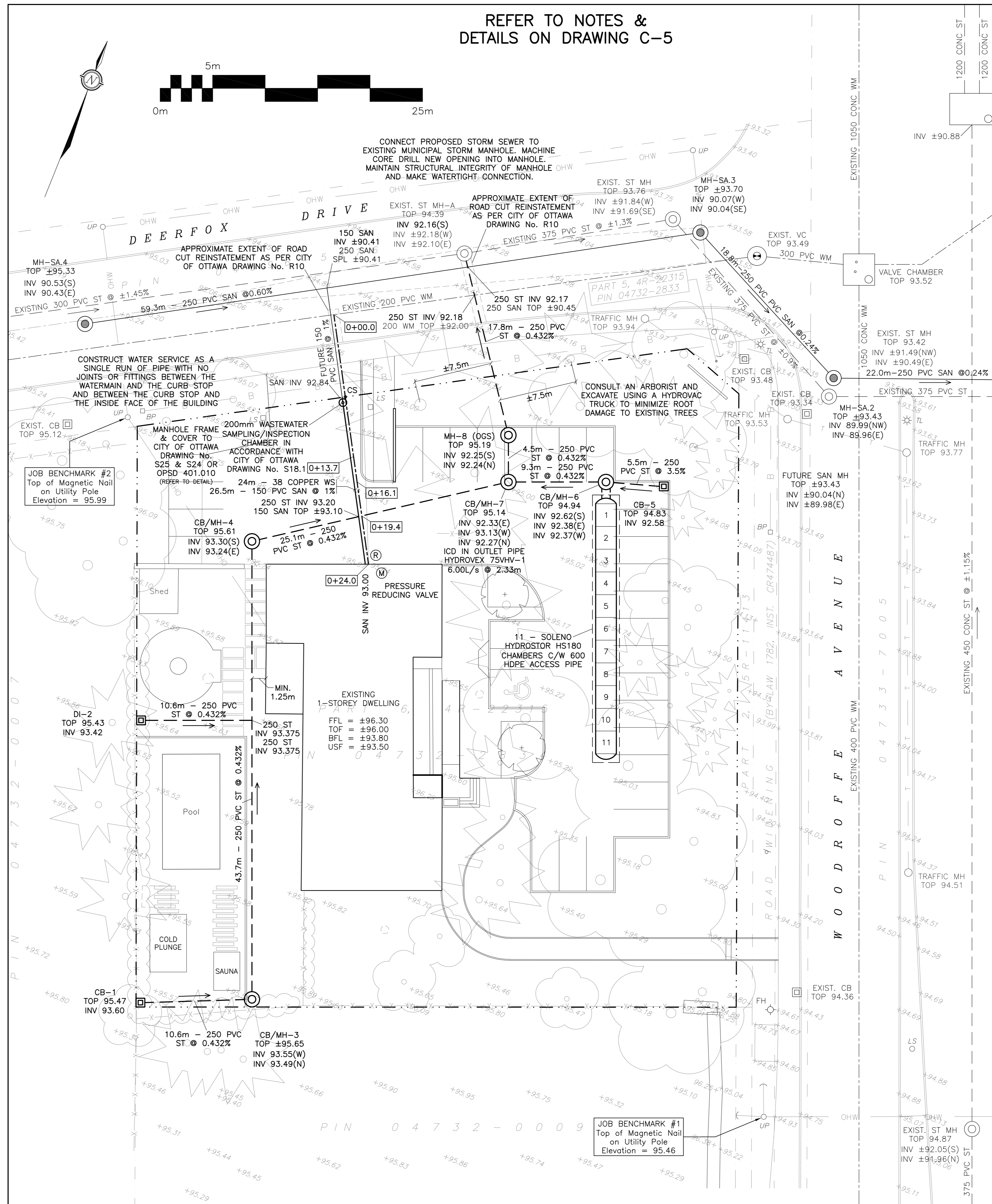

LEGEND

- FFL FINISHED FLOOR ELEVATION
- TOF TOP OF FOUNDATION
- BFL BASEMENT FLOOR ELEVATION
- USF UNDERSIDE OF FOOTING
- PROPERTY LINE
- CB CATCH-BASIN
- MH STORM MANHOLE
- CB/MH CATCH-BASIN/MANHOLE
- MH SANITARY MANHOLE
- VC VALVE CHAMBER
- FH FIRE HYDRANT
- CS CURB STOP & STANDPOST
- (M) WATER METER
- (R) REMOTE WATER METER
- SAN SANITARY SEWER
- ST STORM SEWER
- WS/WM WATER SERVICE/WATERMAIN
- SPL SPRINGLINE OF PIPE
- INV INVERT OF PIPE
- EXISTING GRADE ELEVATION
- 150mm BARRIER CURB

KEY PLAN



No.	DATE	REVISION
4	NOV 17-22	RE-ISSUED FOR APPROVAL
3	SEP 12-22	RE-ISSUED FOR APPROVAL
2	JUN 2-22	ISSUED FOR APPROVAL
1	MAY 16-22	ISSUED FOR COORDINATION

D. B. GRAY ENGINEERING INC.
Stormwater Management - Grading & Drainage - Storm & Sanitary Sewers - Watermain
700 Long Point Circle 613-425-8044
Ottawa, Ontario d.gray@dbgrayengineering.com

Project
EXHALO SPA
3150 WOODROFFE AVENUE
OTTAWA, ONTARIO

SITE SERVICING PLAN

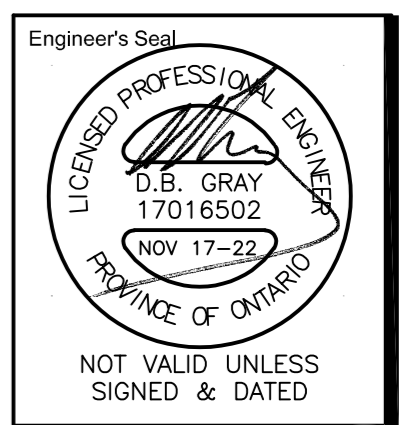

Drawn D.B.G.
H. Scale 1:200
V. Scale
Date MAR 21-22
Job No. 22017

Drawing No.
C-1
of 7

#18785

D07-12-22-0101