

**PAVEMENT DESIGN**

40mm SUPERPAVE 12.5 ASPHALTIC CONCRETE  
 50mm SUPERPAVE 19.0 ASPHALTIC CONCRETE  
 150mm OPSS GRANULAR A CRUSHED STONE  
 40mm OPSS GRANULAR B TYPE II

**NOTE:**  
 ALL EXISTING BUILDINGS, BARNs,  
 POST & WIRE FENCES, TREES,  
 UTILITY WIRES, POLES AND  
 CULVERTS WITHIN LOTS AND BLOCKS  
 TO BE REMOVED, UNLESS  
 OTHERWISE NOTED.

ANY DISTURBED AREA DURING  
 CONSTRUCTION TO BE RESTORED  
 TO THE ORIGINAL CONDITION OR BETTER  
 TO THE SATISFACTION OF THE  
 AUTHORITIES HAVING JURISDICTION

WRITTEN PERMISSION REQUIRED  
 FOR WORK ON ADJACENT LANDS

**NOTE:**  
 FOR WATERMAIN STUBS, 2.4m  
 MIN. COVER TO BE PROVIDED

**NOTE:**  
 ALL WATERMAIN CONNECTIONS AND  
 DECOMMISSIONING OF EXISTING WATERMAINS  
 TO BE COMPLETED BY CITY FORCES. TRENCH  
 BACKFILL/REINSTATEMENT TO BE COMPLETED BY  
 THE CONTRACTOR TO THE SATISFACTION OF THE  
 CITY OF OTTAWA.

**NOTE: RE: TEST PIT/BOREHOLE  
 EXCAVATIONS**  
 ANY DISTURBED MATERIAL ENCOUNTERED  
 BELOW THE SUBGRADE LEVEL WITHIN A  
 BUILDING FOOTPRINT TO BE SUB-EXCAVATED  
 AND BACKFILLED WITH COMPACTED ENGINEERED  
 FILL AS PER GEOTECHNICAL ENGINEERS  
 RECOMMENDATION.

CONTRACTOR TO VERIFY THE  
 PRECISE LOCATIONS AND INVERT  
 ELEVATIONS OF Ex. UNDERGROUND  
 SERVICES AND Ex. UTILITIES PRIOR  
 TO STARTING CONSTRUCTION

**NOTE: CB**  
 FOR CATCHBASIN INFORMATION, REFER TO  
 DRAWING No. 3 FOR DETAIL.

GRADING AND SERVICING FOR  
 ADJACENT CONDO BLOCK WEST OF  
 PROJECT No. 27970 - REV 16,  
 DATED JUN. 27, 2019.

GRADING FOR SUBDIVISION PER IBI  
 PROJECT No. 27970 - REV 16,  
 DATED JANUARY 11, 2019.

SERVICING FOR SUBDIVISION PER IBI  
 PROJECT No. 27970 - REV 16,  
 DATED JANUARY 11, 2019.

COMPOSITE UTILITY PLAN OF  
 SUBDIVISION PER IBI PROJECT No.  
 27970 - REV 7, DATED NOVEMBER  
 29, 2018.

**NOTE**  
 FOR WATERMAIN LAYOUT AT DEAD-END  
 STREETS REFER TO CITY STD. W37.2

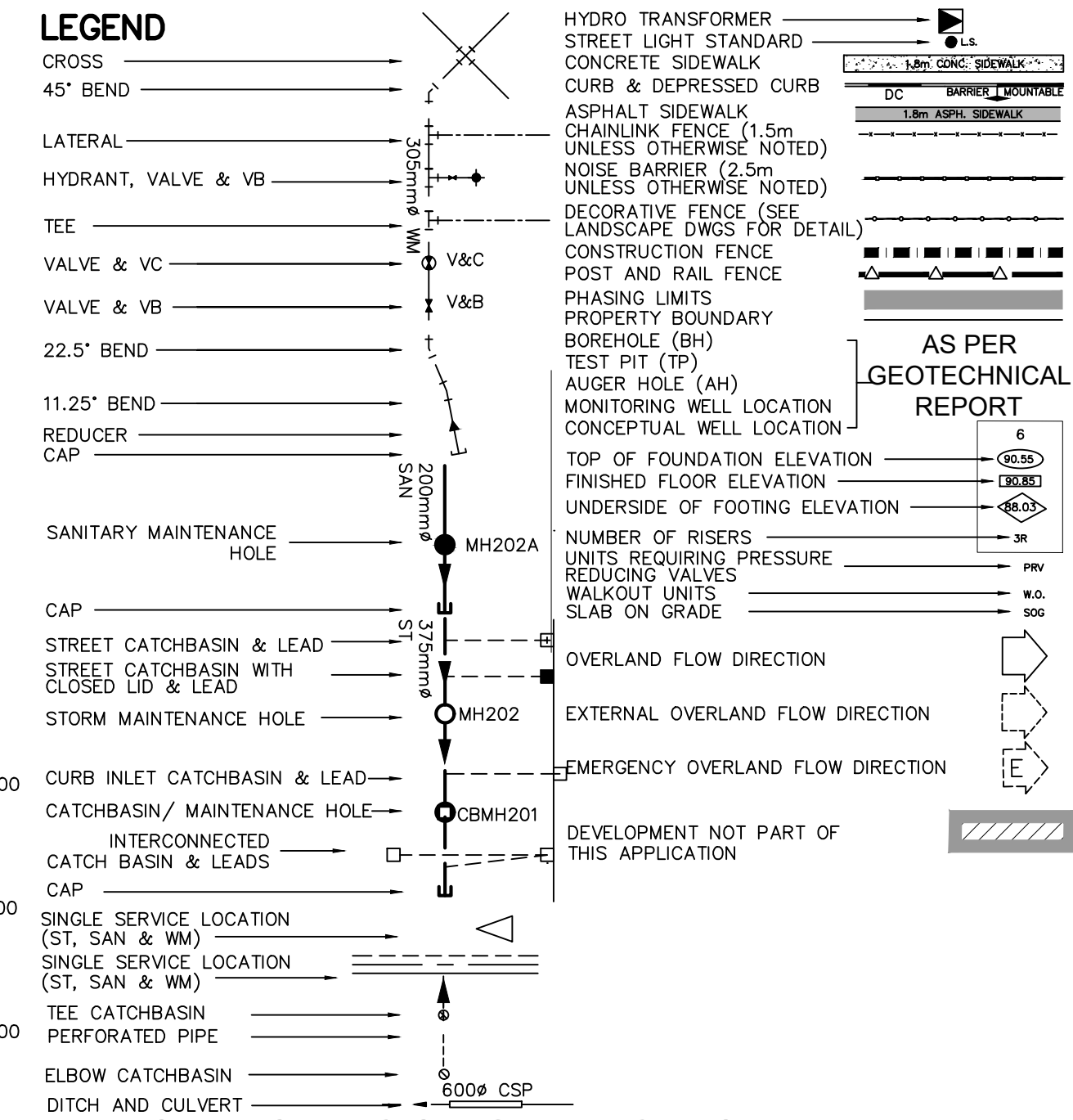
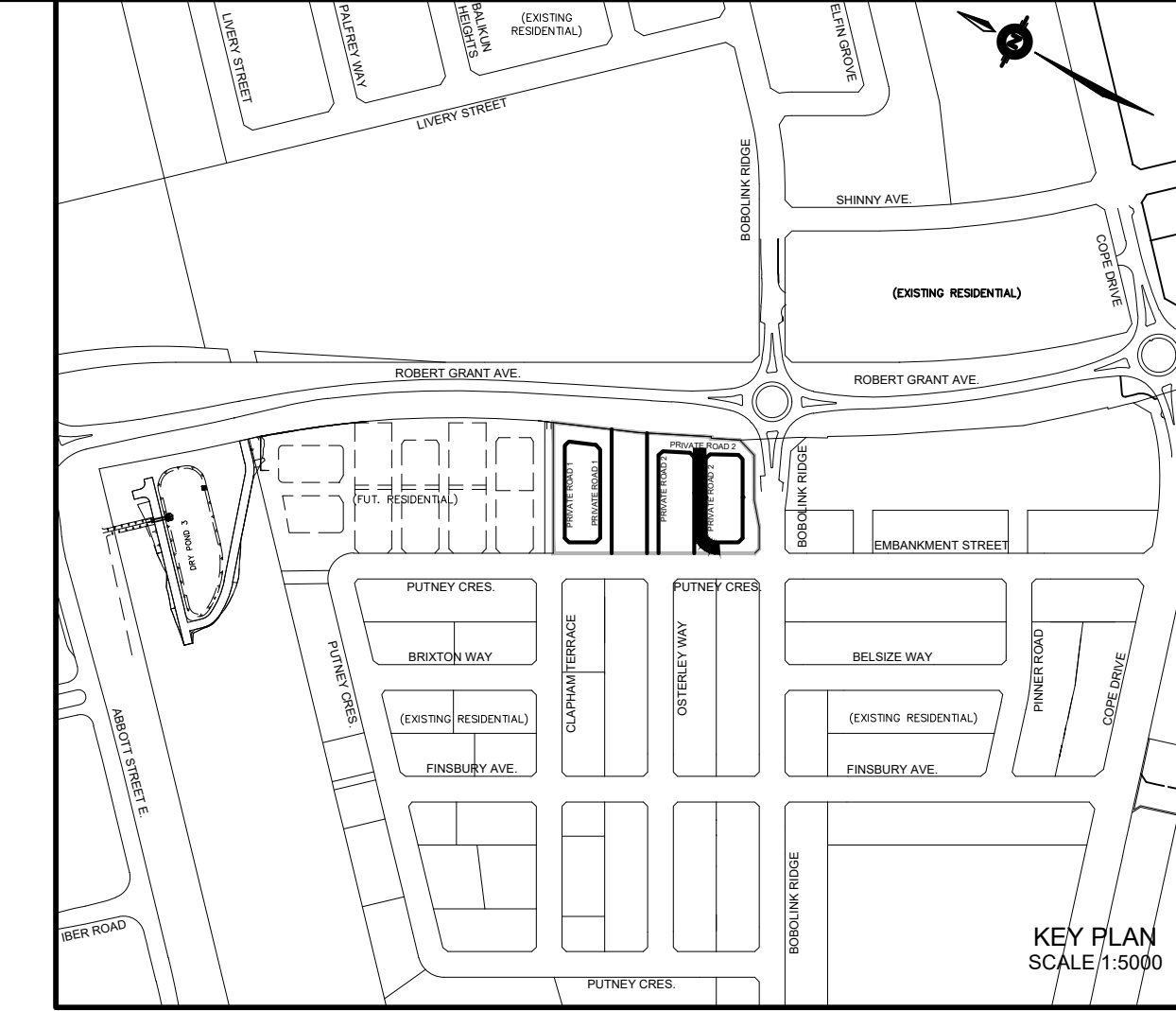
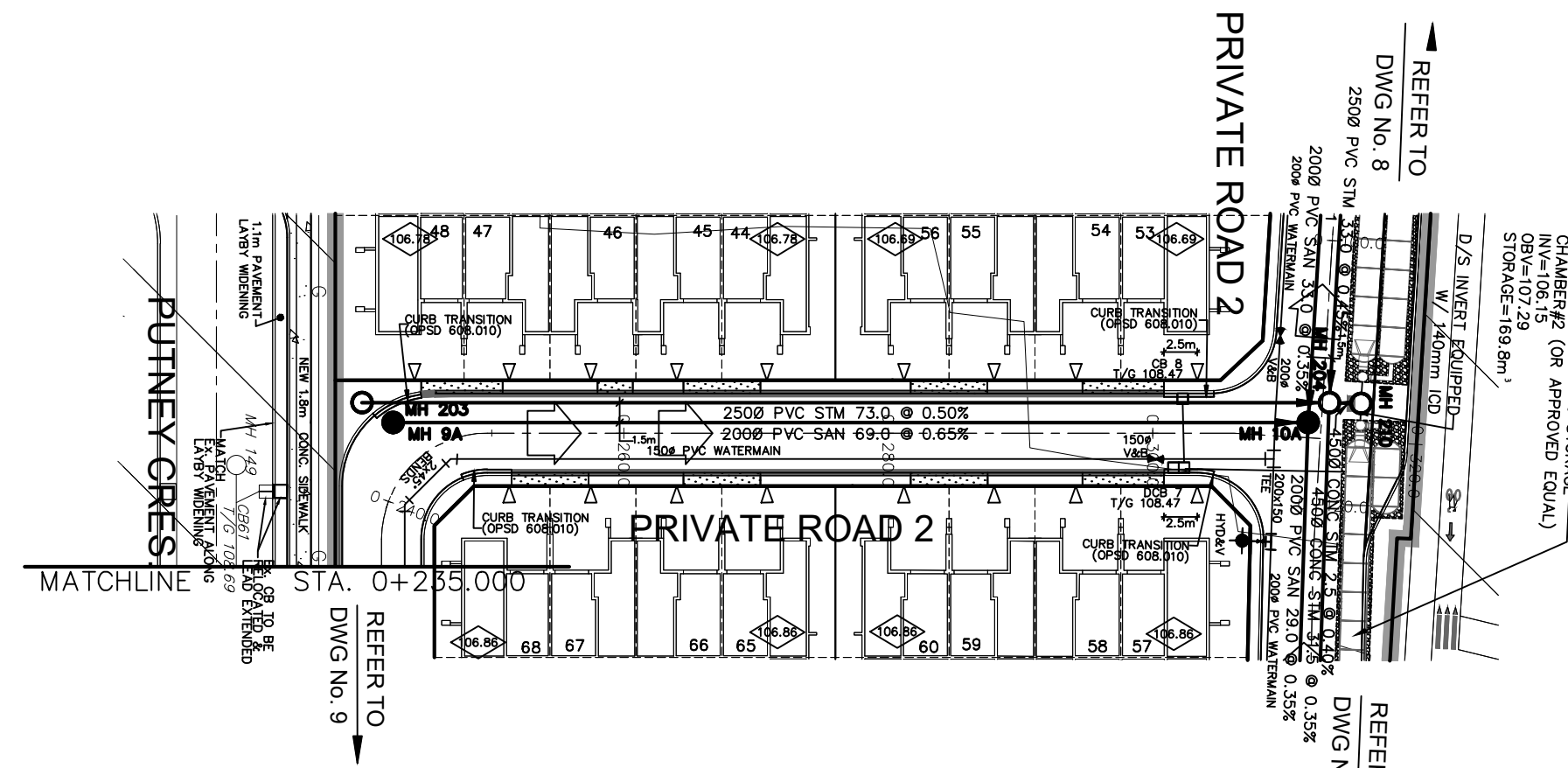

**NOT FOR CONSTRUCTION**

2	S.L.M.	22-06-10	2nd SUBMISSION
1	S.L.M.	22-01-13	1st SUBMISSION

No. BY DATE DESCRIPTION

**TOPOGRAPHIC INFORMATION**  
 TOPOGRAPHIC INFORMATION PROVIDED BY ANNIS, O'SULLIVAN, VOLLEBEKK LTD. PROJECT No. 22111-21 RECEIVED JUNE 24, 2021

**LEGAL INFORMATION**  
 CALCULATED M-PLAN PROVIDED BY ANNIS, O'SULLIVAN, VOLLEBEKK LTD., PROJECT No. 22111-21. RECEIVED MAY 17th, 2022.

**BENCH MARK**  
 SITE BENCHMARK #1, FIRE HYDRANT TOP OF SPINDLE  
 ELEVATION = 109.78m  
 SITE BENCHMARK #2, CP IN ASPHALT  
 ELEVATION = 109.09

**TAMARACK HOMES** BOBOLINK RIDGE BLOCK 343

**DSEL**  
 120 Ibor Road Unit 103  
 Slittsville, Ontario, K2S 1E9  
 Tel. (613) 836-0856  
 Fax. (613) 836-7183  
 www.DSEL.ca

**S. L. MERRICK**  
 100186523  
 2022 06-10  
 PROVINCE OF ONTARIO

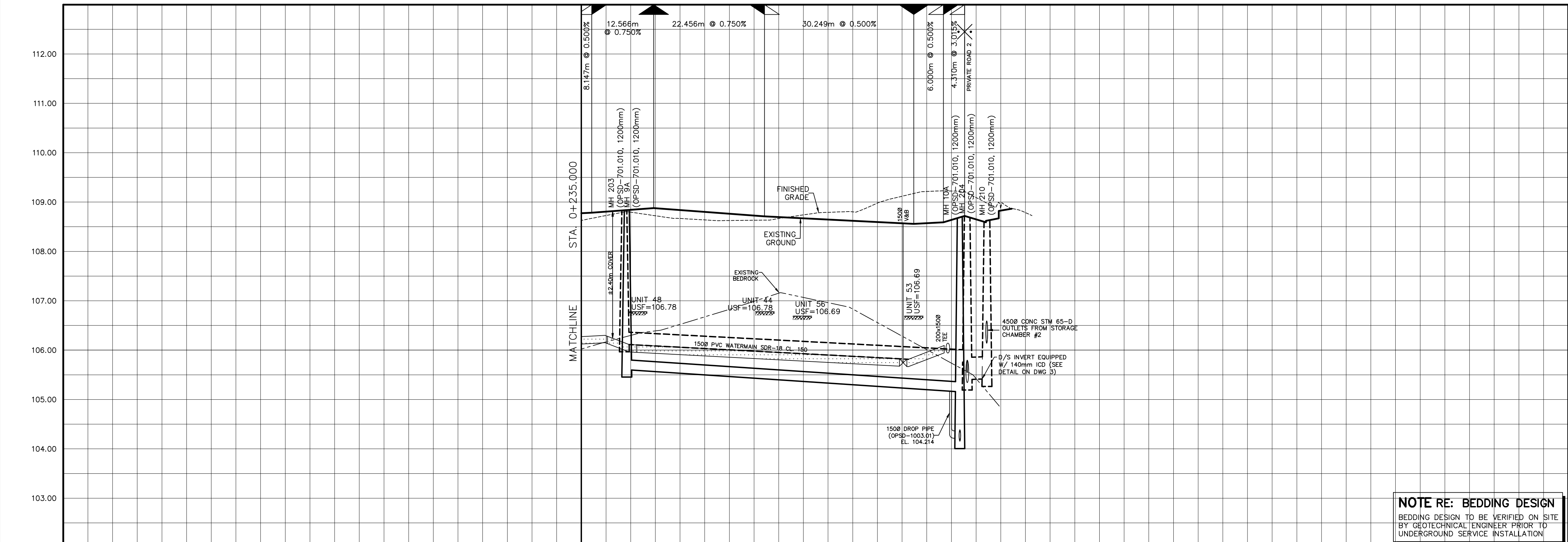

**NOTE RE: BEDDING DESIGN**  
 BEDDING DESIGN TO BE VERIFIED ON SITE  
 BY GEOTECHNICAL ENGINEER PRIOR TO  
 UNDERGROUND SERVICE INSTALLATION

TOP OF WATERMAIN	106.284 45° 106.380 106.180 45° 106.105 106.097	106.032	105.960	105.927	106.571 106.559 106.575 106.559 106.571 106.585 106.571 106.585	106.571	106.559	106.575	106.559	106.571	106.585	106.571	106.585
SANITARY INVERT					200Ø PVC SAN 69.0 @ 0.65% SDR-35								
STORM INVERT					250Ø PVC STM 73.0 @ 0.50% SDR-35								
PROPOSED GRADES	0+235.000-106.784 0+240.000-106.806 0+243.715-106.834 0+244.216-106.838 0+249.670-106.878	0+250.000-106.801	0+272.126-106.710	0+280.000-106.671	0+300.000-106.571 0+302.375-106.559 0+306.694-106.575 0+308.375-106.559 0+311.695-106.571 0+313.195-106.585	0+317.670-106.571	0+320.000-106.585						
CENTERLINE CHAINAGE													

PLAN AND PROFILE OF  
**PRIVATE ROAD 2**  
 (STA. 0+000.000 TO 0+100.000)

DRAWN BY: G.G.G. CHECKED BY: S.L.M. PROJECT No. **21-1261**

DESIGNED BY: G.G.G. CHECKED BY: S.L.M.

SCALE: HORZ. 1:50 0 5 10 15 20 SHEET No. **10**

VERT. 1:500 0 0.5 1.0 1.5 2.0