

*Andrew McCreight*  
**ANDREW MCCREIGHT**  
MANAGER, DEVELOPMENT REVIEW CENTRAL  
PLANNING, DEVELOPMENT & BUILDING SERVICES  
DEVELOPMENT DEPARTMENT, CITY OF OTTAWA

**APPROVED**  
By Andrew McCreight at 1:26 pm, Jun 01, 2026

1 SECTION AA AT PATIO STEPS  
Scale: NTS  
USE OF GEOTEXTILE TO BE CONFIRMED BY THE GEOTECH ENGINEER

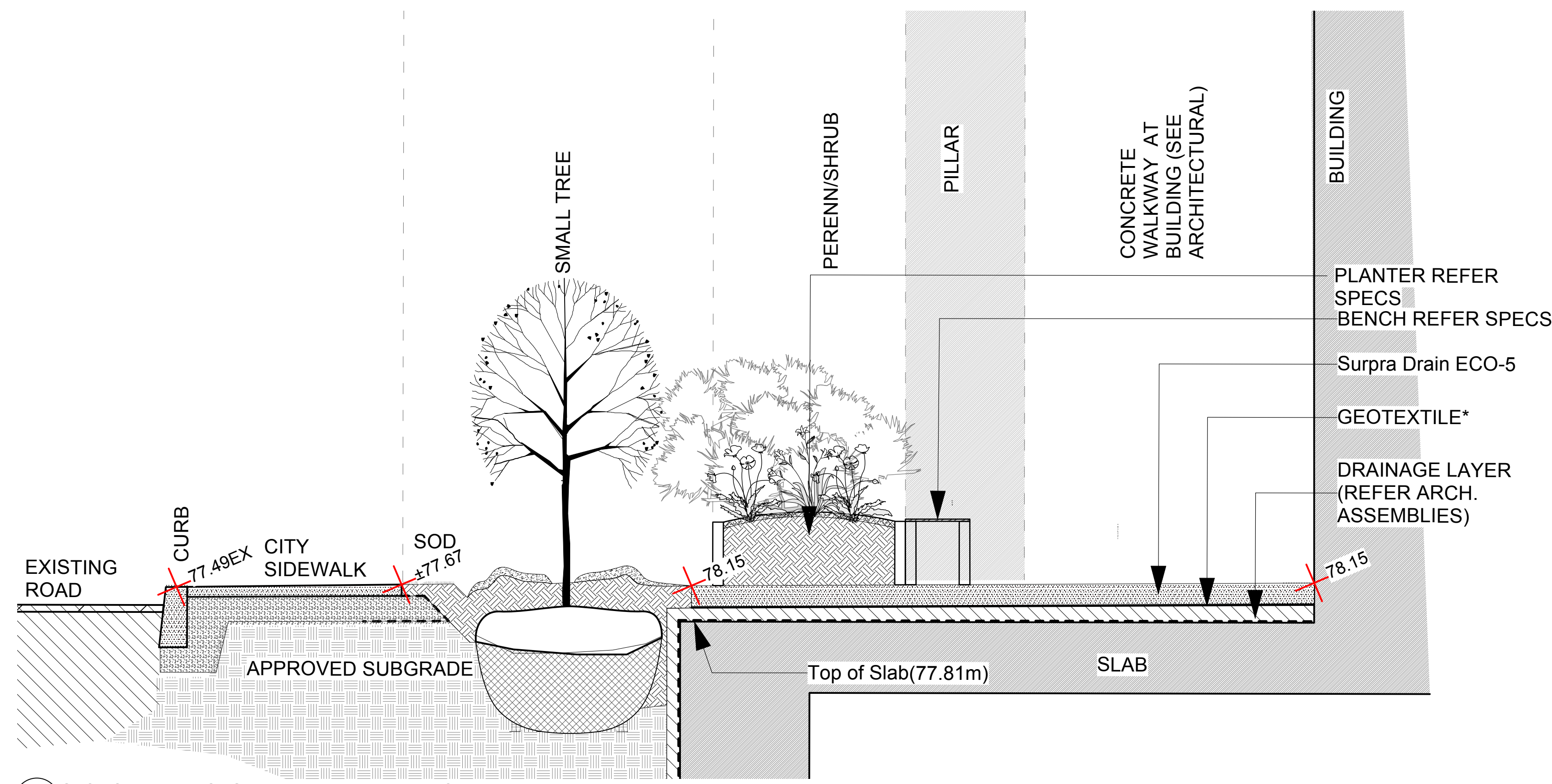

2 SECTION BB THROUGH PLANTER AT ENTRANCE  
Scale: NTS

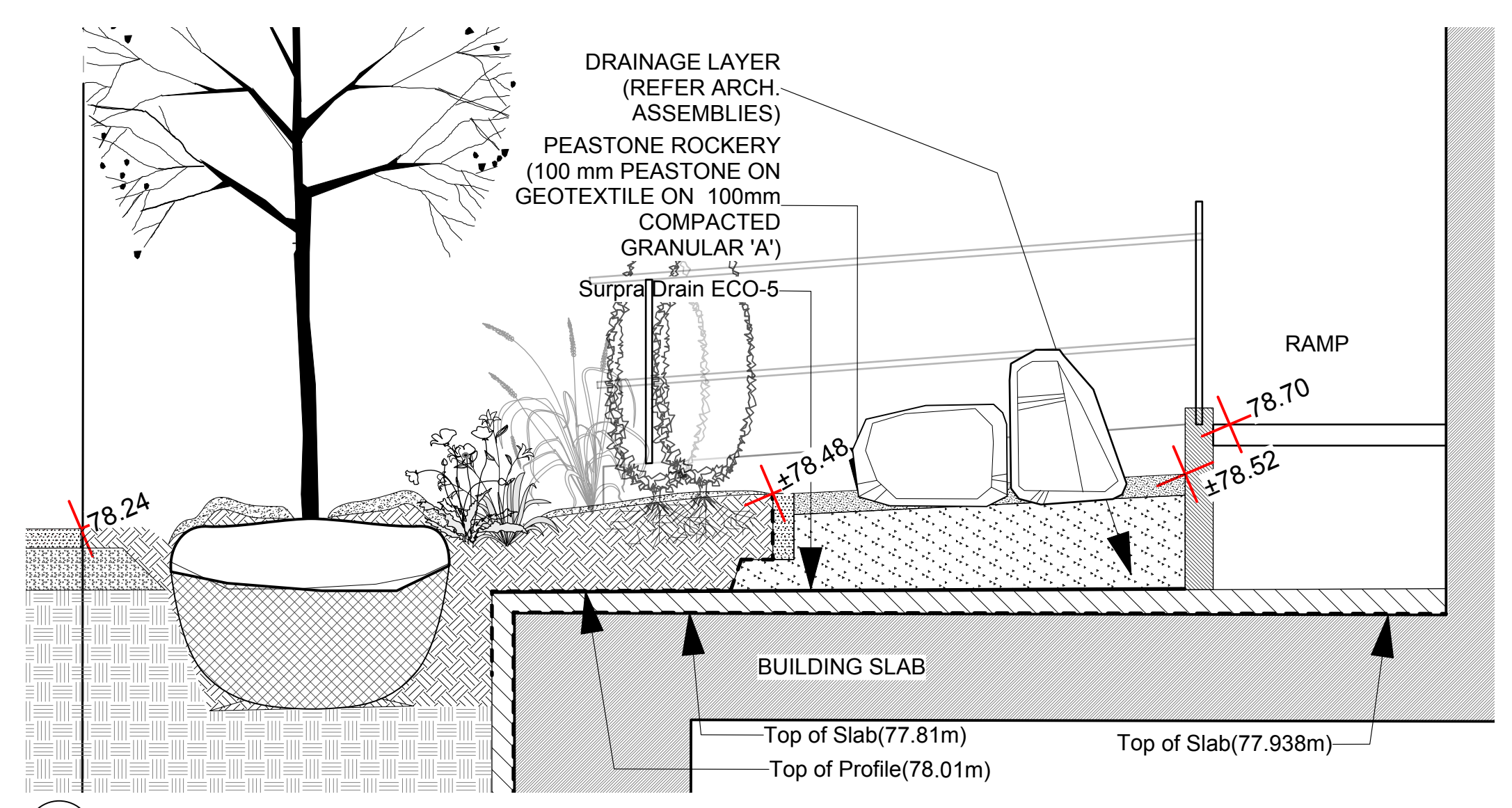

3 SECTION CC AT ROCK INSTALLATION ON SLAB  
Scale: NTS

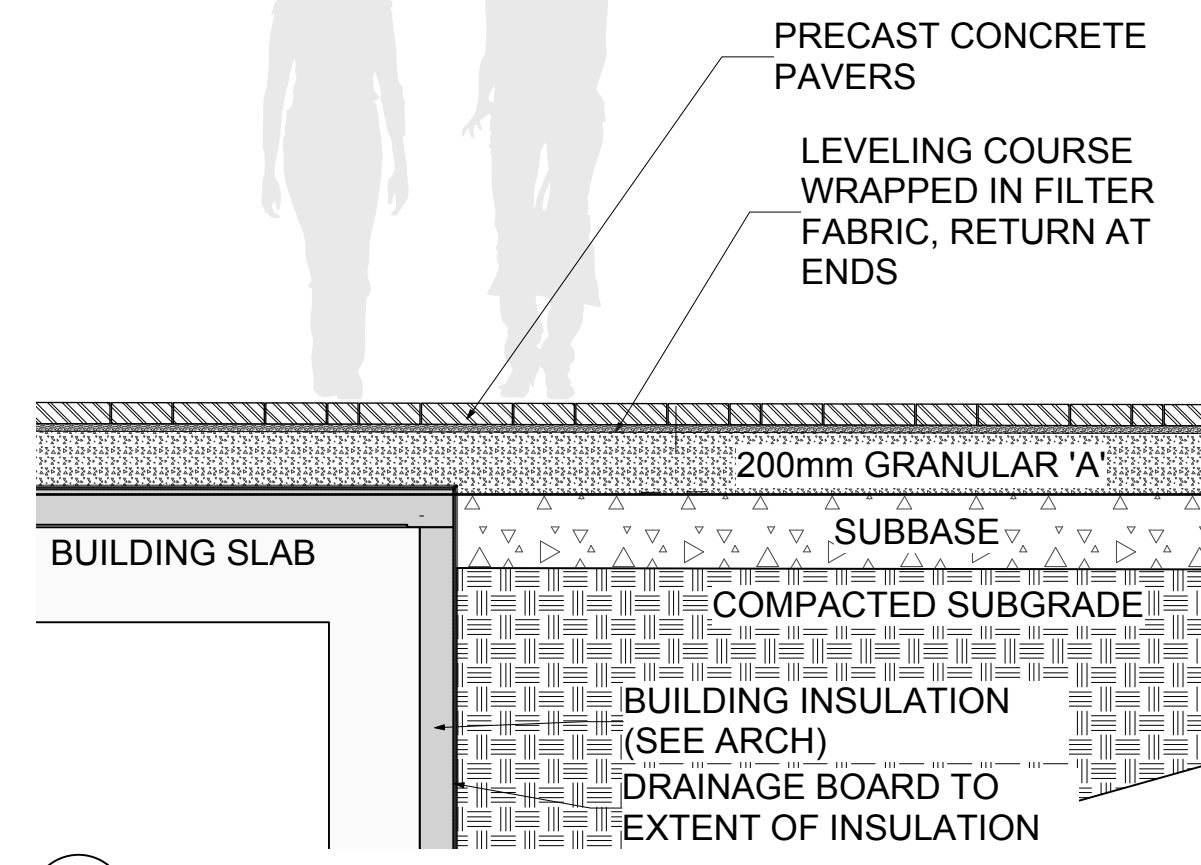

6 PRECAST CONCRETE PAVERS DETAIL ON SLAB  
Scale: NTS

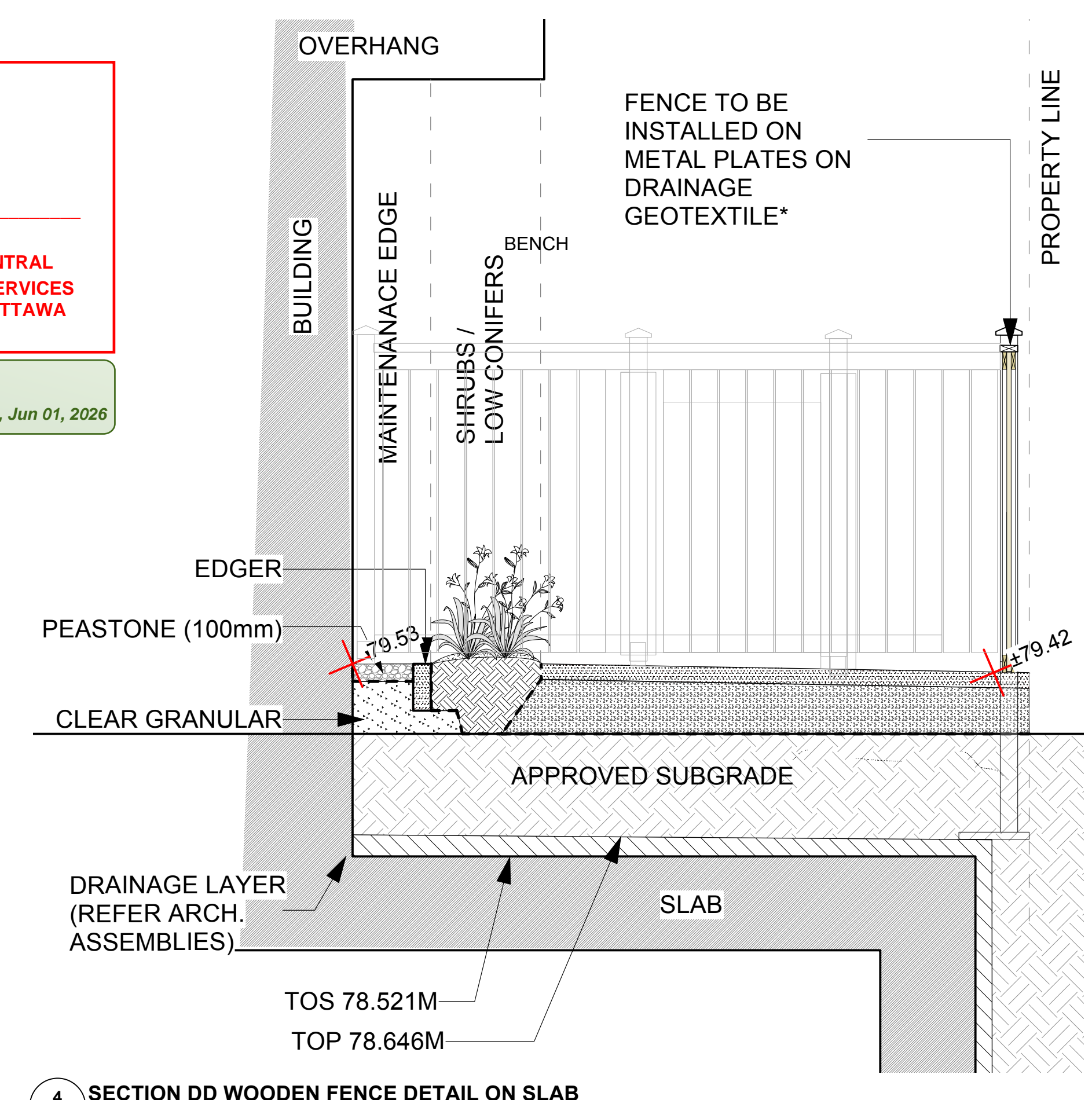

4 SECTION DD WOODEN FENCE DETAIL ON SLAB  
Scale: NTS

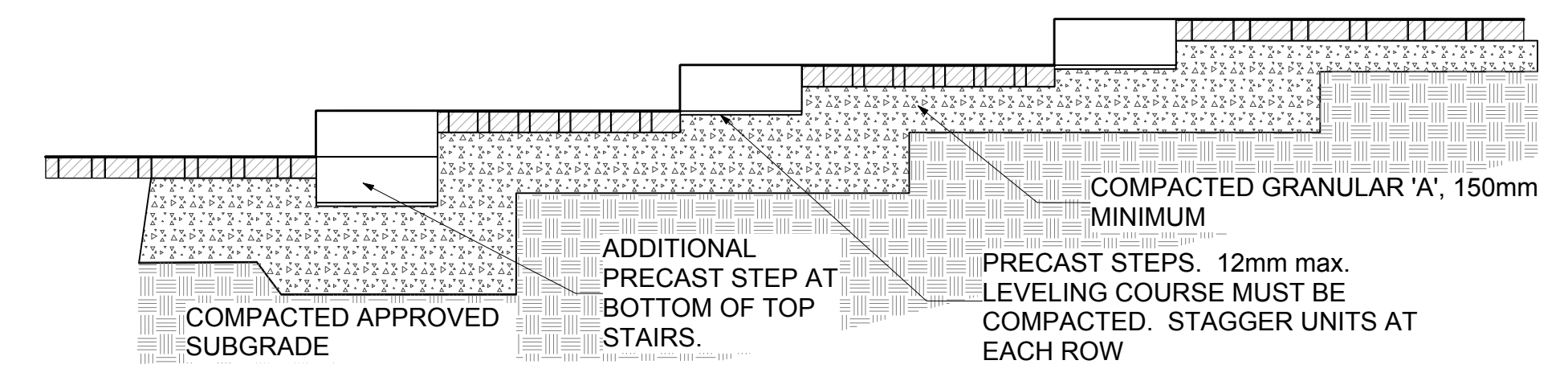

5 SECTION EE AT PRECAST STEPS  
Scale: NTS

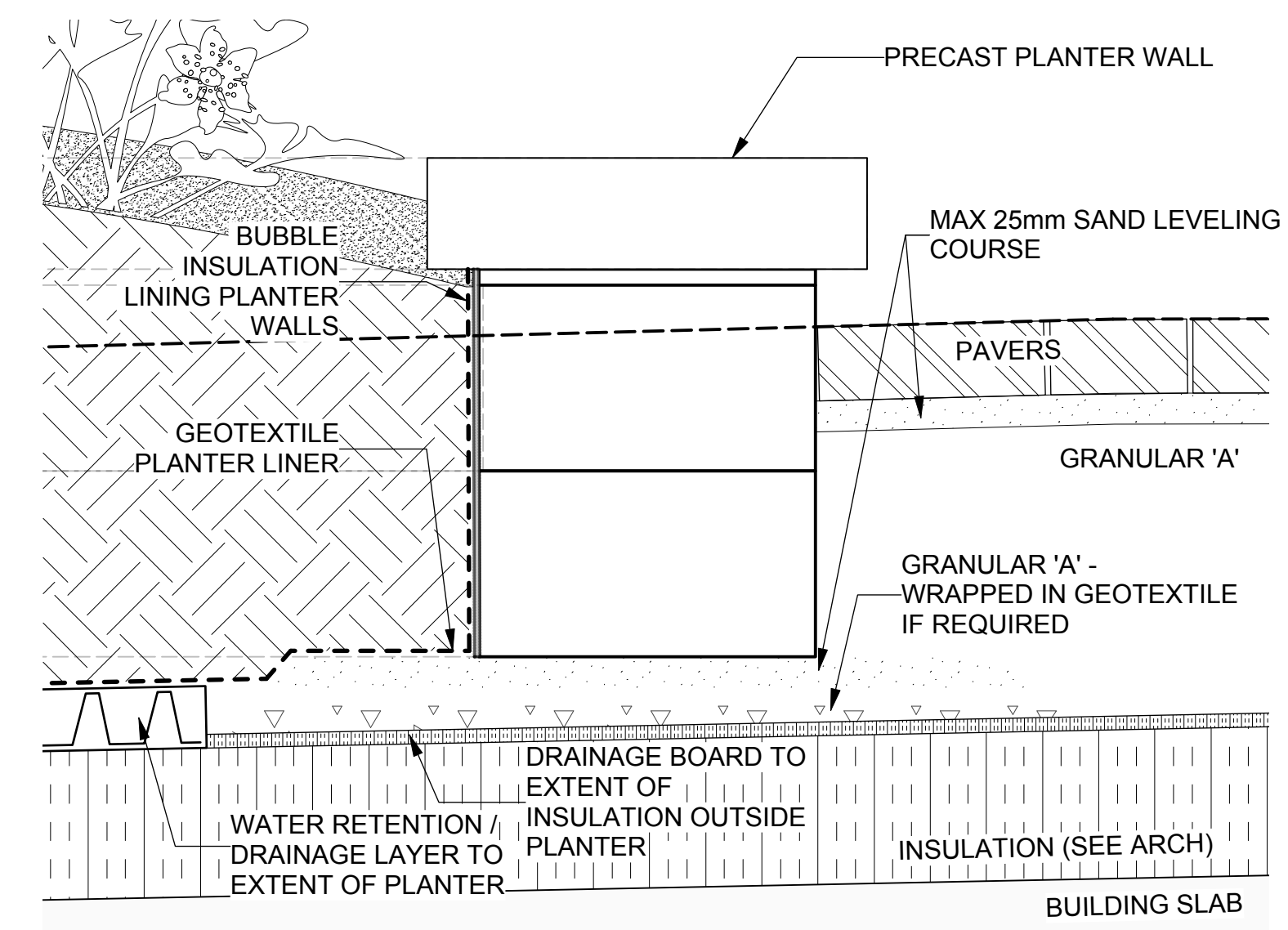

7 PLANTER EDGER DETAIL ON BUILDING SLAB  
Scale: 1:5

3	Issued for Building Permit	2026-04-10
2	Issued for 100% Review Set	2026-04-08
1	Issued for 50% Drawing Set	2026-03-06
no.	issue / revision	date

seal  
north  
ASSOCIATION OF LANDSCAPE ARCHITECTS  
ONARIO  
MEMBER  
2026-04-10

**Ruhland & Associates Ltd**  
landscape architecture • urban design • site planning  
Ph: 613-224-4744 Fx: 613-224-3131 info@rala.ca www.rala.ca

project  
**630 MONTREAL ROAD APARTMENT BUILDING COMPLEX**  
630 MONTREAL RD., OTTAWA, ON

drawing title  
**DETAILS**

scale	drawn by T.F./N.W.	designed by M.R.
date MARCH 02	checked by V.O.	plot date March 02
project number <b>26-1778</b>	drawing number <b>L-03</b>	

Contractor to check and verify all dimensions on the job