

DRAWING LEGEND

- CB CATCH-BASIN
- MH MANHOLE
- CB/MH CATCH BASIN/MANHOLE
- SPL SPRINGLINE OF PIPE
- INV INVERT OF PIPE
- SAN SANITARY SEWER
- ST STORM SEWER
- WS/WM WATER SERVICE/WATERMAIN
- CS CURB STOP & STANDPOST
- VV VALVE & VALVE BOX
- FH FIRE HYDRANT
- FDC FIRE DEPARTMENT CONNECTION
- RD ROOF DRAIN
- WM WATER METER
- RW REMOTE WATER METER READOUT
- EG EXISTING GRADE ELEVATION
- +99.99 PROPOSED GRADE ELEVATION
- XX PROPOSED SLOPE OF GRADE
- EF EMERGENCY OVERLAND FLOW
- T.O.S. TOP OF SLOPE
- CL CENTERLINE OF SWALE
- PL PROPERTY LINE
- DC 150mm CURB/DEPRESSED CURB
- SFB SILT FENCE BARRIER
- LDP LIGHT-DUTY PAVEMENT
- RCP ROAD CUT REINSTATEMENT
- CONC CONCRETE
- LANDSCAPE
- RS RIVER STONE
- FFL FIRST FLOOR ELEVATION
- TOP TOP OF FOUNDATION
- BFL BASEMENT FLOOR ELEVATION
- USF UNDERSIDE OF FOOTING

KEY PLAN

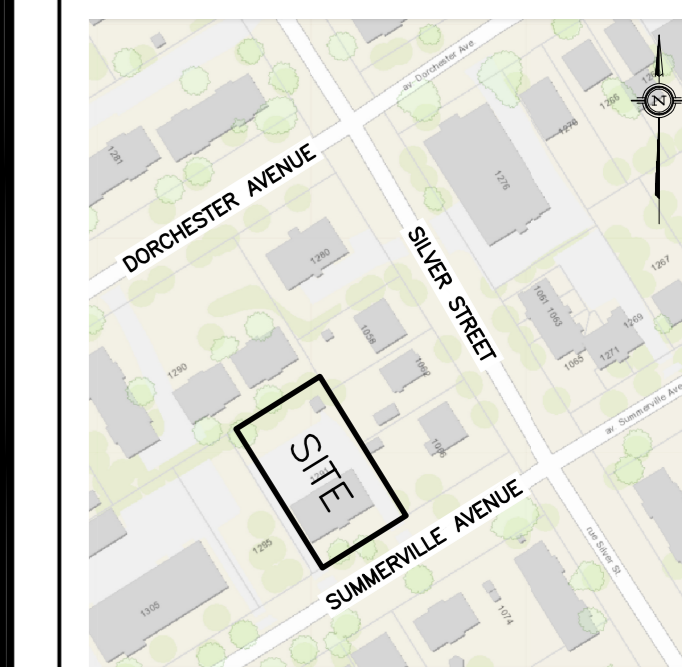

No.	DATE	REVISION
3	OCT 27-21	RE-ISSUED FOR APPROVAL
2	JUL 27-21	ISSUED FOR APPROVAL
1	APR 27-21	ISSUED FOR COORDINATION

D. B. GRAY ENGINEERING INC.
 Stormwater Management - Grading & Drainage - Storm & Sanitary Sewers - Watermain

700 Long Point Circle 613-425-8044
 Ottawa, Ontario d.gray@dbgrayengineering.com

Project

PROPOSED 3-STORY 16-UNIT APARTMENT BUILDING
1291 SUMMERVILLE AVENUE
 OTTAWA, ONTARIO

Drawing Title

EXISTING CONDITIONS, REMOVALS & DECOMMISSIONING

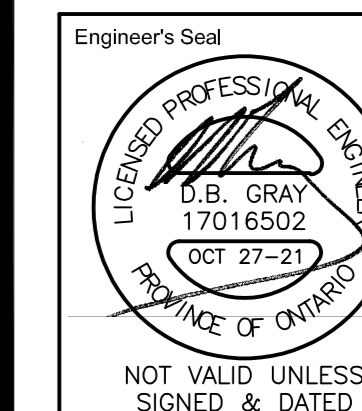

Drawn D.B.G.
 H. Scale 1:100
 V. Scale
 Date FEB 3-21
 Job No. 20102

Drawing No.
C-2
 of 6

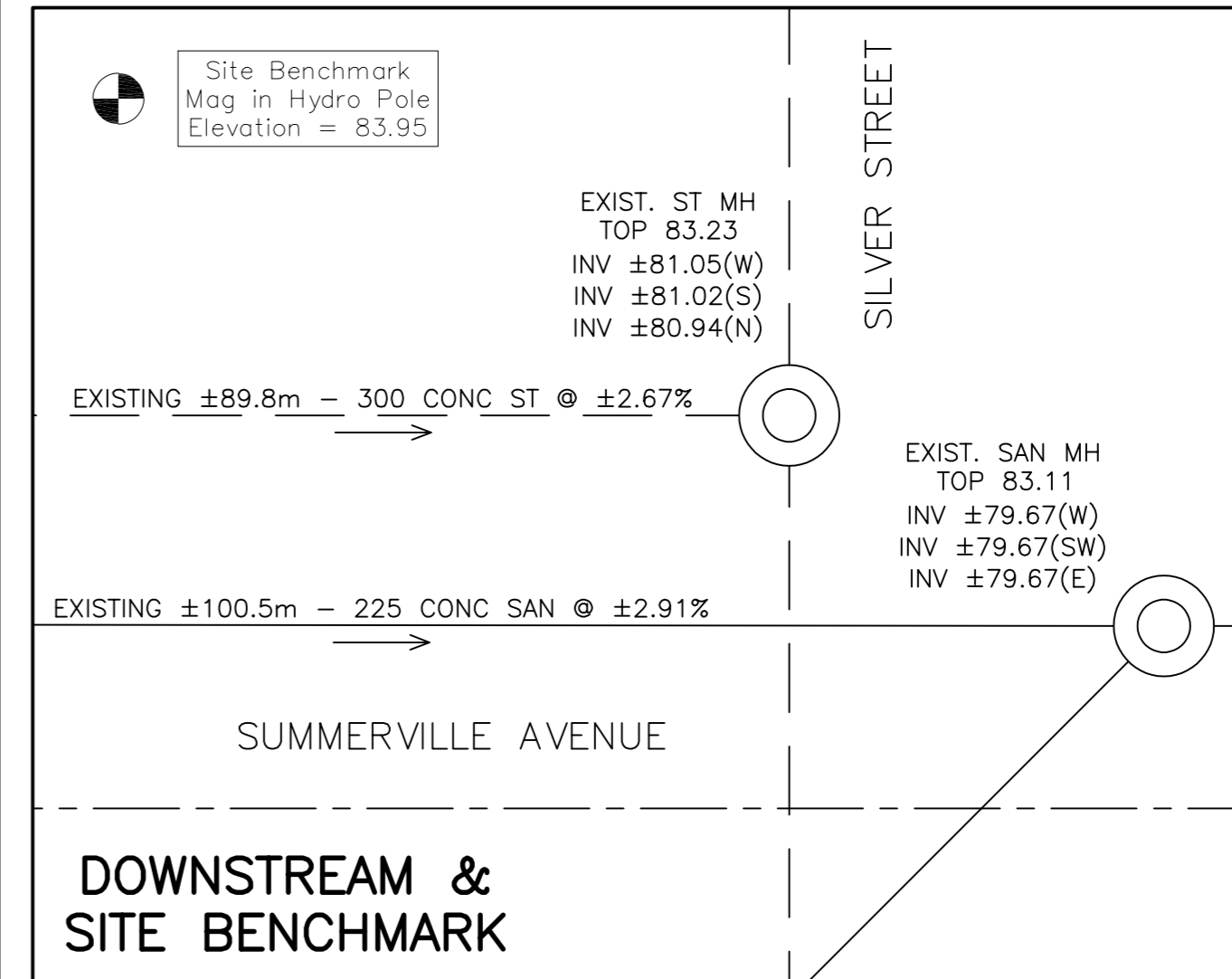

REFER TO NOTES, DETAILS & SCHEDULES ON DRAWINGS C-4 & C-5