

*A. McCreight*

**ANDREW MCCREIGHT**  
**MANAGER, DEVELOPMENT REVIEW CENTRAL**  
**PLANNING, DEVELOPMENT & BUILDING SERVICES**  
**DEVELOPMENT DEPARTMENT, CITY OF OTTAWA**

**APPROVED**  
 By Andrew McCreight at 9:25 am, Nov 15, 2024

**LEGEND:**

- 1 — EXISTING PROPERTY LINE TO REMAIN
- 2 — PROPOSED CURB
- 3 — PROPOSED DEPRESSED CURB
- 4 — PROPOSED TERRACING (3.1 MIN.)
- 5 — PROPOSED SILT FENCE AS PER OPSD 219.110
- 6 — PROPOSED FENCE
- 7 — PROPOSED DOOR ENTRANCE/EEXIT
- 8 — PROPOSED GRASS AREA (100mm TOP SOIL & SOD)
- 9 — PROPOSED CONCRETE FEATURES/SLAB
- 10 — PROPOSED HEAVY DUTY ASPHALT
- 11 — PROPOSED LIGHT DUTY ASPHALT
- 12 — PROPOSED RIP RAP
- 13 — PROPOSED ELEVATION
- 14 — PROPOSED HIGH POINT ELEVATION
- 15 — PROPOSED DEPRESSED CURB
- 16 — PROPOSED BOTTOM OF CURB / ASPHALT ELEVATION
- 17 — PROPOSED TOP OF CURB ELEVATION
- 18 — PROPOSED EXPOSED BOTTOM OF RETAINING WALL
- 19 — PROPOSED TOP OF RETAINING WALL
- 20 — MATCH INTO EXISTING ELEVATION
- 21 — EXISTING ELEVATION
- 22 — PROPOSED OVERLAND MAJOR FLOW ROUTE
- 23 — SUB — PROPOSED 100mmØ PERFORATED SUBDRAIN
- 24 — STM — PROPOSED STORM SEWER
- 25 — SAN — PROPOSED SANITARY SEWER
- 26 — WTR — PROPOSED WATERMAIN
- 27 — STM — EXISTING STORM SEWER
- 28 — SAN — EXISTING SANITARY SEWER
- 29 — WTR — EXISTING WATERMAIN
- 30 — GAS — EXISTING GAS LINE
- 31 — EXISTING MANHOLE
- 32 — EXISTING CATCHBASIN
- 33 — PROPOSED CATCHBASIN-MANHOLE/CATCHBASIN
- 34 — PROPOSED MANHOLE
- 35 — PROPOSED AREA DRAIN
- 36 — PROPOSED CURB STOP
- 37 — PROPOSED PIPE INSULATION
- 38 — PROPOSED 100 YEAR HIGH WATER LEVEL
- 39 — STORM WATERSHED EXTENT
- 40 — WS-XX CONTROLLED — WATERSHED NAME
- 41 — AREA RUNOFF — RUNOFF COEFFICIENT
- 42 — AREA RUNOFF — AREA IN HECTARES

**USE AND INTERPRETATION OF DRAWINGS**

GENERAL CONDITIONS OF THE CONTRACT FOR CONSTRUCTION ARE PART OF THE CONTRACT DOCUMENTS AND DESCRIBE USE AND INTENT OF THE DRAWING. THE CONTRACT DOCUMENTS INCLUDE NOT ONLY THE DRAWINGS, BUT ALSO THE OWNER-CONTRACTOR AGREEMENTS, CONDITIONS OF THE CONTRACT, THE SPECIFICATIONS, ADDENDA, AND MODIFICATIONS ISSUED AFTER EXECUTION OF THE CONTRACT. THESE CONTRACT DOCUMENTS ARE COMPLEMENTARY, AND WHAT IS REQUIRED BY ANY ONE SHALL BE BINDING AS IF REQUIRED BY ALL. WORK NOT COMPLETELY DELINEATED HEREON SHALL BE CONSTRUCTED OF THE SAME MATERIALS AND DETAILED SIMILARLY AS WORK SHOWN MORE COMPLETELY ELSEWHERE IN THE CONTRACT DOCUMENTS.

BY USE OF THE DRAWINGS FOR CONSTRUCTION OF THE PROJECT, THE OWNER CONFIRMS THAT HE HAS REVIEWED AND APPROVED THE DRAWINGS. THE CONTRACTOR CONFIRMS THAT HE HAS VISITED THE SITE, FAMILIARIZED HIMSELF WITH THE LOCAL CONDITIONS, VERIFIED FIELD DIMENSIONS AND CORRELATED HIS OBSERVATIONS WITH THE REQUIREMENTS OF THE CONTRACT DOCUMENTS.

AS INSTRUMENTS OF SERVICE, ALL DRAWINGS, SPECIFICATIONS, CADD FILES OR OTHER ELECTRONIC MEDIA AND COPIES THERE OF FURNISHED BY THE ENGINEER ARE HIS PROPERTY. THEY ARE TO BE USED ONLY FOR THIS PROJECT AND ARE NOT TO BE USED ON ANY OTHER PROJECT, INCLUDING REPEATS OF THE PROJECT. CHANGES TO THE DRAWINGS MAY ONLY BE MADE BY THE ENGINEER.

UNLESS THE REVISION TITLE IS "ISSUED FOR CONSTRUCTION", THESE DRAWINGS SHALL BE CONSIDERED PRELIMINARY AND SHALL NOT BE USED AS A CONSTRUCTION DOCUMENT.

THESE DRAWINGS ILLUSTRATE THE WORK TO BE DONE. THE ENGINEER IS NOT RESPONSIBLE FOR THE MEANS, METHODS, TECHNIQUES, SEQUENCES, AND PROCEDURES USED TO DO THE WORK, OR THE SAFETY ASPECTS OF CONSTRUCTION, AND NOTHING ON THESE DRAWINGS EXPRESSED OR IMPLIED CHANGES THIS CONDITION. CONTRACTOR SHALL DETERMINE ALL CONDITIONS AT THE SITE AND SHALL BE RESPONSIBLE FOR KNOWING HOW THEY AFFECT THE WORK. SUBMITTAL OF A BID TO PERFORM THIS WORK IS ACKNOWLEDGEMENT OF THE RESPONSIBILITIES, AND THAT THEY HAVE BEEN FULLY CONSIDERED IN PLANNING OF THE WORK, AND THE BID PRICE. NO CLAIMS FOR EXTRA CHARGES DUE TO THESE CONDITIONS WILL BE FORTHCOMING.

UNAUTHORIZED CHANGES:

IN THE EVENT THE CLIENT, THE CLIENT'S CONTRACTORS OR SUBCONTRACTORS, OR ANYONE FOR WHOM THE CLIENT IS LEGALLY LIABLE MAKES OR PERMITS TO BE MADE ANY CHANGES TO ANY REPORTS, PLANS, SPECIFICATIONS OR OTHER CONSTRUCTION DOCUMENTS PREPARED BY LRI ASSOCIATES LTD. (LRI) WITHOUT OBTAINING LRI'S PRIOR WRITTEN CONSENT, THE CLIENT SHALL ASSUME FULL RESPONSIBILITY FOR THE RESULTS OF SUCH CHANGES. THEREFORE THE CLIENT AGREES TO WAIVE ANY CLAIM AGAINST LRI AND TO RELEASE LRI FROM ANY LIABILITY ARISING DIRECTLY OR INDIRECTLY FROM SUCH UNAUTHORIZED CHANGES.

IN ADDITION, THE CLIENT AGREES, TO THE FULLEST EXTENT PERMITTED BY LAW, TO INDEMNIFY AND HOLD HARMLESS LRI FROM ANY DAMAGES, LIABILITIES OR COST, INCLUDING REASONABLE ATTORNEY'S FEES AND COST OF DEFENSE, ARISING FROM SUCH CHANGES.

IN ADDITION, THE CLIENT AGREES TO INCLUDE IN ANY CONTRACTS FOR CONSTRUCTION APPROPRIATE LANGUAGE THAT PROHIBITS THE CONTRACTOR OR ANY SUBCONTRACTORS OF ANY TIER FROM MAKING ANY CHANGES OR MODIFICATIONS TO LRI'S CONSTRUCTION DOCUMENTS WITHOUT THE PRIOR WRITTEN APPROVAL OF LRI, AND THAT FURTHER REQUIRES THE CONTRACTOR TO INDEMNIFY BOTH LRI AND THE CLIENT FROM ANY LIABILITY OR COST ARISING FROM SUCH CHANGES MADE WITHOUT SUCH PROPER AUTHORIZATION.

GENERAL NOTES:

EXISTING SERVICES AND UTILITIES SHOWN ON THESE DRAWINGS ARE TAKEN FROM THE BEST AVAILABLE RECORDS, BUT MAY NOT BE COMPLETE OR TO DATE. CONTRACTOR SHALL VERIFY IN FIELD FOR LOCATION AND ELEVATION OF PIPES AND CHECK WITH THE UTILITY COMPANIES BEFORE DIGGING OR PERFORMING WORK.

CONTRACTOR IS ADVISED TO COLLECT INFORMATION ON SOIL CONDITIONS BEFORE START OF CONSTRUCTION.

THE ENGINEER WAIVES ANY AND ALL RESPONSIBILITY AND LIABILITY FOR PROBLEMS WHICH ARISE FROM FAILURE TO FOLLOW THESE PLANS, SPECIFICATIONS AND THE DESIGN INTENT THEY CONVEY, OR FOR PROBLEMS WHICH ARISE FROM OTHERS' FAILURE TO OBTAIN AND/OR FOLLOW THE ENGINEER'S GUIDANCE WITH RESPECT TO ANY ERRORS, OMISSIONS, INCONSISTENCIES, AMBIGUITIES OR CONFLICTS WHICH ARE ALLEGED.

CONTRACTOR TO VERIFY ALL DIMENSIONS AND NOTIFY THE ENGINEER OF ANY DISCREPANCIES BEFORE WORK COMMENCES. DO NOT SCALE DRAWINGS.

5m 0 5 10m  
 SCALE: 1:250

No.	REVISIONS	BY	DATE
04	ISSUED FOR CITY APPROVAL	T.H.	22 NOV 2023
03	ISSUED FOR CITY APPROVAL	T.H.	14 JUN 2023
02	ISSUED FOR CITY APPROVAL	T.H.	15 DEC 2022
01	ISSUED FOR MUNICIPAL APPROVAL	A.S.	04 MAR 2021

No.	REVISIONS	BY	DATE
04	ISSUED FOR CITY APPROVAL	T.H.	22 NOV 2023
03	ISSUED FOR CITY APPROVAL	T.H.	14 JUN 2023
02	ISSUED FOR CITY APPROVAL	T.H.	15 DEC 2022
01	ISSUED FOR MUNICIPAL APPROVAL	A.S.	04 MAR 2021



NOT AUTHENTIC UNLESS SIGNED AND DATED

**LRJ**  
 ENGINEERING | INGÉNIERIE  
 5430 Canotek Road | Ottawa, ON, K1J 9G2  
 www.lri.ca | (613) 842-3434

CLIENT: **KATASA GROUP**  
 69 Rue Jean-Proulx unit #301  
 Gatineau, QC, J8V 1W2

DESIGNED BY: T.H. DRAWN BY: T.H. APPROVED BY: M.B.

PROJECT: **770-774 BRONSON AVENUE**

DRAWING TITLE: **POST-DEVELOPMENT WATERSHED PLAN**

PROJECT NO: **200436**  
 DATE: **NOVEMBER 2023**

**C702**

#18887

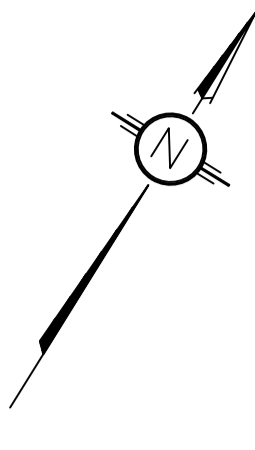
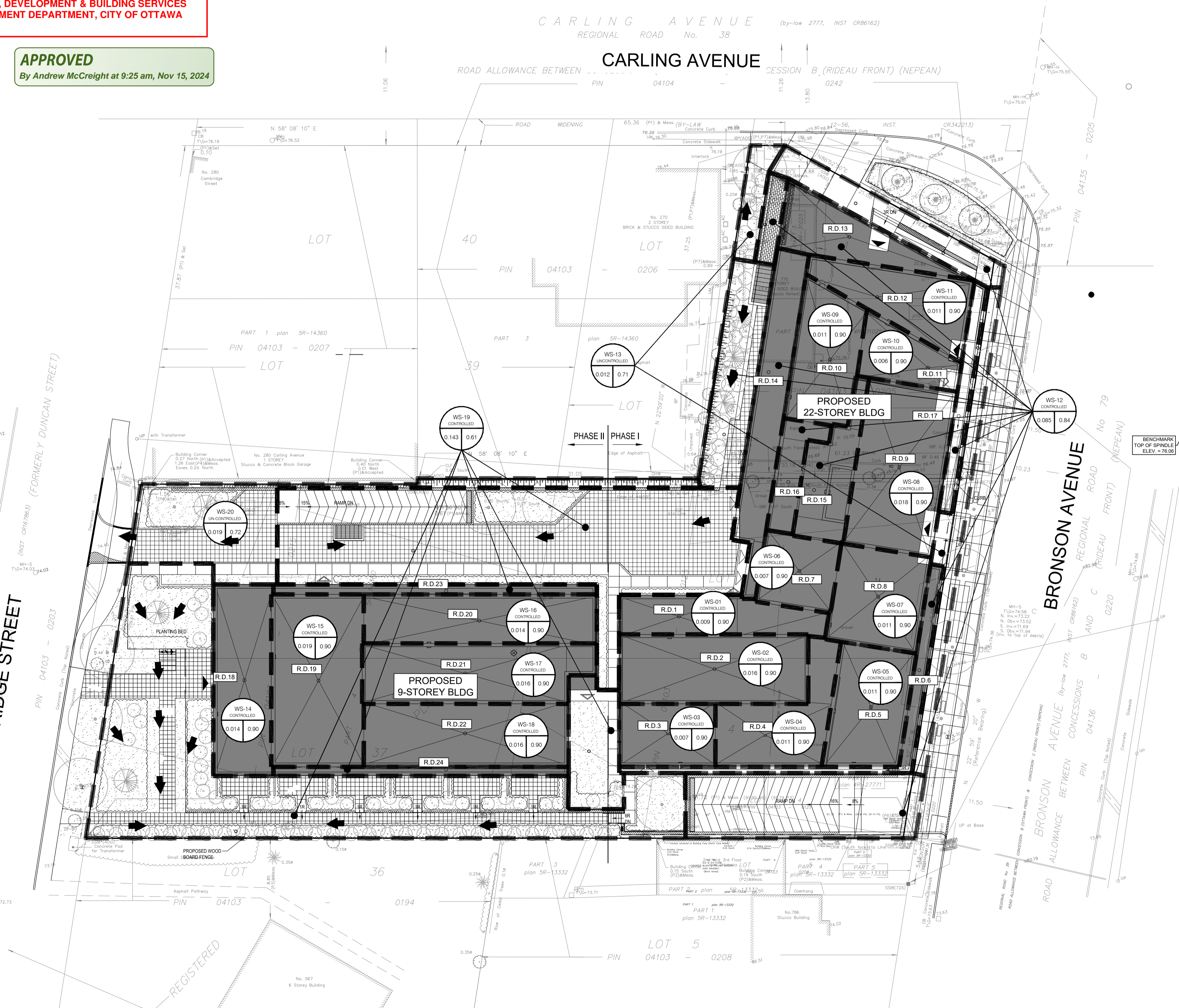

CAMBRIDGE STREET

CARLING AVENUE (by-law 2777, INST CR86162)  
 REGIONAL ROAD No. 38

CARLING AVENUE

BRONSON AVENUE  
 REGIONAL ROAD (RIDEAU FRONT) (NEPEAN)

D07-12-21-0108