

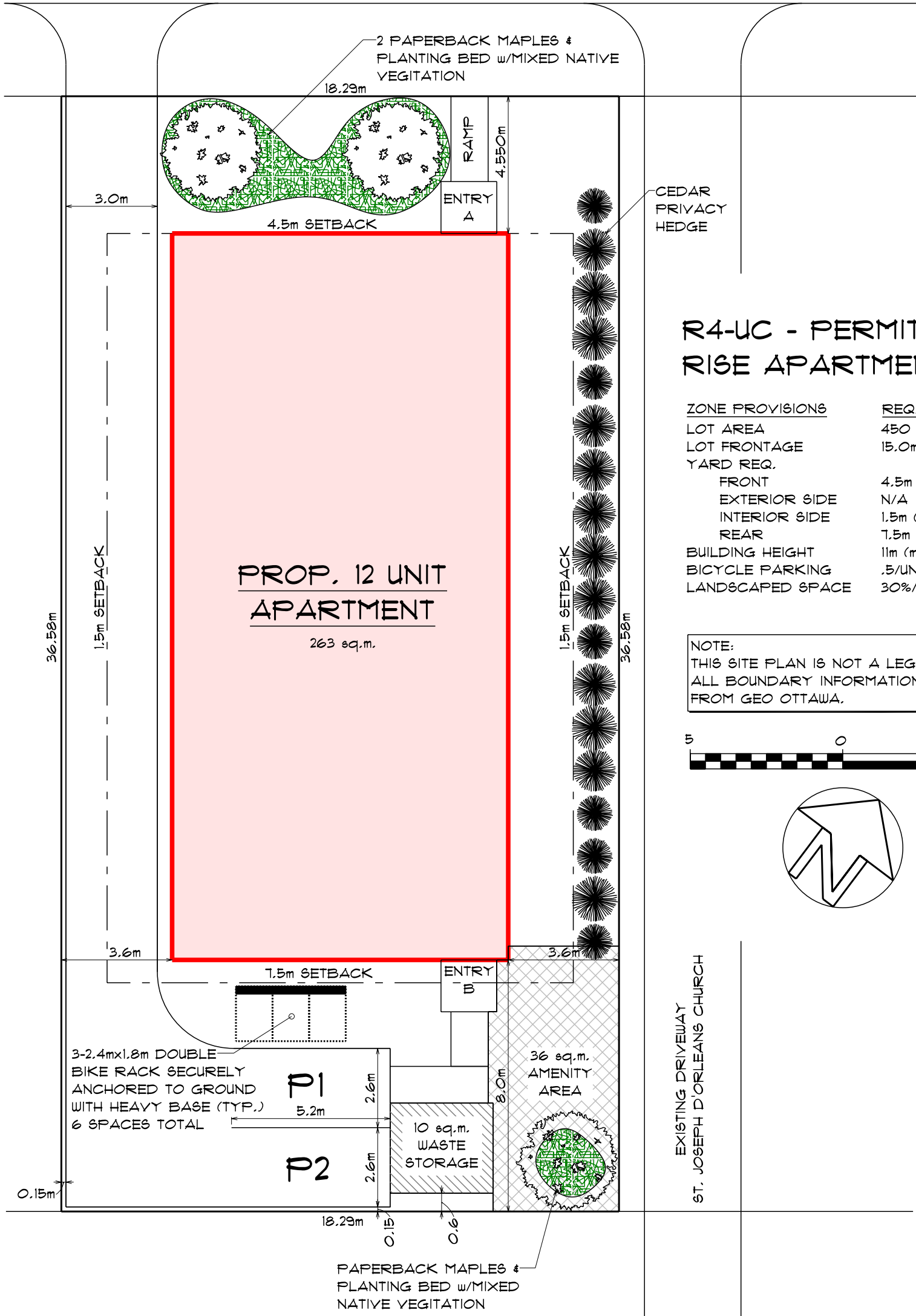

# ROCQUE ST



## R4-UC - PERMITTED USES - LOW RISE APARTMENT DWELLING

ZONE PROVISIONS	REQ.D	PROPOSED
LOT AREA	450 m.sq. (min.)	669.05 m.sq.
LOT FRONTAGE	15.0m (min.)	18.29m
YARD REQ.		
FRONT	4.5m (min.)	4.55m
EXTERIOR SIDE	N/A	N/A
INTERIOR SIDE	1.5m (min.)	3.6m
REAR	7.5m (min.)	8.0m
BUILDING HEIGHT	11m (max.)	12.0m
BICYCLE PARKING	.5/UNIT	6 SPACES
LANDSCAPED SPACE	30%/200.7 m.sq.	37%/246.1 m.sq.

NOTE:  
THIS SITE PLAN IS NOT A LEGAL SURVEY  
ALL BOUNDARY INFORMATION TAKEN  
FROM GEO OTTAWA.

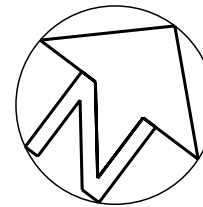
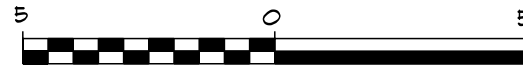

### SKETCH SITE PLAN

SCALE: 1:150

#### COPYRIGHT

All drawings, specifications and related documents are the copyright property of Seaway Design Group and must be returned upon request. Reproduction of drawings, specifications, and related documents in whole or in part is forbidden without the written permission of Seaway Design Group.

These plans form the basis for permit issuance and any deviations from these plans and details, including the ventilation system, heating system, woodstove, fireplaces, decks, balconies and finished basements, will require a revised drawing and clearance by the Building Department.

Engineered floor system and engineered truss system designed by others and not by designer. These systems are exempt as permitted in the OBC 3.2.5.1 (3)(h)

The undersigned has reviewed this design, has qualifications and meets the requirements set out in the Ontario Building Code to be a designer.

REGISTRATION INFORMATION:  
Anthony Wielemaker:  
Individual BCIN# 28341  
Seaway Design Group:  
Firm BCIN# 116151

#### REVISIONS:

No.	Date	Description
1.	26/05/06	FOR ZBA

RESIDENCE FOR

**ROCQUE ST. APARTMENTS**  
6712 ROCQUE ST.  
ORLEANS, ON  
K1C 1A2

PROJECT TITLE

**PROPOSED APARTMENT**

DRAWING TITLE

**PROPOSED SITE & LANDSCAPING PLAN**

DATE: MAY, 2026	APPROVED: A.M.W.
DRAWN BY: E.H.	SCALE: AS SHOWN
PROJECT No.: 25-KD-6712 Rocque St 12 Apt.	



UNIT 10 - 4503 SOUTH AVENUE,  
BROCKVILLE ON tel: 613-704-8797  
www.seawaydg.ca

