

MCGILLIVRAY STREET

SURVEY SOURCE
TOPOGRAPHIC PLAN OF SURVEY OF
LOTS 11 AND 12
AND
PART OF LOTS 3 AND 4
BLOCK 'K'
REGISTERED PLAN 102
CITY OF OTTAWA
 Surveyed by Annis, O'Sullivan, Vollebek Ltd.



Drawing Remains the Property of Copyright Reserved by GJA INC. Do Not Use or Reproduce Without Approval of Gino J. Aiello.
 [PLANTING MIX TO BE APPROVED BY LANDSCAPE ARCHITECT | PLANT MATERIAL TO MEET CNLA STANDARDS/BE APPROVED BY LANDSCAPE ARCHITECT PRIOR TO PLANTING ALL MATERIALS & WORK TO BE MAINTAINED UNTIL FINAL ACCEPTANCE, INCLUDE 1 YEAR WARRANTY FROM DATE OF FINAL ACCEPTANCE | REFER TO CIVIL ENGINEER'S DRAWING FOR ELEVATIONS / GRADING]
 The Landscape Plan is to be read in conjunction with the grading, servicing, site and survey plan. All trees to be preserved on or directly adjacent to the site will be protected | Plant material are to be installed a minimum of 3.0m away from any part of any hydro transformer, 3.0m corridor between a fire hydrant and the curb, a 2.5m radius beside or behind a fire hydrant, 2.0m from any servicing/utility line or structure |

TREE SCHEDULE - JB HOLDINGS 441 ECHO DRIVE MULTI UNIT RESIDENTIAL

| CODE | QTY | BOTANICAL NAME | COMMON NAME | B&B SPECIMEN | NATIVE TO CANADA | FORECASTED SPREAD per City of Ottawa Forestry | Canopy Cover Contribution/Tree in Square Metres | Total Canopy Cover |
|---|-----------|------------------------------|-------------------|--------------|------------------|---|---|--------------------|
| | | | | | | DIAMETER | RADIUS | |
| AC | 4 | Amelanchier canadensis | Tree Serviceberry | 50mm cal | YES | 5.0M | 2.5M | 80 |
| AR | 3 | Acer rubrum | Red Maple | 50mm cal | YES | 10.0M | 5.0M | 235.5 |
| AS | 3 | Acer saccharum | Sugar Maple | 50mm cal | YES | 14.0M | 7.0M | 462 |
| AT | 1 | Asimina triloba | Paw Paw | 50mm cal | YES | 5.0M | 2.5M | 20 |
| BP | 1 | Betula papyrifera | Paper Birch | 50mm cal | YES | 10.0M | 5.0M | 78.5 |
| CR | 1 | Cornus racemosa | Grey Dogwood | 50mm cal | YES | 5.0M | 2.5M | 20 |
| OV | 3 | Ostrya virginiana | Ironwood | 50mm cal | YES | 5.0M | 2.5M | 20 |
| TOTAL DT | 12 | TOTAL DECIDUOUS COVER | | | | | | 876 |
| TOTAL FORECASTED CANOPY COVER IN SQUARE METRES | | | | | | | | 450 |
| TOTAL OVERLAP WITH BUILDINGS, TREES, PROPERTY LINE, IN SQUARE METRES | | | | | | | | 426 |
| CANOPY COVER IN SQUARE METRES | | | | | | | | 1392 |
| SITE AREA IN SQUARE METRES | | | | | | | | 30.60% |
| TOTAL FORECASTED CANOPY COVER as Percentage of Site Area | | | | | | | | |

SHRUB PLANTING

| Code | Qty. | Botanical Name | Common Name | Size | Condition | NATIVE |
|------|------|-------------------------|-------------------------|----------|-----------|--------|
| HK | 175 | Hypericum kalmianum | Kalm St. John's Wort | 30cm | Pot | YES |
| HP | 75 | Hypericum prolificum | Shrubby St. John's Wort | 40cm | Pot | YES |
| AU | 75 | Arctostaphylos uva ursi | Bearberry | 30cm spr | Pot | YES |
| PV | 75 | Panicum virgatum | Switch Grass | 9 cm Pot | | YES |

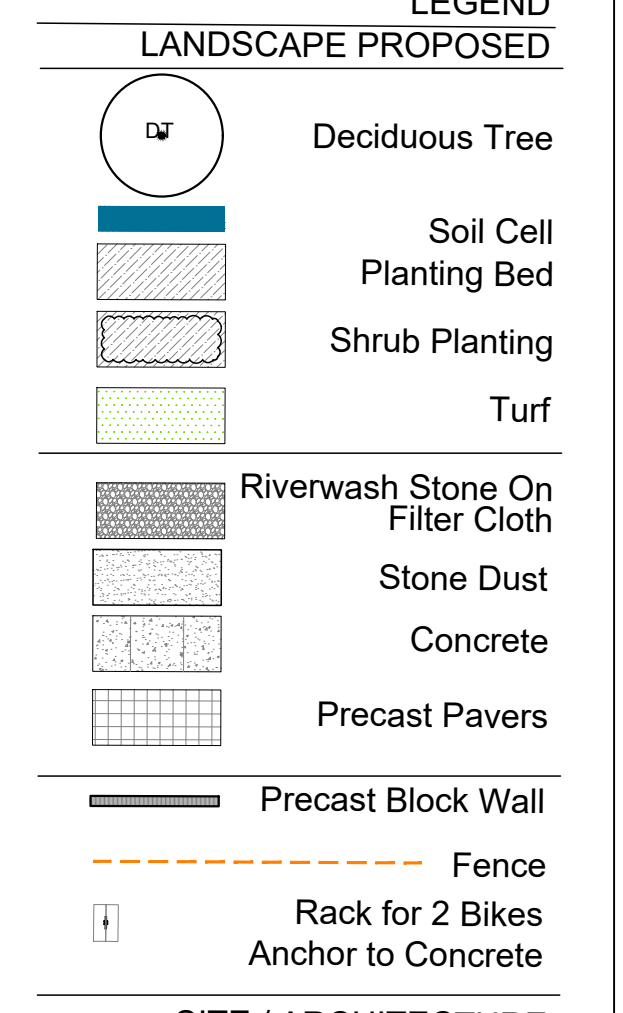
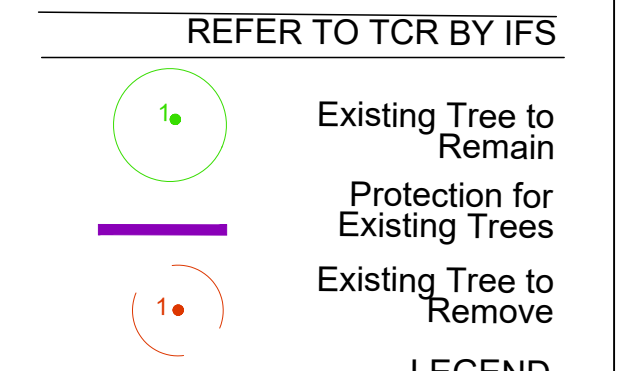
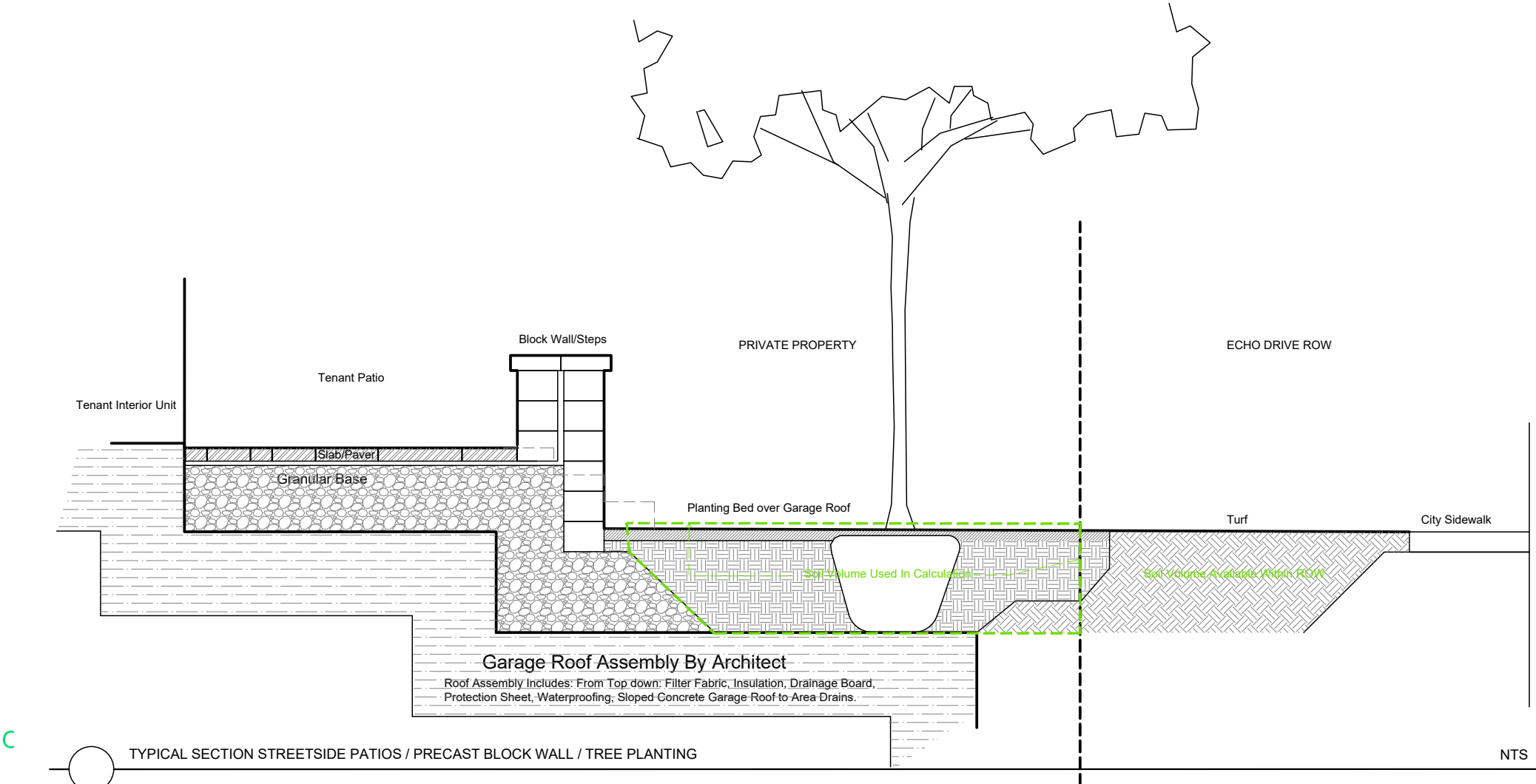
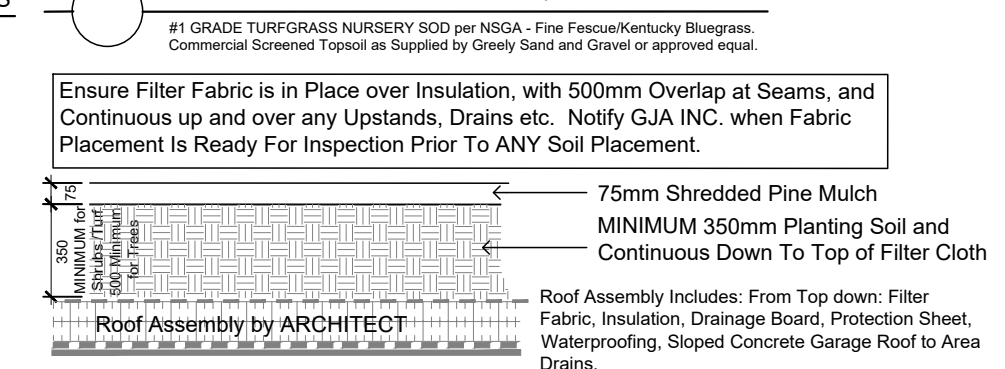
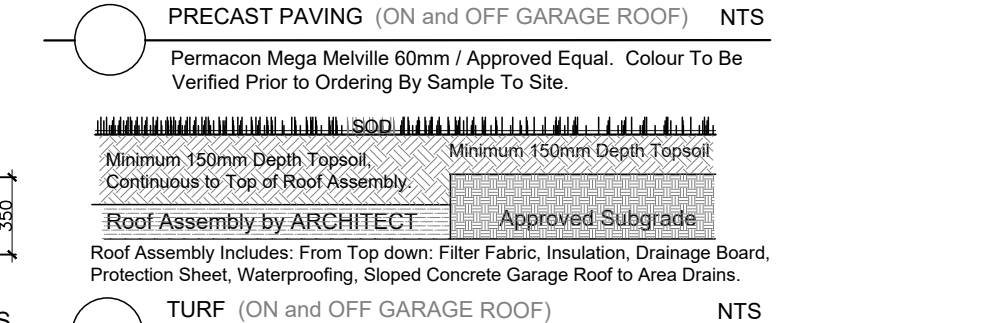
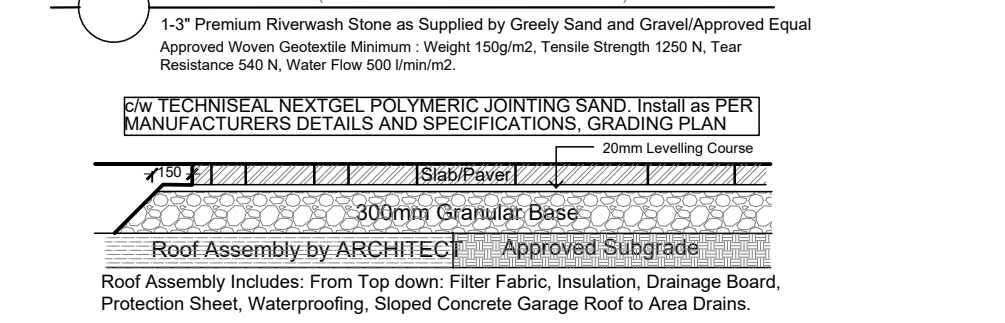
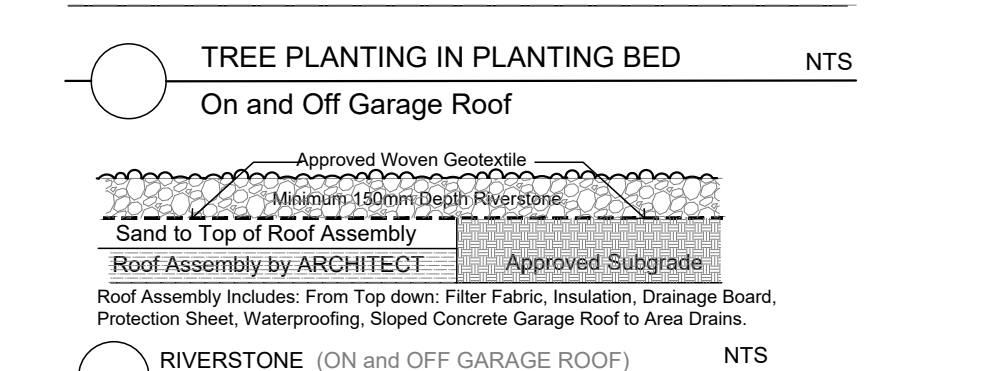
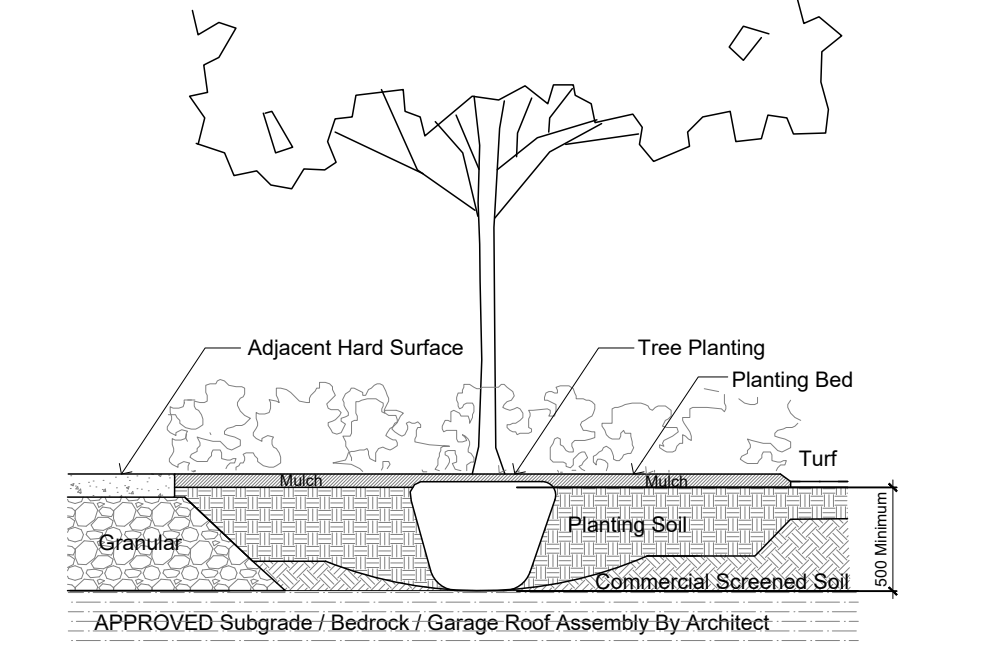
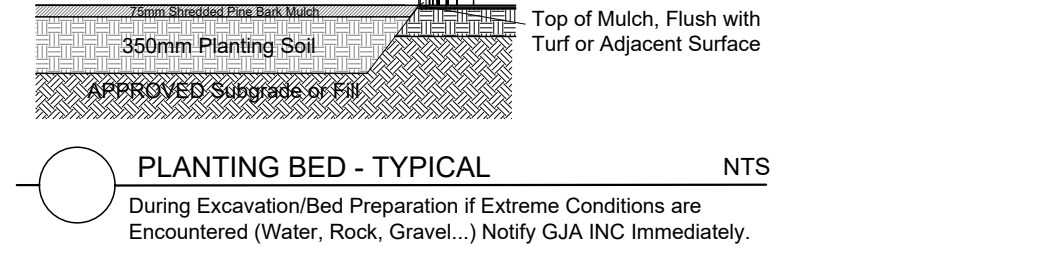
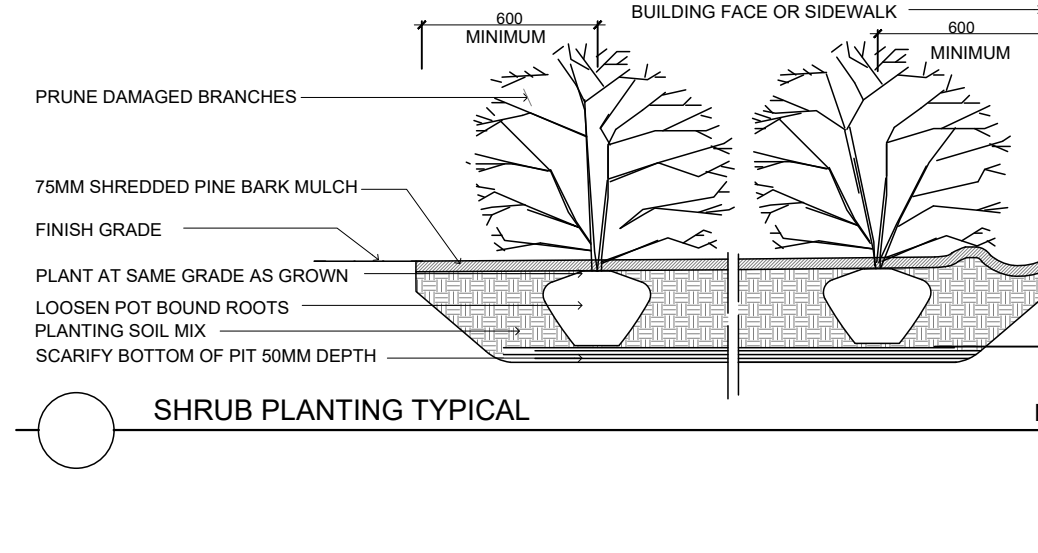
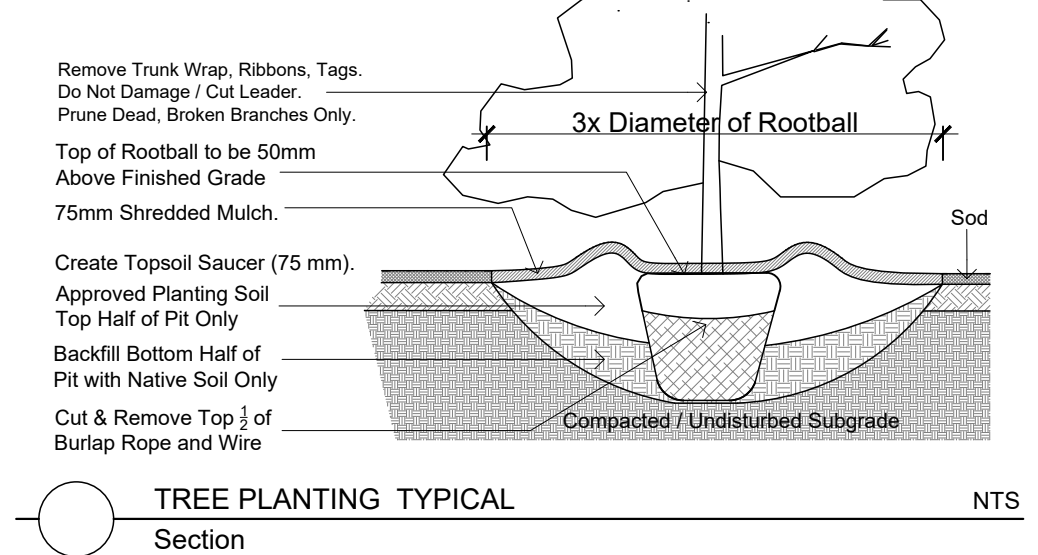
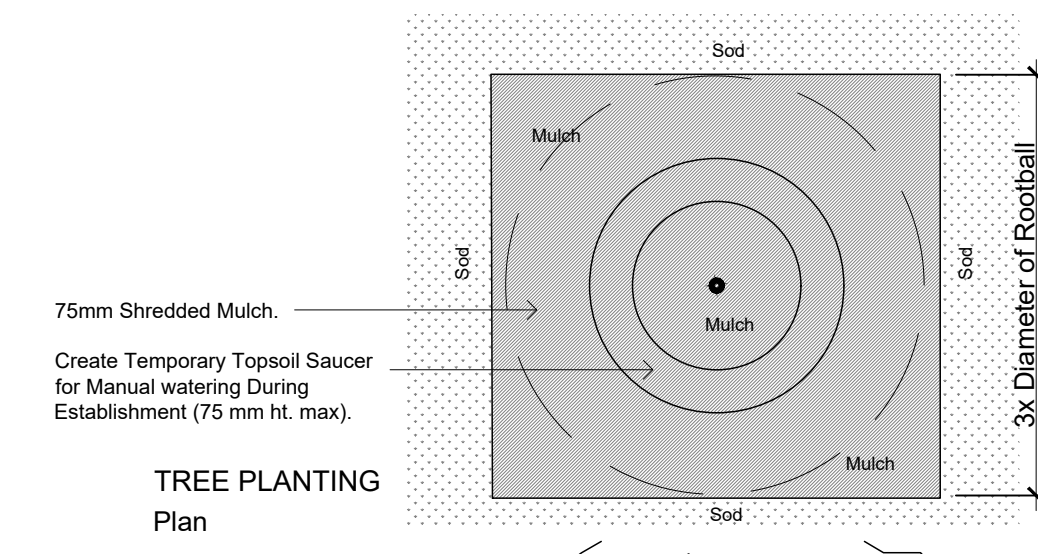
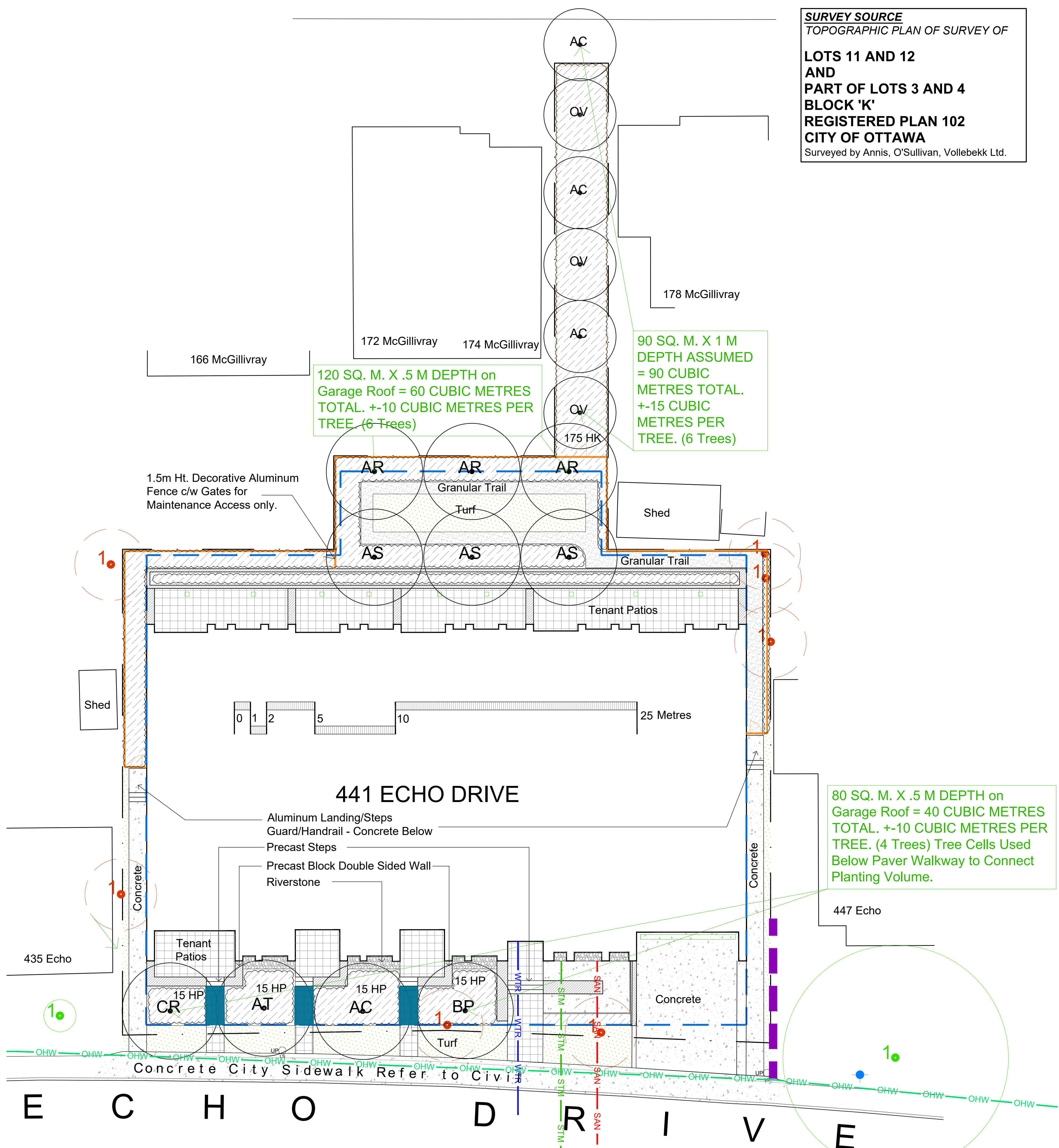

REVISIONS

| | | |
|---|---------------------|------------|
| 1 | SPC SUBMISSION 1 | 2026 04 30 |
| 0 | REVIEW COORDINATION | 2026 01 15 |
| # | Revision | Date |

PROPERTY OWNER
JB HOLDINGS INC.
 107 PRETORIA AVENUE OTTAWA

GJA INC.
 GINO J. AIELLO | LANDSCAPE ARCHITECT
 GJAL.COM | 613 286 5130 | GINO@GJAL.COM
 115 DEBILITY ROAD UNIT # 8 | OTTAWA ONTARIO | K1T 5C2

MULTI UNIT RESIDENTIAL APARTMENT BUILDING
 441 ECHO DRIVE OTTAWA

Landscape Plan
L1
 Scale: 1:125

PLAN NO
 OH#