

G:\Shared drives\Commercial Department\02 - PROJECTS\2025\25029-DC - 1316 Carling Avenue - SWSHEET SET\25029-DC - L1 - Landscape Plan.dwg

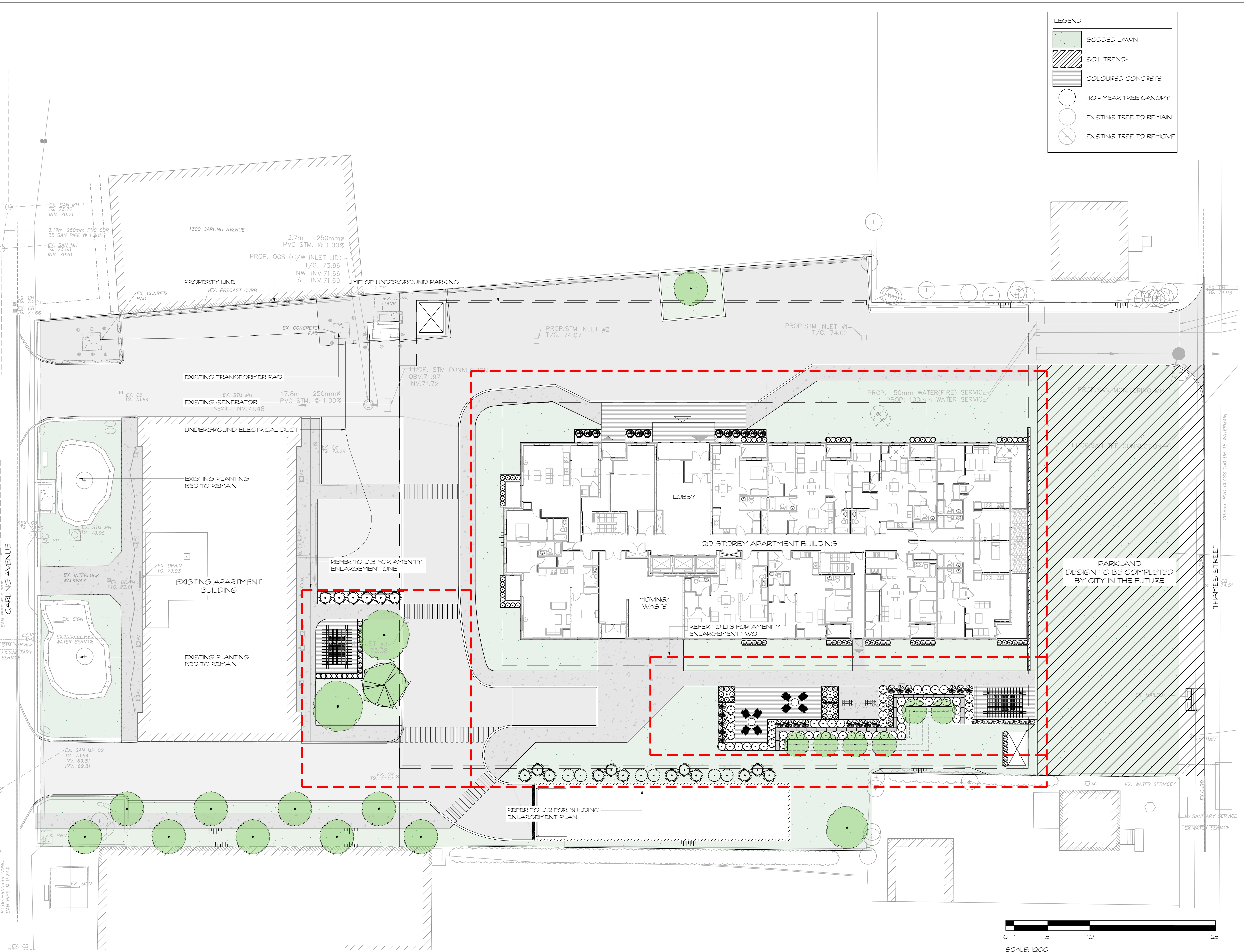

LEGEND

- SODDED LAWN
- SOIL TRENCH
- COLOURED CONCRETE
- 40-YEAR TREE CANOPY
- EXISTING TREE TO REMAIN
- EXISTING TREE TO REMOVE

HOMESTEAD

Seal: North:

No.	Issues and Revisions	Date
1.	ISSUED FOR ZBLA	2026-03-24

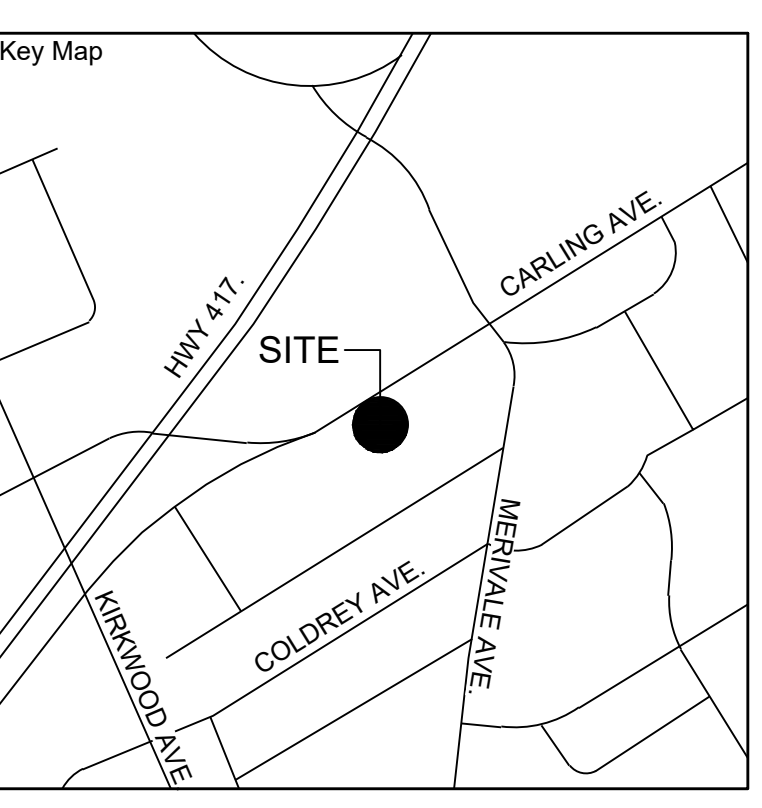

Project Notes

This design and drawing are the property of The Scott Wentworth Landscape Group Ltd. and are not to be copied or used for construction purposes without the Landscape Architect's express written consent.

The contractor shall check and verify all dimensions and report any discrepancies, error, or omissions to the Landscape Architect prior to commencing work.

Base plan information taken from Site Plan provided by:
Company Name: ria architecture
Dated: March 24, 2022

Wentworth Landscapes
13392 Loyalist Parkway R.R.1, Picton ON K0K 2T0
613.547.3772

Consultants



Client HOMESTEAD LAND HOLDINGS	
Project 1316 CARLING AVENUE	
Project Location 1316 CARLING AVENUE OTTAWA, ON	
Drawing Title OVERALL PLAN	
Scale 1:200	
Date 2025-10-07	Plot Date 2026-03-24
Designed By MH	Drawn By PL
Approved By SW	Drawing Number
Project Number 25029-DC	L1.0



SYMBOL	QUANTITY	BOTANICAL NAME	COMMON NAME	SIZE	CONDITION	SPACING	NATIVE	BIODIVERSITY SUPPORTS	ATTRACTS
TREE PLANT MATERIAL SCHEDULE									
Deciduous Trees									
Acr	6	Amelanchier canadensis 'Rainbow Pillar'	Rainbow Pillar Serviceberry	180cm	WB Clump	3m O.C.	Native	124	Yes
CbF	8	Carpinus betulus 'Frans Fontaine'	Frans Fontaine Hornbeam	80mm cal.	WB	As Shown	Ornamental	78	
GtS	1	Gleditsia tricanthos var. inermis 'Street Keeper'	Street Keeper Honey Locust	80mm cal.	WB	As Shown	Native		
Ov	3	Ostrya virginiana	Ironwood	50mm cal.	WB	As Shown	Native	90	Yes

Biodiversity Value represents the number of butterfly and moth species the plant hosts. This is essential as caterpillars are the foundation for building the food web and enhancing biodiversity, being the primary food for nesting birds to feed their young. Based upon the research of Dr. Douglas Tallamy, University of Delaware.

SYMBOL	QUANTITY	BOTANICAL NAME	COMMON NAME	SIZE	TREE TYPE/ SINGLE TREE SIZE	MULTIPLE TREE SOIL VOLUME (m³)
Acr	6	Amelanchier canadensis 'Rainbow Pillar'	Rainbow Pillar Serviceberry	180cm	Small	25
CbF	8	Carpinus betulus 'Frans Fontaine'	Frans Fontaine Hornbeam	80mm	Medium	30
GtS	1	Gleditsia tricanthos 'Street Keeper'	Street Keeper Honey Locust	80mm	Medium	30
Ov	3	Ostrya virginiana	Ironwood	80mm	Medium	25

NOTE
 TARGET SOIL VOLUMES BASED ON CITY OF OTTAWA TREE PLANTING GUIDELINES.
 CALCULATIONS ASSUME 1.5m SOIL DEPTH.

LEGEND

- BODDED LAWN
- SOIL TRENCH
- COLOURED CONCRETE
- 40-YEAR TREE CANOPY
- EXISTING TREE TO RETAIN
- EXISTING TREE TO REMOVE

40 YEAR PROPOSED CANOPY CALCULATIONS:
 8667m² TOTAL SITE AREA
 (6) Amelanchier canadensis 'Rainbow Pillar' (12.5m²ea) 75m²
 (10) Carpinus betulus 'Frans Fontaine' (19.6m²ea) 196m²
 (1) Gleditsia tricanthos 'Street Keeper' (50.2m²ea) 50.2m²
 (3) Ostrya virginiana (50.2m²ea) 150.6m²
TOTAL CANOPY COVER: 471.8m² or 5.4%

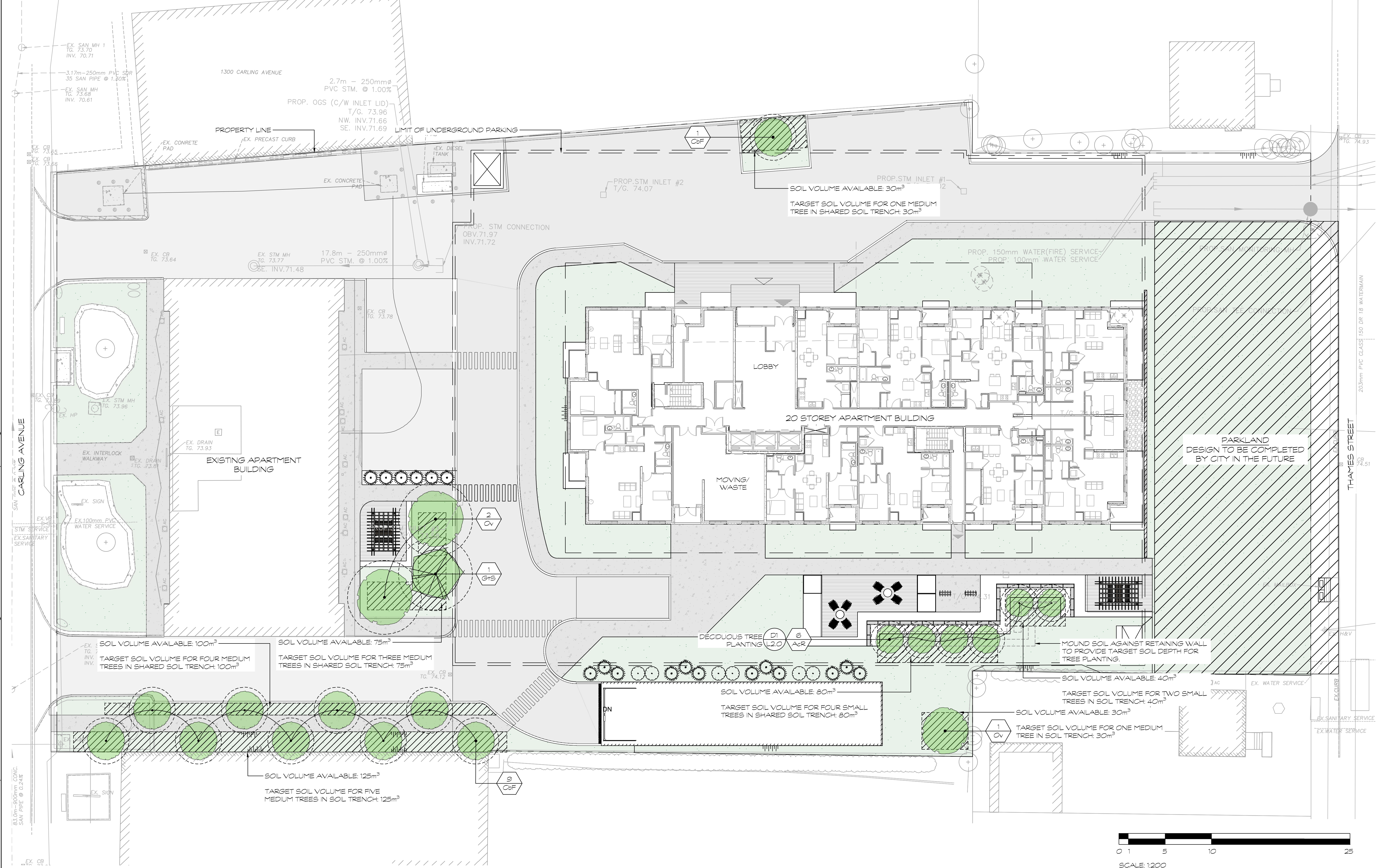

Seal of the Association of Landscape Architects (ALA) Ontario, with a signature and the text 'Landscape Architect' and 'L.L.1'.

No.	Issues and Revisions	Date
1.	ISSUED FOR ZBLA	2026-03-24

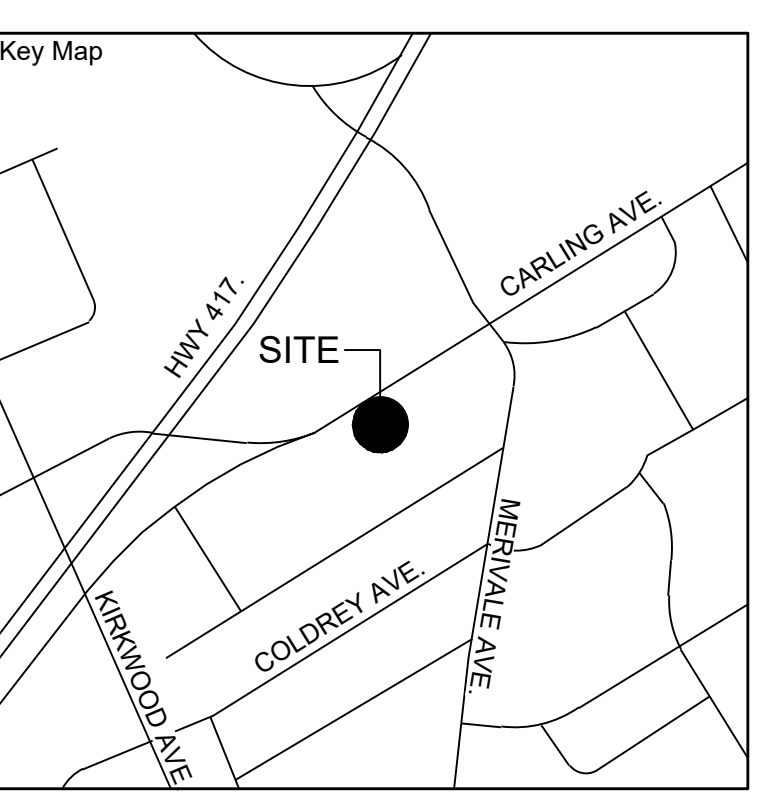

Project Notes
 This design and drawing are the property of The Scott Wentworth Landscape Group Ltd. and are not to be copied or used for construction purposes without the Landscape Architect's express written consent.
 The contractor shall check and verify all dimensions and report any discrepancies, error, or omissions to the Landscape Architect prior to commencing work.
 Base plan information taken from Site Plan provided by: Company Name: ria architecture
 Dated: March 24, 2022

Wentworth Landscapes
 13392 Loyalist Parkway R.R.1, Picton ON K0K 2T0
 613.547.3772

Consultants



Client HOMESTEAD LAND HOLDINGS	
Project 1316 CARLING AVENUE	
Project Location 1316 CARLING AVENUE OTTAWA, ON	
Drawing Title TREE PLANTING PLAN	
Scale 1:150	
Date 2025-10-07	Plot Date 2026-03-24
Designed By MH	Drawn By PL
Approved By SW	Drawing Number
Project Number 25029-DC	L1.1

PLANT MATERIAL SCHEDULE										
SYMBOL	QUANTITY	BOTANICAL NAME	COMMON NAME	SIZE	CONDITION	SPACING	NATIVE	BIODIVERSITY FACTOR	SUPPORTS POLLINATORS	ATTRACTS BIRDS
Coniferous Trees										
T2	12	<i>Thuja occidentalis</i> 'American Pillar'	Full Speed a Hedge Cedar	250cm/3gal	Potted	As Shown	Native	46		Yes
J2S	6	<i>Juniperus chinensis</i> Fairview	Fairview Juniper	175cm HT.	Potted	As Shown	Ornamental			
Shrubs										
I2G	12	<i>Ilex glabra</i> Gem Box	Gem Box Inkberry Holly	80cm/3gal	Potted	80-100cm O.C.	Native	145		Yes
Perennials										
EpP	142	<i>Echinacea purpurea</i> Pawwow	Pawwow White Coneflower	1gal	Potted	40cm O.C.	Native		Yes	Yes
Ornamental Grasses										
C2K	39	<i>Calamagrostis acutiflora</i> 'Karl Foerster'	Karl Foerster Feather Reed Grass	2gal	Potted	80cm O.C.	Ornamental	5		
P2V	33	<i>Panicum virgatum</i>	Switch Grass	2gal	Potted	100cm O.C.	Native	25		Yes

* Biodiversity Value represents the number of butterfly and moth species the plant hosts. This is essential as caterpillars are the foundation for building the food web and enhancing biodiversity, being the primary food for nesting birds to feed their young. Based upon the research of Dr. Douglas Tallamy, University of Delaware.

LEGEND

- SODDED LAWN
- SOIL TRENCH
- COLOURED CONCRETE
- 40-YEAR TREE CANOPY
- EXISTING TREE TO RETAIN
- EXISTING TREE TO REMOVE

HOMESTEAD

Seal of the Association of Landscape Architects (ALA) and a North arrow pointing towards the top right of the page.

No.	Issues and Revisions	Date
1.	ISSUED FOR ZBLA	2026-03-24

Key Map

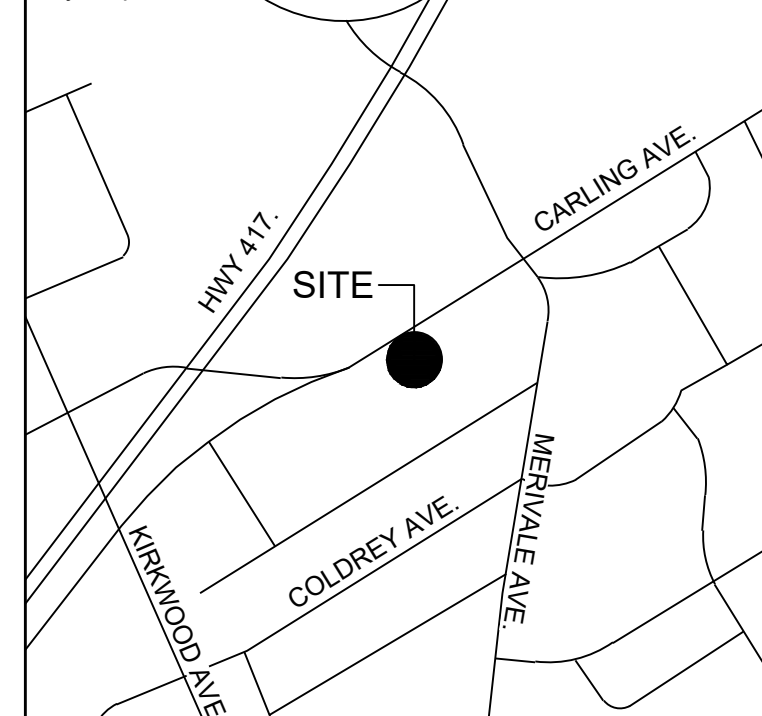

Project Notes

This design and drawing are the property of The Scott Wentworth Landscape Group Ltd. and are not to be copied or used for construction purposes without the Landscape Architect's express written consent.

The contractor shall check and verify all dimensions and report any discrepancies, error, or omissions to the Landscape Architect prior to commencing work.

Base plan information taken from Site Plan provided by:
Company Name: ria architecture
Dated: March 24, 2022

Wentworth Landscapes
13392 Loyalist Parkway R.R.1, Picton ON K0K 2T0
613.547.3772

Consultants



Client:
HOMESTEAD LAND HOLDINGS

Project:
1316 CARLING AVENUE

Project Location:
1316 CARLING AVENUE
OTTAWA, ON

Drawing Title:
BUILDING ENLARGEMENT

Scale:
1:150

Date:
2025-10-07

Plot Date:
2026-03-24

Designed By:
MH

Drawn By:
PL

Approved By:
SW

Drawing Number

Project Number:
25029-DC

L1.2



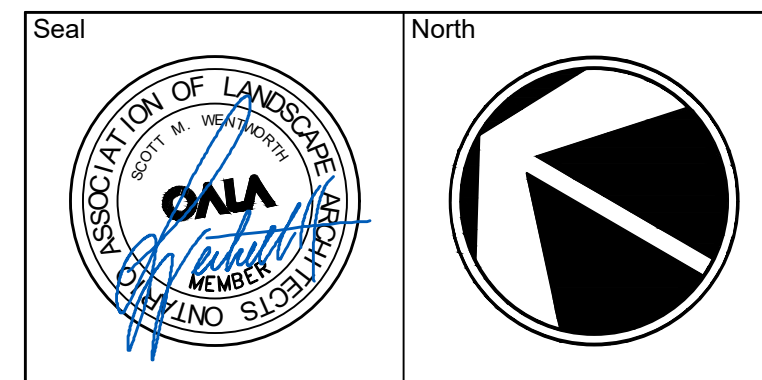

No.	Issues and Revisions	Date
1.	ISSUED FOR ZBLA	2026-03-24

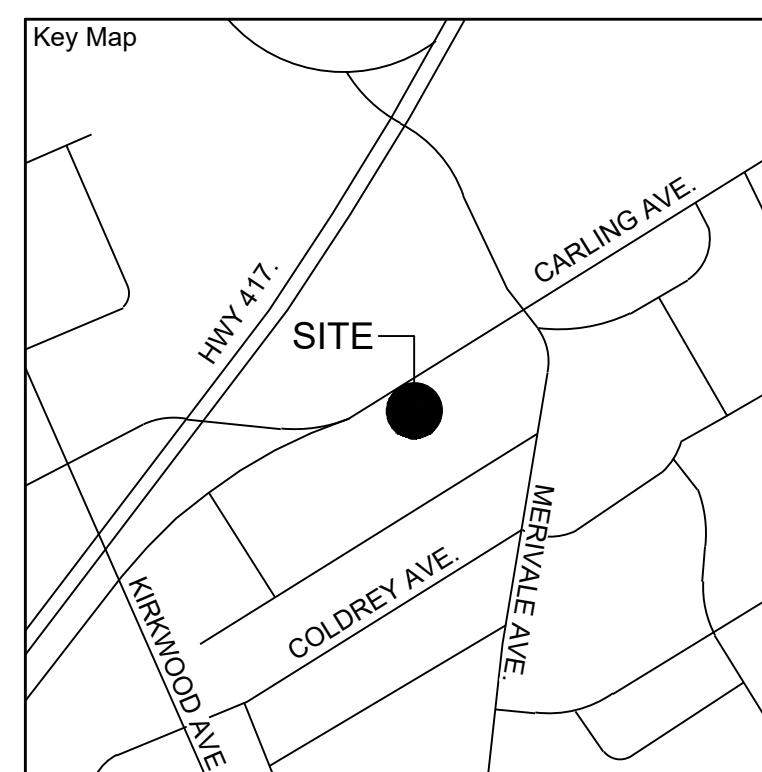

Project Notes
 This design and drawing are the property of The Scott Wentworth Landscape Group Ltd. and are not to be copied or used for construction purposes without the Landscape Architect's express written consent.
 The contractor shall check and verify all dimensions and report any discrepancies, error, or omissions to the Landscape Architect prior to commencing work.
 Base plan information taken from Site Plan provided by: Company Name: ria architecture
 Dated: March 24, 2022

Wentworth Landscapes
 13392 Loyalist Parkway R.R.1, Picton ON K0K 2T0
 613.547.3772

Consultants



Client:
 HOMESTEAD LAND HOLDINGS

Project:
 1316 CARLING AVENUE

Project Location:
 1316 CARLING AVENUE
 OTTAWA, ON

Drawing Title:
 PLANTING AND PAVING DETAILS

Scale	
AS NOTED	
Date	Plot Date
2025-10-07	2026-03-24
Designed By	Drawn By
MH	PL
Approved By	Drawing Number
SW	
Project Number	
25029-DC	L2.0

PLANT MATERIAL QUALITY STANDARDS
 ALL PLANT MATERIAL TO CONFORM TO THE LEVELS OF STANDARDS ESTABLISHED BY THE CANADIAN STANDARDS FOR NURSERY STOCK, EIGHTH EDITION, PUBLISHED BY THE CANADIAN NURSERY LANDSCAPE ASSOCIATION.

WATERING
 ENSURE TREES ARE THOROUGHLY WATERED AT TIME OF PLANTING. CONTINUE WATERING AS REQUIRED TO PROVIDE ADEQUATE MOISTURE FOR THE DURATION OF THE SPECIFIED MAINTENANCE DURING ESTABLISHMENT PERIOD.

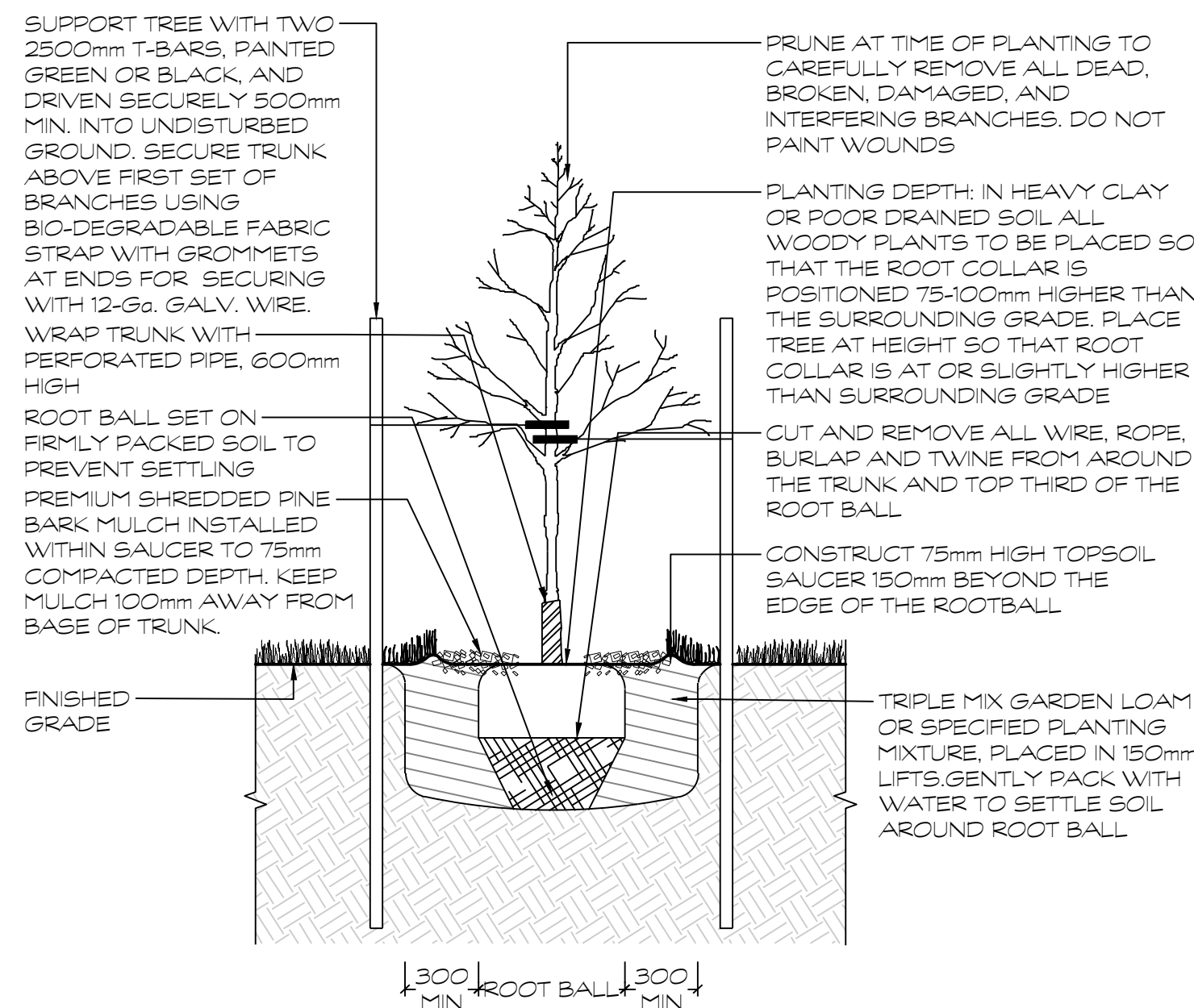
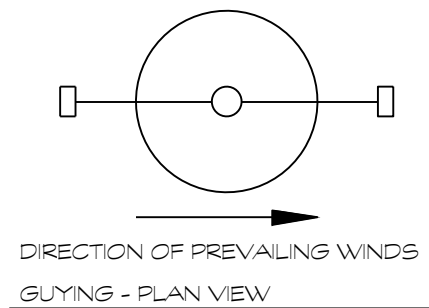

D1 DECIDUOUS TREE PLANTING
 1:25

NOTES
 -SHRUBS AS DETAILED REPRESENTS BOTH CONIFEROUS AND DECIDUOUS SPECIES
 -PLACE MULCH TO EVEN HORIZONTAL GRADE
 -SHRUBS PLANTED IN GROUPS SHALL BE SET IN CONTINUOUS PLANTING BEDS, REFER TO LANDSCAPE LAYOUT PLANS
 -SHRUB BEDS TO BE BACKFILLED WITH TRIPLE MIX GARDEN LOAM PLANTING MIXTURE, OR AS SPECIFIED
 TO A COMPACTED DEPTH OF 450mm
 -FIRMLY COMPACTED BACKFILLED PLANTING MIXTURE TO ELIMINATE AIR POCKETS AND PREVENT SETTLEMENT

PLANT MATERIAL QUALITY STANDARDS
 ALL PLANT MATERIAL TO CONFORM TO THE LEVELS OF STANDARDS ESTABLISHED BY THE CANADIAN STANDARDS FOR NURSERY STOCK, NINTH EDITION, PUBLISHED BY THE CANADIAN NURSERY LANDSCAPE ASSOCIATION.

WATERING
 ENSURE SHRUBS ARE THOROUGHLY WATERED AT TIME OF PLANTING. CONTINUE WATERING AS REQUIRED TO PROVIDE ADEQUATE MOISTURE FOR THE DURATION OF THE SPECIFIED MAINTENANCE DURING ESTABLISHMENT PERIOD.

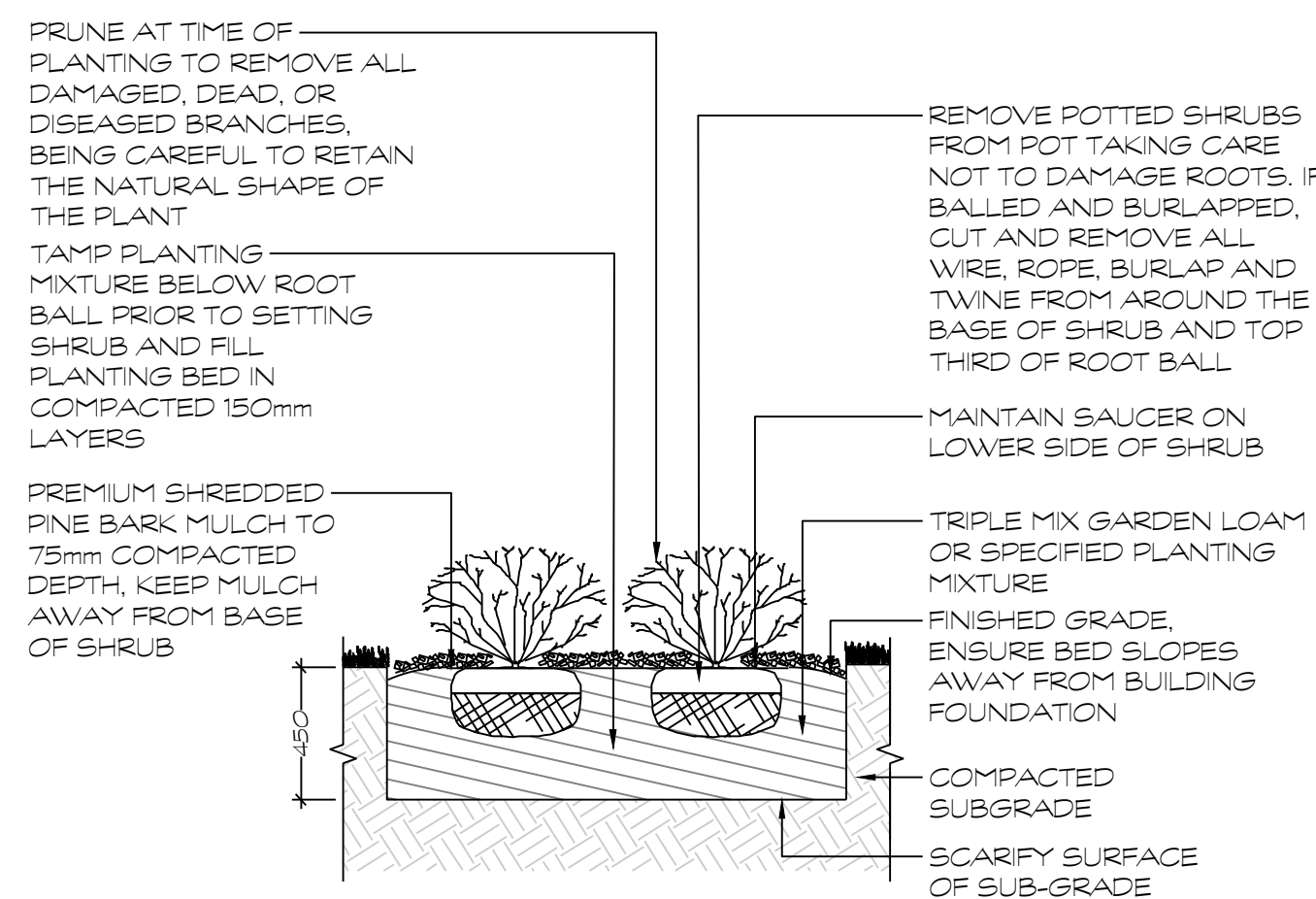

D2 SHRUB PLANTING
 1:25

NOTES
 -PLACE MULCH TO EVEN HORIZONTAL GRADE.
 -FIRMLY COMPACTED BACKFILLED TRIPLE MIX GARDEN LOAM OR SPECIFIED PLANTING MIXTURE TO ELIMINATE AIR POCKETS AND PREVENT SETTLEMENT.

PLANT MATERIAL QUALITY STANDARDS
 ALL PLANT MATERIAL TO CONFORM TO THE LEVELS OF STANDARDS ESTABLISHED BY THE CANADIAN STANDARDS FOR NURSERY STOCK, EIGHTH EDITION, PUBLISHED BY THE CANADIAN NURSERY LANDSCAPE ASSOCIATION.

WATERING
 ENSURE HERBACEOUS PLANTS ARE THOROUGHLY WATERED AT TIME OF PLANTING. CONTINUE WATERING AS REQUIRED TO PROVIDE ADEQUATE MOISTURE FOR THE DURATION OF THE SPECIFIED MAINTENANCE DURING ESTABLISHMENT PERIOD.

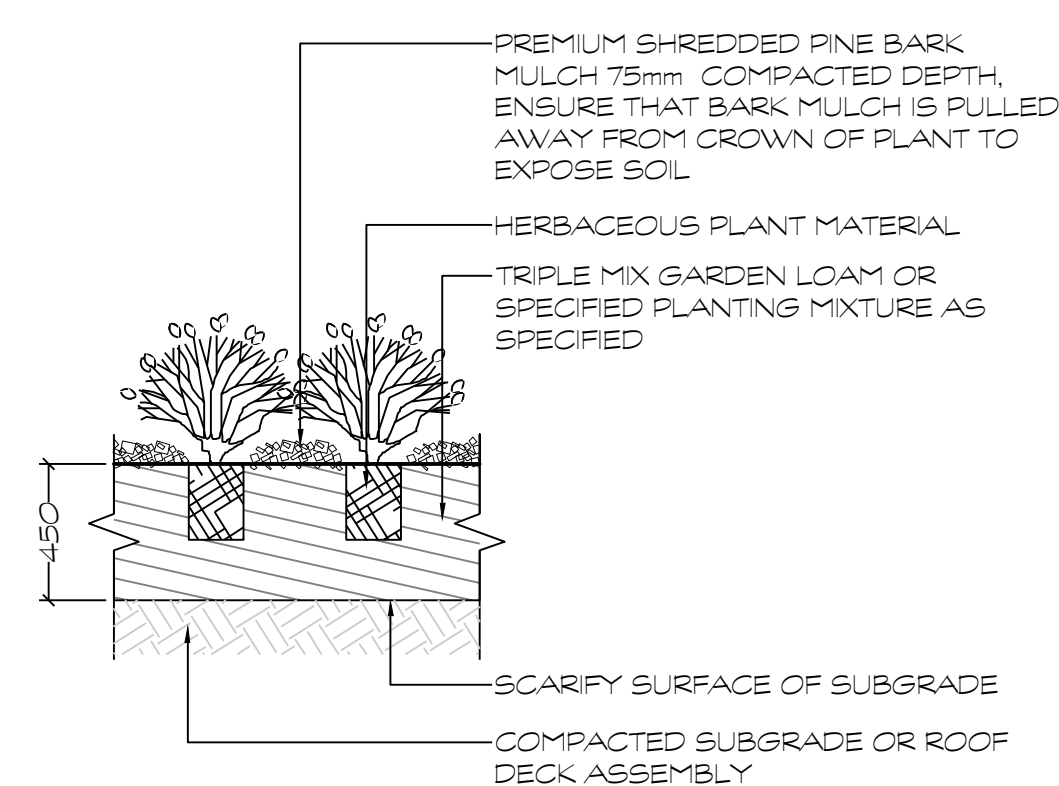

D3 HERBACEOUS PLANTING
 1:25

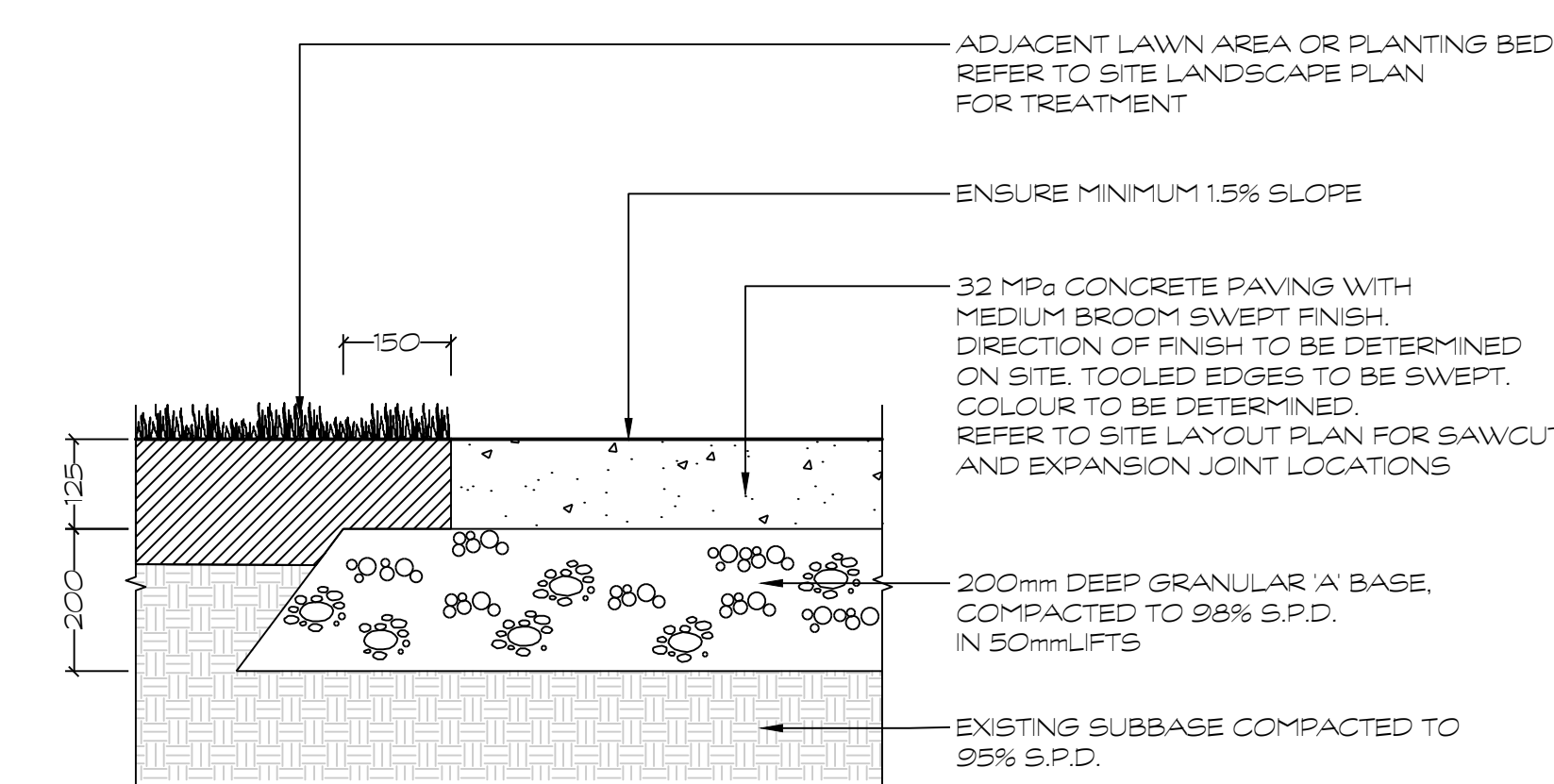

D4 COLOURED CONCRETE PAVING
 1:10

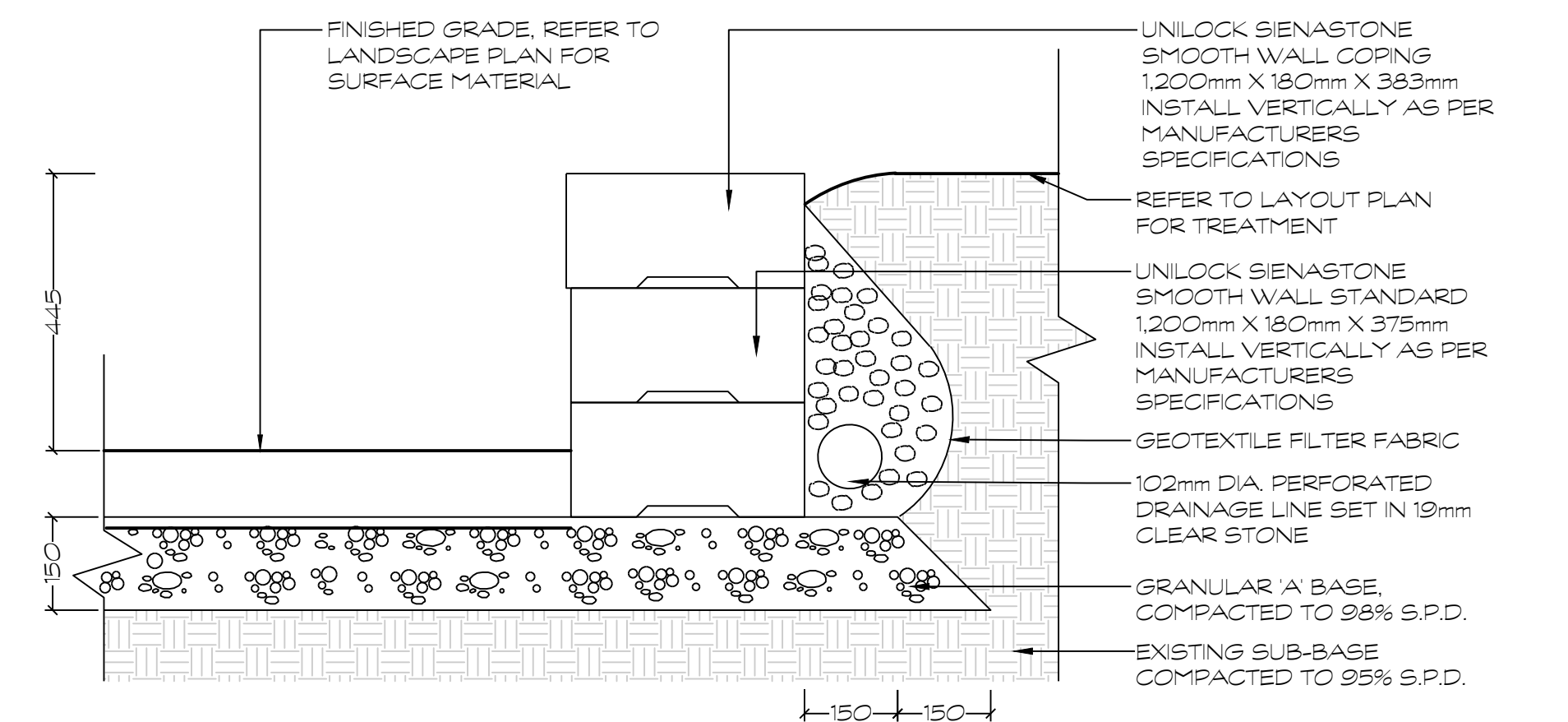

D5 SIENNASTONE SMOOTH PRECAST CONCRETE PLANTER WALL
 1:10

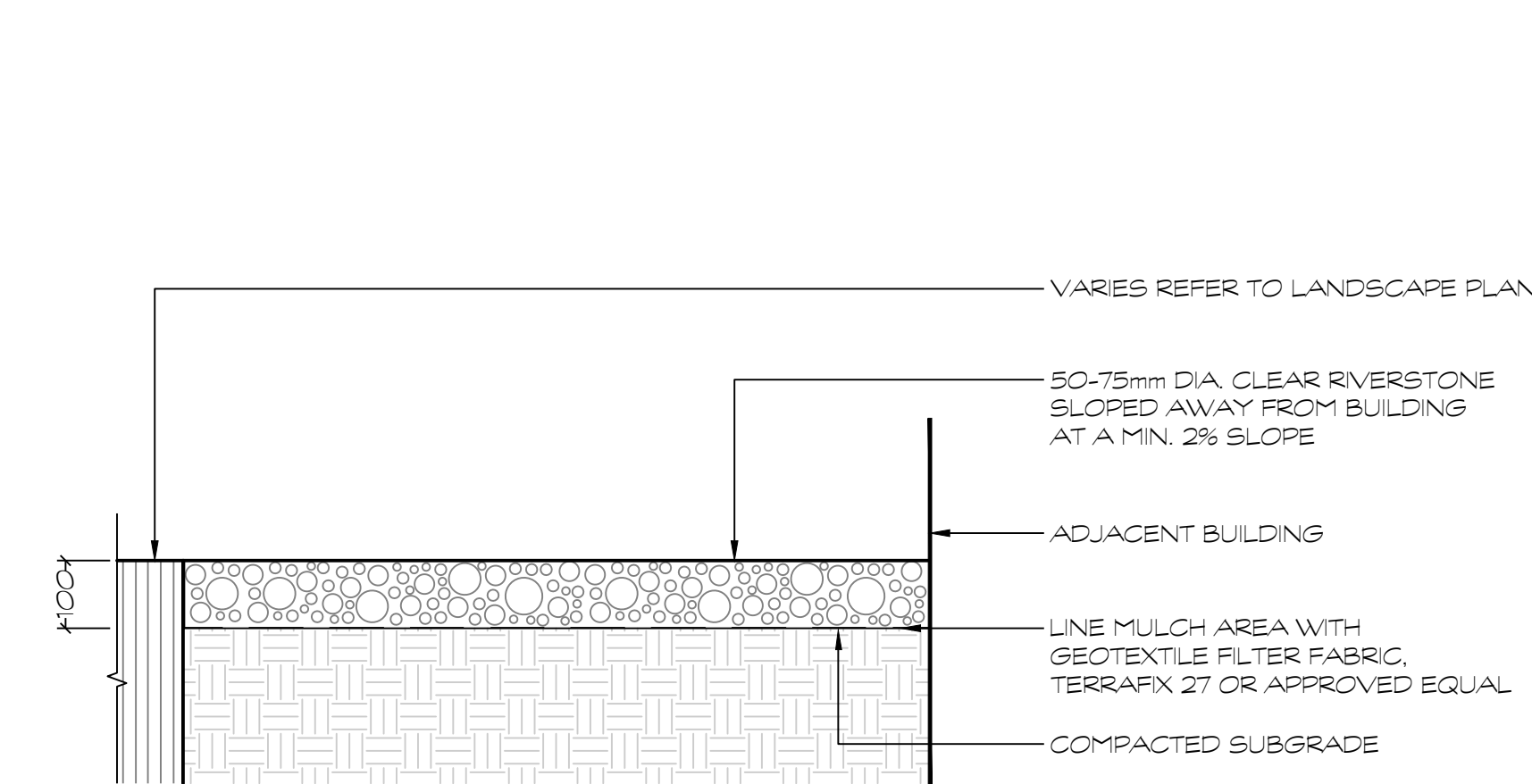

D6 RIVERSTONE MULCH
 1:10

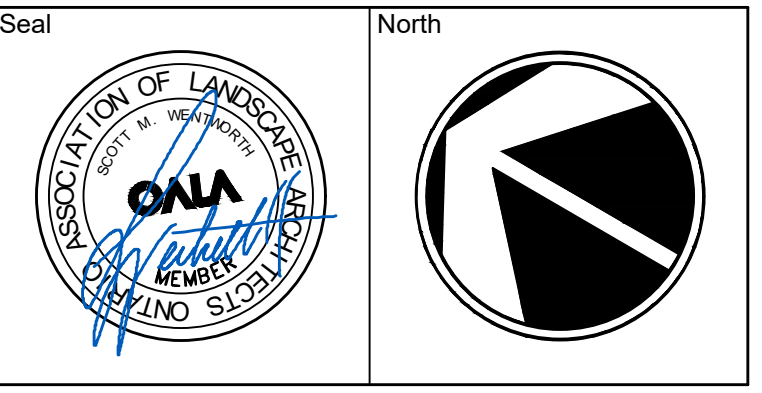

No.	Issues and Revisions	Date
1.	ISSUED FOR ZBLA	2026-03-24

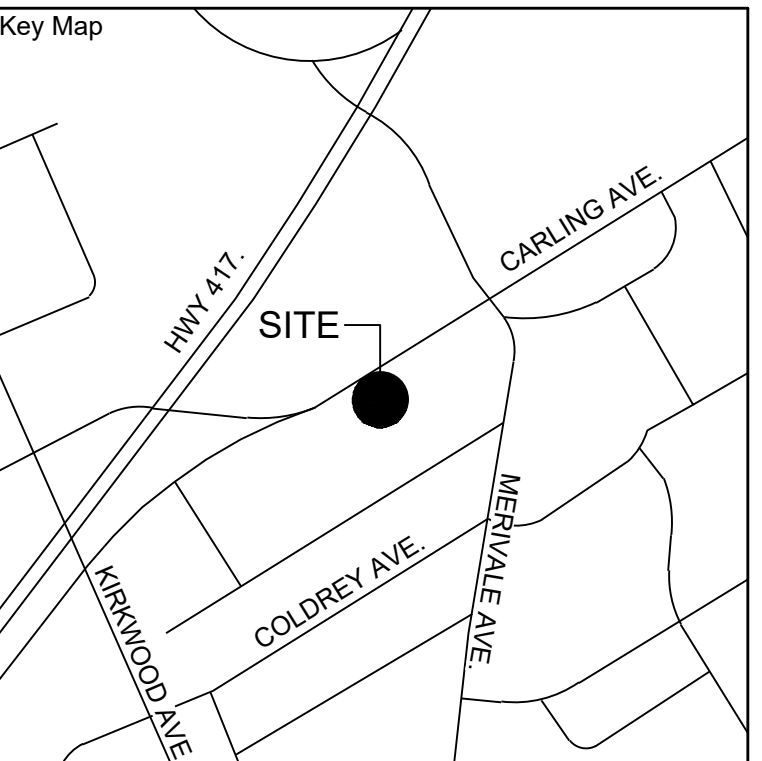

Project Notes
 This design and drawing are the property of The Scott Wentworth Landscape Group Ltd. and are not to be copied or used for construction purposes without the Landscape Architect's express written consent.
 The contractor shall check and verify all dimensions and report any discrepancies, error, or omissions to the Landscape Architect prior to commencing work.
 Base plan information taken from Site Plan provided by:
 Company Name: ria architecture
 Dated: March 24, 2022

Wentworth Landscapes
 13392 Loyalist Parkway R.R.1, Picton ON K0K 2T0
 613.547.3772

Consultants



Client:
 HOMESTEAD LAND HOLDINGS

Project:
 1316 CARLING AVENUE

Project Location:
 1316 CARLING AVENUE
 OTTAWA, ON

Drawing Title:
 PERGOLA DETAILS

Scale AS NOTED	
Date 2025-10-07	Plot Date 2026-03-24
Designed By MH	Drawn By PL
Approved By SW	Drawing Number
Project Number 25029-DC	

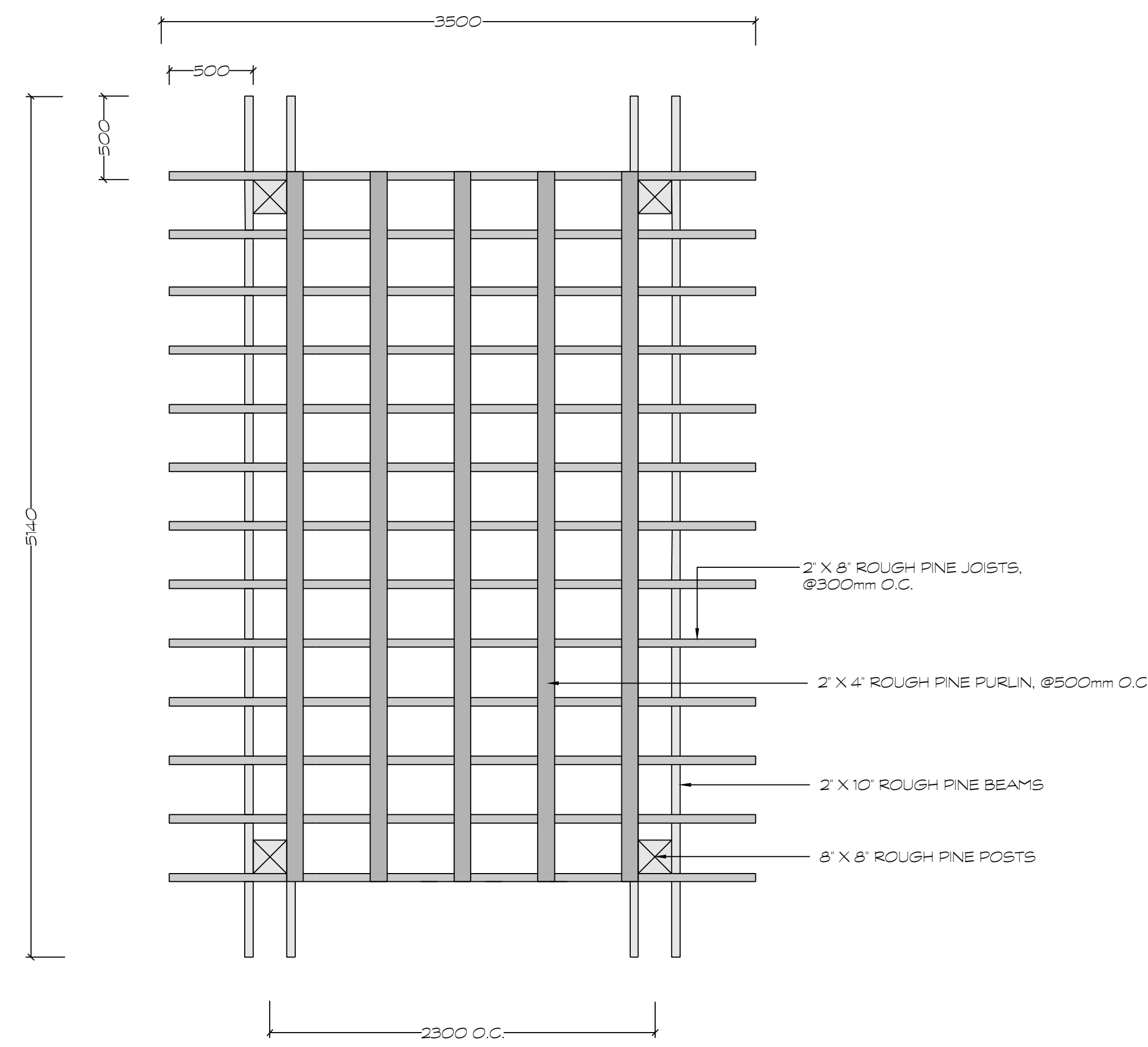

D1 WOODEN PERGOLA - PLAN VIEW
 1:25

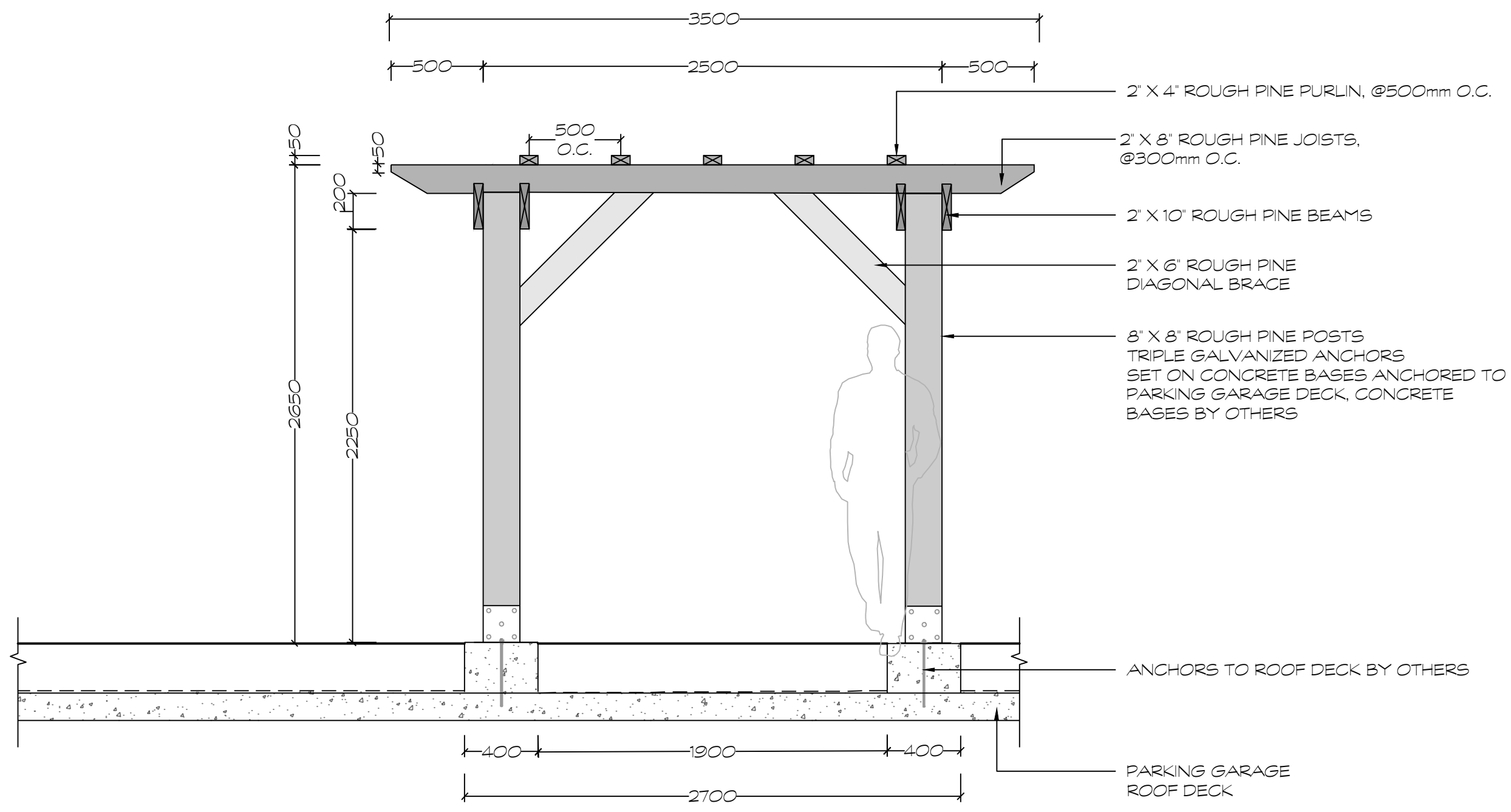

D2 WOODEN PERGOLA - FRONT ELEVATION
 1:25

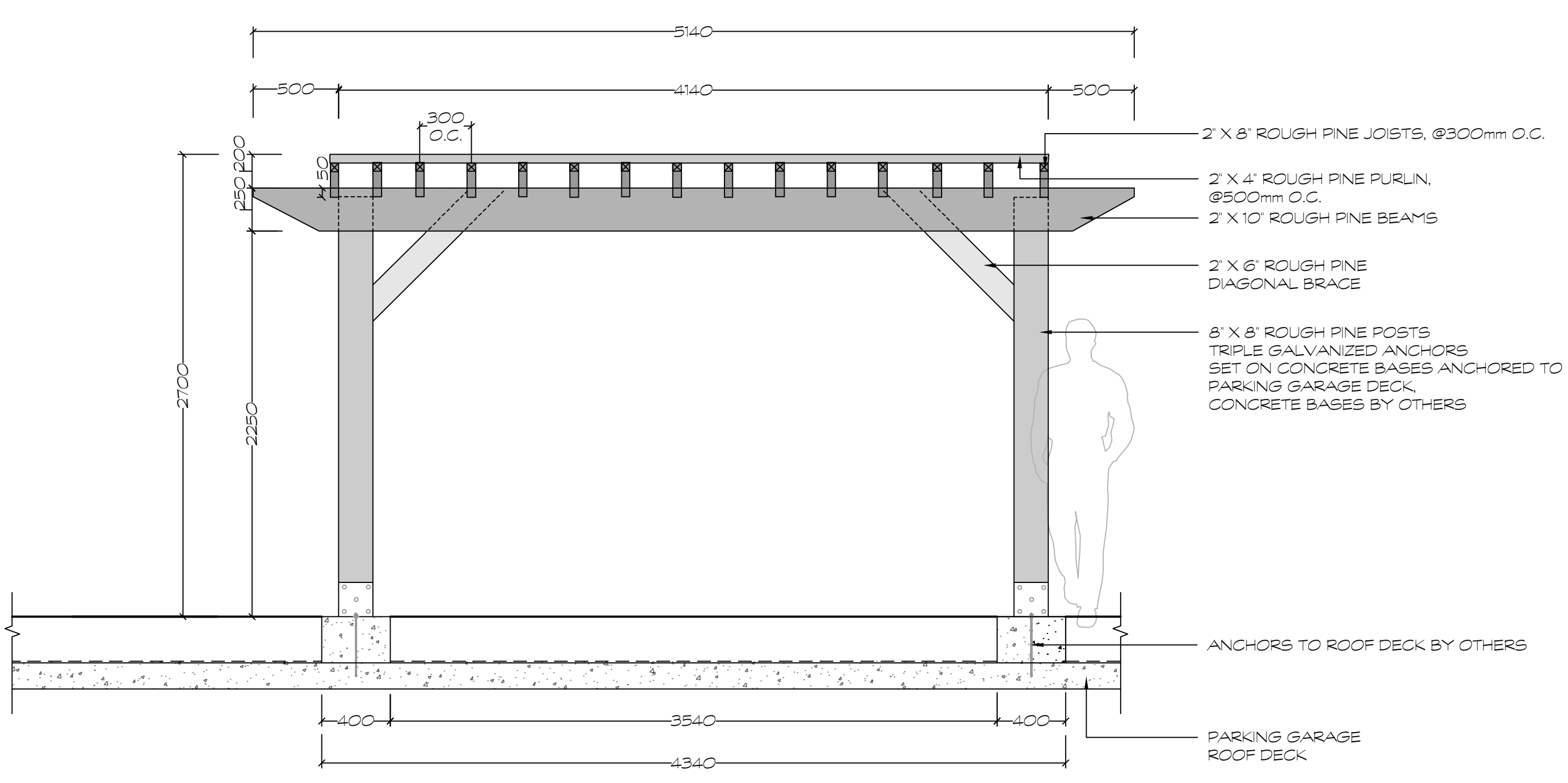

D3 WOODEN PERGOLA - SIDE ELEVATION
 1:25

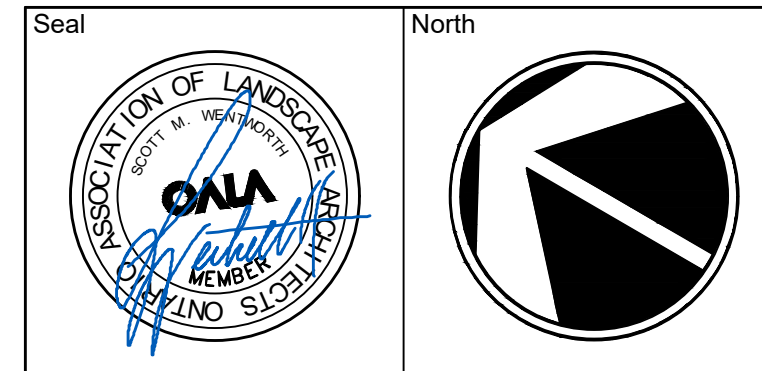

No.	Issues and Revisions	Date
1.	ISSUED FOR ZBLA	2026-03-24

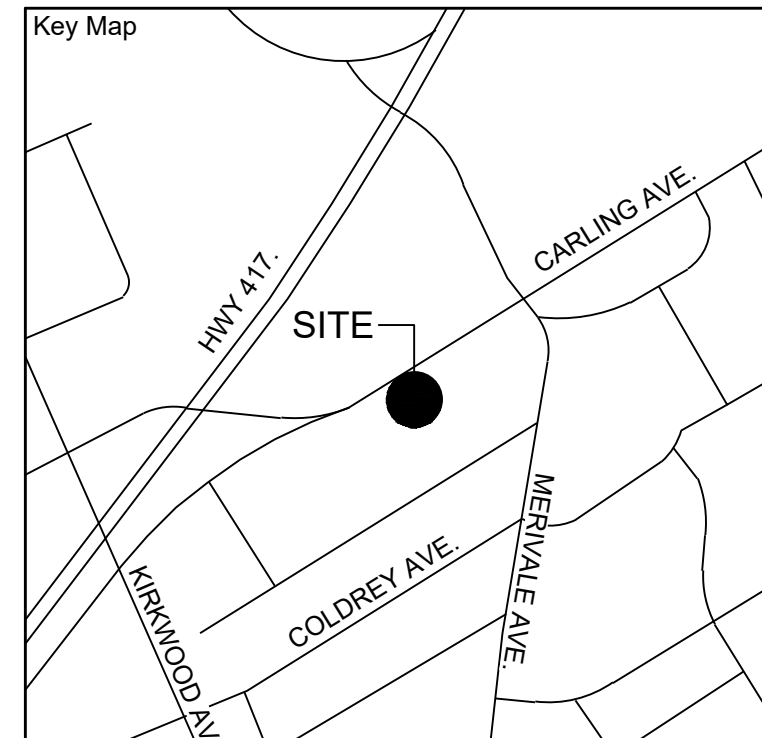

Project Notes

This design and drawing are the property of The Scott Wentworth Landscape Group Ltd. and are not to be copied or used for construction purposes without the Landscape Architect's express written consent.

The contractor shall check and verify all dimensions and report any discrepancies, error, or omissions to the Landscape Architect prior to commencing work.

Base plan information taken from Site Plan provided by:
Company Name: ria architecture
Dated: March 24, 2022

Wentworth Landscapes
13392 Loyalist Parkway R.R.1, Picton ON K0K 2T0
613.547.3772

Consultants



Client: HOMESTEAD LAND HOLDINGS	
Project: 1316 CARLING AVENUE	
Project Location: 1316 CARLING AVENUE OTTAWA, ON	
Drawing Title: SITE FURNISHING DETAILS	
Scale: AS NOTED	
Date: 2025-10-07	Plot Date: 2026-03-24
Designed By: MH	Drawn By: PL
Approved By: SW	Drawing Number:
Project Number: 25029-DC	L2.2

MAGLIN FURNITURE SYSTEMS INC.
TOLL FREE: 1-800-716-5506
WWW.MAGLIN.COM
MODEL: MBE-2300-00025
QTY: (4)

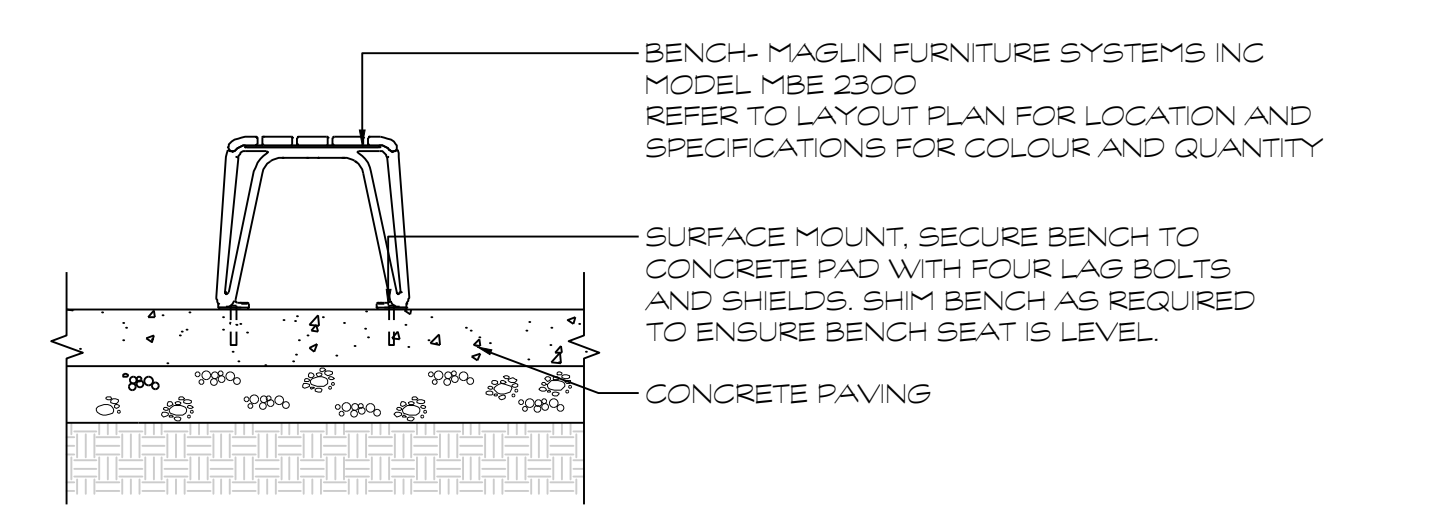
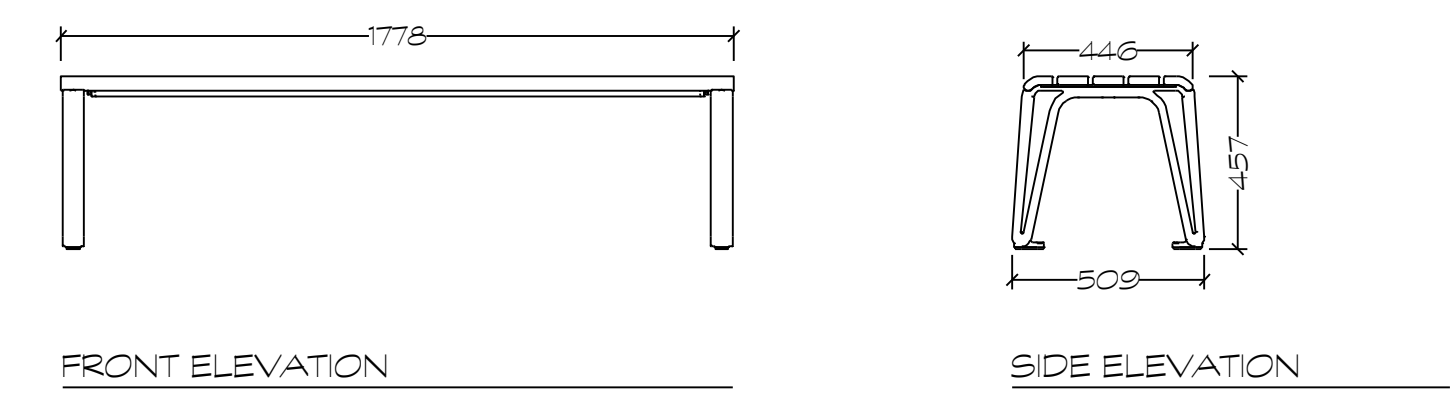

D1 **ICONIC BACKLESS BENCH**
1:20

MAGLIN FURNITURE SYSTEMS INC.
TOLL FREE: 1-800-716-5506
WWW.MAGLIN.COM
MODEL: MTB-2300-00003
QTY: (2)

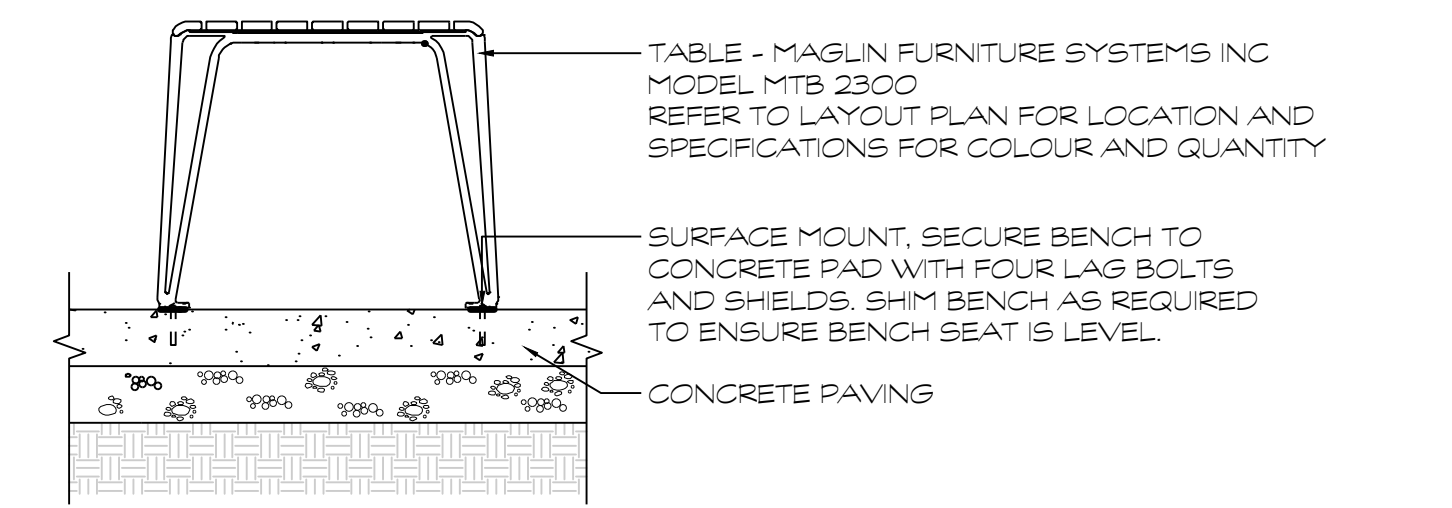
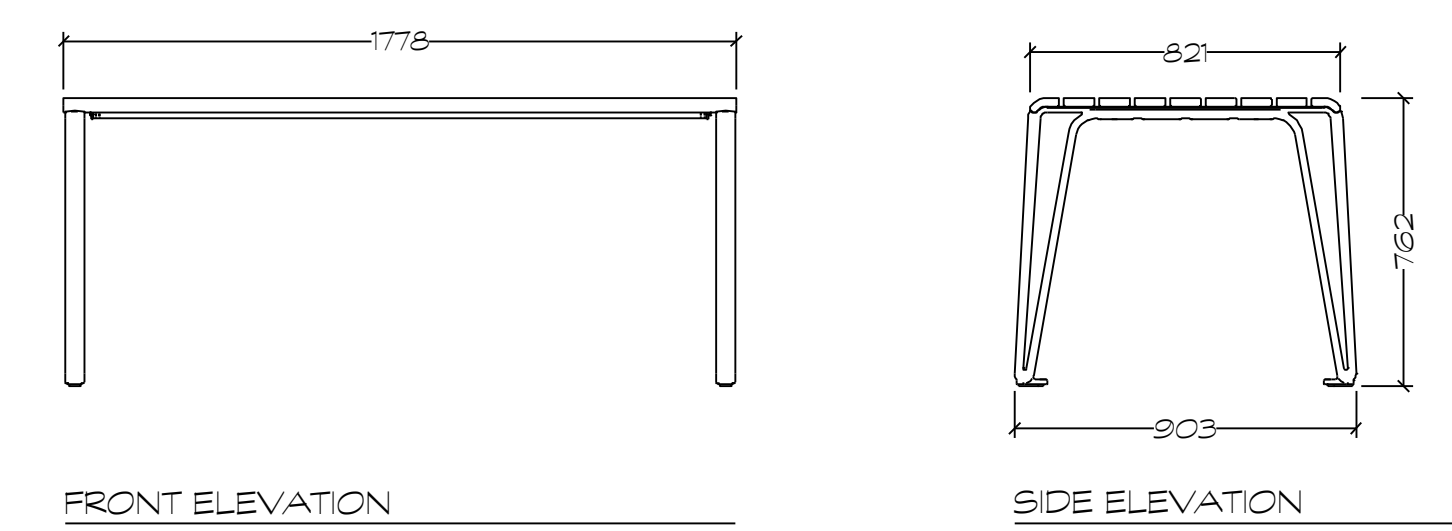

D2 **ICONIC TABLE**
1:20

MAGLIN FURNITURE SYSTEMS INC.
TOLL FREE: 1-800-716-5506
WWW.MAGLIN.COM
MODEL: MBR-350-5
QTY: (2)

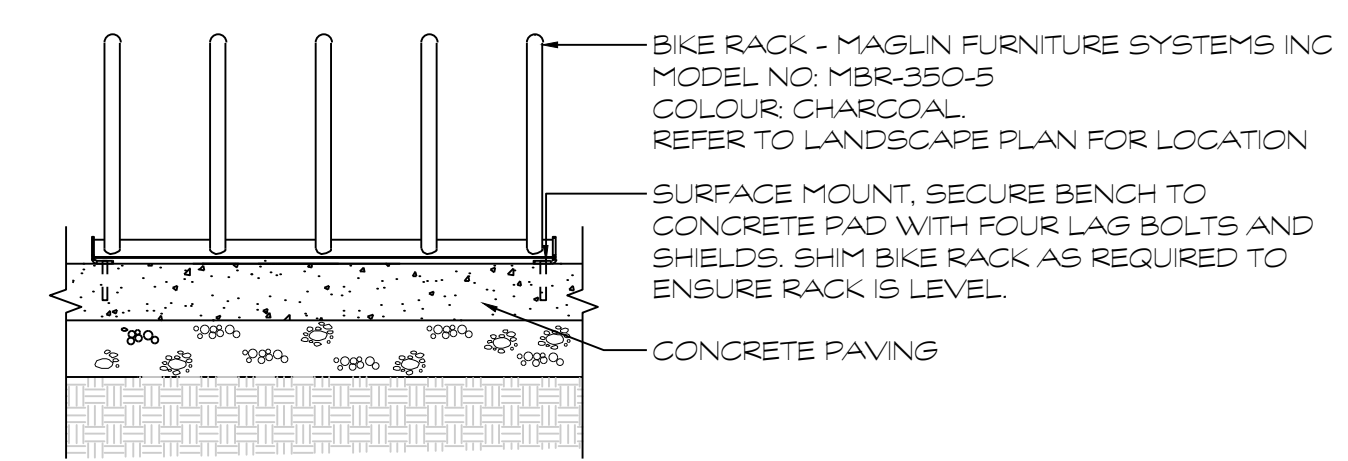
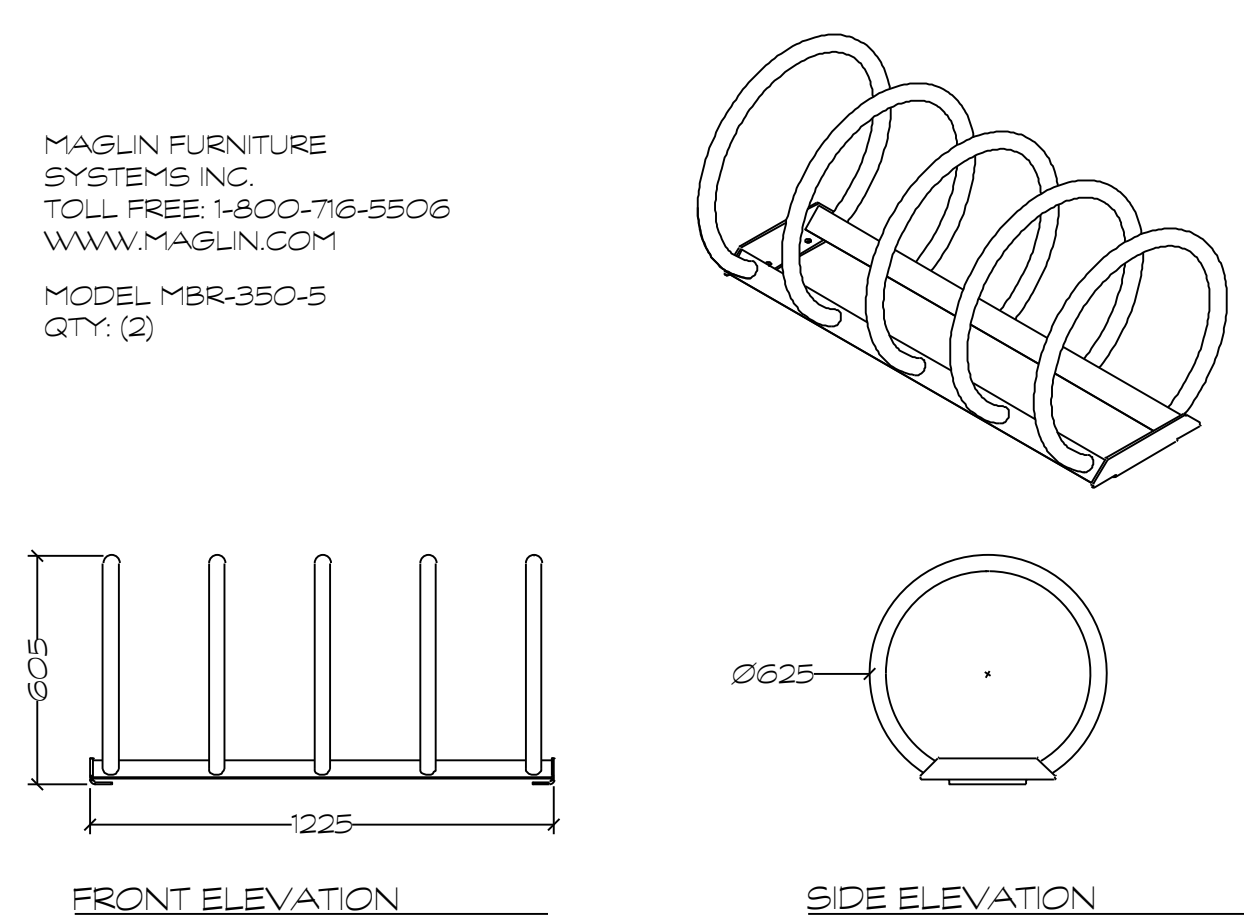

D3 **BIKE RACK**
1:20

MAGLIN FURNITURE SYSTEMS INC.
TOLL FREE: 1-800-716-5506
WWW.MAGLIN.COM
MODEL: MCH-0720-00001
QTY: (8)

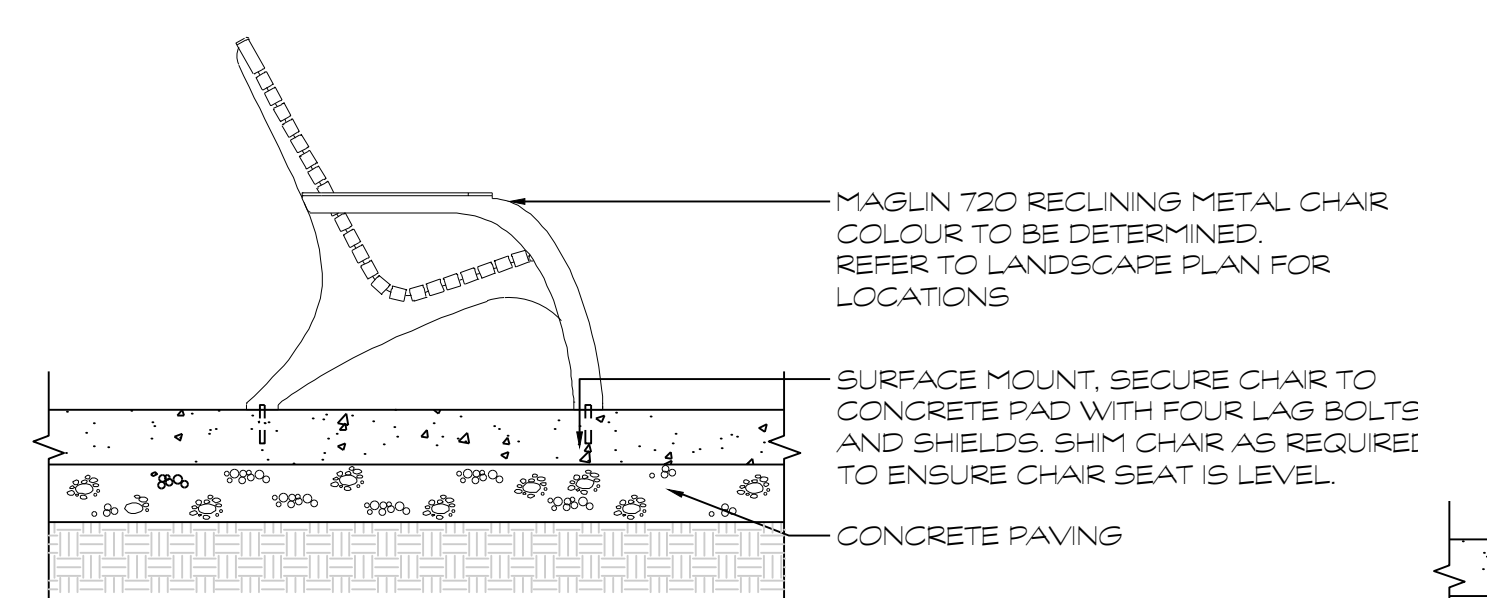
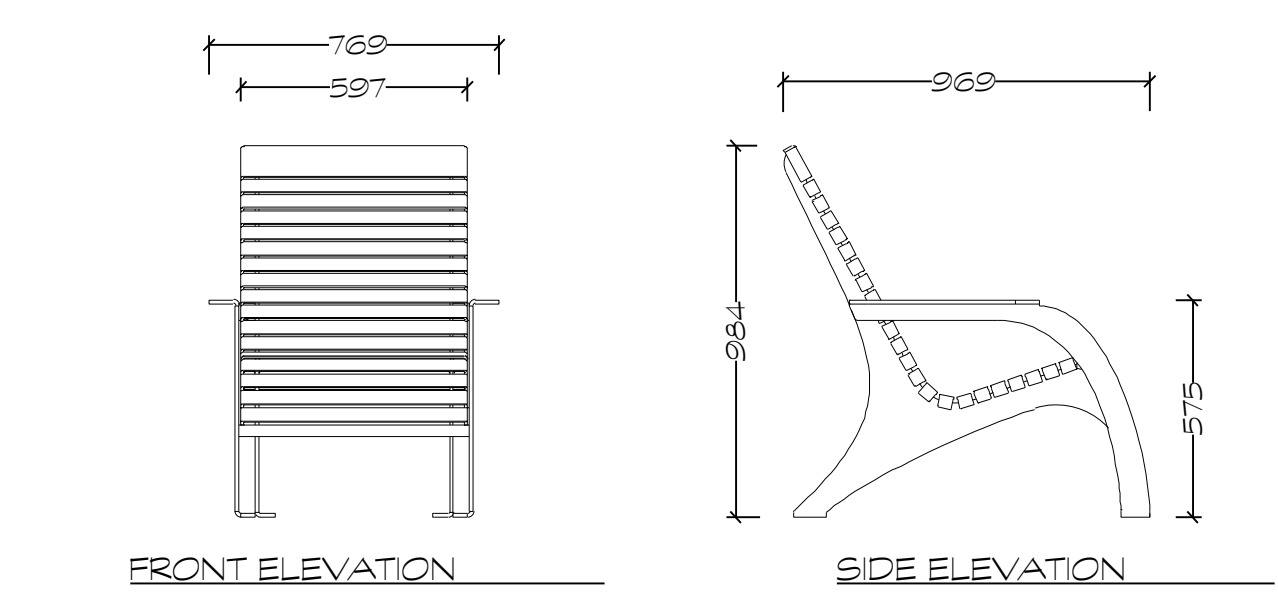

D4 **MAGLIN 720 CHAIR**
1:20

MAGLIN FURNITURE SYSTEMS INC.
TOLL FREE: 1-800-716-5506
WWW.MAGLIN.COM
MODEL: MTB-1900-00005
QTY: (2)

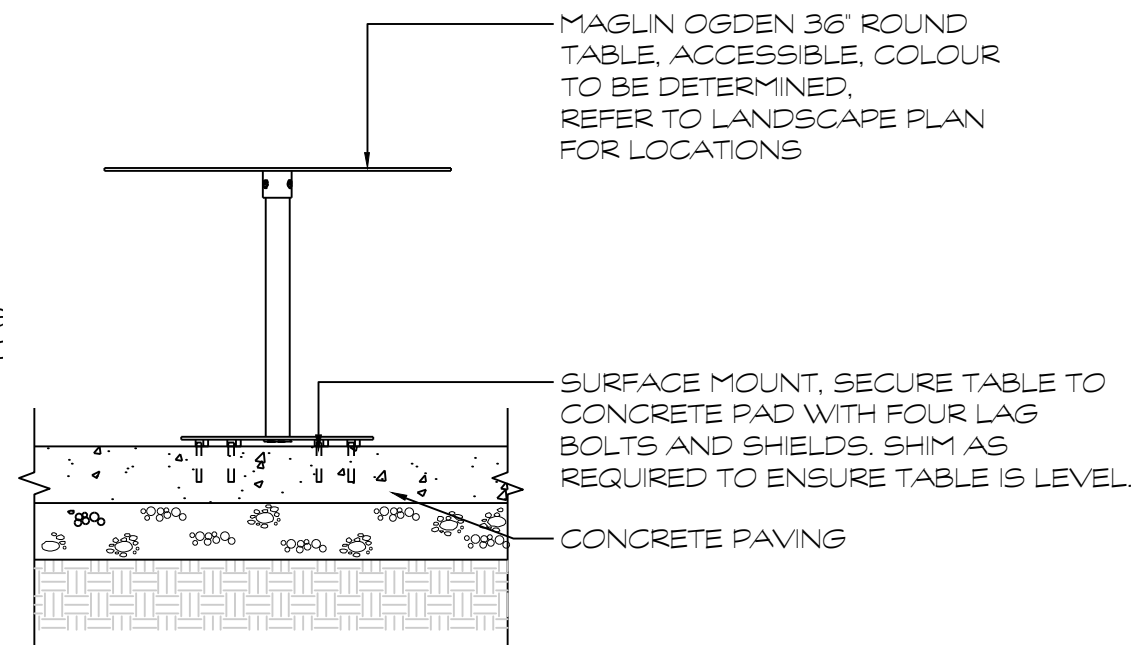
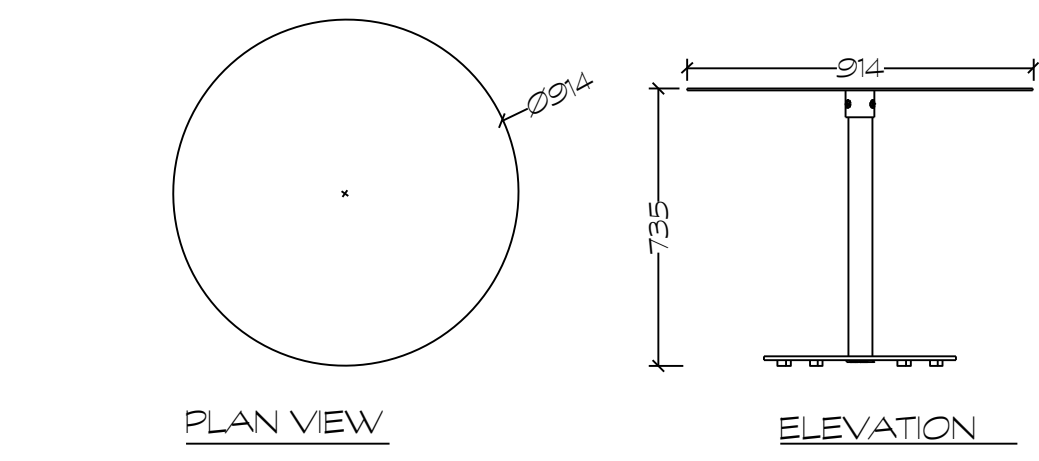

D5 **MAGLIN OGDEN TABLE**
1:20

HAUSER
SITE FURNITURE
HAUSER INDUSTRIES INC.
TOLL FREE: 1-800-268-7328
WWW.HAUSERSITE.COM

SKU: PS-210-24-HD-79X79-39
QTY: (3)

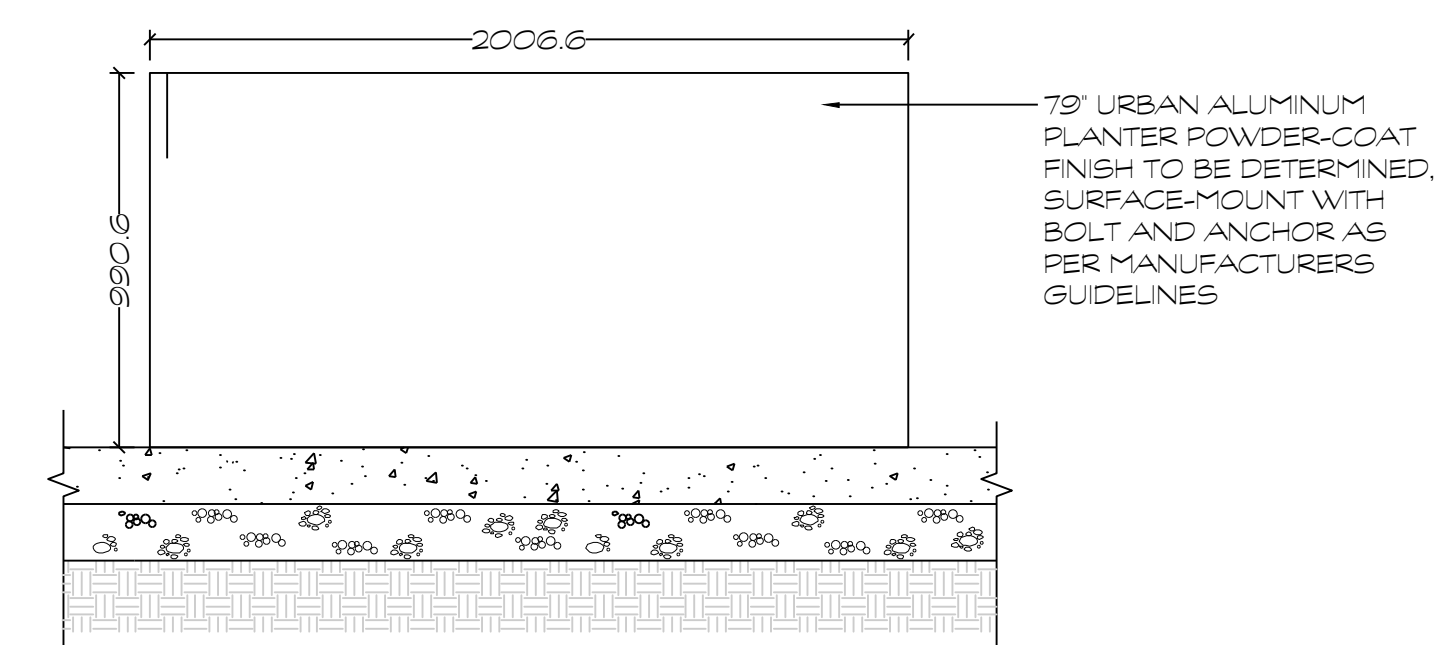

D6 **HAUSER HEAVY DUTY PLANTER**
1:20

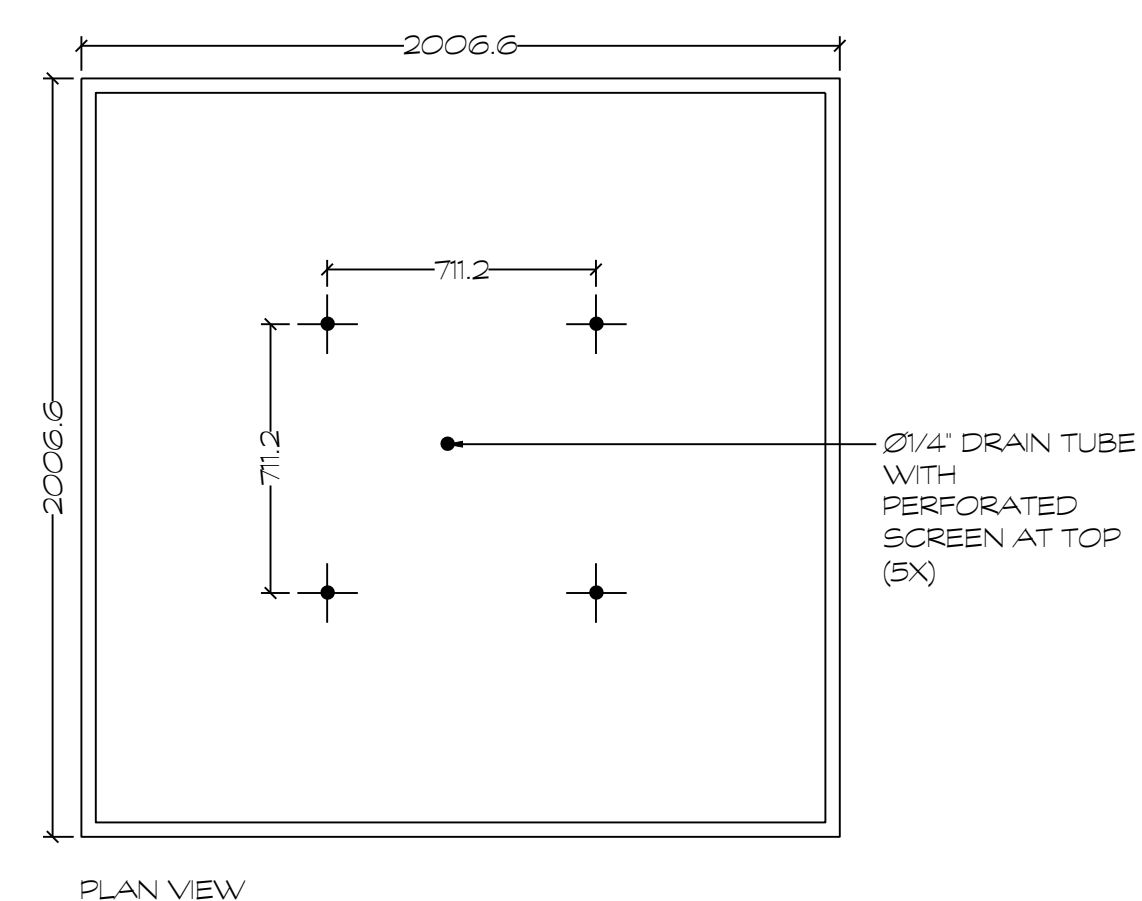

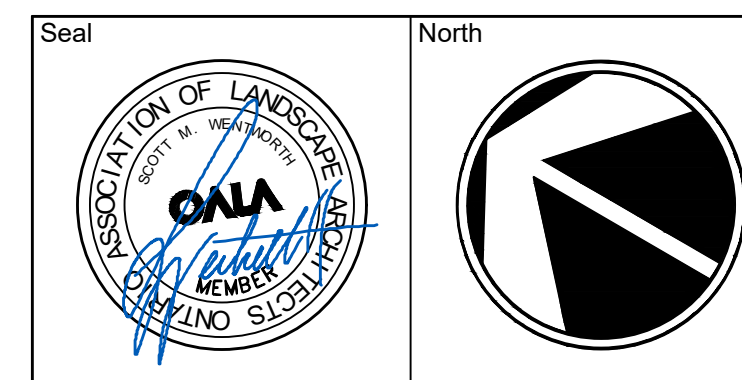

No.	Issues and Revisions	Date
1.	ISSUED FOR ZBLA	2026-03-24

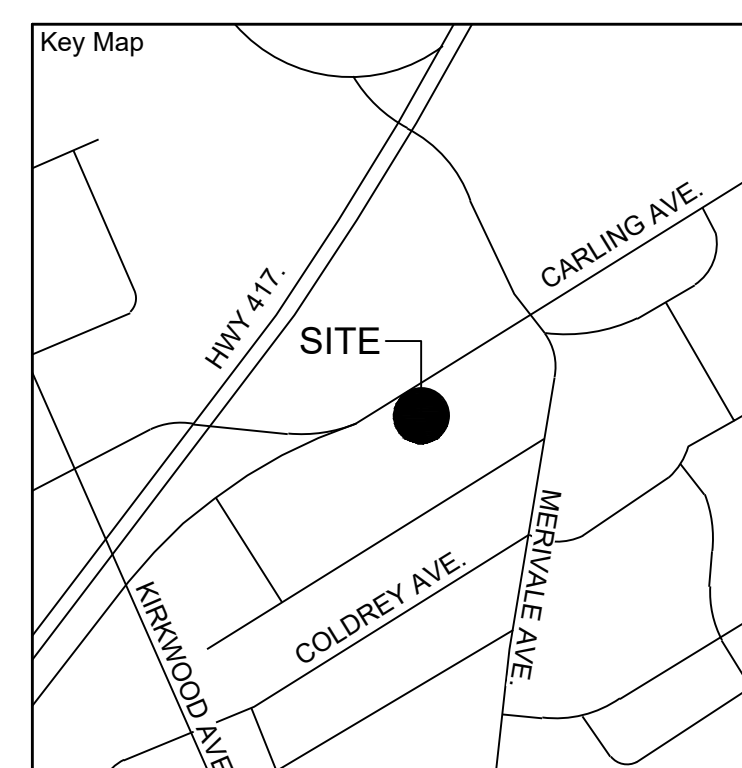

Project Notes
 This design and drawing are the property of The Scott Wentworth Landscape Group Ltd. and are not to be copied or used for construction purposes without the Landscape Architect's express written consent.
 The contractor shall check and verify all dimensions and report any discrepancies, error, or omissions to the Landscape Architect prior to commencing work.
 Base plan information taken from Site Plan provided by:
 Company Name: ria architecture
 Dated: March 24, 2022

Wentworth Landscapes
 13392 Loyalist Parkway R.R.1, Picton ON K0K 2T0
 613.547.3772

Consultants



Client: HOMESTEAD LAND HOLDINGS	
Project: 1316 CARLING AVENUE	
Project Location: 1316 CARLING AVENUE OTTAWA, ON	
Drawing Title: AMENITY AREA CROSS SECTIONS	
Scale: AS NOTED	
Date: 2025-10-07	Plot Date: 2026-03-24
Designed By: MH	Drawn By: PL
Approved By: SW	Drawing Number:
Project Number: 25029-DC	L2.3

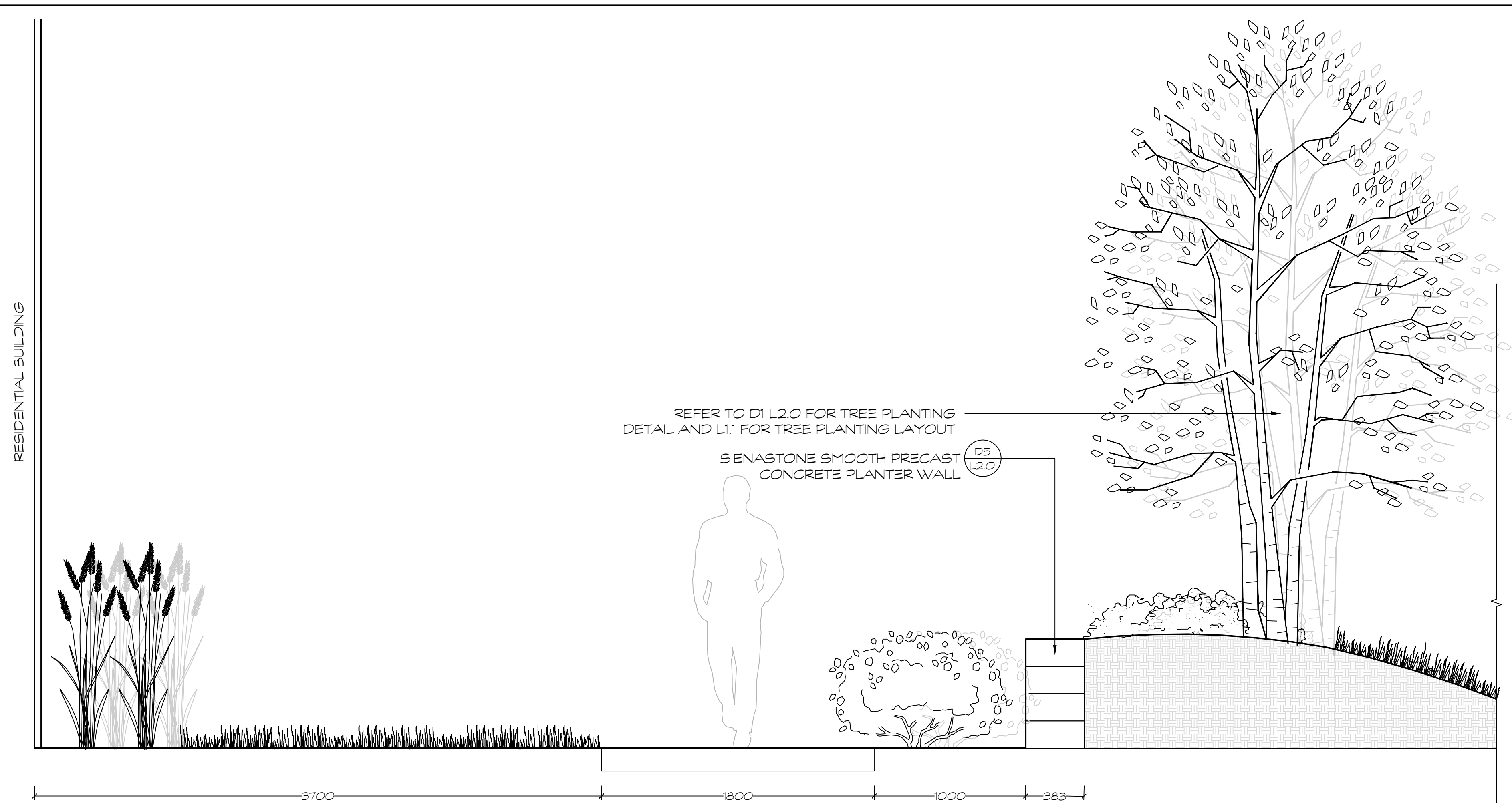

D1 PATHWAY AND BERM PLANTING SECTION A-A'
 1:20

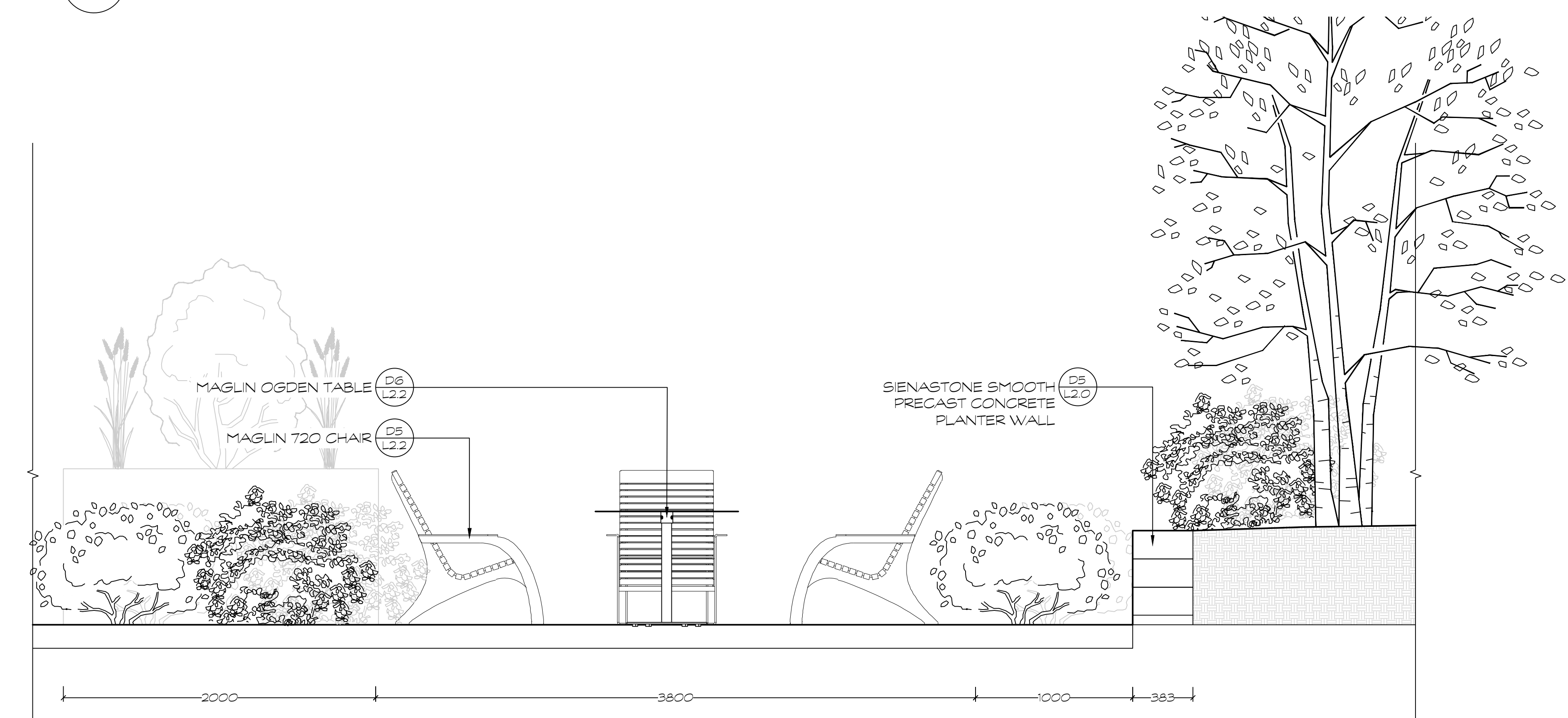

D2 PERGOLA SEATING AREA SECTION B-B'
 1:20