

M:\2025\125109\CAD\PLANNING\CONCEPT PLANS\125109-CP.DWG 2/24/2026 10:19 AM - WSL/OSS

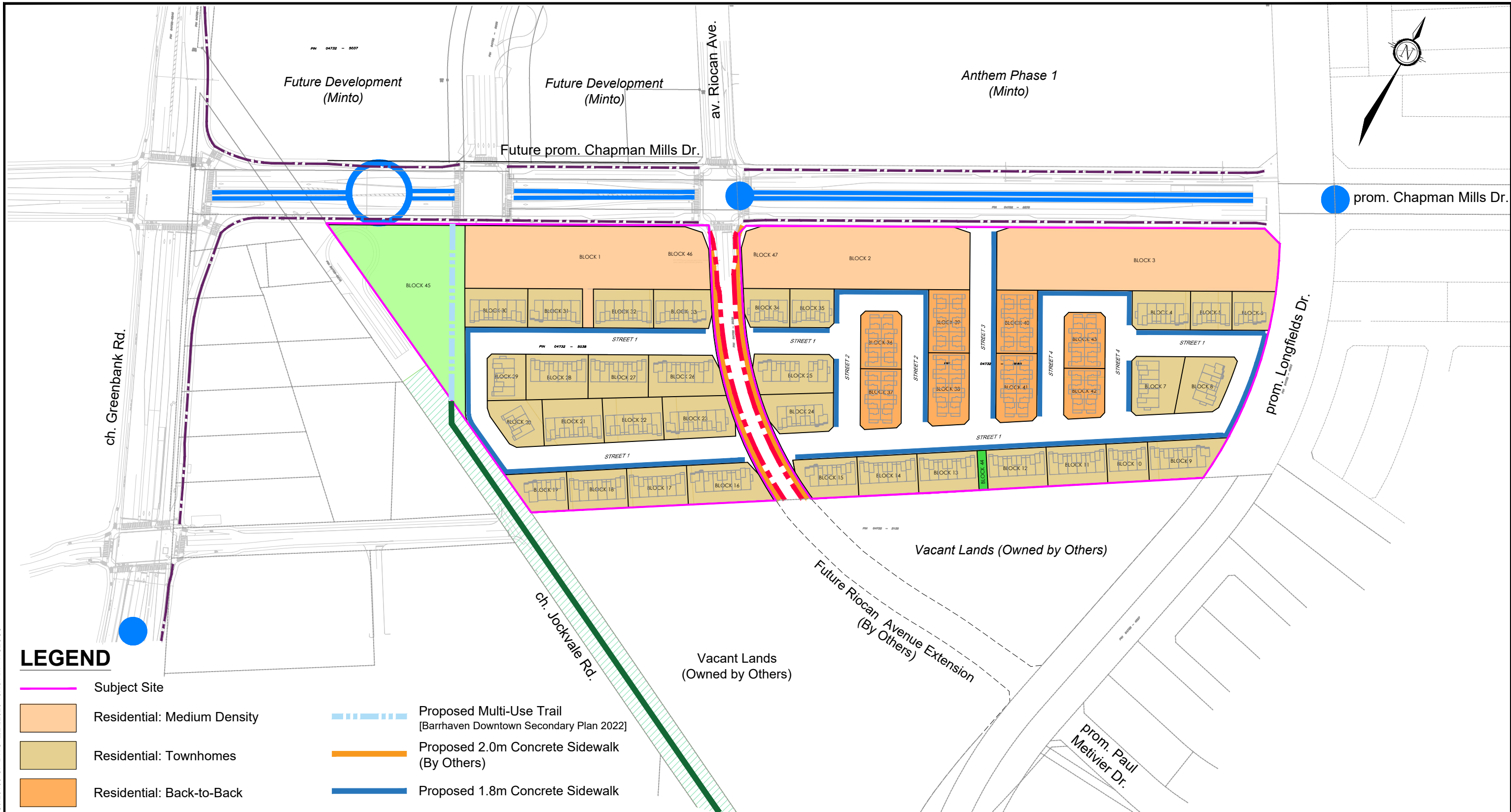

### LEGEND

- Subject Site
- Residential: Medium Density
- Residential: Townhomes
- Residential: Back-to-Back
- Park Block
- Future City Greenspace
- Pathway Block
- Cycling Facility (By Others)  
[Barrhaven Downtown Secondary Plan 2022]
- Proposed Multi-Use Trail (By Others)  
[Barrhaven Downtown Secondary Plan 2022]
- Proposed Multi-Use Trail  
[Barrhaven Downtown Secondary Plan 2022]
- Proposed 2.0m Concrete Sidewalk  
(By Others)
- Proposed 1.8m Concrete Sidewalk
- Proposed 1.5m Cycle Track (By Others)
- Transitway Station (Official Plan 2022)
- Transfer Station (Official Plan 2022)
- Transitway - At-Grade (Official Plan 2022)



**minto**  
Communities

Minto Communities Inc  
180 Kent Street,  
Ottawa, ON  
K1P 0B6



Engineers, Planners & Landscape Architects  
Suite 200, 240 Michael Cowpland Drive  
Ottawa, Ontario, Canada K2M 1P6

Telephone (613) 254-9643  
Facsimile (613) 254-5867  
Website www.novatech-eng.com

**BARRHAVEN TOWN CENTRE  
(STAGE 2)**

**CONCEPT PLAN**

SCALE 1 : 2500

DATE FEB 2026 JOB 125109 FIGURE CP