

**GJA Inc.**  
GNO@GJALA.COM (613) 286 5130

**CONSULTANTS SURVEY**  
ADV LIMITED  
500-14 Concourse Gate K2E 756  
613 727 0850  
adv@adv.com

**ARCHITECT**  
RLA Architecture  
61 Beach Street Ottawa K1S 3J8  
613 724 9832  
info@rla.ca  
rlaarchitecture.ca

**CIVIL**  
STANTEC  
300-1211 Oryx Avenue K2C 3Q4  
613 722 4420  
stntec.com  
stntec.com/en/canada-locations/ottawa-office/ottawa-office

**SITE LOCATION**  
[Map showing site location in Ottawa]

**SURVEY INFORMATION FROM**  
SURVEYOR'S REAL PROPERTY REPORT  
PART 1 Plan of  
PART 2 LOTS 1, 2, 3 and 4, LOT 5 and  
PART OF LANE CLOSED BY JUDGE'S ORDER  
(Stratum No. 203841)  
REGISTERED PLAN 355  
CITY OF OTTAWA  
PART OF LOTS 30  
(CONFESSIONS (OTTAWA FRONT))  
Geographic Township of Nepean and  
PART OF FOOT RESERVE  
REGISTERED PLAN 35687  
CITY OF OTTAWA  
Surveyed by Armin O'Sullivan, Vollebakk Ltd.

- Deciduous Tree
- Planting Bed
- Shrub Planting
- Turf
- Soil Cell
- Concrete
- Concrete Monolithic Curb
- Precast Pavers

- SITE / ARCHITECTURE**
- Parking Garage Below
  - Fire Hydrant
  - FD Siamese Connection
  - Light Standard
  - Hydro/Utility Pole
  - Bike Parking refer to site plan
  - Property Line

- BELOW GRADE SERVICES REFER TO CIVIL/CUP**
- WTR U/G Water Service
  - STM U/G Storm Service
  - SAN U/G Sanitary Service
  - GAS U/G Gas Service
  - BC U/G TelCo Service
  - H U/G Hydro Service
  - OHW O/H Hydro Service

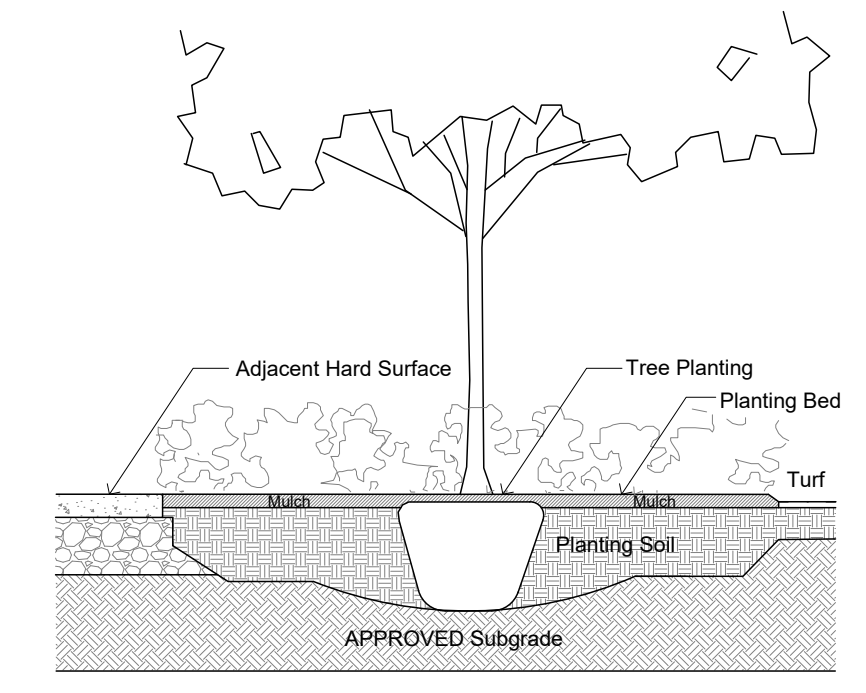

TREE PLANTING IN PLANTING BED NTS

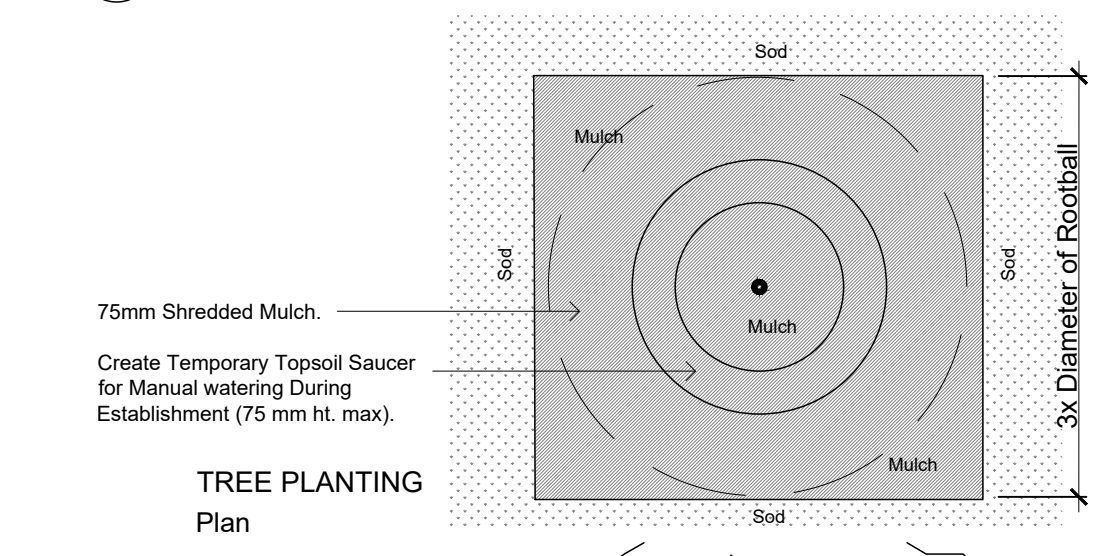

TREE PLANTING PLAN

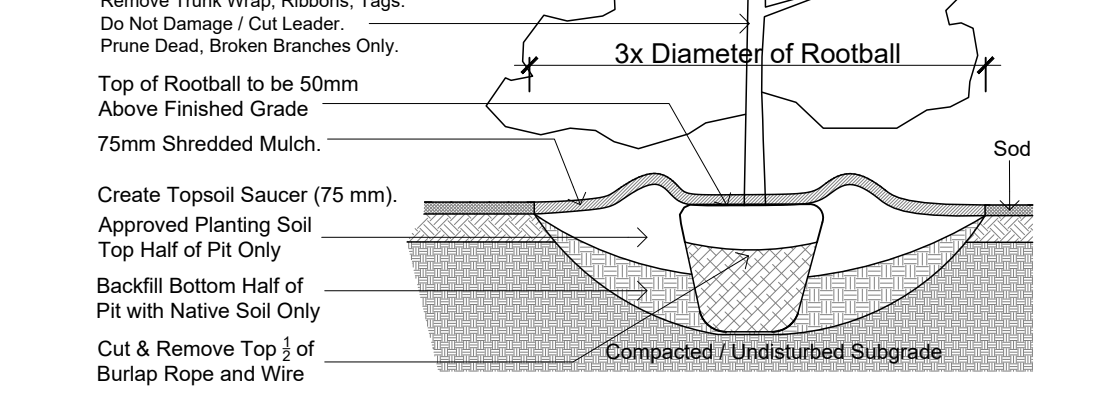

TREE PLANTING TYPICAL SECTION NTS

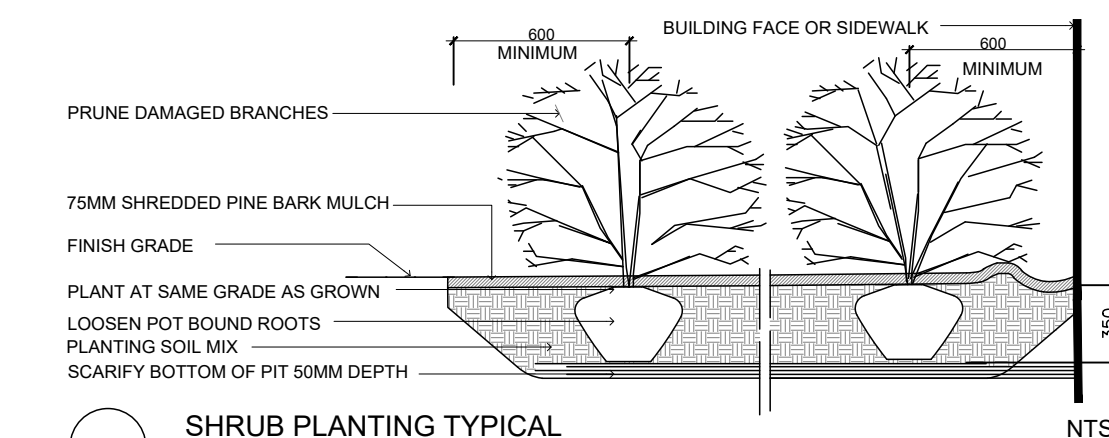

SHRUB PLANTING TYPICAL SECTION NTS

TREE SCHEDULE - 1746 CARLING / 1755 KERR - OVERALL SITE ALL PHASES ZBLA												
CODE	PHASE 1	FUTURE	TOTAL	BOTANICAL NAME	COMMON NAME	B&R SPECIMEN	NATIVE to CANADA	TORONTO CITY OF OTTAWA	SPREAD BY PER	CONTRIBUTION/Tree in Square Metres	Total Canopy Cover	
AR	7	7	14	Acer rubrum	Red Maple	50mm cal	YES	10.0M	5.0M	78.5	1099	
AS	3	7	10	Acer saccharum	Sugar Maple	50mm cal	YES	14.0M	7.0M	154	1540	
BP	3	7	10	Betula papyrifera	Paper Birch	50mm cal	YES	10.0M	5.0M	78.5	785	
CO	3	7	10	Cotinus occidentalis	Common Hackberry	50mm cal	YES	14.0M	7.0M	154	1540	
QM	3	7	10	Quercus macrocarpa	Bur Oak	50mm cal	YES	14.0M	7.0M	154	1540	
QR	3	7	10	Quercus rubra	Red Oak	50mm cal	YES	14.0M	7.0M	154	1540	
CD	3	7	10	Quercus nigra	Black Oak	50mm cal	YES	14.0M	7.0M	154	1540	
CD	3	7	10	Quercus prinus	White Oak	50mm cal	YES	14.0M	7.0M	154	1540	
TOTAL	22	42	64	TOTAL FORECASTED CANOPY COVER IN SQUARE METRES (based on Calculators per Tree as shown above)								8044
TOTAL FORECASTED CANOPY COVER IN SQUARE METRES ADJUSTED FOR OVERCROP WITH OTHER TREES, BUILDINGS LOT LINES, ETC.												
SITE AREA in Square Metres excluding park												
TOTAL FORECASTED CANOPY COVER as Percentage of Site Area												

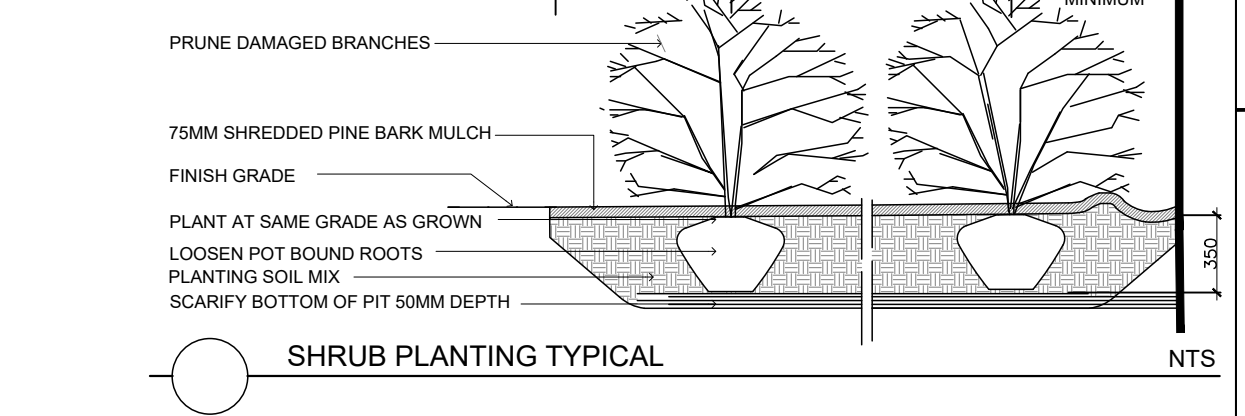
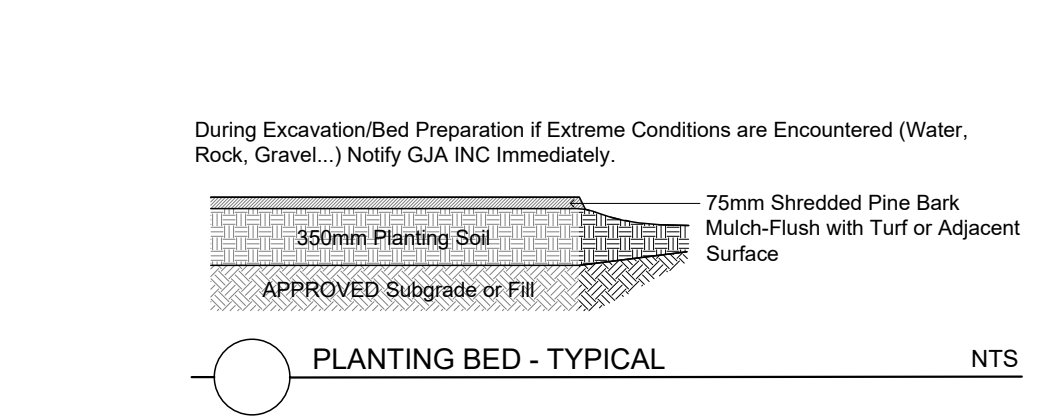
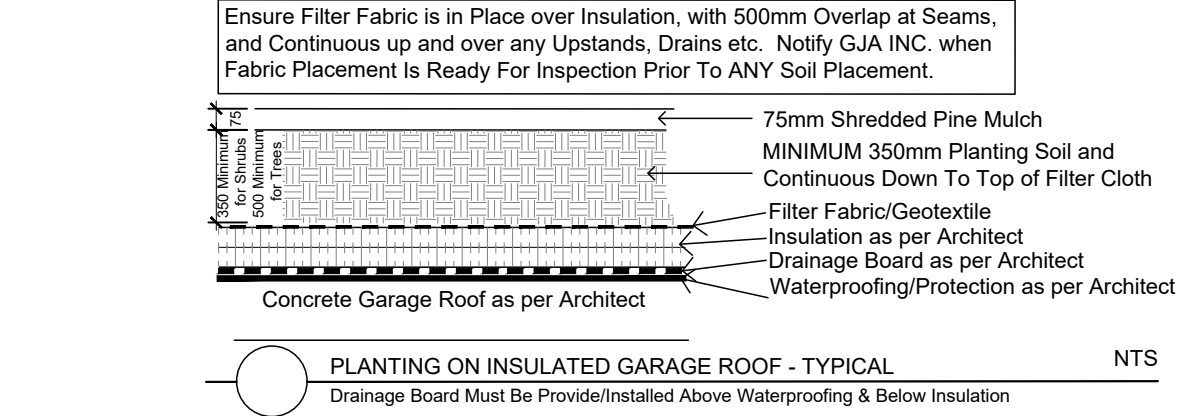
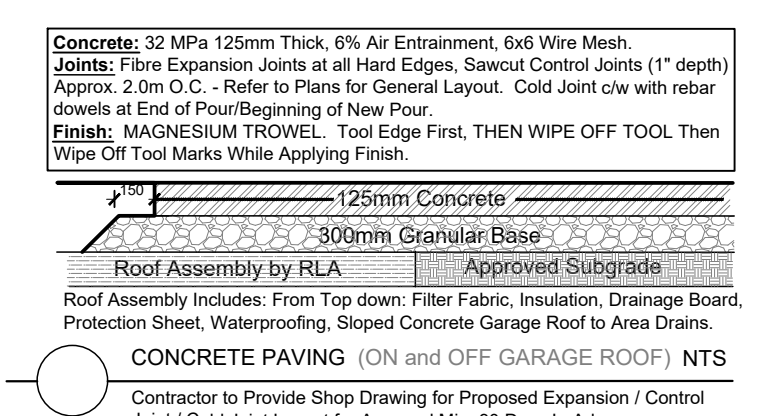

**PROFESSIONAL LANDSCAPE ARCHITECT**

1 ZBLA SUBMISSION 1 2026 01 21  
0 REVIEW/COORDINATION 2025 07 17  
# Revision Date

PROPERTY OWNER  
**KERR BROADVIEW PROPERTIES LTD.**  
236 Metcalfe Street Ottawa K2P 1R3

**GJA INC.**  
GINO J. AIELLO | LANDSCAPE ARCHITECT  
GJALA.COM | 613 286 5130 | GINO@GJALA.COM  
115 DEBILITY ROAD UNIT # 1 | OTTAWA ONTARIO | K1T 5C2

**MIXED USE DEVELOPMENT**

1746 Carling / 1755 Kerr Avenues Ottawa

**Landscape Plan**

**L1**

Scale: 1:250