

**SOURCE REFERENCE:**  
**LEGAL INFORMATION:**  
 1. PLAN OF SUBDIVISION OF PART OF LOT 2, CONCESSION 9, GEOGRAPHIC TOWNSHIP OF CUMBERLAND BLOCK 27 AND PART OF BLOCK 26, REGISTERED PLAN 4M-XXXX CITY OF OTTAWA, PREPARED BY ANNIS O'SULLIVAN VOLLEBECK LTD, REVISION 5, AUGUST 13, 2025.  
**TOPOGRAPHIC INFORMATION:**  
 HORIZONTAL DATUM: NAD 83 (ORIGINAL), MTM - ZONE 9  
 VERTICAL DATUM: CGVD 28.78  
 1. CITY OF OTTAWA 1:1000 MAPPING  
 2. NOVATECH SURVEY  
 3. AOV SURVEY, MAY 2025

**LEGEND**

- RIGHT OF WAY
- MINIMUM ZONING SETBACK
- LOT LINE
- EASEMENT
- PHASING BOUNDARY
- PROPOSED DEPRESSED CURB
- PROPOSED CURB
- PROPOSED TACTILE WALKING SURFACE INDICATOR (TWSI)
- PROPOSED CONCRETE SIDEWALK
- PROPOSED TOWNHOUSE SERVICE LOCATION
- PROPOSED SERVICE LOCATION IN DRIVEWAY
- PROPOSED TOWNHOUSE DUAL SERVICE LOCATION
- PROPOSED SINGLE HOUSE SERVICE LOCATION
- SANITARY MAINTENANCE HOLE & SEWER
- STORM MAINTENANCE HOLE & SEWER
- CATCHBASIN & LEAD
- WATERMAIN
- WATERMAIN CAP
- VALVE & VALVE BOX LOCATION
- FIRE HYDRANT CW LEAD
- WATERMAIN HORIZONTAL BEND
- PROPOSED STREETLIGHT
- PROPOSED STREETLIGHT WITH GROUNDING
- PROPOSED HYDRO ONE TRANSFORMER AND BASE
- PROPOSED STREET LIGHT DISCONNECT
- BELL GRADE LEVEL BOX
- PROPOSED BELL PEDESTAL
- PROPOSED ROGERS VAULT (0.9m x 1.5m)
- PROPOSED GAS METER LOCATION
- PROPOSED INDIVIDUAL HYDRO METER LOCATION
- PROPOSED MULTI UNIT HYDRO METER LOCATION NUMBER INDICATES THE AMOUNT OF UNITS CONNECTED
- PROPOSED BELL END WALL PANEL
- PROPOSED ROGERS END WALL PANEL
- PROPOSED PRIMARY JOINT UTILITY TRENCH (JUT)
- PROPOSED HYDRO DUCT
- PROPOSED STREET LIGHT CONDUIT
- PROPOSED COMMUNITY MAIL BOX
- PROPOSED ROAD CROSSING
- 2H
- 1C
- 1SL
- 1B
- 2S
- PROPOSED DECIDUOUS TREE

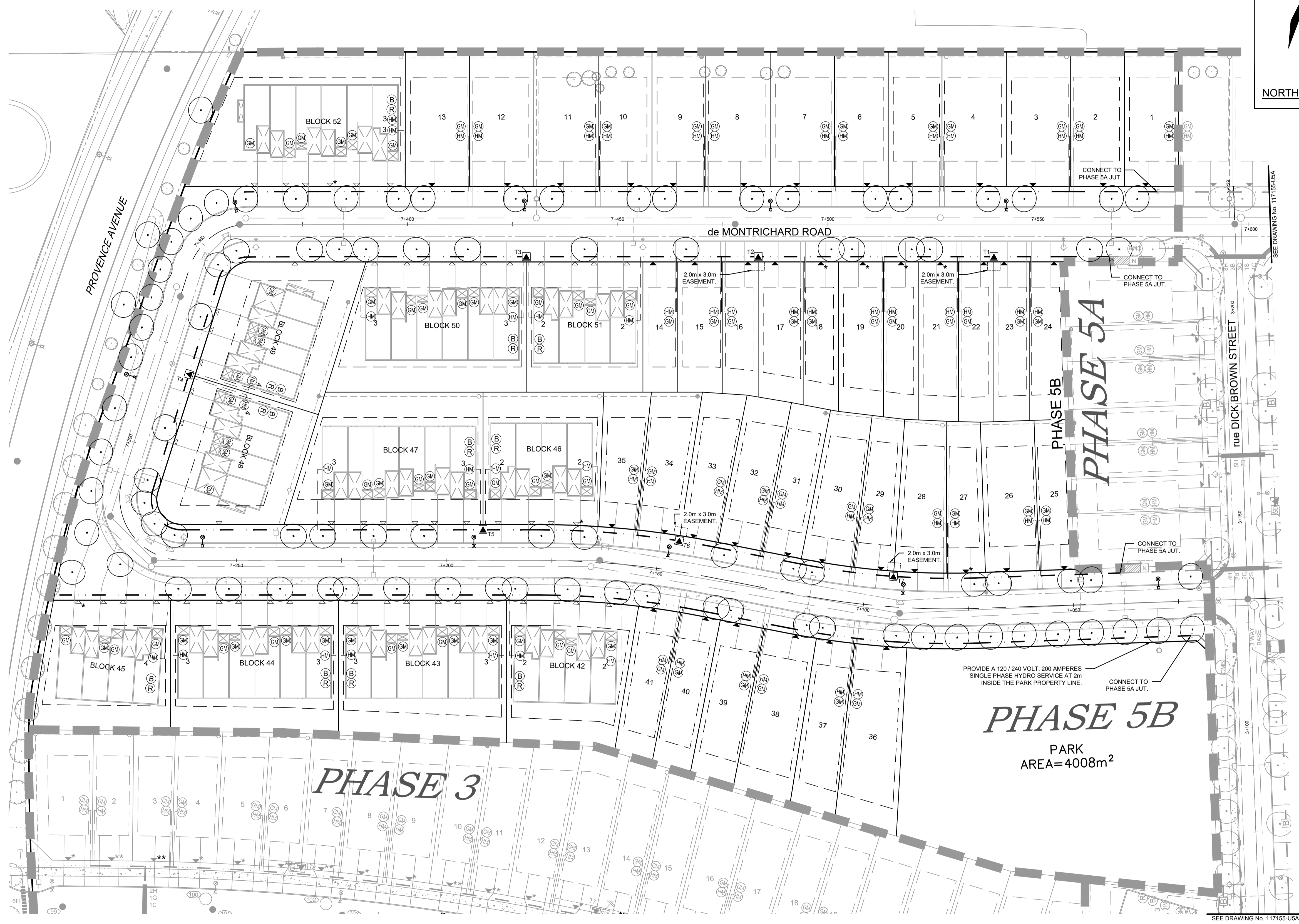

**NOTE:**  
 THE POSITION OF ALL POLE LINES, CONDUITS, WATERMANS, SEWERS AND OTHER UNDERGROUND AND OVERGROUND UTILITIES AND STRUCTURES IS NOT NECESSARILY SHOWN ON THE CONTRACT DRAWINGS, AND WHERE SHOWN, THE ACCURACY OF THE POSITION OF SUCH UTILITIES AND STRUCTURES IS NOT GUARANTEED. BEFORE STARTING WORK, DETERMINE THE EXACT LOCATION OF ALL SUCH UTILITIES AND STRUCTURES AND ASSUME ALL LIABILITY FOR DAMAGE TO THEM.



No.	REVISION	DATE	BY
2.	ISSUED FOR REVIEW	OCT 14/25	TJM
1.	ISSUED FOR UTILITY COORDINATION	AUG 21/25	TJM

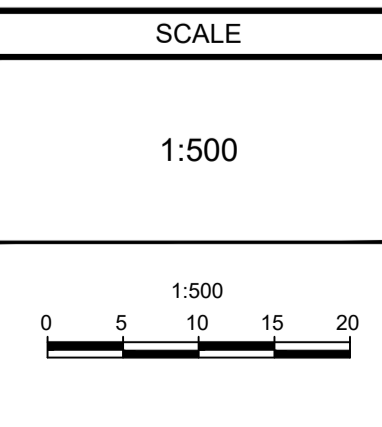

DESIGN	MWB
CHECKED	TJM
DRAWN	MA
CHECKED	TJM
APPROVED	TJM
	MWB



**NOVATECH**  
 Engineers, Planners & Landscape Architects  
 Suite 200, 240 Michael Cowpland Drive  
 Ottawa, Ontario, Canada K2M 1P6  
 Telephone: (613) 254-9643  
 Facsimile: (613) 254-5867  
 Website: www.novatech-eng.com

<b>LOCATION</b> CITY OF OTTAWA PROVENCE ORLÉANS SUBDIVISION (2128 TRIM ROAD)	
<b>DRAWING NAME</b> PHASE 5B COMPOSITE UTILITY PLAN	
PROJECT No.	117155
REV	REV # 2
DRAWING No.	117155-U5B