

REFER TO NOTES & DETAILS ON DRAWING No. C-11 TO C-13

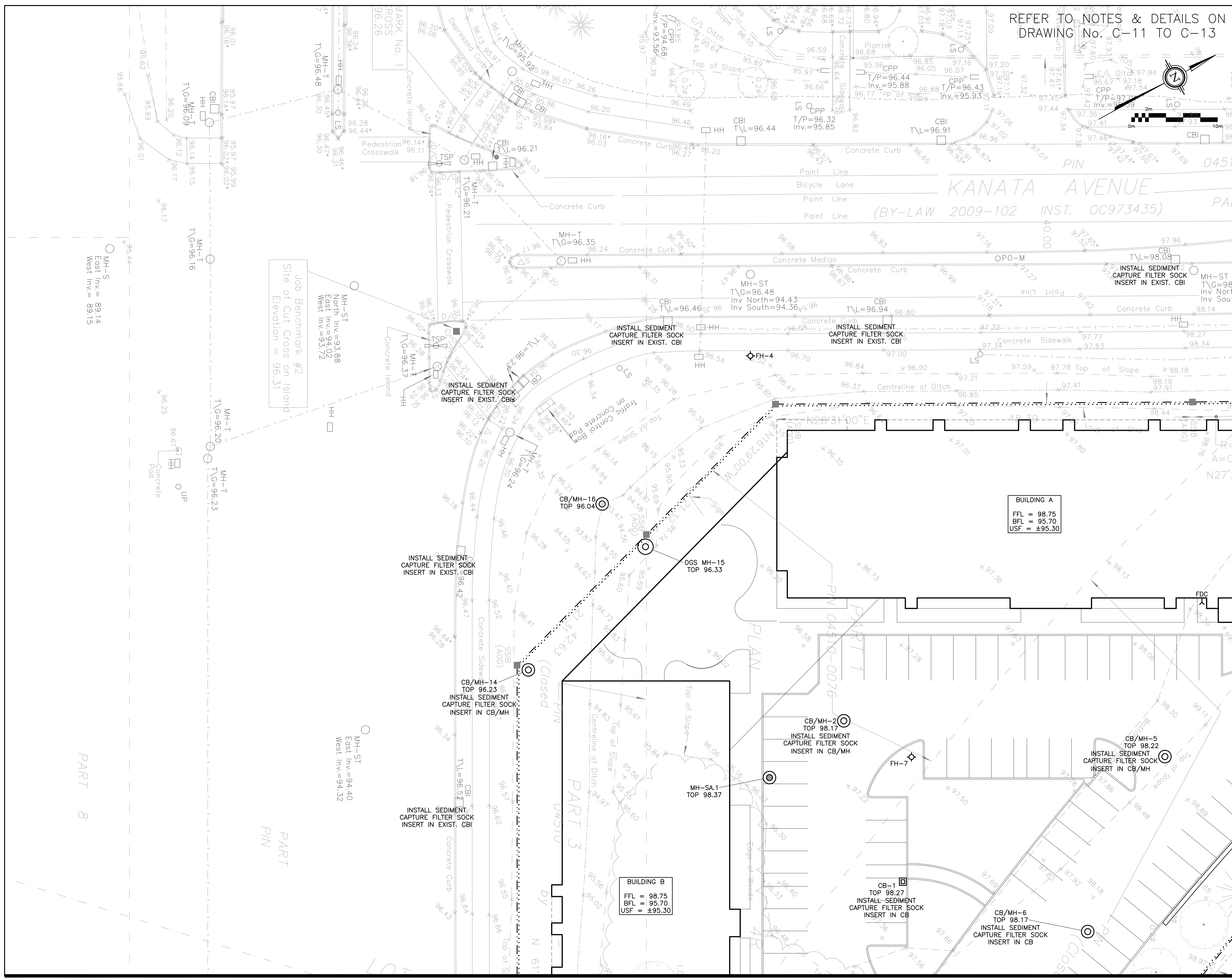

LEGEND

FFL	FINISHED FLOOR ELEVATION
BFL	BASEMENT FLOOR ELEVATION
USF	UNDERSIDE OF FOOTING
---	PROPERTY LINE
CB	CATCH-BASIN
MH	STORM MANHOLE
CB/MH	CATCH-BASIN/MANHOLE
MH	SANITARY MANHOLE
DMAC	DMA CHAMBER
FH	FIRE HYDRANT
FDC	FIRE DEPARTMENT CONNECTION
x99.99	EXISTING ELEVATION
+99.99	PROPOSED ELEVATION
2%	PROPOSED SLOPE
→	EMERGENCY OVERLAND FLOW
---	CENTERLINE OF SWALE
---	150mm BARRIER CURB
DC	DEPRESSED CURB
.....	SILT FENCE BARRIER

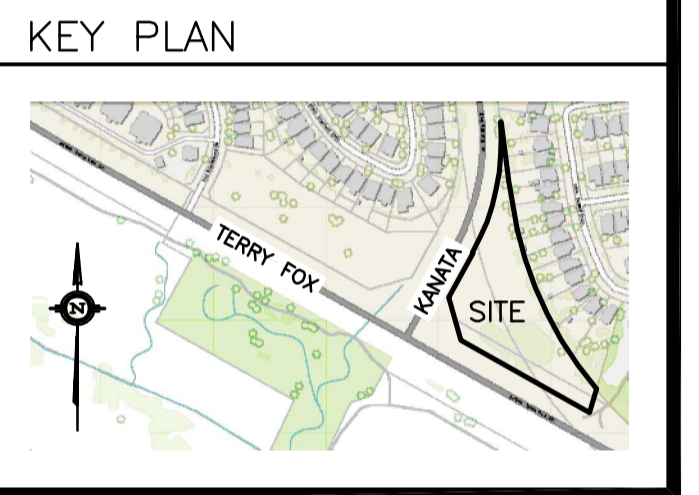

No.	DATE	REVISION
3	JAN 26-26	RE-ISSUED FOR APPROVAL
2	OCT 28-25	RE-ISSUED FOR APPROVAL
1	JUL 11-25	ISSUED FOR APPROVAL

D. B. GRAY ENGINEERING INC.
 Stormwater Management - Grading & Drainage - Storm & Sanitary Sewers - Watermain
 700 Long Point Circle 613-425-8044
 Ottawa, Ontario d.gray@dbgrayengineering.com

Project
**PROPOSED 6-STORY APARTMENT BUILDINGS
 475 TERRY FOX DRIVE
 OTTAWA, ONTARIO**

Drawing Title
**EROSION & SEDIMENT CONTROL PLAN
 (SW CORNER)**

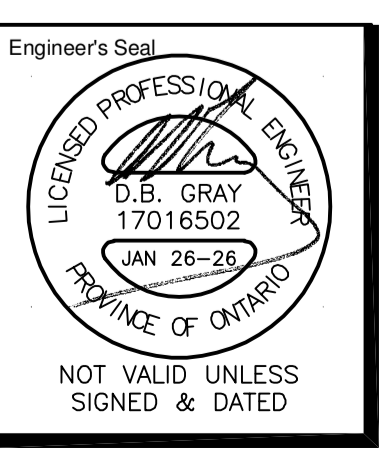

Engineer's Seal
 D.B. GRAY
 17016502
 JAN 26-26
 PROVINCE OF ONTARIO

Drawn D.B.G.
 H. Scale 1:200
 V. Scale
 Date JUL 11-25
 Job No. 24103

Drawing No.
C-8
 of 19

BUILDING A
 FFL = 98.75
 BFL = 95.70
 USF = ±95.30

BUILDING B
 FFL = 98.75
 BFL = 95.70
 USF = ±95.30

Job Benchmark #2
 Site of Cut Cross on Island
 Elevation = 96.31

MH-S
 East Inv. = 89.14
 West Inv. = 89.15

MH-ST
 North Inv. = 93.88
 East Inv. = 94.02
 West Inv. = 93.72

MH-ST
 East Inv. = 94.40
 West Inv. = 94.32

PART 8

PART PIN

PART 3

PART 1

PART 2

PART 4

PART 5

PART 6

PART 7

PART 9