

STREET No. 16-18

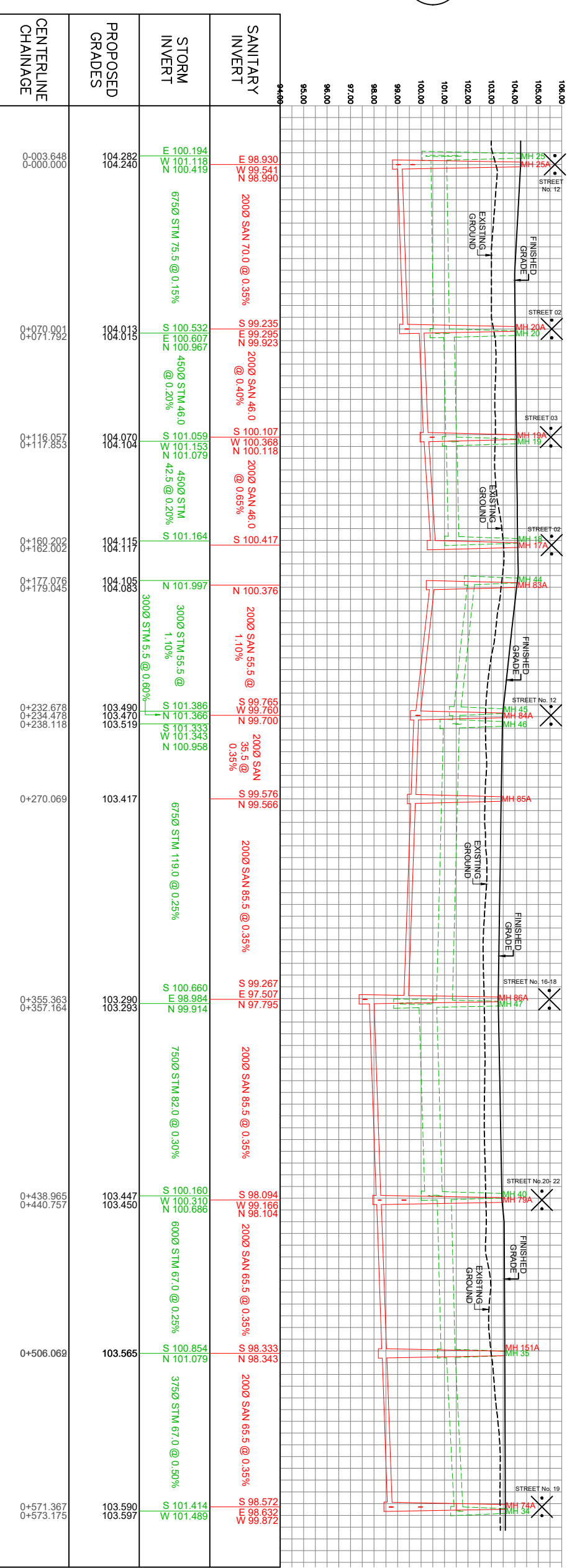

TENDERS PASS & KETTLE VALLEY

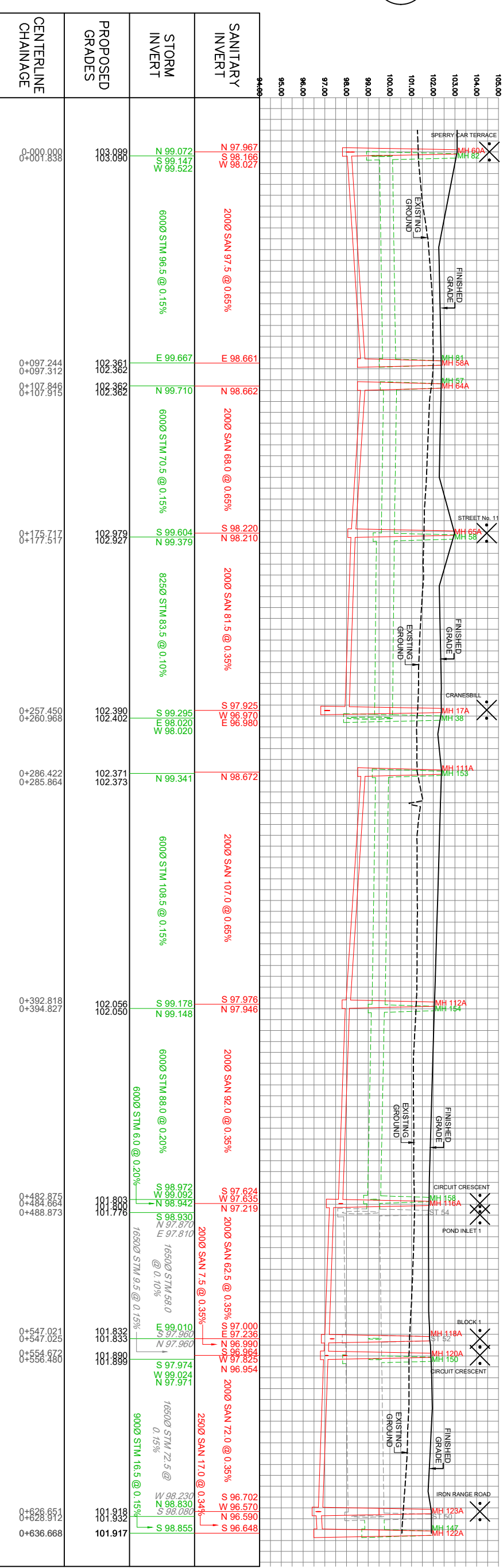

STREET 17

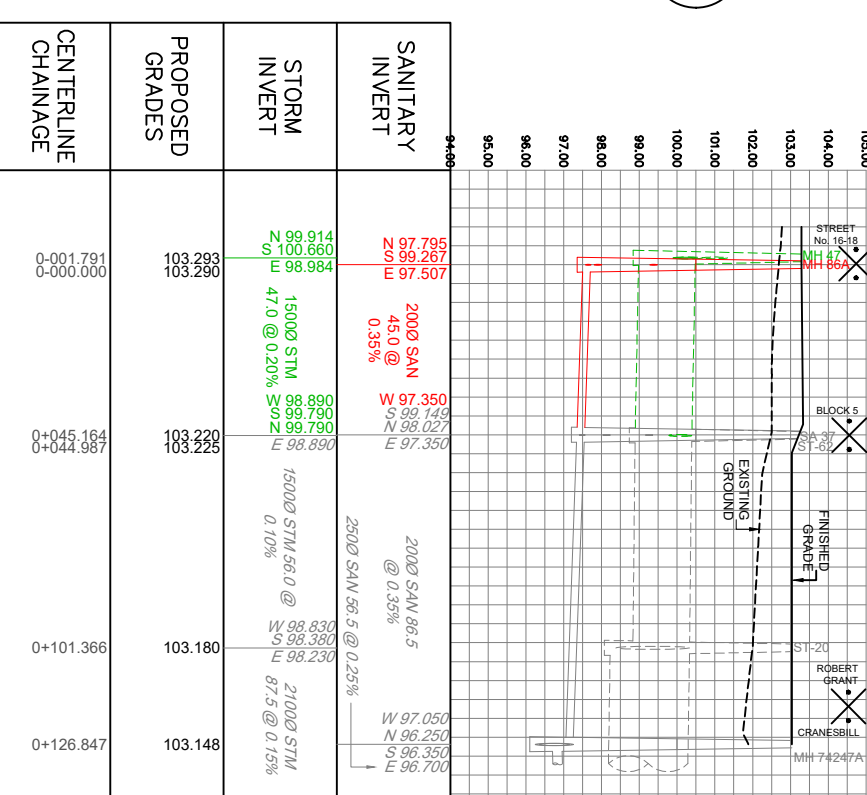

STREET No. 21

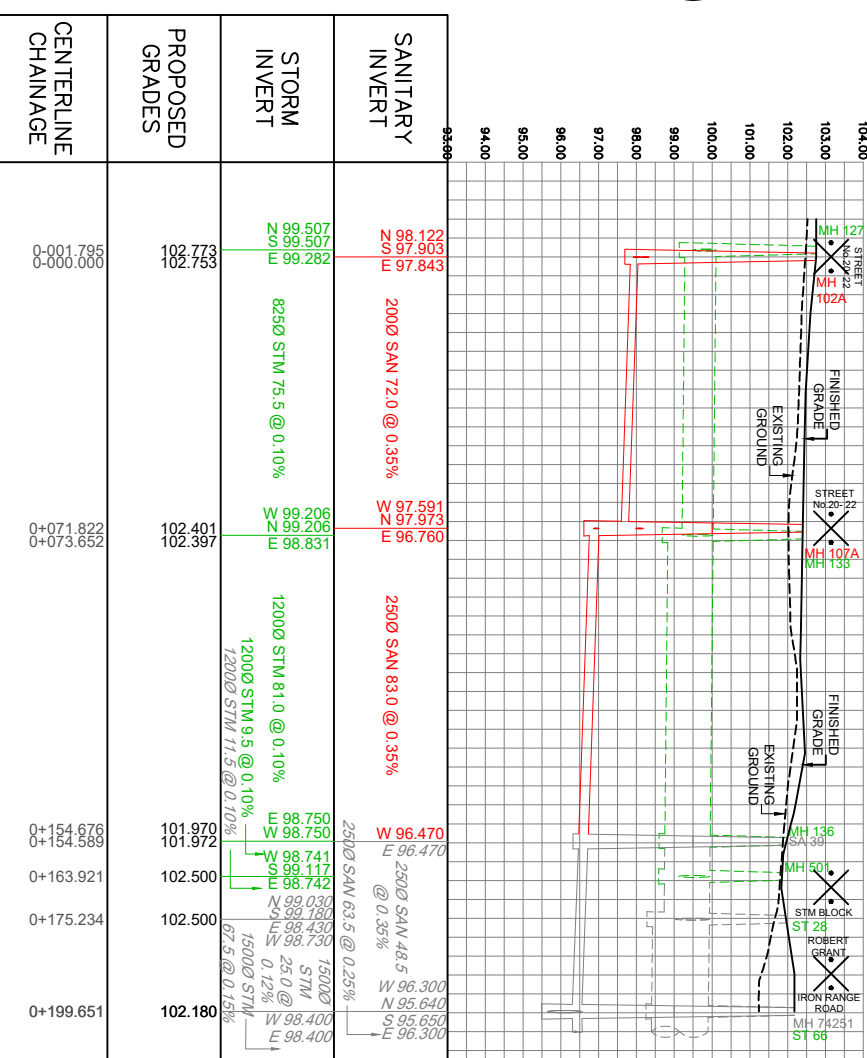

FAREBOX WAY & WHISTLE POST

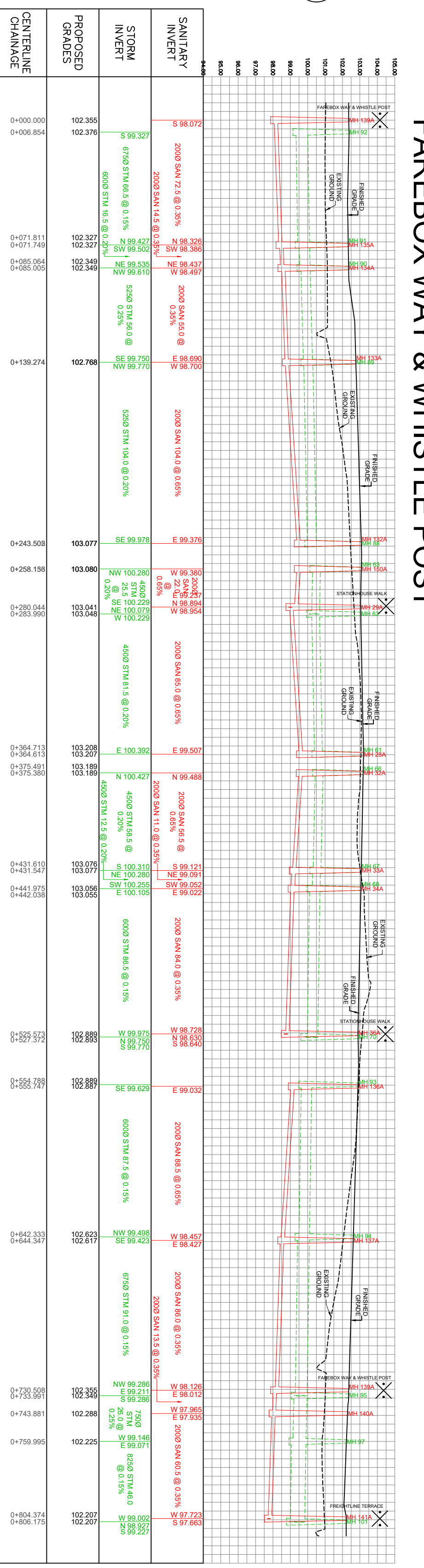

CABLE CAR CRESCENT

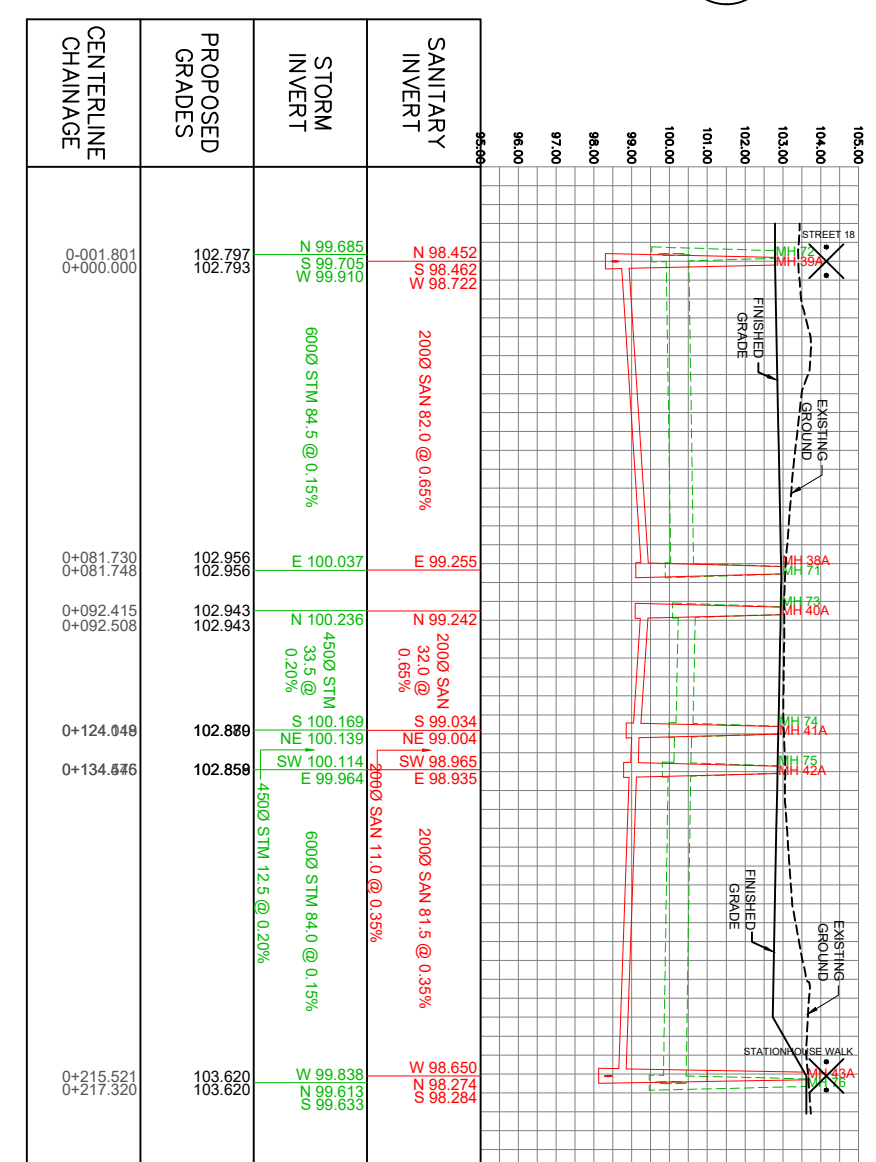

IRON RANGE ROAD

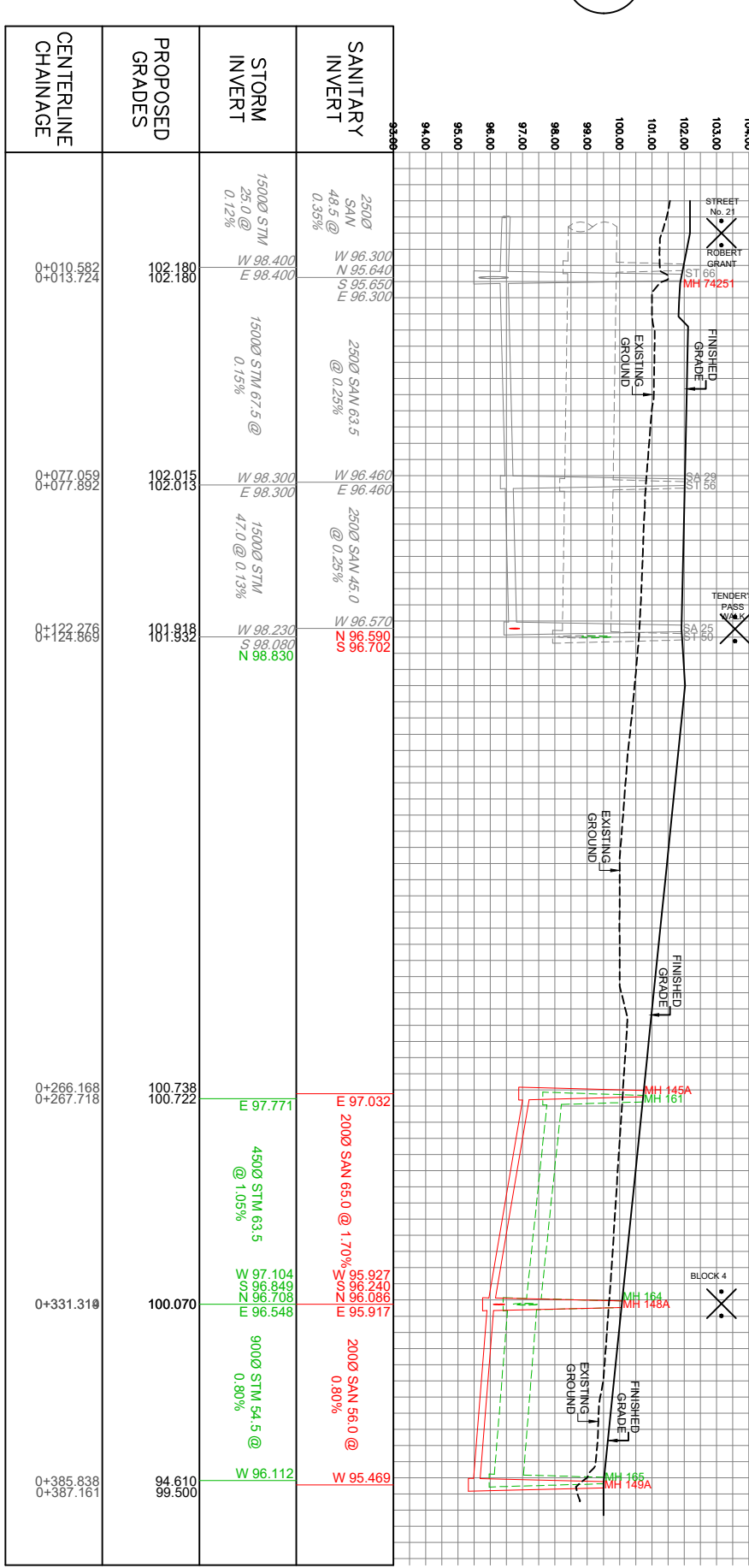

MONORAIL ROAD

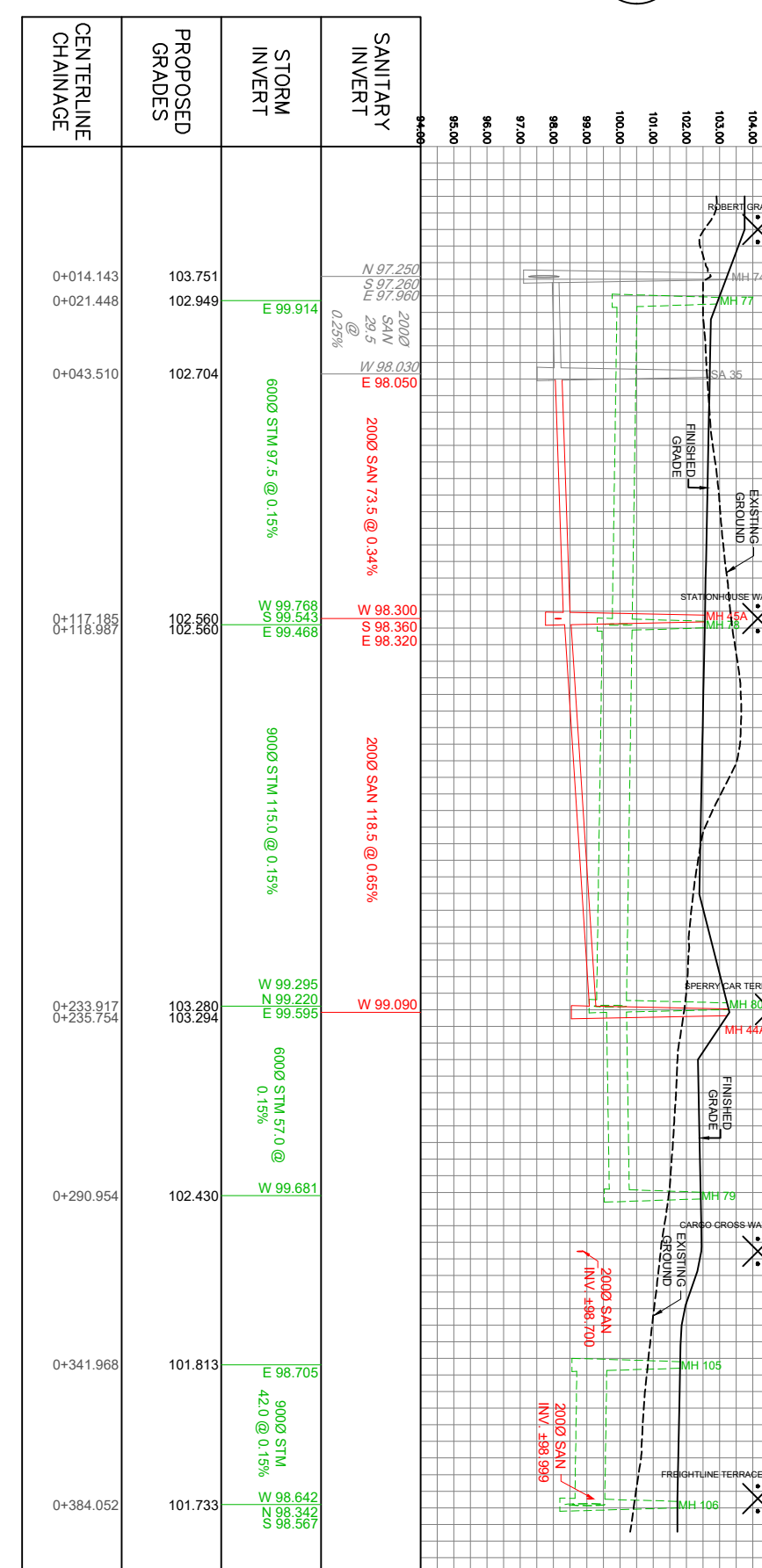

120 Iber Road, Unit 103
 Sibleville, Ontario, K2S 1E9
 Fax: (613) 856-7783
 www.dsel.ca

ABBOTT'S RUN
 PRELIMINARY
 DESIGN
 CITY OF OTTAWA

PROFILES
 SCALE: 1:2000
 PROJECT No.: 22-1205
 DATE: MAY 2025
 DRAWING: 06