



ARTIST RENDERINGS. FOR REFERENCE ONLY.

# NORR

2300, 411 – 1st Street SE  
 Calgary, AB, Canada T2G 4Y5  
 norr.com

NORR Architects Engineers Planners  
 A Partnership of Corporations  
From McMoran Architects (sBarb) Inc. From McMoran Holdings Inc.

Jonathan Hughes, Architect, AAA, OAA, AIBC, MAA, AANB, AAPE  
 Adrian Todella, P.Eng., APEGA  
 Chris Pal, P.Eng., APEGA

# TOWNLET - SITE 3

CALGARY, ALBERTA, CANADA

DEVELOPMENT PERMIT: ISSUED FOR DEVELOPMENT PERMIT

NORR PROJECT NUMBER: RZ1124-0046

APRIL 20, 2026



REAL ESTATE DEVELOPMENT & CONSTRUCTION

## CLIENT

**JAYMAN LIVING**  
 200, 3132 - 118TH AVENUE SE  
 CALGARY, AB, T2Z 3X1  
 403 258 3772

## CONSTRUCTION MANAGER

**CENTRON GROUP**  
 104 - 8826 BLACKFOOT TRAIL SE  
 CALGARY, AB, T2J 3J1  
 403 252 1120

## ARCHITECTURE

**NORR**  
 2300, 411 - 1<sup>st</sup> STREET SE  
 CALGARY, AB, T2G 4Y5  
 403 264 4000

## INTERIORS

**TBC**  
 2300, 411 - 1<sup>st</sup> STREET SE  
 CALGARY, AB, T2G 4Y5  
 403 264 4000

## STRUCTURAL

**ENTUITIVE**  
 150 9<sup>th</sup> AVENUE SW, SUITE 1610  
 CALGARY, AB, T2P 3H9  
 403 879 1270

## LANDSCAPE

**EIGHT ONE EIGHT**  
 1812 14a STREET SW  
 CALGARY, AB, T2T 3W6  
 403 244 8188

## MECHANICAL

**SMITH + ANDERSEN**  
 1205, 330 5<sup>th</sup> AVENUE SW  
 CALGARY, AB, T2P 0L4  
 403 261 8897

## CIVIL

**URBAN SYSTEMS**  
 101-134 11<sup>th</sup> Avenue SE  
 CALGARY, AB, T2G 0X5  
 403 451 3633

## ELECTRICAL

**SMITH + ANDERSEN**  
 1205, 330 5<sup>th</sup> AVENUE SW  
 CALGARY, AB, T2P 0L4  
 403 261 8897

## SURVEY

**URBAN SYSTEMS**  
 101-134 11<sup>th</sup> Avenue SE  
 CALGARY, AB, T2G 0X5  
 403 451 3633

## AMENDED DRAWINGS

DP No	Date Received
DP2026-01975	2026-04-22

THESE DRAWINGS REFER TO THE ABOVE DEVELOPMENT PERMIT NO.

DATE	ISSUED FOR	REV
2026-04-20	FOR DP SUBMISSION	1

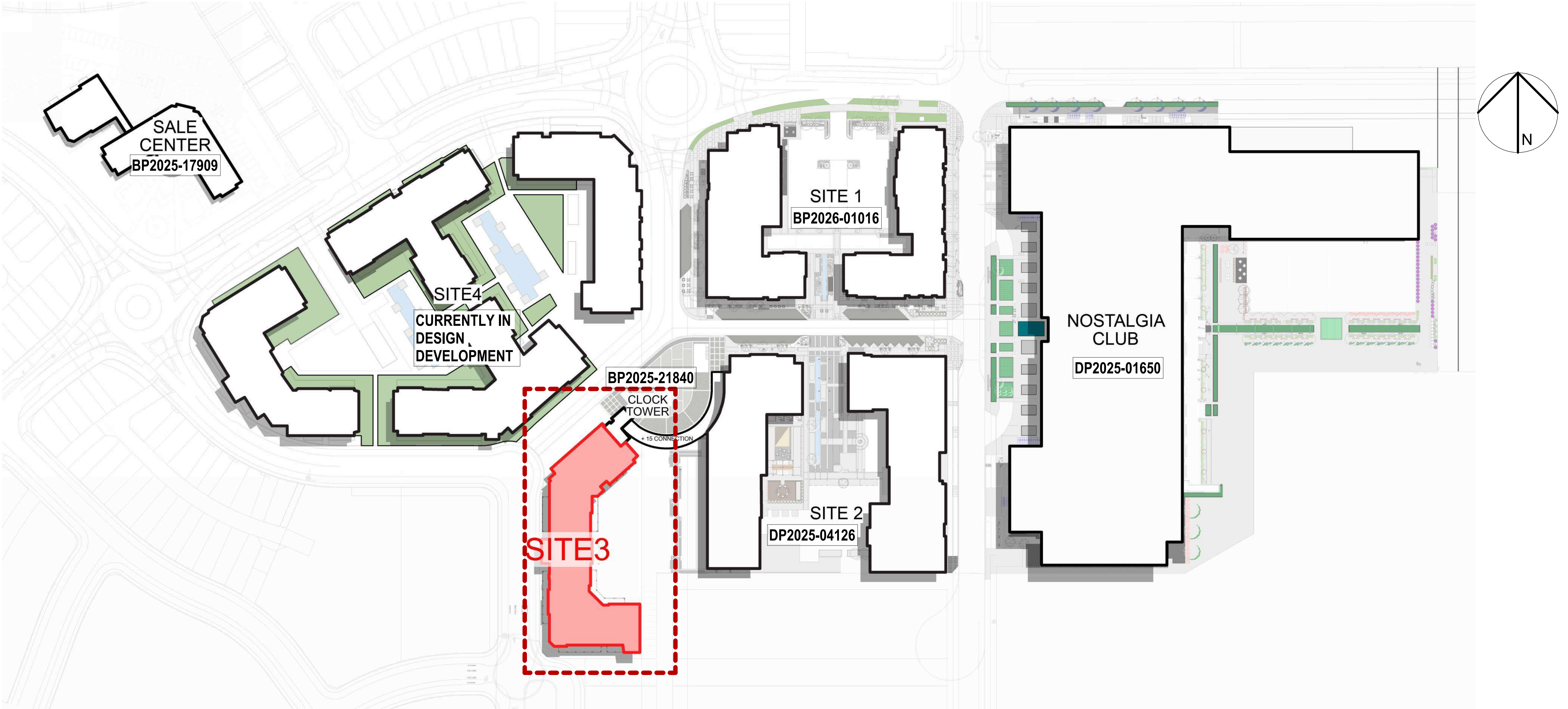

**Site Information**

LAND USE DISTRICT	DIRECT CONTROL DISTRICT	DC (M.U.2)
LEGAL DESCRIPTION		
MUNICIPAL ADDRESS		
COMMUNITY	NOSTALGIA	
SITE AREA	6,514 SM	70,116 SF

**Development Statistics**

PROPOSED USE	6 Storey Mixed Use with 5 Retail Stores at grade and 116 Residential units between levels G1 to G6	
DENSITY	Proposed 116 units/hectare	
DENSITY / SITE COVERAGE	Site 3	2,240 SM 34.4%
LANDSCAPE COVERAGE	SEE LANDSCAPE DRAWINGS	
AMENITY AREA		
Indoor	TBD	TBD
Outdoor	TBD	TBD
Private / Balcony		0 SF
Total	0	
SETBACKS	BYLAW REQ.	PROJ. PROPOSED
WEST	0.0 M	0.0 M
SOUTH	0.0 M	N/A
NORTH	0.0 M	3.00 M
EAST	0.0 M	0.0 M
BUILDINGS HEIGHT	BYLAW REQ.	PROJ. PROPOSED
Overall Proposed Max Height	25.00 M	25.90 M
FLOOR AREA RATIO	FAR	SM
Maximum Allowed	TBD	TBD
Proposed	1.99	12,946.59

**AMENDED DRAWINGS**  
 DP No **DP2026-01975** Date Received **2026-04-22**  
**THESE DRAWINGS REFER TO THE ABOVE DEVELOPMENT PERMIT NO.**

2 SITE CONTEXT  
SCALE: NTC

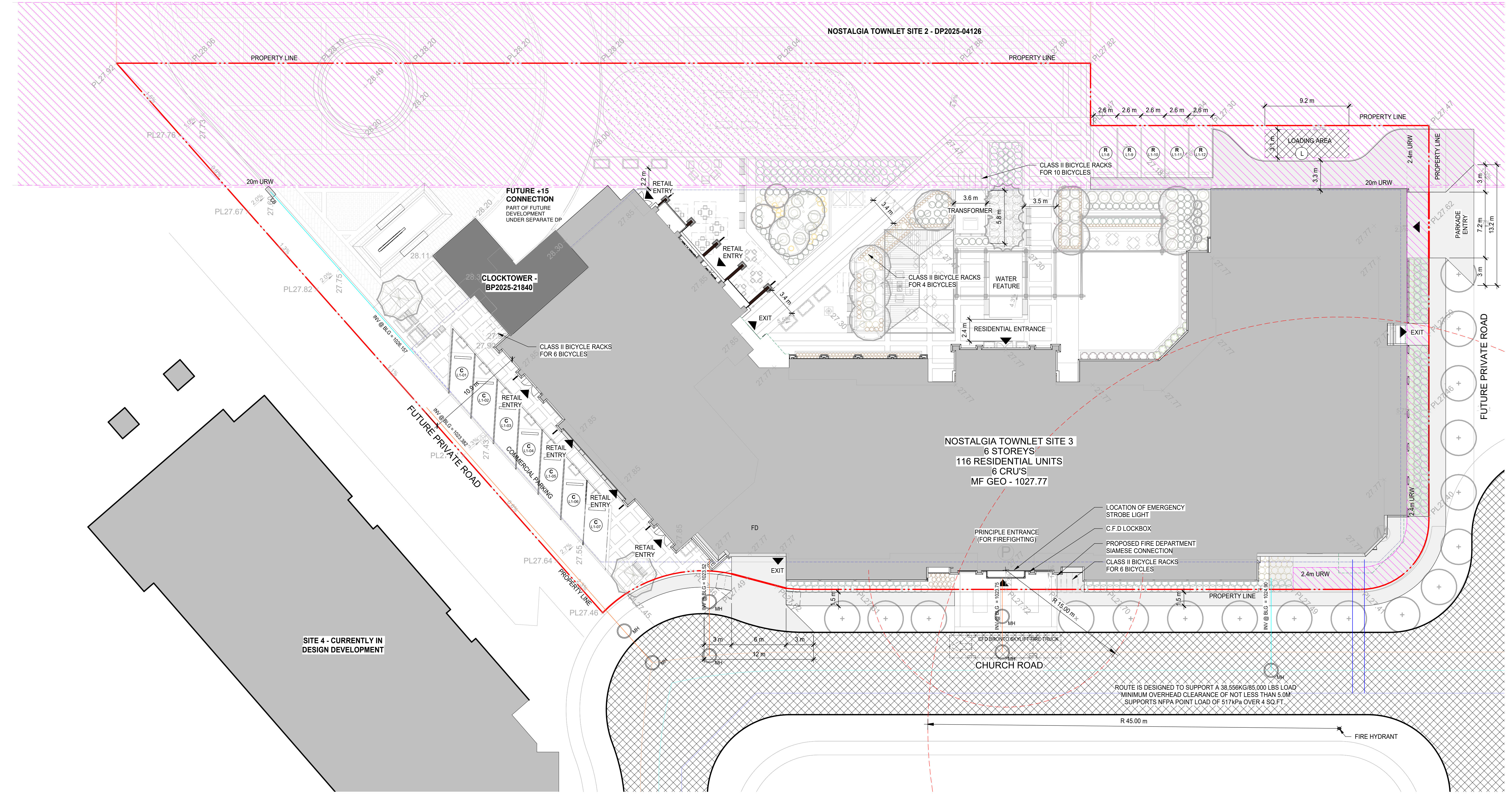

- SITE PLAN NOTES**
- REGULAR ASPHALT ON PARKING STALLS
  - REGULAR CONCRETE ON GARAGE APPROACH
  - WHEEL STOPS TO BE 100mm HIGH AND PLACED 600mm FROM FRONT OF PARKING STALL (V.S.)
  - NO PARKING ANYTIME AT LOADING STALL
  - REFER TO CIVIL DRAWINGS FOR SERVICING AND GRADING
  - REFER TO LANDSCAPE DRAWINGS FOR DETAILS

- GENERAL NOTES**
- REFER TO LANDSCAPE PLANS FOR EXISTING AND PROPOSED TREES, SIDEWALKS AND FEATURES
  - REFER TO LIGHTING PLAN FOR SITE LIGHTING LAYOUT AND DETAILS. ARCHITECTURAL SITE PLAN IS FOR REFERENCE ONLY.
  - REFER TO DP10-003 FOR WASTE & RECYCLING DRAWINGS AND DETAILS
  - ALL PROPERTY LINES ARE EXISTING AND ALL ELEMENTS WITHIN PROPERTY LINE ARE PROPOSED UNLESS NOTED OTHERWISE
  - NO SURFACE PARKING (VISITORS INCLUDED) SHALL EXCEED 4% SLOPE IN ANY DIRECTION
  - ALL INFORMATION ABOUT SERVICES, UTILITY RIGHT OF WAY AND GRADING IS PROVIDED & EXTERIOR STEPS BY CIVIL ENGINEER AND IT'S SHOWN IN ARCHITECTURAL DRAWINGS FOR REFERENCE ONLY. IF THERE IS ANY DISCREPANCY AND FOR ADDITIONAL INFORMATION REFER TO CIVIL DRAWINGS.
  - THIS DEVELOPMENT PERMIT DRAWING AND NOTED AREA CALCULATION IS FOR GENERAL REFERENCE ONLY. ALL BUILDINGS AREAS ARE APPROXIMATE AND ARE TO BE CONFIRMED BY A LAND SURVEYOR REGISTERED IN THE JURISDICTION OF THE PROJECT.

- SITE LEGEND**
- ▲ PRINCIPAL ENTRY
  - C COMMERCIAL PARKING
  - R RESIDENTIAL PARKING
  - V VISITOR PARKING
  - EV ELECTRICAL VEHICLE READY
  - ♿ BARRIER FREE PARKING
  - B.F. BARRIER FREE PARKING SIGNAGE
  - VIS VISITOR PARKING SIGNAGE
  - Ⓟ NO PARKING ANY TIME / FIRELANE
  - Ⓢ STOP SIGN
  - Ⓜ TRANSFORMER & CONC. PAD
  - Ⓜ FIRE HYDRANT EXISTING (E.) & PROPOSED (P.)
  - ASPHALT FINISH
  - PROPERTY LINE
  - URW
  - BUILDING / PROJECTION ABOVE
  - LINE OF BUILDING BELOW
  - PROPOSED / EXISTING WATER LINE - REFER TO CIVIL
  - PROPOSED / EXISTING STORM LINE - REFER TO CIVIL
  - PROPOSED / EXISTING SANITARY LINE - REFER TO CIVIL
  - PROPOSED / EXISTING ELECTRICAL - REFER TO CIVIL

NORR to any party with whom NORR has not entered into a contract.

This drawing shall not be used for construction purposes until the seal appearing hereon is signed and dated by the Architect or Engineer

Project Component  
**DESIGN DEVELOPMENT**

Key Plan

Consultants  
 Architecture: NORR  
 Structural: ENTULIVE  
 Mechanical: SMITH + ANDERSEN  
 Electrical: SMITH + ANDERSEN  
 Interiors: TBC  
 Landscape: EIGHT ONE EIGHT  
 Survey: URBAN SYSTEMS  
 Civil: URBAN SYSTEMS

Seal(s)

JOINT FIRM  
 NORR Architects Engineers Planners  
 Issued by  
 THE ALBERTA ASSOCIATION OF ARCHITECTS  
 Certificate No. AED18004

**NORR**  
 2300, 411 - 1st Street SE  
 Calgary, AB, Canada T2G 4Y5  
 norr.com

NORR Architects Engineers Planners  
 A Partnership of Corporations

Jonathan Hughes, Architect, A.A.A., C.A.A., A.S.C., M.A.S., A.A.S., A.A.P.E.  
 Allan Tamm, P. Eng., J.P.R.C.  
 Chris Hill, P. Eng., J.P.R.C.

Project Manager	Drawn
W.Woodcock	HG
Project Leader	Checked
F.Aris	RD

Client  
**Jayman Living**

Project  
**Nostalgia TOWNLET**

Drawing Title  
**TOWNLET - SITE 3**

Drawing Title  
**SITE LOCATION/SITE PLAN**

Scale  
**As indicated**

Project No.  
**RZ1124-0046**

Drawing No.  
**DP-10-01**



**MATERIAL LEGEND**

- A1 MATERIAL: GLASS  
COLOR: CLEAR  
LOCATION: Window Panels
- A2 MATERIAL: GLASS  
COLOR: CLEAR  
LOCATION: Door Frames
- A3 MATERIAL: SPANDELE  
COLOR: LIGHT BLUE - RGB (138,165,192)  
COLOR: WHITE
- A4 MATERIAL: " " TRIM  
COLOR: WHITE  
LOCATION: DOORS & WINDOWS
- A5 MATERIAL: METAL  
COLOR: BLACK - RGB (0,0,0)  
LOCATION: Window Frame
- A6 MATERIAL: " " DOOR FRAME  
COLOR: BLACK
- A7 "NOT IN USE (SITE 1)
- A8 "NOT IN USE (SITE 1)
- A9 MATERIAL: PREFINISHED METAL CORNICE  
COLOR: DARK BLACK - RGB (0,0,0)
- A10 MATERIAL: SOLAR PANELS
- A11 MATERIAL: STANDING SEAM METAL ROOFING  
COLOR: BLACK - RGB (0,0,0)  
LOCATION: Roof
- A12 MATERIAL: PRE-FINISHED ALUMINUM  
COLOR: OFF WHITE - RGB (230,230,230)  
LOCATION: Balcony Railing
- A13 MATERIAL: PRE-FINISHED ALUMINUM  
COLOR: DARK BLACK - RGB (0,0,0)  
LOCATION: Balcony Railing
- P1 "NOT IN USE (SITE 1)
- P2 "NOT IN USE (SITE 1)
- P3 "NOT IN USE (SITE 1)
- P4 MATERIAL: PANELLING  
COLOR: DARK BLACK - RGB (0,0,0)
- P5 "NOT IN USE (SITE 1)
- P6 "NOT IN USE (SITE 1)
- P7 MATERIAL: PANELLING  
COLOR: LIGHT GRAY - RGB (176,176,176)
- S1 MATERIAL: STUCCO  
COLOR: LIGHT GRAY-RGB (204,204,204)
- S2 MATERIAL: STUCCO  
COLOR: WARM GRAY-RGB (228, 222, 218)
- S3 MATERIAL: STUCCO  
COLOR: WARM GRAY - RGB (182,178,173)
- B1 "NOT IN USE (SITE 1)
- B2 "NOT IN USE (SITE 1)
- B3 "NOT IN USE (SITE 1)
- B4 "NOT IN USE (SITE 1)
- B5 MATERIAL: STONE  
COLOR: ALBERTA SANDSTONE Random Rubble Installation
- B6 MATERIAL: BRICK  
COLOR: PEWTER
- B7 MATERIAL: BRICK  
COLOR: OXYA IRONSPOT SMOOTH
- C1 MATERIAL: CONCRETE  
COLOR: GREY - RGB (161,148,142)
- 22 EMERGENCY SCUPPER
- 23 MATERIAL: COLOR:  
LOCATION: Entrance Logo

NORR to any party with whom NORR has not entered into a contract.

This drawing shall not be used for construction purposes until the seal appearing hereon is signed and dated by the Architect or Engineer.

Project Component  
**DESIGN DEVELOPMENT**  
Key Plan

Consultants  
Architecture: NORR  
Structure: ENTUTLIVE  
Mechanical: SMITH + ANDERSEN  
Electrical: SMITH + ANDERSEN  
Interiors: TBC  
Landscape: EIGHT ONE EIGHT  
Survey: URBAN SYSTEMS  
Civil: URBAN SYSTEMS

Seal(s)  

JOINT FIRM  
NORR Architects Engineers Planners  
INCORPORATED  
THE ALBERTA ASSOCIATION OF ARCHITECTS  
CERTIFICATE NO. A221952  
**NORR**  
2300, 411 - 1st Street SE  
Calgary, AB, Canada T2G 4Y5  
nor.com  
NORR Architects Engineers Planners  
A Partnership of Corporations  
Member of the Alliance of Architects, Engineers, Planners and Surveyors of Alberta  
Jonathan Hughes, Architect, A.A.A. C.M.A. A.S.C. M.A.S. A.A.S.P. A.A.P.E.  
Alicia Young, P.Eng., P.F.C.S. A.P.C.S.A.  
Chris Lee, P.Eng., A.P.C.S.A.

Project Manager W. Woodcock	Drawn SD
Project Leader F. Aris	Checked RD

Client  
**Jayman Living**

Project  
**Nostalgia TOWNLET**

**TOWNLET - SITE 3**

Drawing Title  
**BUILDING ELEVATIONS**

Scale  
As indicated

Project No.  
RZ1124-0046

Drawing No.  
**DP-30-01**



**2 SOUTH ELEVATION**  
SCALE: 1:150

- P5 MATERIAL: GLASS  
COLOR: CLEAR
- S7 MATERIAL: STUCCO  
COLOR: WARM GRAY - RGB (228,222,218)
- S8 MATERIAL: STUCCO  
COLOR: LIGHT GRAY - RGB (204,204,204)
- P10 MATERIAL:  
COLOR:  
LOCATION: Entrance Logo
- B13 MATERIAL: STONE  
COLOR: ALBERTA SANDSTONE Random Rubble Installation
- B14 MATERIAL: BRICK  
COLOR: PEWTER
- B15 MATERIAL: BRICK  
COLOR: OXYA IRONSPOT SMOOTH
- C16 MATERIAL: CONCRETE  
COLOR: GREY - RGB (161,148,142)
- S17 MATERIAL: STUCCO  
COLOR: WARM GRAY - RGB (182,178,173)
- B18 MATERIAL: BRICK  
COLOR: DOVE TAIL
- B19 MATERIAL: BRICK  
COLOR: OBSIDIAN
- B20 MATERIAL: BRICK  
COLOR: OXYA IRONSPOT SMOOTH



**1 WEST ELEVATION**  
SCALE: 1:150

**AMENDED DRAWINGS**  
DP No Date Received  
DP2026-01975 2026-04-22  
**THESE DRAWINGS REFER TO THE ABOVE DEVELOPMENT PERMIT NO.**



1 NORTH ELEVATION  
DP-30-02  
SCALE: 1:150

### MATERIAL LEGEND

- A1 MATERIAL: GLASS  
COLOR: CLEAR  
LOCATION: Window Panels
- A2 MATERIAL: GLASS  
COLOR: CLEAR  
LOCATION: Door Frames
- A3 MATERIAL: SPANDREL  
COLOR: LIGHT BLUE - RGB (138,165,192)  
COLOR: WHITE
- A4 MATERIAL: " " TRIM  
COLOR: WHITE  
LOCATION: DOORS & WINDOWS
- A5 MATERIAL: METAL  
COLOR: BLACK - RGB (0,0,0)  
LOCATION: Window Frame
- A6 MATERIAL: " DOOR FRAME  
COLOR: BLACK
- A7 "NOT IN USE (SITE 1)
- A8 "NOT IN USE (SITE 1)
- A9 MATERIAL: PREFINISHED METAL CORNICE  
COLOR: DARK BLACK - RGB (0,0,0)
- A10 MATERIAL: SOLAR PANELS
- A11 MATERIAL: STANDING SEAM METAL ROOFING  
COLOR: BLACK - RGB (0,0,0)  
LOCATION: Roof
- A12 MATERIAL: PREFINISHED ALUMINUM  
COLOR: OFF WHITE - RGB (230,230,230)  
LOCATION: Balcony Railing
- A13 MATERIAL: PREFINISHED ALUMINUM  
COLOR: DARK BLACK - RGB (0,0,0)  
LOCATION: Balcony Railing
- P1 "NOT IN USE (SITE 1)
- P2 "NOT IN USE (SITE 1)
- P3 "NOT IN USE (SITE 1)
- P4 MATERIAL: PANELLING  
COLOR: DARK BLACK - RGB (0,0,0)
- P5 "NOT IN USE (SITE 1)
- P6 "NOT IN USE (SITE 1)
- P7 MATERIAL: PANELLING  
COLOR: LIGHT GRAY - RGB (176,176,176)
- S1 MATERIAL: STUCCO  
COLOR: LIGHT GRAY-RGB (204,204,204)
- S2 MATERIAL: STUCCO  
COLOR: WARM GRAY-RGB (228, 222, 218)
- S3 MATERIAL: STUCCO  
COLOR: WARM GRAY - RGB (182,176,173)
- B1 "NOT IN USE (SITE 1)
- B2 "NOT IN USE (SITE 1)
- B3 "NOT IN USE (SITE 1)
- B4 "NOT IN USE (SITE 1)
- B5 MATERIAL: STONE  
COLOR: ALBERTA SANDSTONE Random Rubble Installation
- B6 MATERIAL: BRICK  
COLOR: PEWTER
- B7 MATERIAL: BRICK  
COLOR: OYYS RAINSPOT SMOOTH
- C1 MATERIAL: CONCRETE  
COLOR: GREY - RGB (151,148,142)
- 22 EMERGENCY SCUPPER
- 23 MATERIAL:  
COLOR:  
LOCATION: Entrance Logo

NORR to any party with whom NORR has not entered into a contract.

This drawing shall not be used for construction purposes until the seal appearing hereon is signed and dated by the Architect or Engineer.

Project Component  
**DESIGN DEVELOPMENT**

Key Plan

Consultants

- Architecture: NORR
- Structural: ENTUITIVE
- Mechanical: SMITH + ANDERSEN
- Electrical: SMITH + ANDERSEN
- Interiors: TBC
- Landscape: EIGHT ONE EIGHT
- Survey: URBAN SYSTEMS
- Civil: URBAN SYSTEMS

Seal(s)

JOINT FIRM  
NORR Architects Engineers Planners  
SMITH + ANDERSEN ARCHITECTS  
THE ALBERTA ASSOCIATION OF ARCHITECTS  
Certificate No. 82718504

**NORR**

2300, 411 - 1st Street SE  
Calgary, AB, Canada T2G 4Y5  
norr.com

NORR Architects Engineers Planners  
A Partnership of Corporations

Jonathan Hughes, Architect, A.A.A. O.A.A. A.S.C. A.S.P.A. A.A.S.P. A.A.P.E.  
Adam Young, P.Eng., P.F.C.S.  
Chris Lee, P.Eng., A.P.E.C.A.

Project Manager	Drawn
W.Woodcock	SD
Project Leader	Checked
F.Aris	RD

Client

Project

TOWNLET - SITE 3

Drawing Title

**BUILDING ELEVATIONS**

Scale

As indicated

Project No.

RZ1124-0046

Drawing No.

**DP-30-02**

**AMENDED DRAWINGS**

DP No Date Received  
DP2026-01975 2026-04-22

**THESE DRAWINGS REFER TO THE ABOVE DEVELOPMENT PERMIT NO.**

- P5 MATERIAL: GLASS  
COLOR: CLEAR
- S7 MATERIAL: STUCCO  
COLOR: WARM GRAY - RGB (228,222,218)
- S8 MATERIAL: STUCCO  
COLOR: LIGHT GRAY - RGB (204,204,204)
- P10 MATERIAL:  
COLOR:  
LOCATION: Entrance Logo
- B13 MATERIAL: STONE  
COLOR: ALBERTA SANDSTONE Random Rubble Installation
- B14 MATERIAL: BRICK  
COLOR: PEWTER
- B15 MATERIAL: BRICK  
COLOR: OYYS RAINSPOT SMOOTH
- C16 MATERIAL: CONCRETE  
COLOR: GREY - RGB (151,148,142)
- S17 MATERIAL: STUCCO  
COLOR: WARM GRAY - RGB (182,176,173)
- B18 MATERIAL: BRICK  
COLOR: DOVE TAIL
- B19 MATERIAL: BRICK  
COLOR: OBSIDIAN
- B20 MATERIAL: BRICK  
COLOR: OYYS RAINSPOT SMOOTH



2 EAST ELEVATION  
DP-30-02  
SCALE: 1:150