

1 landscape plan: phase 2 residential  
1:200

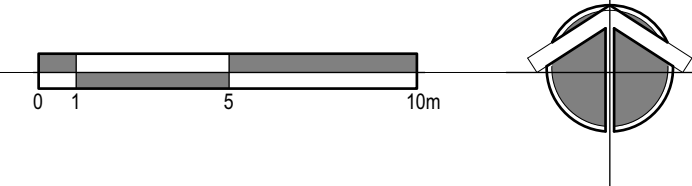

**trees**

	<b>bur oak</b> <i>Quercus macrocarpa</i> Qty: 1	75mm caliper balled and burlapped
	<b>columnar colorado spruce</b> <i>Picea pungens 'Fastigiata'</i> Qty: 16	3m height balled and burlapped
	<b>midnight schubert chokecherry</b> <i>Prunus virginiana 'Midnight Schubert'</i> Qty: 6	50mm caliper balled and burlapped
	<b>trembling aspen</b> <i>Populus tremuloides</i> Qty: 18	75mm caliper balled and burlapped
	<b>thunderchild flowering crabapple</b> <i>Malus 'Thunderchild'</i> Qty: 7	50mm caliper balled and burlapped
	<b>paper birch</b> <i>Betula papyrifera</i> Qty: 5	50 mm caliper balled and burlapped

**shrubs**

	<b>andorra juniper</b> <i>Juniperus horizontalis 'Plumosa Compacta'</i> Qty: 16	#5 container 600 mm min height + spread
	<b>red osier dogwood</b> <i>Cornus sericea</i> Qty: 15	#5 container 600mm min height + spread
	<b>red osier dogwood</b> <i>Cornus sericea</i> Qty: 4	#5 container 600mm min height + spread
	<b>juniper</b> <i>Juniperus horizontalis</i> Qty: 24	#5 container 600mm min height + spread
	<b>ilac</b> <i>Syringa 'Josee'</i> Qty: 6	#5 container 600mm min height + spread
	<b>nannyberry</b> <i>Viburnum lentago</i> Qty: 9	#5 container 600mm min height + spread
	<b>wood's rose</b> <i>Rosa woodsii</i> Qty: 25	#5 container 600 mm min height + spread
	<b>snowbelle mock orange</b> <i>Philadelphus x 'Snowbelle'</i> Qty: 30	#5 container 600mm min height + spread

**site legend**

	decorative concrete paving		Turfgrass Water Conservation Alliance certified drought tolerant sod
	concrete unit paver		City of Calgary Colourful Mesic Grassland seed mix
	plain grey concrete paving		perennial plantings
	berm (+/- 1-2 m height)		



**perennials**

	<b>Perennial Flax</b> <i>Linum perenne 'Saphyr'</i> Qty: 49	#2 container
	<b>blue oat grass</b> <i>Helictotrichon sempervirens</i> Qty: 11	#2 container
	<b>Walker's Low Catmint</b> <i>Nepeta x faassenii 'Walker's Low'</i> Qty: 73	#2 container
	<b>karl foerster grass</b> <i>Calamagrostis acutiflora</i> Qty: 69	#2 container
	<b>prairie sky switch grass</b> <i>Panicum virgatum 'Prairie'</i> Qty: 33	#2 container

**site furniture**

	pergola structure
	bike racks
	bench
	picnic table with seating

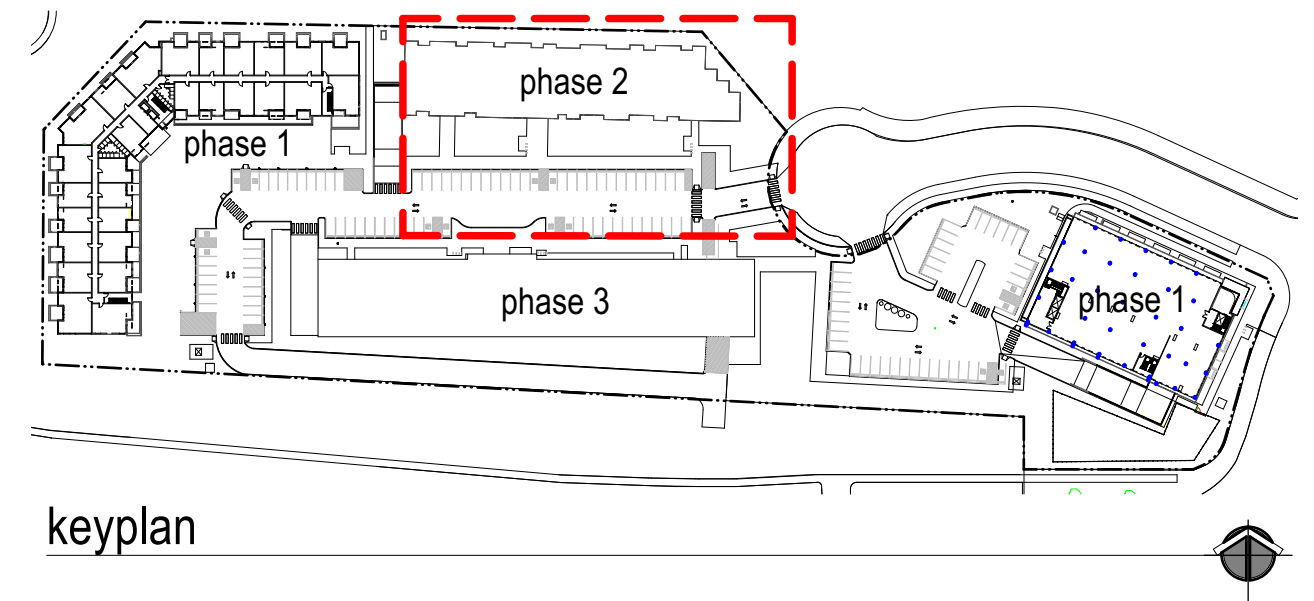

**land use bylaw landscape requirements**

City Of Calgary Zoning	M-H1		
landscape area	required	provided	
<b>total parcel area</b>	<b>3,947.05 m2</b>	<b>m2</b>	
landscape area required for M-H1 zoning (40% of parcel area)	1,578.82 m2	<b>2088.26 m2</b>	
Item 556 low water landscaping reduction -3%			
landscape provided - ground level:	2,088.26	m2	
landscape provided - first floor terrace:	0.00	m2	
landscape provided - ground level and first floor terrace combined:	2,088.26	m2	
landscape area provided at grade (percentage of total parcel area):	100	%	
landscape provided - fourth floor terrace:	0.00	m2	
<b>total landscape area provided</b>	<b>2088.26 m2</b>		
total landscape area provided (percentage of total parcel area):	53	%	
hard surfaced landscape area (maximum of 40% of provided landscape area)	835.30 m2	465.81 m2	
hard surfaced landscape area provided (percentage of landscape area provided)		22	%
soil area as per item 556 (maximum of 30% of provided landscape area)	626.48 m2	294.30 m2	
<b>total number of trees (ground level and first floor terrace only)</b>	<b>required</b>	<b>provided</b>	
(145 m2 of provided landscape area as per option 555)			
number of existing trees on site:	0		
number of new trees required:	46	53	
low water trees required as per item 556 (30% minimum of trees provided)	16	7	
<b>deciduous trees (ground level and first floor terrace only)</b>	<b>required</b>	<b>provided</b>	
large trees as per item 552 (50% min 75mm cal)	18	19	
medium trees as per item 552 (50% min 50mm cal)	18	17	
total deciduous trees	36		
<b>coniferous trees (ground level and first floor terrace only)</b>	<b>required</b>	<b>provided</b>	
large trees as per item 552 (50% 3.0m ht min)	7	16	
medium trees as per item 552 (50% 2.0m ht min)	7		
total coniferous trees	13	16	
<b>shrubs (ground level and first floor terrace only)</b>	<b>required</b>	<b>provided</b>	
(2/45 m2 of required landscape area as per item 552) (min 600mm height and spread)	93	129	
low water shrubs required as per item 556 (30% minimum of shrubs provided)	28	55	

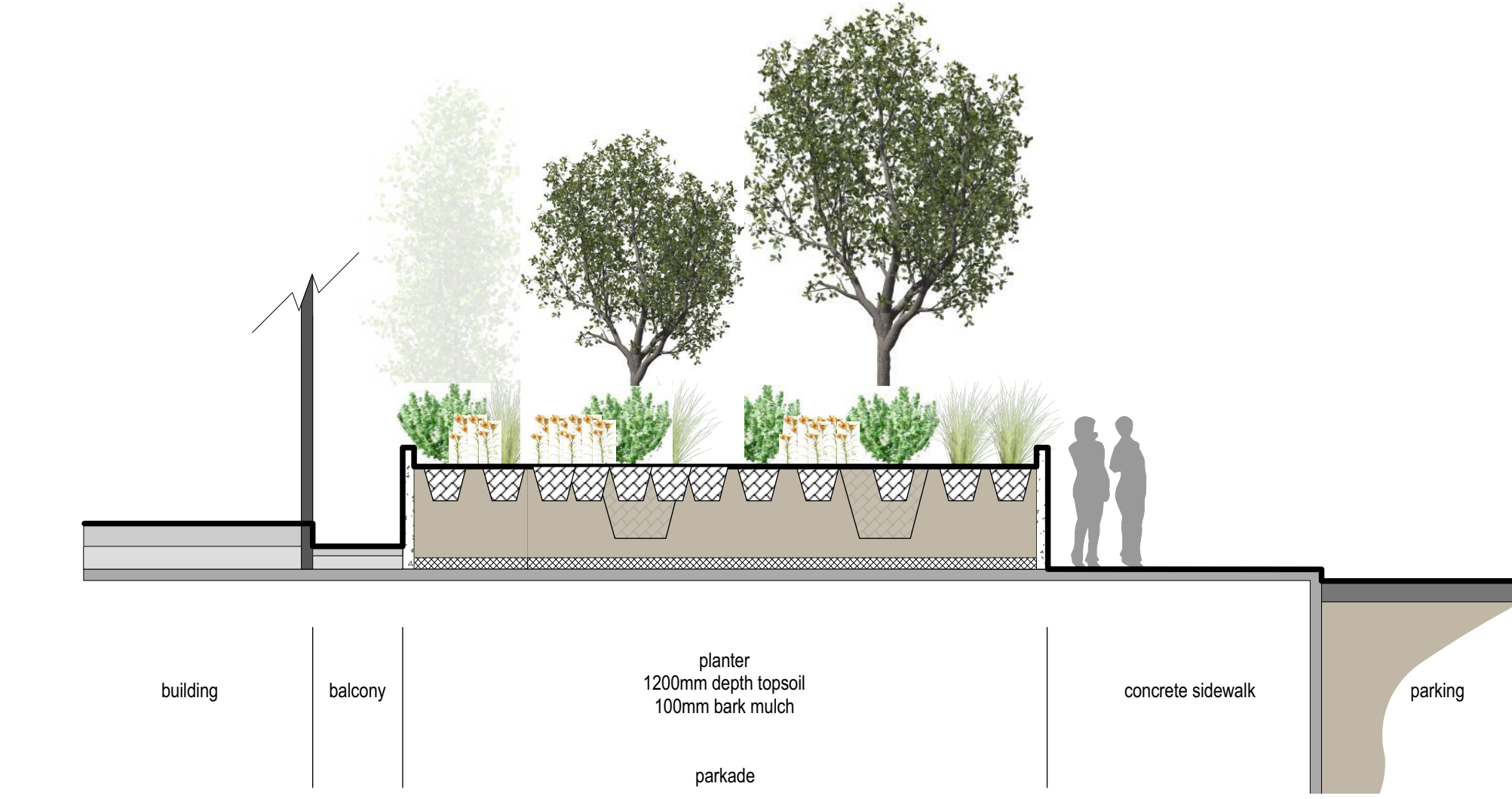

2 front garden schematic section  
1:75

**NOT FOR CONSTRUCTION**  
for review and coordination only

- notes**
- This drawing is copyright © 818 studio ltd., and shall not be reproduced, revised, transmitted and / or utilized by any third party outside of the Owner without written permission from 818 studio ltd.
  - Do not scale drawings.
  - Refer to Civil drawings for all grading information.
  - All walkways are plain concrete unless noted otherwise.
  - All landscape areas to be watered with an automatic underground irrigation system. Contractor to ensure irrigation meter is installed and properly operating prior to charging and running the irrigation system.
  - All planting beds and tree wells to be mulched with bark chip mulch, to 100 mm depth. Contractor to ensure planting beds extend to drip line of outermost plant materials in planting bed.

**EIGHT ONE EIGHT STUDIO**  
PLANNING + DESIGN COLLABORATIVE

number	revision	date	by	approved
2	development permit			2025-07-28
1	90% review			2025-07-22
	issued for			date (y.m.d)

project  
**wentworth landing**  
phase 2  
8888 12th avenue sw, calgary, alberta

drawing  
landscape plan

drawn	approved
checked	project number
date	sheet
scale	as noted

04120.1  
**DPL2**



ARTIST RENDERING - FOR REFERENCE ONLY.

# NORR TRICO - WENTWORTH LANDING - PHASE 2 RESIDENTIAL

1127 85 ST SW and 8888 BOW TR SW, CALGARY, AB

2300, 411 – 1st Street SE  
 Calgary, AB, Canada T2G 4Y5  
 norr.com

NORR Architects Engineers Planners  
 A Partnership of Corporations  
Poon Mokwae Architects (Alberta) Inc. Poon Mokwae Holdings Inc.

Jonathan Hughes, Architect, A.A.A., O.A.A., A.I.B.C., M.A.A., A.A.N.B., A.A.P.E.  
 Adrian Todella, P.Eng., A.P.E.G.A.  
 Chris Pal, P.Eng., A.P.E.G.A.

DEVELOPMENT PERMIT: DEVELOPMENT PERMIT NO.  
 NORR PROJECT NUMBER: RZ1124-0021-00  
 CLIENT PROJECT NUMBER: CLIENT PROJECT NUMBER



**ISSUE FOR DP - JULY 28, 2025**

<b>SURVEY</b>	<b>CIVIL</b>	<b>ARCHITECTURE</b>	<b>STRUCTURAL</b>
T.B.D ADDRESS CITY, PROVINCE, POSTAL CODE PHONE NUMBER	<b>RICHVIEW ENGINEERING</b> 203 38th Ave NE SUITE 201 CALGARY, AB, T2E 2M3 +1 403-230-3218	<b>NORR ARCHITECTS &amp; PLANNERS</b> 411 - 1st STREET SE CALGARY, AB, T2G 4Y5 +1 403-264-4000	<b>GLOTMAN-SIMPSON</b> 1661 5TH Ave W VANCOUVER, BC, V6J 1N5 +1 604-734-8822
<b>MECHANICAL</b>	<b>ELECTRICAL</b>	<b>INTERIORS</b>	<b>LANDSCAPE</b>
		T.B.D ADDRESS CITY, PROVINCE, POSTAL CODE PHONE NUMBER	<b>818 STUDIO</b> 1812 14A St SW CALGARY, AB, T2T 3W6 +1 403-244-8188









This drawing has been prepared solely for the use of TRICO HOMES and there are no representations of any kind made by NORR ARCHITECTS & PLANNERS to any party with whom NORR ARCHITECTS & PLANNERS has not entered into a contract.

This drawing shall not be used for construction purposes until the seal appearing hereon is signed and dated by the Architect or Engineer.

Project Component

Key Plan

Consultants  
Survey: T.B.D  
Civil: RICHVIEW ENGINEERING  
Architecture: NORR ARCHITECTS & PLANNERS  
Structural: GLOTMAN-SIMPSON  
Mechanical:  
Electrical:  
Interiors: T.B.D  
Landscape: 616 STUDIO

Seal(s)



JOINT FIRM  
NORR Architects Engineers Planners  
Registered by  
THE ALBERTA ASSOCIATION OF ARCHITECTS  
Certificate No. A6333364

**NORR**  
2300, 411 - 1st Street SE  
Calgary, AB, Canada T2G 4Y5  
nor.com  
NORR Architects Engineers Planners  
A Partnership of Corporations  
Jonathan Hughes, Architect, A.A.A., C.M.A., A.B.C., M.A.A., A.A.S., A.A.P.E.  
Amar, Yashraj, P.Eng., P.F.C.S.,  
Chris Park, P.Eng., A.P.E.C.A.

Project Manager: DMH  
Project Leader: EF  
Client: TRICO HOMES  
Drawn: Author  
Checked: Checker

Project: TRICO - WENTWORTH LANDING - PHASE 2 RESIDENTIAL  
1127 85 ST SW and 8888 BOW TR SW, CALGARY, AB  
Drawing Title: RENDERS

Scale:  
Project No.: RZ1124-0021-00  
Drawing No.: DP-A10-09 BLDG2

PRELIMINARY - NOT FOR CONSTRUCTION

