

SITE LEGEND

- XX FIRE ACCESS ROUTE - HEAVY DUTY ASPHALT (CAPABLE OF SUPPORTING MIN. 30,000kg (85,000lb) LOAD & NFPA 1901 POINT LOAD OF 517kPa OVER 24x24 AREA)
- UTILITY RIGHT-OF-WAY - REFER TO CIVIL
- LANDSCAPING - REFER TO LANDSCAPE DRAWINGS
- RAISED PLANTER BEDS - REFER TO LANDSCAPE DRAWINGS
- CONCRETE (SIDEWALK / CURB / WALKWAY / PAVERS) - REFER TO LANDSCAPE DRAWINGS
- HEATED CONCRETE RAMP DOWN TO PARKING OR TROWELED HERRINGBONE FINISH
- ASPHALT
- 6" C.I.P. CONCRETE RAISED PLANTER WALLS / CURBS - REFER TO LANDSCAPE DRAWINGS
- LOADING ZONE - ASPHALT WITH CAPACITY TO CARRY THE WEIGHT OF A LOADING TRUCK OF 55,000 lbs (25,000 kg) (SYMBOL PAINTED ON CONCRETE)
- PRINCIPLE ENTRY - WITHIN 15m OF FIRE ACCESS ROUTE ($45m$ RADIUS FROM FIRE HYDRANT)
- BARRIER-FREE RAMP
- PROPOSED BARRIER-FREE PARKING - SYMBOL PAINTED ON ASPHALT
- BIKE RACK - REFER TO LANDSCAPE DRAWINGS
- 1.5m WIDE PAINTED CROSSWALK
- VISITOR FREE PARKING SIGN (INSTALLED AT ALL RELEVANT LOCATIONS)
- PARKING SIGN (INSTALL SIGNAGE AT ALL RELEVANT LOCATIONS)
- 'STOP' SIGN, 'LOADING ZONE, NO PARKING' SIGN, 'LOADING' SIGN
- PROPOSED TRANSFORMER AND CONCRETE PAD - REFER TO ELECTRICAL
- FIRE HYDRANT - PROPOSED / EXISTING LOCATION - REFER TO CIVIL
- DIRECTION OF TRAVEL
- LIMIT OF CONSTRUCTION DISTURBANCE
- WATER METER, ELECTRIC METER, GAS METER LOCATIONS - REFER TO CIVIL
- MANHOLE / CATCH BASIN / AREA DRAIN - REFER TO CIVIL
- SITE ELECTRICAL MAY REQUIRE CONCRETE BASE - REFER TO ELECTRICAL
- ELECTRIC VEHICLE (EV) CHARGING STATION - REFER TO ELECTRICAL
- FIRE TRUCK PATH AND FIRE DEPT. ACCESS - TURNING RADIUS AS INDICATED
- PROPERTY LINE - DELINEATES SCOPE OF WORK
- EXTENTS OF PARKADE WALLS BELOW GRADE
- PROPOSED / EXISTING WATER LINE - REFER TO CIVIL
- PROPOSED / EXISTING STORM LINE - REFER TO CIVIL
- PROPOSED / EXISTING SANITARY LINE - REFER TO CIVIL
- PROPOSED / EXISTING ELECTRICAL (OH OR UG) - REFER TO CIVIL
- UTILITY RIGHT OF WAY (UROW) - REFER TO CIVIL
- EXISTING / OFFSITE - REFER TO CIVIL / SURVEY
- LINE OF EAVES AT ROOF OVERHANGS
- LINE OF RETAINING WALL
- LINE OF ACCESS ROAD CURB
- LINE OF THE SAFETY GUARDRAIL ALONG ACCESS ROAD

SITE GENERAL NOTES

1. ALL BUILT ELEMENTS WITHIN PROPERTY LINE ARE PROPOSED UNLESS NOTED OTHERWISE
2. WHEEL STALLS TO BE 100mm HIGH AND PLACED 600mm FROM FRONT OF PARKING STALL (TYP)
3. NO PARKING STALLS SHOULD EXCEED 4% SLOPE IN ANY DIRECTION
4. NO PARKING ANYTIME / FIRE LANE SIGNAGE TO BE POSTED ON INTERNAL ROADWAY ON SITE
5. LANDSCAPE SHOWN FOR REFERENCE ONLY - REFER TO LANDSCAPE DRAWINGS FOR ADDITIONAL DETAILS
6. SITE SIGNAGE DETAILS SHOWN IN LANDSCAPE DRAWINGS
7. FOR PROPOSED SITE LIGHTING - REFER TO ELECTRICAL DRAWINGS
8. SITE SERVICES, PEDESTALS, CONDUITS, UTILITY RIGHT OF WAY AND GRADES SHOWN FOR REFERENCE ONLY - REFER TO CIVIL DRAWINGS FOR ADDITIONAL DETAILS
9. ALL BUILDING AREAS AND COVERAGE CALCULATIONS ARE APPROXIMATE AND SHOULD BE CONFIRMED BY A LAND SURVEYOR REGISTERED IN THE JURISDICTION OF THE PROJECT
10. REFER TO BICYCLE STORAGE SITE DETAIL FOR ADDITIONAL INFORMATION
11. PROPOSED LOCATION FOR FIRE DEPARTMENT CONNECTION (P.D.C.) IS 3m, 3m AND 15m FROM PRINCIPAL ENTRANCE OF ALL BUILDINGS. INSTALL ON EXTERIOR WALL OF EACH BUILDING IN LOCATION INDICATED
12. ARROWS SHOWN ON ASPHALT INDICATE DIRECTION OF TRAVEL
13. IRRIGATION SYSTEM TO BE SUPPLIED AND INSTALLED BY OWNERS CONTRACTOR. SEPARATE METERS WILL BE LOCATED AS PER DESIGN IF REQUIRED
14. CAST IN PLACE EXTERIOR CONCRETE RISERS IN WALKWAYS TO BE COMPLETED BY SITE CONTRACTOR. RISERS SHOWN ARE ESTIMATED BASED ON GRADES. ALL RISER COUNTS AND LOCATIONS TO BE CONFIRMED. REFER TO CIVIL
15. PROPOSED LOCATIONS FOR FIRE ALARM CONTROL PANEL AND LOCKBOX INDICATED
16. UNLESS OTHERWISE SPECIFIED, ALL SURFACE PARKING TO BE DESIGNATED AS VISITOR PARKING
17. REFER TO LANDSCAPE PLANS FOR FINISHES AND MATERIALS SPECIFIED FOR ALL SIDEWALKS AND WALKWAYS
18. INSTALL REGULAR ASPHALT AT PARKING STALL LOCATIONS. HEAVY DUTY ASPHALT WHERE INDICATED
19. AN URBAN FORESTRY TECHNICIAN MUST BE ON SITE DURING EXCAVATION OF ALL PROPOSED SERVICES TO MITIGATE ANY DAMAGE TO EXISTING ADJACENT PUBLIC TREES. CONTACT URBAN FORESTRY BY PHONING 311 AT LEAST 3 BUSINESS DAYS IN ADVANCE OF EXCAVATION. IF CANOPES OR ROOT SYSTEMS ARE DAMAGED TO THE POINT WHERE THE TREE BECOMES UNSTABLE, THEN URBAN FORESTRY WILL REQUIRE THEIR REMOVAL USING AN APPROVED IDENTIFIED TREE CONTRACTOR AT APPLICANTS EXPENSE. PLUS COMPENSATION FOR THE REMOVED TREES
20. REFER TO CIVIL DRAWINGS FOR LOCATIONS AND SIZING OF TRANSIT ZONES AND TRANSIT PADS.



2 DP SITE CONTEXT MAP - SATELLITE VIEW
DP-A10-02 SCALE: 1:1

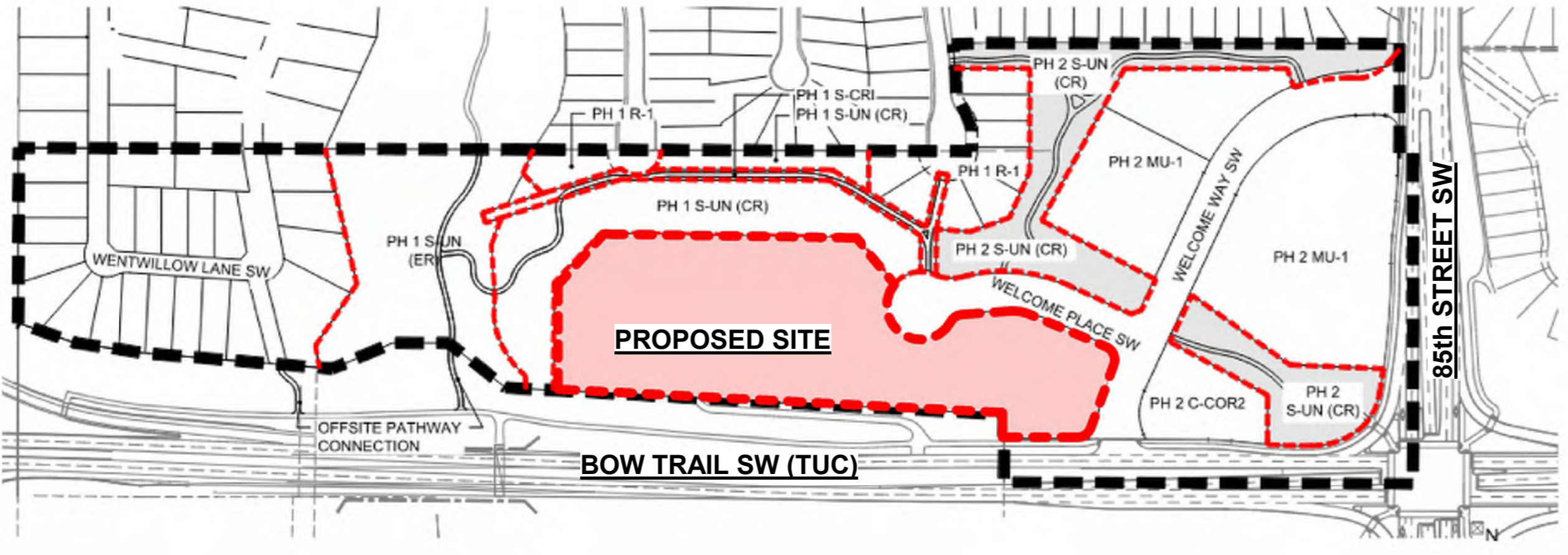

3 DP LANDUSE BYLAW
DP-A10-02 SCALE: 1:1

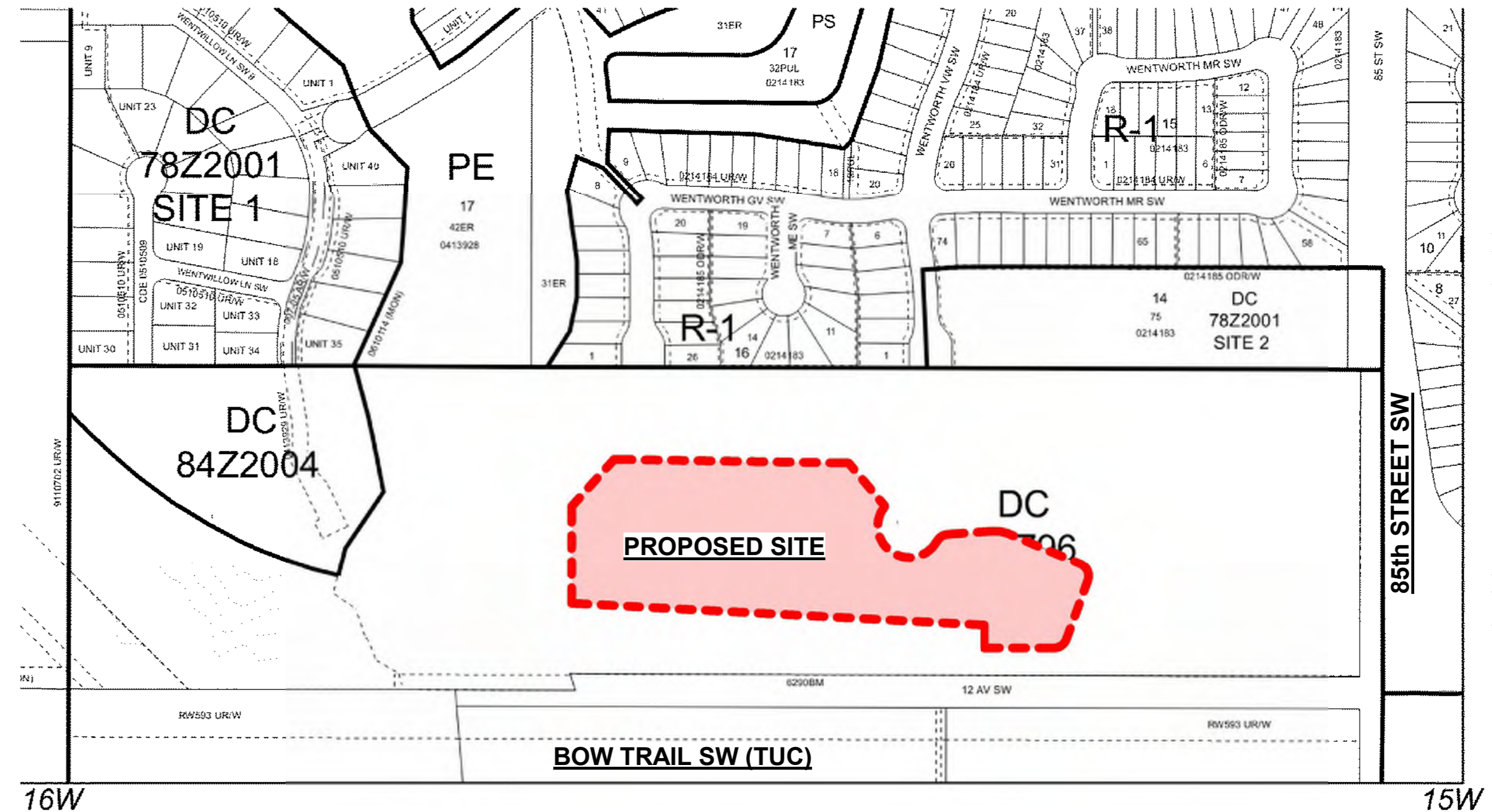

4 DP LANDUSE BYLAW KEY PLAN
DP-A10-02 SCALE: 1:1

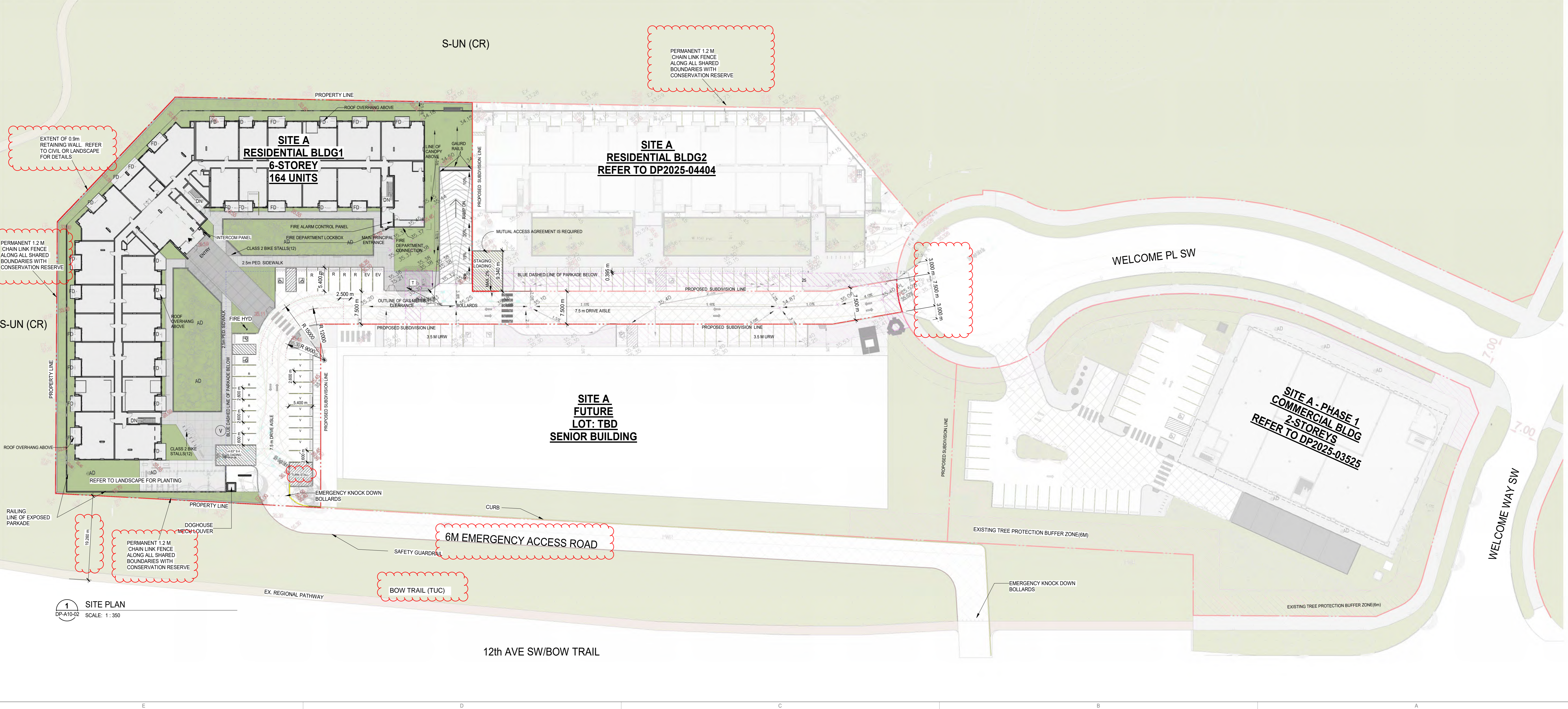

1 SITE PLAN
DP-A10-02 SCALE: 1:350

DATE	ISSUED FOR	REV
2025/05/28	DP Submission	1
2025/10/15	DR1 reply	2

AMENDED DRAWINGS
 DP No: DP2025-03290
 Date Received: DEC 19 2025
 THESE DRAWINGS REFER TO THE ABOVE DEVELOPMENT PERMIT NO.

This drawing has been prepared solely for the use of TRICO HOMES and there are no representations of any kind made by NORR ARCHITECTS & PLANNERS to any party with whom NORR ARCHITECTS & PLANNERS has not entered into a contract.
 This drawing shall not be used for construction purposes until the seal appearing hereon is signed and dated by the Architect or Engineer.

Project Component	Key Plan
Consultants	Survey: T.B.D. Civil: RICHVIEW ENGINEERING Architecture: NORR ARCHITECTS & PLANNERS Structural: GLOTMAN-SIMPSON Mechanical: Electrical: T.B.D. Interiors: T.B.D. Landscape: 616 STUDIO

NORR
 2300, 411 - 1st Street SE
 Calgary, AB, Canada T2G 4Y5
 norr.com
 NORR Architects Engineers Planners
 A Partnership of Corporations
 Jonathan Hughes, Architect, AIA, CMAA, CBC, CM, CMAT, AIAA, AIAPE
 Adam Yonke, P.Eng., P.Eng. (PECA)
 Chris Hill, P.Eng., PECA

Project Manager	Drawn
DP	AAAD
Project Leader	Checked
EF	DH/EF
Client	TRICO HOMES

Project: **TRICO - WENTWORTH LANDING - PHASE 1 RESIDENTIAL**
 1127 85 ST SW and 8888 BOW TR SW, CALGARY, AB
 Drawing Title: **OVERALL SITE PLAN**

Scale	As indicated
Project No.	RZ1124-0021-00
Drawing No.	DP-A10-02

PRELIMINARY - NOT FOR CONSTRUCTION



NOTE: ARTIST RENDERING FOR REFERENCE ONLY



NOTE: ARTIST RENDERING FOR REFERENCE ONLY



NOTE: ARTIST RENDERING FOR REFERENCE ONLY



NOTE: ARTIST RENDERING FOR REFERENCE ONLY

DATE	ISSUED FOR	REV
2025/05/28	DP Submission	1
2025/10/15	DR1 reply	2

AMENDED DRAWINGS
 DP No. Date Received
 DP2025-03290 DEC 19 2025
 THESE DRAWINGS REFER TO THE ABOVE DEVELOPMENT PERMIT NO.

This drawing has been prepared solely for the use of TRICO HOMES and there are no representations of any kind made by NORR ARCHITECTS & PLANNERS to any party with whom NORR ARCHITECTS & PLANNERS has not entered into a contract.

This drawing shall not be used for construction purposes until the seal appearing hereon is signed and dated by the Architect or Engineer

Project Component

Key Plan

Consultants
 Survey: T.B.D
 Civil: RICHVIEW ENGINEERING
 Architecture: NORR ARCHITECTS & PLANNERS
 Structural: GLOTMAN-SIMPSON
 Mechanical:
 Electrical:
 Interiors: T.B.D
 Landscape: 616 STUDIO

Seal(s)

NORR
 2300, 411 - 1st Street SE
 Calgary, AB, Canada T2G 4Y5
 norr.com
 NORR Architects Engineers Planners
 A Partnership of Corporations
 Jonathan Hughes, Architect, AIA, OAA, ABCI, NAA, AAAS, AIAPE
 Adam Young, P.Eng., OFSQA
 Chris Lee, P.Eng., APECA

Project Manager	Drawn
DH	AL
Project Leader	Checked
EF	DHEF

Client
TRICO HOMES

Project
TRICO - WENTWORTH LANDING - PHASE 1 RESIDENTIAL
 1127 85 ST SW and 8888 BOW TR SW, CALGARY, AB
 Drawing Title
RENDERS

Scale
 Project No. RZ1124-0021-00
 Drawing No. **DP-A10-07**

PRELIMINARY - NOT FOR CONSTRUCTION



1 WEST ELEVATION
SCALE: 1:150



2 NORTH WEST ELEVATION
SCALE: 1:150

MATERIALS BOARD			MATERIALS LEGEND	
	MATERIAL: BRICK MASONRY MANUFACTURER: T.B.D. COLOR: DARK BROWN		MATERIAL: FIBRECEMENT (FLUSH) MANUFACTURER: T.B.D. COLOR: POWDER BLACK	01 MATERIAL: HARDFEEL PANEL SIDING MANUFACTURER: JAMES HARDE COLOR: ARCTIC WHITE
	MATERIAL: HARDFEEL PANEL MANUFACTURER: T.B.D. COLOR: ARCTIC WHITE		MATERIAL: SOFFIT ALUMINUM TRIM MANUFACTURER: T.B.D. COLOR: WOOD GRAIN	02 MATERIAL: BRICK MASONRY MANUFACTURER: T.B.D. COLOR: DARK BROWN
			MATERIAL: HARDFEEL PANEL SIDING MANUFACTURER: JAMES HARDE COLOR: SIERRA	03 MATERIAL: HARDFEEL PANEL SIDING MANUFACTURER: JAMES HARDE COLOR: SIERRA RICH ESPRESSO
			MATERIAL: HARDFEEL PANEL SIDING MANUFACTURER: JAMES HARDE COLOR: SIERRA RICH ESPRESSO	04 MATERIAL: HARDFEEL PANEL SIDING MANUFACTURER: T.B.D. COLOR: SIERRA GRAY
			MATERIAL: HARDFEEL PANEL SIDING MANUFACTURER: T.B.D. COLOR: SIERRA GRAY	05 MATERIAL: METAL CLAD PVC WINDOW WITH TRIM MANUFACTURER: T.B.D. COLOR: BLACK
			MATERIAL: HARDFEEL PANEL SIDING MANUFACTURER: JAMES HARDE COLOR: ARCTIC WHITE	06 MATERIAL: METAL CLAD PVC WINDOW WITH TRIM MANUFACTURER: T.B.D. COLOR: WHITE
			MATERIAL: SOFFIT ALUMINUM TRIM MANUFACTURER: T.B.D. COLOR: WOOD GRAIN	07 MATERIAL: BALCONY GUARDRAIL GLASS SYSTEM MANUFACTURER: T.B.D. COLOR: BLACK HARDWARE, FROSTED GLASS
			MATERIAL: SOFFIT ALUMINUM TRIM MANUFACTURER: T.B.D. COLOR: WOOD GRAIN	08 MATERIAL: ALUMINUM SOFFIT MANUFACTURER: T.B.D. COLOR: WOOD GRAIN
			MATERIAL: SOFFIT ALUMINUM TRIM MANUFACTURER: T.B.D. COLOR: WOOD GRAIN	09 MATERIAL: ALUMINUM FASCIA MANUFACTURER: T.B.D. COLOR: WOOD GRAIN
			MATERIAL: SOFFIT ALUMINUM TRIM MANUFACTURER: T.B.D. COLOR: WOOD GRAIN	10 MATERIAL: METAL CLAD PVC SLIDING DOORS MANUFACTURER: T.B.D. COLOR: BLACK

MATERIALS LEGEND

- MATERIAL: HARDFEEL PANEL SIDING
MANUFACTURER: JAMES HARDE
COLOR: SMOOTH COBBLE STONE
- MATERIAL: BRICK MASONRY
MANUFACTURER: T.B.D.
COLOR: DL SMOKEHOUSE
- MATERIAL: HARDFEEL PANEL SIDING
MANUFACTURER: JAMES HARDE
COLOR: SMOOTH COUNTRY-LANE RED
- MATERIAL: HARDFEEL PANEL SIDING
MANUFACTURER: JAMES HARDE
COLOR: NEWBOLT SCOT
- MATERIAL: METAL CLAD PVC WINDOW WITH TRIM
MANUFACTURER: T.B.D.
COLOR: BLACK
- MATERIAL: METAL CLAD PVC WINDOW WITH TRIM
MANUFACTURER: T.B.D.
COLOR: WHITE
- MATERIAL: BALCONY GUARDRAIL GLASS SYSTEM
MANUFACTURER: T.B.D.
COLOR: BLACK HARDWARE, FROSTED GLASS
- MATERIAL: ALUMINUM SOFFIT
MANUFACTURER: T.B.D.
COLOR: WOOD GRAIN
- MATERIAL: ALUMINUM FASCIA
MANUFACTURER: T.B.D.
COLOR: B&H
- MATERIAL: METAL CLAD PVC SLIDING DOORS
MANUFACTURER: T.B.D.
COLOR: BLACK

DP MATERIAL LEGEND
SCALE: 1:1

DATE	ISSUED FOR	REV
2025/05/28	DP SUBMISSION	1
01		
02		

WALL FINISHES

AMENDED DRAWINGS
DP No: DP2025-03290
Date Received: DEC 19 2025
THESE DRAWINGS REFER TO THE ABOVE DEVELOPMENT PERMIT NO.

This drawing has been prepared solely for the use of TRICO HOMES and there are no representations of any kind made by NORR Architects Engineers Planners to any party with whom NORR Architects Engineers Planners has not entered into a contract.

This drawing shall not be used for construction purposes until the seal appearing hereon is signed and dated by the Architect or Engineer.

Project Component: CONSTRUCTION DOCUMENTATION
Key Plan

Consultants:
Survey: ARCADIS GEOMATICS (CANADA) INC.
Civil: RICHVIEW ENGINEERING
Architecture: NORR Architects Engineers Planners
Structural: GLOTMAN-SIMPSON
Mechanical:
Electrical:
Interiors:
Landscape: 818 STUDIO

Seal(s)

NORR
2300, 411 - 1st Street SE
Calgary, AB, Canada T2G 4Y5
nor.com
NORR Architects Engineers Planners
A Partnership of Corporations
Professional Engineers (P.Eng.)
Professional Architects (P.Arch.)
Professional Planners (P.Planner)

Project Manager	Drawn
D.H.C.	A.A.G.A.L.
Project Leader	Checked
R.ROY	D.H.E.F.

Client: **TRICO HOMES**

Project: **TRICO - WENTWORTH LANDING - PHASE 1**
1127 85 ST SW & 8888 BOW TR SW CALGARY, AB

Drawing Title: **OVERALL BUILDING ELEVATIONS**

Scale: As indicated

Project No: RZ1124-0021-00

Drawing No: **DP-A40-01**

100 All The Book - 2023 - Rev (Sept23) - Copyright © 2023

PRELIMINARY - NOT FOR CONSTRUCTION

17/10/2025 10:50:30 AM



1 NORTH ELEVATION
 DP-A40-02 SCALE: 1:150



2 EAST ELEVATION
 DP-A40-02 SCALE: 1:150



3 SOUTH ELEVATION
 DP-A40-02 SCALE: 1:150

MATERIALS BOARD	
	MATERIAL: BRICK MASONRY MANUFACTURER: T.B.D COLOR: DARK BROWN
	MATERIAL: FIBRECEMENT (FLUSH) MANUFACTURER: T.B.D COLOR: POWDER BLACK
	MATERIAL: HARDEPANEL SIDING MANUFACTURER: JAMES HARDE COLOR: SIERRA 6
	MATERIAL: HARDEPANEL MANUFACTURER: T.B.D COLOR: ARCTIC WHITE
	MATERIAL: SOFFIT ALUMINUM TRIM MANUFACTURER: T.B.D COLOR: WOOD GRAIN

MATERIALS LEGEND	
01 MATERIAL: HARDEPANEL SIDING MANUFACTURER: T.B.D COLOR: ARCTIC WHITE	07 MATERIAL: BALCONY GUARDRAIL GLASS SYSTEM MANUFACTURER: T.B.D COLOR: BLACK HARDWARE, FROSTED GLASS
02 MATERIAL: BRICK MASONRY MANUFACTURER: T.B.D COLOR: DARK BROWN	08 MATERIAL: ALUMINUM SOFFIT MANUFACTURER: T.B.D COLOR: WOOD GRAIN
03 MATERIAL: HARDEPANEL SIDING MANUFACTURER: JAMES HARDE COLOR: SIERRA RICH ESPRESSO	09 MATERIAL: ALUMINUM FASCIA MANUFACTURER: T.B.D COLOR: WOOD GRAIN
04 MATERIAL: HARDEPANEL SIDING MANUFACTURER: T.B.D COLOR: IRON GRAY	10 MATERIAL: METAL CLAD PVC SLIDING DOORS MANUFACTURER: T.B.D COLOR: BLACK
05 MATERIAL: METAL CLAD PVC WINDOW WITH TRIM MANUFACTURER: T.B.D COLOR: BLACK	
06 MATERIAL: METAL CLAD PVC WINDOW WITH TRIM MANUFACTURER: T.B.D COLOR: WHITE	

WALL FINISHES	
01	
02	

DATE	ISSUED FOR	REV
2025/05/28	DP SUBMISSION	1

AMENDED DRAWINGS
 DP No: DP2025-03290 Date Received: DEC 19 2025
 THESE DRAWINGS REFER TO THE ABOVE DEVELOPMENT PERMIT NO.

This drawing has been prepared solely for the use of TRICO HOMES and there are no representations of any kind made by NORR Architects Engineers Planners to any party with whom NORR Architects Engineers Planners has not entered into a contract.

This drawing shall not be used for construction purposes until the seal appearing hereon is signed and dated by the Architect or Engineer.

Project Component: CONSTRUCTION DOCUMENTATION
 Key Plan

Consultants:
 Survey: ARCADIS GEOMATICS (CANADA) INC.
 Civil: RICHVIEW ENGINEERING
 Architecture: NORR Architects Engineers Planners
 Structural: GLOTMAN-SIMPSON
 Mechanical:
 Electrical:
 Interiors:
 Landscape: 618 STUDIO

NORR
 2300, 411 - 1st Street SE
 Calgary, AB, Canada T2G 4Y5
 norr.com
 NORR Architects Engineers Planners
 A Partnership of Corporations
Not a licensed professional in the jurisdiction of Alberta
 Jonathan Hughes, Architect, A.A.A., O.A.A., A.S.C., A.S.E., A.S.P.A., A.S.P.E.
 Adam Yonke, P.Eng., O.P.E.C.
 Chris Lee, P.Eng., A.S.P.E.

Project Manager D.H.C.	Drawn A.A.Q.A.L.
Project Leader R.R.O.Y.	Checked D.H.E.F.

Client: **TRICO HOMES**

Project: **TRICO - WENTWORTH LANDING - PHASE 1**
 1127 85 ST SW & 8888 BOW TR SW CALGARY, AB

Drawing Title: **OVERALL BUILDING ELEVATIONS**

Scale: As indicated

Project No: RZ1124-0021-00

Drawing No: **DP-A40-02**

PRELIMINARY - NOT FOR CONSTRUCTION