

CLIENT

CONSULTANTS:

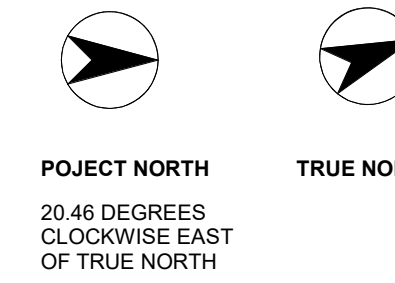

LEGEND - SITE PLAN

- CATCH BASIN SEE CIVIL
- ⊕ MANHOLE SEE CIVIL
- STREET LIGHTING
- SITE SERVICES LINES (SEE CIVIL)
- - - - - ROOF/ EAVES OVERHANG
- - - - - SETBACK LINE
- PROPERTY LINE
- ***** CHAINLINK FENCE
- o-o-o-o- DECORATIVE METAL FENCE
- ▒ SITE ASPHALT PAVING - LIGHT DUTY
- ▓ SITE ASPHALT PAVING - HEAVY DUTY
- ▒ CONCRETE SIDEWALK - BROOM FINISH
- ▒ CONCRETE PAVING / PAD - BROOM FINISHED
- ▒ SITE VEGETATION - SEE LANDSCAPE DRAWING
- ▒ SITE EARTH - SEE LANDSCAPE DRAWING
- ▒ SITE - GRAVEL
- ▒ SITE - BRICK OR STONE PAVEMENT (HARDSCAPED LANDSCAPE)
- ▒ TRAFFIC PAINTED LINES - 100 WIDE, TYPICAL OHSA YELLOW COLOUR
- ▒ PEDESTRIAN CROSSING TRAFFIC PAINTED LINES

SPECIAL NOTES FOR CITY OF CALGARY

- THE MUNICIPAL GOVERNMENT ACT PROHIBITS FOOD ESTABLISHMENT USES WITHIN THE LANDFILL SETBACK AREA UNLESS A VARIANCE IS RECEIVED. NO FOOD HANDLING IS TO BE ALLOWED IN THE GENERAL INDUSTRIAL. IN ADDITION, FOOD ESTABLISHMENT, HOSPITALS, SCHOOLS AND RESIDENCES ARE PROHIBITED IN THIS SITE.
- ALL SITE SIGNAGES TO BE BACKLIT OR NEON GLOW. THIS IS TO BE CONFIRMED THROUGH SIGNAGE DP APPLICATION.
- ALL SOFT SURFACED LANDSCAPED AREA MUST BE IRRIGATED BY AN UNDERGROUND IRRIGATION SYSTEM.
- STRUCTURAL TO ENSURE THAT THE FOOTING OF THE RETAINING WALL TO BE OUTSIDE OF THE 3.5M URW PLAN 191 1037.
- AREAS LABELLED "HARDSCAPE LANDSCAPING - BRICK PAVEMENT" ON SITE, IS TO BE DESIGNED TO SUPPORT 38,556 KGS.

SITE NOTES:

- SITE PLAN BASED ON SITE SURVEY DRAWING.
- FOR ALL EXISTING SITE ITEMS, PROPERTY LINE DIMENSIONS, SEE SITE SURVEY PLAN/BUILT SITE SURVEY.
- EXISTING TOPOGRAPHY - BASED ON SITE SURVEY PLAN, REFER TO SITE SURVEY FOR ALL EXISTING TOPOGRAPHY INFORMATION.
- FOR LOCATION OF CATCHBASINS, MANHOLES AND FIREHYDRANT NEW AND OLD, SEE CIVIL.
- FOR SITE GRADING, SITE SERVICING PLAN, OVERLAND DRAINAGE, GEODETIC TOP OF FLOOR, SEE CIVIL.
- FOR ASPHALT PAVEMENT, HEAVY DUTY AND LIGHT DUTY, CONCRETE PAVEMENT, SUBGRADES, DEPTH AND SPECIFICATIONS, REFER TO GEOTECHNICAL REPORT.
- ASPHALT DRIVEWAY - HEAVY DUTY - SHALL SUPPORT A LOAD OF 85,000LB, 38556 kg.
- SIDEWALK EXPANSION JOINTS @ 7500 OC MAX & @ CURVES, TANGENTS & CORNERS
- ALL SIDEWALK AND DRIVEWAY THAT IS TO BE REPAIRED OR BUILT ON CITY PROPERTY, MUST FOLLOW CITY STANDARD, CONTACT CITY FILE MANAGER PRIOR TO CONSTRUCTION.
- ALL PAVEMENT MARKINGS AND SIGNS - ARROW, HANDICAP STALL PAVEMENT MARKING, ZEBRA CROSSING, CROSS WALKS, PARKING STRIPES PER TO CITY STANDARD. IN THE ABSENCE OF ANY CITY INFORMATION, PAINT TO BE OHSA YELLOW.
- ALL SITE ELEMENTS SUCH AS BENCHES, SIAMSESE ETC IS DIMENSIONED TO CENTERED, UNLESS THE DIMENSION IS SHOWN TO THE PERIMETER OF THE OBJECT, IN THAT CASE IT IS DIMENSIONED TO THE FACE.
- ALL DIMENSIONS FROM BUILDING IS TO THE SHEATHING OR EXTERIOR GRID. SEE FLOOR PLAN FOR GRIDS. ALLOW MAX 150MM FOR CLADDING.
- ALL WEATHER ROAD - 6000MM WIDE. TO BE CREATED DURING CONSTRUCTION. ROADWAY TO BE UNOBSTRUCTED AT ALL TIME, AND BE CAPABLE OF SUPPORTING 39,000KG LOAD.
- FIRE HYDRANTS MUST BE OPERATIONAL DURING ALL PHASES OF CONSTRUCTION.
- BICYCLE RACK TO BE 600MM OC FROM ANOTHER BICYCLE RACK, FOLLOW MANUFACTURER'S SUGGESTED CLEARANCE.
- ANY EXISTING CITY SIDEWALKS OR ELEMENTS ON CITY PROPERTY THAT WAS DAMAGED DURING CONSTRUCTION MUST BE REPAIRED PRIOR TO COMPLETION.
- BARRIER FREE CURB CUT, WITHIN PROPERTY MUST MEET BUILDING CODE. SEE DETAILS.
- PROVIDE BARRIER FREE SIGN IN FRONT OF EACH BARRIER FREE PARKING STALLS.
- IF PARKING STALL IS NOT SPECIFICALLY DIMENSIONED, FOLLOW CITY BYLAW STANDARD.
- FOR ANY DROP IN HEIGHT GREATER THAN 600MM HIGH IN SITE SURFACE, SIDEWALK OR LANDSCAPING OR RETAINING WALL PROVIDE GUARD RAIL 1070 HIGH.
- SIDEWALK SHALL HAVE A MAXIMUM CROSS SLOPE OF 2%.
- SIDEWALK TO HAVE MAXIMUM SLOPE OF 10%.
- RAMP SURFACE - W/ 12.5 DEEP DRAINAGE GROOVES & 150(H) X 250(W) CONC CURB ON BOTH SIDES
- RESERVED - (STEEL ANGLE CORNER GUARD TO BE L 102X102X6.4, 1200 HIGH & PAINTED OHSA YELLOW)
- REFER TO LANDSCAPE DRAWINGS FOR TREES/SHRUBS SCHEDULE AND LANDSCAPE INFORMATION.
- SITE GRADING AND DRAINAGE, ARE TO BE VERIFIED BY CONTRACTOR BEFORE EXECUTING WORK. IF ARCHITECTURAL DRAWINGS SHOWS THESE INFORMATION, IT IS ONLY FOR COORDINATION PURPOSE. SEE CIVIL DRAWINGS TO VERIFY.
- MOLOK TO BE INSTALLED PER MANUFACTURER'S RECOMMENDATIONS.
- RUBBER WHEELSTOP TO BE - BURNO LANDSCAPE CENTRE, RUBBER PARKING CURB, 6"X4"X6"
- PARKIGN SIGNAGE:
 - A. ACCESSIBILITY SIGNAGE - SEE
 - B. SIGNAGE FOR LOADING STALL SIGNAGE TO STATE: LOADING STALLS - MAX 30 MIN. SHORT TERM USE DURING OFF-PEAK TIMES.
- SEE LANDSCAPE DRAWING FOR ADDITIONAL SITE INFORMATION.
- ALL ELECTRICAL SERVICING FOR FREESTANDING LIGHT STANDARDS MUST BE PROVIDED FROM UNDERGROUND.

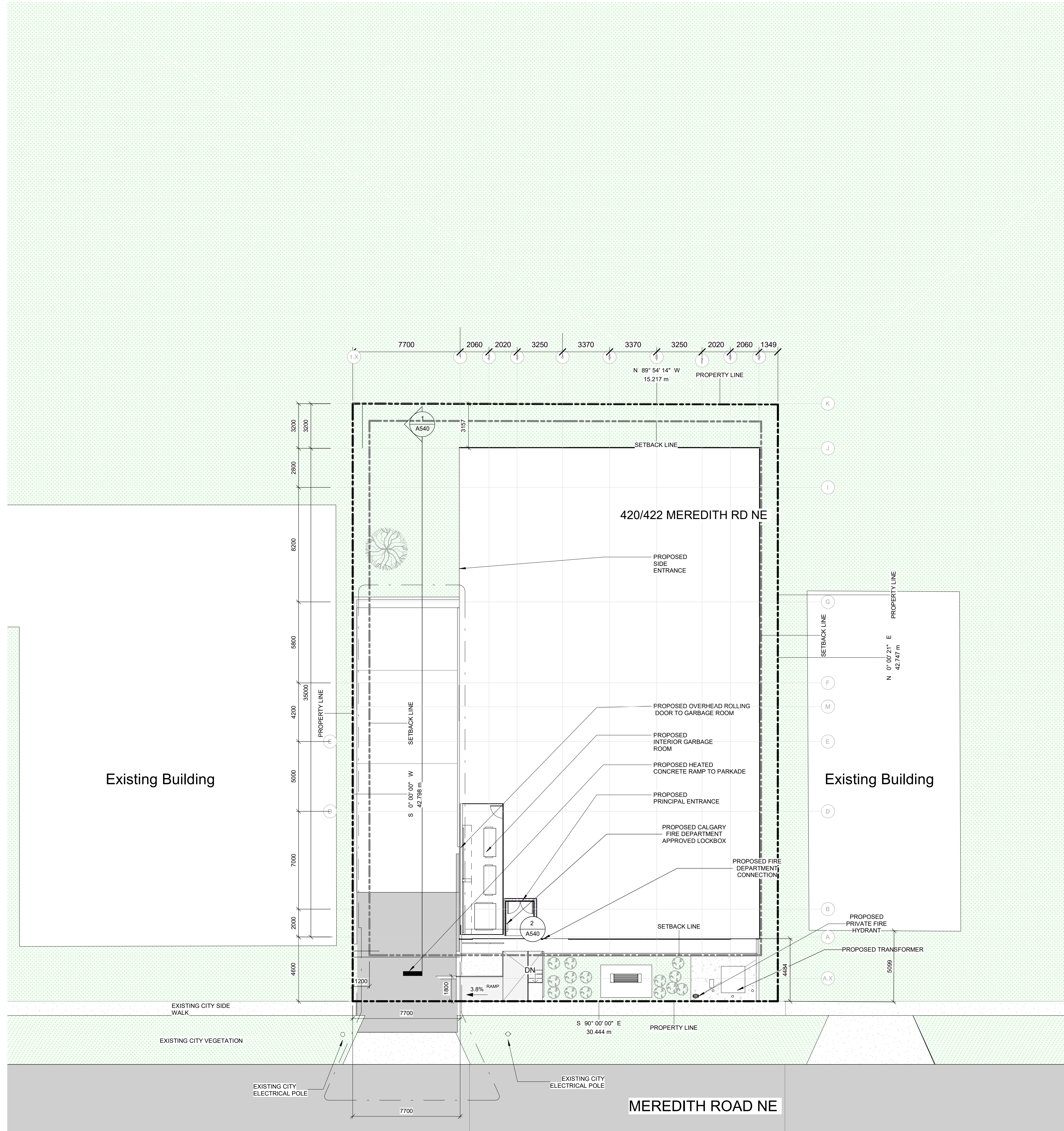

1 SITE PLAN
A100 1 : 150

2	2024-10-02	DP - CR - RESPONSE	M/E	R/B
1	2024-07-04	DEVELOPMENT SUBMISSION	M/E	R/B
No. : YYYY-MM-DD		ISSUED FOR	DRN	CHK

REVISION:
MUNICIPAL ADDRESS:
420 MEREDITH RD NE, CALGARY,
AB T2E 5A6

LEGAL ADDRESS:
LOT 6&7, BLOCK 1, PLAN E

PROJECT TITLE:
MEREDETH
APPARTMENT

SHEET TITLE:
SITE PLAN

PROJECT NO.: CN-011
SHEET NO.:
A100

CLIENT

CONSULTANTS:

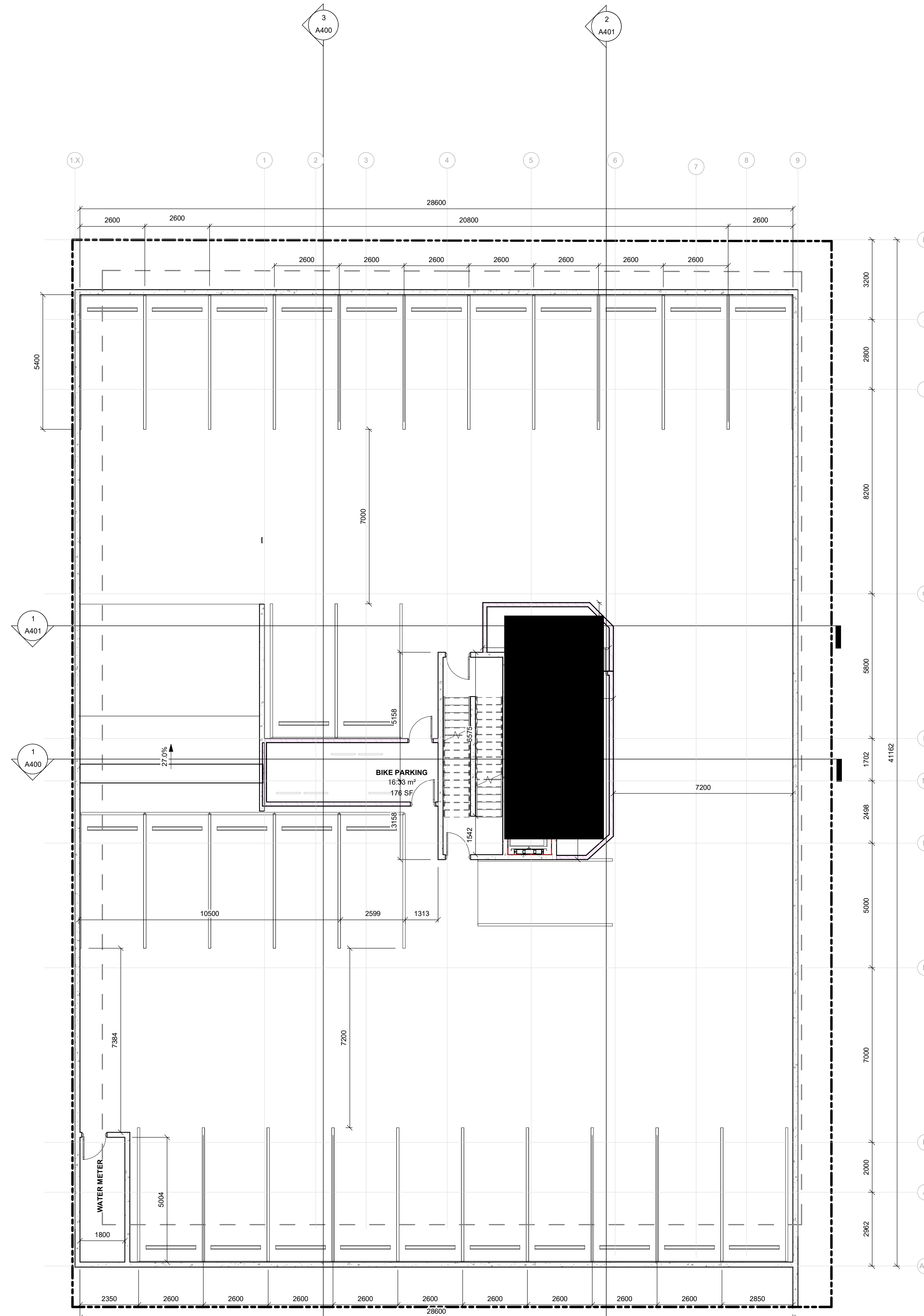

1 FLOOR PLAN - PARKADE
A225 1 : 100

2	2024-10-02	DP - CR - RESPONSE	M.E.	R.B.
1	2024-07-04	DEVELOPMENT SUBMISSION	M.E.	R.B.
No. YYYY-MM-DD		ISSUED FOR	DRN	CHK

REVISION:

MUNICIPAL ADDRESS:
420 MEREDITH RD NE, CALGARY,
AB T2E 5A6

LEGAL ADDRESS:
LOT 6&7, BLOCK 1, PLAN E

PROJECT TITLE:
MEREDETH
APPARTMENT

SHEET TITLE:
PARKADE PLAN

PROJECT NO.:
CN-011

SHEET
NO:

A225

CLIENT

CONSULTANTS:

SCHEDULE - EXTERIOR MATERIALS	
LEGEND	MATERIAL NAME
3.45E	PRECAST - ORANGE
3.45H	PRECAST - BLUE
4.22A2	SITE - RETAINING WALL - BLOCKS
4.43A1	STONE SERIES - GLACIER EUROPEAN LEDGE
6	ASPHALT SHINGLE ROOF TILE
7.32	ROOF TILE - ASPHALT SHINGLE
7.42A6	Appliance - Stainless Steel - Brushed
7.42A6	Stainless Steel, Brushed
7.44A2	METAL SIDING - WOODGRAIN 6" - AUTUMN
7.44F2	Default Floor
7.46.33A1	VINYL SIDING - WHITE
7.46.33A4	VINYL SIDING - DARK
7.46.33H	VINYL SIDING - BLUE
7.46.46B2	HARDIE PANEL STUCCO - PEARL GRAY
7.46A3	FIBRE CEMENT SIDING - 6" DARK GREY
8	STONE PAVEMENT
8.11A	DOOR - SERVICE - METAL - GREY
8.36A	DOOR - OVERHEAD - METAL - WHITE
8.41C	Default
8.81A	Glass - Exterior Glazing
9.24A	HARDIE PANEL STUCCO - ARCTIC WHITE
9.24A	STUCCO - WHITE
9.24B	STUCCO - GREY
9.24C	STUCCO - MEDIUM GREY
32.39A	BOLLARD - YELLOW OHSA
A.21A4	BRICK - IXL - MIDNIGHT BLACK



4 BUILDING ELEVATION - NORTH
A300 1 : 100



2 BUILDING ELEVATION - WEST
A300 1 : 100

LEGEND
LOCATION OF PLYWOOD BACKING BEHIND SIGNAGE.

- BUILDING ELEVATION NOTES:**
- NOTES:
1. ALL SIGNAGE IS NOT IN CONTRACT. SIGNAGE IS SHOWN FOR INFORMATION ONLY. SIGNAGE APPLICATION TO BE MADE SEPARATELY AT TENANT IMPROVEMENT STAGE.
 2. AT ALL SIGNAGE LOCATIONS, PROVIDE 13MM EXTERIOR GRADE PLYWOOD BACKING BEHIND SHEATHING.
 3. SEE ELECTRICAL FOR LIGHTING.
 4. PER REQUEST OF CITY OF CALGARY, ALL GLAZING TO BE CLEAR. NO COLOURED COATING OR TINT TO BE APPLIED.



5 ELEVATION - MATERIALS
A300 1 : 4

2	2024-10-02	DP - CR - RESPONSE	M.E	R.B
1	2024-07-04	DEVELOPMENT SUBMISSION	M.E	R.B
		ISSUED FOR	DRN	CHK

REVISION:

MUNICIPAL ADDRESS:
420 MEREDITH RD NE, CALGARY,
AB T2E 5A6

LEGAL ADDRESS:
LOT 6&7, BLOCK 1, PLAN E

PROJECT TITLE:
MEREDETH
APPARTMENT

SHEET TITLE:
BUILDING ELEVATION

PROJECT NO.: CN-011
SHEET NO.:
A300

CLIENT

CONSULTANTS:



1 BUILDING ELEVATION - SOUTH
A301 1 : 100



2 BUILDING ELEVATION - EAST
A301 1 : 100

SCHEDULE - EXTERIOR MATERIALS	
LEGEND	MATERIAL NAME
3.49E	PRECAST - ORANGE
3.49H	PRECAST - BLUE
4.22A2	SITE - RETAINING WALL - BLOCKS
4.43A1	STONE SERIES - GLACIER EUROPEAN LEDGE
6	ASPHALT SHINGLE ROOF TILE
7.32	ROOF TILE - ASPHALT SHINGLE
7.42A6	Appliance - Stainless Steel - Brushed
7.42A6	Stainless Steel, Brushed
7.44A2	METAL SIDING - WOODGRAIN 6" - AUTUMN
7.44F2	Default Floor
7.46.33A1	VINYL SIDING - WHITE
7.46.33A4	VINYL SIDING - DARK
7.46.33H	VINYL SIDING - BLUE
7.46.46B2	HARDIE PANEL STUCCO - PEARL GRAY
7.46A3	FIBRE CEMENT SIDING - 6" DARK GREY
8	STONE PAVEMENT
8.11A	DOOR - SERVICE - METAL - GREY
8.36A	DOOR - OVERHEAD - METAL - WHITE
8.41C	Default
8.81A	Glass - Exterior Glazing
9.24A	HARDIE PANEL STUCCO - ARCTIC WHITE
9.24A	STUCCO - WHITE
9.24B	STUCCO - GREY
9.24C	STUCCO - MEDIUM GREY
32.39A	BOLLARD - YELLOW OHSA
A.21A4	BRICK - 1XL - MIDNIGHT BLACK

LEGEND
LOCATION OF PLYWOOD BACKING BEHIND SIGNAGE.

BUILDING ELEVATION NOTES:
NOTES:
1. ALL SIGNAGE IS NOT IN CONTRACT. SIGNAGE IS SHOWN FOR INFORMATION ONLY. SIGNAGE APPLICATION TO BE MADE SEPARATELY AT TENANT IMPROVEMENT STAGE.
2. AT ALL SIGNAGE LOCATIONS, PROVIDE 15MM EXTERIOR GRADE PLYWOOD BACKING BEHIND SHEATHING.
3. SEE ELECTRICAL FOR LIGHTING.
4. PER REQUEST OF CITY OF CALGARY, ALL GLAZING TO BE CLEAR. NO COLOURED COATING OR TINT TO BE APPLIED.

BRICK - 1XL - INTERSTATE BRICK PROFILES



A.21A4

DARK GREY



STUCCO



9.24A

WHITE



FIBREBOARD SIDING - JAMESHARDIE
HORIZONTAL SIDING - HARDIE PLANK,
LAP CEDARMILL & SMOOTH 5/8"



7.46A3

DARK GREY



METAL SIDING 4" SIDING
(COLOR: DIAMOND RIB - SMP PREPAINTED
STEEL)



7.44E2

GREY



ALUMINIUM COMPOSITE
PANEL
(ALPOLIC - 30 YRS
WARRANTY - STOCK COLOR)



7.42A5

DARK GREY



2	2024-10-02	DP - CR - RESPONSE	M.E	R.B
1	2024-07-04	DEVELOPMENT SUBMISSION	M.E	R.B
		ISSUED FOR	DRN	CHK

REVISION:
MUNICIPAL ADDRESS:
420 MEREDITH RD NE, CALGARY,
AB T2E 5A6

LEGAL ADDRESS:
LOT 6&7, BLOCK 1, PLAN E

PROJECT TITLE:
**MEREDETH
APPARTMENT**

SHEET TITLE:
BUILDING ELEVATION

PROJECT NO.: CN-011
SHEET NO.:
A301

Table 4-2: Tree Separations To Utilities

Deep Utilities	Poplar		Deciduous		Coniferous	
	Services	Mains Parallel to tree line	Services	Mains Parallel to tree line	Services	Mains Parallel to tree line
Sanitary	3.0 m	4.0 m	0 m ^b	2.5 m	0 m ^b	3.0 m
Storm (<4.5 m deep)	3.0 m	4.0 m	0 m ^b	2.5 m	0 m ^b	3.0 m
Water	3.0 m	4.0 m	0 m ^b	2.5 m	0 m ^b	3.0 m
Hydrants	3.0 m	4.0 m	N/A	2.5 m	N/A	3.0 m
Shallow Utilities	Poplar		Deciduous		Coniferous	
	Services	Mains Parallel to tree line	Services	Mains Parallel to tree line	Services	Mains Parallel to tree line
ATCO	2.0 m ^a	2.0 m ^a	2.0 m	2.0 m	2.0 m ^a	2.0 m ^a
TELUS	2.0 m ^a	2.0 m ^a	1.5 m	1.5 m	2.0 m ^a	2.0 m ^a
CTV	2.0 m ^a	2.0 m ^a	1.5 m	1.5 m	2.0 m ^a	2.0 m ^a
ENMAX	2.0 m ^a	2.0 m ^a	1.5 m	1.5 m	2.0 m ^a	2.0 m ^a
Overhead (to outside conductor)	9.0 m		7.0 m - 9.0 m		7.0 m - 9.0 m	
Transformers (within Utility Rights of Way)	N/A (Tree planting not permitted within Utility Rights-of-Way)					
Street Light Poles	Poplar		Deciduous		Coniferous	
	5.0 m		4.0 m - 5.0 m		Min. 4.0 m	

Notes: a) A 3.0 m separation may be required at the discretion of the utilities.
b) Pipe joints are not permitted on water or sewer services located under medians.
c) Trees on residential (15.0 m ROW) boulevards, with no sidewalks, can be planted 1.0 m from driveways. Driveway crossings are to be aligned, wherever possible, to allow space for tree planting.

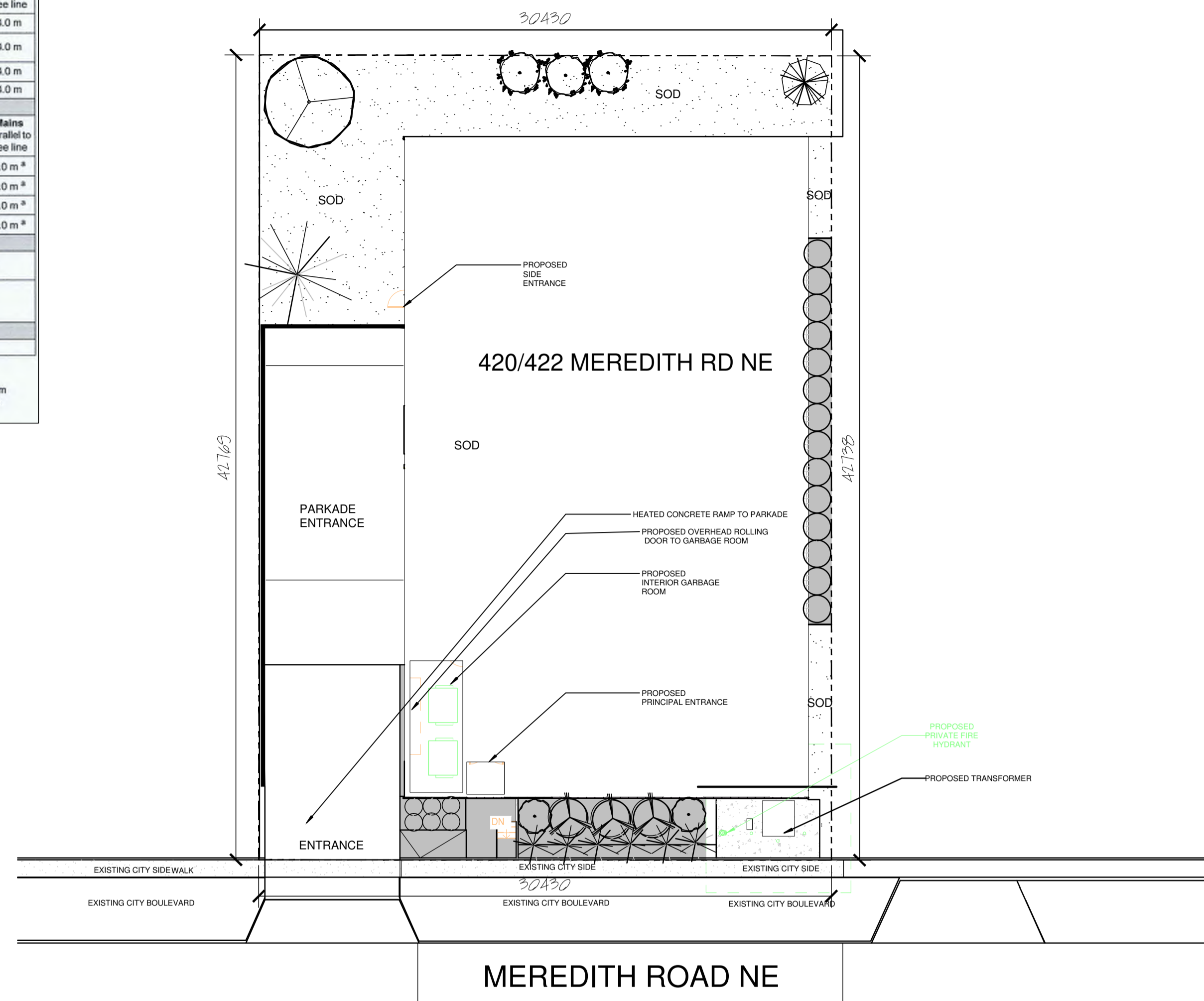

LANDSCAPE REQUIREMENTS:

NORTH YARD AREA- 30.43X12m SETBACK = 365m²
SOUTH YARD AREA- 30.43X9m SETBACK = 9129m²
EAST YARD AREA- 42.73X12m SETBACK = 5128m²
WEST YARD AREA- 42.77X12m SETBACK = 5132m²
TOTAL LANDSCAPE AREA: 230.34m²

TREES REQUIRED
- 1 TREE/35m² OF LANDSCAPE AREA 230.34 m² = 7 TREES REQUIRED
- 2 SHRUBS/35m² OF LANDSCAPE AREA 230.34m² = 14 SHRUBS REQUIRED

TOTAL CONIFEROUS TREE REQUIRED = 2 TREES
- 25% OF TREES TO BE CONIFEROUS: 7 X 25% = 2 TREES
- 50% CONIFEROUS TREES TO BE MIN. 2.0m HT. = 1 TREES
- 50% CONIFEROUS TREES TO BE MIN. 3.0m HT. = 1 TREES

TOTAL DECIDUOUS TREES REQUIRED: = 5 TREES
- 50% DECIDUOUS TREES TO BE MIN. 50mm CAL. = 3 TREES
- 50% DECIDUOUS TREES TO BE MIN. 75mm CAL. = 2 TREES

TOTAL CONIFEROUS TREES PROVIDED: = 2 TREES
- MIN. 2.0m HT. = 1 TREES
- MIN. 3.0m HT. = 1 TREES

TOTAL DECIDUOUS TREES PROVIDED: = 7 TREES
- MIN. 50 mm CAL. = 4 TREES
- MIN. 75 mm CAL. = 3 TREES

TOTAL TREES PROVIDED OVERALL = 9 TREES

TOTAL SHRUBS PROVIDED = 22 SHRUBS

PLANT LEGEND

- PURPLE SPIRE CRAB
- SPRING SNOW CRAB
- PARKLAND PILLAR BIRCH
- SWISS STONE PINE
- BLUE COLUMNAR SPRUCE
- SUMMER WINE NINEBARK
- ALPINE CURRANT
- CALGARY CARPET JUNIPER
- OVERDAM GRASS

LEGEND

- SOD ON 150 mm DEPTH TOPSOIL
- 75mm DEPTH CEDAR MULCH IN ALL PLANTING BEDS
ALL PLANTING BEDS SHALL HAVE PRO BLACK EDGING

PLANT LIST

QTY	COMMON NAME	BOTANICAL NAME	SIZE	REMARKS
TREES				
3	PURPLE SPIRE CRAB	MALUS JEFFSPIRE	50 mm CAL.	B&D
1	COLUMNAR BLUE SPRUCE	PICEA PUNGENS FASTIGIATA	2000 mm HT.	B&D
1	SWISS STONE PINE	PINUS CEMBRA	3000 mm HT.	B&D
1	PARKLAND PILLAR BIRCH	BETULA PLATYPHYLA JEFFPARK	50 mm CAL.	B&D
2	PARKLAND PILLAR BIRCH	BETULA PLATYPHYLA JEFFPARK	75 mm CAL.	B&D
1	SPRING SNOW CRAB	MALUS SPRING SNOW	75 mm CAL.	B&D
SHRUBS				
6	CALGARY CARPET JUNIPER	JUNIPERUS SABINA CALGARY CARPET	600 mm DIA POTTED	
2	SUMMER WINE NINEBARK	PHYSOCARPUS OPULIFOLIUS 'SEWARD'	600 mm HT POTTED	
14	ALPINE CURRANT	RIBES ALPINUM	600 mm HT POTTED	
PERENNIALS				
6	OVERDAM GRASS	CALAMAGROTIS 'OVERDAM'	2 YEAR CONTAINER	

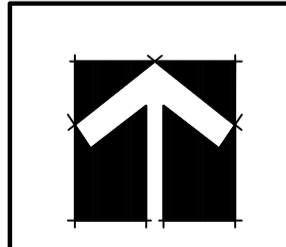

4				
3				
2				
1				
NO.	ISSUE	BY	DATE	APPROD

8				
7				
6				
5				
NO.	REVISIONS	BY	DATE	APPROD

SUB - CONSULTANT
SUB - CONSULTANT

CONSULTANT

Bruce E. Williams

J.L.A. GROUP
LANDSCAPE ARCHITECTURE

CLIENT
DRAWING SCALE: 1:300 Metric
Use, reproduction or revision of this drawing or its components is strictly prohibited without written permission from WLA Group Ltd. Any discrepancies or omissions shall be reported to the Landscape Architect prior to commencement of any work. The drawing or its components shall not be scaled.

DRAWN	DATE
BEW	JULY 04, 2024
DESIGNED	DATE
BEW	JULY 04, 2024
CHECKED	DATE
BEW	JULY 04, 2024
JULY 04, 2024	DATE
ISSUED FOR DEVELOPMENT PERMIT	
ISSUED FOR CONSTRUCTION	

PROJECT	
DRAWING	LANDSCAPE PLAN

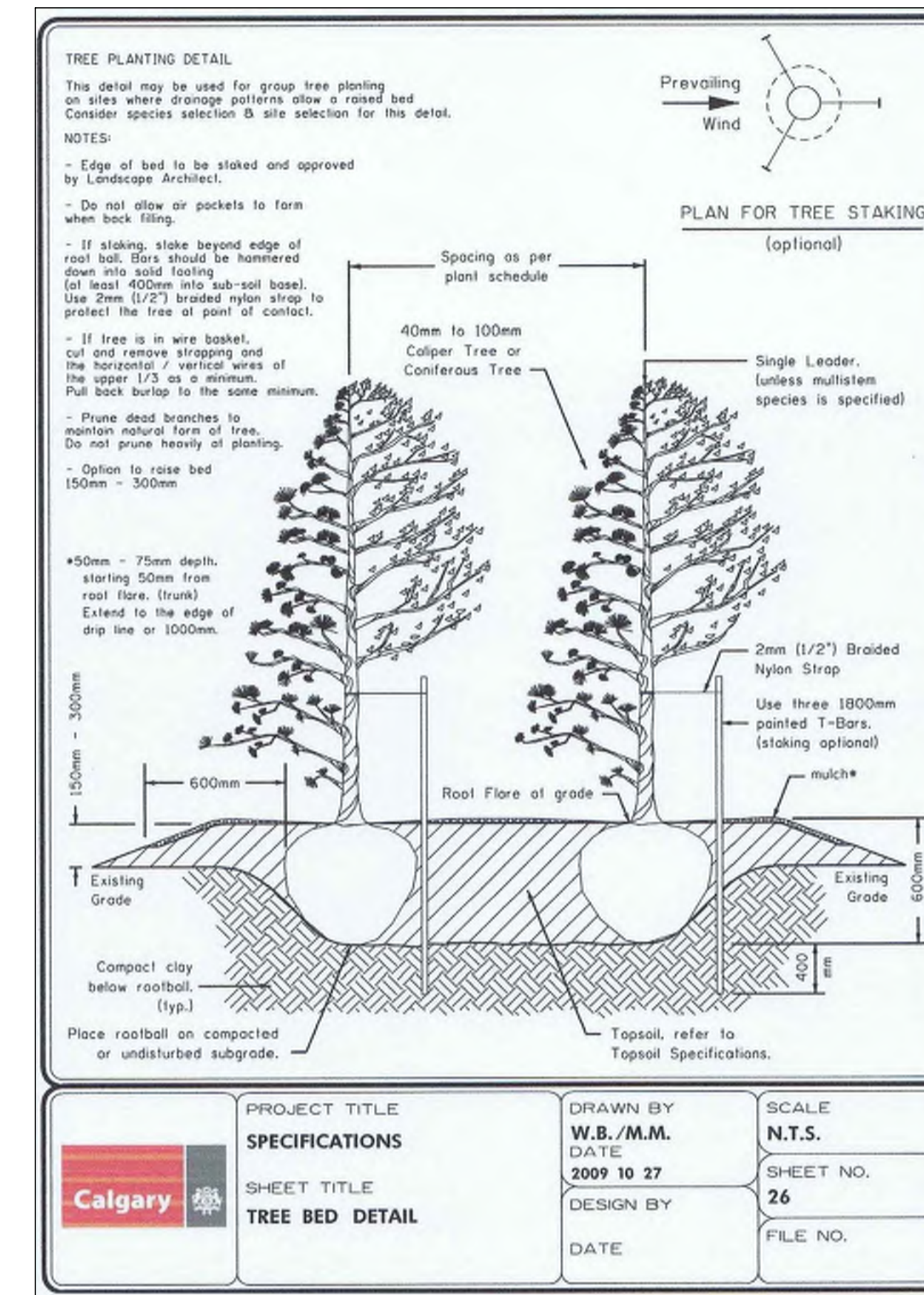
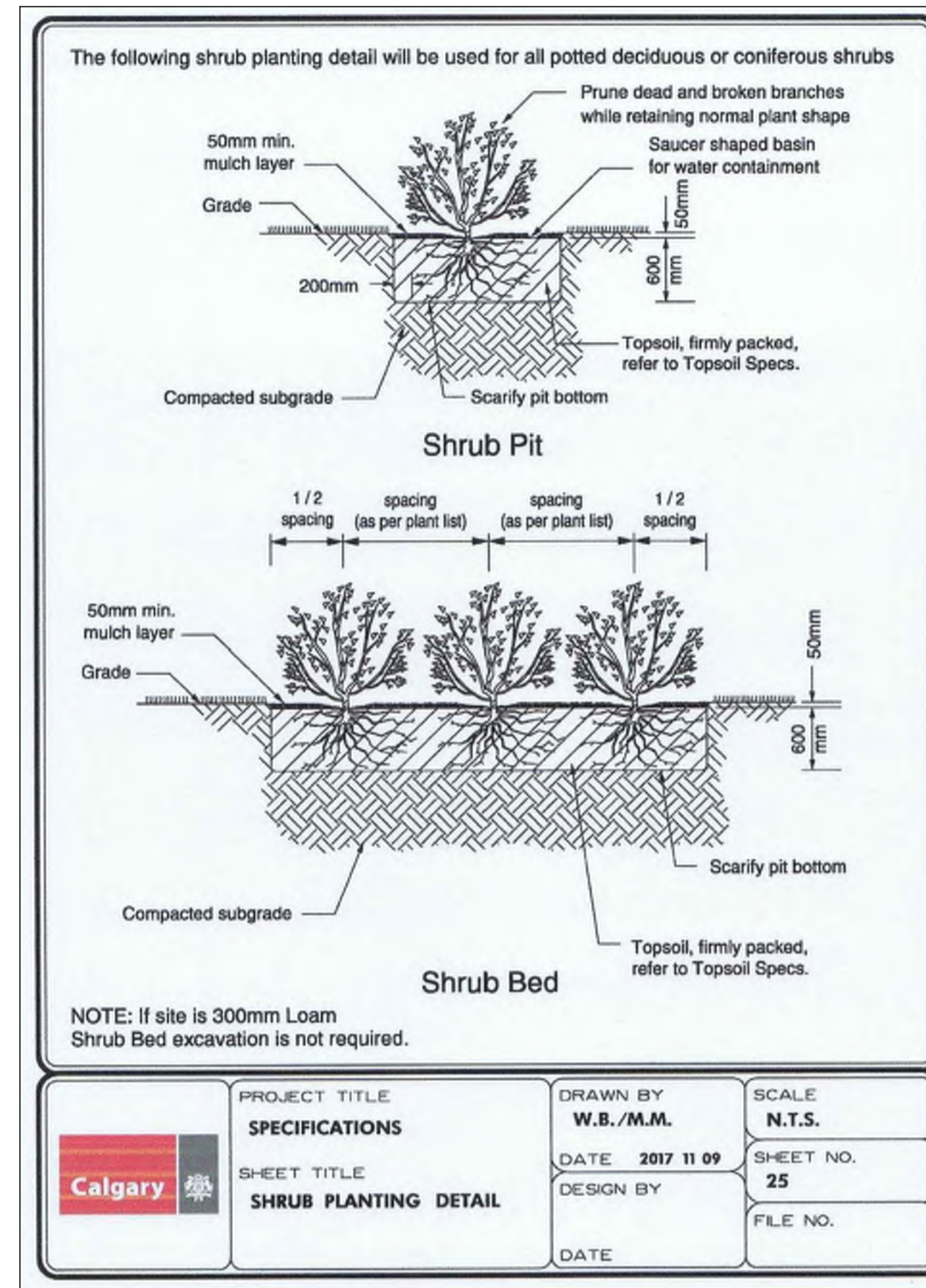
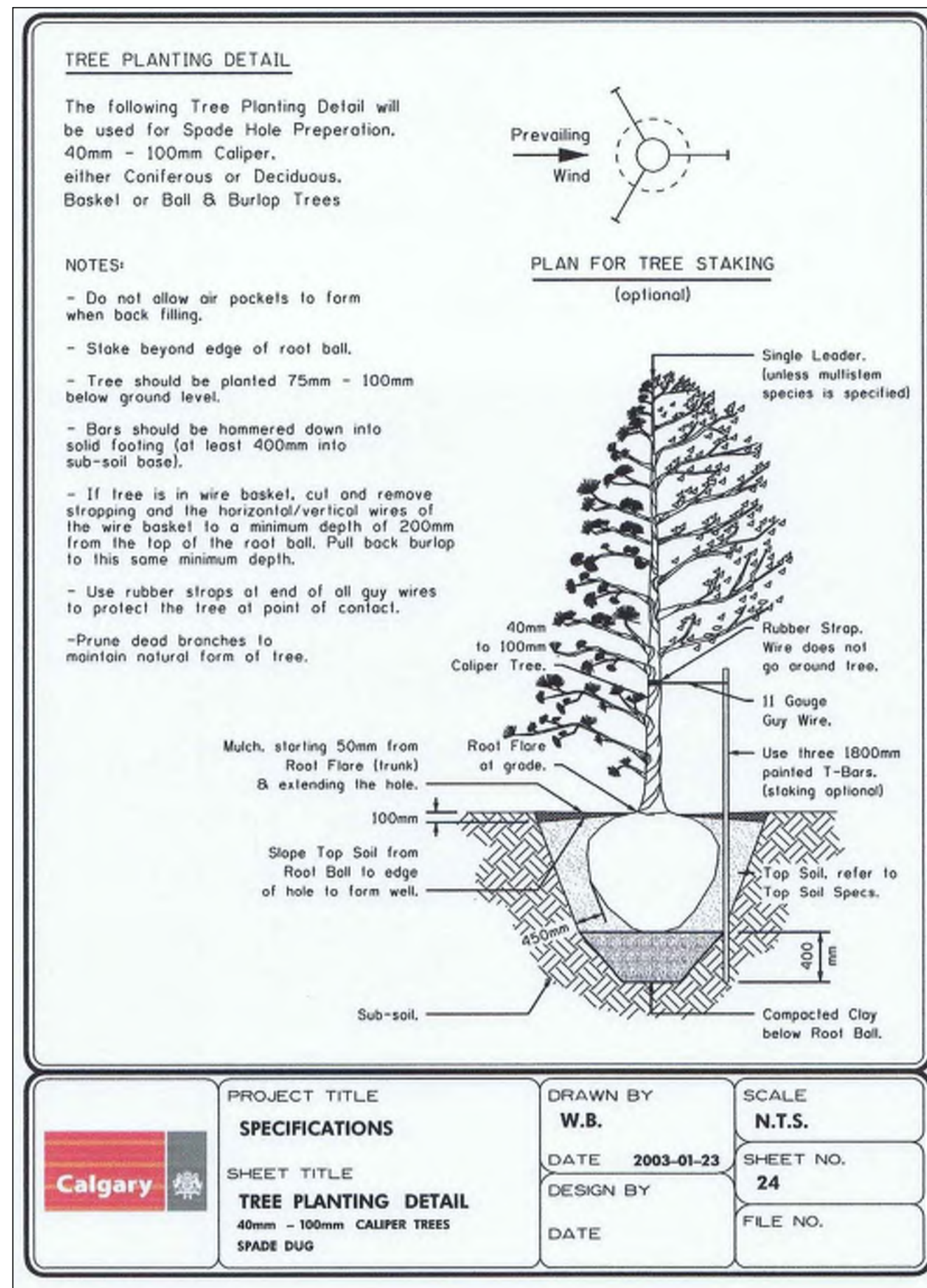

PLANTING NOTES:

1. CONTRACTOR TO CALL FIRST CALL AT 1-800-242-3447 TO HAVE EXISTING UTILITIES LOCATED PRIOR TO START OF ANY CONSTRUCTION.
2. CONTRACTOR TO ENSURE THAT ALL NECESSARY ARRANGEMENTS ARE MADE WITH THE PIPELINE COMPANIES CONCERNING THE MOVEMENT OF MATERIALS AND EQUIPMENT NEAR ANY PIPELINE RIGHT OF WAYS/
3. CONTRACTOR IS RESPONSIBLE FOR THE HOARDING OF ALL TREE WITHIN OR ADJACENT TO CONSTRUCTION AREAS.
4. CONTRACTOR IS RESPONSIBLE FOR HAULING OF ALL EXCESS MATERIALS OFF THE SITE.
5. CONTRACTOR IS RESPONSIBLE FOR ANY DAMAGE TO LANDSCAPED AREAS AND MUST MAKE ALL NECESSARY RESTORATIONS AND REPAIRS.
6. CONTRACTOR TO VERIFY ALL DIMENSIONS AND REPORT ANY DISCREPANCIES TO THE LANDSCAPE ARCHITECT.
7. LAYOUT TO BE APPROVED BY LANDSCAPE ARCHITECT PRIOR TO CONSTRUCTION STARTING.
8. ALL MEASUREMENTS IN MILLIMETERS UNLESS OTHERWISE NOTED.
9. ALL PLANT MATERIAL TO BE NURSERY GROWN STOCK AND SHALL MEET OR EXCEED THE SPEC'S OF THE CDN NURSERY TRADES ASSOC. FOR SIZE, HT, SPREAD, GRADING QUALITY AND METHOD OF CULTIVATION.
10. NO SUBSTITUTIONS OF MATERIALS, PRODUCTS OR QUANTITIES WITHOUT PRIOR CONSENT OF LANDSCAPE ARCHITECT.
11. AREAS TO RECEIVE SOD TO HAVE TOPSOIL TO A DEPTH OF 100mm, AREAS TO RECEIVE SEED TO HAVE TOPSOIL TO A DEPTH OF 150mm, AREAS FOR PLANTING BEDS TO A DEPTH OF 450mm.
12. ALL PLANT MATERIAL AND WORKMANSHIP TO CONFORM TO THE REQUIREMENTS OF THE CITY OF CALGARY DESIGN AND CONSTRUCTION STANDARDS IN ITS MOST RECENT EDITION.
13. 75mm DEPTH SHREDDED BARK MULCH IN ALL PLANTING BEDS.
14. PLANTING TO BE IRRIGATED BY LOW WATER IRRIGATION. IRRIGATION SHALL BE PLACED IN TREE AND SHRUB AREAS ONLY IN ACCORDANCE WITH THE CITY OF CALGARY REQUIREMENTS.

4					
3					
2					
1					
NO.	ISSUE	BY	DATE	APPRD	

8					
7					
6					
5					
NO.	REVISIONS	BY	DATE	APPRD	

SUB - CONSULTANT	
SUB - CONSULTANT	

CONSULTANT

J.L.A. GROUP
LANDSCAPE ARCHITECTURE

CLIENT	
DRAWING SCALE:	
Use, reproduction or revision of this drawing or its components is strictly prohibited without written permission from WLA Group Ltd. Any discrepancies or omissions shall be reported to the Landscape Architect prior to commencement of any work. The drawing or its components shall not be scaled.	

DRAWN	BEW	DATE	JULY 04, 2014
DESIGNED	BEW	DATE	JULY 04, 2014
CHECKED	BEW	DATE	JULY 04, 2014
ISSUED FOR DEVELOPMENT PERMIT		DATE	JULY 04, 2014
ISSUED FOR CONSTRUCTION		DATE	

PROJECT

DRAWING

DETAILS

DPL-2